

1. Structure waterproof, with breathing apparatus design
2. Thin edge transparent end cover scheme, seamless stitching
3. High quality PC diffusing material, anti-UV anti-yellowing, uniform light, high light efficiency (square lampshade is available)
4. The lamp body is made of 6063 aluminum, surface oxidation resistance treatment, high heat dissipation and anti-corrosion performance
5. The control scheme is steady on and DMX512 protocol, can be customized different segmentation scheme, the system is stable and reliable

Spring buckle
installation type
installation scheme,
suitable for narrow
slot installation

Adopt 100~240V
voltage input,
suitable for different
engineering
requirements

LED LINEAR LIGHT

LLS-OP-W30A





- Small size
- Structural waterproof
- Easy maintenance
- Kinds of brackets optional
- A variety of control mode optional, DMX, 0-10V, DALI, steady on, etc.;

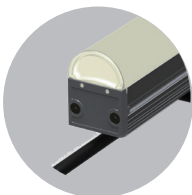
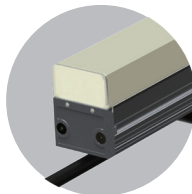

LED LINEAR LIGHT
LLS - OP - W30A

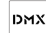
TPK®



Model	Length	Power(Max)	Colours	Lumen	Beam Angle	Control	Chips Brand	Package
LLS-OP-W30A-L6	L615mm	12W	2700K/3000K 4000K/5700K	480lm	160°	    	EPistar OSRAM CREE San'an BRIDGELUX LUMILEDS	0.58±5%Kg 40 Units/Ctn 125.5*32 *23CM
			R+G+B RGBW	300lm				
LLS-OP-W30A-L12	L1220mm	24W	2700K/3000K 4000K/5700K	960lm				1.16±5%Kg 20 Units/Ctn 125.5*32 *23CM
			R+G+B RGBW	600lm				

100-277
VAC

24
VDC

IP66

RGBW

-20°C~45°C



