

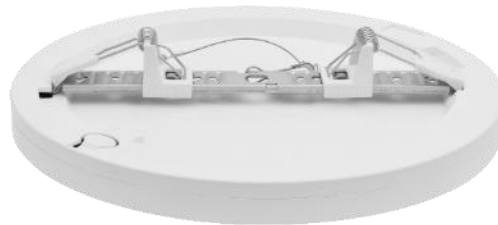

Percebes -Super Slim Panel light



NEW



Technology Parameter



Model	Size (mm)	Power	Cutout Round Hole	Cutout Square Hole	Flux(LM)	Voltage (V)	CCT Change	Radar Sensor	PF	Beam Angle	IP Grade	CCT(K)
PCB-170	Φ 170*19mm	12W	Φ 65-155mm	65-115mm	1000	165-265	√	√	0.5/0.9	120°	20	2700-6500
PCB-225	Φ 225*19mm	18W	Φ 65-210mm	65-155mm	1500	165-265	√	√	0.5/0.9	120°	20	2700-6500
PCB-330	Φ 330*19mm	24W	Φ 65-310mm	65-225mm	2100	165-265	√	√	0.5/0.9	120°	20	2700-6500
PCB-330	Φ 330*19mm	30W	Φ 65-310mm	65-225mm	2800	165-265	√	√	0.5/0.9	120°	20	2700-6500

Size Options:

19mm  =Only 2 Phones thickness !

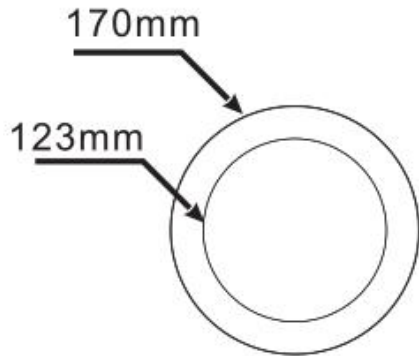

❶ 12W □170mm



Fit all cut-out from

 Round Hole 65-155mm

 Square Hole 65-115mm

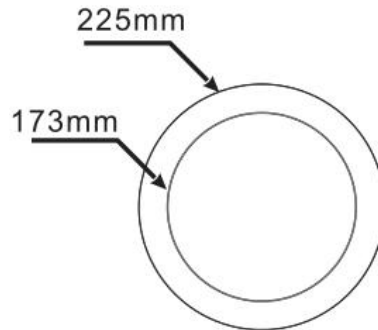

❷ 18W □225mm



Fit all cut-out from

 Round Hole 65-210mm

 Square Hole 65-180mm

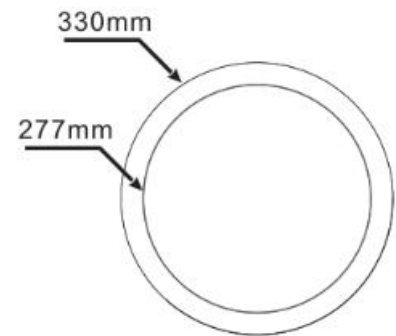

❸ 24W/30W □330mm



Fit all cut-out from

 Round Hole 65-310mm

 Square Hole 65-225mm

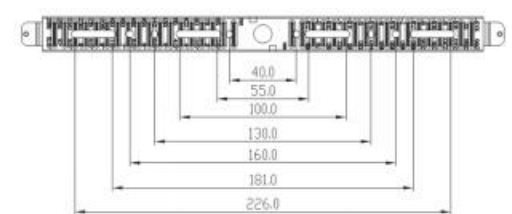
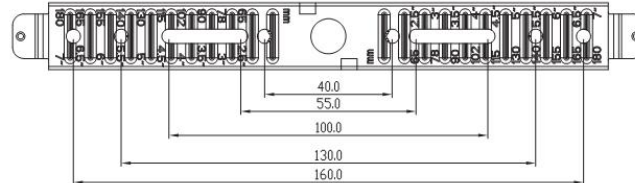
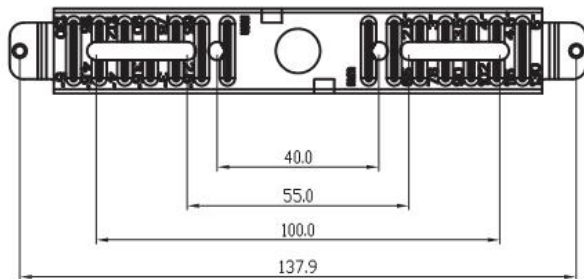

CCT Change +Power Change By Dip Switch

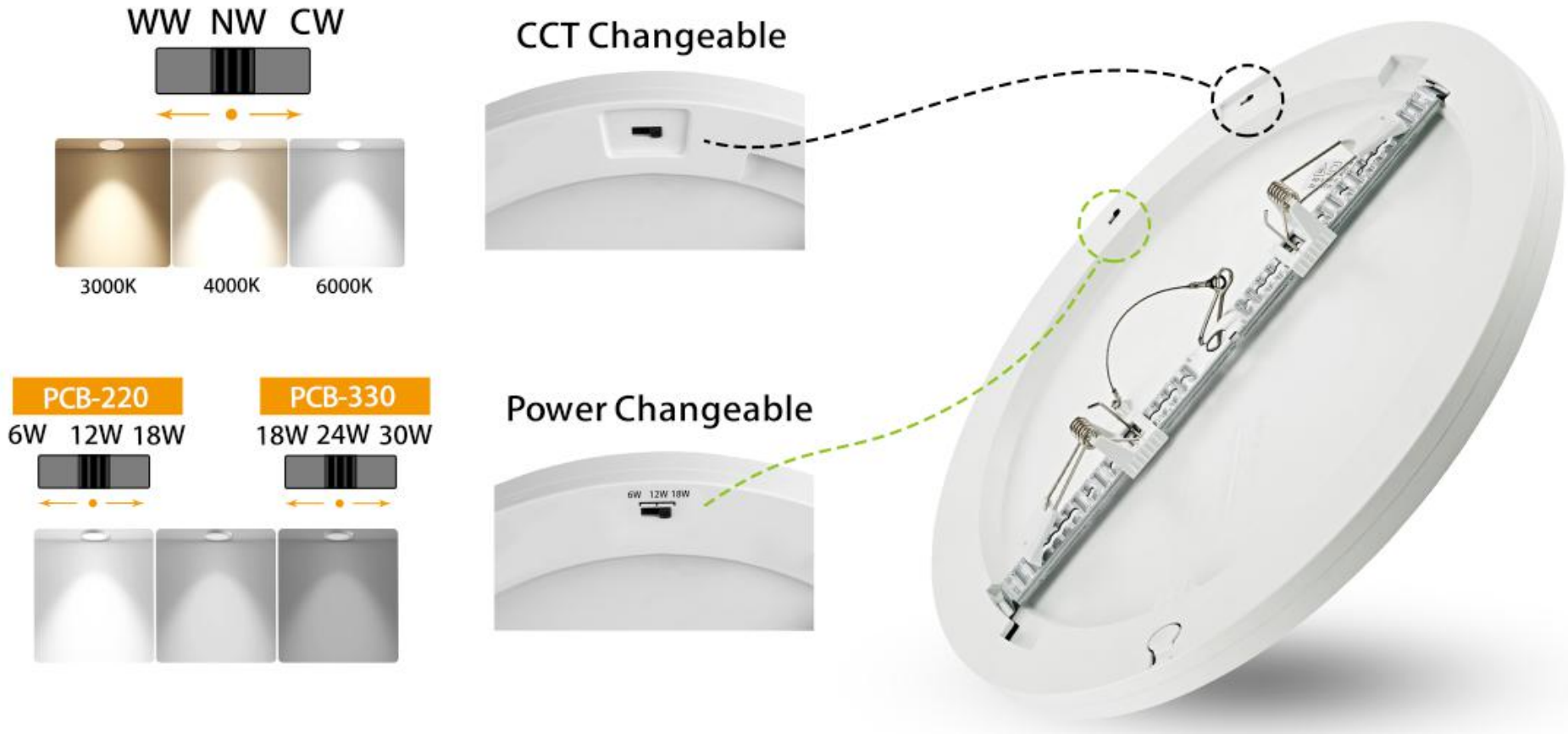

ADVANTAGES:

1. Save Investment
2. Save SKU
3. Save After-Buy Costs (Shipping + Warehouse + Local Delivery + Shelf Space)

DIY Metal Ring Options:



Original White Ring



Chrome Metal Ring



Black Metal Ring



Satin Nickel Metal Ring

Radar Sensor Function:



Can work in both day and night time,
NO need external sensor control module!

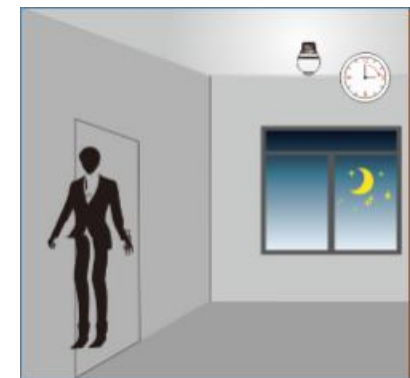
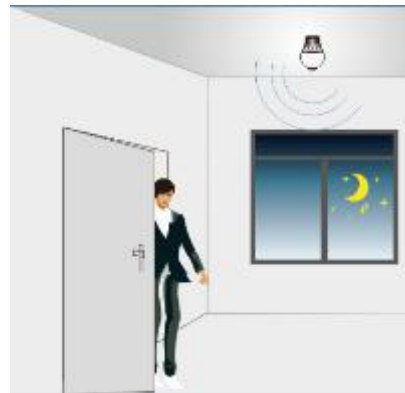
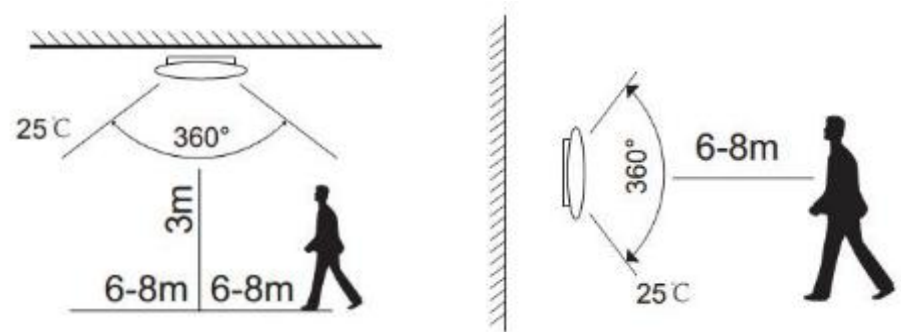

As long as a motion is detected , the lamp
will switch on automatically for about 30s .
And it will keep on as long as the motion
continues .



The Lamp will automatically
switch off in 30s after the
motion stops .

Traic Dimmable Function:



Rotate the dimmer to adjust your desired brightness



100% Brightness



50% Brightness



10% Brightness



WIFI Dimming + CCT change Function:

TOPjet

tuya[®]

Directly connected to WIFI
No need conversion

Various control at will

All-day cozy lighting

Build a healthy lifestyle

amazon alexa

Google Home

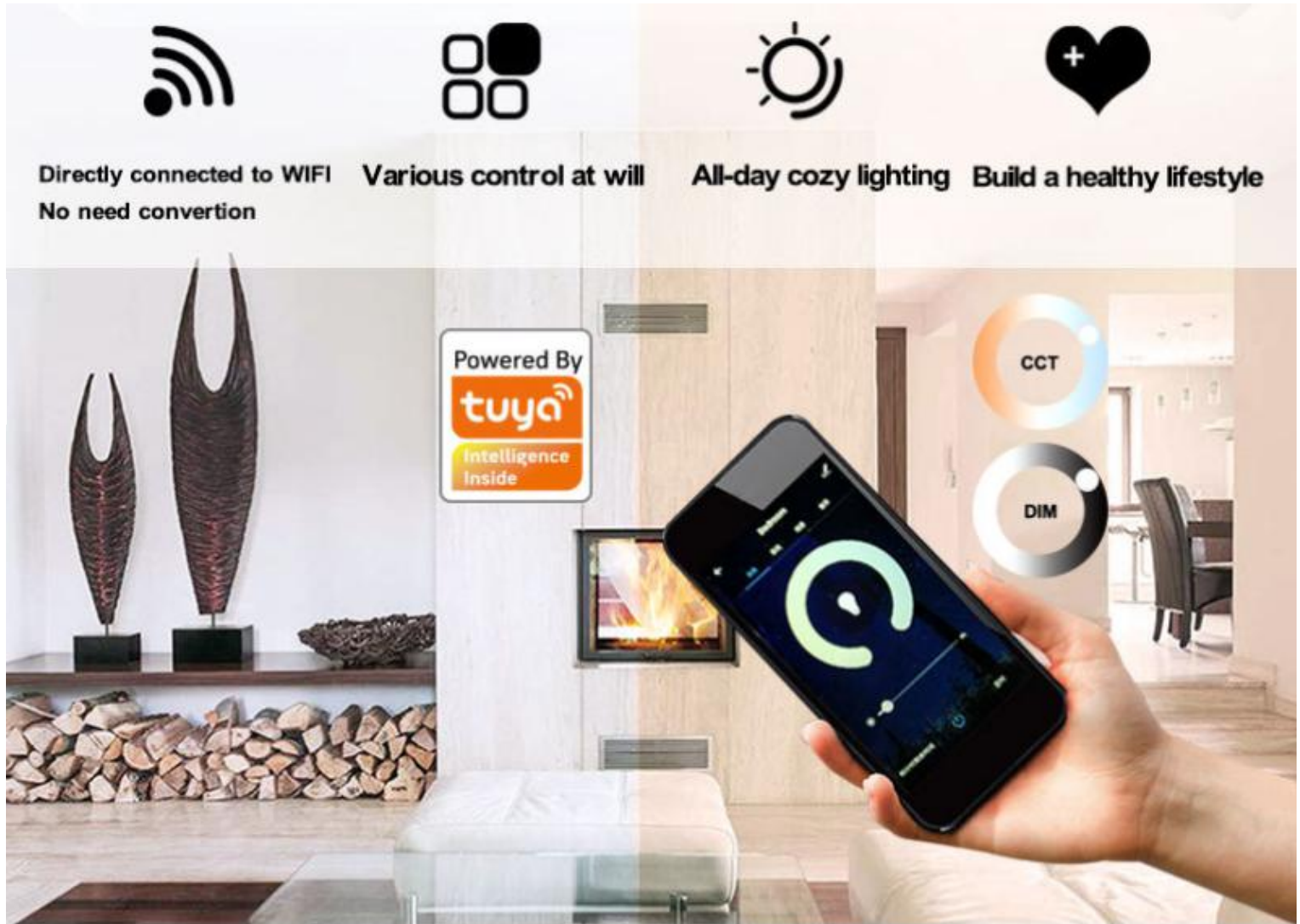

1: Built-in Wire connector

TOPJET

Built-in Wire Connector
Just simply plug in and play !



Traditional products

No wire connector



VS

Much more simple & fast installation,
additionally save wire connector costs !

2:Optional Magnetic version

TOPJET

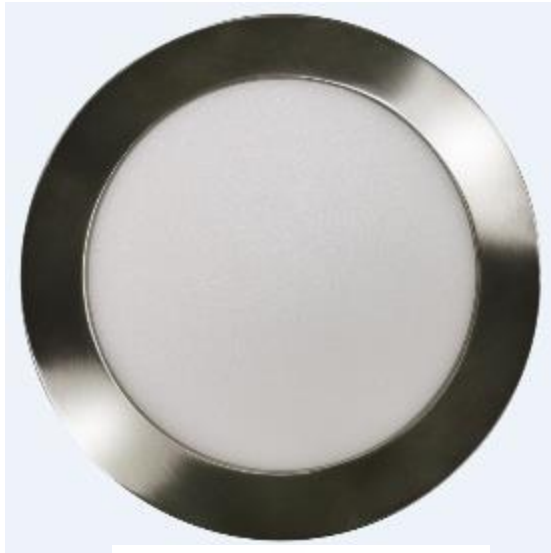

Replaceable metal ring ,DIY colors .
Much more market options !

Traditional products

No Metal Ring version



VS

3:Constant IC driver

TOPJET



Traditional products



Linear IC only

VS

1- Better stability.

The voltage can withstand 165-275V, linear only 200-240V. The lights are liable to break when the power grid fluctuates.

2- Longer service life

The actual service life can reach 3-5 years ! Linear IC lifetime is much shorter

3- Higher conversion efficiency

Up to 95%, linear only 75%, the lamp body heat will increase.

4:Low voltage LEDs

TOPJET

Traditional products

High voltage LEDs

VS



1- Have better performance .

Linear IC use high voltage LEDs. The heat and temperature will increase dramatically

2- Lower lumen depreciation than Linear IC during use.

Good maintenance on brightness . Linear IC will have bigger & quicker lumen depreciation.

Topjet light Ra>80



Other light Ra 60-80



Study Room



Living Room



Bed room



Hallways

Recessed ▼

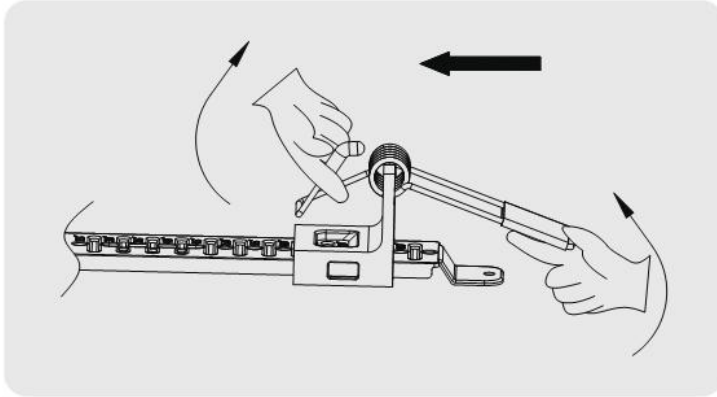

Pull the spring and push in

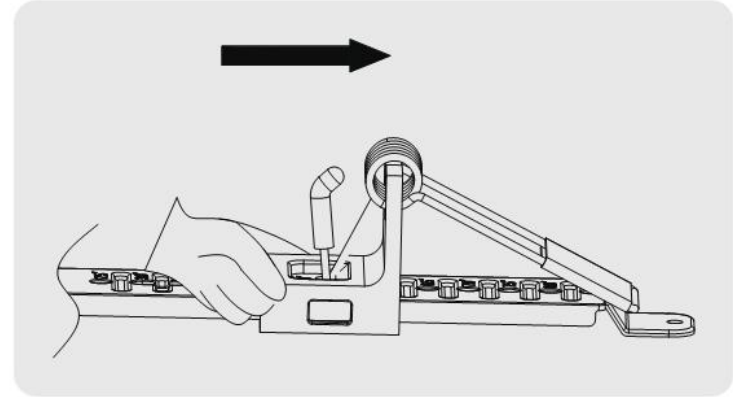

Push out directly to adjust

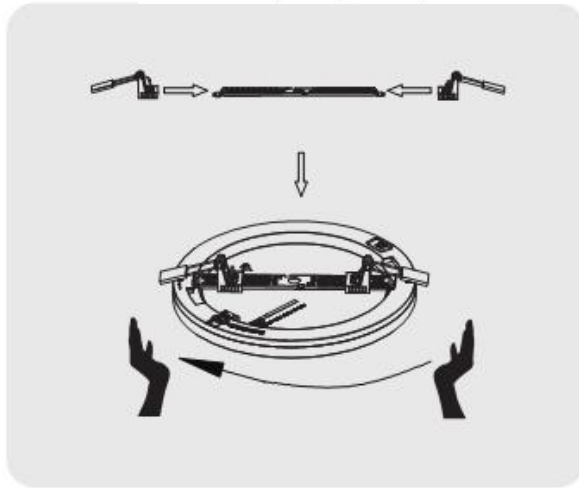

Step1 : Install the springs to the bracket. Ensure the spring stay at the suitable position according to the ceiling hole size. Install the bracket to panel.

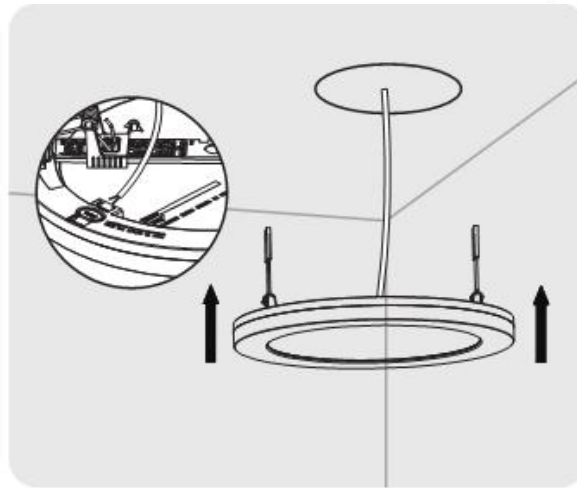

Step2: Directly push in wires into the connector;

Step3: Pick up the spring and install to the ceiling hole.



Surface-mounted

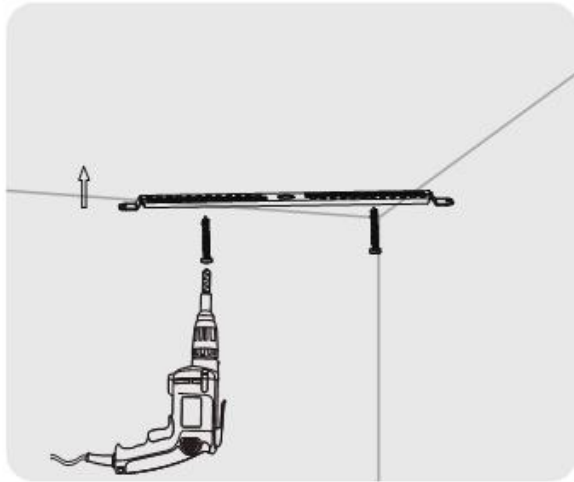
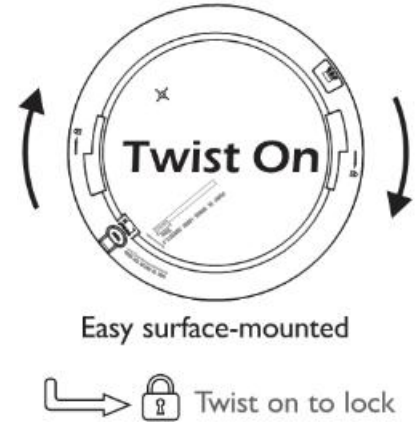
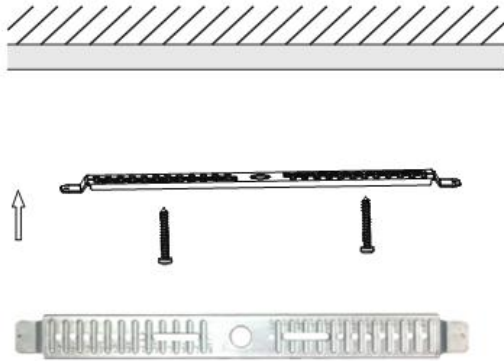

Step1:Fix the bracket on the ceiling;

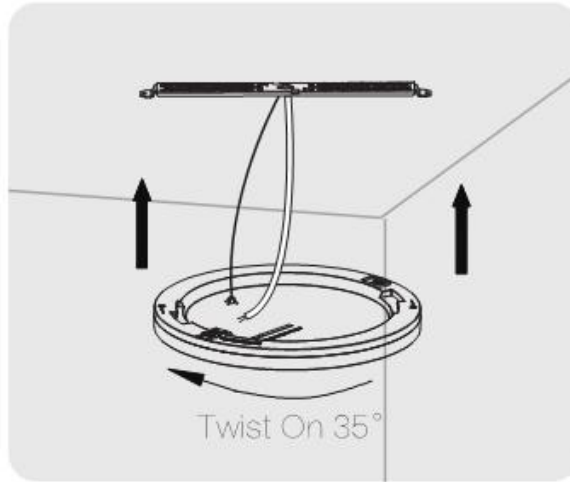

Step2:Connect the lamp's the power cable;

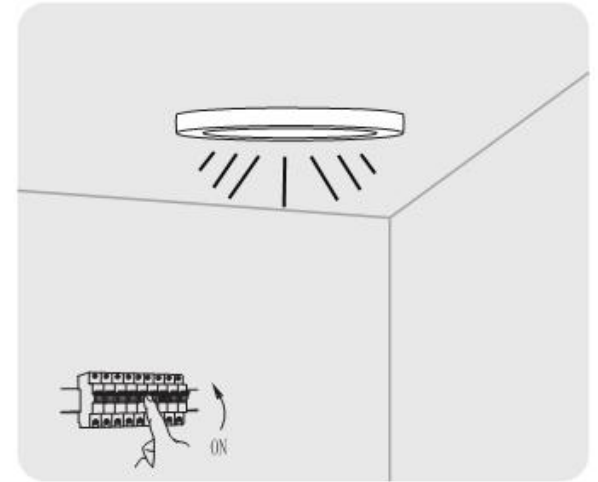

Step3:Twist on the fitting

Chain Store Packaging Ref.



Accessories



Leroy Merlin



Note : Extra packaging costs will be added accordingly.

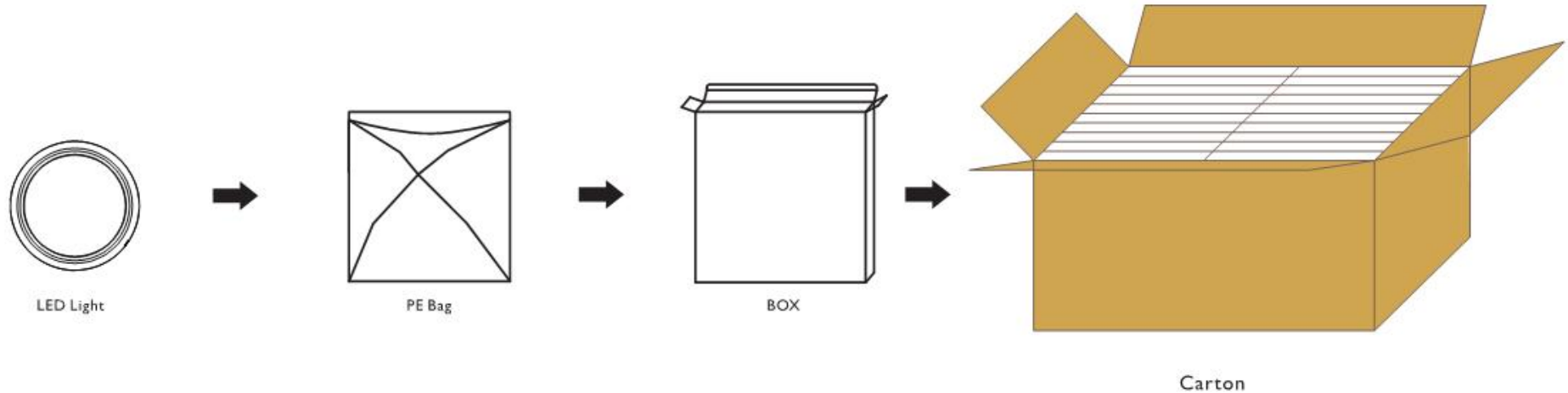

Package List:

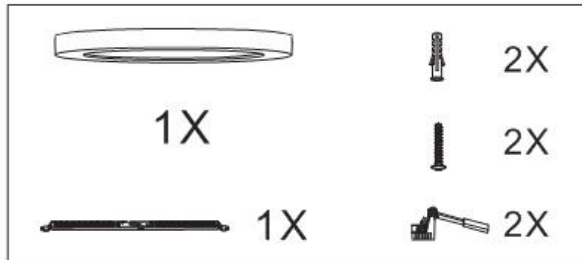

Model Item	C-170 (12W)	C-225 (18W)	C-330 (24W/30W)
Box Size	175x31x175mm	230x31x230mm	335x31x335mm
Qty / Box	1pcs	1pcs	1pcs
Carton Size	365x335x370mm	650x240x245mm	345x345x350mm
Qty / Carton	40pcs	20pcs	10pcs
G.W.	13.70KG	10.35KG	9.70KG
Qty / 20GP	24,756	9000	6000
Qty / 40GP	51,280	21000	15000

Note: there may be tolerance on weight, please check with us for details.

Flat Design !

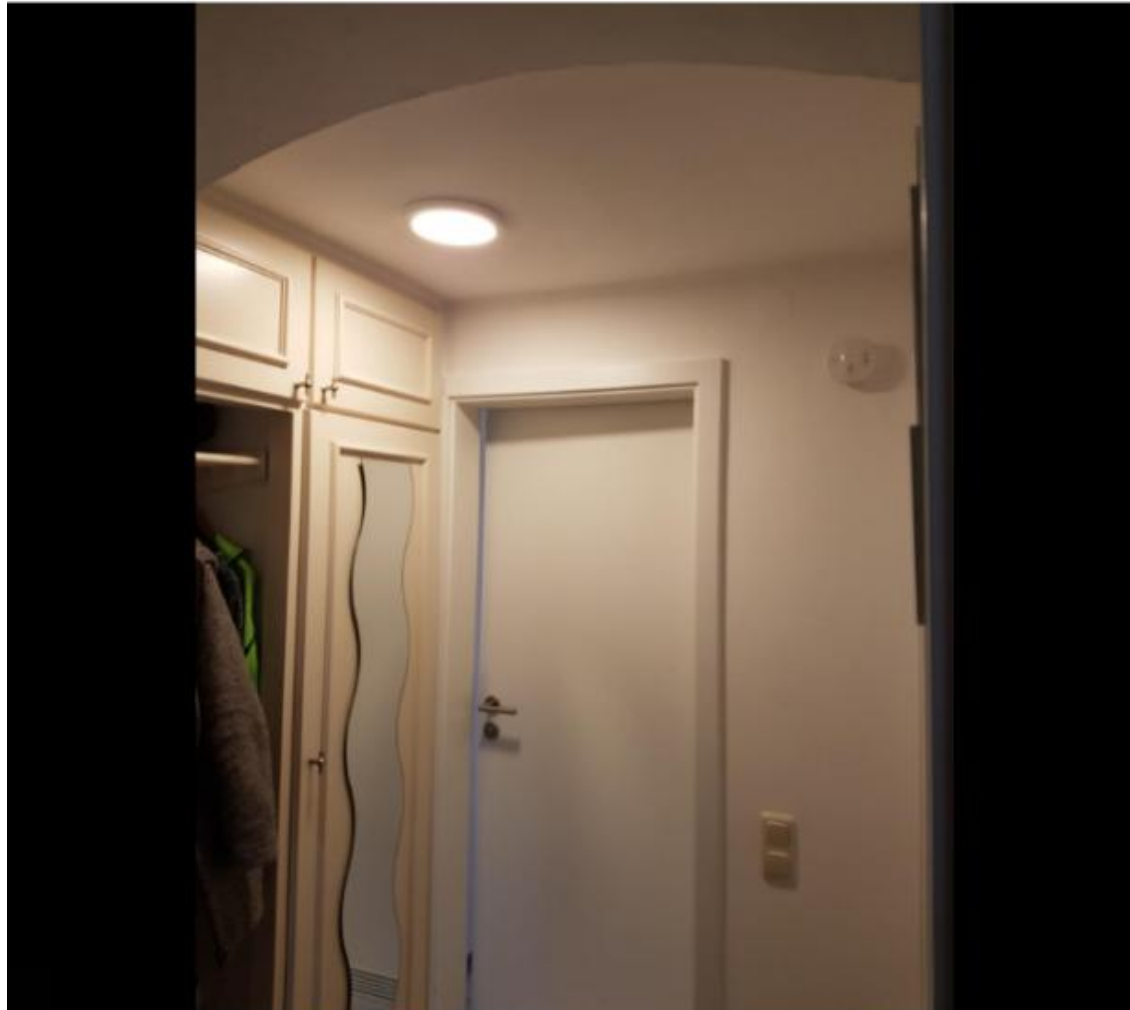

★★★★★ Perfect for my little hallway

By Wagner on Mar 04, 2020

Nice, flat and inconspicuous lamp.

I was looking for something similar to illuminate my little hall niche and still be able to open the compartment of the built-in closet.

Installation:

I put on surface, and it was the simplest lamp I have ever installed. Drill and dowel two holes, screw the holding rod to the ceiling, pinch the cable into the holes and screw it on.

And it got light ☺

I had an old 40 watt lamp before and it was much darker.

I am absolutely satisfied.

Images in this review



High Brightness!



★★★★★ Bright LED Light

By Andre S. on Feb 07, 2019

Very bright light and very flat lamp. I attached the lamp to the wall in our stairwell. The lamp is ideal for this because it is very flat. The brightness of the led lamp corresponds to 120 watts but only 18 watts led are consumed. I think it's good for my electricity bill and the environment.

There are brackets on the back in case someone wants to fix the lamp in a hole. The lamp comes on without the 1 second led delay time.

Images in this review



★★★★★ Surprisingly bright!

February 14, 2019

Verified purchase

Since I am a big friend of LED lights, I bought this flat LED light for our warehouse. Very amazing what such a small lamp with 18 watts of power brings in brightness. It is very light and easy to attach. I use you as a surface-mounted lamp. That was definitely not the last purchase. So far I am very satisfied.

flexible and easy to install!



Sandra Redeker

★★★★★ **Easy to assemble**

February 10, 2019

Verified purchase

The lamp is very bright and subtle. Because it is an LED lamp, the subtle design matches the economical and ecological LED illuminant. Assembly is made easier in that the construction of the lamp allows it to be screwed apart and attached "one after the other" to the ceiling.

It looks great in my bathroom and is highly recommended.

.....

★★★★★ **Top replacement for old recessed spotlights**

September 27, 2019

Verified purchase

In my house entrance I had to replace two old recessed spotlights (29 years old, 60W spotlights). Due to the size of the light bulbs and their heat development, I now had to cover two circular cutouts with a diameter of 160 mm. The Lumare LED ceiling light has adjustable clamps that easily fit for bolt circles up to 180 mm. The entire exchange was done in no time.

And now the best: the things also look great and bring a nice bright, friendly light. My wife and I are thrilled. Unfortunately I am afraid that I will have to install more of these LED ceiling lights now, because the neighbors also got a taste for it.

easy to install!



★★★★★ TOP!!!

By Horst Kittelmann on Feb 13, 2020

Simply beautiful TOP LED!

Easy to assemble and sufficient for my kitchen.

Would buy again and again TOP TOP product

!!!

Images in this review



ISO Certificates: ISO 9001: 2015 ISO 14001: 2015

International Certificates: CB CE RoHS TUV SÜD SAA PATENTED







Topjet Factory info:

- * 350 workers.
 - * Privately owned 20,000SQM Factory.
 - * Privately invested MOLDS.
 - * Have 40 Automatic Injection Machines To Make Plastic Housing.
 - * Do SMT and Driver by ourself.
- Have ISO 9001, ISO14001, TUV, CE, ROHS, SAA, CB, BIS certificates.

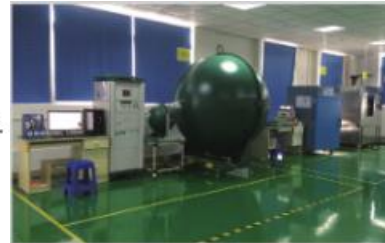

EMC Test Lab



Injection Machines

Worldwide Strategic Partners Wanted !

