



COMPANY PROFILE

REEL TECH

"New Maintenance Solutions for lighting on the ground level"



Established : 2002
Sales Amount : USD 8,000,000 (2023)
Employee : 35
Business Type: Manufacturer
Overseas Exports : 50 countries
Certificate : CE, TUV, ETL, FCC, ISO9001(Etc)

➤ **Date Of Foundation:**

February 5th, 2002

➤ **Employee Number**

35 (May, 2020)

➤ **President**

Mr. Shin Jeong Hoon

➤ **Head Office & Factory**

Suncheon-city, Jeonnam (South Korea)

➤ **Business Filed**

- Lifters for lightings
(High-bay, Industrial
down-light, Chandelier, etc)
- **CCTV Lifter**
- Smoke Detector Lifter
- Batten Type Lifter
- Partition Lifter



ABOUT US

Certification

"We focus on qualities and safeties for consumers"

Cooperation Certification

- INNO-BIZ Enterprise
- Venture Business

Award Certificates

- Awarded the Minister's honorable mention by the Ministry of Commerce, Industry and Energy
- Awarded as the best for the Top 100 Superior Patented Product

Quality and Safety Certification



Patents

- USA Patent
- Chinese Patent
- Korean Patent



Do you have problems with lighting maintenance? Solution to your problem is remote lighting lifter.

The infographic is divided into two main sections. The left section illustrates traditional methods: a person on a ladder, a person on a bucket, and a person on a scissor lift. The right section illustrates the REEL TECH method: three people at ground level using remote controls to adjust lights hanging from a ceiling. The ceiling is represented by a blue truss structure with three light fixtures hanging from it. The REEL TECH method is shown with three silhouettes of people at ground level, each holding a remote control and pointing it at a light fixture. The traditional methods are shown with three silhouettes of people on different types of lifting equipment, each reaching for a light fixture.

No HEAVY EQUIPMENT!
No need of rent the lifting equipment to maintenance.

No ELECTRIC SHOCK!
No electric current during maintenance and no risk of electric shock.

No DANGER!
No risk of work in high places and prevent the accident could happen during maintenance.

No PROFESIONAL!
No professional or skilled engineer to maintenance.

EASY TO OPERATE!
Can control with remote control or wireless panel control over 1,000,000 lifters and lighting fixtures by single remote control over 100m control distance.

EASY INSTALL METHOD!
Lifter has a center of gravity, so it be easily installed only by hanger hooks.

SAVE TIME!
No need to wait for professionals or short down time to maintenance.

SAVE MONEY!
Save cost of rent the lifting equipment to maintenance.

Electrical Contacts

The innovative circular contacts are rated to 16A. The female contacts are sprung so that the contact surfaces are always under pressure. These innovative circular contacts are detached from each other to isolate the electric current.

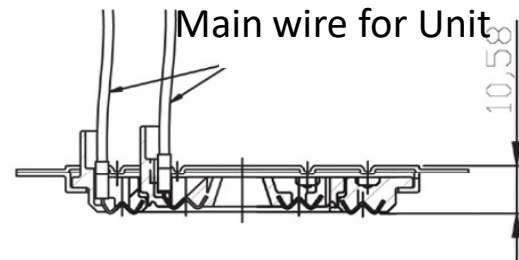
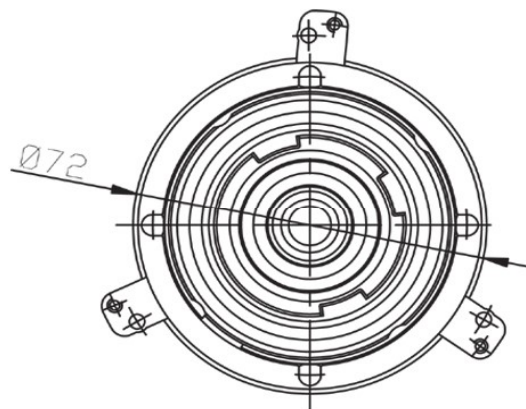

Upper part contact

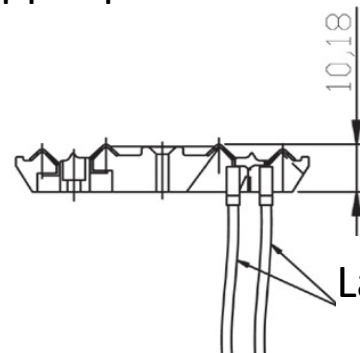
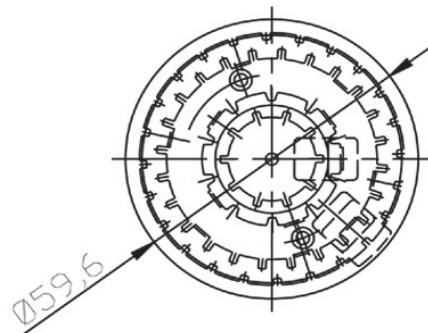

Lower part contact



◇ Locking-Device

When descending or ascending, lifter automatically stops interrupted or reaches the floor level.

◇ Suspension cable

Load capacity for single suspension cable is 10 times and double suspension cables are 10 times more.

◇ Slow Shaft

When lower contact cover is reaches to the slow shaft, it will reduce the speed of motor to prevent damaging the suspension cable.

◇ Locking Device

Illustrated can hold up to 1000kg of load so that the suspension cables are only under tension when in use.

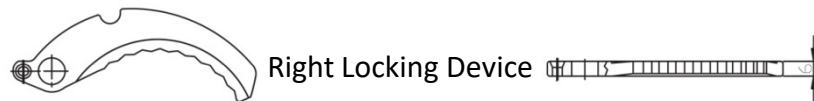

Right Locking Device



Left Locking Device

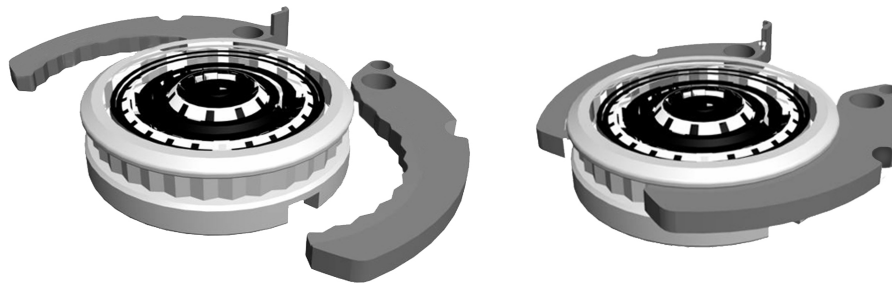

The locking device provides safety from falling.

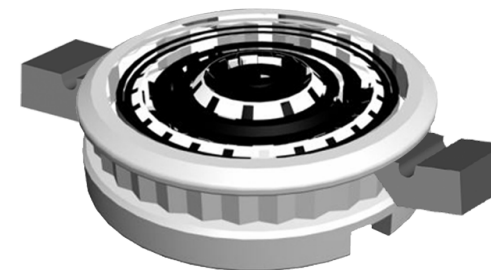

Compact type - Locking Device

"REEL TECH is leader of remote lighting lifter in the world"

Operation Method (Wireless)



< Handheld Remote Control



< Wireless Control Panel>

Unit>

Operation Method (Hard Wired)

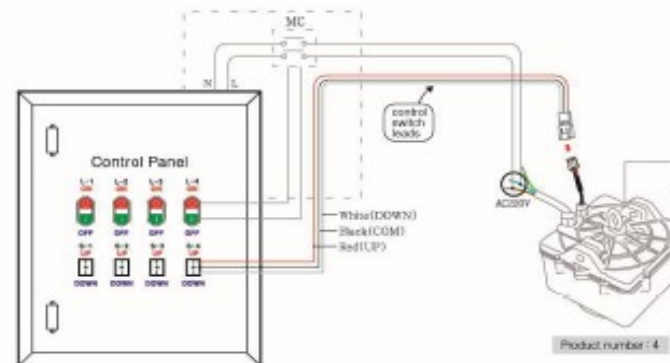

Panel size can be different along the installation place.

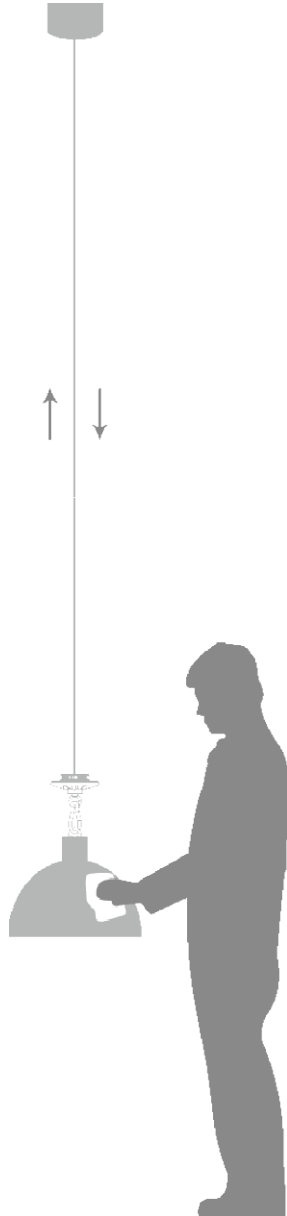



REEL TECH

PRODUCTS RANGE

"REEL TECH is leader of remote lighting lifter in the world"



< Mini Type >

< Compact Type >

< Hook up Type >



< Heavy Duty Type >

	Single Wire Type	Double Wire Type
Lowering Height	15m	10m
Loading Weight	1~50kg	

"REEL TECH is leader of remote lighting lifter in the world"



Model no.	PFI-100	PFI-200	PFI-300	PFI-500
Lowering Height	30m	20m	20m	15m
Loading Weight	50~100kg	60~200kg	100~300kg	100~500kg
* Remarks : Based on lowering height ,we can supply PFI-1000, PFI-1500				

< Super heavy duty type >

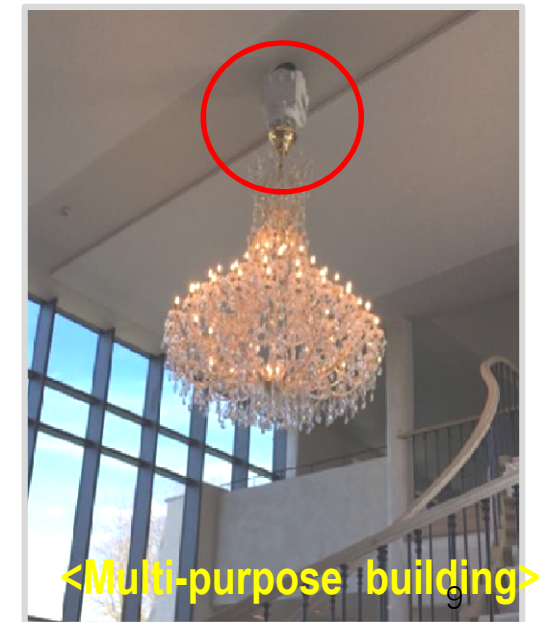

Adjustment of lowering height

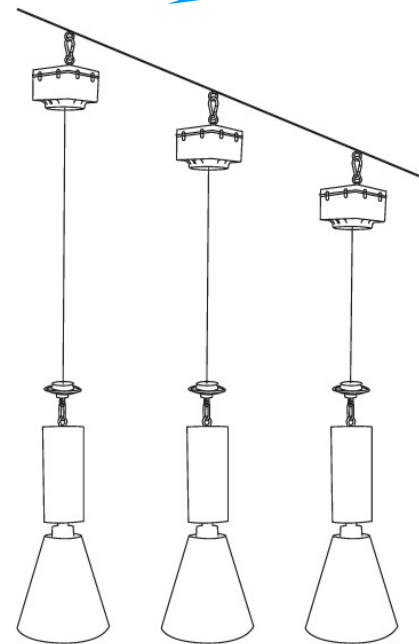
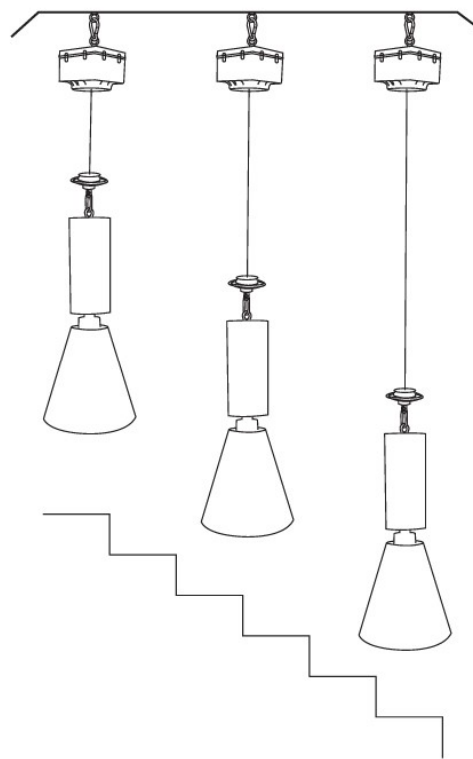
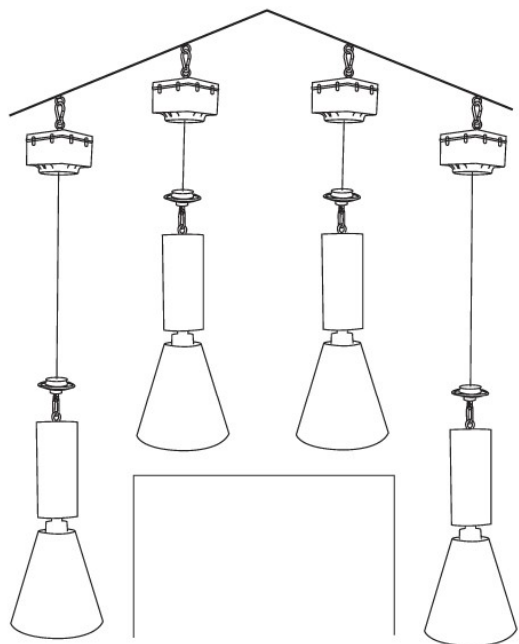

The lowering height of the lifter can be easily adjusted by pressing stop button.

To set-up the lowering height, you must set the lighting fitting in the position and press down the stop button for 3 seconds till you hears the beep noise.

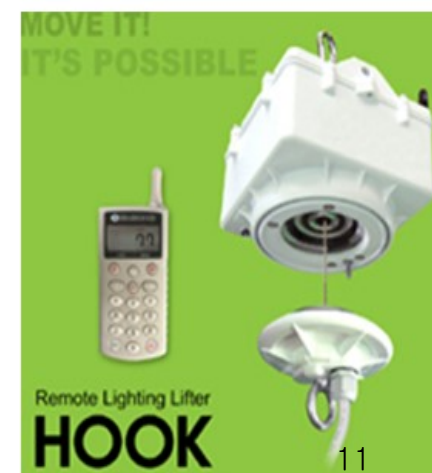

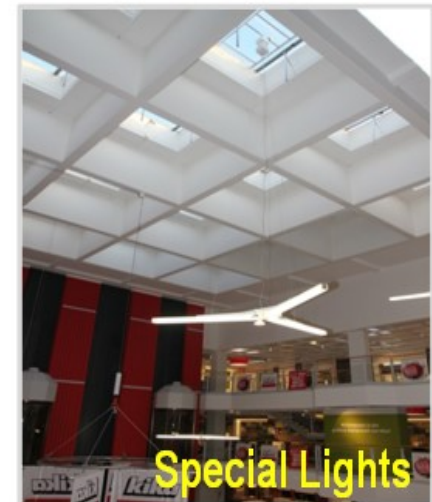

ABOUT US

Photo gallery

"REEL TECH is leader of remote lighting lifter in the world"



2006 LG Electronic Hong Kong Exhibition



2006 Korea International Dong-ah Fair Exhibition



2007 Korea International Housing Fair Exhibition

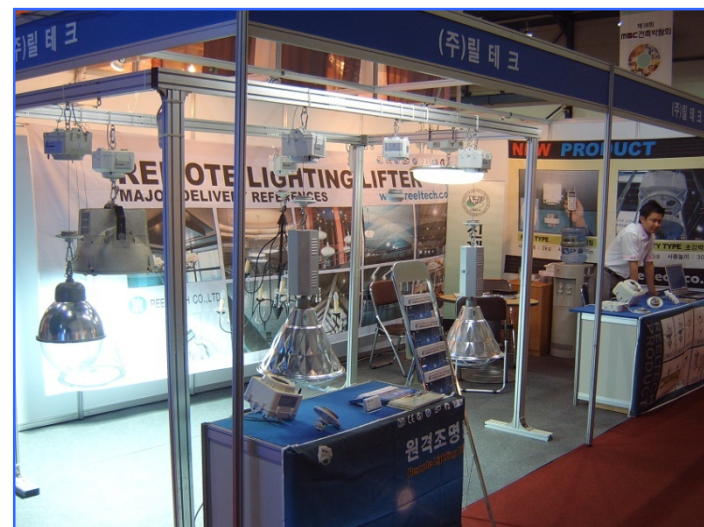

2007 Busan International Housing Fair Exhibition

ABOUT US

Photo gallery

"REEL TECH is leader of remote lighting lifter in the world"



2008 Light + Building Frankfurt Exhibition



2009 France BATIMAT



2009 Guangzhou International Lighting Fair



2010 Light + Building Frankfurt Exhibition

ABOUT US

Photo gallery

"REEL TECH is leader of remote lighting lifter in the world"



2011 Hong Kong Exhibition



Dubai 2012 Big 5 Show



2013 Hong Kong exhibition



2014 Hong Kong exhibition

ABOUT US

Photo gallery

"REEL TECH is leader of remote lighting lifter in the world"



2016 NSC Exhibition (USA)

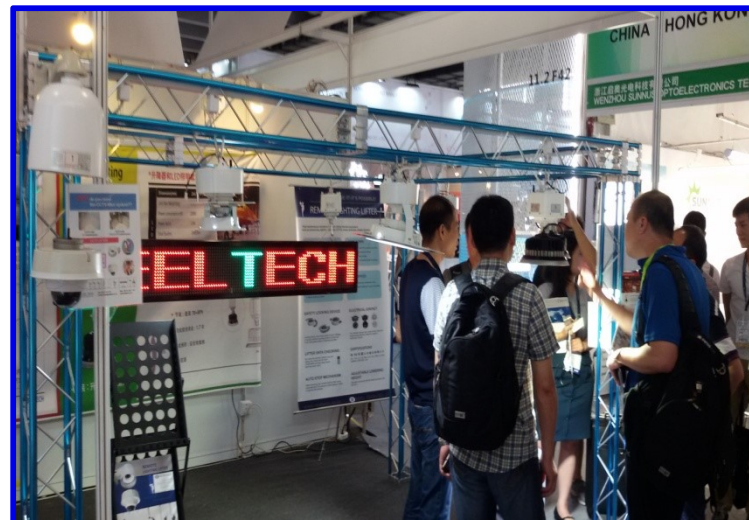

2017 Guangzhou Lighting Expo (China)



2017 CPSE (Security expo, Shenzhen), China



2017 Export meeting (Japan)

ABOUT US

Photo gallery

"REEL TECH is leader of remote lighting lifter in the world"



2017 PWX Expo (USA)



2018 BOMA Exhibition (USA)



2018 Dubai Big 5 (UAE)



2019 Light Fair International (USA)

ABOUT US

Photo gallery

"REEL TECH is leader of remote lighting lifter in the world"



2019 Light Fair International (USA)



2019 Nominated LFI innovation awards (USA)



2019 Hong Kong Lighting Fair

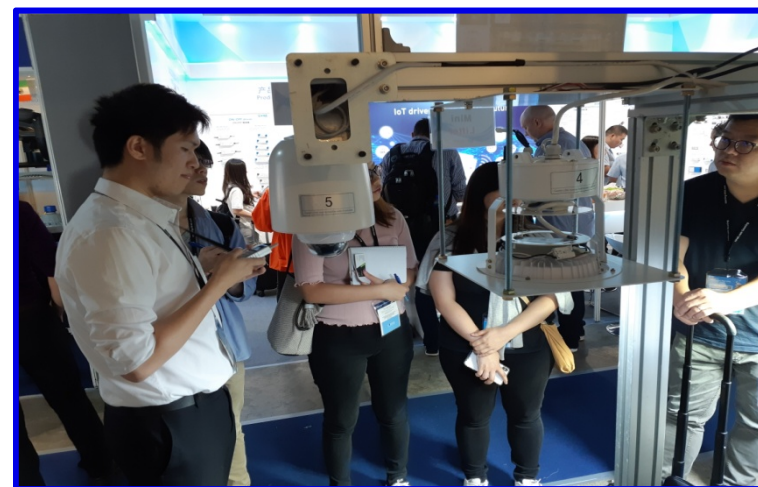

2019 Hong Kong Lighting Fair



www.reeltech.co.kr



REELTECH

Move it! It's possible

