

Edge margin take-off KA654

Art.-no. ZT013121A

Torque-controlled removal of edge strips.



Waste strips are produced when fabric or film strips are trimmed by machine. The KA654 is used for even, torque-controlled removal of these edge strips. The torque can be adjusted on the control unit via the motor control unit supplied. In automatic mode, the KA654 is controlled via an interface. Manual stopping and starting is also possible. The illustration shows the KA654 including the optional material query.

Product brochure

Edge margin take-off KA654

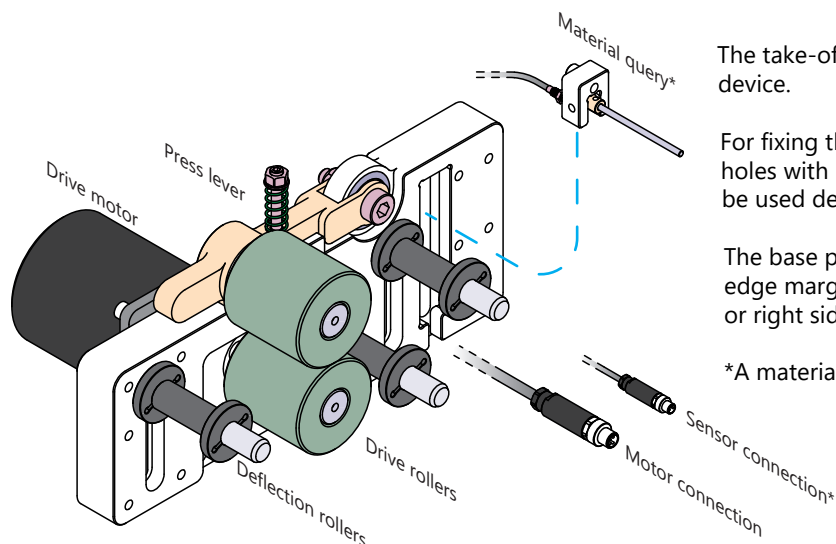
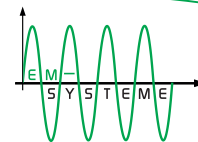

The take-off device does not include a winding device.

For fixing the take-off device, there are 13 through holes with M6 threads on the base plate, which can be used depending on the installation situation.

The base plate of the KA654 is symmetrical, so the edge margin take-off can be used equally on the left or right side.

*A material query for monitoring the edge strip is optionally available and can be retrofitted at any time.

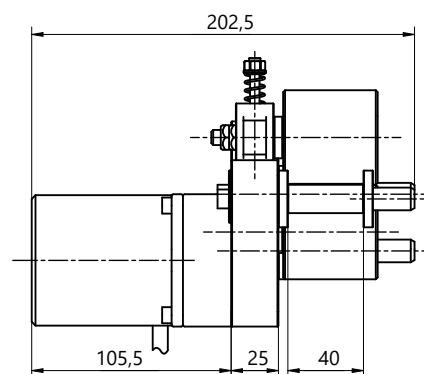
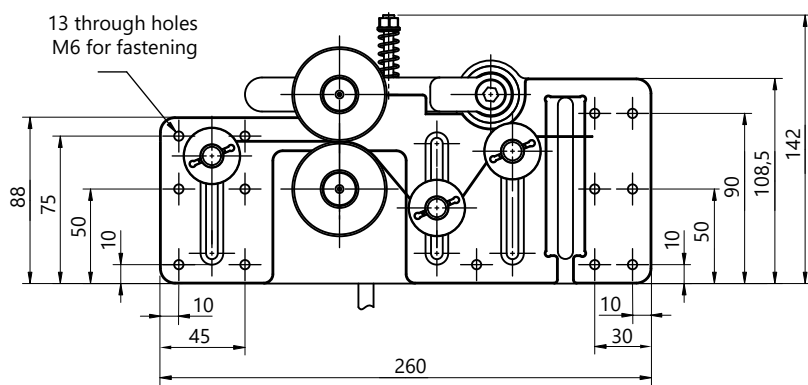

Control unit:

Three operating modes (Auto - Off - Manual) can be set.

The take-off force can be set in the range 0 to 4 N with a rotary control.

The 230 VAC power supply is provided via a permanently installed connecting cable with a protective contact plug.

A 5-pin interface is used for communication with external devices (e.g. higher-level control system).

An internal relay controls the run-on time of the drive motor in the setting range from 10 s to 2 min (default 1 min).

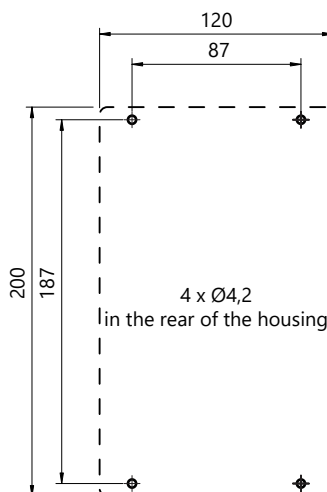

Drilling pattern

Scope of supply:

Take-off device with three deflection rollers

Control unit

Connecting cables

Technical data:

Output for solenoid valve	24 VDC via interface
Error signal material query	24 VDC via interface
Take-off force	adjustable from 0 to 4 N
Take-off speed	maximum 65 m/min

