

KSTTM

Future Connection

AC Charging Connector
for Electric Vehicle

Since 1973



Professional Terminals and Connectors Supplier



*AC Charging Connector
for Electric Vehicle*



Web



eDM

Website: www.ksterminals.com
Catalog: edm.ksterminals.com



General Charging Mode of IEC 61851

Type	Charging Mode	Power Supply	Breaker	Charging Power	Device	Charging Time (24KWh Battery)
Normal	Mode 1	230VAC, 1Ø	16A	3.3KW	Home Outlet	8h
	Mode 2	230VAC, 1Ø	32A	6.6KW	ICCB	4h
	Mode 3	230VAC, 3Ø	32A	12KW	AC EVSE	2h
Fast	Mode 4	500VDC	125A	50KW	DC EVSE	30min

※ Practical charging power and charging time depend on the adopted surface standard and battery capacity.

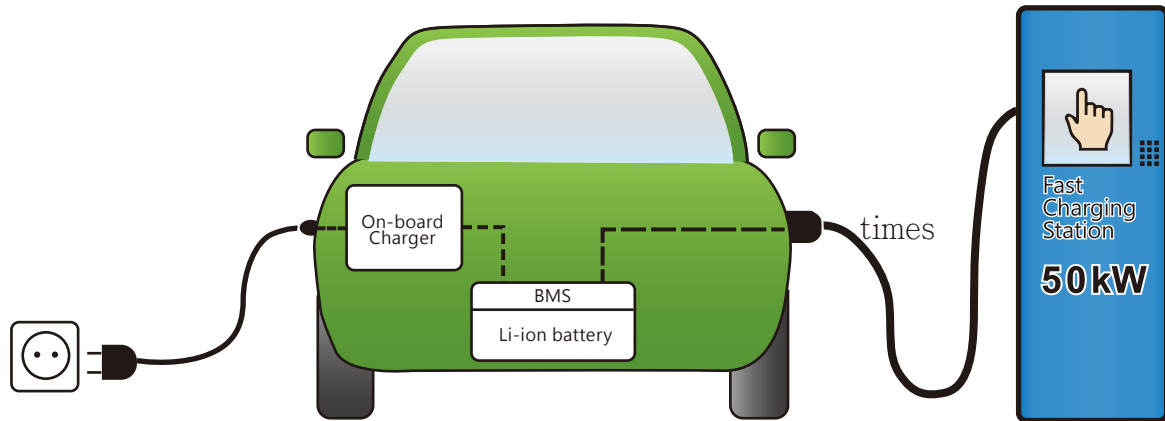

Normal Charging Mode (AC)

Fast Charging Mode (DC)

General Connection Type of IEC 61851

Case A: Permanent On-board Cable

Use the supply cable and plug permanently attached to EV.

A1 : Plug the supply cable into domestic or industrial socket.

A2 : Plug the supply cable into the charging station.

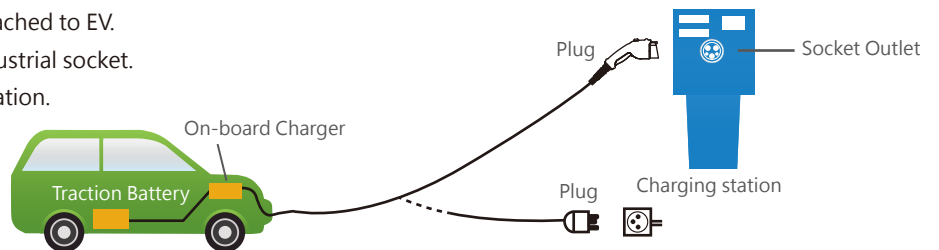

Case B: Portable Bilateral Plugs or Cord Set with ICCB

Use the detachable cable assembled with AC plug and EV connector.

B1 : Plug the supply cable into domestic or industrial socket.

B2 : Plug the supply cable into the charging station.

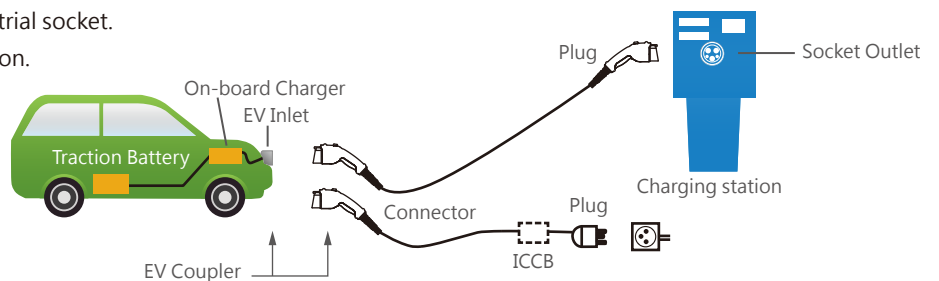

Case C: Permanent Cable attached to EVSE

Use the supply cable and vehicle connector permanently attached to EVSE.

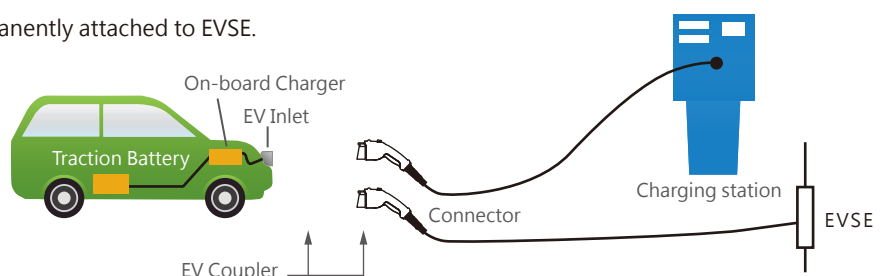



GB / T 20234



No.: CQC15029130897

AC Charging Connector for Electric Vehicle : GB / T 20234 Standard

VCCG2A032D0 / VCCG2A016D0 VCCG2A010D0

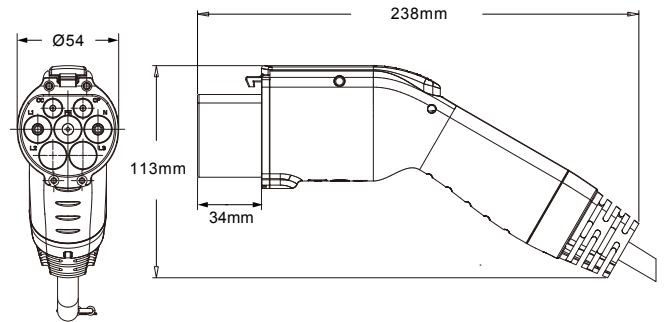

Features

- Conformity in surface design with GB / T 20234-2015.
- Ergonomic and streamlined designs allow for user-friendly interaction.
- High protection level to resist severe environment.
- Products passed 5000N driveover test.
- Applicable to connection B and Connection C of IEC 61851.

Application

BEV, PHEV, charging pile, cord set and domestic wall-mounted charger, etc.

Charging mode : mode2 / mode3 ; Types of connection : Case B / Case C

Product Perimeter

Project

Specification

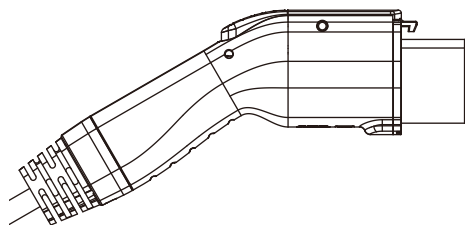

Vehicle Connector Color
Rated Current
Rated Voltage
Force
Lifespan
Flammability Rating
Protection Level
Operating temperature
Main Material
TATC Application No.

Black
32A / 16A / 10A
250V AC
≤ 100N
≥ 10000 times
UL 94V-0
With Cap IP54 , Body IP67
-30°C ~ +50°C
PBT / PC / PA66 / Copper alloy
16A: QA16EE1EB0812 / QA16EF1EB0812
32A: QA16EE1EB0822 / QA16EF1EB0822

AC Charging Cable Spec.

Specification

Color

Standard

32A Cable	$3 \times 6.0\text{mm}^2 + 1 \times 0.75\text{mm}^2$	Black	GB / T 33594
16A Cable	$3 \times 2.5\text{mm}^2 + 1 \times 0.75\text{mm}^2$	Black	GB / T 33594
10A Cable	$3 \times 1.5\text{mm}^2 + 1 \times 0.75\text{mm}^2$	Black	GB / T 33594



GB / T 20234



No.: CQC16029149670

AC Charging Connector for Electric Vehicle : GB / T 20234 Standard

VCCG2A032D0-G0 / VCCG2A016D0-G0

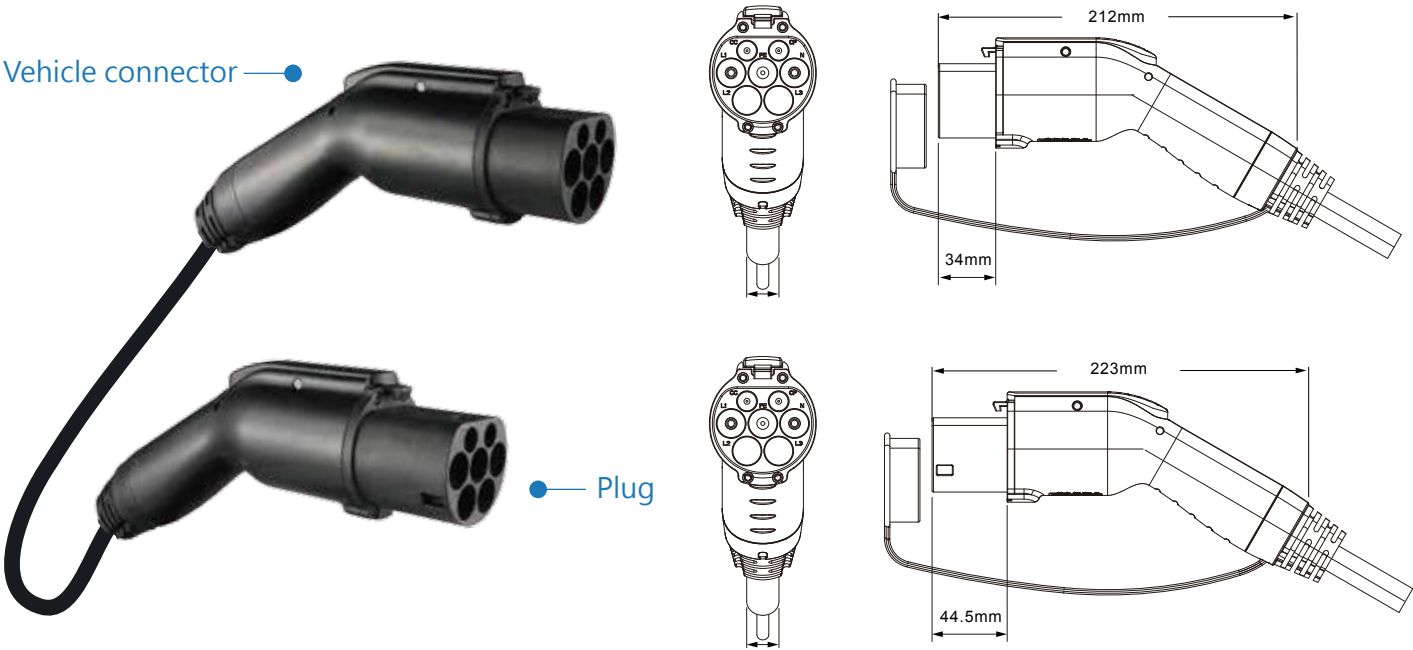

Features

- Conformity in surface design with GB / T 20234-2015.
- Ergonomic and streamlined designs allow for user-friendly interaction.
- High protection level to resist severe environment.
- Products passed 5000N driveover test.
- Applicable to connection B and Connection C of IEC 61851.

Application

BEV, PHEV, Charging pile, cord set, domestic wall-mounted charger, etc.
Charging mode : mode2 / mode3 ; Type of connection : Case B.

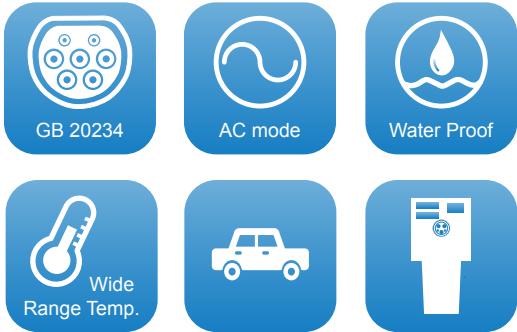

Product Perimeter

Project

Specification

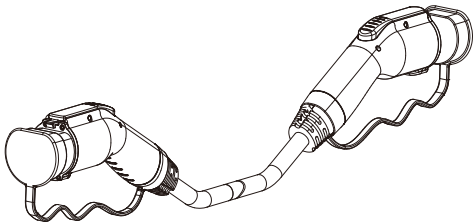

Vehicle Connector Color
Rated Current
Rated Voltage
Force
Lifespan
Flammability Rating
Protection Level
Operating temperature
Main Material
TATC Application No.

Black
32A / 16A
250V AC
≤ 100N
≥ 10000 times
UL 94V-0
With Cap IP54 , Body IP67
-30℃ ~ +50℃
PBT/PC/PA66/Copper alloy
16A: QA16EE1EB0812 / QA16EF1EB0812
32A: QA16EE1EB0822 / QA16EF1EB0822

AC Charging Cable Spec.

Specification

Color

Standard

32A Cable
16A Cable

3×6.0mm²+1×0.75mm²
3×2.5mm²+1×0.75mm²

Black
Black

GB / T 33594
GB / T 33594



GB / T 20234



No.: CQC15029130897

AC Charging Connector for Electric Vehicle : GB / T 20234 Standard

VCIG2A032B0 VCIG2A016B0



Vehicle inlet

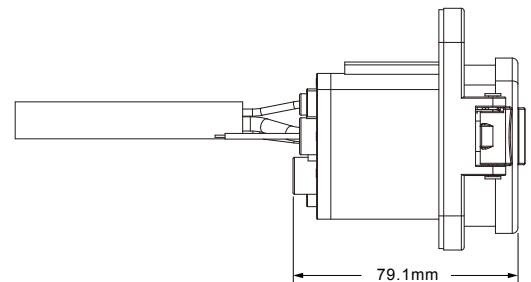
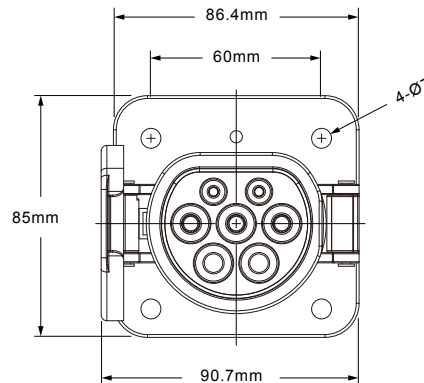

GB 20234



AC mode



Water Proof



Dust Proof



Wide Range Temp.

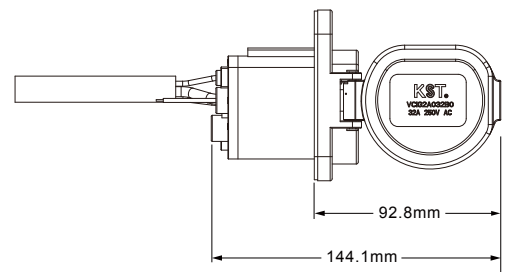

Features

- Conformity in surface design with GB / T 20234-2015.
- Temperature detecting function.
- High protection level to resist severe environment.
- Applicable to Connection B and Connection C of IEC 61851.



Application

BEV, PHEV, etc.

Types of connection : Case B / Case C

Product Perimeter

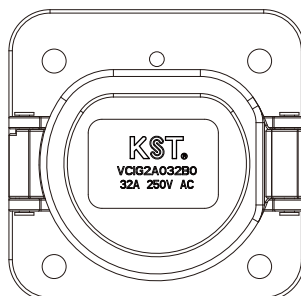

Project

Vehicle inlet Color
Rated Current
Rated Voltage
Lifespan
Flammability Rating
Protection Level
Operating temperature
Main Material
Temperature detecting range
TATC Application No.

Specification

Black
16A / 32A
250V AC
≥ 10000 times
UL 94V-0
IP54
-30°C ~ +50°C
PBT / PC / Brass
-30°C ~ +150°C
16A: QA16EE1EB0812 / QA16EF1EB0812
32A: QA16EE1EB0822 / QA16EF1EB0822

AC Charging Cable Spec.

Specification

Color

Standard

16A Cable
32A Cable

3×2.5mm²+2×0.75mm²
3×6.0mm²+2×0.75mm²

Black
Black

CQC 1104 &
KEMA-KEUR DEKRA K175-2



GB / T 20234



No.: CQC16029148023

AC Charging Connector for Electric Vehicle : GB / T 20234 Standard

VCSG2A032B0 VCSG2A016B0



Socket

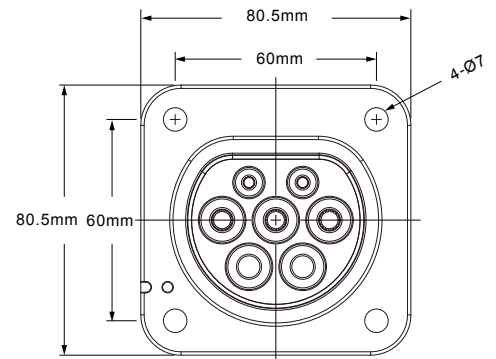

GB 20234



AC mode



Water Proof



Dust Proof



Wide Range Temp.

Features

- Conformity in surface design with GB / T 20234-2015.
- Temperature detecting function.
- High protection level to resist severe environment.
- Applicable to Connection A and Connection B of IEC 61851.



Application

EVSE, charging pile and domestic wall-mounted charger, etc.
Charging mode : mode3 ; Types of connection : Case A / Case B

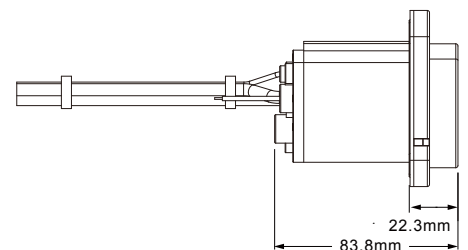
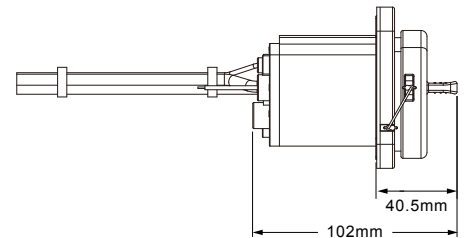

Product Perimeter

Project

Specification

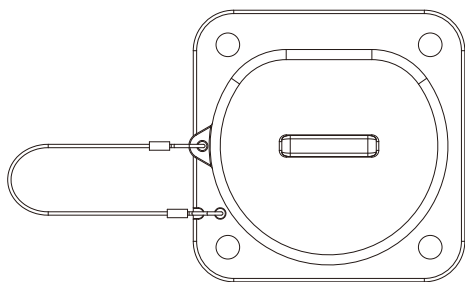

Socket Color
Rated Current
Rated Voltage
Lifespan
Flammability Rating
Protection Level
Operating temperature
Main Material
Temperature detecting range
TATC Application No.

Black
16A / 32A
250V AC
≥ 10000 times
UL 94V-0
IP54
-30°C ~ +50°C
PBT / PC / Brass
-30°C ~ +150°C
16A: QA16EE1EB0812 / QA16EF1EB0812
32A: QA16EE1EB0822 / QA16EF1EB0822

AC Charging Wire Spec.

Specification

Equal Standard

16A Wire
32A Wire

2×2.5mm²+1×4.0mm²+2×0.75mm²
2×6.0mm²+1×10mm²+2×0.75mm²

CQC 1104 &
KEMA-KEUR DEKRA K175-2



GB / T 20234



No.: CQC16029148023

AC Charging Connector for Electric Vehicle : GB / T 20234 Standard

VCSG2A032C0 VCSG2A016C0



Socket

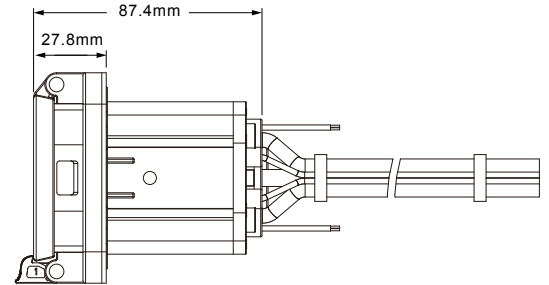
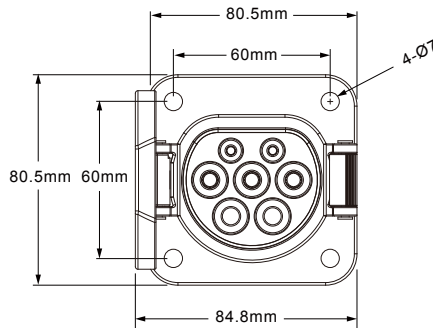

GB 20234



AC mode



Water Proof

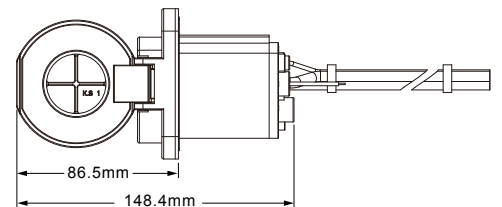

Dust Proof

Wide
Range Temp.

Features

- Conformity in surface design with GB / T 20234-2015.
- Temperature detecting function.
- High protection level to resist severe environment.
- Applicable to Connection A and Connection B of IEC 61851.



Application

EVSE, charging pile and domestic wall-mounted charger, etc.

Charging mode : mode3 ; Types of connection : Case A / Case B

Product Perimeter

Project

Specification

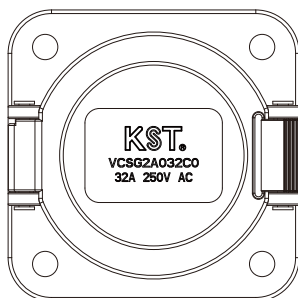

Socket Color
Rated Current
Rated Voltage
Lifespan
Flammability Rating
Protection Level
Operating temperature
Main Material
Temperature detecting range
TATC Application No.

Black
16A / 32A
250V AC
≥ 10000 times
UL 94V-0
IP54
-30℃ ~ +50℃
PBT / PC / Brass
-30℃ ~ +150℃
16A: QA16EE1EB0812 / QA16EF1EB0812
32A: QA16EE1EB0822 / QA16EF1EB0822

AC Charging Wire Spec.

Specification

Equal Standard

16A Wire
32A Wire

2×2.5mm²+1×4.0mm²+2×0.75mm²
2×6.0mm²+1×10mm²+2×0.75mm²

CQC 1104 &
KEMA-KEUR DEKRA K175-2



GB / T 20234



No.: CQC16029148023

AC Charging Connector for Electric Vehicle : GB / T 20234 Standard

VCSG2A032D0 VCSG2A016D0



Socket

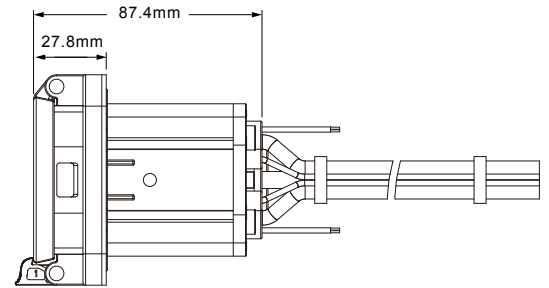
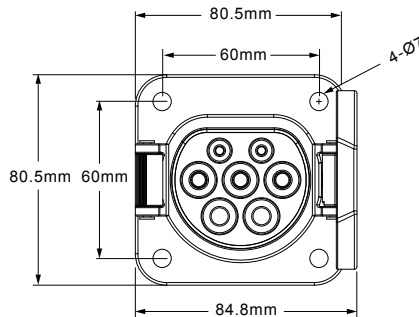

GB 20234



AC mode



Water Proof

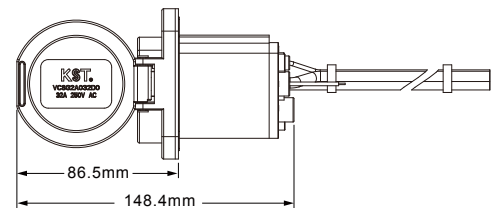

Dust Proof

Wide
Range Temp.

Features

- Conformity in surface design with GB / T 20234-2015.
- Temperature detecting function.
- High protection level to resist severe environment.
- Applicable to Connection A and Connection B of IEC 61851.



Application

EVSE, charging pile and domestic wall-mounted charger, etc.

Charging mode : mode3 ; Types of connection : Case A / Case B

Product Perimeter

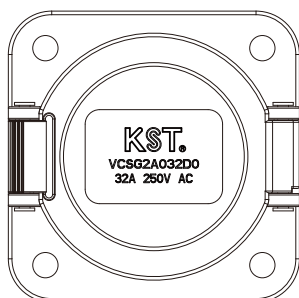

Project

Socket Color
Rated Current
Rated Voltage
Lifespan
Flammability Rating
Protection Level
Operating temperature
Main Material
Temperature detecting range
TATC Application No.

Specification

Black
16A / 32A
250V AC
≥ 10000 times
UL 94V-0
IP54
-30°C ~ +50°C
PBT / PC / Brass
-30°C ~ +150°C
16A: QA16EE1EB0812 / QA16EF1EB0812
32A: QA16EE1EB0822 / QA16EF1EB0822

AC Charging Wire Spec.

16A Wire
32A Wire

Specification

2×2.5mm²+1×4.0mm²+2×0.75mm²
2×6.0mm²+1×10mm²+2×0.75mm²

Equal Standard

CQC 1104 &
KEMA-KEUR DEKRA K175-2



GB / T 20234

Electronic Locking Solenoid For Vehicle Inlet

VCELG-H12SA0-00



Application

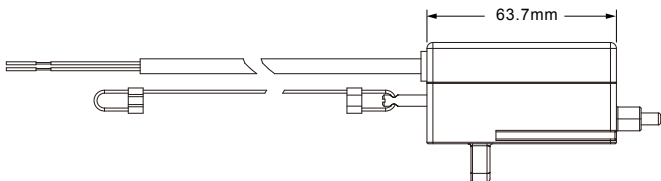
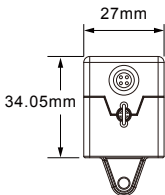

Project	Specification
Rated Current	3A
Rated Voltage	DC 12V
Estimated Life	≥ 10000 times
Operating temperature	-30℃ ~ +50℃

GB / T 20234

Electronic Locking Solenoid For Socket

VCELG-V12SA0-00



Application

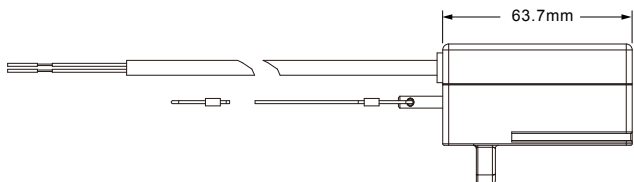
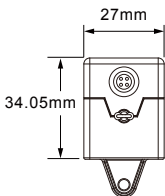

Project	Specification
Rated Current	3A
Rated Voltage	DC 12V
Estimated Life	≥ 10000 times
Operating temperature	-30℃ ~ +50℃



IEC 62196 -2

Electronic Locking Solenoid **For Socket**

VCSIHA1 / VCSIHA0



Application

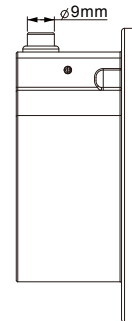
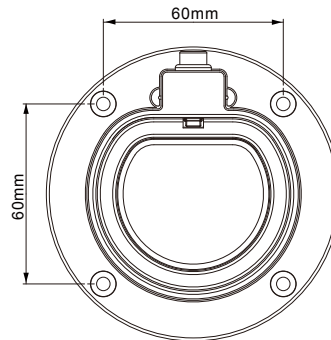

Project	Specification
Housing color	Black
Standards/regulations	IEC 62196-2
Charging standard	Type 2
Possible mounting positions	Front mounting
Mounting hole diameter	4.5 mm (ø)
Application	for vehicle charging connectors on charging stations (EVSE)

SAE J1772

Electronic Locking Solenoid **For Socket**

VCSSHA1



Application

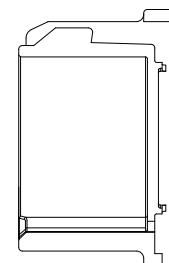
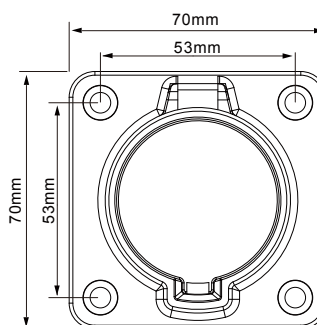

Project	Specification
Housing color	Black
Standards/regulations	SAE J1772
Charging standard	Type 1
Possible mounting positions	Front mounting
Mounting hole diameter	5.6 mm (ø)
Application	for vehicle charging connectors on charging stations (EVSE)



UL 2251

AC Charging Connector for Electric Vehicle : SAE J1772 Standard

VCPU2A080D0 / VCPU2A040D0 / VCPU2A032D0
VCPU2A016D0 / VCPU1A016D0

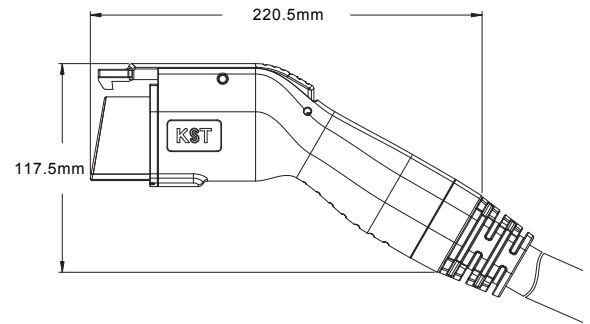

Features

- Conformity in surface design with SAE J1772, as well as product test accordance with UL 2251.
- Ergonomic and streamlined designs allow for user-friendly interaction.
- High level of protection against severe environment.
- Products passed 5000N driveover test.
- Applicable to Connection B and Connection C of IEC 61851.

Application

BEV, PHEV, charging pile, cord set and domestic wall-mounted charger, etc.

Charging mode : mode2 / mode3 ; Type of connection : Case B / Case C.

Product Perimeter

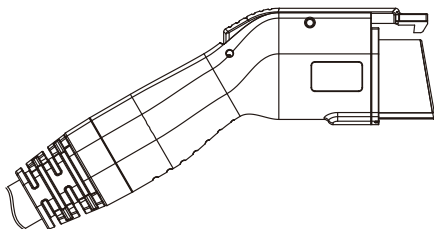

Project

Plug Color
Rated Current
Rated Voltage
Lifespan
Flammability Rating
Protection Level
Operating temperature
Main Material

Specification

Black
80A / 40A / 32A / 16A
240V AC
≥ 10000 times
UL 94V-0
NEMA 4 (Body IP67)
-30°C ~ +50°C
PBT / PC / PA66 / Copper Alloy

AC Charging Cable Spec.

Specification

Color

Standard

80A Cable	2x5AWG+1x6AWG+1x16AWG	Black	UL62 EVE
40A Cable	2x8AWG+1x10AWG+1x18AWG	Black	UL62 EVE
32A Cable	3x10AWG + 1x18AWG	Black	UL62 EVE
16A Cable	3x14AWG + 1x18AWG	Black	UL62 EVE
16A Cable	3x14AWG + 1x18AWG	Black	UL62 EVJE



UL 2251

AC Charging Connector for Electric Vehicle : SAE J1772 Standard

VCSU2A080D0 / VCSU2A080E0

VCSU2A040D0 / VCSU2A040E0

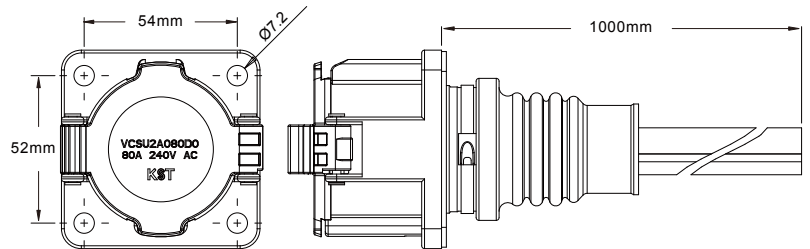

Features

- Conformity in surface design with SAE J1772, as well as product test accordance with UL 2251.
- Ergonomic and streamlined designs allow for user-friendly interaction.
- High level of protection against severe environment.
- Products passed 5000N driveover test.
- Applicable to Connection B and Connection C of IEC 61851.

Application

BEV, PHEV, charging pile, cord set and domestic wall-mounted charger, etc.

Product Perimeter

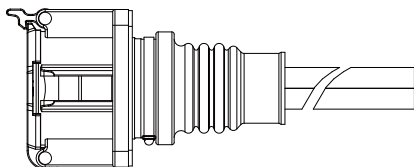

Project

Plug Color
Rated Current
Rated Voltage
Lifespan
Flammability Rating
Protection Level
Operating temperature
Main Material

Specification

Black
80A / 40A
240V AC
≥ 10000 times
UL 94V-0
NEMA 4 (With Plug)
-30°C ~ +50°C
PBT / PC / PA66 / Copper Alloy

AC Charging Cable Spec.

Specification

Color

Standard

80A Wire
40A Wire

2x5AWG+1x6AWG+2x18AWG
2x8AWG+1x10AWG+1x18AWG

UL62
UL62



IEC 62196



AC Charging Connector for Electric Vehicle : IEC 62196-2 Type2 Standard

VCSI2A032B0 / VCSICA032B0

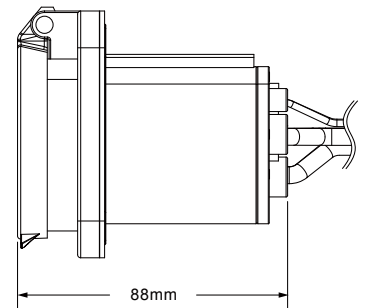
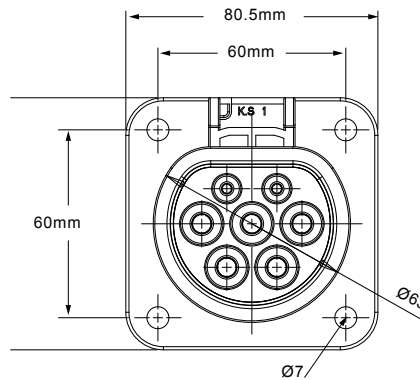

Features

- Conformity in surface design with IEC 62196-2 Type 2 as well as product test accordance with IEC 62196-1 & IEC 62196-2.
- Applicable in both single-phase and three-phase electric system.
- Exclusive magnetic lock with high speed connection for an extended lifespan.
- Applicable to Connection A and Connection B of IEC 61851.
- Certificated by TUV.

Application

Charging pile

Product Perimeter

Project

Specification

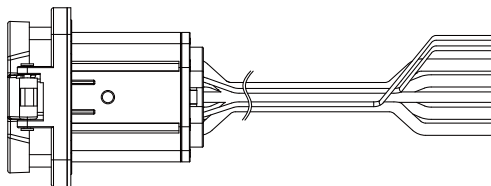

Plug Color
Rated Current
Rated Voltage

Black
32A
250V AC (Single-Phase)
250V / 480V AC (Three-Phase)

Force
Lifespan
Flammability Rating
Protection Level
Operating temperature
Main Material
TUV Certificate NO.

≤ 100N
≥ 10000 times
UL 94V-0
IP44
-30°C ~ +50°C
PBT / PC / Copper / Copper Alloy
R 50302730

AC Charging Wire Spec.

Specification

Standard

32A Wire

5×6.0mm²+2×0.75mm²

EN50620



IEC 62196



AC Charging Connector for Electric Vehicle : IEC 62196 TYPE2

VCCICA063B0 / VCCICA032B0 / VCCI2A032B0
VCCI2A020B0 / VCCI2A013B0

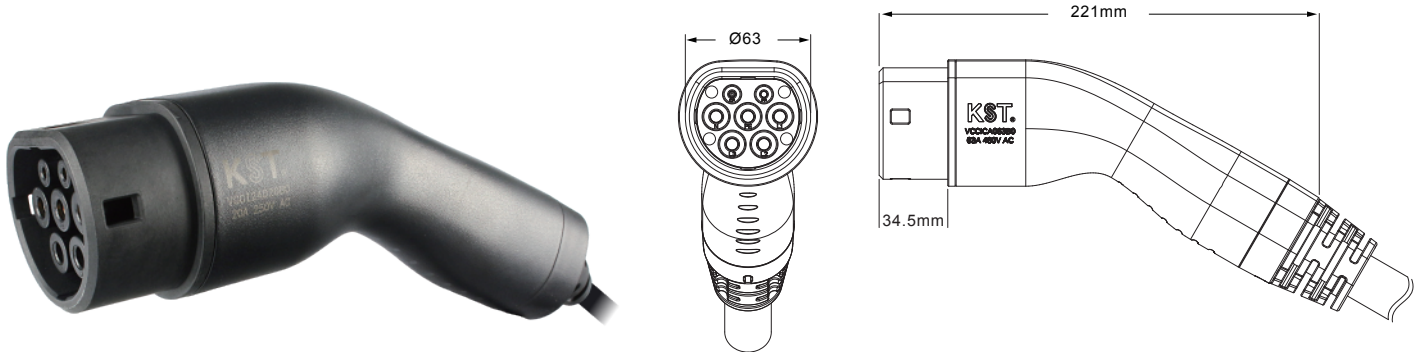

Features

- Conformity in surface design with IEC62196-2 TYPE2, as well as product test accordance with IEC 62196-2.
- Ergonomic and streamlined designs allow for user-friendly interaction.
- High protection level to resist severe environment.
- Products passed 5000N driveover test.
- Applicable to connection B and Connection C of IEC 61851.

Application

BEV, PHEV, charging pile, cord set and domestic wall-mounted charger, etc.
Charging mode : mode2 / mode3 ; Types of connection : Case B / Case C

Product Perimeter

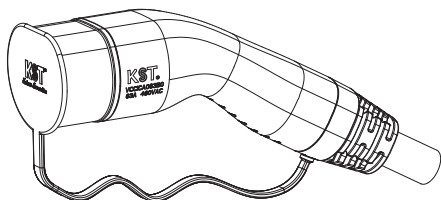

Project

Plug Color
Rated Current
Rated Voltage
Lifespan
Flammability Rating
Protection Level
Operating temperature
Main Material

Specification

Black
63A / 32A / 20A / 13A
250V AC / 480V AC
≥ 10000 times
UL 94V-0
With Cap IP54 (Body IP67)
-30°C ~ +50°C
PBT / PC / PA66 / Brass

AC Charging Cable Spec.

Specification

Color

Standard

Three-phase 63A Cable
Three-phase 32A Cable
Single-phase 32A Cable
Single-phase 20A Cable
Single-phase 13A Cable

5×16mm²+1×0.75mm²
5×6.0mm²+1×0.75mm²
3×6.0mm²+1×0.75mm²
3×2.5mm²+1×0.75mm²
3×1.5mm²+1×0.75mm²

Black
Black
Black
Black
Black

EN50620
EN50620
EN50620
EN50620
EN50620



IEC 62196



AC Charging Connector for Electric Vehicle : IEC 62196 TYPE2 TO TYPE2
EV Plug-to-Plug Charging Cable Set

VCCICA032B0-I0

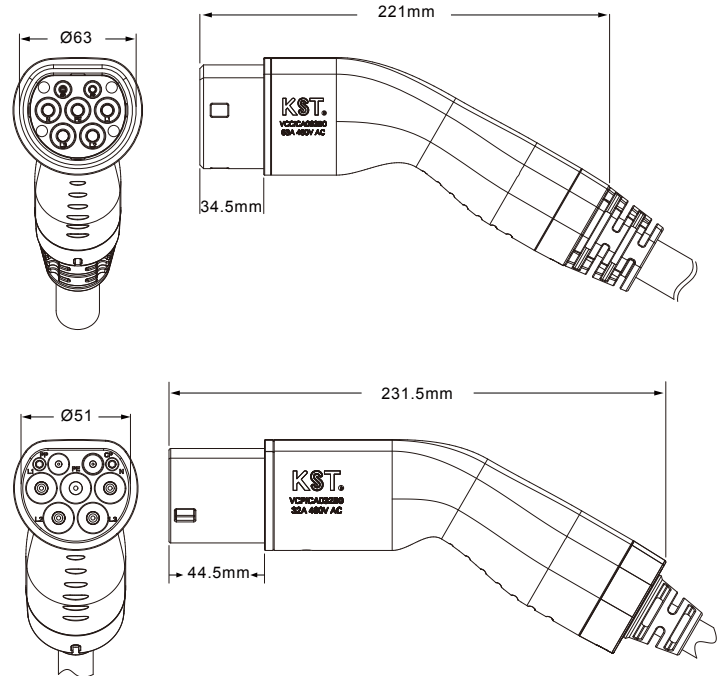

Features

- Conformity in surface design with GB / T 20234-2015.
- Ergonomic and streamlined designs allow for user-friendly interaction.
- High protection level to resist severe environment.
- Products passed 5000N driveover test.
- Applicable to Connection B of IEC 61851.

Application

For connecting BEV, PHEV and charging pile.
Types of connection : Case B



Product Perimeter

Project

Specification

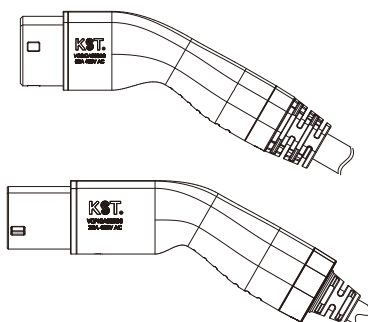

Vehicle Connector + Plug Color
Rated Current
Rated Voltage
Force
Lifespan
Flammability Rating
Protection Level
Operating temperature
Main Material

White
32A(Single Phase & three Phase)
480V AC
 $\leq 100N$
 ≥ 10000 times
UL 94V-0
IP54
 $-30^{\circ}C \sim +50^{\circ}C$
PBT / PC / PA66 / Brass

AC Charging Cable Spec.

Specification

Color

Standard

32A Cable

$5 \times 6.0mm^2 + 1 \times 0.75mm^2$

Black

EN50620



IEC 62196



AC Charging Connector for Electric Vehicle : IEC 62196 TYPE2

VCCICA063C0 / VCCICA032C0 / VCCI2A032C0
VCCI2A020C0

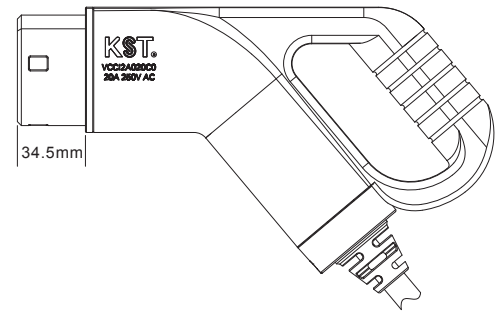
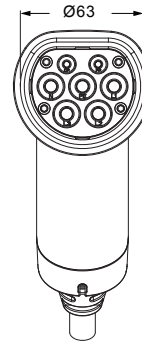

Features

- Conformity in surface design with IEC62196-2 TYPE2, as well as product test accordance with IEC 62196-2.
- Ergonomic and streamlined designs allow for user-friendly interaction.
- High protection level to resist severe environment.
- Products passed 5000N driveover test.
- Applicable to connection B and Connection C of IEC 61851.

Application

BEV, PHEV, charging pile, cord set and domestic wall-mounted charger, etc.

Charging mode : mode2 / mode3 ; Types of connection : Case B / Case C

Product Perimeter

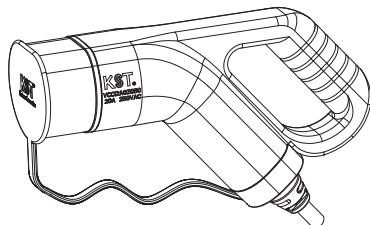

Project

Plug Color
Rated Current
Rated Voltage
Lifespan
Flammability Rating
Protection Level
Operating temperature
Main Material

Specification

Black
63A / 32A / 20A / 13A
250V AC / 480V AC
≥ 10000 times
UL 94V-0
With Cap IP54 (Body IP67)
-30°C ~ +50°C
PBT / PC / PA66 / Brass

AC Charging Cable Spec.

Specification

Color

Standard

Three-phase 63A Cable
Three-phase 32A Cable
Single-phase 32A Cable
Single-phase 20A Cable

$5 \times 16\text{mm}^2 + 1 \times 0.75\text{mm}^2$
 $5 \times 6.0\text{mm}^2 + 1 \times 0.75\text{mm}^2$
 $3 \times 6.0\text{mm}^2 + 1 \times 0.75\text{mm}^2$
 $3 \times 2.5\text{mm}^2 + 1 \times 0.75\text{mm}^2$

Black
Black
Black
Black

EN50620
EN50620
EN50620
EN50620



Taiwan E-Scooter

DC Charging Connector for Electric Scooter : TES-0D-01-01

ESPCBD080A0 / ESSCBD080A0

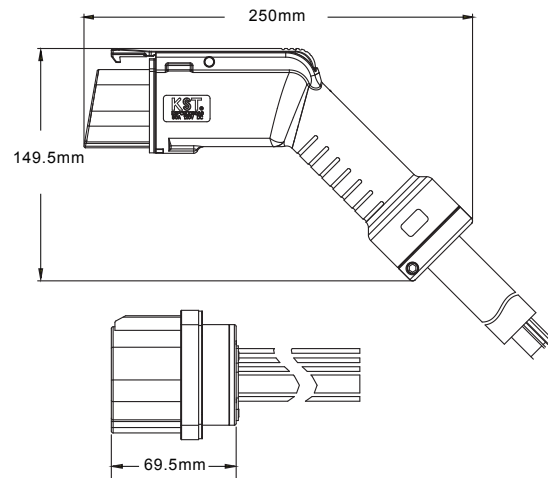

TES-0D-01-01



DC mode



Water Proof



Dust Proof



Wide
Range Temp.

Features

- Conformity in surface design with TES-0D-01-01, as well as product test accordance with TES-0D-01-01.
- Ergonomic and streamlined designs allow for user-friendly interaction.
- High protection level to resist severe environment.
- Products passed 800N driveover test.

Application

E-Scooter, Charging pile, cord set, domestic wall-mounted charger, etc.

Product Perimeter

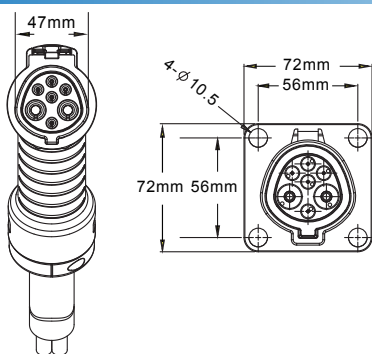

Project

Plug Color
Rated Current
Rated Voltage
Lifespan
Flammability Rating
Protection Level
Operating temperature
Main Material

Specification

Gray
80A
120V DC
≥ 10000 times
UL 94V-0
IP55 (Body IP67)
-30°C ~ +50°C
PBT / PC / PA66 / Copper Alloy

AC Charging Cable Spec.

80A Cable

Specification

$2 \times 25\text{mm}^2 + 7 \times 0.75\text{mm}^2$
 $+ 2 \times 0.75\text{mm}^2$

Color

Black

Standard



Taiwan E-Scooter

DC Charging Connector for Electric Scooter : TES-0D-01-01 (Interface)

ESPCBD025B0 / ESSCBD080A0

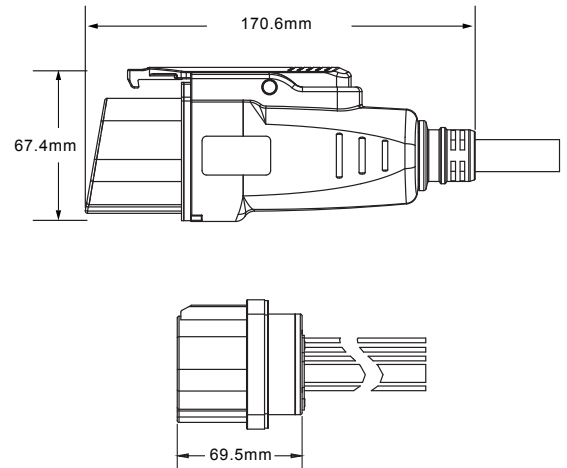

TES-0D-01-01



DC mode



Water Proof



Dust Proof



Wide
Range Temp.

Features

- Conformity in surface design with TES-0D-01-01, as well as product test accordance with TES-0D-01-01.
- Ergonomic and streamlined designs allow for user-friendly interaction.
- High protection level to resist severe environment.
- Products passed 800N driveover test.

Application

E-Scooter, Charging pile, cord set, domestic wall-mounted charger, etc.

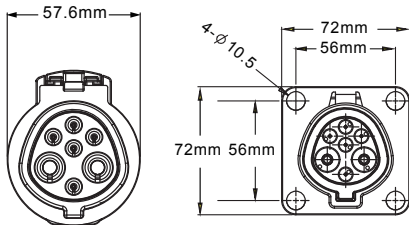
Product Perimeter	Project	Specification
	Plug Color Rated Current Rated Voltage Lifespan Flammability Rating Protection Level Operating temperature Main Material	Black 25A 120V DC ≥ 10000 times UL 94V-0 IP55 (Body IP67) -30°C ~ +50°C PBT / PC / PA66 / Copper Alloy

AC Charging Cable Spec.	Specification	Color	Standard
25A Cable	2×3.5mm ² +5×0.5mm ²	Black	



TES-0D-01-01

Electronic Locking Solenoid For Socket

ESSCBHA0



Application

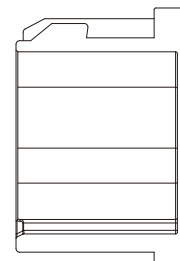
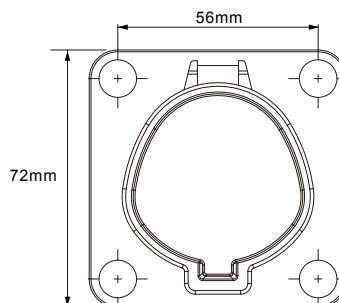

Project	Specification
Housing color	Black
Standards/regulations	TES-0D-01-01
Main Material	PA66
Possible mounting positions	Front mounting
Mounting hole diameter	10.5 mm (ø)
Application	E-Scooter, Charging pile, cord set, domestic wall-mounted charger, etc.



Application in EV Charging System

- Supply Cable with Bilateral Plugs



- Cord Set



- Charging Pile



- Domestic wall-mounted charger



- On-Board Inlet



- Charging Stations/Parking





Web



eDM

Website: www.ksterminals.com

Catalog: edm.ksterminals.com



K.S. TERMINALS INC.

NO.8, ZHANGBIN E. 3rd ROAD, XIANXI TOWNSHIP,
CHANGHUA COUNTY 507, TAIWAN.
MAIL / P.O.BOX66, XIANXI, TAIWAN, 507
SALES / TEL:886-4-7582765 FAX:886-4-7582786
ADM / TEL:886-4-7580001 FAX:886-4-7580003

健和興端子股份有限公司

彰化縣線西鄉彰濱東三路8號
信箱 / 線西郵政信箱66號
銷售 / 電話: 04-7582765 傳真: 04-7582786
行政 / 電話: 04-7580001 傳真: 04-7580003
E-MAIL: exp@ksterminals.com.tw



B009A2-EN-2021.06.30