



## Progress Through Innovation

### LIHYANN INDUSTRIAL CO.,LTD

753, Sec 1, Si-Nan Rd., Wurih, 41465 Taichung, Taiwan

TEL: +886-4-23351588 FAX: +886-4-23359383

E-mail:marketing@lihyann.com <http://www.lihyann.com>



LIHYANN reserves the right to change product specifications without further notices. 072019



**AUTO TOOLS**  
**2020~2021**



**ONE-STOP SOLUTION**  
**GARAGE SERVICE EQUIPMENT**  
High Efficiency, Labour-Saving, Cost Effective.







WOLF'S HEAD



## GARAGE SERVICE EQUIPMENT







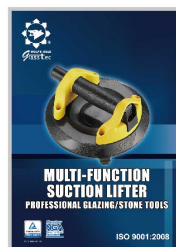
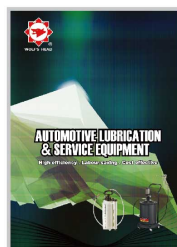





**High Efficiency , Labour Saving , Cost Effective**

LihYann Industrial Co. Ltd. has been in the forefront of product development and manufacturing in Taiwan since 1974, providing a wide range of practical items and solutions for both auto services and hardware tool markets. Among its important achievements is the development of the world's first vacuum oil-extractor, which has revolutionized the process of oil exchange in both application efficiency and cost-effectiveness.

Dedicated to research and development, LihYann has over the years introduced numerous originally designed models of machines and equipment for auto maintenance and lubricating services, earning the company over 100 patents concerning both technical and functional aspects of various products. All its products have been tested and approved to meet the demand of times. Its product range covers oil-extracting equipment, hardware tools and other auto-related products.



## CONTENTS

	<b>ATF Series</b>	<b>1</b>
	<b>Oil Suction Series</b>	<b>5</b>
	<b>Oil Dispensing Series</b>	<b>13</b>
	<b>Power Steering and Engine Flush Service</b>	<b>14</b>
	<b>Waste Oil Drainer Series</b>	<b>15</b>
	<b>Oil Filter Crusher</b>	<b>19</b>
	<b>Exhaust Management Series</b>	<b>20</b>
	<b>Carbon Cleaning Service Series</b>	<b>21</b>
	<b>Parts Cleaning / Hygiene Service</b>	<b>23</b>
	<b>Cooling System Service Series</b>	<b>26</b>
	<b>Brake System Service Series</b>	<b>33</b>
	<b>Body Work Tools</b>	<b>39</b>
	<b>Storage Boxes / Tool Carts</b>	<b>42</b>

## AT-1010 Dipstick type ATF Changer

AT-1010 is designed for changing fluid in sealed transmission including CVT and DSG system. Two tanks design to drain old fluid and fill new fluid separately. 12V pump connects to car battery for easy operation.

2 tanks design covers all CVT and DSG system.  
Old fluid tank to drain fluid or evacuate fluid through dipstick  
Large fluid tank to see through fluid level 12V pump design  
Complete adaptors for various CVT and DSG system.

MODEL	AT-1010
DIMENSION	520x420x1170 mm
WEIGHT	35.5 kg
CAPACITY	Used Fluid 10 L New Fluid 10 L



## AT-1000A Professional ATF Exchanger

AT-1000A is equipped with flow regulator which provides most convenience of connecting to the vehicle.

MODEL	AT-1000A
CAPACITY	Used Fluid & New Fluid 20L Separate
DIMENSION	650x530x980 mm
WEIGHT	46.24 kg
VOLTAGE	110V or 220V
PUMP	Gear Pump

PAT:

5.918.647	6.450.294	6.227.332	6.450.252
-----------	-----------	-----------	-----------

### PROFESSIONAL TYPE



With Oil Suction Function

## WH-202 Semi Automatic ATF Exchanger

- ▶ It's never easy to replace waste fluid completely by traditional method. The new fluid is easy to mix with old one during the exchange. The result includes, slow acceleration, shaking while shifting gears, over heating and excessive fuel consumption.
- ▶ ATF exchanger can solve the problems and restore the performance of gear box.

MODEL	WH-202
FEATURE	Circulate, Flush, Exchange
CAPACITY	Used Fluid & New Fluid 20L Separate
WEIGHT	46 kg
DIMENSION	650x565x900 mm
OIL-OUTPOUR	3-4 L
VOLTAGE	110V or 220V
PUMP	Gear Pump

### ECONOMY TYPE



## WH-202A Semi Automatic ATF Exchanger

MODEL	WH-202A
FEATURE	Flush, Exchange, Oil suction
CAPACITY	Used Fluid & New Fluid 20L Separate
WEIGHT	55 kg
DIMENSION	610x565x900 mm
OIL-OUTPOUR	3-4 L
VOLTAGE	110V, 220V
PUMP	Gear Pump

With Oil Suction Function

### PRACTICAL TYPE



## WH-320 ATF Fitting Connectors

- ▶ Standard set for AT-1200A, WH-202, WH-202A.



Include WH-198

NO.	Suitable for motorcar
1	MERCEDES BENZ, SIERRA, LANCIA
2	BMW
3	GM
4	ALPHA ROMEO
5	VOLVO
6	VW / RENAULT
7	AUDI / RENAULT
8	JAPANESE / TAIWANESE / KOREAN / OPEL cars
9	SAAB / CITROEN / LANCIA
9A	CITROEN / LANCIA
10	JAPANESE / TAIWANESE / KOREAN / OPEL cars
11	JAPANESE / TAIWANESE / KOREAN / OPEL cars
12	VW / AUDIN (with level stick)
13	PEUGEOT 405 / AUSTIN2000cc (with level stick)
15	90° Angle fitting for BMW and TOYOTA
16	VOLVO 850
17	OPEL CORSA
2A	Special use for BMW after 1996
I	5/16" CONNECTOR HOSE
F	5/16" CONNECTOR HOSE
H	1/2" CONNECTOR HOSE
G	3/16" CONNECTOR HOSE
S	(Snap in style fittings) 9MM/10MM
T	(Snap in style fittings) 11MM/12MM
U	(Snap in style fittings) 13MM/16MM/19MM/23MM



## Transmission Filling System

- ▶ Manual operated pump to fill seal transmission system.
- ▶ Standard and optional adaptors cover all CVT and DSG design.
- ▶ Pump stroke to minimize leakage when reaching overflow point.
- ▶ Fluid control valve to shut off dispensing immediately.
- ▶ Large transparent tank to see through fluid level.



Include WH-320DG

Model	K-10C-2
Dimension	260x370x595 mm
Capacity	7.5 L
Weight	3.44 kg

### K-10C-2



Optional

214087



Optional

WH-934A (for VW)



Model	K-10L
Dimension	330x260x650 mm
Capacity	9.5 L
Weight	3.5 kg

8PCS



Include WH-320DG

### K-10L



### T-4A1

8PCS



Include WH-320DG

Model	T-4A1
Dimension	247x204x430 mm
Capacity	4 L
Weight	2.28 kg



11PCS



Include WH-320H

Model	T-5A
Dimension	230x180x420 mm
Capacity	5 L
Weight	3.2 kg

### T-5A



## Available Adaptors for Transmission Filling



225020  
For spare fluid



WH-320HC  
Include AT-101~AT-118



**Transmission Filling Hose For VAG (VW/AUDI/CVT/DSG)**  
Hose length: 2M Weight: 333 g  
Male thread : M24 x 1.5  
▶ Shut-off valve prevents oil spillage.  
▶ ATF filling hose for VAG gearbox.

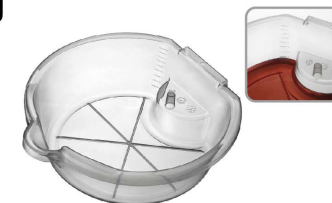

**WH-9004E1**  
**Drain Pan With Level Scale**  
Dimension: 350x320x110 mm  
Weight: 210 g  
▶ Transparent design to see through the draining volume.  
▶ Very useful in transmission fluid change.  
▶ Check drain old fluid volume before filling new fluid to prevent waste.

AT-101 FORD 1/8 NPT



AT-102 Universal (BMW, HONDA, NISSAN, etc.)



AT-103 VW/AUDI



AT-104 VW/AUDI, PORSCHE



AT-105 VW/AUDI, MINI COOPER M10x1.0P



AT-106 MERCEDES 722.9 M12x1.5P



AT-107 DSG M24x1.5P



AT-108 VW/AUDI CVT M22x1.5P



AT-109 VOLVO  
M5/16x24N



AT-110 TOYOTA/LEXUS  
M18x1.5P



AT-111 SKODA M30x1.5P



AT-112 VW/Passat and Tiguan  
after 2007  
M10x1.0p M15x1.0P



AT-113 Infiniti 7 speed  
M8x1.0P



AT-114 Universal-Honda, Hyunda, Kia  
5x8x200mm



AT-115 NEW SKODA  
M18x1.5P



AT-116 Mini cooper  
M14x1.5P



AT-117 NISSAN Serena S-HYBRID  
M10x1.5P



AT-118 NISSAN JUKE  
M12x1.25P



AT-119 GM  
M12x1.75P



AT-120 VAG with 7 speed dual clutch  
transmission gearboxes







## WH-198 Oil Quality Comparator

- The accessory provides the ability to examine oil quality visually.

Model	WH-198
Dimension	310x215x65 mm
Weight	1 kg



## LY-2051 Vacuum Pump Oil Extractor

*With oil dispensing function*

- Vacuum pump provides strong & constant vacuum force.
- Glass vacuum chamber to monitor waste oil extraction.
- Separate loop design to prolong pump life.

Model	LY-2051
Dimension (mm)	710x650x1280
Capacity	60 L
Vacuum chamber capacity	18 L
Internal oil tank capacity	42 L
Weight	119 kg
Oil refuel hose power	0.28
New oil capacity	6 L
Oil suction capacity	5.6 L/min

Patents Granted in Following Nations

Taiwan	153477	USA	5.918.647
Japan	3064234	Germany	299197476



Oil Submersible Vacuum Pump

**DELUXE TYPE**



## LY-205 Vacuum Pump Oil Extractor

Model	LY-205
Dimension (mm)	710x650x1280
Capacity	60 L
Vacuum chamber capacity	18 L
Internal oil tank capacity	42 L
Weight	99 kg
Oil suction capacity	5.6 L/min

**PROFESSIONAL TYPE**

Patents Granted in Following Nations

Taiwan	153477	USA	5.918.647
Japan	3064234	Germany	299197476



### SUCTION TUBES (for LY-2051/LY-205)

- To extract engine oil from automobiles and motorcycles.
- To extract crank case oil from various automobiles.
- To extract gearbox oil from various automobiles.
- To extract automatic transmission fluid from various automobiles.



3C025026	BENZ Connector	200034	5.8 mm oil suction tube
3C025028	BENZ.BMW connector	200027	6 mm oil suction tube
3C025027	Connector for coolant	200025	6 mm steel oil suction tube
200008	Connector for brake fluid suction	200026	7 mm steel oil suction tube
200024	3/8" gear oil tube	3M013028	Steel string
200035	Aluminium tube		



## Manual Fluid Extractor

- Manual operation.
- Maintenance free.
- Transparent tank to see fluid level.
- Modularized design to provide best performance.



Model	PA-600T	PA-800T	PA-1000T
Dimension	220x220x490 mm	220x220x600 mm	220x220x700 mm
Weight	2.48 kg	2.73 kg	2.99 kg
Capacity	5.5 L	7.5 L	9.5 L
Power	Manual	Manual	Manual

**PA-600T**



**PA-800T**



**PA-1000T**



## Manual and Air Fluid Extractor

- Manual and air operation.
- Maintenance free.
- Transparent tank to see fluid level.
- Modularized design to provide best performance.



Model	PA-600TA	PA-800TA	PA-1000TA
Dimension	220x220x490 mm	220x220x600 mm	220x220x700 mm
Weight	2.48 kg	2.73 kg	2.99 kg
Capacity	5.5 L	7.5 L	9.5 L
Power	Manual / air	Manual / air	Manual / air

**PA-600TA**



**PA-800TA**



**PA-1000TA**





## PA-1011A Combo Fluid Extractor

- ▶ Uses both manual or air for operation.
- ▶ Venturi system design to provide excellent performance.
- ▶ Capacity: 9.5L
- ▶ Maintenance free.



200024	10 mm gear oil tube
200027	6 mm oil suction tube (Nylon)
200025	6 mm steel oil suction tube
200026	7 mm steel oil suction tube

Model	PA-1011A
Dimension	265x315x650 mm
Capacity	9.5 L
Weight	4.8 kg
Power	Manual or Air



For both  
manual and air  
operation →



## AC-6L Pneumatic Fluid Dispenser With Withdraw Function

- ▶ Air fluid dispenser suitable for lubricant, antifreeze, diesel and low viscosity fluid such as water.
- ▶ Withdraw dispensing fluid from the source to fulfill dispensing tank.
- ▶ Transparent design to check fluid level.
- ▶ Air release valve to avoid over pressurizing.
- ▶ Tank available in 6L, 8L and 10L.

Model	AC-6L
Dimension	510x280x220 mm
Capacity	6 L
Weight	2.3 kg
Power	Air



## WH-550U Fluid Transfer Pump

- ▶ Manual transfer pump with manual operation design.
- ▶ Viton seal which is suitable for diesel, AdBlue, and low corrosive fluid.
- ▶ Transparent composite plastic for viewing fluid.
- ▶ Scale on the syringe body.

Model	WH-550U
Dimension	445x90 mm
Weight	0.56 kg
Capacity	0.55 L
Usage	AdBlue



## Syringe for Vehicle Fluid Change

- ▶ Transparent design to see fluid visually.
- ▶ Suitable for fluid suction and supply in vehicle service.

Model	JI-200	JI-550	JI-1500
Weight	0.246 kg	0.38 kg	0.691 kg
Capacity	200 ml	550 ml	1.5 L
Usage	Brake fluid	Oil	Oil

Composite plastic resists to brake fluid and antifreeze.

JI-200



JI-550

Applications such as gear oil and differential fluid.

JI-1500



## JI-1500A Syringe For Diesel Supply/ Withdraw

- ▶ Transparent design to visualize the fluid.
- ▶ Suitable to add or remove diesel fuel from filters, etc.
- ▶ Rotative switch off.

Model	JI-1500A
Weight	0.93 kg
Capacity	1.5 L
Usage	Gasoline / Diesel / Fuel

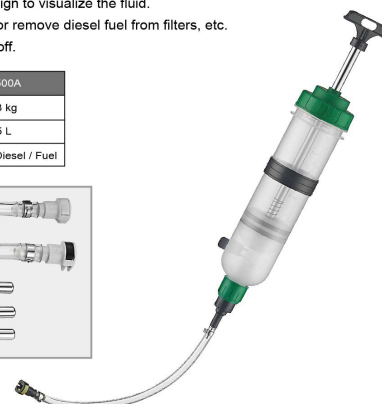

## JI-1500U Syringe For AdBlue®/ DEF Supply / Withdraw

- ▶ Transparent design to visualize the fluid.
- ▶ Suitable to add or remove AdBlue Liquid from reservoir tanks.

Model	JI-1500U
Weight	0.75 kg
Capacity	1.5 L
Usage	AdBlue



## DEF-2585YF AdBlue®/DEF Filling Funnel - Straight

- ▶ AdBlue filling funnel connects to all filling necks.
- ▶ Open/close valve to stop filling once the tank is full.
- ▶ Transparent funnel with level scale.
- ▶ Funnel cover keeps out dirt and debris when not in use.
- ▶ Air breathing pipe design allows air out of the tank and prevent splashing and over filling.

Model	DEF-2585YF
Dimension	95x110X400 mm
Weight	292 g
Capacity	1.1 L



## DEF-2585YS AdBlue®/DEF Filling Funnel - Angled

- ▶ AdBlue filling funnel connects to all filling necks.
- ▶ Open/close valve to stop filling once the tank is full.
- ▶ Transparent funnel with level scale.
- ▶ Funnel cover keeps out dirt and debris when not in use.
- ▶ Air breathing pipe design allows air out of the tank and prevent splashing and over filling.

Model	DEF-2585YS
Dimension	95x200X390 mm
Weight	313 g
Capacity	1.1 L

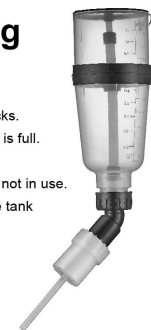





## T-80AG 80L Air Gear Pump Oil Extractor/Drainer

- ▶ Oil level sight tube.
- ▶ Telescopic tube adjusts from 1140~1582 mm.
- ▶ Extra large diameter drain pan and removable filter.
- ▶ Safe pressure depletion of waste oil.
- ▶ No lifting, pouring or spillage.
- ▶ Gear pump fitted to extract oil via the dipstick.
- ▶ For use on gearbox oil, automatic transmission oil and in motorcycle.
- ▶ Gear pump design.

Model	T-80AG
Dimension	470x560x1140~1582 mm
Capacity	80 L
Weight	38 kg
Power	Air
Pump	1/4" Gear pump



Air Gear pump



80 L



## LY-90T 90L Air Gear Pump Oil Extractor/Drainer

- ▶ Oil level sight tube.
- ▶ Extra large diameter drain pan and removable filter.
- ▶ Safe pressure depletion of waste oil.
- ▶ No lifting, pouring or spillage.
- ▶ Gear pump fitted to extract oil via the dipstick.
- ▶ For use on gearbox oil, automatic transmission oil and in motorcycle.
- ▶ Gear pump design.
- ▶ Large glass chamber.

Model	LY-90T
Dimension	600x600x1390 mm
Weight	38.94 kg
Capacity	Chamber: 8 L, Tank: 80 L
Power	Air
Pump	1/4" Gear pump



Air Gear pump

90 L



### SUCTION TUBES (for T-80AG / LY-90T / LY-60T / LY-90A / OK-3NG / T-80CJV)

- ▶ To extract engine oil from automobiles and motorcycles.
- ▶ To extract crank case oil from various automobiles.
- ▶ To extract gearbox oil from various automobiles.
- ▶ To extract automatic transmission fluid from various automobiles.

200024	3/8" gear oil tube
200035	Aluminum tube
200027	6 mm oil suction tube
200025	6 mm steel oil suction tube
200026	7 mm steel oil suction tube
3M013028	Steel string



## LY-90A 90L Air Venturi Oil Extractor

- ▶ Waste oil mobile reservoirs to be used for motor and gear oil collection.
- ▶ Drainers can be used under vehicle lifts or inside lubrication pit.
- ▶ Large handle for easy maneuverability.
- ▶ Two brake wheels ( Ø3" ) and two casters ( Ø3" ) .
- ▶ Extra large drain bowl / Adjustable collecting bowl / For the convenient and safe collection.
- ▶ Venturi design.

Model	LY-90A
Dimension	600x600x1390 mm
Capacity	Chamber: 8 L, Tank: 80 L
Weight	37.94 kg
Power	Air
Oil Draining	Air Pressure

90 L



## LY-70P 70L Venturi System Oil Extractor

- ▶ Waste oil mobile reservoirs to be used for motor and gear oil collection.
- ▶ Drainers can be used under vehicle lifts or inside lubrication pit.
- ▶ Large handle for easy maneuverability.
- ▶ Two brake wheels ( Ø3" ) and two casters ( Ø3" ) .
- ▶ Extra large drain bowl / Adjustable collecting bowl / For the convenient and safe collection.
- ▶ Venturi design.

Model	LY-70P
Dimension	600x600x1390 mm
Capacity	Chamber: 10 L, Tank: 60 L
Weight	28.84 kg
Power	Air
Oil Draining	Air Pressure



70 L



## OK-3NG 9L Electrical Gear Pump Oil Extractor

- ▶ New handle and caster design for convenient use.
- ▶ Aluminum alloy pump, quality guaranteed use.
- ▶ Come with suction tubes.
- ▶ Gear pump design.

Model	OK-3NG
Dimension	450x430x890 mm
Capacity	9 L
Weight	26.5 kg
Voltage	110V or 220V
Power	Electric



Electric Gear pump

12 L

BASIC TYPE





## T-80CJV 80L Waste Oil Drainer/Extractor

- ▶ Waste oil mobile reservoirs to be used for motor and gear oil collection.
- ▶ Drainers can be used under vehicle lifts or inside lubrication pit.
- ▶ Large handle for easy maneuverability.
- ▶ Two brake wheels (Ø3") and two casters (Ø3") .
- ▶ Extra large drain bowl / Adjustable collecting bowl / For the convenient and safe collection.
- ▶ Venturi design.
- ▶ Telescopic tube adjusts from 1160~1370 mm.

80 L



Model	T-80CJV
Dimension	450x450x1160~1370 mm
Capacity	80 L
Weight	30 kg
Power	Air
Oil Draining	Air Pressure

## GP-2A 16L Air Gear Pump Oil Extractor

- ▶ Check oil level visually.
- ▶ Gear pump fitted to extract oil via the dipstick.
- ▶ Comes with suction tubes.
- ▶ Gear pump design.

16 L



200024	3/8" gear oil tube
200027	6 mm oil suction tube
200025	6 mm steel oil suction tube
200026	7 mm steel oil suction tube

Model	GP-2A
Dimension	310x330x1020 mm
Capacity	16 L
Weight	9 kg
Power	Air



Air Gear pump



## GP-200 Electrical Gear Pump Oil Extractor

- ▶ Separate loops design for oil suction & supply services.
- ▶ 1/2" gear pump.
- ▶ Both oil suction & supply services.
- ▶ Large extraction capacity.
- ▶ Filter installed to clean waste oil.
- ▶ Large wheel design provides high maneuverability.

Model	GP-200
Dimension	460x470x1030 mm
Weight	40.3 kg
Voltage	110V / 60HZ
Oil suction capacity	16 L/min



1/2" Gear pump  
For Large Volume Job



## GP-RS 12V Portable Oil Transfer Pump



200024	3/8" x400 mm gear oil tube
200027	4x6x750 mm oil suction tube (nylon)
200047	5/16" x400 mm oil suction tube

Model	GP-RS
Dimension	355x270x170 mm
Weight	3.1 kg
Voltage	DC-12V
Oil suction capacity	3~4 L/min
Capacity	7.5 L



## LY-90F 90L Stainless Fuel Retriever

- ▶ Venturi design with air power operated.
- ▶ 90L stainless steel tank.
- ▶ Suck in and refill gasoline during maintenance job.
- ▶ Safety valve design.
- ▶ CE certified (97/23/EC PED).
- ▶ Provided with earth line.



90 L

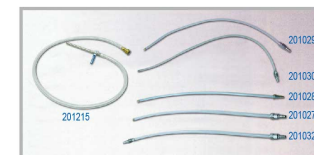

201027	1/2" oil suction tube
201028	3/8" oil suction tube
201029	5/8" oil suction tube
201030	4 x 6 oil suction tube
201032	3/8" oil suction tube
201215	1/2" teflon oil drainer tube

Model	LY-90F
Dimension	530x530x1100 mm
Weight	29.98 kg
Capacity	90 L
Power	Air



## LY-40FS 40L Stainless Fuel Retriever

- ▶ Venturi design with air power operated.
- ▶ No petrol fume during operation.
- ▶ Suck in and refill gasoline during maintenance job.
- ▶ Safety valve design.



40 L

Model	LY-40FS
Dimension	420x390x940 mm
Weight	15.5 kg
Capacity	40 L
Power	Air



Optional Adaptors For Fuel Retriever

201123



3D025413



3D025414







## AC-5A Pressure Fluid Dispenser

- ▶ Maneuverable oil dispensing units for convenient and safe oil handling in the workshop.
- ▶ Suitable for any vehicles.
- ▶ Easy to operate and user friendly.

Model	AC-5A
Dimension	450x430x1050 mm
Capacity	40 L
Weight	20 kg
Power Source	air pressure



**5T0045**  
LubeMeter  
(Optional)

40 L



## AC-6A Pressure Fluid Dispenser

- ▶ Maneuverable oil dispensing units for convenient and safe oil handling in the workshop.
- ▶ Suitable for any vehicles.
- ▶ Easy to operate and user friendly.

Model	AC-6A
Dimension	450x430x1050 mm
Capacity	80 L
Weight	36 kg
Power Source	air pressure

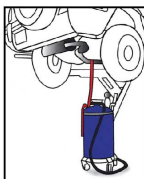

80 L



## DF-5A Differential Fluid Dispenser

- ▶ Manual differential fluid dispenser.
- ▶ Supplies with hook and flexible dispensing nozzle.
- ▶ Safety valve to prevent over pressurized.
- ▶ 5L Capacity.

Model	DF-5A
Dimension	185x220x430 mm
Weight	2.3 kg
Capacity	5 L



## DF-1010 Differential Fluid Changer

- ▶ Evacuate and refill fluid through differential inlet.
- ▶ Tube selection makes it easy for accessing hard-to-reach differential inlet.
- ▶ 2 tanks design to hold different fluid
- ▶ 12V DC power
- ▶ Can be used for manual gear box and transfer case fluid change.

Model	DF-1010
Dimension	420x540x1130 mm
Weight	33.7 kg
Capacity	Used Fluid 10 L New Fluid 10 L



## PC-500 Power Steering Flushing System

- ▶ Power Steering Flush is fast - an average service takes less than ten minutes from start to finish.
- ▶ Power Steering Flush is simple to operate - with easy to follow directions on the manual.
- ▶ Power Steering Flush - has sight tubes that provide dramatic visual comparison during fluid transfer.
- ▶ Power Steering Flush is profitable - More premium services can be performed in less time. Customer satisfaction will be high, leading to more referrals, maximising profit levels.
- ▶ Maneuverable - rolls easily in tight spaces.
- ▶ Simple - No tools required.
- ▶ Durable - all metal case.
- ▶ Easy - instructions printed on lid.
- ▶ Convenient - no pits, lifts, or ramps.

US PAT:10.348.415



New Fluid  
Control knob



New/Oil Fluid  
Sight Tube



Old Fluid  
reservoir



New Fluid  
Filler Cap

Model	PC-500
Dimension	500x480x940 mm
Capacity	New Fluid 5 L / Used Fluid 16 L
Weight	33.3 kg
Voltage	110V, 220V, 12V





## T-30D Waste Oil Drainer

- ▶ Composite lid and drum with reservoir and drain pan on telescopic post.
- ▶ Gravity drain using tap on rear of unit.
- ▶ Includes visible 'Full Drum' device.
- ▶ Includes large diameter drain pan insert and heavy duty mesh for draining oil filters.
- ▶ Made from high density Polyethylene.

Model	T-30D
Dimension	550x550x920~1080 mm
Capacity	30 L
Weight	8.9 kg



## T-50D Waste Oil Drainer

- ▶ Composite lid and drum with reservoir and drain pan on telescopic post.
- ▶ Gravity drain using tap on rear of unit.
- ▶ Includes visible 'Full Drum' device.
- ▶ Optional large diameter drain pan.
- ▶ Insert and Heavy duty mesh for draining oil filters.
- ▶ Made from high density Polyethylene.

Model	T-50D
Dimension	550x550x930~1455 mm
Capacity	50 L
Weight	12 kg



## T-80D 80L Waste Oil Dispenser (Auto check valve)

- ▶ Waste oil mobile reservoirs to be used for motor and gear oil collection.
- ▶ Drainers can be used under vehicle lifts or inside lubrication pit.
- ▶ Large handle for easy maneuverability.
- ▶ Two brake wheels (Ø3") and two casters (Ø3") .
- ▶ Extra large drain bowl / Adjustable collecting bowl / For the convenient and safe collection.

Model	T-80D
Dimension	470x560x1140~1580 mm
Capacity	80 L
Weight	36 kg
Oil Draining	Air Pressure

auto valve design for oil depletion



## T-80C 80L Waste Oil Drainer (Auto check valve)

For scissor type lifter

- ▶ Waste oil mobile reservoirs to be used for motor and gear oil collection.
- ▶ Drainers can be used under vehicle lifts or inside lubrication pit.
- ▶ Large handle for easy maneuverability.
- ▶ Two brake wheels (Ø3") and two casters (Ø3") .
- ▶ Extra large drain bowl / Adjustable collecting bowl / For the convenient and safe collection.

Model	T-80C
Dimension	450x450x1100~1370 mm
Capacity	80 L
Weight	29.7 kg
Oil Draining	Air Pressure

auto valve design for oil depletion



Swing arm design

## T-80L 80L Waste Oil Drainer (Manual valve)

- ▶ Waste oil mobile reservoirs to be used for motor and gear oil collection.
- ▶ Drainers can be used under vehicle lifts or inside lubrication pit.
- ▶ Large handle for easy maneuverability.
- ▶ Two brake wheels (Ø3") and two casters (Ø3") .
- ▶ Extra large drain bowl / Adjustable collecting bowl / For the convenient and safe collection.

Model	T-80L
Dimension	470x560x1140~1580 mm
Capacity	80 L
Weight	28 kg
Oil Draining	Air Pressure

manual valve design for oil depletion



## T-80DT 80L Waste Oil Drainer (Auto check valve)

- ▶ Waste oil mobile reservoirs to be used for motor and gear oil collection.
- ▶ Drainers can be used under vehicle lifts or inside lubrication pit.
- ▶ Large handle for easy maneuverability.
- ▶ Two brake wheels (Ø3") and two casters (Ø3") .
- ▶ Extra large drain bowl / Adjustable collecting bowl / For the convenient and safe collection.

Model	T-80DT
Dimension	530x530x1440 mm
Capacity	80 L
Weight	36 kg
Oil Draining	Air Pressure







Material: Metal

**3MD17002**



530 mm  
Steel Oil Drain Pan  
3.08 kg

**3C030005**



550 mm  
Oil Drain Pan  
1.01 kg

**217006**



380 mm  
Collection Bowl  
(For T-80L)  
0.65 kg

**3C015012**



352 mm  
Pre-Spray Net  
0.28 kg

## HP-300A 3/8" Diaphragm Transfer Pump

► Air operated diaphragm pump.

Specification

- Max. Air Supply Pressure: 8 kgf/cm<sup>2</sup> (120 psig)
- Inlet & Outlet : 3/8 npt
- Air Inlet : 1/4 npt
- Max Flow Rate : 8 G.P.M. ( 32 L/Min )
- Max. Size Solid :  $\phi$  2 mm
- Suction Lift Capability : 6M Primed , 3M Dry

Materials

- Non Body Wetted: Aluminum Alloy
- Body Wetted: A-15: Aluminum Alloy (A)
- Body Weight: A-15: 4 KG
- Applications & Chemical Characteristics : Paint, Waste Oil, Resin, Slop ; 5<PH<8

Model	HP-300A
Material Outlet	3/8"
MAX Delivery	28 L/min
Working Pressure	27 bar
Pump Ratio	1:1
Weight	7.58 kg
Dimension	360x290x790 mm



## Drum Drain Basin

- Plastic basin install on drum for receiving waste oil.
- Intended to be installed at a standard barrel, the drain lid marries with the barrel inlet allowing simple and efficient draining of waste oil from filters etc.
- Manufactured from chemical resistant high density polyethylene with UV stabilizer.
- Features ribbed drainage channels and a filter gate to catch foreign objects.

**LY-350**  
for 20 L / 30L drum



**LY-550**  
for 205 L drum



## Tire Axle Drain Pan

- To drain axle oil during wheel repair.
- Keeping compartment to hold axle nuts.
- Optional magnets to make stable sitting on the wheel.

Model	U-220	U-220B
Dimension	345x213x174 mm	345x213x174 mm
Capacity	2.2 L	2.2 L



**U-220**



**U-220B**



Magnets



## Waste Oil Storage

- This drain pan have a broad appeal and are suitable for both the DIY user and professional mechanic.
- Purpose made for the recovery of oil and anti-freeze, these pans help keep the workshop floor free from oily residue and aid return of oil to recycling containers with minimum risk of spills or splashes.
- Made from high density Polyethylene.
- Heavy wall construction stays rigid, even with hot oil.
- Large handle positioned to aid carrying and pouring.
- Resistant to most chemicals and solvents.
- Will not dent or rust and are easy to clean.

Model	WH-050A	WH-080A	WH-9004CC	WH-9004BC
Weight	600 g	800 g	900 g	1.27 kg
Dimension	435x310x115 mm	600x320x135 mm	580x410x130 mm	585x450x175 mm
Capacity	5 L	8 L	8 L	14 L



**WH-050A**



**WH-080A**



**WH-9004CC**



**WH-9004BC**

## Waste Oil Receiving Pan



**WH-9004M**



**WH-9004F**



**WH-9004E**



**WH-9004D**



**WH-9004MA**



**WH-9004C**



**WH-9004B**



**WH-9004A**

Model	WH-9004MA	WH-9004M	WH-9004F	WH-9004E	WH-9004D	WH-9004C	WH-9004B	WH-9004A
Weight	470 g(without hose)	340 g	285 g	210 g	400 g	600 g	930 g	1.8 kg
Dimension	405x217x140 mm	405x217x68 mm	435x210x90 mm	350x320x110 mm	430x400x110 mm	520x390x150 mm	600x450x180 mm	820x540x200 mm
Capacity	2.68 L	2.68 L	2 L	4.5 L	8 L	11 L	15 L	24 L
Material	PP	PP	PP	PP	PP	PE	PE	PE



## Pneumatic Oil Filter Crusher

- ▶ Reduce re-cycling costs, take a positive step towards an environment friendly workshop.
- ▶ Bench mounted or free standing pneumatic oil filter crusher.
- ▶ Removes up to 95% of waste oil and crushes filter to less than 1/4 its original size.
- ▶ Up to 5 tonnes of crushing power.
- ▶ Operates on normal workshop compressed air.
- ▶ Unique safety door ensures device will not operate unless secured.

Description / Model	WH-312 Car and light truck	WH-312A Heavy Duty truck
Filter Max. Height	280 mm	280 mm
Filter Max. Width	140 mm	140 mm
Remark	Without stand case	With stand case
Power	Compressed air 100-120 PSI	Compressed air 100-120 PSI
Dimension	320x330x770 mm	670x450x1550 mm



Air Safety Switch



Air Pressure Valve

## WH-312C Oil Filter Cutting System

- ▶ Roller bearing provide smooth rolling action.
- ▶ Hardened hardware throughout.
- ▶ No parts or adapters to change.
- ▶ Separate steel housing & paper filter for best environment protection.

Model	WH-312C
Dimension	575x330x210 mm
Weight	7.79 kg



## WH-312A (With stand)



## WH-707B Air Exhaust Fume Extractor

- ▶ This modern, portable, compact exhaust gas extractor is designed to operate in any size workshop and is an ideal alternative to fixed, space consuming, expensive systems.
- ▶ Suitable for use on cars, vans, motorcycles, light commercial, it allows the garage mechanic to work on the vehicle with the engine running, without causing pollution of the air or contravening the current workshop regulations.
- ▶ Exhaust handling machine.
- ▶ The height and elevation is adjustable.
- ▶ Designed as a go anywhere extractor, it is mounted on a robust metal stand with simple and easy to adjust height and suction setting.
- ▶ The unit is powered by air.
- ▶ Working pressure of 5-8 bar.

Model	WH-707B
Dimension	250x280x1230 mm
Weight	9.14 kg

### Patents Granted in Following Nations

Taiwan	153477	USA	5,918,647
Japan	3064234	Germany	299197476

### 3G021018



Flexible hose



### Optional Accessories

## 213036 Exhaust Hose For Double Pipes

Operating demonstration for motorcycle.

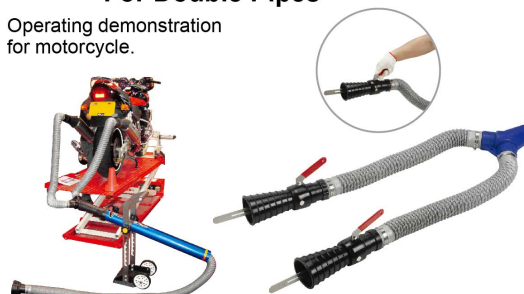

## 229001 Exhaust Hose For WH-707B Length: 3 m



## WH-737A Metal Line Stopper (12 pcs)

- ▶ To plug the metal line and prevent fluid leakage in disconnection.
- ▶ Used in fuel lines, brake line, power steering and transmission cooler lines.
- ▶ Suitable for banjo fittings.
- ▶ Rubber insert accessory for quick plug.

Model	WH-737A
Dimension	370x270x60 mm
Weight	1200 g
Material	PA







## EC-900A Injection Cleaning System

- ▶ Decrease engine temperature.
- ▶ Decrease fuel consumption.
- ▶ Extended engine life.
- ▶ Cleans carbon of combustion chamber.
- ▶ Cleans carbon deposits of fuel injection nozzle.

Model	EC-900A
Dimension	560x470x960 mm
Weight	25 kg
Capacity	1 L
Power	Air operated



Includes: EC-900D

## EC-900J Deluxe Injection Cleaning / Testing Kit -by Fuel Rail

- ▶ Quick coupler connections.
- ▶ Complete set of adapters / fittings.
- ▶ Carbon cleaning function included.
- ▶ Complete tools to remove fuel line.
- ▶ Large pressure gauge.

Model	EC-900J
Dimension	435x390x115 mm
Weight	6.32 kg

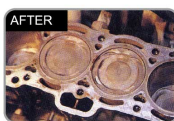

## EC-900DL Super Fuel Injection Testing Kit

- ▶ Quick coupler connections.
- ▶ Complete set of adapters / fittings.
- ▶ Special designed storage case.

Model	EC-900DL
Dimension	435x390x115 mm
Weight	4.2 kg



Optional Adaptor For EC-900J and EC-900DL



## EC-900SC 12Pcs Diesel Fuel Line Plugs

- ▶ Set of twelve diesel fuel line blanks, mainly fitted to Ford, PSA and Renault.
- ▶ Contains six pairs of male and female connectors covering three connector types.
- ▶ Ideal for stopping the flow of fuel after pipework has been disconnected.

Model	EC-900SC
Dimension	277x218x43 mm
Weight	0.54 kg
Usage	Fuel, Diesel

Size: 7.9 mm , 9.5 mm , 9.9 mm , 5/16" , 3/8", 10 mm



## EC-900M Carbon Cleaning Set For Manifold and Injector

Model	EC-900M
Dimension	380x100x390 mm
Weight	21.1 kg
Power	Air operated
Capacity	1000 ml / bottle



Comes with EC-900DL and EC-900G1



## Carbon Cleaning Canister For Manifold & Throttle

**Note:** EC-900G1 may combine with EC-900J for manifold & throttle cleaning.

Model	EC-900G	EC-900K
Dimension	340x215x130 mm	63x63x255 mm
Weight	1.44 kg	500 g
Power	Air operated	Air operated
Capacity	1000 ml	560 ml



Accessories For EC-900G

### EC-900G1 S Type Spray Nozzle



### EC-900G3 Y Type Spray Nozzle



### 220028 Spray Nozzle with Fix-Lock Feature



## Fuel & Air Conditioning Hose Disconnect Set

- ▶ Releases the fuel line locking, quick connect coupler release.
- ▶ Die cast tools suitable for press type quick disconnection joints found on Ford, GM(Vauxhall/Opel) and Chrysler vehicles. Ingenious swivel action allows quick selection of correct sized tool.

Model	Remark
AT-001	It fits any 9 mm or 10 mm fuel line
AT-002	It fits any 11 mm or 12 mm fuel line
AT-003	It fits any 13 mm, 16 mm, 19 mm, 23 mm fuel line

AT-001



AT-002



AT-003





## AF-90S 90L Cleaning Foam Sprayer (Auto check valve)

- ▶ Caster with brake.
- ▶ Spray gun - aluminum alloy.
- ▶ Pressure gauge - stainless steel.
- ▶ Mainbody - stainless steel 90L.
- ▶ Connecting to compressor, equipped with 10M long hose.

Model	AF-90S
Dimension	580x580x950 mm
Capacity	90 L
Weight	24 kg
Operating	60 psi / 4 kg
Length	10 m
Diameter	1/2"
Material	Stainless Steel



Pressure gauge-stainless steel



Mainbody-stainless steel

DELUXE TYPE

90 L



## AF-70S 70L Cleaning Foam Sprayer (Manual valve)

- ▶ Caster with brake.
- ▶ Spray gun - aluminum alloy.
- ▶ Pressure gauge - stainless steel.
- ▶ Mainbody - stainless steel 70L.
- ▶ Connecting to compressor, equipped with 10M long hose.

Model	AF-70S
Dimension	500x500x900 mm
Capacity	70 L
Weight	22 kg
Operating	60 psi / 4 kg
Length	10 m
Diameter	1/2"
Material	Stainless Steel



ECONOMY TYPE

70 L



## AS-30 30L Pneumatic Fluid Atomiser

- ▶ 30 litres pressure sprayer for spraying non-toxic detergent, low-acid based chemical, low viscosity lubricant and other similar products.
- ▶ Operations include vehicle cleaning, farming, hygiene maintenance, etc.
- ▶ Continuous use without connecting to air-line.
- ▶ Stainless steel design.

Model	AS-30
Dimension	370x380x835 mm
Capacity	30 L
Weight	12.5 kg
Power Source	Pneumatic
Hose Length	6 m
Hose Outlet	1/4
Material	Stainless Steel

30 L



## WH-108N Foaming Spraying Gun



## WH-109 Atomising Spraying Gun

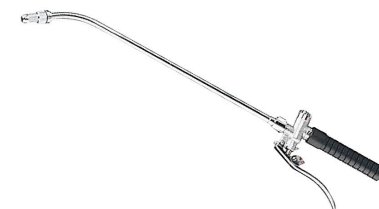

## WH-700 Electrical Parts Washer

- ▶ The system will increase your working efficiency with its unique design.
- ▶ Large filter installed.

Model	WH-700
Dimension	820x620x1150 mm
Capacity	40 L
Weight	65 kg
Horsepower	1/8
Voltage	110V / 220V



3H015004  
Filter Net



## WH-702 Brake Disk Lining Cleaning System

- ▶ Removable filter installed to recycle waste water / detergent.
- ▶ Extra large diameter drain pan & removable filter grid.
- ▶ Mobile design to ensure best manoeuvrability in workshop.
- ▶ Quick loosen and remove dried oil, grease and dirt from the brake.
- ▶ Clean hazardous dust safely from all types of brakes.
- ▶ Design for cleaning vehicle brakes during brake inspections and repair jobs.

Model	WH-702
Dimension	500x450x985~1205 mm
Capacity	20 L
Weight	34 kg
Power	Air operated







## Mobile Parts Washer With Cleaning Brush

- ▶ The system will increase your working efficiency with its unique design.
- ▶ Large filter installed.
- ▶ Easy to bring to work place.
- ▶ Plastic material provides best resistance to water based solvent.

- ▶ With power switch.
- ▶ Brush design.



Model	WH-700MI	WH-700MS
Dimension	750x527x231 mm	460x660x260 mm
Voltage	110V / 220V / 240V	110V / 220V / 240V
Weight	9 kg	5 kg
Capacity	20 L	9 L

### WH-700MI



### WH-700MS



## WH-700MSA Air Pulse Parts Cleaner

- ▶ Easy to bring to work place.
- ▶ Plastic material provides best resistance to water-based solvent.
- ▶ With aluminum extendable pallet.

Model	WH-700MSA
Dimension	600x450x270 mm
Weight	7.52 kg
Capacity	20 L
Power	Air



## WH-700SA Economic Parts Washer

- ▶ Designed to fit most 5 gallon buckets.
- ▶ Tapered basin with cord and hose channels allow a snug fit.
- ▶ Self-contained 4.5 gallon/minute submersible pump for strong, continuous cleaning power.

Model	WH-700SA
Dimension	350x345x130 mm
Voltage	110V
Weight	1.42 kg
Capacity	3 L



without 5 gallons barrel



## Parts Washing Brush

- ▶ Replacement flow through brush for most popular parts washer.
- ▶ Solid nylon handle.

Model	223002	220056
Material	Nylon	Nylon



## SC-2000A Coolant Replacement System

- ▶ Synchronized operation, which sucks in waste coolant and supplies new coolant at exchange operation.
- ▶ Intake safety valve attached, automatically releases pressure while it is too high.
- ▶ "Engine Off" operation, back flush procedure to remove coolant and particulates efficiently on a hot or cold vehicle.
- ▶ Simple controls and quick coupler connection system make operation extremely fast, clean and easy.
- ▶ Simply connect to upper radiator hose with universal step adaptors.
- ▶ "Air Evacuation" operation to purge trapped air from cooling system to eliminate the possibility of engine damage due to overheating.

### RT-919SC

Airvac coolant refiller radiator neck coolant adaptor.



Model	SC-2000A
Dimension	480x650x1050 mm
Capacity	New / Waste Tank: 35 L
Weight	61.7 kg

### SC-2000A ACCESSORIES



Patent No:165822  
US PAT:10.115.296



## RT-919AD Radiator Pressure Tester Kit

- ▶ Pressure tester to check leakage of radiator.
- ▶ Multi adaptors included which apply for most car models in the market.
- ▶ 0-35 psi, colour-coded gauge, pressure release valve, plastic carrying case.
- ▶ Comprehensive operating instruction enclosed.

Model	RT-919AD
Dimension	385x290x102 mm
Weight	2.94 kg
Quantity	16 Pcs



Pressure testing by hand pump



## RT-919C Radiator Pressure Tester Kit

- ▶ Pressure tester to check leakage of radiator.
- ▶ Multi adaptors included which apply for most car models in the market.
- ▶ 0-35 psi, colour-coded gauge, pressure release valve, plastic carrying case.
- ▶ Comprehensive operating instruction enclosed.

Model	RT-919C
Dimension	430x330x100 mm
Weight	3.1 kg
Quantity	20 Pcs



Pressure testing by hand pump

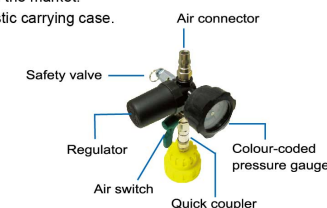

## RT-919S Radiator Pressure Tester Kit

- ▶ Pressure tester to check leakage of radiator.
- ▶ 0-35 psi, colour-coded gauge, pressure release valve, plastic carrying case.
- ▶ Comprehensive operating instruction enclosed.

Model	RT-919S
Dimension	430x330x100 mm
Weight	3 kg
Quantity	21 Pcs





## RT-919F Universal Radiator Pressure Tester Kit

- ▶ The adapter's expandable rubber body allows user to connect to most automotive Cooling Systems without the need for additional costly adapters.
- ▶ User can perform pressure testing and cooling system diagnostics simultaneously.
- ▶ 0-35 psi, colour-coded gauge, and pressure release valve, plastic carrying case.
- ▶ Comprehensive operating instruction enclosed.



Pressure testing by hand pump

Model	RT-919F
Dimension	400x380x90 mm
Weight	3.0 kg
Quantity	5 Pcs

- WH-801A 16.5~37 mm  
WH-801B 28~42 mm  
WH-801C 38~50 mm  
WH-801D 46~60 mm



## RT-919LB Radiator Pressure Tester Kit With Coolant Refiller

- ▶ Pressure tester to check leakage of radiator.
- ▶ Multi adaptors included which apply for most car models in the market.
- ▶ 0-35 psi, colour-coded gauge, pressure release valve, plastic carrying case.
- ▶ Comprehensive operating instruction enclosed.



PRESSURE HAND PUMP

Includes pressure release valve that, after testing, releases pressure buildup before removing the adaptor from the radiator neck.

Includes Airvac Coolant Refiller  
**RT-919HB**

Dimension: 135x103x230 mm  
Weight: 1.6 kg Quantity: 6 pcs



### Adaptor List For RT-919LB

- NO. 01 (060) BLACK MERCEDES BENZ Mini cooper  
NO. 02 BLUE Audi (after 2000)  
NO. 03 YELLOW OPEL.VW.FORD  
NO. 04 RED B.M.W  
NO. 05 ORANGE B.M.W  
NO. 06 BLACK Audi.CITROEN. RENAULT.FIAT.PEUGEOT  
NO. 07 BLACK VOLVO.VW(before 2000)  
NO. 08 BLACK Adjustable Stationary Seat  
NO. 09 BLACK 50m/m universal connector with No.8 adjustable stationary seat. (Japanese car series,European car series)  
NO. 10 BLACK 35m/m universal connector with No.8 adjustable stationary seat. (Japanese car series,European car series)  
NO. 11 BLACK 27m/m universal connector with No.8 adjustable stationary seat. (Japanese car series,European car series)  
NO. 12 BLACK Coordinate No.8 with No.9-11  
NO. 13 BLACK Suitable for the series car of radiator's upper cap use.  
NO. 14 Stainless fastener  
NO. 15 BLACK HONDA.TOYOTA  
NO. 16 BLACK MITSUBISHI.FORD. NISSAN.MAZDA  
NO. 17 BLACK (040) FORD  
NO. 18 BLACK (042) FORD  
NO. 19 BLACK MERCEDES BENZ  
NO. 20 GREEN FORD  
NO. 21 BLACK GM FORD  
NO. 22 BLACK GM OPEL  
NO. 23 YELLOW BMW E 60  
NO. 24 BLUE FORD(after 2010)  
NO. 25 (045) BLACK PREVIA TOYOTA RAV4  
NO. 26 BLACK GM Trucks Optional



## RT-919J Radiator Cap Pressure Tester Kit

- ▶ Pressure tester to check the gasket of radiator cap.
- ▶ Instantly detect leakage of cooling system.
- ▶ Multi adaptors included which apply for most car models in the market.
- ▶ Hand pump with colour-coded gauge.
- ▶ Comprehensive operating instruction enclosed.
- ▶ 0-35 psi, colour-coded gauge, pressure release valve, plastic carrying case.

Model	RT-919J
Dimension	360x270x80 mm
Weight	1.71 kg
Quantity	10 Pcs

- NO. 1 BLUE TOYOTA.HONADA  
NO. 2 ORANGE MITSUBISHI. FORD. NISSAN. MAZDA  
NO. 3 BLACK NIPPON HINO  
NO. 4 ORANGE RENAULT. AUDI. VW.  
NO. 5 RED VOLVO. CITROEN. RENAULT. FIAT. PEUGEOT  
NO. 6 YELLOW OPEL. VW. FORD  
NO. 7 GREEN VOLVO.RENAULT  
NO. 8 BLACK B.M.W  
NO. 9 BLACK MERCEDES



- Optional  
NO. 10 BLACK GM. FORD TRUCK. OPEL  
NO. 11 ORANGE GM. FORD

## RT-919W Heavy Truck Radiator Tester

- ▶ For most truck radiators include: DAF / Iveco / MAN / Mercedes / Renault / ERF Scania / Volvo/ Fuso/ Hino.
- ▶ Metal sturdy design to ensure long lasting usage.

Model	RT-919W
Dimension	385x85x300 mm
Weight	3.11 kg
Quantity	8 Pcs



## RT-919MD Universal Radiator Tester With Expandable Adaptors

- ▶ Universal design to fit on most radiator necks.
- ▶ No need for additional costly adaptors.
- ▶ Metal sturdy design to ensure long lasting usage.

Model	RT-919MD
Dimension	385x85x300 mm
Weight	2.16 kg
Quantity	6 Pcs







## TP-3590A Turbo System Pressure Tester 9 Pcs

- Designed to detect leaks within the turbo system and cooling system hoses.
- Features a pressure gauge with shut off valve, pressure regulator, and pressure release valve.
- Comes with four pairs of adaptors to fit most sizes of hose.

Model	TP-3590A
Dimension	612x238x115 mm
Weight	3.5 kg
Quantity	9 PCS

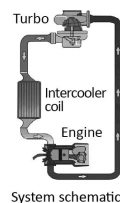

ADAPTOR SIZES :  
35-45 mm  
50-60 mm  
65-75 mm  
80-90 mm

## Airvac Coolant Refiller

- Purges trapped air from cooling system to eliminate the possibility of engine damage due to overheating.
- Performs vacuum leak test on cooling system.
- Refills cooling system free of trapped air quickly, efficiently and with no mess.
- Universal rubber body plus four additional bushings covers most vehicle radiators.
- Muffler dampens noise output during operation.



Operating demonstration

### RT-919H

### RT-919HA

Model	RT-919H	RT-919HA
Dimension	320x180x130 mm	135x103x153 mm
Weight	1.86 kg	0.87 kg
Quantity	8 Pcs	7 pcs



### RT-919HB

### RT-919I

TW PAT:M362300

Model	RT-919HB	RT-919I
Dimension	135x103x230 mm	135x103x138 mm
Weight	1.6 kg	0.63 kg
Quantity	6 pcs	3 pcs



## RT-919K1 Universal Coolant Filling Set

- Quick and easy way to refill coolant during cooling system bleeding process.
- Quick, efficient, and no mess.

Model	RT-919K1
Dimension	160x160x260 mm
Weight	680 g
Quantity	8 Pcs



## Coolant Filling Set

- Quick and easy way to refill coolant during cooling system bleeding process.
- Quick, efficient, and no mess.



Filling process

### RT-919K

### RT-919K2



Model	RT-919K	RT-919K2
Dimension	160x160x260 mm	160x160x260 mm
Weight	450 g	500 g
Quantity	4 Pcs	3 Pcs



K-050  
Japanese Vehicles  
American Vehicles



K-041  
HONDA  
TOYOTA



K-043  
MITSUBISHI.FORD.  
NISSAN.MAZDA



209130  
HYUNDAI KIA



209059  
DAEWOO  
FOR KOREAN MODELS

## WH-507U Cooling System Flushing Gun

- Designed for cooling system flushing.
- Step adaptor connects to hoses in different diameters.
- Use air and water to clean up system.
- Trigger handle to control flushing and simulate pulsing force.

Model	WH-507U
Dimension	320x125 mm
Weight	0.24 kg



## RT-919HT Airvac Coolant Refiller With Fluid Tank

- One switch design to control vacuum and refill.
- Built in fluid tank, no mess with external tank.
- With new fluid tank.

Model	RT-919HT
Dimension	300x300x420 mm
Weight	3.98 kg
Quantity	5 L





## WH-737 Line Clamp Triple Pack

- ▶ Smooth rounded jaw edges prevent damage to internal hose reinforcement.
- ▶ Quick and simple one-hand use.
- ▶ Material: PA+GF



Anti-slip design.

Model	WH-737
Dimension	350x112x75 mm
Weight	220 g
Quantity	3 Pcs

**Large**  
Size range : 3~66 mm  
Size : 66 mm  
Weight : 130 g

**Medium**  
2~28 mm  
28 mm  
80 g

**Small**  
1~19 mm  
19 mm  
40 g

## WH-737S Line Clamp Triple Pack

- ▶ Smooth rounded jaw edges prevent damage to internal hose reinforcement.
- ▶ Quick and simple one-hand use.
- ▶ Material: Aluminum



Anti-slip design.

Model	WH-737S
Dimension	350x112x75 mm
Weight	468 g
Quantity	3 Pcs

**Large**  
Size range : 1~65 mm  
Size : 65 mm  
Weight : 210 g

**Medium**  
3~26 mm  
26 mm  
140 g

**Small**  
3~16 mm  
16 mm  
80 g

## WH-737L Angled Line Clamp

- ▶ Smooth rounded jaw edges prevent damage to internal hose reinforcement.
- ▶ Quick and simple one-hand use.
- ▶ Material: Aluminum



45°

Model	WH-737L
Dimension	185x85x35 mm
Weight	150 g
Quantity	1 Pc



Size range: 18 mm-31 mm

## WH-8560 Low Profile Coolant/Antifreeze Receiver

- ▶ Designed for waste fluid receiving during repairing jobs.
- ▶ Very low profile which can slide under passenger car easily.
- ▶ With covered splash net to prevent spillage and splash.
- ▶ One piece polyethylene plastic can be used for antifreeze.
- ▶ Very suitable for cooling system repairing job.

Model	WH-8560
Dimension	850x600x125 mm
Capacity	20 L
Weight	4 kg



- ★ Only 125 mm high. (include casters).
- ★ Polyethylene material.
- ★ Strong construction for heavy duty use.
- ★ 4 casters installed provide best maneuverability.



## WH-7292A 30L Low Profile Drain Pan

- ▶ Built-in handle and 4" casters for easy transport.
- ▶ Ideal for transmission fluid, coolant, or oil draining.
- ▶ Can be stored upright for space saving.
- ▶ Large capacity 30 L.



Model	WH-7292A
Dimension	935x730x155 mm
Capacity	30 L
Weight	6.5 kg

## 5T0002

### Antifreeze Tester-Dial Type

- ▶ Composite body and rubber bulb for workshop durability.
- ▶ Tests ethylene glycol strength and includes temperature adjustment scale for accurate interpretation of mixture strength.

Model	5T0002
Dimension	200x90x18 mm
Weight	79 g



## Portable Refractometer

- ▶ This portable refractometer is a precision instrument designed to measure engine coolant, battery acid and windscreen washer fluid.
- ▶ Remember to use the appropriate scale when measuring the above fluids.

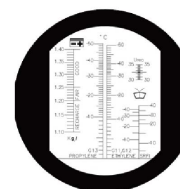

### SC-414



Model	SC-414
Dimension	75x210x52 mm
Weight	350 g
Quantity	5 Pcs

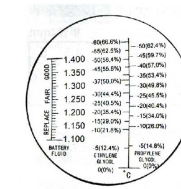

### SC-414A



Model	SC-414A
Dimension	75x210x52 mm
Weight	350 g
Quantity	5 Pcs





## WH-505 Pressure Brake Bleeder

- ▶ Air operated pressure brake bleeder.
- ▶ Suitable for clutch bleed as well as brake bleed.
- ▶ 5 Litre capacity tank.
- ▶ Complete with WH-505CA master cylinder adaptor kit.

Model	WH-505
Dimension	350x275x450 mm
Capacity	5 L
Weight	9.6 kg



## WH-505A Pressure Brake Bleeder with air tank

- ▶ Air operated pressure brake bleeder.
- ▶ Portable - can be disconnected from air supply.
- ▶ Stores pressure inside tank.
- ▶ Suitable for clutch bleed as well as brake bleed.
- ▶ 6 Litre capacity tank.
- ▶ Complete with WH-505CA master cylinder adaptor kit.

Model	WH-505A
Dimension	350x275x450 mm
Capacity	6 L
Weight	12 kg



## WH-505S Stainless Pressure Brake Bleeder (SUS 340)

- ▶ Air operated pressure brake bleeder.
- ▶ Suitable for clutch bleed as well as brake bleed.
- ▶ 5 Litre capacity tank.
- ▶ Stainless steel body.
- ▶ Complete with WH-505CA master cylinder adaptor kit.

Model	WH-505S
Dimension	350x275x450 mm
Capacity	5 L
Weight	10 kg



## WH-505CA Master Cylinder Adaptor Kit

standard set for WH-505 WH-505A WH-505S

- ▶ Comes in a blow mold case.
- ▶ Compatible for most pressure brake bleeders.
- ▶ Suitable for clutch bleeding and brake bleeding.
- ▶ Heavy-duty plastic and O-rings withstand brake fluid.
- ▶ The master cylinder adaptors fit most American, Asian, and European manufactured cars and light trucks, such as GM, BMW, Audi, Nissan, Mazda, and Honda.

Diameter : mm

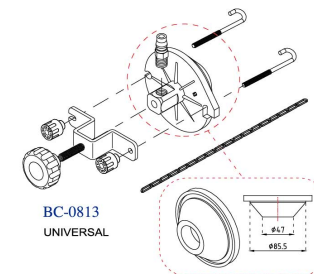

BC-0813  
UNIVERSAL

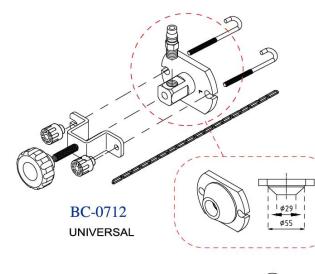

BC-0712  
UNIVERSAL

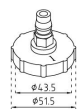

BC-01  
CHRYSLER, DODGE, JEEP,  
PLYMOUTH

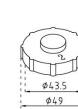

BC-02  
CHRYSLER, DODGE, JEEP,  
PLYMOUTH

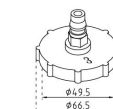

BC-03  
MOST LATE MODEL GM CARS (BUICK,  
CADILLAC, CHEVROLET, GMC, HUMMER,  
OLDSMOBILE, PONTIAC) SOME MAZDA

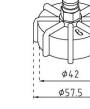

BC-06  
MOST EUROPEAN CARS (ALFA ROMEO,  
AUDI, BMW, JAGUAR, LAND ROVER,  
MERCEDES, PEUGEOT, PORSCHE,  
RENAULT, SAAB, VW, VOLVO),  
CHRYSLER CROSSFIRE, DAIHATSU,  
LATE MODEL FORD, KIA, SOME MAZDA, MINI

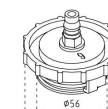

BC-09  
HONDA ACCORD

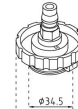

BC-10  
NISSAN

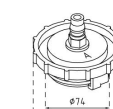

BC-12  
HONDA

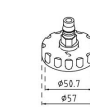

BC-19  
ALL HYUNDAI, MITSUBISHI,  
NISSAN, SUBARU,  
SOME CHRYSLER/DODGE,  
SOME FORD/LINCOLN

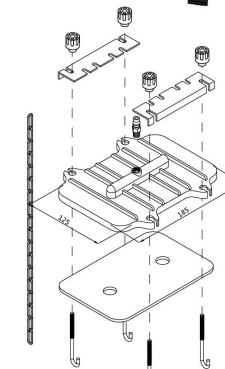

BC-11  
U.S. CHRYSLER OF GM



BC-21  
TOYOTA, LEXUS

## WH-505CNA Master Cylinder Adaptor Kit

optional set

Diameter : mm

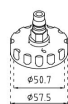

BC-20  
FORD ESCAPE (RED)

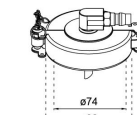

BC-25  
HONDA

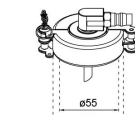

BC-26  
HONDA

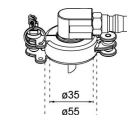

BC-27  
NISSAN MICRA,  
MITSUBISHI COLT PLUS

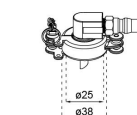

BC-34A  
NISSAN TIIDA,  
LIVINA, MICRA

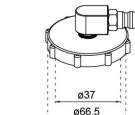

BC-41  
MAZDA,  
FORD KUGA





## Master Cylinder Adaptor

### BC-06A



Aluminum  
Weight: 220 g  
For MAZDA

### BC-15



73 mm x P3.0  
Weight: 74 g  
For FORD

### BC-16



64 mm x P3.0  
Weight: 70 g  
For DAIHATSU

### BC-17



Diameter: 68 mm  
Weight: 207 g  
For MITSUBISHI

### BC-18



77 mm x P3.0  
Weight: 75 g  
For NISSAN BLUEBIRD



### BC-21



Diameter: 43 mm  
Weight: 229 g  
For TOYOTA & LEXUS

### BC-22



Diameter: 35.5 mm  
Weight: 200 g  
For MITSUBISHI

### BC-23



Diameter: 35 mm  
Weight: 200 g  
For MITSUBISHI

### BC-24



Diameter: 23 mm  
Weight: 195 g  
For TOYOTA

### BC-31



Diameter: 43 mm  
Weight: 55 g  
For LUXGEN

### BC-35



Diameter: 26 mm  
Weight: 55 g  
For MITSUBISHI DELICA

### BC-42



Diameter: 49.5 mm  
Weight: 60 g  
For GM 2013+

### BC-47



Diameter: 54 mm  
Weight: 226 g  
For CHEVROLET COLORADO, ISUZU D-MAX

### BC-48



Diameter: 41 mm  
Weight: 156 g  
For FORD RANGER

### UK-31



Diameter: 99.5 mm  
Weight: 250 g

## Universal Master Cylinder Adaptor

- Used to connect bleeding system to the vehicle master cylinder reservoir.
- Compatible with a wide range of reservoir designs.

### UK-34



Diameter: 104 mm  
Weight: 570 g

### UK-36



Diameter: 95x178 mm  
Weight: 922 g

### UK-35



Diameter: 115x215 mm  
Weight: 1008 g

### UK-37



For GM & CHRYSLER

## For Truck

### TC-1A



Diameter: 105 mm  
Weight: 160 g  
For FUSO

### TC-2A



Diameter: 58 mm  
Weight: 94 g  
For ISUZU

### TC-3A



Diameter: 86 mm  
Weight: 116 g  
For UD

### TC-4A



Dimension: 37 mm  
Weight: 90 g  
For HINO

## WH-505CH For Motorcycle

Model	WH-505CH
Dimension	412x210x110 mm
Material	Aluminum
Weight	1316 g



## WH-505D

### Pressure Brake Bleeder

- Complete with WH-505CA master cylinder adaptor kit.
- Air operated pressure brake bleeder.
- Suitable for clutch bleed as well as brake bleed.
- 5 Litre capacity tank.

Model	WH-505D
Dimension	410x310x900 mm
Capacity	5 L
Weight	16 kg



With master cylinder adaptor kit.

## PA-506

### Vacuum Brake Fluid Bleeder

- Vacuum brake bleeder.
- 6 litre capacity.
- Uses standard workshop air supply.
- Removes fluid via bleed nipples to allow bleeding or entire fluid replacement.

Model	PA-506
Dimension	270x230x375 mm
Capacity	6 L
Weight	2.9 kg
Power	Air Vacuum

200008	Connector for brake fluid suction
200024	10 mm gear oil tube



## 204031

### Fluid Supply Bottle

Model	204031
Capacity	1 L
Material	PE+HD



## 204079

### Bleeding Bottle To Receive Old Fluid

Model	204079
Capacity	1 L
Material	PE+HD







## WH-505J Vacuum Brake Fluid Bleeder

- ▶ Vacuum brake bleeder.
- ▶ 3 litre capacity.
- ▶ Uses standard workshop air supply.
- ▶ Removes fluid via bleed nipples to allow bleeding or entire fluid replacement.

### INCLUDE:

WH-508D BRAKE FLUID SUPPLY BOTTLE 1L  
(Adjustable Nozzle)

Model	WH-505J
Material	PE
Capacity	2.8 L
Power	Air Vacuum
Weight	1420 g

WH-508D

For new fluid supply



## WH-505T Pneumatic Brake Fluid Bleeder

- ▶ Flush and bleed the system without the risk of running the reservoir dry.
- ▶ Max. working pressure of 30psi makes the unit suitable for ABS systems.
- ▶ Valve design to control the flow.
- ▶ With level scale in "Liter" and "Quart".
- ▶ Optional universal adaptor.
- ▶ Features a 45mm threaded hydraulic fluid reservoir cap to fit most European cars.

Model	WH-505T
Dimension	116x116x350 mm
Capacity	1.50 L
Material	PE
Power	AIR
Weight	722 g



## WH-505H Manual Brake Fluid Bleeder

- ▶ Standard with an adaptor for European cars.
- ▶ 2.5 litre capacity.
- ▶ Optional universal adaptor.

Model	WH-505H
Dimension	170x190x420 mm
Capacity	2.50 L
Weight	1140 g
Material	PE
Power	Manual



## WH-505V 12V Pressure Brake Fluid Bleeder (Stainless Steel Cabinet)

- ▶ Standard with an adaptor for European cars.
- ▶ Suitable for clutch bleed as well as brake bleed.
- ▶ 5 litre capacity tank.

Model	WH-505V
Dimension	365x300x820 mm
Capacity	5 L
Weight	13.36 kg
Power	DC 12V



## WH-509 Brake Fluid Tester

- ▶ There is an electronic circuit design for the tester to maintain its accuracy in the event of power shortage.
- ▶ High-tech brake fluid sensor, easy to hand.
- ▶ User-friendly handle to perfectly fit the hand.
- ▶ The tester exam the quality of the brake fluid.
- ▶ With plastic case.

Model	WH-509
Dimension	110x46x210 mm
Weight	0.3 kg



## BFT-320 Brake Fluid Safety Meter

- ▶ Award-winning ergonomic design.
- ▶ Operates off 12 volt supply-cars own battery.
- ▶ LCD screen instructions available in 16 different languages.
- ▶ Supplied to the World's leading brake and brake fluid manufacturers.
- ▶ User-friendly.
- ▶ Now available up to 320°C(608°F)-suitable for use on new brake fluid and racing fluids.
- ▶ Will not operate if connected to the wrong polarity.
- ▶ LCD screen instructions lead operator through the complete testing sequence.
- ▶ Own branding available.

Model	BFT-320
Dimension	315x24x100 mm
Weight	1.2 kg



## 204050 Universal Fluid Supply Bottle

Model	204050
Dimension	150x140x250 mm
Weight	238 g
Capacity	1.5 L



## 204004 Fluid Syringe

- ▶ Capacity: 50c.c.



## 204137 Brake Fluid Receiving Bottle -with check valve design

- ▶ Brake nipple to fit on all bleeding point.
- ▶ Check valve design to prevent air into the system.

Model	204137
Dimension	76x52x190 mm
Weight	0.28 kg
Capacity	0.6 L
Material	HDPE



## 5T0001 Fluid Syringe





## Multi-Function Suction Cups

- ▶ The longitudinal holes in the articulated joints allow the transport of surfaces which are curved beyond standard such as those found on some automobile windscreens.
- ▶ Aluminum handle.



Body work application

WH-9601

WH-9601J

WH-9601K



Model	WH-9601	WH-9601J	WH-9601K
Diameter	125 mm, 4.92"	100 mm, 3.93"	75 mm, 2.95"
Loading Capacity	20 kg	15 kg	10 kg

## TV-169 Manual Vacuum Dent Puller

- ▶ Sliding hammer to ease dent without damaging to the paint surface.
- ▶ Comes with 3 suction pads.



Model	TV-169
Dimension	755x166.5x100 mm
Weight	4.7 kg
Material	Steel & Plastic
Sliding Hammer	1.22 kg

## TV-169A Air Vacuum Dent Puller

- ▶ Sliding hammer to ease dent without damaging to the paint surface.
- ▶ Comes with 3 suction pads.
- ▶ Get the power and versatility of a slide hammer without marring the finish by welding or drilling body panels.
- ▶ Pneumatic control creates a super-strong vacuum, making it easy to pull most dents out of panels.
- ▶ Instantly removes most dents without damaging paint.
- ▶ Requires air compressor - no drilling, welding or sanding required.
- ▶ 4" and 5" rubber cups for small and large dents.
- ▶ Urethane air supply hose with check valve.



Model	TV-169A
Dimension	612x238x92 mm
Weight	4.3 kg
Material	Steel & Plastic
Air Inlet	1/4"
Sliding Hammer	1.22 kg



## PS-2105 5 Pcs Trim Fastener And Molding Removal Kit

- ▶ Kit includes 5 different sizes and styles of tools to simplify trim and trim stud removal.
- ▶ This kit is made of composite plastic to prevent damage to trim, moldings, alloy wheels, or painted finishes.

Model	PS-2105
Dimension	60x160 mm 21x178 mm 20x211 mm 30x200 mm 75x176 mm
Weight	192 g



## PS-2106 6 Pcs Mini Trim And Panel Removal Kit

- ▶ Kit includes 6 different sizes and styles of tools to simplify trim and trim stud removal.
- ▶ This kit is made of composite plastic to prevent damage to trim, moldings, alloy wheels, or painted finishes.

Model	PS-2106
Dimension	38x198 mm 24x202 mm 24x200 mm 15x202 mm 30x202 mm 33x198 mm
Weight	132 g



## 213047 Mini Precision Hammer

- ▶ Mini hammer fitted with one steel face and one rubber face.
- ▶ Deliver precise force to make an item fit.
- ▶ Suitable for trim and panel work.
- ▶ Less likely to damage painted finishes.

Model	213047
Dimension	55x173 mm
Weight	46 g



## PS-2112P 12 Pcs Composite Fastner/Panel Removal Kit

Model	PS-2105
Dimension	60x160 mm 21x178 mm 20x211 mm 30x200 mm 75x176 mm
Weight	192 g

Model	PS-2106
Dimension	38x198 mm 24x202 mm 24x200 mm 15x202 mm 30x202 mm 33x198 mm
Weight	132 g

Model	213047
Dimension	55x170 mm
Weight	46 g







## PS-435 Trim Fastener And Molding Removal Tool

Model	PS-435
Dimension	400x35x13.5 mm
Weight	140 g
Material	Nylon



## PS-2704 4 Pcs Composite Scraper Kit

- ▶ Composite scrapers remove object without marring or damaging aluminum and painted finishes.
- ▶ Ideal for removing trim, residue from alloy wheels, badges and decals from bodywork.
- ▶ Plastic edges will not scratch or mark paint or panel work and can be re-sharpened with a file when required.

Model	PS-2704
Dimension	275 mm
Blade sizes	38 mm, 25 mm, 23 mm, 20 mm
Weight	393 g



## PS-1218 Plastic Chisel/Wedge set

- ▶ Removes timing belt cover, oil drain, etc.
- ▶ Also work for panel/trim removal.
- ▶ Composite plastic design which won't cause any damage.

Model	PS-1218
Dimension	127 mm, 175 mm, 127 mm, 175 mm
Material	PA+GF



## PS-285 5 in 1 Caulk Finishing Tool

- ▶ Useful helper for smoothing the bead of sealant such as silicone and acrylic.
- ▶ Ideal for floor, kitchen, bathroom and window sealing job.
- ▶ Can be applied repeatedly and easy to clean.
- ▶ Compact design includes 5 shapes of spatulas.

Model	PS-285
Dimension	135x20x21 mm
Weight	24 g
Material	HIPS



## PS-215 One Hand Silicone Remover

- ▶ For scraping, cleaning and peeling silicone in all occasions.
- ▶ Easy and simple use, one hand operation.
- ▶ Built by composite plastic, strong enough to do the job.
- ▶ Will not damage surface material during the operation.

Model	PS-215
Dimension	212x34x25.5 mm
Weight	22 g
Material	POM

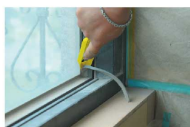

Push the remover backward to scrape the silicone.



Pull the remover backward to peel the silicone.



## Assorted Case With Various Compartments

- ▶ Tough composite plastic compartment with selective configuration.
- ▶ Clear see-through design to identify contents at a glance.
- ▶ Each compartment with belt clip for easy carrying.
- ▶ Optimal divider for more storage options.

- Dimension: 300x145x330 mm
- Weight: 1.8 kg



### KT-918F

Inner Box:  
KT-09(S) x 18 pcs

18  
PCS



### KT-612F

Inner Box:  
KT-06(M) x 12 pcs

12  
PCS



### KT-9615F

Inner Box:  
KT-09(S) x 9 pcs  
KT-06(M) x 6 pcs

15  
PCS



### KT-369F

Inner Box:  
KT-09(S) x 6 pcs  
KT-06(M) x 4 pcs  
KT-03(L) x 2 pcs

12  
PCS



### KT-3538A

• Dimension: 385x335x60 mm  
= Clapboard x 10 pcs



### KT-3538B

• Dimension: 385x335x60 mm  
= Box x 14 pcs



### KT-3538C

• Dimension: 385x335x60 mm  
= Clapboard x 4 pcs  
+ Box x 8 pcs



### KT-3538D

• Dimension: 385x335x60 mm  
= Clapboard x 6 pcs  
+ Box x 6 pcs



KT-14(Small):  
89.5x66x53 mm



## Tool Cart Professional Utility Cart

**KT-707E**



**KT-707F**



**KT-707TV**



**KT-909E**



**KT-909F**



**KT-909FB**



**KT-707F1**



**KT-707F2**



**KT-707F3**



Model	KT-707E	KT-707F	KT-707TV	KT-909E	KT-909F	KT-909FB	KT-707F1/F2/F3
Dimension	750x460x925 mm	750x460x980 mm	750x460x1180 mm	990x513x950 mm	990x513x1010 mm	990x513x1010 mm	750x460x980 mm
Upright	560 mm x 4 pcs	280 mm x 8 pcs	200 mm x 4 pcs 560 mm x 4 pcs	560 mm x 4 pcs	280 mm x 8 pcs	280 mm x 8 pcs	280 mm x 8 pcs
Plate	630x424 mm	630x424 mm	630x424 mm	866x500 mm	866x500 mm	866x500 mm	630x424 mm

- ▶ Quality carts for automotive, shop and maintenance applications.
- ▶ Easy assembly with rubber mallet.
- ▶ Molded shelves won't rust, dent, or require painting.
- ▶ Will not scratch car finish.
- ▶ 4" Brake wheel x 2 pcs.
- ▶ 4" Swivel wheel x 2 pcs.
- ▶ Material : Plastic.
- ▶ Upright : Aluminum alloy.



Standard wheels  
with butterfly brake



Option wheels  
with step brake



## KT-3852F Economic Utility Cart

- ▶ Quality carts for automotive, shop and maintenance applications.
- ▶ Easy assembly with rubber mallet.
- ▶ Molded shelves won't rust, dent, or require painting.
- ▶ Will not scratch car finish.
- ▶ 4" Brake wheel x 2 pcs.
- ▶ 4" Swivel wheel x 2 pcs.
- ▶ Material : Plastic.
- ▶ Upright : Aluminum alloy.

Model	KT-3852F
Dimension	685x435x940 mm
Upright	280 mm x 8 pcs
Material	Plastic
Plate	500x380 mm



## KT-808FB Professional Tool/Utility Cart

- ▶ Top shelf with various compartments for organizing and reaching for tools or parts easily at work place.
- ▶ Quality carts for automotive, shop and maintenance applications.
- ▶ Easy assembly with rubber mallet.
- ▶ Molded shelves won't rust, dent, or require painting.
- ▶ Will not scratch car finish.
- ▶ 4" Brake wheel x 2 pcs.
- ▶ 4" Swivel wheel x 2 pcs.
- ▶ Material : Plastic.
- ▶ Upright : Aluminum alloy.

Model	KT-808FB
Dimension	710x593x980 mm
Upright	280 mm x 8 pcs
Material	Plastic
Plate	Top: 670x593 mm Middle & Bottom: 630x424 mm



## A-300 Hose And Tool Holder

- ▶ Accessories for KT-707 & KT-909 series.



## Recycle Bin And Tray

- ▶ Ergonomic grip handles decrease the potential of back injury and finger strain.
- ▶ Plastic construction won't rust, dent, clip or peel.

Model	KT-508U	KT-508US
Dimension	355x262x230 mm	400x260x490 mm
Material	PP	HDPE



**KT-508U**

**KT-508US**

**KT-600**



**KT-4252**



Opening Increased

Model	KT-600	KT-4252
Dimension	575x430x180 mm	536x412x202 mm
Material	PP	PP





## Tool Cart / Professional Utility Cart

- ▶ Quality carts for automotive, shop and maintenance applications.
- ▶ Easy assembly with rubber mallet.
- ▶ Molded shelves won't rust, dent, or require painting.
- ▶ 3" brake wheel x 2 pcs .
- ▶ 3" swivel wheel x 2 pcs .
- ▶ Will not scratch car finish.
- ▶ Material : Plastic.
- ▶ Upright : Aluminum alloy.



**KT-4658**



**KT-4658-2**



Model	KT-4658	KT-4658-2
Dimension	575x455x900 mm	575x455x810 mm
Material	Plastic	Plastic
Upright	350 mm	555 mm
Divider	6 pcs	4 pcs

Model	KT-4658D
Dimension	575x455x900 mm
Material	Plastic
Upright	350 mm
Divider	6 pcs



KT-1010(L)x2  
KT-1073(M)x4  
KT-1045(S)x10

Model	KT-4665
Dimension	650x465x915 mm
Each Upright Height	280 mm
Upright	350 mm x 8 pcs
Divider	6 pcs
Material	Plastic



**KT-4658D**



**KT-4665**



## Professional Tool Cart

**KT-201**



**KT-202**



Model	KT-201	KT-202
Dimension	750x460x940 mm	750x460x940 mm
Upright	560 mm x 4 pcs	560 mm x 4 pcs
Material	Plastic, Steel	Plastic, Steel

**KT-301**



**KT-301B**



**KT-301AM**



**KT-301BT**



Model	KT-301	KT-301B	KT-301AM	KT-301BT
Dimension	750x460x980 mm	750x460x980 mm	750x460x980 mm	750x460x980 mm
Upright	280 mm x 8 pcs	280 mm x 8 pcs	280 mm x 8 pcs	280 mm x 8 pcs
Material	Plastic, Steel	Plastic, Steel	Plastic, Steel	Plastic, Steel



## KT-202DA Mobile Tool Trolley With Hanging Net

- ▶ Light weight design to provide best maneuverability.
- ▶ Material : Combination between steel, aluminum and PP (fiber) for extra strength and durability.
- ▶ Plate breaking force (PP with fiber) : 800 kg.
- ▶ 4" hard wearing nylon wheels and locking casters.
- ▶ Drawer size: 475 x 295 x 60 mm.

Model	KT-202DA
Dimension	750x460x1325 mm
Weight	24.7 kg
Upright	560 mm x 4 pcs
Plate	630x424 mm
Material	Steel, Aluminum, Plastic
Loading Capacity	Plate 120 kg / Level
	Drawer 20 kg / Each



## EG-600 Windshield Carrying Tool Cart

Model	EG-600
Dimension	850x600x1090 mm
Material	PA+30% fiber
Upright	350 mm x 8 pcs
Material	Plastic, Steel



2			D			
201123	Optional Adaptors For Fuel Retrifer	12	DEF-2585YF	AdBlue®/DEF Filling Funnel - Straight		8
204004	Fluid Syringe	38	DEF-2585YS	AdBlue®/DEF Filling Funnel - Angled		8
204031	Fluid Supply Bottle	36	DF-1010	Differential Fluid Changer		14
204050	Universal Fluid Supply Bottle	38	DF-5A	Differential Fluid Changer		13
204079	Bleeding Bottle To Receive Old Fluid	36				
204137	Brake Fluid Receiving Bottle	38	E			
213036	Exhaust Hose For Double Pipes	20	EC-900A	Injection Cleaning System		21
213047	Mini Precision Hammer	40	EC-900DLA	Super Fuel Injection Testing Kit		21
214087	Residue / Fluid Catch Funnel	3	EC-900G	Carbon Cleaning Canister For Manifold & Throttle		22
217006	Collection Bowl	17	EC-900G1	S Type Spray Nozzle		22
220028	Spray Nozzle with Fix-Lock Feature	22	EC-900G3	Y Type Spray Nozzle		22
220056	Parts Washing Brush	25	EC-900J	Deluxe Injection Cleaning / Testing Kit		21
223002	Parts Washing Brush	25	EC-900K	Carbon Cleaning Canister For Manifold & Throttle		22
225020	Tank for Spare Transmission Fluid	4	EC-900M	Carbon Cleaning Set For Manifold and Injector		22
229001	Exhaust Hose For WH-707B	20	EC-900SC	12Pcs Diesel Fuel Line Plugs		21
231009	Strap	42	EG-600	Windshield Carrying Tool Cart		47
3			G			
3C015012	Pre-Spray Net	17	GP-200	Electrical Gear Pump Oil Extractor		11
3C023251	Drill Bit Clip	42	GP-2A	16L Air Gear Pump Oil Extractor		11
3C023250	Clapboard	42	GP-RS	12V Portable Oil Transfer Pump		12
3C030005	Oil Drain Pan	15				
3D025413	Optional Adaptors For Fuel Retrifer	12	H			
3D025414	Optional Adaptors For Fuel Retrifer	12	HP-300A	3/8"Diaphragm Transfer Pump		17
3G021018	Red Rubber Hose For WH-707B	20	J			
3H015004	Filter Net For WH-700	24	JL-1500	Syringe For Vehicle Fluid Change		8
3MD17002	Steel Oil Drain Pan	17	JL-1500A	Syringe For Fuel Supply / Extraction		8
			JL-1500U	Syringe For Adblue / DEF Supply / Extraction		8
5			JL-200	Syringe For Vehicle Fluid Change		8
5T0001	Fluid Syringe	38	JL-550	Syringe For Vehicle Fluid Change		8
5T0002	Antifreeze Tester-Dial Type	32				
A			K			
A-300	Hose And Tool Holder	44	K-10C-2	Transmission Filling System		3
AC-5A	Pressure Fluid Dispenser	13	K-10L	Transmission Filling System		3
AC-6A	Pressure Fluid Dispenser	13	KT-201	Professional Tool Cart		46
AC-6L	Pneumatic Fluid Dispenser With Withdraw Function	7	KT-202	Professional Tool Cart		46
AF-70S	70L Cleaning Foam Sprayer	23	KT-202DA	Mobile Tool Trolley With Hanging Net		47
AF-90S	90L Cleaning Foam Sprayer	23	KT-301	Professional Tool Cart		46
AS-30	30L Pneumatic Fluid Atomiser	23	KT-301AM	Professional Tool Cart		46
AT-001	Fuel & Air Conditioning Hose Disconnect Set	22	KT-301B	Professional Tool Cart		46
AT-002	Fuel & Air Conditioning Hose Disconnect Set	22	KT-301BT	Professional Tool Cart		46
AT-003	Fuel & Air Conditioning Hose Disconnect Set	22	KT-3538A	Assorted Case With Various Compartments		42
AT-1000A	Professional ATF Exchanger	1	KT-3538B	Assorted Case With Various Compartments		42
AT-1010	Dipstick type ATF Changer	1	KT-3538C	Assorted Case With Various Compartments		42
			KT-3538D	Assorted Case With Various Compartments		42
			KT-369F	Assorted Case With Various Compartments		42
			KT-3852F	Economic Utility Cart		44
BC-06A	Master Cylinder Adaptor	35	KT-4252	Recycle Bin And Tray		44
BC-15	Master Cylinder Adaptor	35	KT-4658	Tool Cart / Professional Utility Cart		45
BC-16	Master Cylinder Adaptor	35	KT-4658D	Tool Cart / Professional Utility Cart		45
BC-17	Master Cylinder Adaptor	35	KT-4658-2	Tool Cart / Professional Utility Cart		45
BC-18	Master Cylinder Adaptor	35	KT-4665	Tool Cart / Professional Utility Cart		45
BC-20	Master Cylinder Adaptor	34	KT-508U	Recycle Bin And Tray		44
BC-21	Master Cylinder Adaptor	35	KT-508US	Recycle Bin And Tray		44
BC-22	Master Cylinder Adaptor	35	KT-600	Recycle Bin And Tray		44
BC-23	Master Cylinder Adaptor	35	KT-612F	Assorted Case With Various Compartments		42
BC-24	Master Cylinder Adaptor	35	KT-707E	Tool Cart Professional Utility Cart		43
BC-25	Master Cylinder Adaptor	34	KT-707F	Tool Cart Professional Utility Cart		43
BC-26	Master Cylinder Adaptor	34	KT-707F1	Tool Cart Professional Utility Cart		43
BC-27	Master Cylinder Adaptor	34	KT-707F2	Tool Cart Professional Utility Cart		43
BC-31	Master Cylinder Adaptor	35	KT-707F3	Tool Cart Professional Utility Cart		43
BC-34A	Master Cylinder Adaptor	34	KT-707TV	Tool Cart Professional Utility Cart		43
BC-35	Master Cylinder Adaptor	35	KT-808FB	Professional Tool/Utility Cart		44
BC-41	Master Cylinder Adaptor	34	KT-909E	Tool Cart Professional Utility Cart		43
BC-42	Master Cylinder Adaptor	35	KT-909F	Tool Cart Professional Utility Cart		43
BC-47	Master Cylinder Adaptor	35	KT-909FB	Tool Cart Professional Utility Cart		43
BC-48	Master Cylinder Adaptor	35	KT-918F	Assorted Case With Various Compartments		42
BFT-320	Brake Fluid Safety Meter	38	KT-9615F	Assorted Case With Various Compartments		42





## L

LY-205	Vacuum Pump Oil Extractor	5
LY-2051	Vacuum Pump Oil Extractor	5
LY-350	Drum Drain Basin	17
LY-40FS	40L Stainless Fuel Retriever	12
LY-550	Drum Drain Basin	17
LY-70P	70L Venturi System Oil Extractor	10
LY-90A	90L Air Venturi Oil Extractor	10
LY-90F	90L Stainless Fuel Retriever	12
LY-90T	90L Air Gear Pump Oil Extractor / Drainer	9

## O

OK-3NG	12L Electrical Gear Pump Oil Extractor	10
--------	--	----

## P

PA-1011A	Combo Fluid Extractor	7
PA-506	Vacuum Brake Fluid Bleeder	36
PA-600T	Manual Fluid Extractor	6
PA-600TA	Manual And Air Fluid Extractor	6
PA-800T	Manual Fluid Extractor	6
PA-800TA	Manual And Air Fluid Extractor	6
PA-1000T	Manual Fluid Extractor	6
PA-1000TA	Manual And Air Fluid Extractor	6
PC-500	Power Steering Flushing System	14
PS-1218	Plastic Chisel/Wedge set	41
PS-215	One Hand Silicone Remover	41
PS-2105	5pcs Trim Fastener And Molding Removal Kit	40
PS-2106	6pcs Mini Trim And Panel Removal Kit	40
PS-2112P	12Pcs Composite Fastner/Panel Removal Kit	40
PS-2704	4pcs Composite Scraper Kit	41
PS-285	5 in 1 Caulk Finishing Tool	41
PS-435	Trim Fastener and Molding Removal Tool	41

## R

RT-919AD	Radiator Pressure Tester Kit	26
RT-919C	Radiator Pressure Tester Kit	26
RT-919F	Universal Radiator Pressure Tester Kit	27
RT-919H	Airvac Coolant Refiller	29
RT-919HA	Airvac Coolant Refiller	29
RT-919HB	Airvac Coolant Refiller	29
RT-919HT	Airvac Coolant Refiller With Fluid Tank	30
RT-919I	Airvac Coolant Refiller	29
RT-919J	Radiator Cap Pressure Tester Kit	28
RT-919K	Coolant Filling Set	30
RT-919K1	Universal Coolant Filling Set	30
RT-919K2	Coolant Filling Set	30
RT-919LB	Radiator Pressure Tester Kit with Coolant Refiller	27
RT-919MD	Universal Radiator Pressure Tester With Expandable Adaptors	28
RT-919S	Radiator Pressure Tester Kit	26
RT-919SC	Aivac Coolant Refiller Radiator Neck Coolant Adaptor	26
RT-919W	Heavy Truck Radiator Tester	28

## S

SC-2000A	Coolant Replacement System	26
SC-414	Portable Refractometer	32
SC-414A	Portable Refractometer	32

## T

T-30D	Waste Oil Drainer	15
T-4A1	Transmission Filling System	3
T-5A	Transmission Filling System	3
T-50D	Waste Oil Drainer	15
T-80AG	80L Air Gear Pump Oil Extractor / Drainer	9
T-80C	80L Waste Oil Drainer(Auto Check valve)	16
T-80CJV	80L Waste Oil Drainer / Extractor	11
T-80D	80L Waste Oil Dispenser(Auto Check valve)	15

## T

T-80DT	80L Waste Oil Drainer(Auto Check valve)	16
T-80L	80L Waste Oil Drainer(Manual valve)	16
TC-1A	Master Cylinder Adaptor For Truck	36
TC-2A	Master Cylinder Adaptor For Truck	36
TC-3A	Master Cylinder Adaptor For Truck	36
TC-4A	Master Cylinder Adaptor For Truck	36
TP-3590A	Turbo System Pressure Tester 9 Pcs	29
TV-169	Manual Vacuum Dent Puller	39
TV-169A	Air Vacuum Dent Puller	39

## U

U-220	Tire Axle Drain Pan	17
U-220B	Tire Axle Drain Pan	17
UK-31	Master Cylinder Adaptor	35
UK-34	Universal Master Cylinder Adaptor	35
UK-35	Universal Master Cylinder Adaptor	35
UK-36	Universal Master Cylinder Adaptor	35
UK-37	Universal Master Cylinder Adaptor	35

## W

WH-050A	Waste Oil Drain Pan	18
WH-080A	Waste Oil Drain Pan	18
WH-108N	Foaming Spraying Gun	24
WH-109	Atomising Spray Gun	24
WH-198	Oil Quality Comparator	5
WH-202	Semi Automatic ATF Exchanger	2
WH-202A	Semi Automatic ATF Exchanger	2
WH-312	Pneumatic Oil Filter Crusher	19
WH-312A	Pneumatic Oil Filter Crusher	19
WH-312C	Oil Filter Separator With Drain Pan	19
WH-320	ATF Fitting Connectors	2
WH-320DG	ATF Adaptor Kit 8 Pcs	3
WH-320H	ATF Adaptor Kit 11 Pcs	3
WH-320HC	ATF Adaptor Kit 18 Pcs	4
WH-505	Pressure Brake Bleeder	33
WH-505A	Pressure Brake Bleeder with Air Tank	33
WH-505CA	Master Cylinder Adaptor Kit	34
WH-505CH	Master Cylinder Adaptor Kit for Motorcycle	36
WH-505CNA	Master Cylinder Adaptor Kit	34
WH-505D	Pressure Brake Bleeder	36
WH-505H	Manual Brake Fluid Bleeder	37
WH-505J	Vacuum Brake Fluid Bleeder	37
WH-505S	Stainless Pressure Brake Bleeder(SUS 340)	33
WH-505T	Pneumatic Brake Fluid Bleeder	37
WH-505V	12V Pressure Brake Fluid Bleeder	37
WH-507U	Cooling System Flushing Gun	30
WH-509	Brake Fluid Tester	38
WH-550U	Fluid Transfer Pump	7
WH-700	Electrical Parts Washer	24
WH-700MI	Mobile Parts Washer with Cleaning Brush	25
WH-700MS	Mobile Parts Washer with Cleaning Brush	25
WH-700MSA	Air Pulse Parts Cleaner	25
WH-700SA	Economic Parts Washer	25
WH-702	Brake Disk Lining Cleaning System	24
WH-707B	Air Exhaust Fume Extractor	20
WH-7292A	30L Low Profile Drain Pan	32
WH-737	Line Clamp Triple Pack	31
WH-737A	Metal Line Stopper	20
WH-737L	Angled Line Clamp	31
WH-737S	Line Clamp Triple Pack	31
WH-8560	Low Profile Coolant / Antifreeze Receiver	32
WH-9004A	Waste Oil Receiving Pan	18
WH-9004B	Waste Oil Receiving Pan	18
WH-9004BC	Waste Oil Drain Pan	18
WH-9004C	Waste Oil Receiving Pan	18
WH-9004CC	Waste Oil Drain Pan	18
WH-9004D	Waste Oil Receiving Pan	18

WH-9004E	Drain Pan with Level Scale	18
WH-9004E1	Drain Pan with Level Scale	4
WH-9004F	Drain Pan with Level Scale	18
WH-9004M	Waste Oil Receiving Pan	18
WH-9004MA	Waste Oil Receiving Pan	18
WH-933A	Transmission Filling Hose For VAG	4
WH-934A	Filter Drain Pan	3
WH-9601	Multi-Function Suction Cup	39
WH-9601J	Multi-Function Suction Cup	39
WH-9601K	Multi-Function Suction Cup	39

