

FH1004 SERIES 20 POS. FUSE HOLDER FOR BLADE (PLUG-IN) TYPE FUSES WITH CLEAR COVER

**Specifications:**

Max. Fuse Rating :	40 A
Voltage :	32 V
Position of each module:	20
Body Material :	PA66 GF 30
Cover Material :	PC

**Description :**

Original design. It is modular, so can be used by assembling each other at any size, no need any insertion part for joining each other. It is very solid and rigid when joined. It has air circulation canal to cool itself automatically. It has two receptacles places for spare fuses & one fuse puller. The fuse puller can be accessible at every time. The fuse terminals are directly connected with the fuses, there is no extra connector between fuse and fuse cables. The terminals can be used with spring clip or without spring clip. The connection flanges are asymmetric and this prevents any wrong assembling. The clear cover included. The cover canals are also asymmetric so that cover can not be connected reverse direction. The material of fuse holder is made of special thermoplastic which is resistant to heat and stroke. The clear cover made from PC. Modular power distribution and Fuse Holder is patented with its all characteristics and innovations.

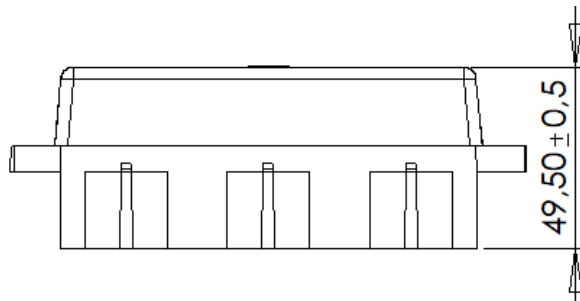
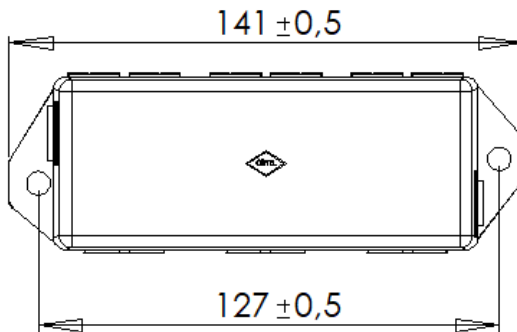
Dimensions : Dimensions are in mm**Ordering Information :**

Part Number	Packing Size
FH1004C-DK25	25 pcs. in a Carton Box

Related Products :

Blade Type Fuses
(product code: S2XXX)



Terminal
(product code: T9071-T9072)



Heavy Duty Terminal
(product code: T9071HD-T9072HD)



Fuse Puller
(product code: FH6001)