



ABOUT US

The original idea
makes design distinctive,
the function makes it work
and quality adds value

Serge Zuev

PRODUCING UNIQUE GYPSUM VENT DIFFUSERS

At Ventmann, we engineer and manufacture innovative, modern vent diffusers. And they all incorporate our first-of-its-kind patented gypsum composite, together with refined designs to complement a range of interiors. In our company, we like to say "air has never been so elegant." We hope that for your project, Ventmann vent diffusers will be your choice for air elegance.

OUR PURPOSE

Each of our products is so much more than just another vent diffuser. They are minimalist interior elements that can be integrated discreetly into any interior, or used to accentuate the precise lines and rigid angles of your design.

We work hard to create, produce and supply next generation solutions to our partners and clients. We have three values that all our products meet:

- They are innovative - our diffusers are the first on the market to be made from our special gypsum composite, so they can be frameless and fit any contemporary design. Our philosophy is that modern interiors need modern vents.
- They are sustainable - gypsum is one of the most sustainable and clean materials in use. Furthermore, we follow an environmentally-friendly production process and use ecological packaging.
- They are elegant - we want our diffusers to maintain the integrity of the interior design, completely blending in with wall and ceiling surfaces.

OUR VISION

We grow together with our partners. That is why we always ensure the highest quality standards for our products. We want our distribution partners to have full confidence when assuring their customers that Ventmann diffusers are the best choice. This commitment to partnership and quality is helping us to achieve our ambition of supplying Ventmann diffusers worldwide.

OUR PLANS FOR GROWTH AND DEVELOPMENT

In addition to continuously developing our distribution network, we are also expanding our production capacity as demand grows. We aim to add more patented diffusers as our manufacturing capabilities expand, which will help us to further grow our partner network and ensure the Ventmann brand is a great choice for partners who want to be the first in bringing innovations to the vent diffuser market.



LINE





FRAMELESS



PLASTERED - IN



PAINTABLE



The Ventmann LINE vent diffuser is an elegant and flexible interior design solution. With this model, you can create strikingly unique interior elements. Or you can make the diffusers virtually invisible. It is your choice.

The Ventmann LINE vent diffuser is available with varying numbers of slots, and in varying sizes. The SLIM version is ideal if you aim to have the diffusers virtually invisible. By contrast, you can also make the diffusers a design feature. For example, our LINE diffusers can be used as imitations to create a continuous line without any breaks.

This is a model that is engineered for practicality. These diffusers, like all of our models, can be painted using the same paint as the other surfaces in the room. This means there are no frames and the diffusers are seamlessly and elegantly integrated. The connections used are simple and unobtrusive, and our LINE model does not require lowering of the ceiling height.

The Ventmann LINE vent diffuser is also versatile. It can be adapted in a range of different ways to suit your project's needs. Our standard LINE vent diffuser is available:

- In 1-slot, 2-slot or 3-slot versions
- In standard lengths of 625mm, 1000mm and 1250mm
- With slot widths of either 12mm or 18mm.

If your project requires non-standard solutions or specific dimensions, we are happy to help.

To see just how easy it is to install the Ventmann LINE vent diffuser, have a look at our product showcase video.

And our catalogue contains all of the technical information about this model, so you can explore all of its possibilities and see how it would fit with your project.



LINE



CIRCLE



SQUARE



SIDE



ART



SKU LIST



Installation:
video instructions
 **YouTube**



Download a digital
version of the catalog
 **Download**

LINE 1/12

SLOT DIFFUSER

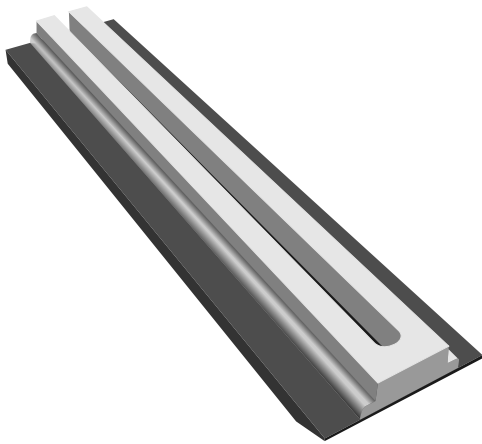

1
AMOUNT OF SLOTS

12 mm
WIDTH OF SLOT

2.5 kg
1 M. LENGTH DIFFUSER WEIGHT
WITHOUT PACKAGING (NET)

625 / 1000 / 1250
STANDARD SLOT LENGTH (MM)

Steel punched sheet. Distributes the air supply through the diffuser.

Gypsum mix segment. Sanded, puttied, painted. Suitable for all operations in combination with surface finishing

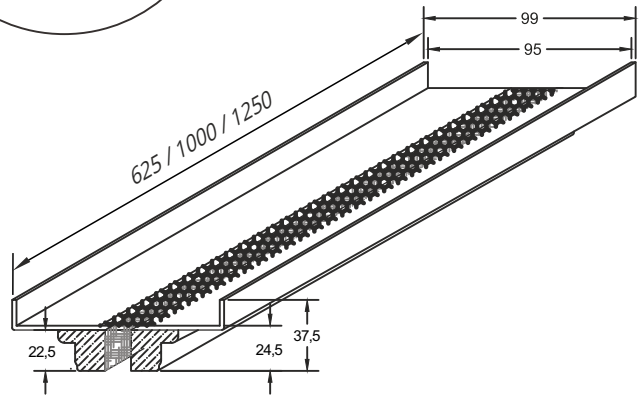
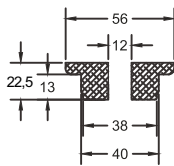
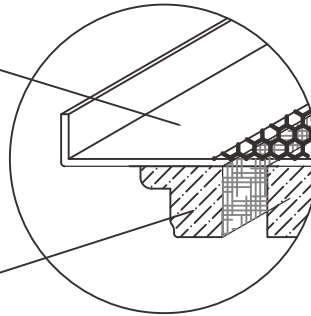

Airborne noise and resistance, 1 m.

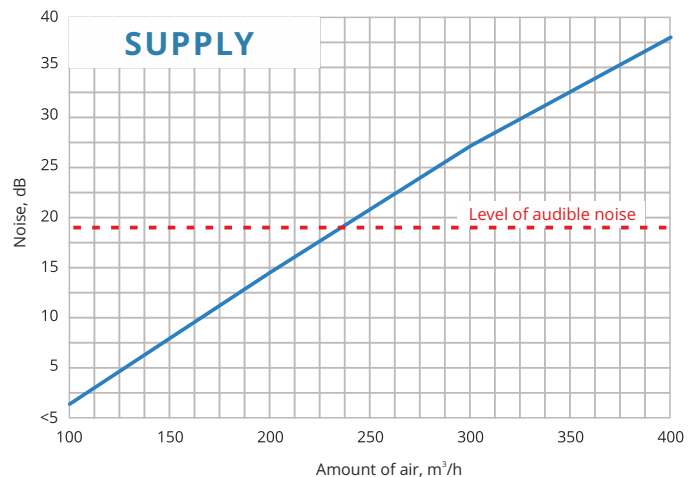
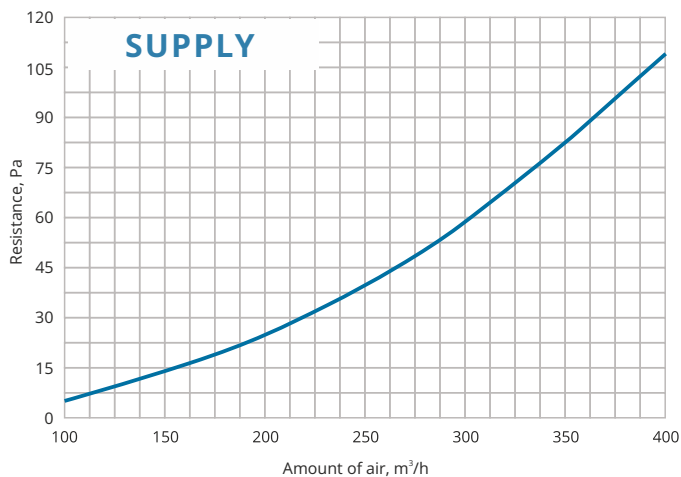

With this SLIM version of the LINE vent diffuser, the slot is 1/3 narrower. Despite this narrowing, there is virtually no loss of technical performance. This makes it a great choice for designs where the diffusers need to be subtly integrated.

PERCEPTIBLE AIRSPEED $L_{0,2}(m)$ DISTANCE

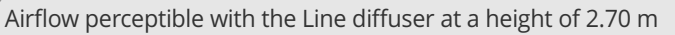

PERCEPTIBLE AIRSPEED REACH LIMIT

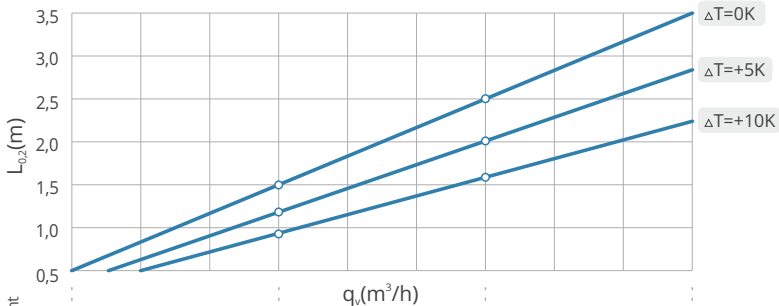

| Order code: | LINE | 625 | 1 | 12 | q _l (m³/h) | | | |
|-------------|------|------|---|----|-----------------------|----|-----|-----|
| | | | | | 35 | 40 | 45 | 50 |
| | LINE | 1000 | 1 | 12 | 60 | 70 | 80 | 90 |
| | LINE | 1250 | 1 | 12 | 75 | 88 | 102 | 115 |
| | LINE | 625 | 1 | 18 | 35 | 40 | 45 | 70 |
| | LINE | 1000 | 1 | 18 | 60 | 77 | 94 | 110 |
| | LINE | 1250 | 1 | 18 | 75 | 97 | 118 | 140 |

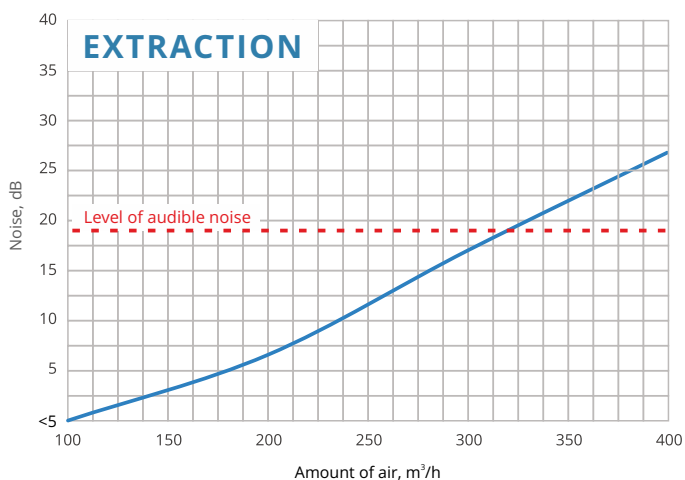
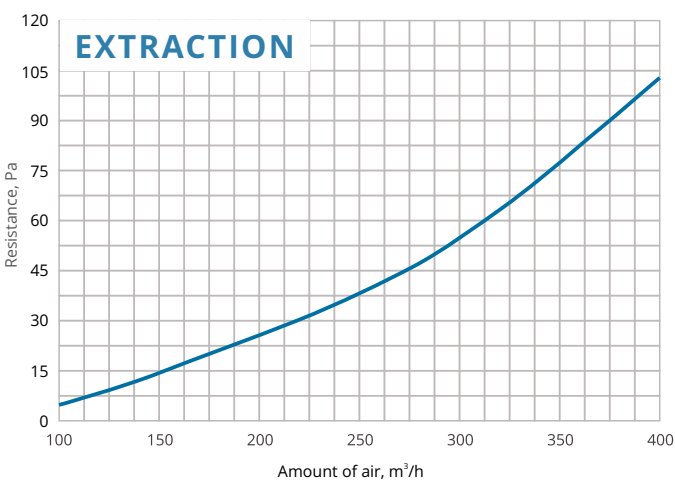

LINE 1/18

SLOT DIFFUSER + DEFLECTOR (AS OPTION)

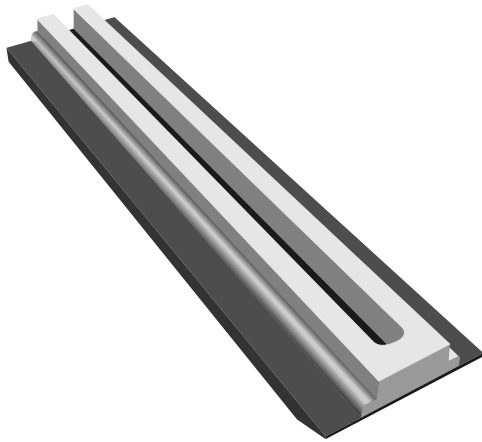

1
AMOUNT OF SLOTS

18 mm
WIDTH OF SLOT

2.5 kg
1 M. LENGTH DIFFUSER WEIGHT
WITHOUT PACKAGING (NET)

625 / 1000 / 1250
STANDARD SLOT LENGTH (MM)

OPTIONAL:
Deflector
SPECIAL CONSTRUCTION, CAN BE
ADDED ANYTIME LATER

Steel punched sheet. Distributes the air supply through the diffuser.

Gypsum mix segment. Sanded, puttied, painted. Suitable for all operations in combination with surface finishing

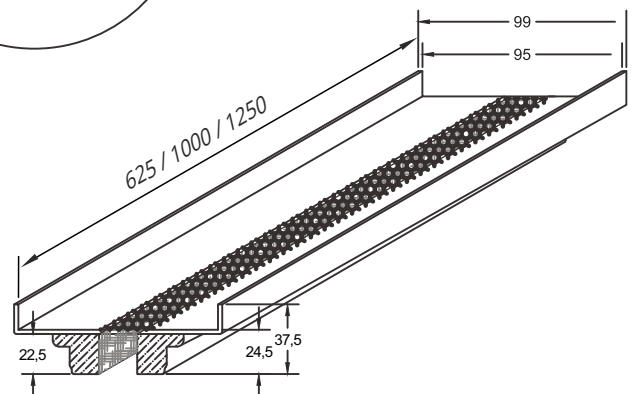
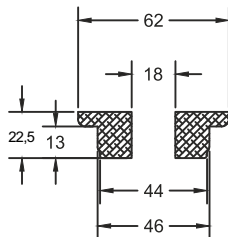

Airborne noise and resistance, 1 m.

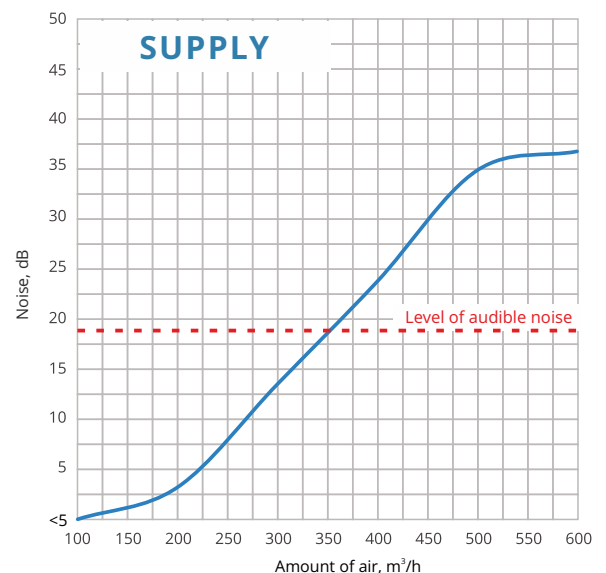
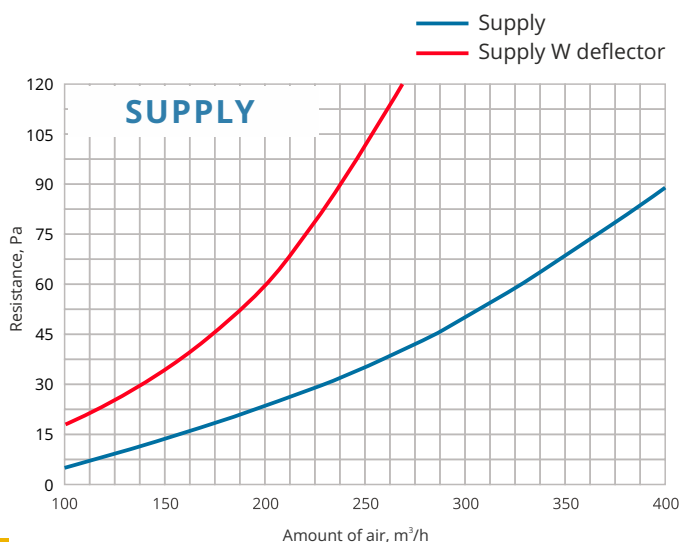

PERCEPTIBLE AIRSPEED $L_{0,2}(m)$ DISTANCE

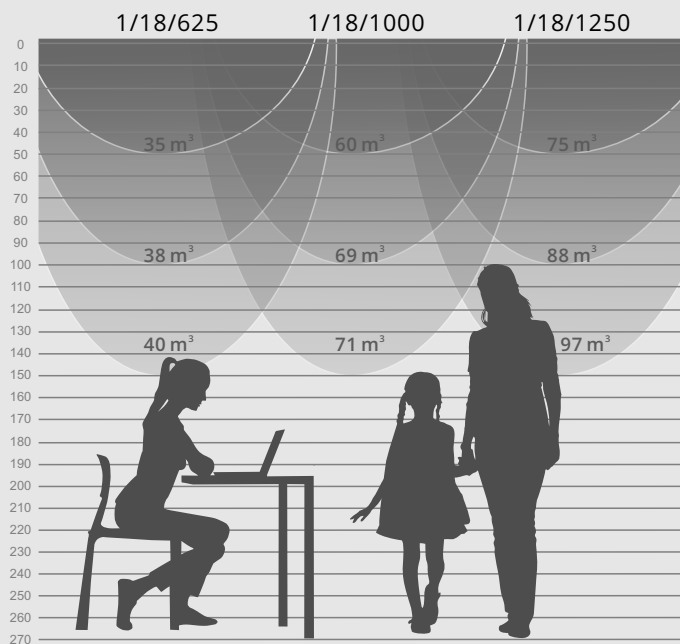

Airflow perceptible with the Line diffuser at a height of 2.70 m

AIRFLOW WITH DEFLECTOR



Airflow deflected 90° angle

PERCEPTIBLE AIRSPEED REACH LIMIT

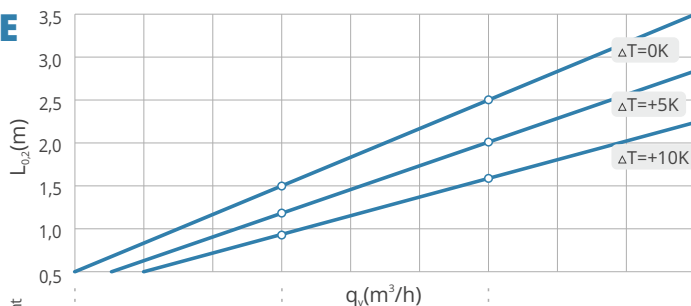

| Order code: | Slots length amount width | q _v (m³/h) | | | |
|----------------|---------------------------------|-----------------------|----|-----|-----|
| | | 35 | 40 | 45 | 50 |
| LINE 625 1 12 | | 35 | 40 | 45 | 50 |
| LINE 1000 1 12 | | 60 | 70 | 80 | 90 |
| LINE 1250 1 12 | | 75 | 88 | 102 | 115 |
| LINE 625 1 18 | | 35 | 40 | 45 | 70 |
| LINE 1000 1 18 | | 60 | 77 | 94 | 110 |
| LINE 1250 1 18 | | 75 | 97 | 118 | 140 |

The LINE diffuser with one slot creates a feeling of lightness.

It seamlessly integrates the ventilation system into any space, adding a touch of elegance and exclusivity.

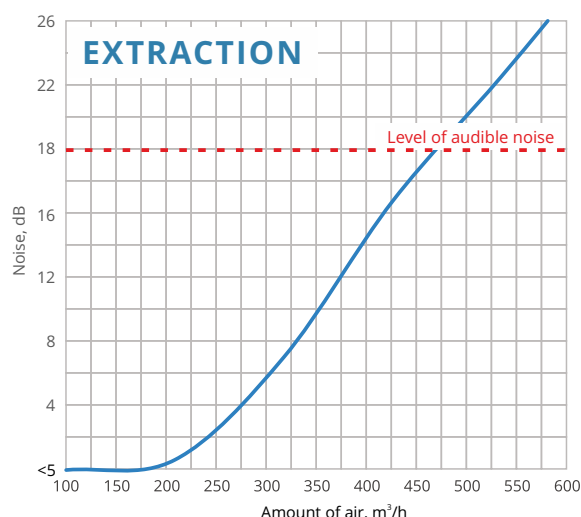
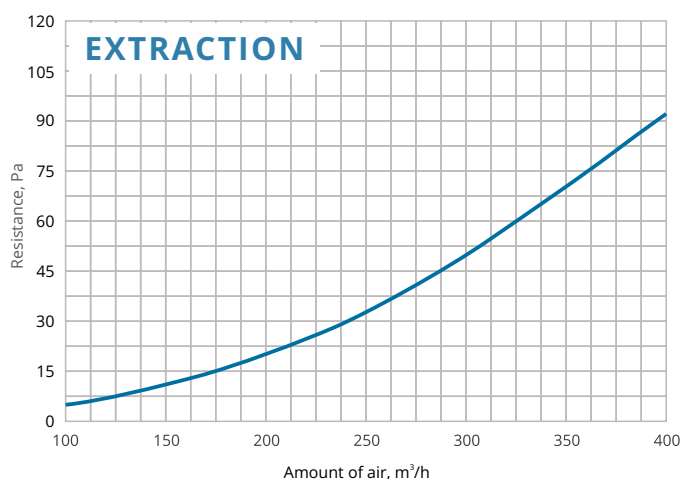

LINE 2/12

SLOT DIFFUSER

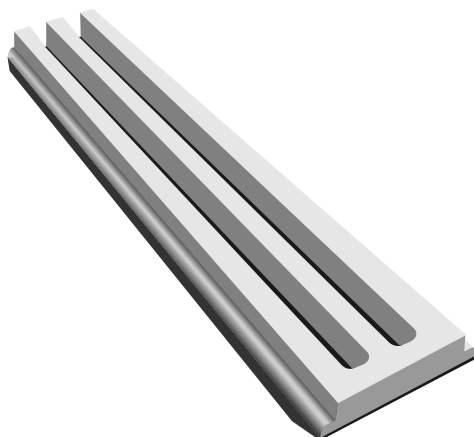

2

AMOUNT OF SLOTS

12 mm

WIDTH OF SLOT

2.735 kg

1 M. LENGTH DIFFUSER WEIGHT
WITHOUT PACKAGING (NET)

625 / 1000 / 1250

STANDARD SLOT LENGTH (MM)

Steel punched sheet. Distributes the air supply through the diffuser.

Gypsum mix segment. Sanded, puttied, painted. Suitable for all operations in combination with surface finishing

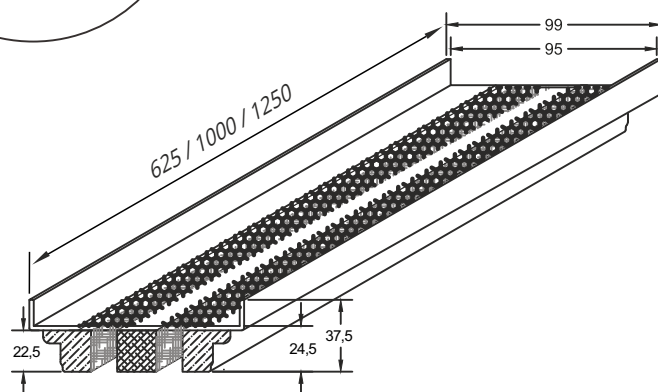
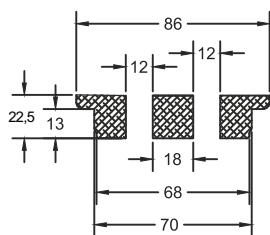
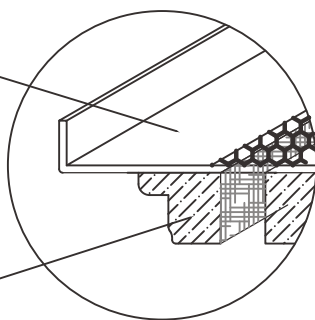

Airborne noise and resistance, 1 m.

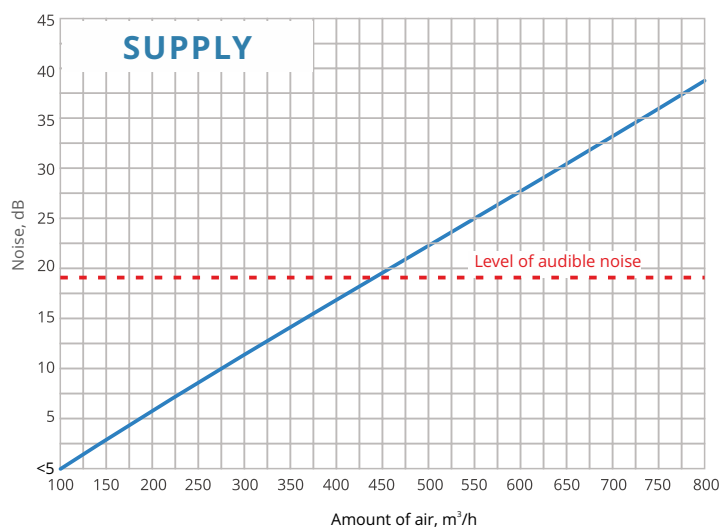
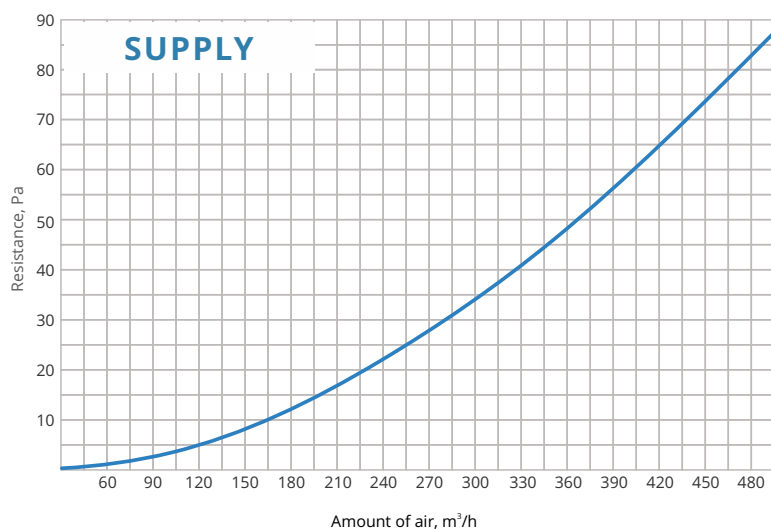

This SLIM version of the LINE vent diffuser has slots that are 30% narrower, making them less pronounced in the interior. They are easily integrated into walls and ceilings. And despite their narrower slots, they still offer good technical performance.

PERCEPTIBLE AIRSPEED $L_{0,2}(m)$ DISTANCE

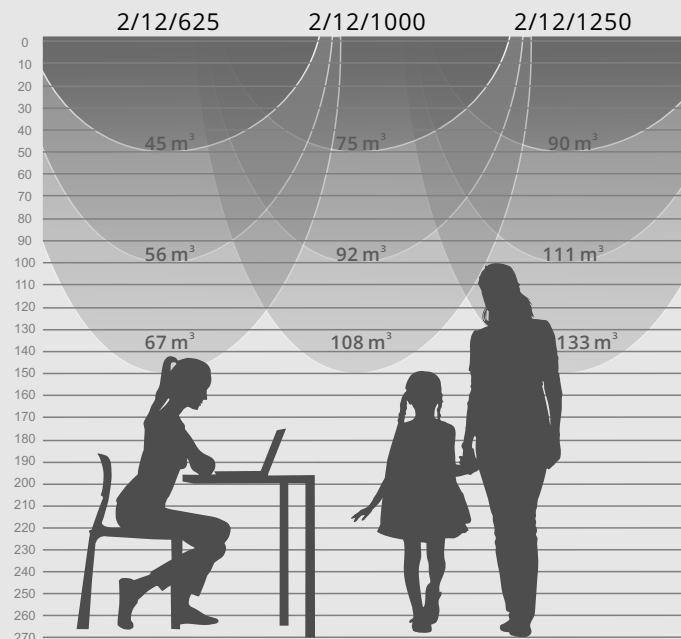

Airflow perceptible with the Line diffuser at a height of 2.70 m

PERCEPTIBLE AIRSPEED REACH LIMIT

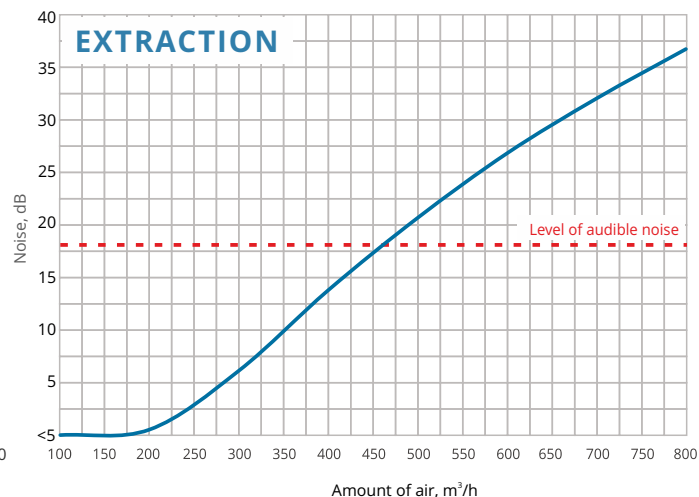
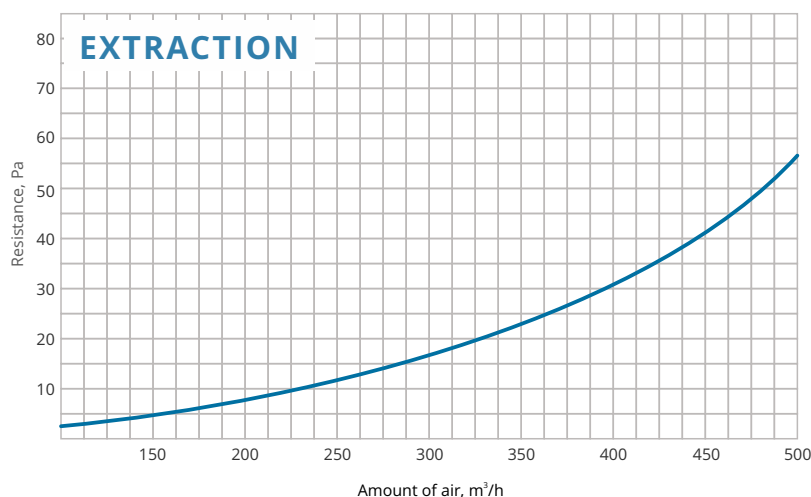
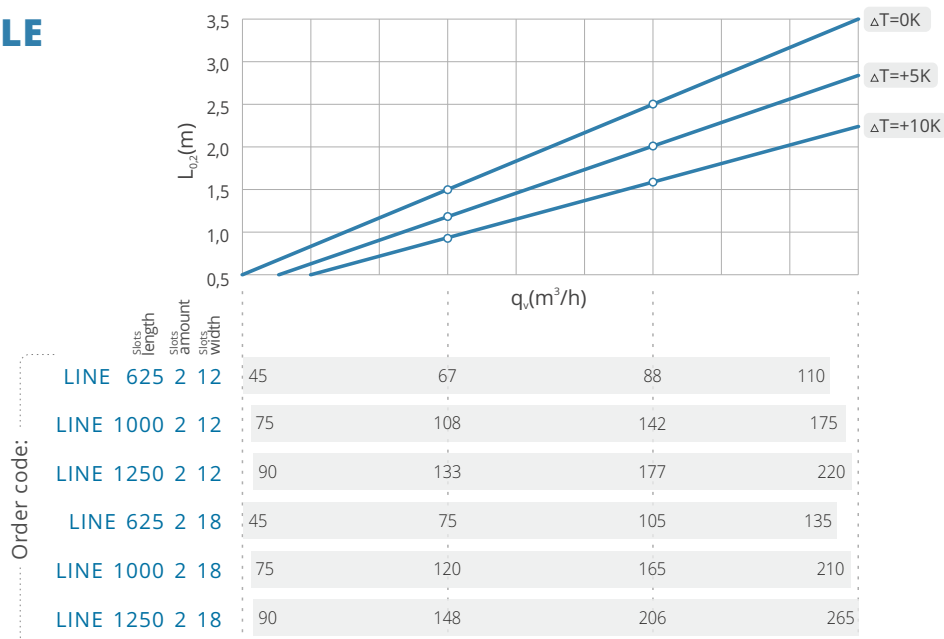

LINE 2/18

SLOT DIFFUSER + DEFLECTOR (AS OPTION)

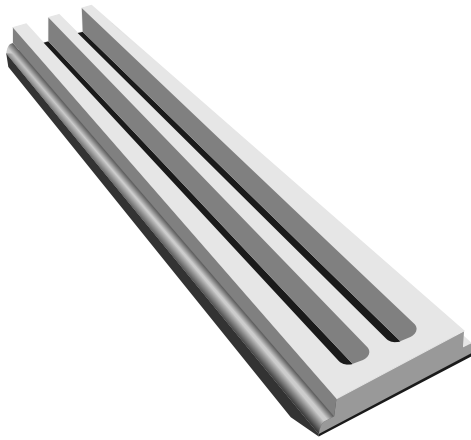

2
AMOUNT OF SLOTS

18 mm
WIDTH OF SLOT

2.735 kg
1 M. LENGTH DIFFUSER WEIGHT
WITHOUT PACKAGING (NET)

625 / 1000 / 1250
STANDARD SLOT LENGTH (MM)

OPTIONAL:
Deflector
SPECIAL CONSTRUCTION, CAN BE
ADDED ANYTIME LATER

Steel punched sheet. Distributes the air supply through the diffuser.

Gypsum mix segment. Sanded, puttied, painted. Suitable for all operations in combination with surface finishing

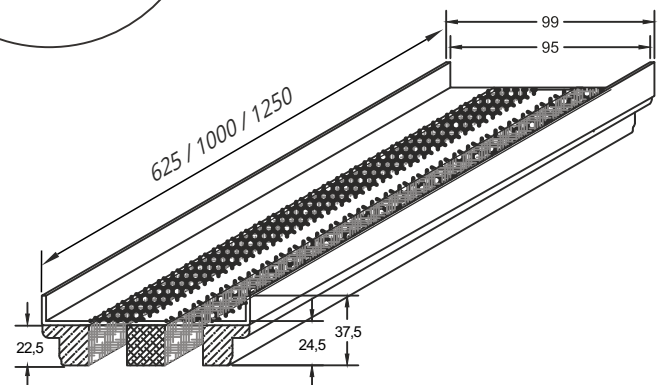
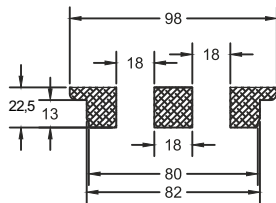
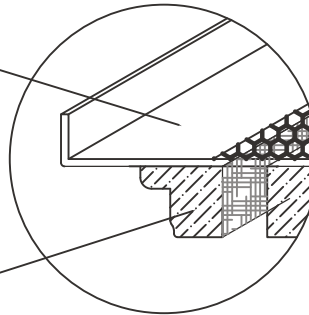

Airborne noise and resistance, 1 m.

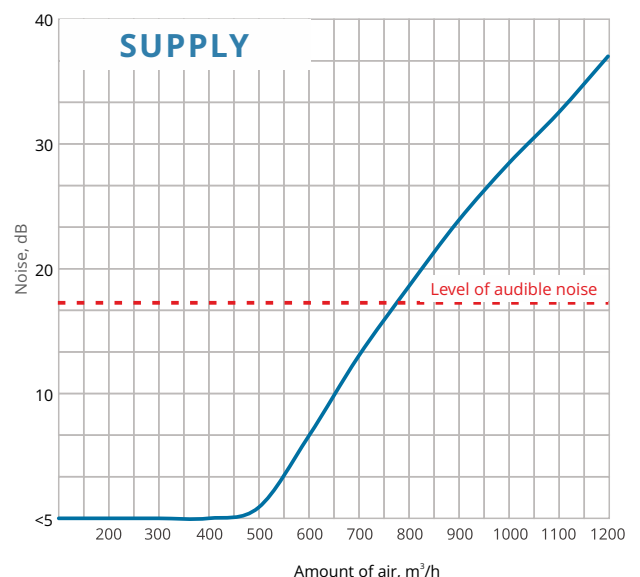
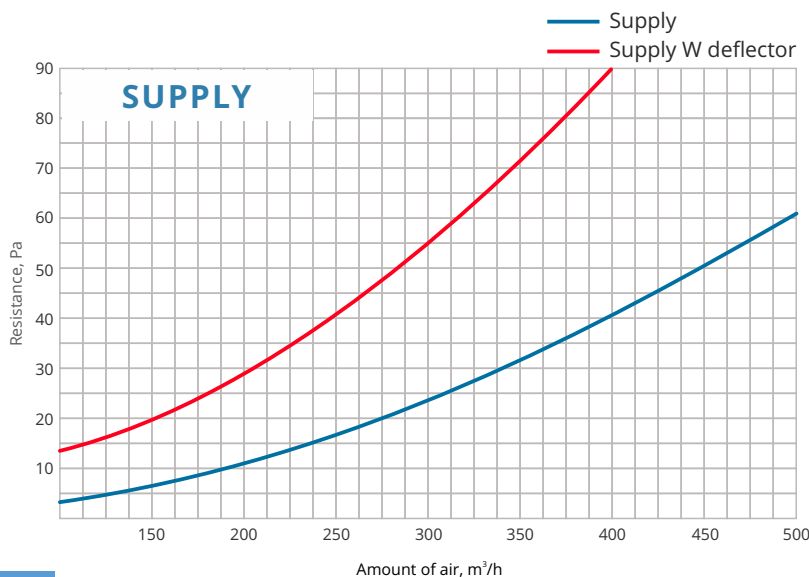

PERCEPTIBLE AIRSPEED $L_{0,2}(m)$ DISTANCE

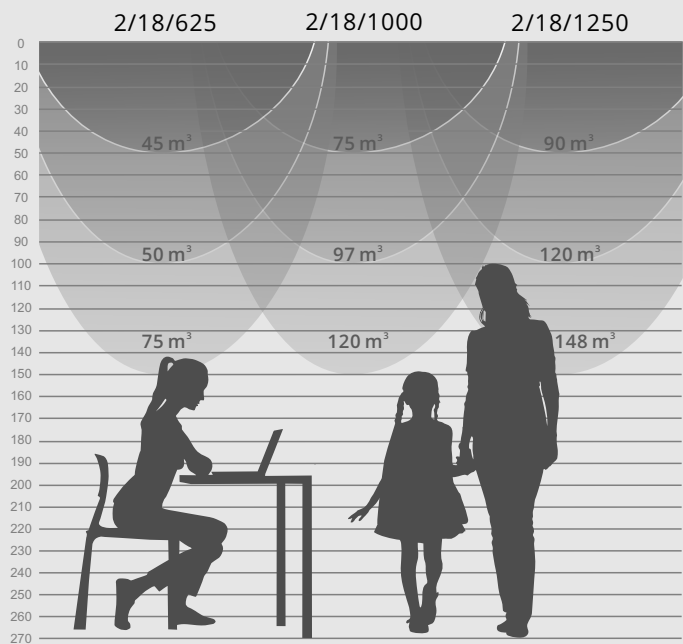

Airflow perceptible with the Line diffuser at a height of 2.70 m

AIRFLOW WITH DEFLECTOR



Airflow deflected 90° angle

PERCEPTIBLE AIRSPEED REACH LIMIT

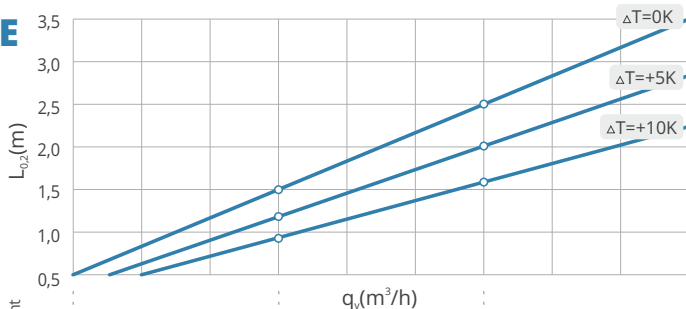

Order code:

| Order code | Line length | Slot amount | Slot width | 45 m^3 | 75 m^3 | 90 m^3 | 120 m^3 | 148 m^3 |
|----------------|-------------|-------------|------------|----------|----------|----------|-----------|-----------|
| LINE 625 2 12 | 625 | 2 | 12 | 45 | 67 | 88 | 110 | |
| LINE 1000 2 12 | 1000 | 2 | 12 | 75 | 108 | 142 | 175 | |
| LINE 1250 2 12 | 1250 | 2 | 12 | 90 | 133 | 177 | 220 | |
| LINE 625 2 18 | 625 | 2 | 18 | 45 | 75 | 105 | 135 | |
| LINE 1000 2 18 | 1000 | 2 | 18 | 75 | 120 | 165 | 210 | |
| LINE 1250 2 18 | 1250 | 2 | 18 | 90 | 148 | 206 | 265 | |

This two-slot LINE diffuser integrates well into both walls and ceilings. It can suit both very large and very small interiors, and is suitable for supplying or exhausting indoor air.

EXTRACTION

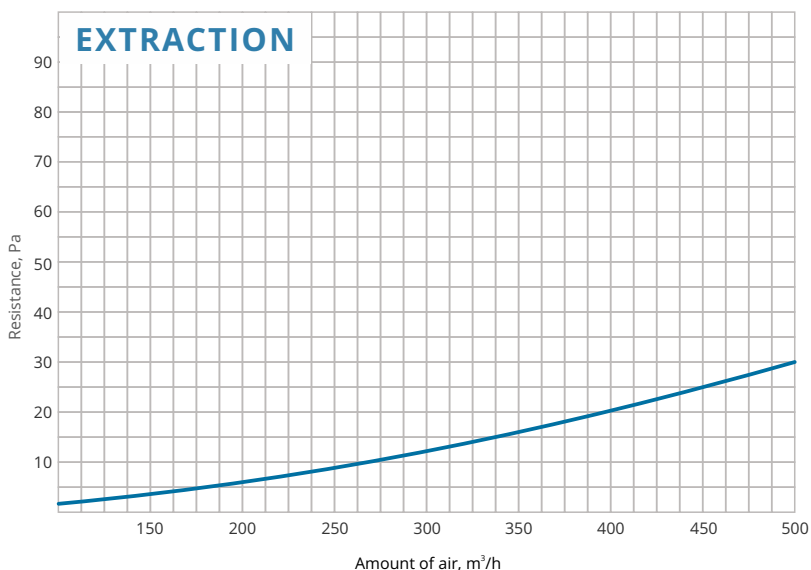

EXTRACTION

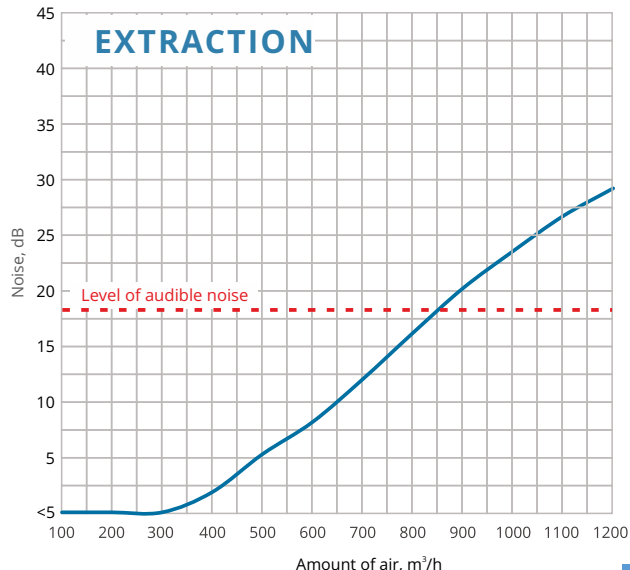

STANDARD ACOUSTIC BOXES GOOD TO GO

Order code:

GTG 75 625

Hole diameter Box length

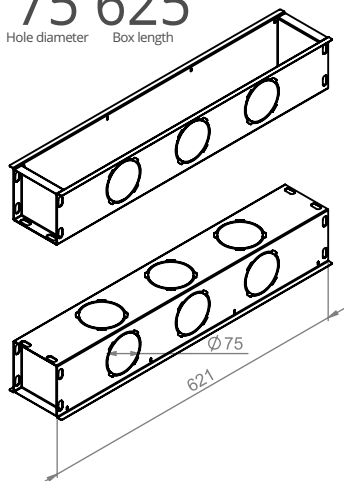

Order code:

GTG 75 1000

Hole diameter Box length

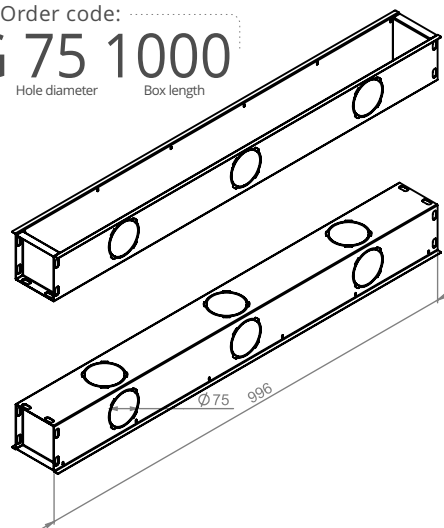

Order code:

GTG 125 625

Hole diameter Box length

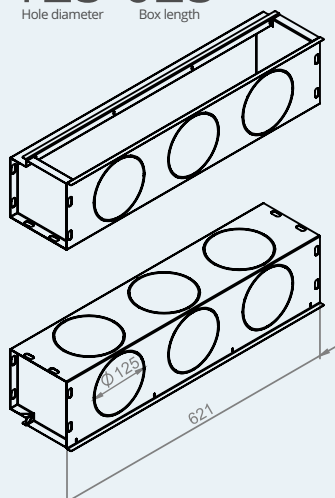

Order code:

GTG 125 1000

Hole diameter Box length

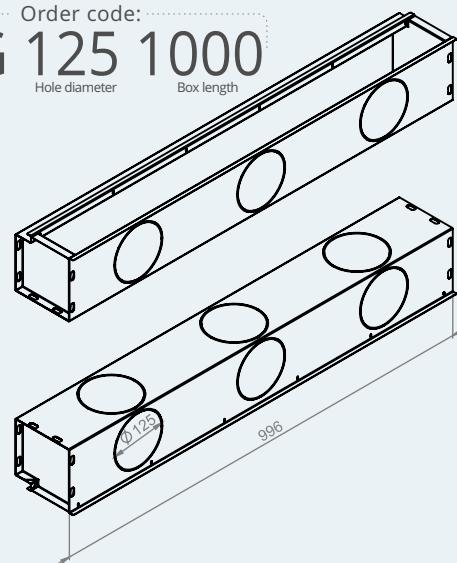

Order code:

GTG 160 625

Hole diameter Box length

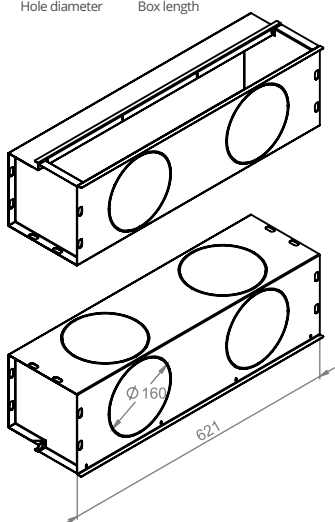

Order code:

GTG 160 1000

Hole diameter Box length

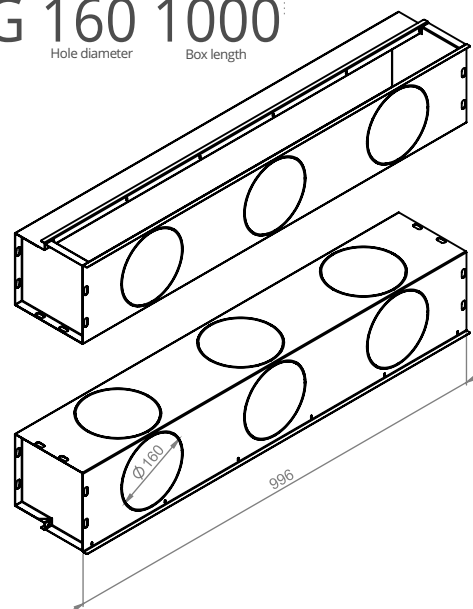

SUITABLE FOR LINE DIFFUSERS: 1/12, 1/18, 2/12, 2,18

The junction boxes can be ordered with individual dimensions, the order sheet is at the end of the catalogue.

Order code:
GTG 75 1250

Hole diameter Box length

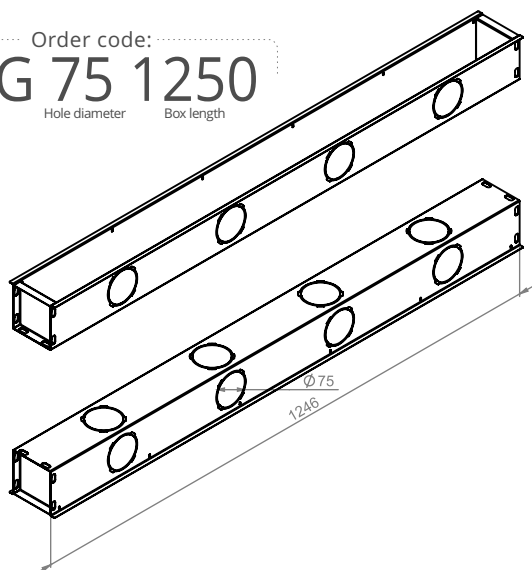

Order code:
GTG 75

Hole diameter

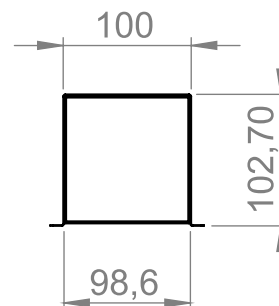

Order code:
GTG 125 1250

Hole diameter Box length

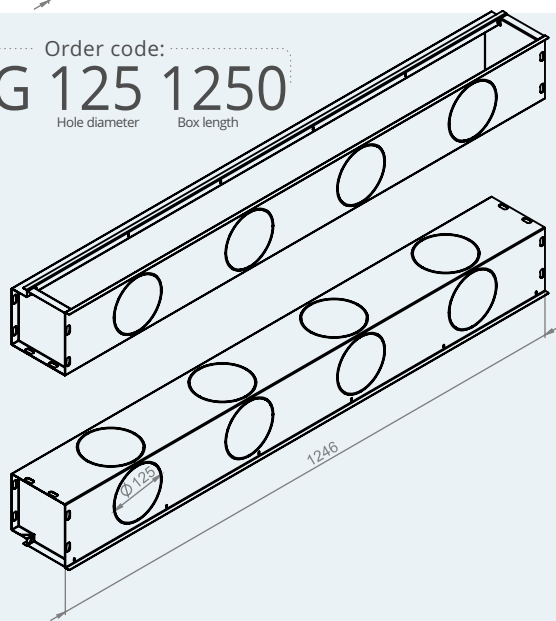

Order code:
GTG 125

Hole diameter

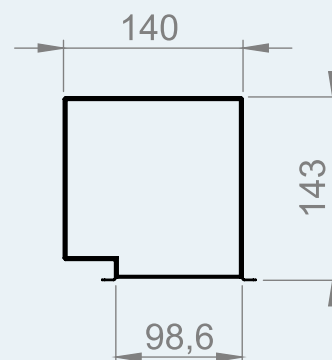

Order code:
GTG 160 1250

Hole diameter Box length

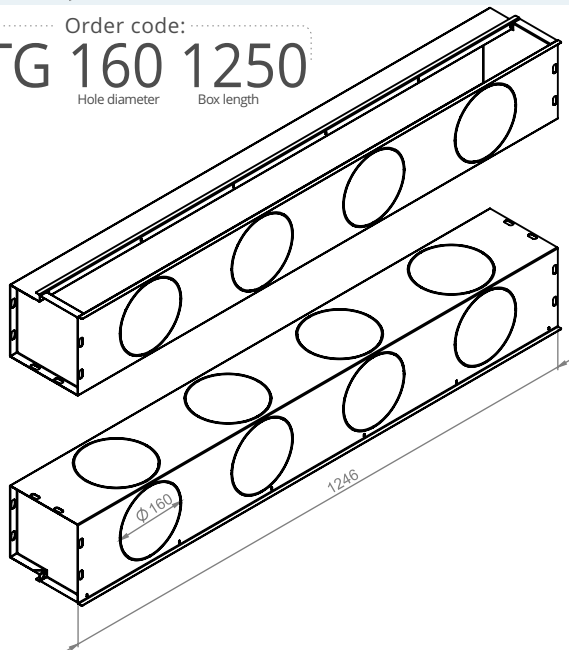

Order code:
GTG 160

Hole diameter

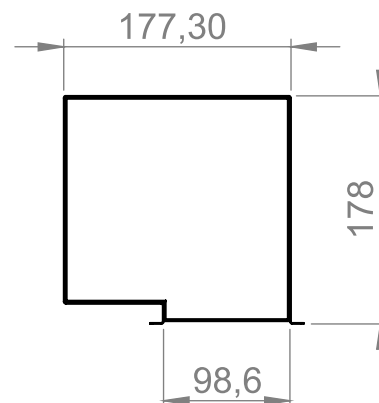

LINE 3/12

SLOT DIFFUSER

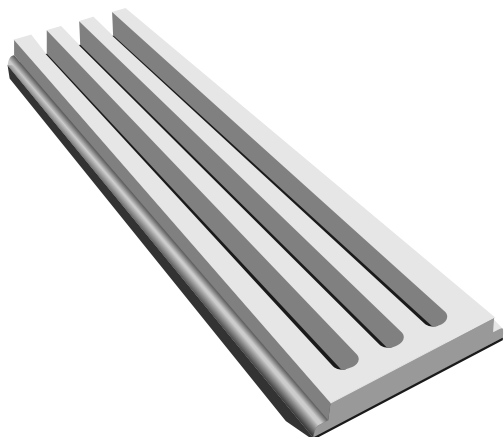

3
AMOUNT OF SLOTS

12 mm
WIDTH OF SLOT

4.085 kg
1 M. LENGTH DIFFUSER WEIGHT
WITHOUT PACKAGING (NET)

625 / 1000 / 1250
STANDARD SLOT LENGTH (MM)

Steel punched sheet. Distributes the air supply through the diffuser.

Gypsum mix segment. Sanded, puttied, painted. Suitable for all operations in combination with surface finishing

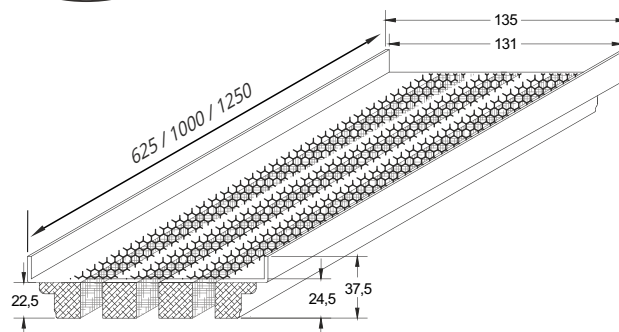
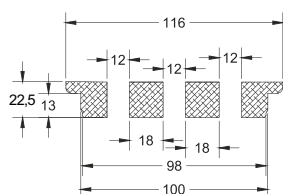
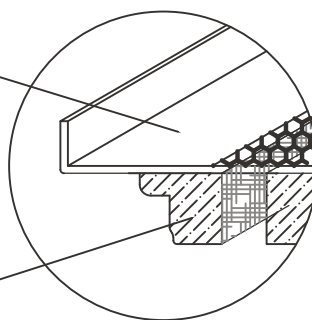

Airborne noise and resistance, 1 m.

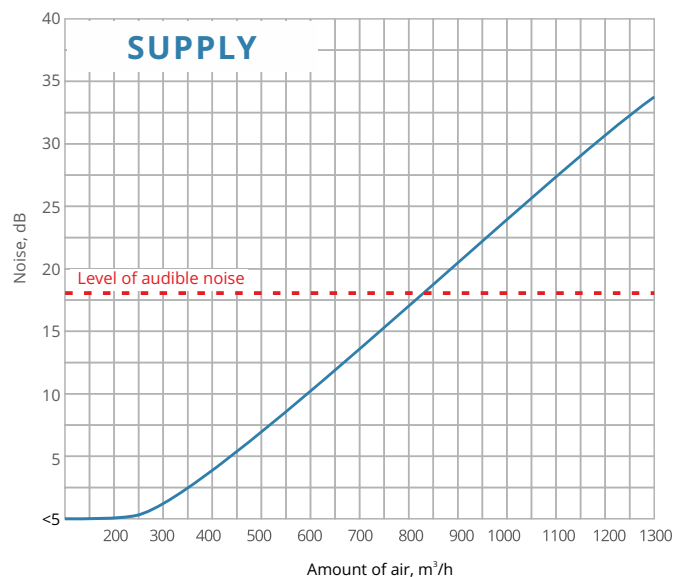
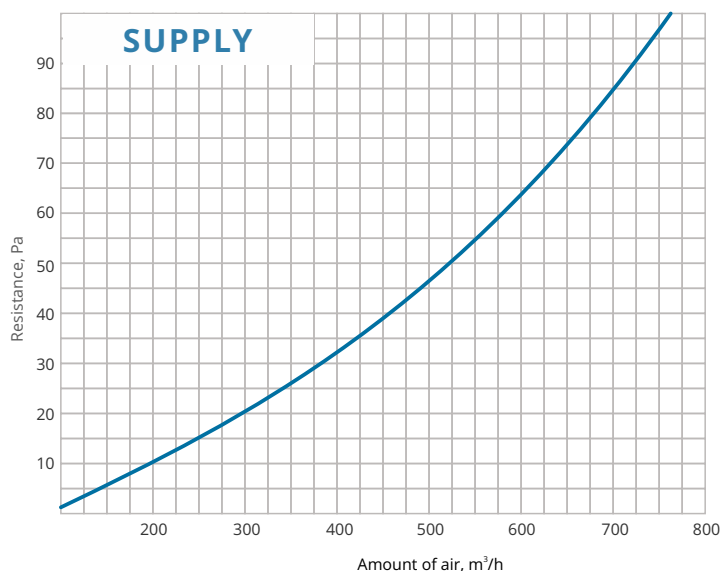

This SLIM version of the LINE vent diffuser is characterised by lightness and elegance. It combines strong technical performance with subtlety and discretion, with no extra noise produced.

PERCEPTIBLE AIRSPEED $L_{0,2}(m)$ DISTANCE

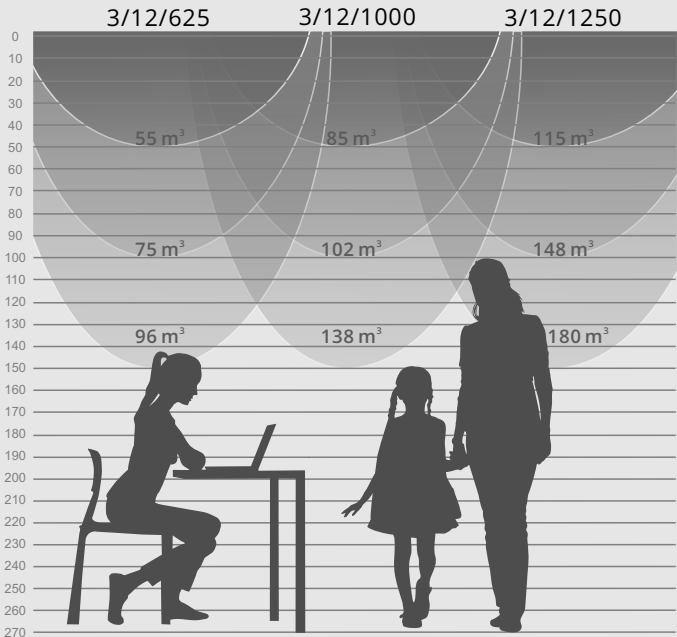

Airflow perceptible with the Line diffuser at a height of 2.70 m

PERCEPTIBLE AIRSPEED REACH LIMIT

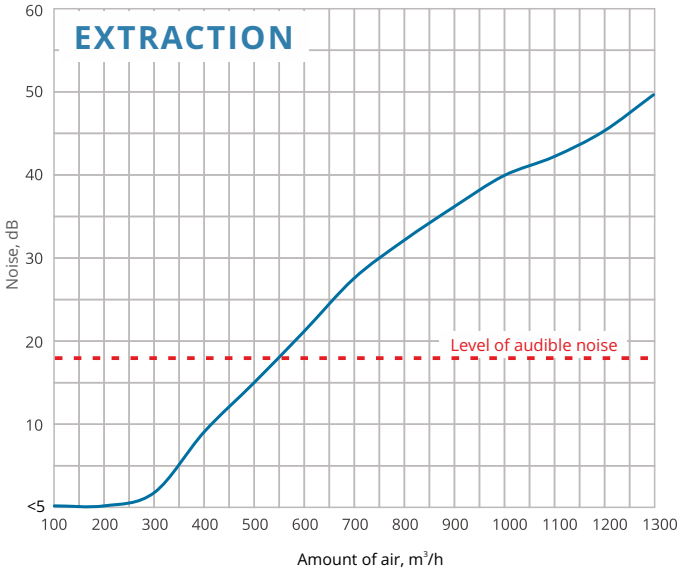
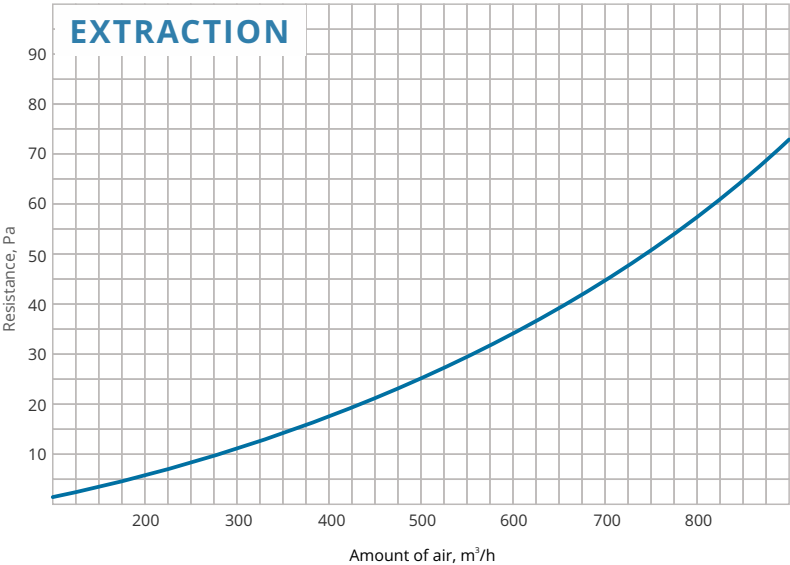
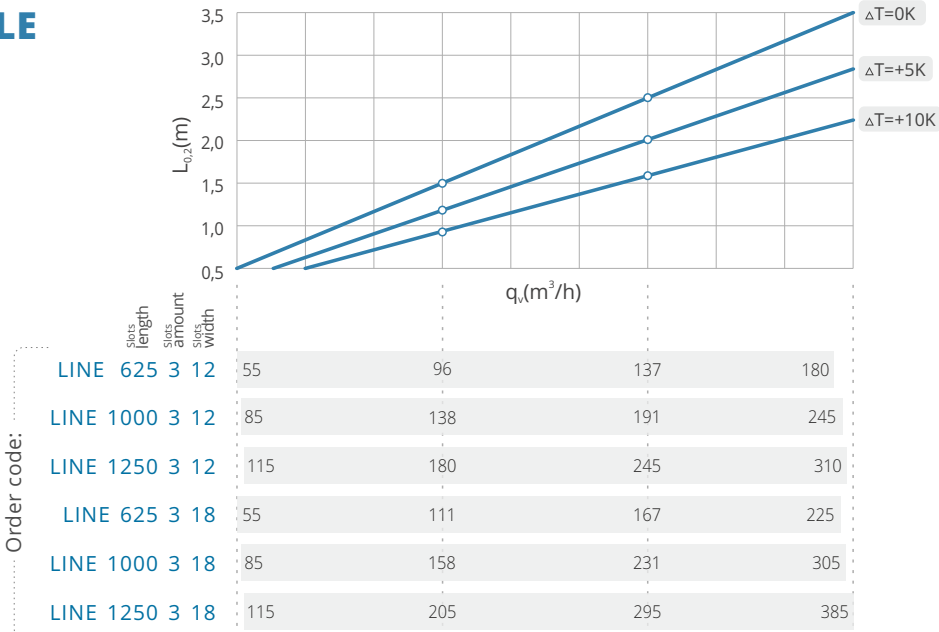

LINE 3/18

SLOT DIFFUSER + DEFLECTOR (AS OPTION)

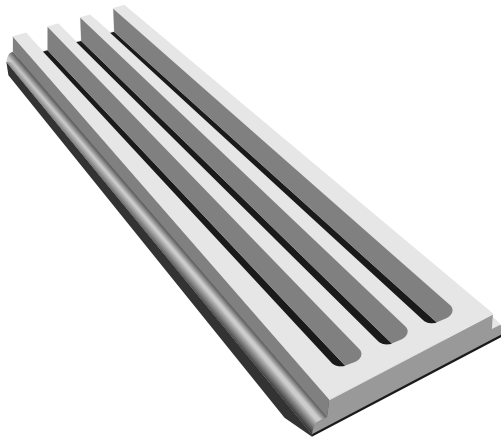

3
AMOUNT OF SLOTS

18 mm
WIDTH OF SLOT

4.085 kg
1 M. LENGTH DIFFUSER WEIGHT WITHOUT
PACKAGING (NET)

625 / 1000 / 1250
STANDARD SLOT LENGTH (MM)

OPTIONAL:
Deflector
SPECIAL CONSTRUCTION, CAN BE
ADDED ANYTIME LATER

Steel punched sheet. Distributes the air supply
through the diffuser.

Gypsum mix segment. Sanded, puttied,
painted. Suitable for all operations in
combination with surface finishing

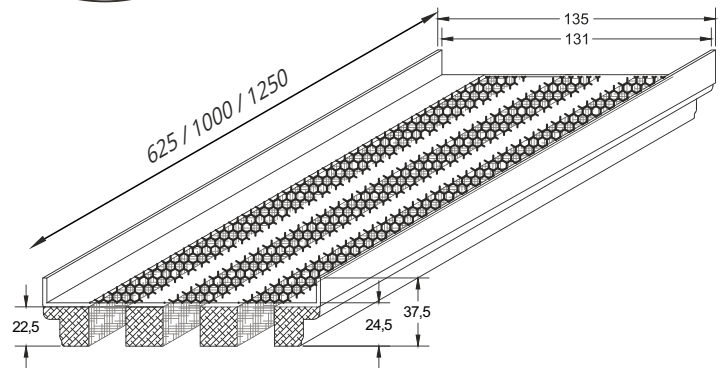
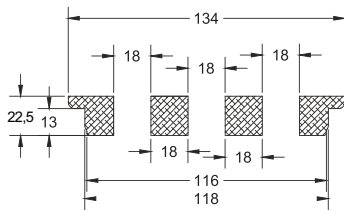
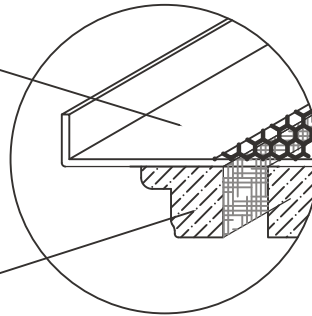

Airborne noise and resistance, 1 m.

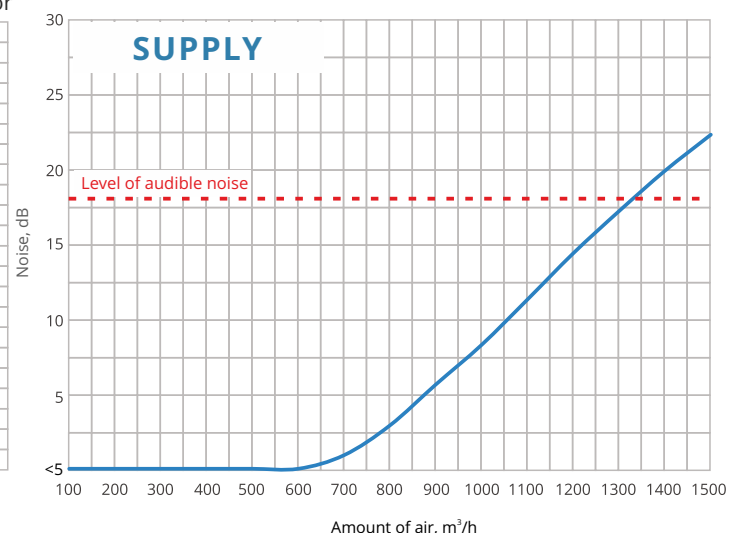
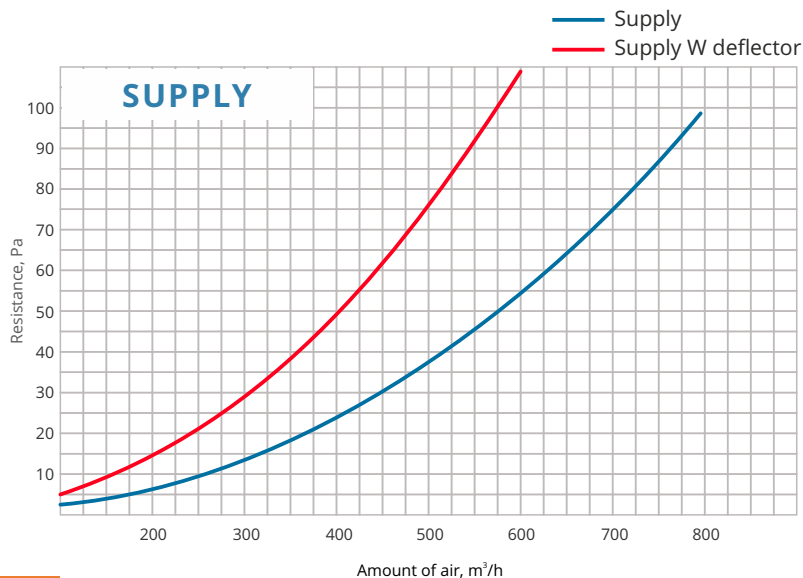

PERCEPTIBLE AIRSPEED $L_{0,2}(m)$ DISTANCE

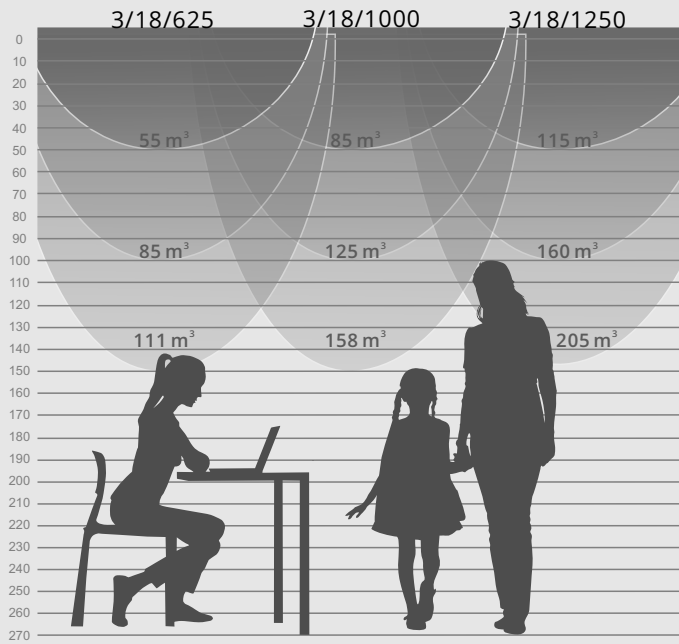

Airflow perceptible with the Line diffuser at a height of 2.70 m

AIRFLOW WITH DEFLECTOR



Airflow deflected 90° angle

PERCEPTIBLE AIRSPEED REACH LIMIT

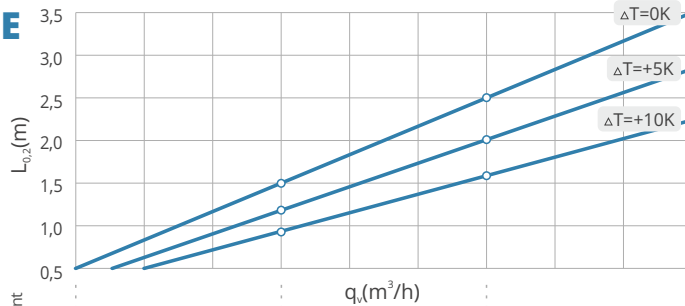

Order code:

| LINE | slots length | slots amount | slots width | 55 | 96 | 137 | 180 |
|----------------|--------------|--------------|-------------|-----|-----|-----|-----|
| LINE 625 3 12 | | | | 55 | 96 | 137 | 180 |
| LINE 1000 3 12 | | | | 85 | 138 | 191 | 245 |
| LINE 1250 3 12 | | | | 115 | 180 | 245 | 310 |
| LINE 625 3 18 | | | | 55 | 111 | 167 | 225 |
| LINE 1000 3 18 | | | | 85 | 158 | 231 | 305 |
| LINE 1250 3 18 | | | | 115 | 205 | 295 | 385 |

This three-slot LINE diffuser is extremely elegant. It has the highest capacity of any diffuser in our LINE range, making it well-suited for spaces where changing air volumes can be a real challenge.

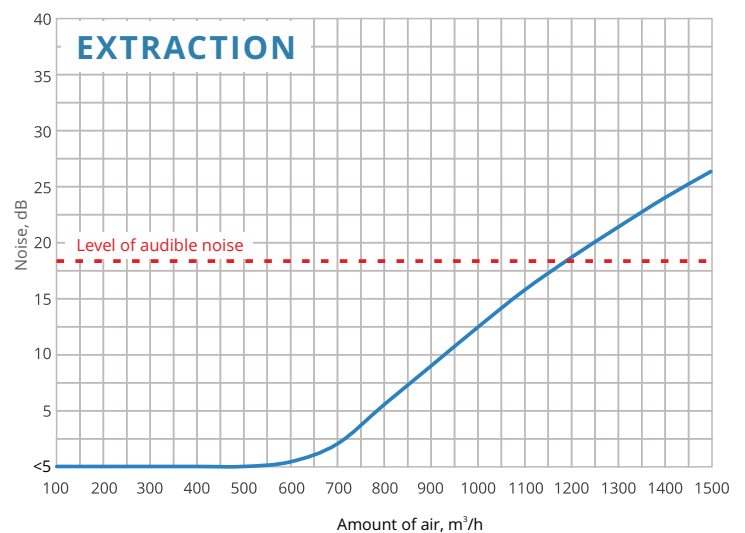
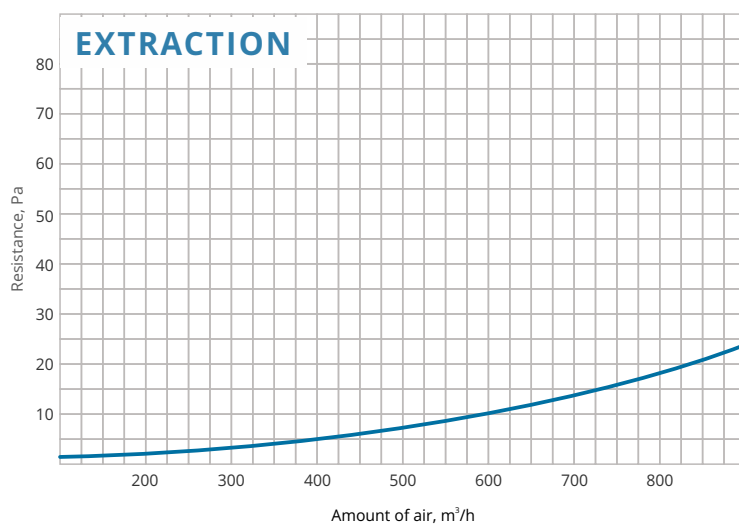

STANDARD ACOUSTIC BOXES GOOD TO GO

Order code:
GTG 3 125 625

Hole diameter

Box length

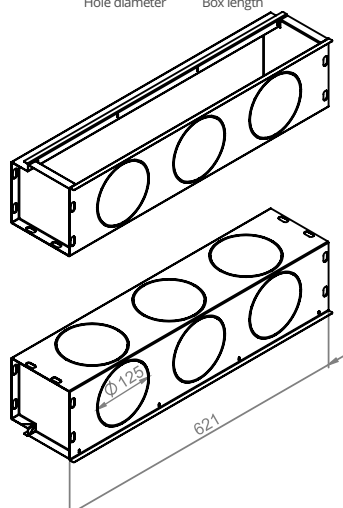

Order code:
GTG 3 125 1000

Hole diameter

Box length

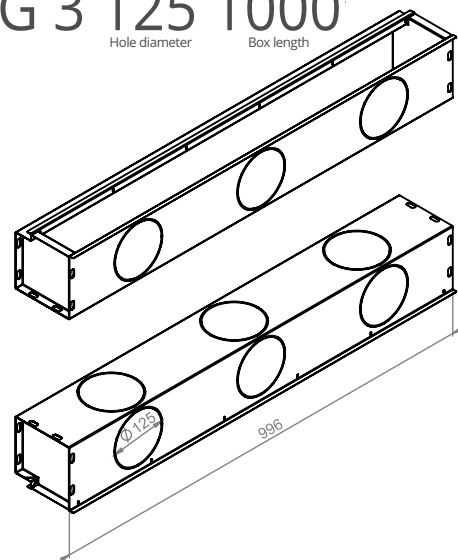

Order code:
GTG 3 160 625

Hole diameter

Box length

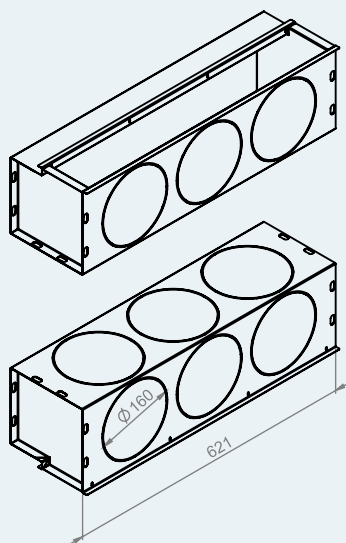

Order code:
GTG 3 160 1000

Hole diameter

Box length

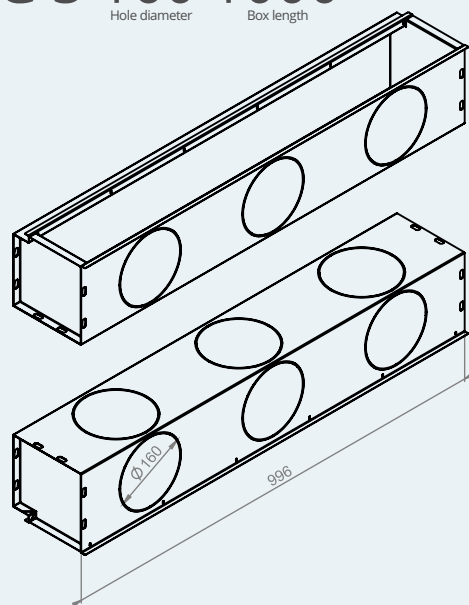

SUITABLE FOR LINE DIFFUSERS: 3/12, 3/18

The junction boxes can be ordered with individual dimensions, the order sheet is at the end of the catalogue.

Order code:
GTG 3 125 1250

Hole diameter

Box length

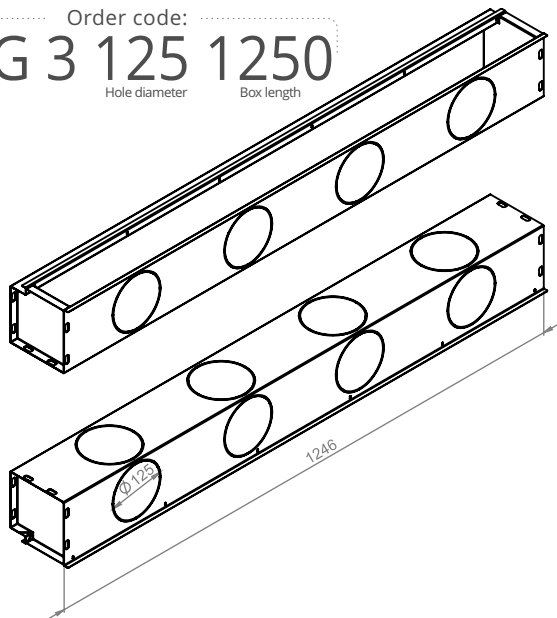

Order code:
GTG 3 125

Hole diameter

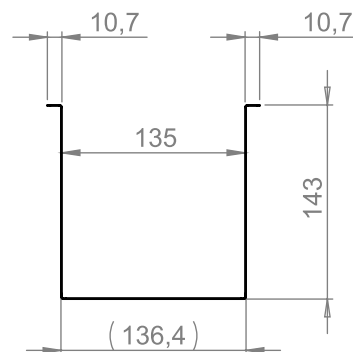

Order code:
GTG 3 160 1250

Hole diameter

Box length

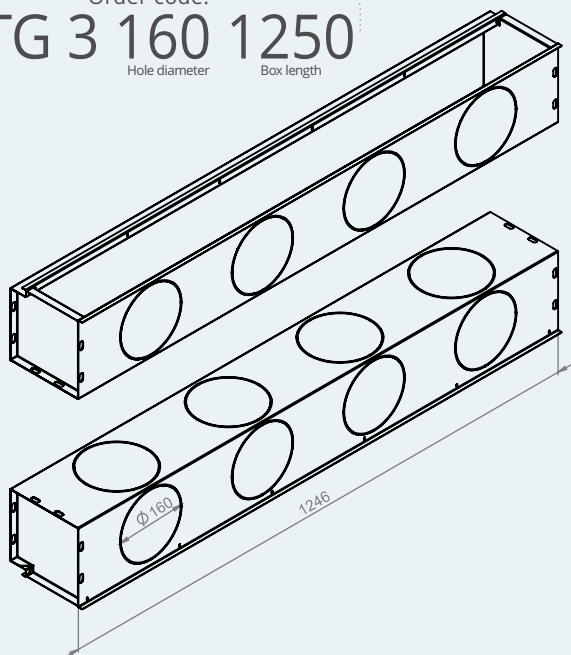

Order code:
GTG 3 160

Hole diameter

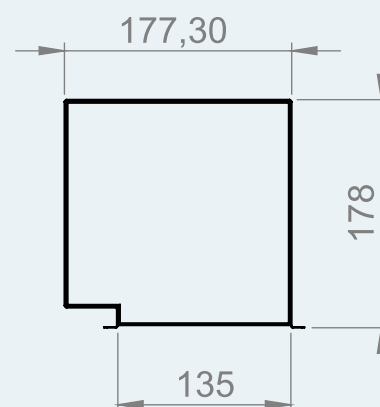

CIRCLE





FRAMELESS



PLASTERED - IN



PAINTABLE



The Ventmann Frameless CIRCLE vent diffusers is a highly versatile solution for every room type and interior design style. Its stylistic dexterity and ability to blend in perfectly with the environment make it our most popular model.

Like all Ventmann vent diffusers, every version of the CIRCLE model can be plastered together with the wall or the ceiling, and the same paint can be applied. This enables a new level of elegance and seamless integration for our ventilation systems.

Our standard CIRCLE model is available with a variety of connection nozzle sizes:

- the smallest connection nozzle diameters available are 100mm or 125mm.
- the mid-sized option for connection nozzle diameter is 160mm.
- and the largest connection nozzle diameters available are 200mm or 250mm.

The diffuser cap is supported by our new Click system. This system makes it even easier to put the cap in place correctly. It is also more environmentally friendly and has a higher operational temperature range than the magnets previously used.

These beautiful, sleek diffusers create a stunning effect, especially when multiple units are installed in a single room.

To see for yourself, and learn more about how these diffusers are installed, you can watch our product showcase video using the QR code below.

You can also find all of the technical information on our CIRCLE vent diffusers in our catalogue.

Ventmann – your choice of air elegance.



LINE



CIRCLE



SQUARE



SIDE



ART



SKU LIST



Installation:
video instructions
 **YouTube**



Download a digital
version of the catalog
 **Download**

CIRCLE 100/125

ROUND DIFFUSER



100/125 mm

DIAMETER OF COUPLING SLEEVE

2.60 kg

WEIGHT WITHOUT PACKAGING (NET)

Order code for 100 ø:
CIRCLE 100
Hole diameter

Order code for 125 ø:
CIRCLE 125
Hole diameter

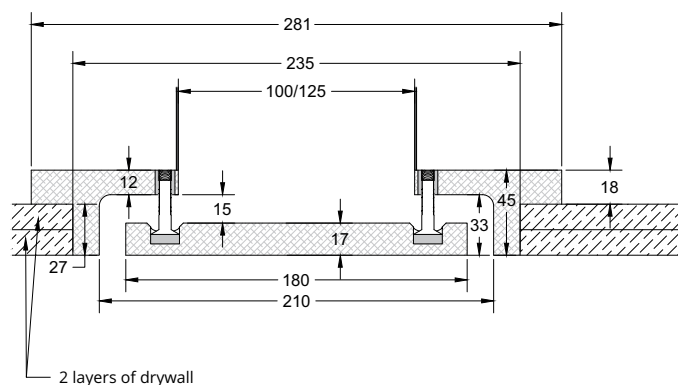
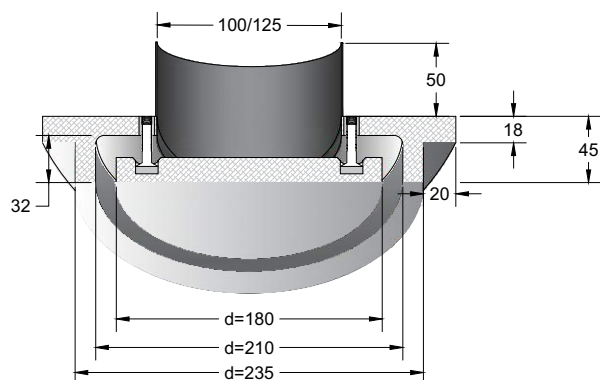

Airborne noise and resistance, 1 m.

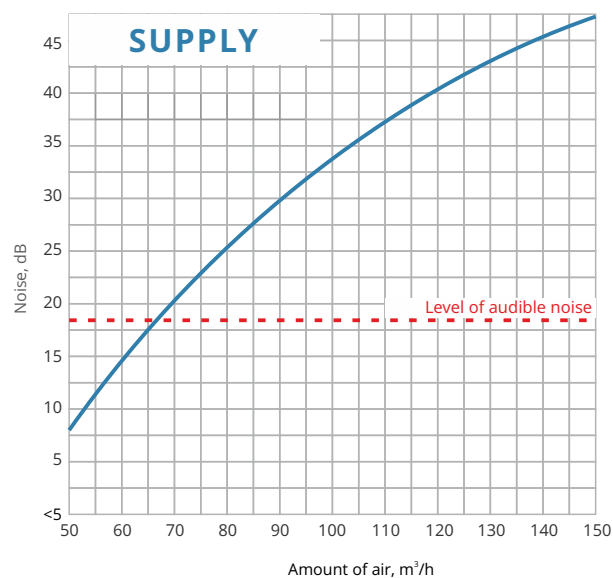
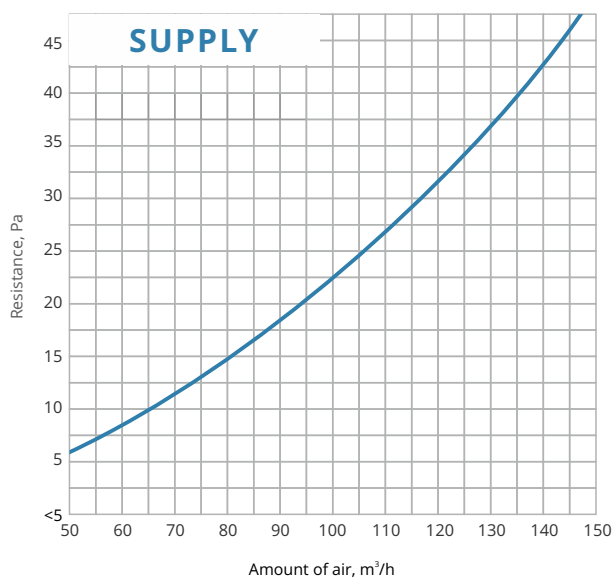

The round slot CIRCLE vent diffuser is ideally suited to a variety of room sizes. It can be used for both air supply and air extraction.

SENSIBLE AIRFLOW

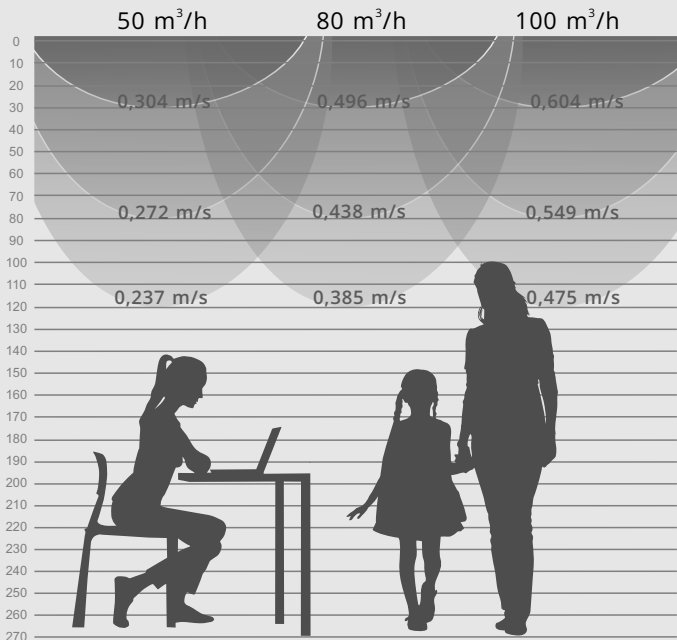

AIR VELOCITY AT DISTANCE FROM DIFFUSER

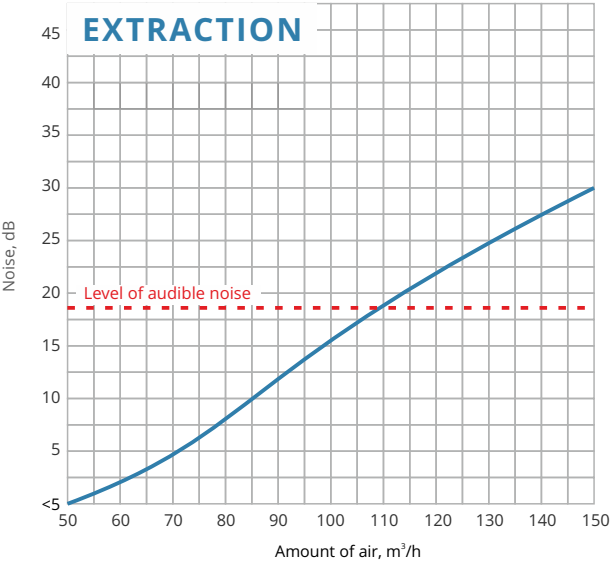
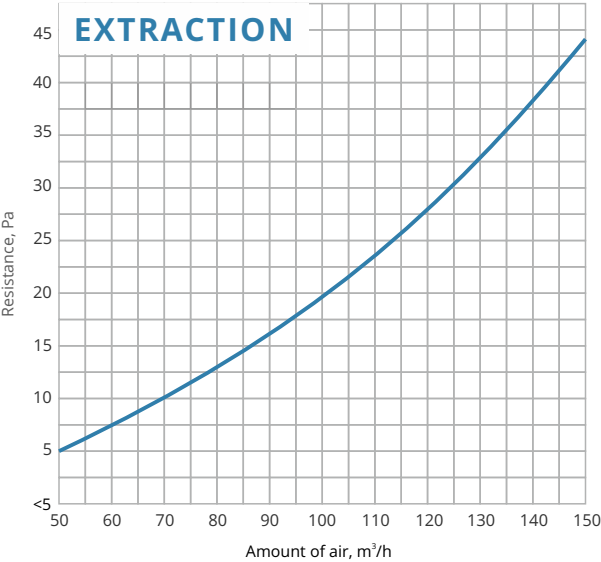
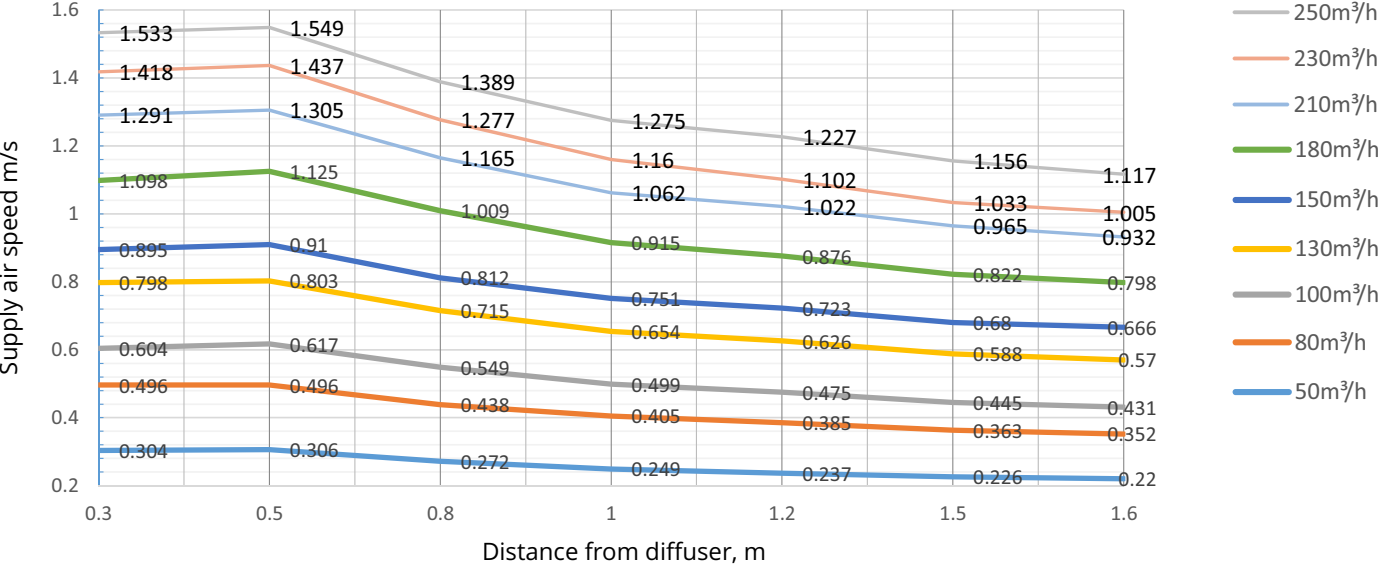

CIRCLE 160

ROUND DIFFUSER



160 mm

DIAMETER OF COUPLING SLEEVE

3.20 kg

WEIGHT WITHOUT PACKAGING (NET)

Order code:
CIRCLE 160

Hole diameter

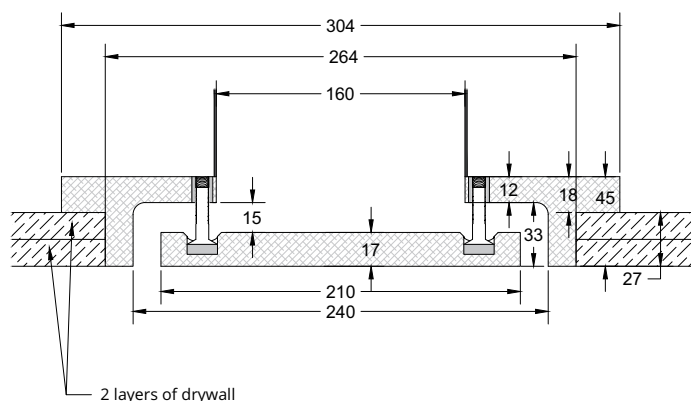
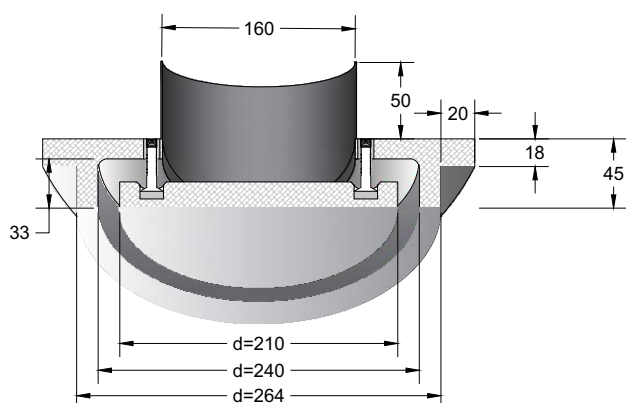

Airborne noise and resistance, 1 m.

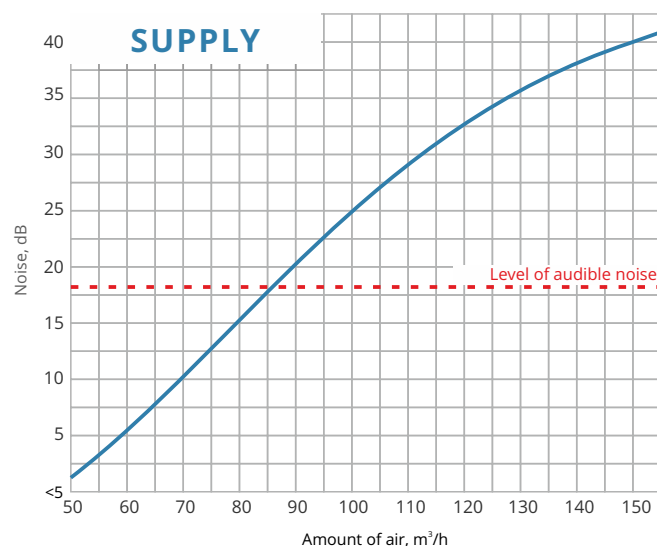
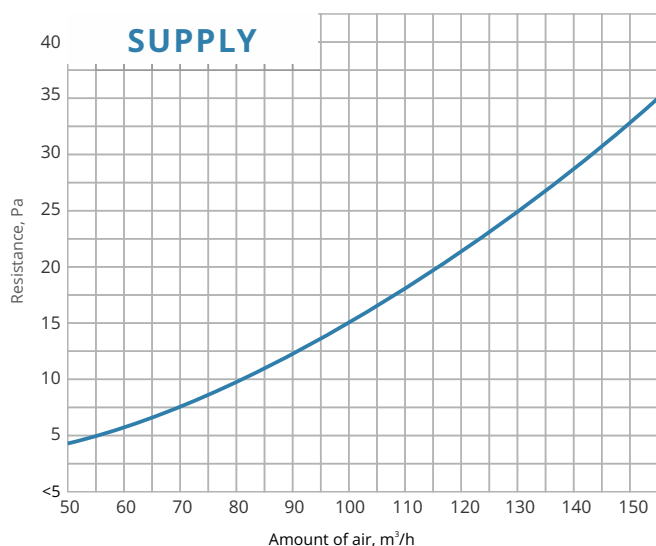

The CIRCLE vent diffuser fits well into a range of spaces and designs. With its round slots, it is suitable for air supply and air extraction purposes.

SENSIBLE AIRFLOW

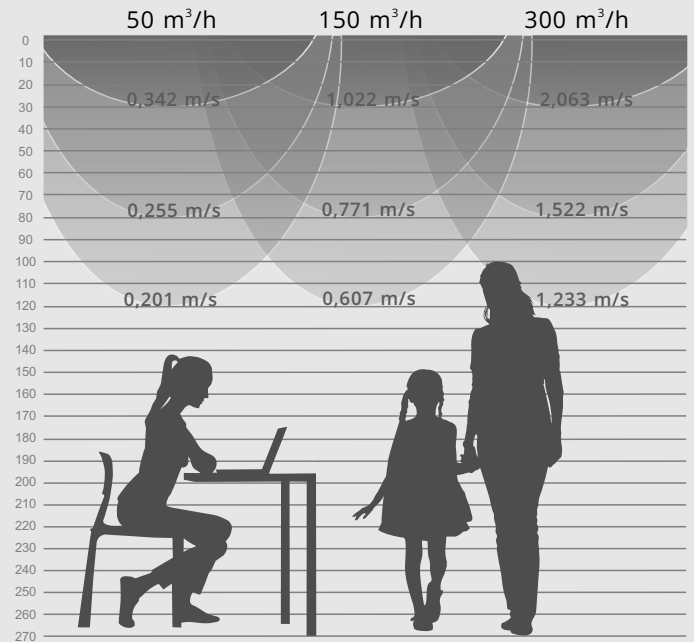

Airflow perceptible with the Circle diffuser at a height of 2.70 m

AIR VELOCITY AT DISTANCE FROM DIFFUSER

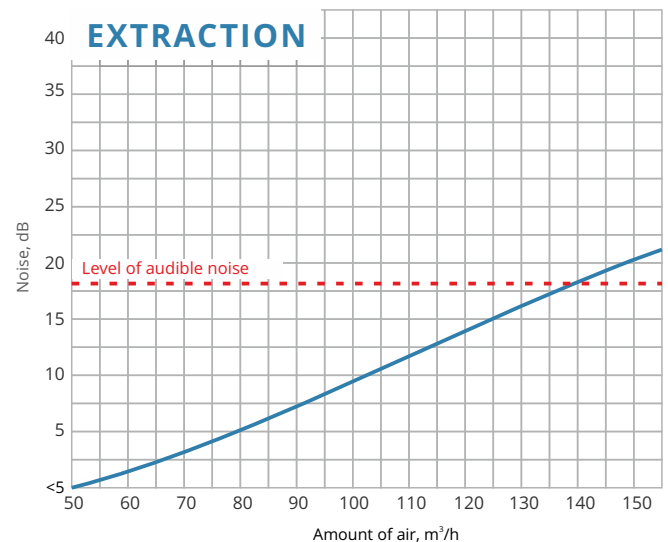
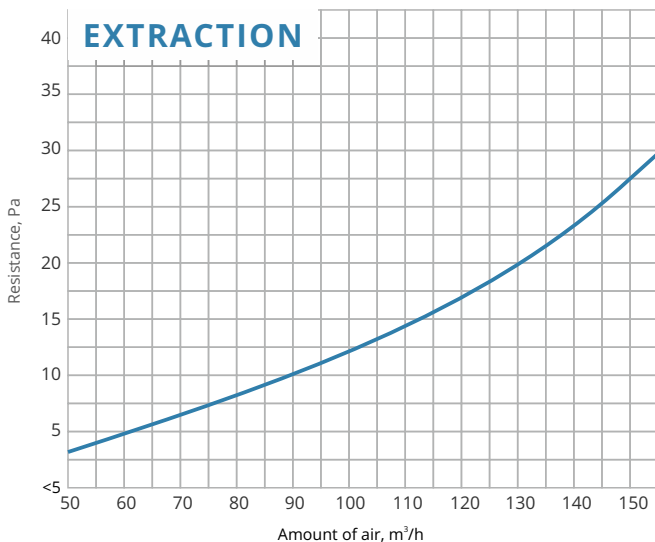
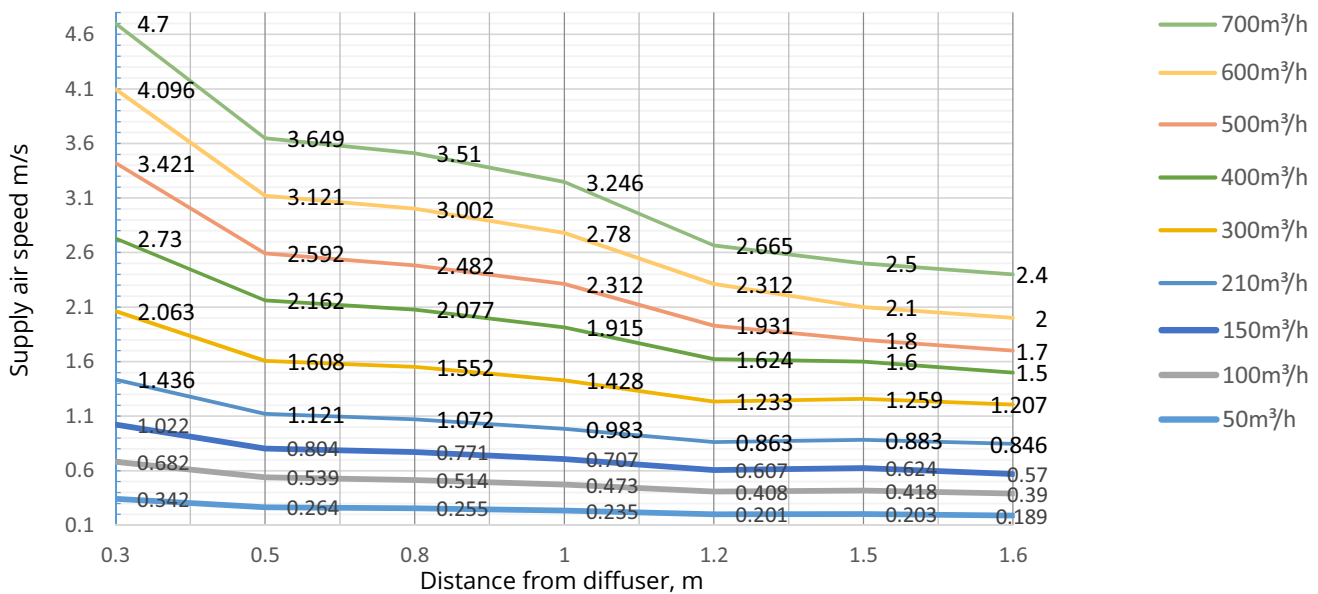

CIRCLE 200/250

ROUND DIFFUSER



200/250 mm
DIAMETER OF COUPLING SLEEVE

3.90 kg
WEIGHT WITHOUT PACKAGING (NET)

Order code for 200 ø:
CIRCLE 200
Hole diameter

Order code for 250 ø:
CIRCLE 250
Hole diameter

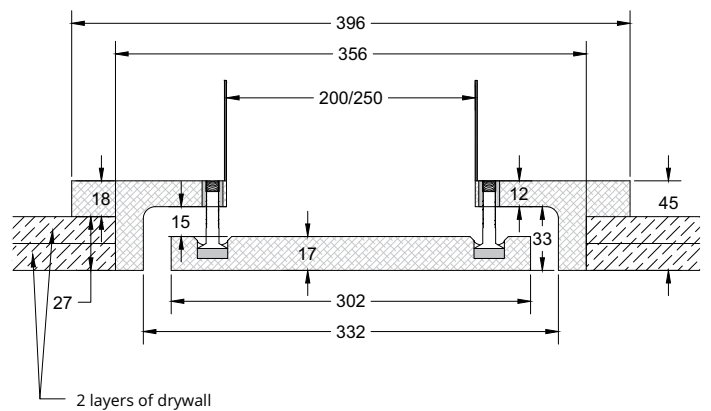
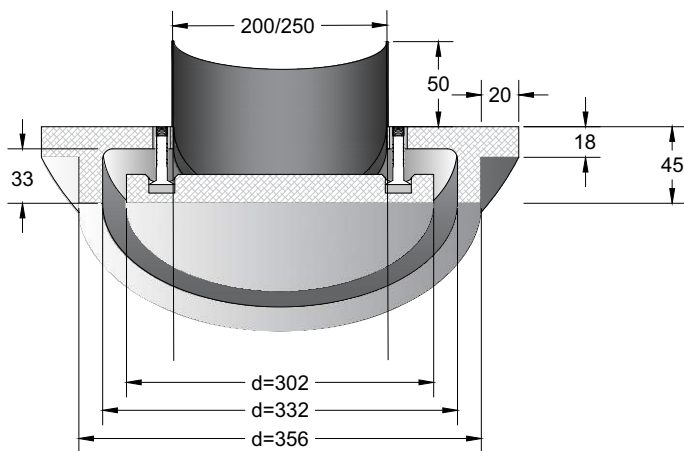

Airborne noise and resistance, 1 m.

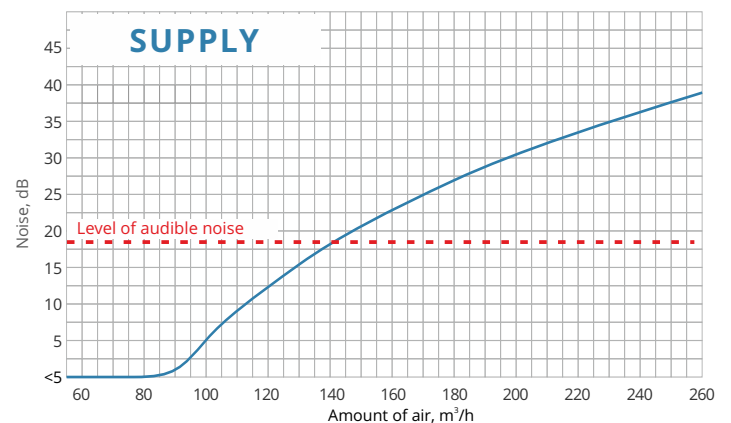
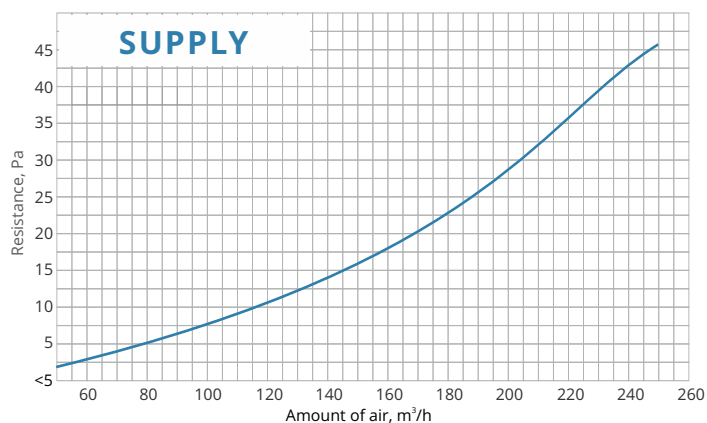

The CIRCLE vent diffuser fits well into a range of spaces and designs. With its round slots, it is suitable for air supply and air extraction purposes.

SENSIBLE AIRFLOW

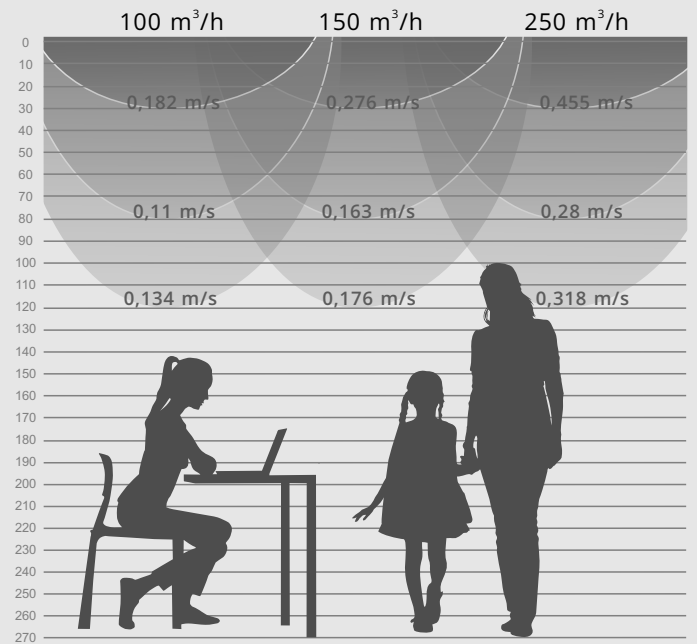

Airflow perceptible with the Circle diffuser at a height of 2.70 m

AIR VELOCITY AT DISTANCE FROM DIFFUSER

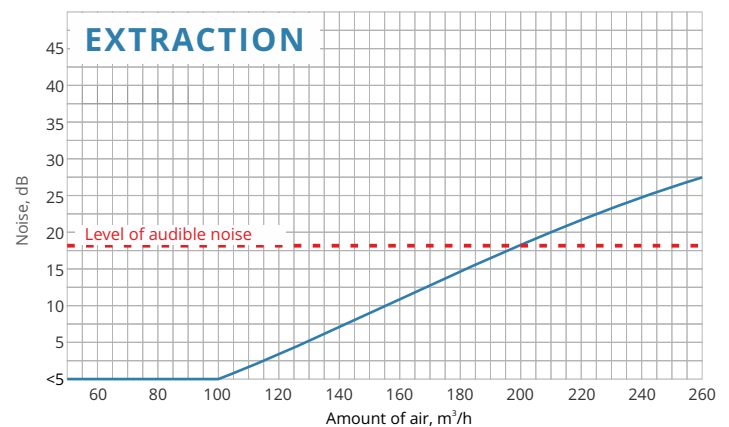
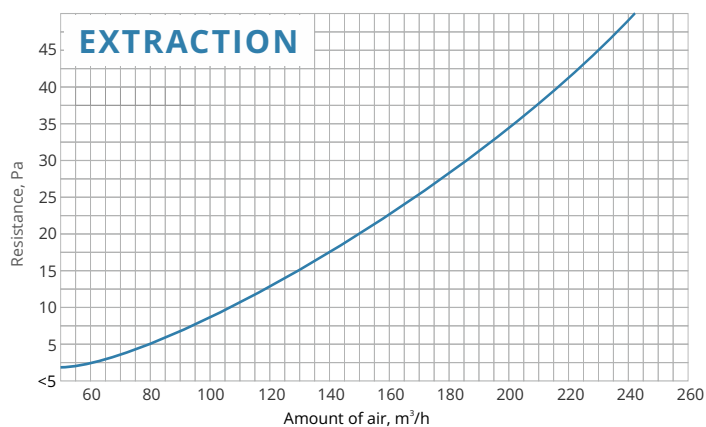
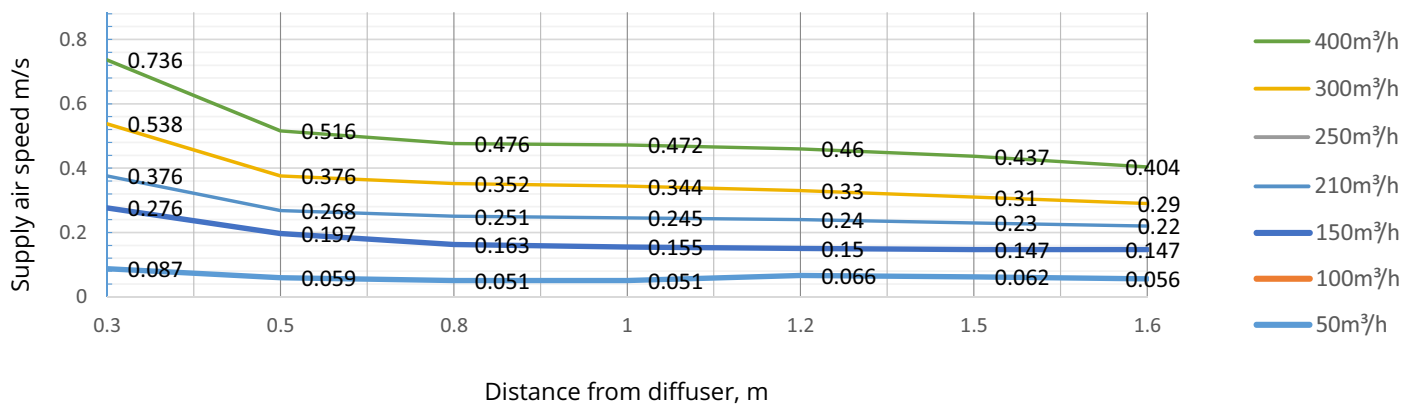

SQUARE





FRAMELESS



PLASTERED - IN



PAINTABLE



The Ventmann SQUARE vent diffuser can act as both an air distributor and a minimalist interior element. It will accentuate the precise lines and rigid angles of your design, with an elegance that means it can be an integral part of any interior.

Due to their well-defined shape, multiple Ventmann SQUARE diffusers can be installed in a single room for an impressive effect.

The Ventmann SQUARE vent diffuser is also a practical solution. Like all of our units, they are mounted at the same time as the walls and ceilings, and can be painted with the same paint. This is all thanks to our unique gypsum composite.

In addition, even standard SQUARE models can be adapted to your needs:

- 100mm or 125mm - these are the standard connection nozzle diameters that you can select.
- The diffuser cap is supported by our new Click system.

This system makes it even easier to put the cap in place correctly. It is also more environmentally friendly and has a higher operational temperature range than the magnets previously used.

If you are looking for non-standard interior details for your project, or your market requires specific SQUARE vent diffuser sizes - we can help you.

To get a look at how these diffusers appear inside an interior, and to understand the installation process, you can watch our product showcase video. Use the QR code below to access it.

You will find all of the technical details you need on the Ventmann SQUARE vent diffuser in our catalogue, and our consultants are ready to answer any questions you might have.

Ventmann – your choice of air elegance.



LINE



CIRCLE



SQUARE



SIDE



ART



SKU LIST



Installation:
video instructions
 **YouTube**



Download a digital
version of the catalog
 **Download**

SQUARE 100/125

SQUARE-SLOT DIFFUSER

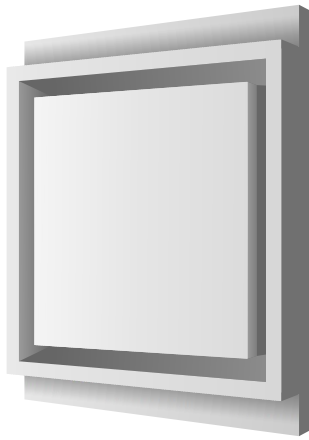

100/125 mm
DIAMETER OF COUPLING SLEEVE

2.40 kg
WEIGHT WITHOUT PACKAGING (NET)

Order code for 100 ø:
SQUARE 100
Hole diameter

Order code for 125 ø:
SQUARE 125
Hole diameter

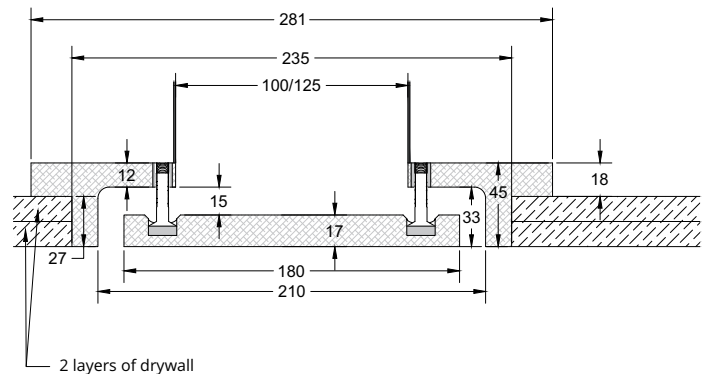
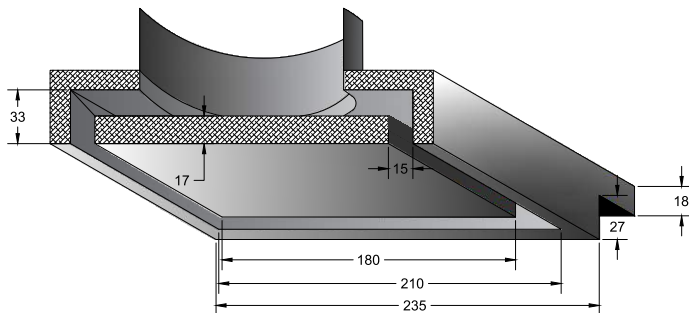

Airborne noise and resistance, 1 m.

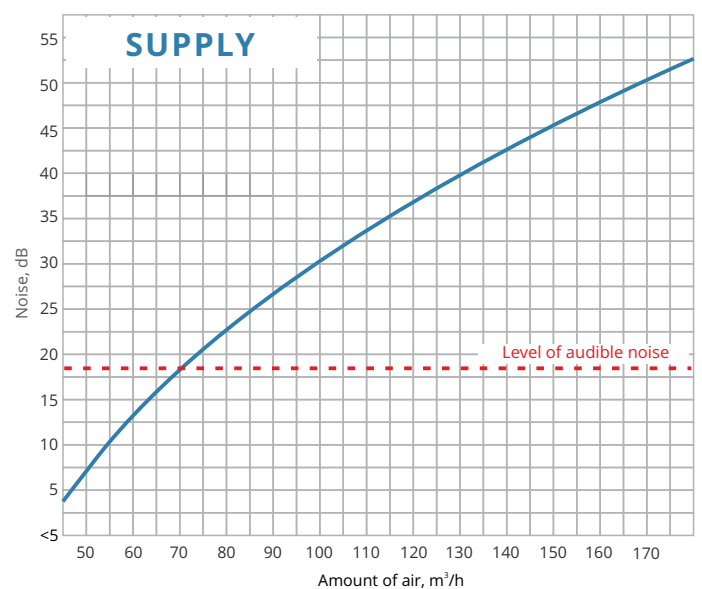
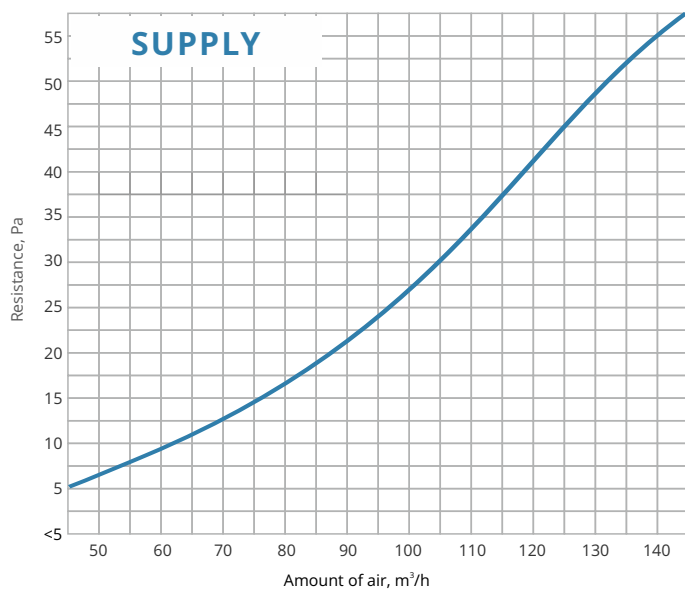

The Ventmann SQUARE vent diffuser is frameless and features a square sloy. It is ideal for a variety of room sizes and spaces, and several units can be deployed in one room. It can be used for both air supply and air extraction, and can be manufactured with a 100mm or 125mm connection pipe.

SENSIBLE AIRFLOW

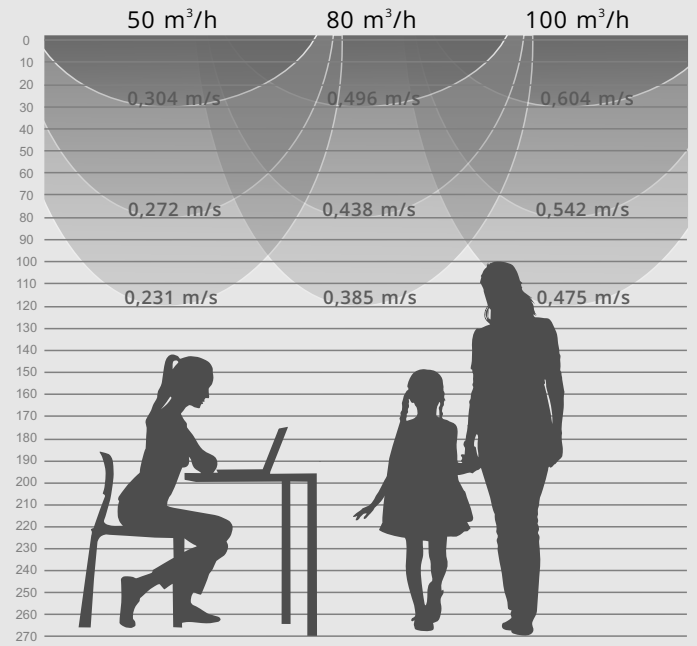

Airflow perceptible with the Square diffuser at a height of 2.70 m

AIR VELOCITY AT DISTANCE FROM DIFFUSER

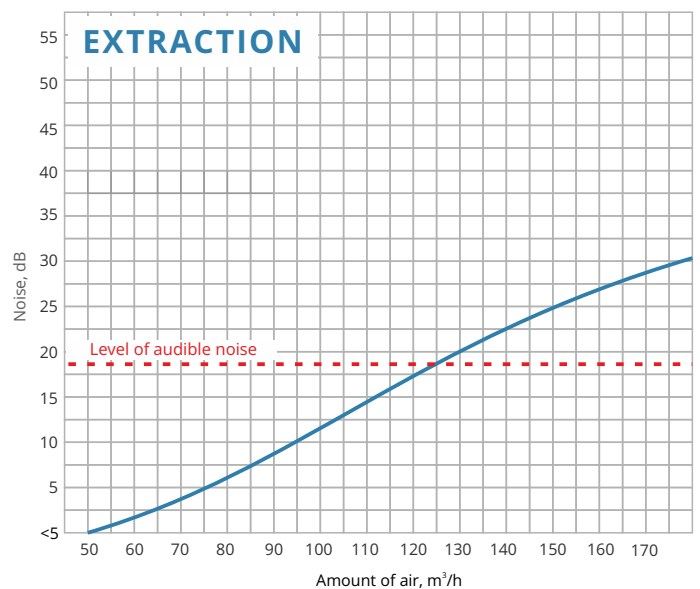
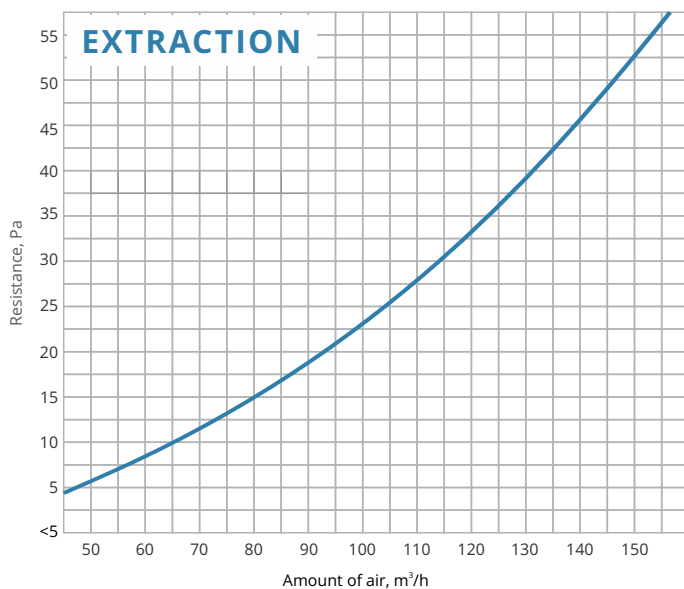
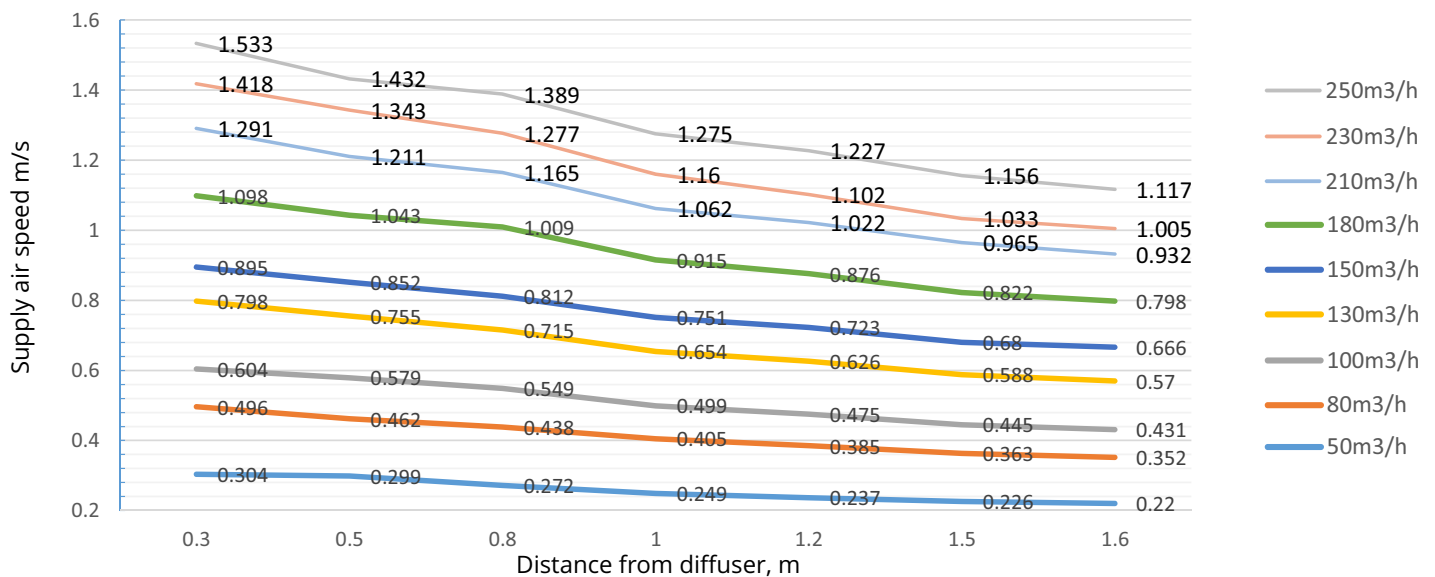

SIDE



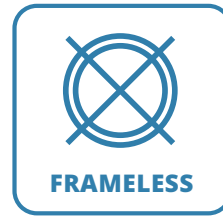

FRAMELESS



PAINTABLE

The unique design of the Ventmann SIDE vent diffuser ensures air is distributed on the plane surface on which they are mounted.

In terms of aesthetics, the Ventmann SIDE's duct diffusers are attractive as interior design solutions - their caps can be mounted in a circular or a square shape. This provides design versatility while also allowing for discretion.

The Ventmann SIDE vent diffuser also offers a lot in terms of practicalities. Like all of our diffusers, its base can be plastered and painted together with the entire surface. This is thanks to our first-of-its-kind gypsum composite.

This is also a versatile and adaptable ventilation solution. The standard SIDE vent diffuser comes with the following options:

- Round or square - choose the shape of the diffuser cap that best suits your design needs, or your customer's preference.
- The smallest connection nozzles available are 100mm or 125mm in diameter.
- There is a medium-sized connection nozzle available, which has a diameter of 160mm.
- The largest connection nozzle available for this model are 200mm or 250mm in diameter.

If your project requires specific interior solutions or your market requires specific SIDE diffuser sizes, we can help you.

With the Ventmann SIDE vent diffuser, the choice is yours. The diffuser can become a striking part of your design, or can be discretely integrated into your minimalist aesthetic.

To get an idea of how this diffuser could fit into your project, and to see the installation process, please take a look at our product showcase video using the QR code below.

All of the technical information on this model is available in our catalogue, and our consultants would be happy to answer any technical or design questions you might have.

Ventmann – your choice of air elegance.



LINE



CIRCLE



SQUARE



SIDE



ART



SKU LIST



Installation:
video instructions
 YouTube



Download a digital
version of the catalog
 Download

SIDE 100/125

SIDE PLATE DIFFUSER



SIDE ROUND

Order code for 100 \varnothing :

SIDE 0 100

Corners Hole diameter

Order code for 125 \varnothing :

SIDE 0 125

Corners Hole diameter



SIDE SQUARE

Order code for 100 \varnothing :

SIDE 4 100

Corners Hole diameter

Order code for 125 \varnothing :

SIDE 4 125

Corners Hole diameter

100/125 mm
DIAMETER OF COUPLING SLEEVE

2.735 kg
WEIGHT WITHOUT PACKAGING (NET)

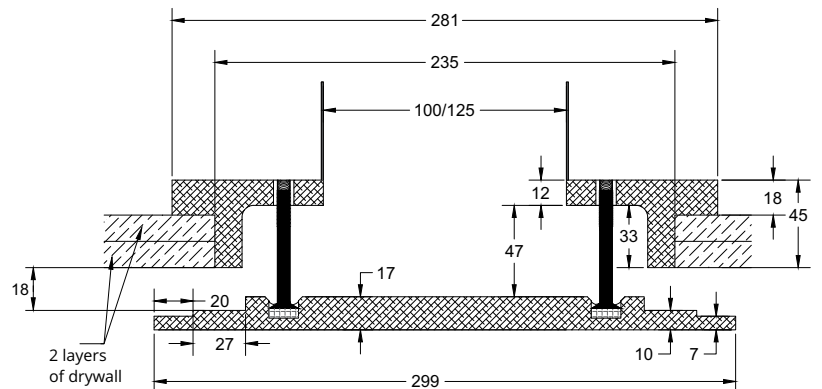
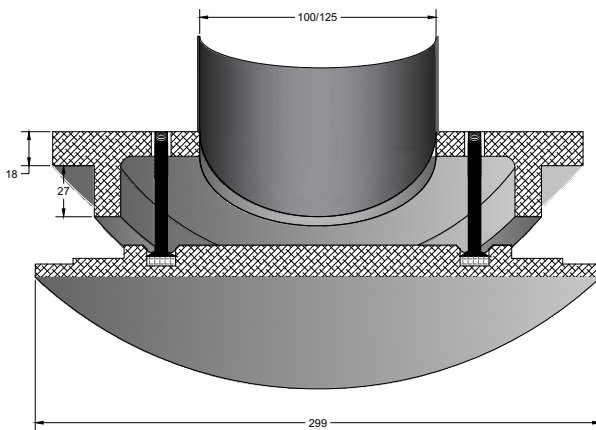

Airborne noise and resistance, 1 m.

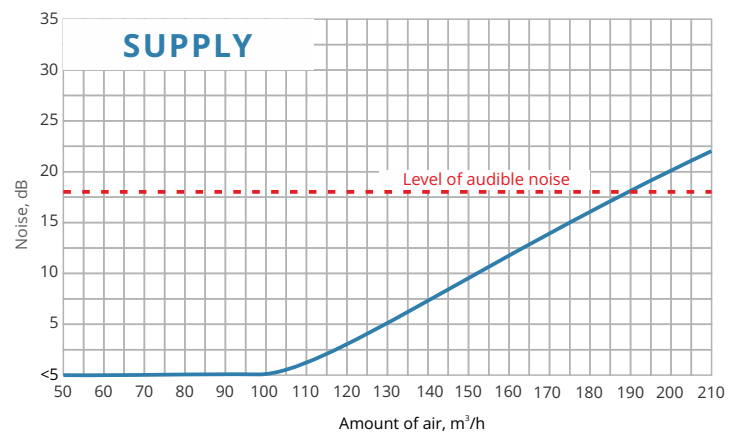
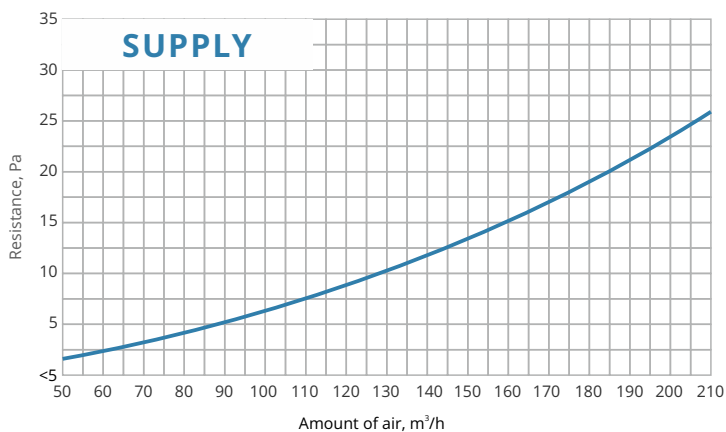

Thanks to its unique design, the Ventmann SIDE vent diffuser provides air diffusion in a horizontal plane when installed in a wall. As a result, it can be mounted above seating areas or desks without causing discomfort to the occupant.

SENSIBLE AIRFLOW

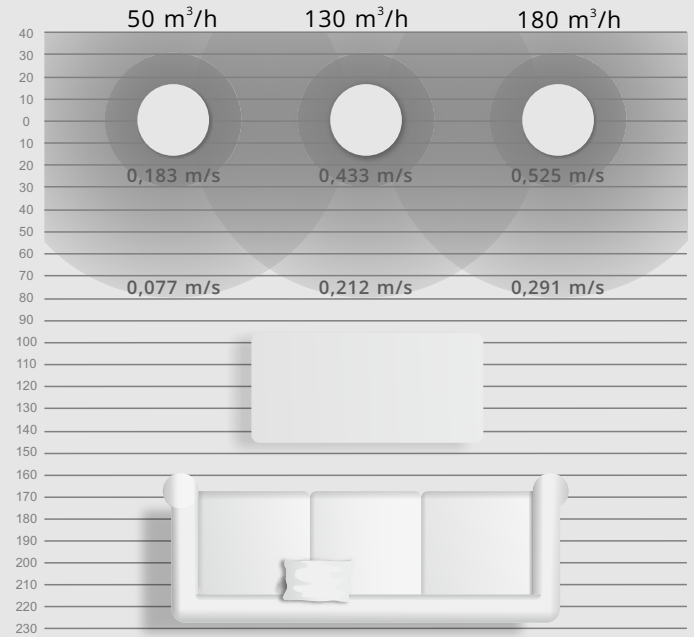

Airflow perceptible with the Side diffuser in the ceiling (top view)

AIR VELOCITY AT DISTANCE FROM DIFFUSER

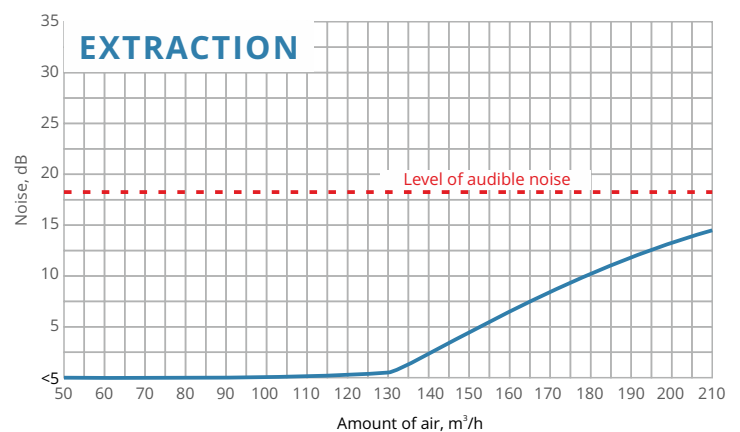
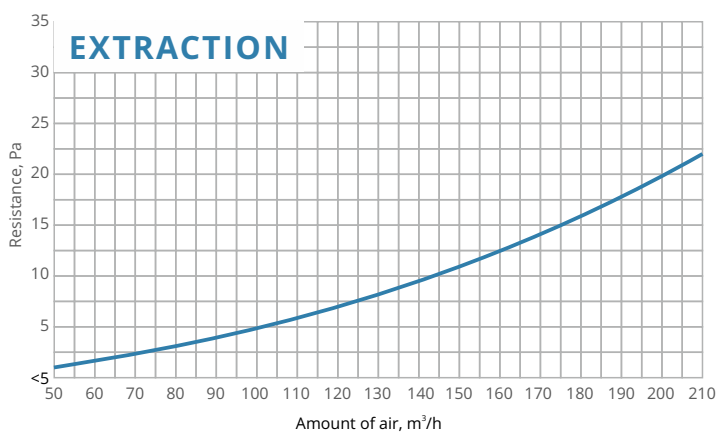
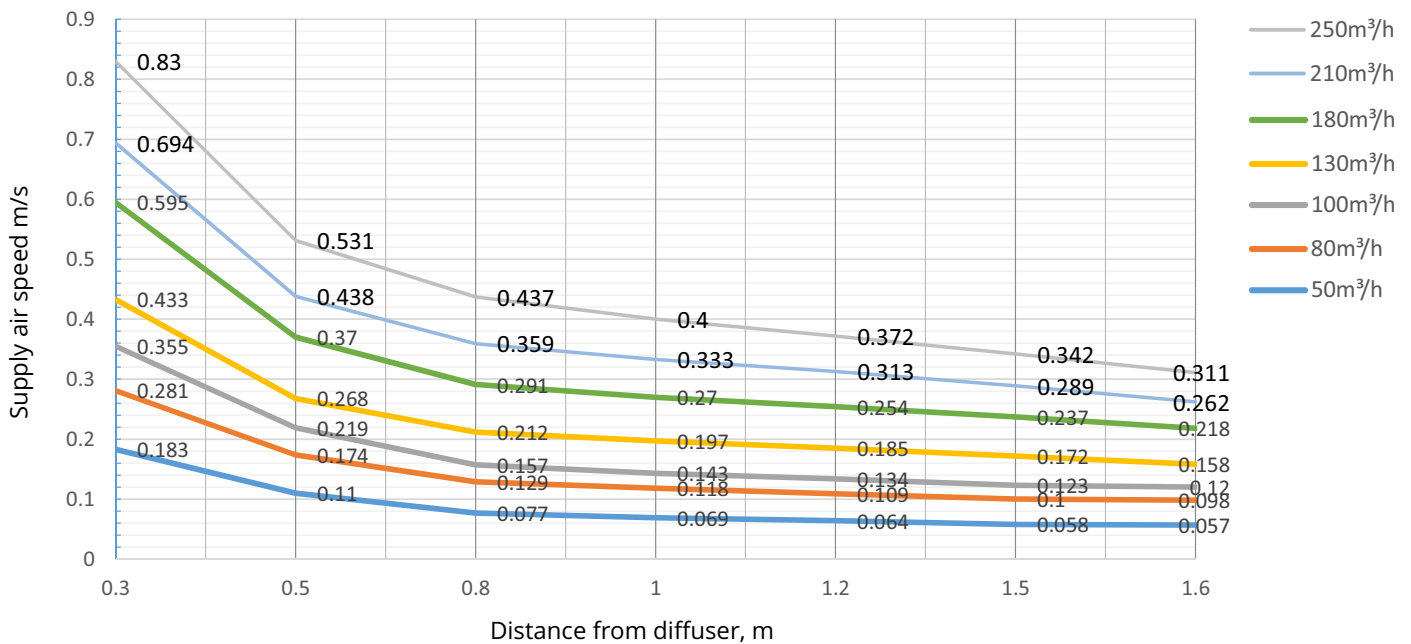

SIDE 160

SIDE PLATE DIFFUSER

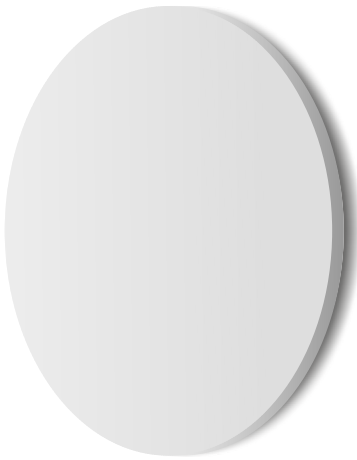

SIDE ROUND

Order code:
SIDE 0 160
Corners Hole diameter



SIDE SQUARE

Order code:
SIDE 4 160
Corners Hole diameter

160 mm

DIAMETER OF COUPLING SLEEVE

3.968 kg

WEIGHT WITHOUT PACKAGING (NET)

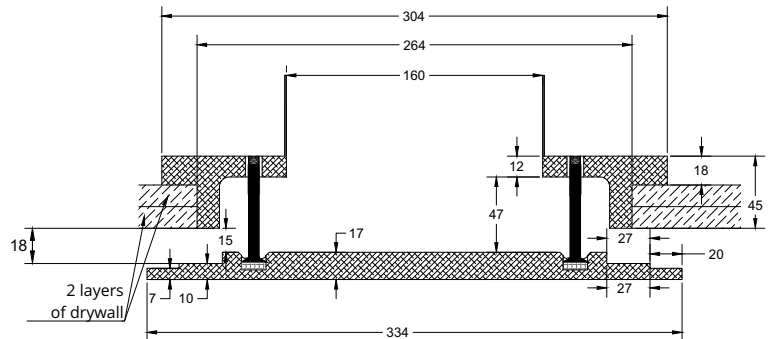
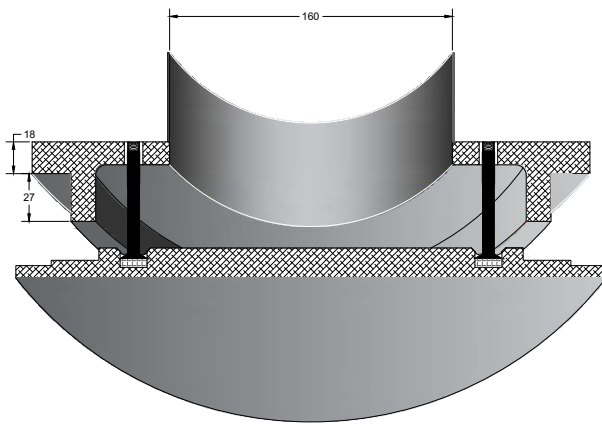

Airborne noise and resistance, 1 m.

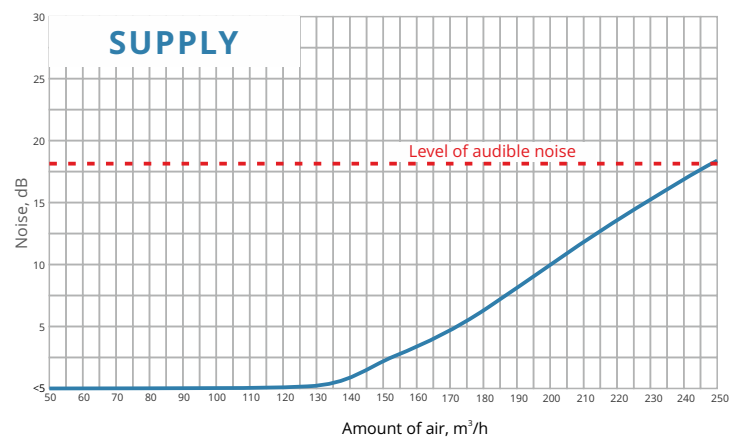
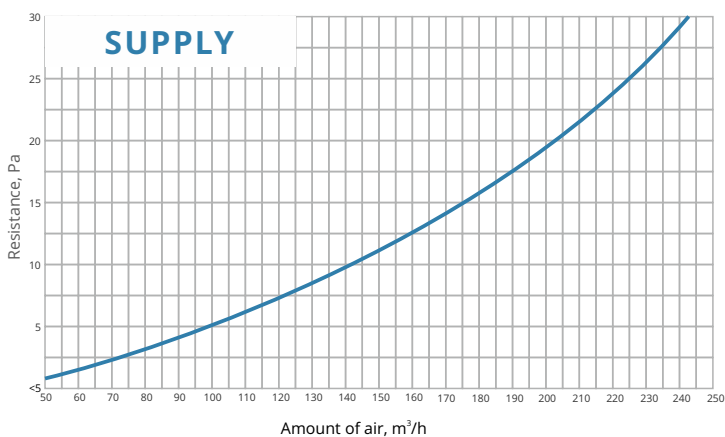

This is our medium-sized version of the SIDE vent diffuser. It is ideal for both ventilation and air condition systems. It is suitable for both supplying and extracting air, and thanks to its unique design it can be mounted over desks or seating areas.

SENSIBLE AIRFLOW

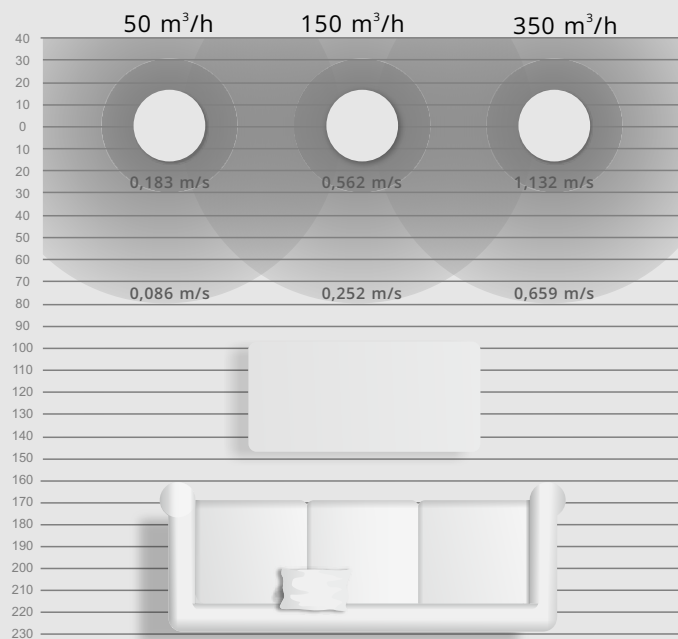

Airflow perceptible with the Side diffuser in the ceiling (top view)

AIR VELOCITY AT DISTANCE FROM DIFFUSER

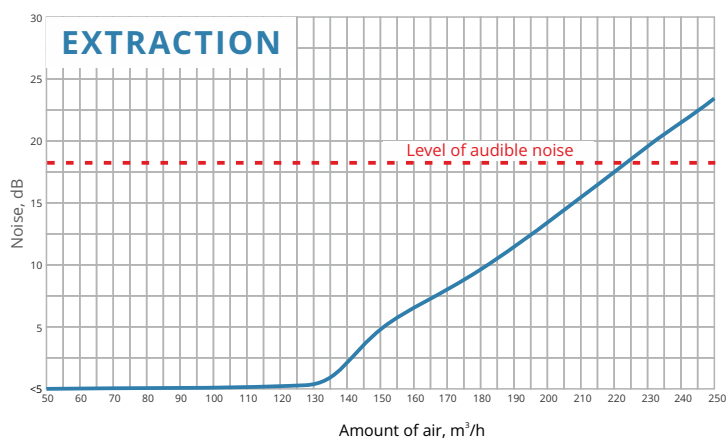
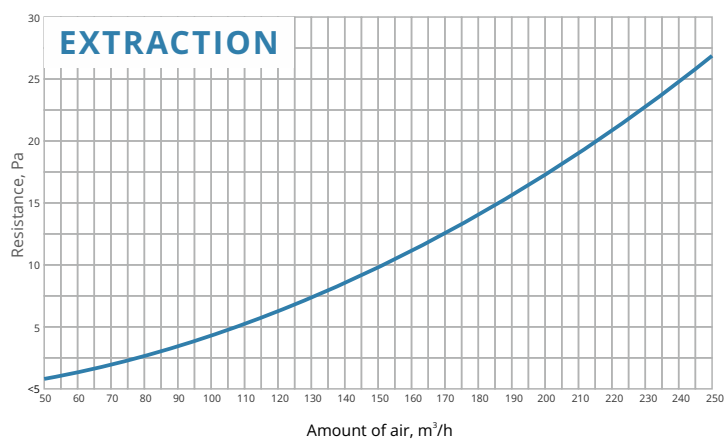
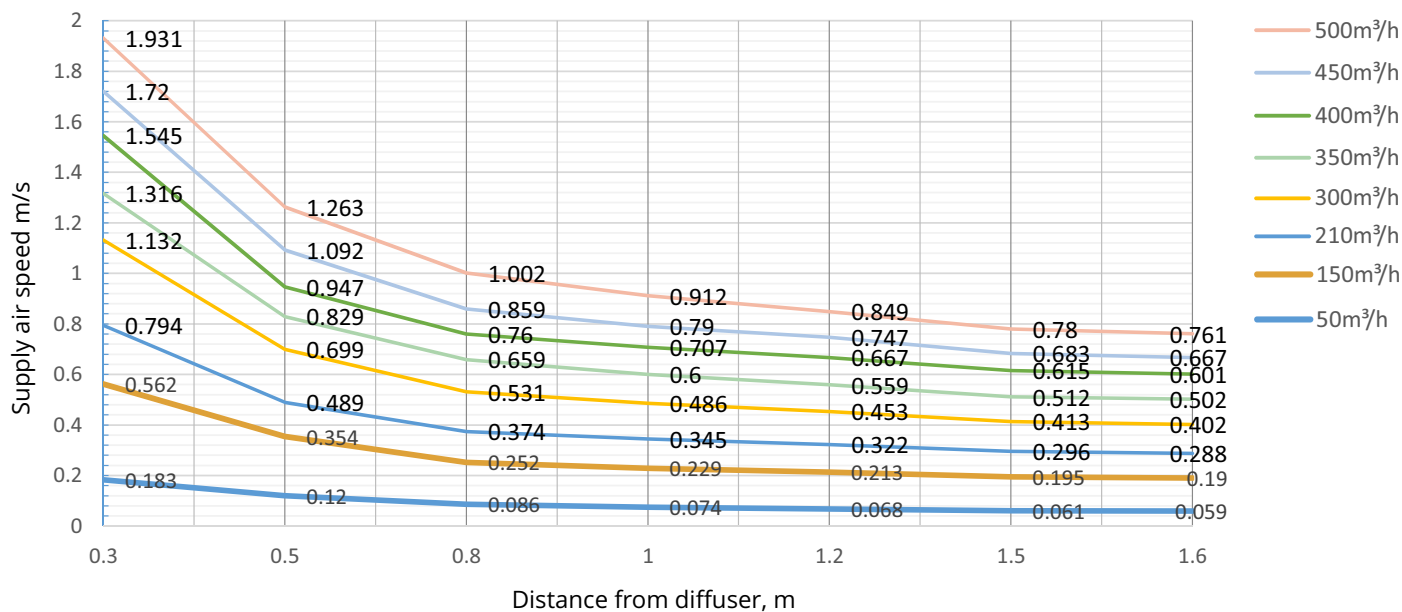

SIDE 200/25

SIDE PLATE DIFFUSER



SIDE ROUND

Order code:
SIDE 0 200
Corners Hole diameter
Order code:
SIDE 0 250
Corners Hole diameter



SIDE SQUARE

Order code:
SIDE 4 200
Corners Hole diameter
Order code:
SIDE 4 250
Corners Hole diameter

200/250 mm
DIAMETER OF COUPLING SLEEVE

4.8 kg
ROUND MODEL WEIGHT WITHOUT
PACKAGING (NET)

6.2 kg
SQUARE MODEL WEIGHT WITHOUT
PACKAGING (NET)

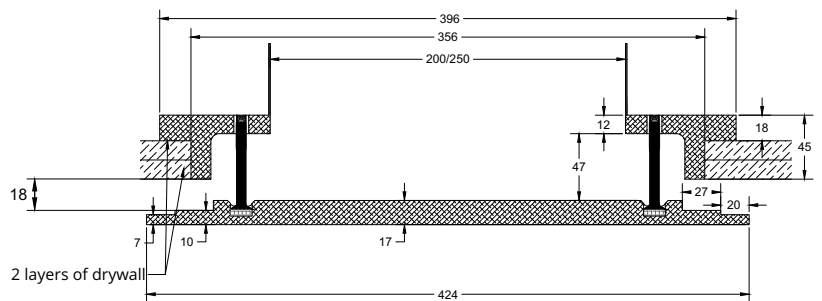
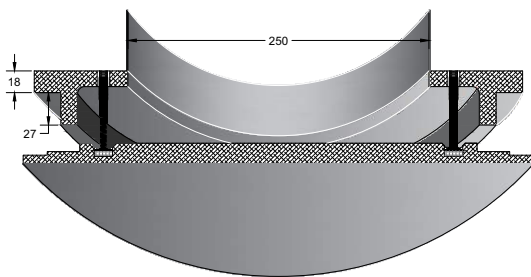

Airborne noise and resistance, 1 m.

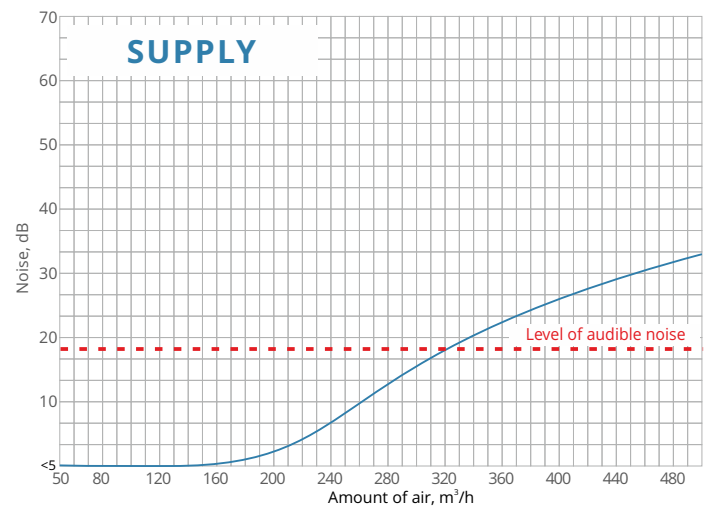
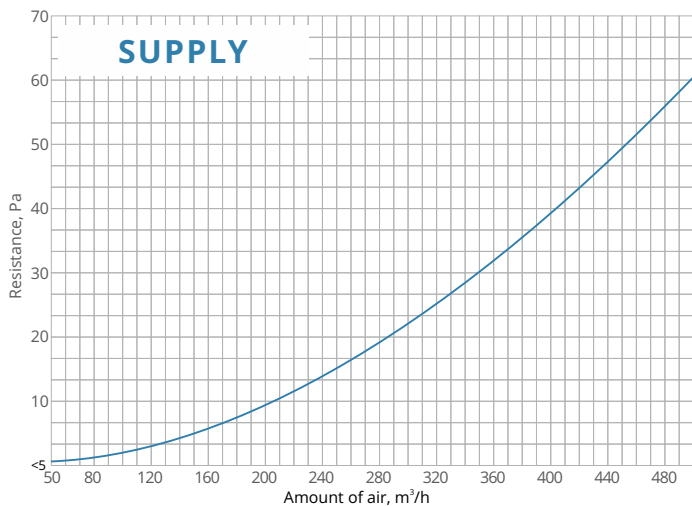

This is our largest SIDE vent diffuser. It can be used to supply and extract air, and is suitable for both ventilation and air condition systems. Thanks to its unique design it will not cause any discomfort to occupants when mounted above workstations or seating areas.

SENSIBLE AIRFLOW

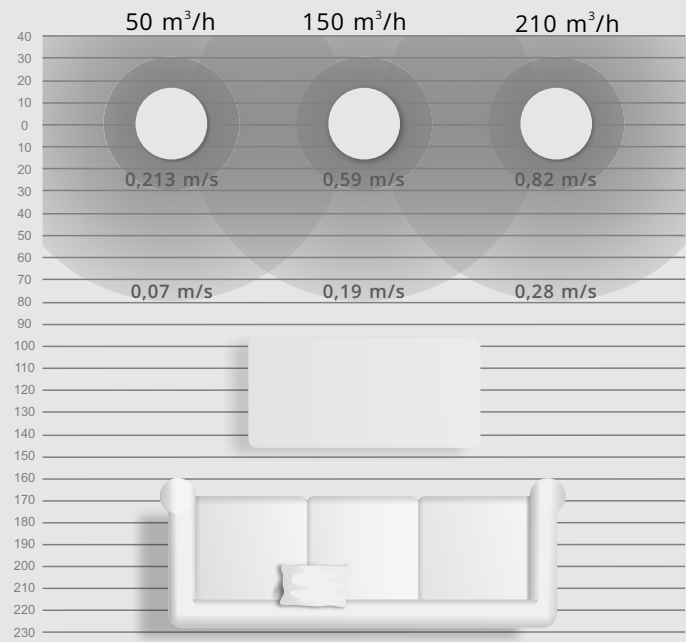

Airflow perceptible with the Side diffuser in the ceiling (top view)

AIR VELOCITY AT DISTANCE FROM DIFFUSER

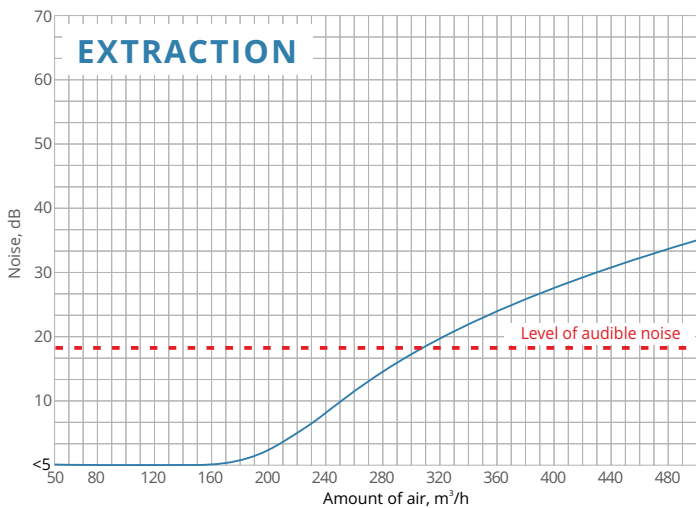
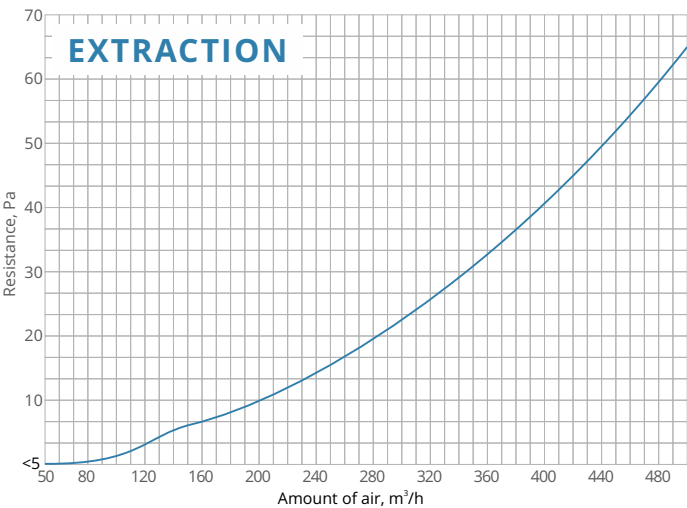
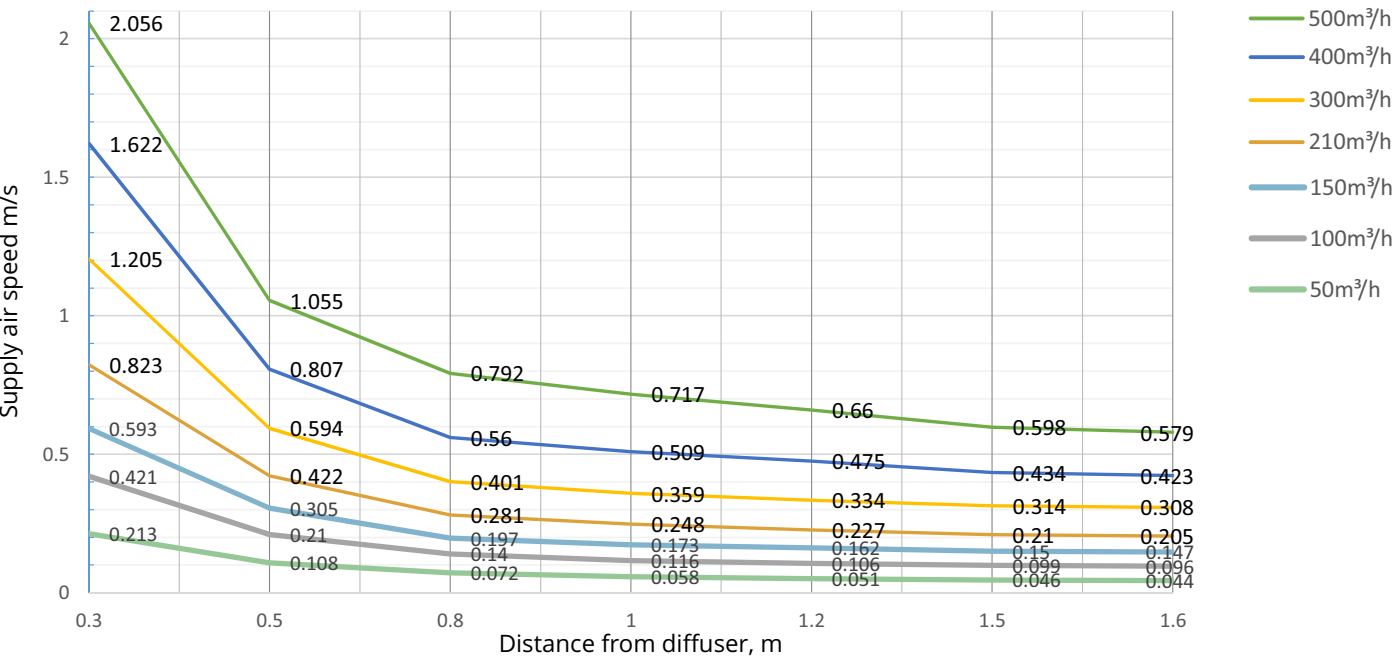

ART





FRAMELESS



PLASTERED - IN



PAINABLE



The Ventmann ART frameless grill provides an ideal solution for fireplaces, ventilation systems and inspection hatches that seamlessly match classical, high-spec interiors. With size, design, and colour all customisable, these Gypsum grills offer versatility, style and quality.

The inside of these frameless grills is composed of precision laser-cut metal, and the exterior is formed from our special gypsum composite and secured by industrial grade magnets. Using these magnets ensures there are no visible locks or handles, but the grill remains easy to open. This ensures a completely frameless finish to seamlessly integrate with your design.

The Ventmann ART frameless grill:

- comes in white as standard,
- and is available in 3 different styles.

Alternatively, you can also customise the grill to suit your needs exactly:

- it can be produced to your own custom-designed style,
- and it can be made in the colour you require to match your interior.

The grill has a range of potential functionalities. Firstly, it is an ideal option for interior fireplaces and woodburner, providing elegance and character to complement these standout features. Secondly, it provides a stylish option for air vents, especially in classically designed interior spaces. Thirdly, the ART frameless grill can be used as a discrete and aesthetically-pleasing service door or inspection hatch.

Because all custom designs are laser cut, you can choose precisely the amount of permeability you want from your ART grill. For vents, you can select a high level of permeability. Meanwhile, for service doors and hatches the grill can be virtually impermeable.

All our grills are produced using our first-of-its-kind gypsum composite for unrivalled quality. The special formula we use for our gypsum composite ensures it absorbs water well - this means the plaster for the joint sticks well and will not crack later. It can be sanded to a smooth finish, and painted to fit seamlessly with the rest of your interior.

Ventmann - your choice of air elegance.



Installation:
video instructions
 **YouTube**



Download a digital
version of the catalog
 **Download**



LINE



CIRCLE



SQUARE



SIDE



ART



SKU LIST

ART

FRAMELESS GRILLS



3
DIFFERENT DESIGN STYLES

3
DIFFERENT SIZES

1.2 kg
WEIGHT WITHOUT PACKAGING

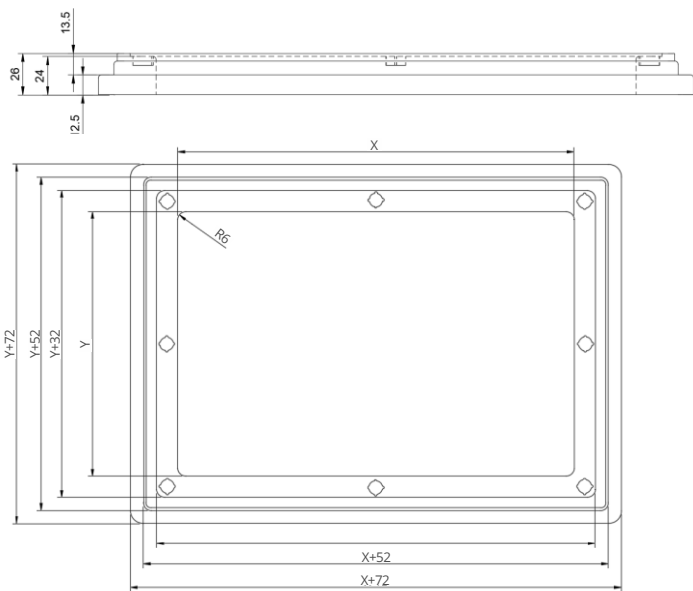

| Art grills dimensions | | |
|-----------------------|-----|-----|
| SIZE | X | Y |
| S | 200 | 100 |
| M | 300 | 200 |
| L | 400 | 300 |

Art diffuser design

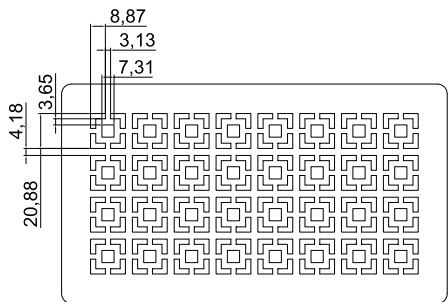

ART 1

Order code example:
ART 1 M W

Design Size Color

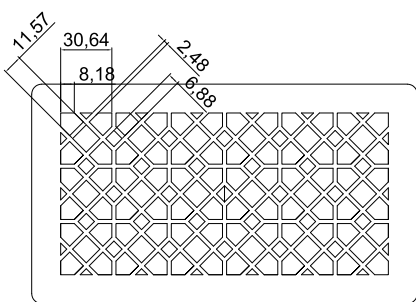

ART 3

Order code example:
ART 3 M W

Design Size Color

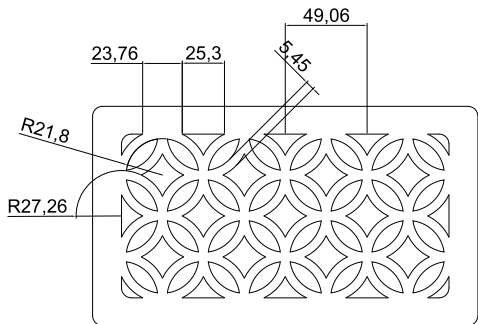

ART 6

Order code example:
ART 6 M W

Design Size Color

These high-spec grills are a great choice for any fireplace, ventilation system or service door in interiors with classical or modern designs. They feature a frameless finish thanks to our unique gypsum composite frame and the use of industrial grade magnets for locking. The grill is available in 3 styles, or the pattern can be custom-designed.

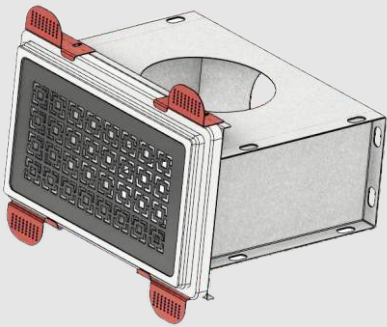

| Art grills effective area -Ak (m2) | | | |
|------------------------------------|---------|---------|---------|
| SIZE \ DESIGN | ART 1 | ART 3 | ART 3 |
| S | 0,00756 | 0,01267 | 0,00907 |
| M | 0,02270 | 0,03808 | 0,02790 |
| L | 0,04445 | 0,07606 | 0,05614 |

ART GRILLES PLENUM BOX (OPTIONAL)

| Dimensions | | | | | | | |
|------------|-----|-----|-----|-----|-----|-----|-----|
| SIZE | X | Y | L | W | H | D1 | D2 |
| S | 200 | 100 | 272 | 172 | 165 | 100 | 125 |
| M | 300 | 200 | 372 | 272 | 200 | 125 | 160 |

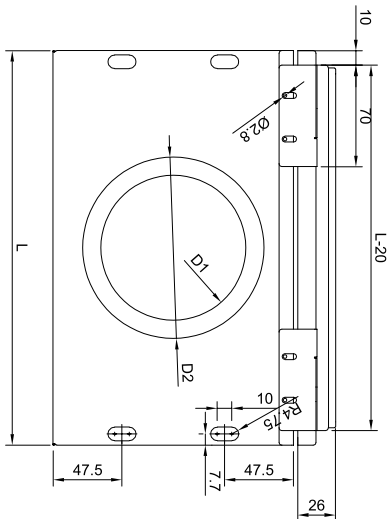
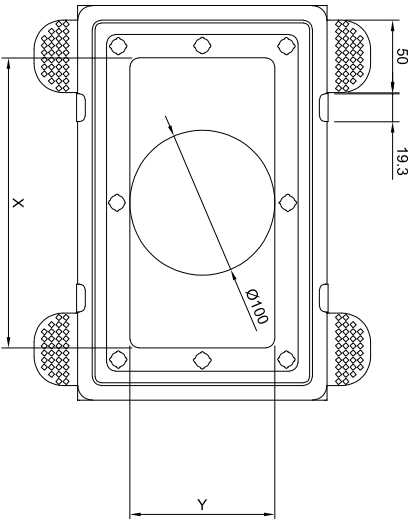
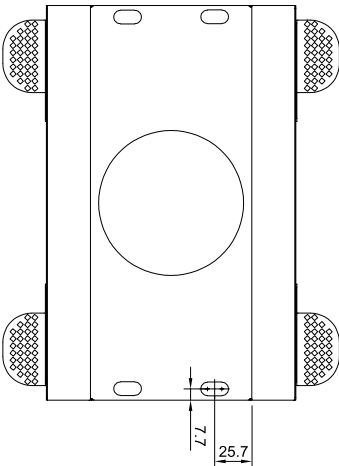
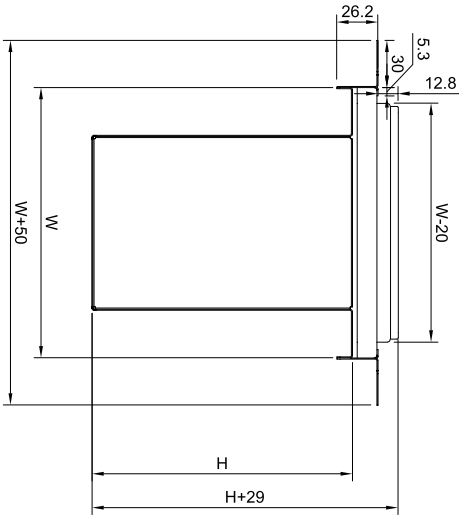

FRAMELESS DIFFUSERS ORDER CODES

The colour-coding shows which parts
are compatible with one another.



1 SLOT LINE DIFFUSER

| ORDER CODE | SLOT LENGTH | SLOTS AMOUNT | SLOT WIDTH | PAGE |
|-------------|-------------|--------------|------------|------|
| LINE625112 | 625 | 1 | 12 | 5, 6 |
| LINE1000112 | 1000 | 1 | 12 | 5, 6 |
| LINE1250112 | 1250 | 1 | 12 | 5, 6 |
| LINE625118 | 625 | 1 | 18 | 7, 9 |
| LINE1000118 | 1000 | 1 | 18 | 7, 9 |
| LINE1250118 | 1250 | 1 | 18 | 7, 9 |



2 SLOTS LINE DIFFUSER

| ORDER CODE | SLOT LENGTH | SLOTS AMOUNT | SLOT WIDTH | PAGE |
|-------------|-------------|--------------|------------|--------|
| LINE625212 | 625 | 2 | 12 | 9, 10 |
| LINE1000212 | 1000 | 2 | 12 | 9, 10 |
| LINE1250212 | 1250 | 2 | 12 | 9, 10 |
| LINE625218 | 625 | 2 | 18 | 11, 12 |
| LINE1000218 | 1000 | 2 | 18 | 11, 12 |
| LINE1250218 | 1250 | 2 | 18 | 11, 12 |

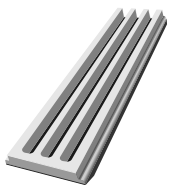

3 SLOTS LINE DIFFUSER

| ORDER CODE | SLOT LENGTH | SLOTS AMOUNT | SLOT WIDTH | PAGE |
|-------------|-------------|--------------|------------|--------|
| LINE625312 | 625 | 3 | 12 | 15, 16 |
| LINE1000312 | 1000 | 3 | 12 | 15, 16 |
| LINE1250312 | 1250 | 3 | 12 | 15, 16 |
| LINE625318 | 625 | 3 | 18 | 17, 18 |
| LINE1000318 | 1000 | 3 | 18 | 17, 18 |
| LINE1250318 | 1250 | 3 | 18 | 17, 18 |

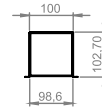

ACOUSTIC JUNCTION BOXES 75MM

| ORDER CODE | CONNECTION DIAMETER | SLOT LENGTH | SLOTS AMOUNT | PAGE |
|------------|---------------------|-------------|--------------|--------|
| GTG75625 | 75 | 625 | 1/2 | 13, 14 |
| GTG751000 | 75 | 1000 | 1/2 | 13, 14 |
| GTG751250 | 75 | 1250 | 1/2 | 13, 14 |

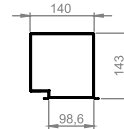

ACOUSTIC JUNCTION BOXES 125MM

| ORDER CODE | CONNECTION DIAMETER | SLOT LENGTH | SLOTS AMOUNT | PAGE |
|------------|---------------------|-------------|--------------|--------|
| GTG125625 | 125 | 625 | 1/2 | 13, 14 |
| GTG1251000 | 125 | 1000 | 1/2 | 13, 14 |
| GTG1251250 | 125 | 1250 | 1/2 | 13, 14 |

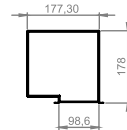

ACOUSTIC JUNCTION BOXES 160MM

| ORDER CODE | CONNECTION DIAMETER | SLOT LENGTH | SLOTS AMOUNT | PAGE |
|------------|---------------------|-------------|--------------|--------|
| GTG160625 | 160 | 625 | 1/2 | 13, 14 |
| GTG1601000 | 160 | 1000 | 1/2 | 13, 14 |
| GTG1601250 | 160 | 1250 | 1/2 | 13, 14 |

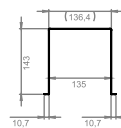

ACOUSTIC JUNCTION BOXES 125MM

| ORDER CODE | CONNECTION DIAMETER | SLOT LENGTH | SLOTS AMOUNT | PAGE |
|-------------|---------------------|-------------|--------------|--------|
| GTG3125625 | 125 | 625 | 3 | 19, 20 |
| GTG31251000 | 125 | 1000 | 3 | 19, 20 |
| GTG31251250 | 125 | 1250 | 3 | 19, 20 |

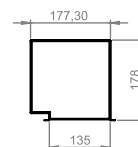

ACOUSTIC JUNCTION BOXES 160MM

| ORDER CODE | CONNECTION DIAMETER | SLOT LENGTH | SLOTS AMOUNT | PAGE |
|-------------|---------------------|-------------|--------------|--------|
| GTG3160625 | 160 | 625 | 3 | 19, 20 |
| GTG31601000 | 160 | 1000 | 3 | 19, 20 |
| GTG31601250 | 160 | 1250 | 3 | 19, 20 |

FRAMELESS DIFFUSERS ORDER CODES

The colour-coding shows which parts
are compatible with one another.



SQUARE DIFFUSER

| ORDER CODE | CONNECTION DIAMETER | PAGE |
|------------|------------------------|--------|
| SQUARE100 | 100 | 31, 32 |
| SQUARE125 | 125 | 31, 32 |



CIRCLE DIFFUSER

| ORDER CODE | CONNECTION DIAMETER | PAGE |
|------------|------------------------|--------|
| CIRCLE100 | 100 | 23, 24 |
| CIRCLE125 | 125 | 23, 24 |
| CIRCLE160 | 160 | 25, 26 |
| CIRCLE200 | 200 | 27, 28 |
| CIRCLE250 | 250 | 27, 28 |



SIDE DIFFUSER ROUND

| ORDER CODE | CONNECTION DIAMETER | PAGE |
|------------|------------------------|--------|
| SIDE0100 | 100 | 35, 36 |
| SIDE0125 | 125 | 35, 36 |
| SIDE0160 | 160 | 37, 38 |
| SIDE0200 | 200 | 39, 40 |
| SIDE0250 | 250 | 39, 40 |



SIDE DIFFUSER SQUARE

| ORDER CODE | CONNECTION DIAMETER | PAGE |
|------------|------------------------|--------|
| SIDE4100 | 100 | 35, 36 |
| SIDE4125 | 125 | 35, 36 |
| SIDE4160 | 160 | 37, 38 |
| SIDE4200 | 200 | 39, 40 |
| SIDE4250 | 250 | 39, 40 |

CONTACTS

EMAIL

sales@ventmann.eu

ADDRESS

Perkunkiemio str. 4A LT-12128,
Vilnius, Lithuania

WEB PAGE

www.ventmann.eu

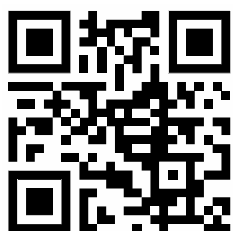

Visit our WEB page

