

# SHOYEIDO

Traditional Japanese Incense - “Koh”



— Kyoto — Osaka — Tokyo — Yokohama — Sapporo — Boulder —



The price in this catalogue is with Japanese consumption Tax (10%). Shown in parentheses is the price without Tax.

## ABOUT SHOYEIDO

Since our establishment in the early 18th century, Shoyeido has worked diligently to perfect the art of manufacturing Japanese incense, also known as "Koh".

We offer a wide variety of unique and hand-blended scents for every occasion.

Our slogan, "Life with Fragrance" is meant to convey how incense can be a companion to the many activities in our day-to-day live. Our products are made

mainly from natural ingredients. We believe it is not only our responsibility to appreciate and protect these generous gifts of nature, but also to preserve the traditions of incense blending that have been passed down from generation to generation.



## GIFT OF NATURE

Natural ingredients such as agarwood, sandalwood, cinnamon, clove, star anise — to name a few — are not indigenous to Japan. We work closely with many countries to gather these items and to protect the ecological integrity of all natural components in our incense recipes.

We believe it is not only our responsibility to appreciate and protect these generous gifts of nature, but also to preserve the traditions of incense blending that have been passed down from generation to generation.

Shoyeido products are produced with the greatest care so our customers can enjoy the highest quality of incense.



## INCENSE FOR MIND AND ATMOSPHERE

It is widely believed that incense was brought to Japan over 1400 years ago, along with the conveyance of Buddhism.

Historically, Japanese Incense has often been cherished and used for religious occasions, in the social routine of samurai warriors, and more.

During the Edo period (1603-1867), incense became popular among all classes, as it was established as a tradition for all Japanese culture.

Centuries later, the Japanese style of living has changed but the appreciation and pride for incense in Japanese culture remains the same.

We are pleased to convey the concept of "life with fragrance" to our customers.



## TEN VIRTUES OF KOH

It brings communication with the transcendent.

It refreshes mind and body.

It removes impurity.

It brings alertness.

It is a companion in solitude.

In the midst of busy affairs, it brings a moment of peace.

When it is plentiful, one never tires of it.

When there is little, still one is satisfied.

Age does not change its efficacy.

Used everyday, it does no harm.



For more information >>





A highly skilled artisan makes most exclusive incense by hand. Made from centuries-old recipes and containing fine ingredients.

## Production of Premium Incense



For more information



### ★ Limited Availability

The finest quality Agarwood is becoming increasingly rare and the reliable supply will be difficult in the future. To monitor the production of our premium incenses, and with respect to the environment of nature, the amount of production of our premium incense is limited.

Produced with our time-honored, traditional manufacturing techniques, featuring the familiar rich fragrance of agarwood.



### Myokaku — Enlightenment Pure, dignified.

**111006** JPY 22,000 (20,000)  
Approx. 36 sticks, 18 cm  
**111020** JPY 6,600 (6,000)  
15 sticks, 11 cm  
★ Limited Availability



### Gaho — Refinement Splendor, elegance.

**110606** JPY 11,000 (10,000)  
Approx. 36 sticks, 18 cm  
**110620** JPY 3,300 (3,000)  
15 sticks, 11 cm  
★ Limited Availability



### Nankun — Southern Wind Warmth, rejoicing.

**110506** JPY 6,600 (6,000)  
Approx. 36 sticks, 18 cm  
**110520** JPY 2,200 (2,000)  
15 sticks, 11 cm  
★ Limited Availability



### Misho — Gentle Smile Happiness, understanding.

**110406** JPY 3,300 (3,000)  
Approx. 36 sticks, 18 cm  
**110420** JPY 1,650 (1,500)  
20 sticks, 11 cm



### Shunyou — Beckoning Spring Lush, tranquility.

**110306** JPY 2,200 (2,000)  
Approx. 36 sticks, 18 cm  
**110320** JPY 1,100 (1,000)  
20 sticks, 11 cm



### Kyojiman — Pride of Kyoto Quietude, affection.

**110206** JPY 1,650 (1,500)  
Approx. 36 sticks, 18 cm



### Ohjya-koh — King's Aroma Confidence, harmony, use anytime.

**110106** JPY 1,100 (1,000)  
Approx. 36 sticks, 18 cm



### Matsu-no-tomo — Friend of Pine Recollection, strength.

**120106** JPY 880 (800)  
Approx. 36 sticks, 18 cm





## Seifu — Fresh Breeze

Fresh Breeze refreshes your body and soul.

**123305** **JPY 13,200** (12,000)  
Short, loose, 490 sticks, 13.5 cm

**123308** **JPY 4,620** (4,200)  
Short, loose, 165 sticks, 13.5 cm



## Enmei — Circle

A circle is often drawn as an object of enlightenment. Please enjoy the essence of a circle with this subdued fragrance.

**123105** **JPY 8,800** (8,000)  
Short, loose, 490 sticks, 13.5 cm

**123108** **JPY 3,300** (3,000)  
Short, loose, 165 sticks, 13.5 cm



## Kyozaakura

— Kyoto Cherry Blossoms

A sandalwood-based fragrance to tempt you into visions of cherry blossoms in spring.

**122605** **JPY 2,750** (2,500)  
Short, loose, 490 sticks, 13.5 cm

**122608** **JPY 1,430** (1,300)  
Short, loose, 175 sticks, 13.5 cm



## Kinkaku — Golden Pavilion

A refreshing sandalwood fragrance inspired by the Golden Pavilion reflected on the pond.

**122505** **JPY 2,200** (2,000)  
Short, loose, 490 sticks, 13.5 cm

**122508** **JPY 1,100** (1,000)  
Short, loose, 175 sticks, 13.5 cm



## Hakuun

— White Cloud

A fragrance inspired by the image of white clouds in a blue sky. High quality natural ingredients are blended to create this subtle scent.

**122905** **JPY 6,600** (6,000)  
Short, loose, 490 sticks, 13.5 cm

**122908** **JPY 2,530** (2,300)  
Short, loose, 170 sticks, 13.5 cm



## Gozan

— Five Hills

A mellow and deep fragrance, based on the best sandalwood available from Mysore, India.

**122705** **JPY 3,850** (3,500)  
Short, loose, 490 sticks, 13.5 cm

**122708** **JPY 1,980** (1,800)  
Short, loose, 175 sticks, 13.5 cm



## Kyonishiki

— Kyoto Autumn Leaves

A quiet fragrance of sandalwood gives rise to images of autumn leaves in Arashi-yama, Kyoto.

**122405** **JPY 1,650** (1,500)  
Short, loose, 490 sticks, 13.5 cm

**122408** **JPY 880** (800)  
Short, loose, 150 sticks, 13.5 cm



## Nokiba — Moss Garden

A mild fragrance of sandalwood that smells like plum flowers blooming by the windows.

**122305** **JPY 2,200** (2,000)  
Short, loose, 490 sticks, 13.5 cm

**122308** **JPY 1,100** (1,000)  
Short, loose, 150 sticks, 13.5 cm



Our master blenders designed these scents to enhance any occasion with a spiritual nuance of fragrance.

TAMAYURA -Embrace an enchanting moment, immersed in delicate, fine fragrance.  
Low Smoke & delicate scent.



## Oboro — Illusions

A noble and savory fragrance, made from selected herbs and spices.

**126213** **JPY 4,400** (4,000)  
Short, loose – 470 sticks, 13.5 cm

**126283** **JPY 2,200** (2,000)  
Short, loose – 165 sticks, 13.5 cm



## Kasumi — Gossamer

A subtly bitter fragrance of sandalwood mixed with high quality herbs and spices.

**126212** **JPY 3,300** (3,000)  
Short, loose – 470 sticks, 13.5 cm

**126282** **JPY 1,650** (1,500)  
Short, loose – 165 sticks, 13.5 cm



## Kyo-no-kumo

Elegant and mature scent of Aromatic wood, Agarwood bases.

**126307** **JPY 2,750** (2,500)  
45g (Approx.200 sticks), 9 cm, with a holder



## Kyo-murasaki

Soothing scent of Aromatic wood, Agarwood bases.

**126306** **JPY 2,200** (2,000)  
45g (Approx.200 sticks), 9 cm, with a holder



## Kyo-matsuba

Fresh aroma reminiscent of pine tree.

**126305** **JPY 1,650** (1,500)  
45g (Approx.200 sticks), 9 cm, with a holder



## Kyo-no-ume

Be enchanted with Modest and sweet fragrance.

**126304** **JPY 1,320** (1,200)  
45g (Approx.200 sticks), 9 cm, with a holder



## Kyo-hiyori

A clean and refreshing fragrance reminiscent of a sunny breeze.

**126303** **JPY 1,100** (1,000)  
45g (Approx.200 sticks), 9 cm, with a holder



## Honoka — Silhouette

A mild, sweet fragrance of sandalwood with herbs and spices.

**126211** **JPY 2,200** (2,000)  
Short, loose – 470 sticks, 13.5 cm

**126281** **JPY 1,100** (1,000)  
Short, loose – 165 sticks, 13.5 cm



## Madoka — Chiffon

A gentle low-smoke blend with a sweet, heart-warming accent, featuring sandalwood, cinnamon, and herbs.

**126210** **JPY 1,650** (1,500)  
Short, loose – 470 sticks, 13.5 cm

**126280** **JPY 825** (750)  
Short, loose – 165 sticks, 13.5 cm

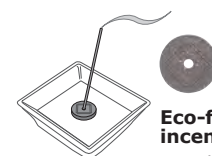

### Eco-friendly disposable incense holder

Avoid strong impact or exposure to water since it is made of soil.



Practical & smart design packaging.

TRAY ▶P.16 takuba 11cm



Named after periods and places in Japanese history, our line of Horin incense offers a modern twist on the ancient art of incense appreciation. Perfect for galleries, large rooms and musical events.



### Tenpyo — Peaceful Sky

A noble Japanese fragrance; deep, natural.

**210521 JPY 6,600** (6,000)  
10 coils, with a holder

**210523 JPY 2,200** (2,000)  
20 sticks, 7 cm, with a holder

**210524 JPY 6,600** (6,000)  
80 sticks, 7 cm, with a holder



### Muromachi — City of Culture

A solemn and calming fragrance.

**210421 JPY 3,960** (3,600)  
10 coils, with a holder

**210423 JPY 1,540** (1,400)  
20 sticks, 7 cm, with a holder

**210424 JPY 4,620** (4,200)  
80 sticks, 7 cm, with a holder



### Horikawa — River Path

Sweet and mellow fragrance, based on sandalwood.

**210221 JPY 3,080** (2,800)  
10 coils, with a holder

**210223 JPY 1,100** (1,000)  
20 sticks, 7 cm, with a holder

**210224 JPY 3,300** (3,000)  
80 sticks, 7 cm, with a holder



### Genroku — Returning Spirit

Enjoy this rich, sandalwood-based fragrance.

**210321 JPY 2,860** (2,600)  
10 coils, with a holder

**210323 JPY 990** (900)  
20 sticks, 7 cm, with a holder

**210324 JPY 2,970** (2,700)  
80 sticks, 7 cm, with a holder



### Shirakawa — White River

A soft and sweet fragrance, based on sandalwood.

**210621 JPY 1,870** (1,700)  
10 coils, with a holder

**210623 JPY 880** (800)  
20 sticks, 7 cm, with a holder

**210624 JPY 2,420** (2,200)  
80 sticks, 7 cm, with a holder



### Nijo — Avenue of the Villa

A traditional fragrance of sandalwood, with a flowery note.

**210121 JPY 1,320** (1,200)  
10 coils, with a holder

**210123 JPY 660** (600)  
20 sticks, 7 cm, with a holder

**210124 JPY 1,870** (1,700)  
80 sticks, 7 cm, with a holder



### Kyogosai

— Horin Sticks Assortment

Nijo, Shirakawa, Genroku, Muromachi, Tenpyo - each 4 sticks.

**211012 JPY 1,320** (1,200)  
20 sticks, 7 cm, with a holder

Using our exclusive pressed incense process, Shoyeido's master blenders have developed the Xiang Do line of atmospheric incenses. Here are 19 of beautiful fragrances - at once evocative, lush, and crowd-pleasing.



**Rose**  
214202



**Lotus**  
214205

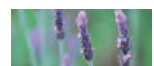

**Lavender**  
214208



**Violet**  
214209



**Coffee**  
214210



**Tea**  
214213



**Sencha**  
214218



**Citrus**  
214222



**Grapefruit**  
214227



**Mixed berry**  
214232



**Mixed fruits**  
214236



**Forest**  
214241



**Vanilla**  
214245



**Peppermint**  
214247



**Marine**  
214258



**Frankincense**  
214263



**Agarwood**  
214273



**Sandalwood**  
214276



**Palo santo**  
214279



### Xiang Do FOUR

— Assortment of popular fragrance

Rose, Lavender, Vanilla, Peppermint  
- each 5 sticks.

214442 JPY 880 (800)  
20 sticks, 7 cm, with a holder

Five fragrances to evoke the memories of a journey; scenery, sound, light, and all you encountered along the way.



### Kaho — Flower Garden

A rich, yet bittersweet fragrance of radiant flowers.

211523 JPY 770 (700)  
20 sticks, 7 cm, with a holder

211524 JPY 1,870 (1,700)  
80 sticks, 7 cm, with a holder



### Yukiyanagi

— Spring Blossoms

Ambrosial notes of a blooming spring garden.

211623 JPY 770 (700)  
20 sticks, 7 cm, with a holder

211624 JPY 1,870 (1,700)  
80 sticks, 7 cm, with a holder



### Sou sou

— Rustling Meadow

Atmospheric scent blanketing green fields.

211723 JPY 770 (700)  
20 sticks, 7 cm, with a holder

211724 JPY 1,870 (1,700)  
80 sticks, 7 cm, with a holder



### Sougetsu

— Moon Reflection

A wafting scent of fresh flowers, heralding a new season.

211823 JPY 935 (850)  
20 sticks, 7 cm, with a holder

211824 JPY 2,530 (2,300)  
80 sticks, 7 cm, with a holder



### Yoinouta — Poetry at Dusk

The enchanting fragrance of aromatic wood, floating delicately in the early evening.

211923 JPY 935 (850)  
20 sticks, 7 cm, with a holder

211924 JPY 2,530 (2,300)  
80 sticks, 7 cm, with a holder



### KUNRO ASSORTMENT

— Assortment of five fragrance

Kaho, Yukiyanagi, Sou sou,  
Sougetsu, Yoinouta - each 5 sticks.

211401 JPY 1,320 (1,200)  
25 sticks, 7 cm, with a holder



For millennia, camel-driven caravans traced a 1,500 mile route between India and Egypt to trade in exotic frankincense, myrrh, sandalwood and rare spices. This fabled passage would become forever known as the Incense Road. Shoyeido celebrates the immense history and romance of this ancient path with three of our purest incense blends: Nan-zan, made of sweet frankincense; Nanto, fashioned of fine sandalwood; and Nanshu, a sultry, Chai-inspired fusion of cinnamon and spices.



**Nanzan** — Southern Mountain  
The best Frankincense ever used in an incense stick. Mellow and warm.  
**213302** **JPY 1,870** (1,700)  
60 sticks, 7 cm, with a holder



**Nanshu** — Southern State  
Nanshu incense blend summons the alluring fragrance of fine tea: rich and complex - and slightly mysterious.  
**213702** **JPY 1,870** (1,700)  
60 sticks, 7 cm, with a holder



**Nanto** — Southern Capital  
Distinctive Sandalwood with a sultry accent. Uplifting.  
**213402** **JPY 1,870** (1,700)  
60 sticks, 7 cm, with a holder



**Incense Road Assortment**  
**213801** **JPY 1,870** (1,700)  
60 sticks, 7 cm, with a holder  
20 sticks of each Nan-zan, Nanshu, Nanto

- ① **Nanzan** — Southern Mountain  
**213312** **JPY 770** (700)  
20 sticks, 7 cm, with a holder
- ③ **Nanto** — Southern Capital  
**213412** **JPY 770** (700)  
20 sticks, 7 cm, with a holder

- ② **Nanshu** — Southern State  
**213712** **JPY 770** (700)  
20 sticks, 7 cm, with a holder



The legendary Japanese story The Tale of Genji is one of the world's profound cultural achievements. Written by the Lady Murasaki in the early 11th Century as entertainment for the Empress Akiko, this thousand - year - old masterpiece lays claim to many literary firsts : the world's first true novel.

The first psychological novel. The first historical novel. The Tale of Genji is a window into a bygone world, providing a glimpse into the Japan of a millennium ago.

With The Genji Series, Shoyeido is pleased to evoke the scenes and sublime beauty of The Tale of Genji.



**Utakata** — Transient Dream  
**623601** **JPY 1,650** (1,500)  
20 sticks, 7 cm (4 scents, 5 of each), with a holder

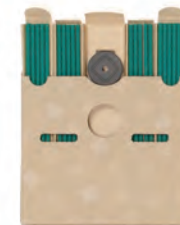

**Hanachirusato** — Field of Blossoms  
**620950** **JPY 880** (800)  
20 sticks, 7 cm, with a holder



**Hahakigi** — Beauty  
**621720** **JPY 1,650** (1,500)  
20 sticks, 7 cm (4 scents, 5 of each), with a holder

## FLORAL WORLD INCENSE ASSORTMENT

In the 1890s, SHOYEIDO developed Floral World cone-shaped incense in an effort to introduce Japanese incense to the world, thus becoming the first company in Japan to successfully export incense to the United States. Since that time, Floral World incense has continued to evolve and change, while being cherished by many people along the way. Once again, change is in store for this popular line of incense. We welcome you to enjoy these six rich fragrances, which evoke the lovely scent of a bouquet of flowers.

六種

花  
世  
界



RED

Rose

PURPLE

Lavender

BLUE

Iris

GREEN

Sandalwood

LIME GREEN

Jasmine

YELLOW

Freesia



### FLORALWORLD Incense Assortment - Cone

**220112** JPY 2,750 (2,500)  
30 pcs. (5 pcs. each of 6 scents),  
with a holder



### FLORALWORLD Incense Assortment - Stick

**220111** JPY 2,750 (2,500)  
60 sticks (10 sticks each of 6 scents),  
7 cm, with a holder

## FLORAL WORLD

Singular scent pack is available for each kind.  
Each scent is available in a unique package



60 sticks



30 pcs.

### Rose

#### Stick

**220131** JPY 2,750 (2,500)  
60 sticks, 7 cm, with a holder

#### Cone

**220132** JPY 2,750 (2,500)  
30 pcs., with a holder

### Iris

#### Stick

**220161** JPY 2,750 (2,500)  
60 sticks, 7 cm, with a holder

#### Cone

**220162** JPY 2,750 (2,500)  
30 pcs., with a holder

### Jasmine

#### Stick

**220181** JPY 2,750 (2,500)  
60 sticks, 7 cm, with a holder

#### Cone

**220182** JPY 2,750 (2,500)  
30 pcs., with a holder



### Lavender

#### Stick

**220141** JPY 2,750 (2,500)  
60 sticks, 7 cm, with a holder

#### Cone

**220142** JPY 2,750 (2,500)  
30 pcs., with a holder

### Sandalwood

#### Stick

**220171** JPY 2,750 (2,500)  
60 sticks, 7 cm, with a holder

#### Cone

**220172** JPY 2,750 (2,500)  
30 pcs., with a holder

### Freesia

#### Stick

**220191** JPY 2,750 (2,500)  
60 sticks, 7 cm, with a holder

#### Cone

**220192** JPY 2,750 (2,500)  
30 pcs., with a holder



## Incense Holder nana

This product is shaped as the numeral "7". In Japanese, "Nana" is the pronunciation for the number 7. Depending on the shape and style of your incense burner, users can attach this holder on the rim of a small bowl, or place it on a plate.



736515

JPY 2,420 (2,200)

Material: Zinc Alloy  
Surface: Gold plating  
W 3 x H 1.8 cm



2 ways by hanging it on rim of a bowl



5 ways by putting it on a plate

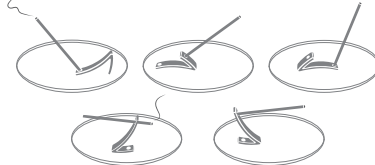

## Incense Tray takuba

"Takuba" is a simple and practical incense tray, which allows the user to burn an entire stick of incense, while leaving no unused portion when the stick is done burning. After use, it is simple and easy to clear the tray to be used again.

Available in 3 length variations.

Contents:  
1x Ceramic felt tray with  
Bamboo cover,  
1x Replacement Ceramic felt tray.



- ① **takuba 9cm**  
736505 JPY 4,070 (3,700)  
Usable Incense stick length: Under 7cm  
W 9 x H 2.8 cm
- ② **takuba 11cm**  
736510 JPY 4,400 (4,000)  
Usable Incense stick length: Under 9cm  
W 11 x H 2.8 cm
- ③ **takuba 19cm**  
736506 JPY 5,170 (4,700)  
Usable Incense stick length: Under 18cm  
W 19 x H 2.8 cm



## Incense Tray Black

737101

W 10 x H 10 cm

★ EXPORT-ONLY



## Silver Incense Holder

A simple yet sophisticated silver incense holder.

JPY 1,980 (1,800)

Material: Silver 925



### Cherry Blossoms

735201

W 2 x H 2 cm



### Maple

735202

W 2.1 x H 2.3 cm



### Plover

735203

W 2.1 x H 2.3 cm



### Snow

735204

W 2 x H 2 cm



2 sizes of holes

1 for Shoyeido's 7cm, thick stick incense

1 for Shoyeido's 13.5cm, thin stick incense

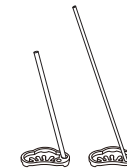

### Pine

735205

W 2.5 x H 1.3 cm



### G clef

735206

W 1.1 x H 2.5 cm



## Tweezers

736501

JPY 3,520 (3,200)

Material: Stainless, Rattan  
W 1.3 x L 8.5 x H 1.1 cm



2 ways for use

Easy to ignite  
short incense sticks.

Hold incense at any point.  
The length to burn can be  
adjusted.







**New Spring**  
– Hatsuharu  
734501



**Plum Blossoms**  
– Umemi  
734502



**Cherry Blossoms**  
– Hanasaki  
734503



**White Lilac**  
– Unohana  
734504



**Fujiyama**  
– Fujitosakura  
735945



**Rose**  
– Rose garden  
730404



**Lavender**  
– Lavender wreath  
730405



**Arabian Jasmine**  
– Maturika  
730406



**Stream**  
– Sanae  
734505



**Kingfisher**  
– Ryobo  
734506



**Morning Glory**  
– Tanabata  
734507



**Moon Viewing**  
– Tsukimi  
734508



**Freesia**  
– Freesia  
730407



**Japanese Iris**  
– Iris  
730408



**Lotus Flower**  
– Renge  
730409



**Best Wishes**  
– Tsurukame  
730410



**Autumn Ivy**  
– Momiji  
734509



**Small Chrysanthemum**  
– Shigure  
734510



**Winter Peony**  
– Shimofuri  
734511



**White Rabbit**  
– Harumachi  
734512



**Cat on Roof**  
– Kawaneko  
730411



**Greenery Lattice**  
– Hagoshi  
730412



**Indigo Arabesque**  
– Takokarakusa  
735807



**Octopus Vine**  
– Tobi-takokarakusa  
735808



**Pine Tree**  
– Matsu  
736401

★ EXPORT-ONLY

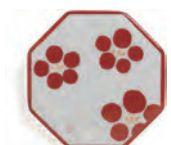

**Plum**  
– Umebachi  
736402

★ EXPORT-ONLY

## Precautions for using Incense Holder

Please stick incense into a holder, and securely stand it leaning in the direction of the holder's thicker part. Incense can fall if it is stood wrong.

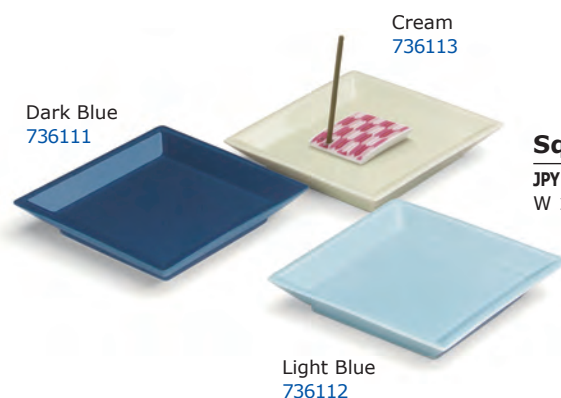
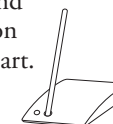

Cream  
736113

Dark Blue  
736111

Light Blue  
736112

## Square Porcelain Incense Tray

JPY 660 (600)  
W 10 x H 10 cm

## Porcelain Incense Holder

JPY 660 (600)

Square W 3.5 x H 3.5 cm  
Octagon W 3.5 x H 3.5 cm  
Circle W 4.0 x H 3.5 cm

Rectangle W 4.0 x H 3.0 cm  
Oval W 5.5 x H 2.8 cm

**Small Owl**

720146  
JPY 3,960 (3,600)  
H 9 cm  
/ ▲

**Owl**

720141  
JPY 5,280 (4,800)  
H 12 cm  
/ ▲ ◎

**Teddy**

720154  
JPY 6,160 (5,600)  
H 10 cm  
/ ▲

**Bunny**

720153  
JPY 6,160 (5,600)  
H 12.3 cm  
/ ▲

**Matroos**

720108 JPY 7,590 (6,900)  
H 17 cm  
/ ▲

**Child Guardian**

720183 JPY 5,280 (4,800)  
H 14 cm  
/ ▲

**Rabbit**

720145 JPY 5,280 (4,800)  
H 12 cm  
/ ▲

**Small Cat**

720184 JPY 4,180 (3,800)  
H 10 cm  
/ ▲

**Frog**

720147 JPY 4,180 (3,800)  
H 9 cm  
/ ▲

Usable shape of incense :  
/ stick ▲ cone ◎ coil

**Konoha**  
– Foliage

730201 JPY 2,530 (2,300)  
W 12.6 cm  
/ ▲

**Senbiki**  
– Lines

731102 JPY 3,300 (3,000)  
W 7.8 x H 4.8 cm  
/ ▲ ◎

**Miyuki Ichimatsu**  
– Checker

718102 JPY 6,050 (5,500)  
W 6.7 x H 6.2 cm  
/ ▲ ◎

## INCENSE CENSER

**① Tsuki**

724982

**② Sumi**

724981

JPY 5,500 (5,000)  
W 7 x H 8.2 cm

**Lantern**

724201 JPY 3,850 (3,500)  
W 6.5 x H 9 cm

**Nanban Style**

724211 JPY 5,500 (5,000)  
W 6 x H 9 cm

**Oribe Green**

724921 JPY 6,600 (6,000)  
W 6.5 x H 9.5 cm

**Tinted Ivy**

724503 JPY 9,900 (9,000)  
W 5.8 x H 8.5 cm

**Cloisonne**

724506 JPY 29,700 (27,000)  
W 5.8 x H 9.5 cm

**How to use Incense Censer**

Remove the lid and place Miyako Ash in to the incense censer. Light the tip of the incense and fan out of the fire flame. Insert the stick incense in to the ash or place coil/cone incense on the ash.

\* We recommend removing the lid while burning incense. In many cases the lid will restrict the flow of oxygen and can extinguish the incense.

**Miyako Ash**

751101 JPY 220 (200)  
Use with  
incense censer  
30 g

Sachets are Non-burning incense items which release a fragrance in its natural, unheated state.

Historically, Japanese fragrant sachets have consisted of a plain or brocade cloth bag with "Nioi-koh" - a powdered mix of natural ingredients such as clove, camphor and sandalwood - inside.

Shoyeido's fragrant sachets continue this long-held style.

In a closet



In a drawer



In a Bathroom



In a Car



Fragrant sachet is appropriate for use in a car, closet or in a bag to give your clothing and personal articles a pleasant fragrance.

Following 300-year-old recipes, Shoyeido's traditional sachets are available in colorful cloth, brocade and paper envelopes. They can be used in a pocket, on a purse, or in drawers, closets, suitcases, cars, etc. They add a subtle fragrance of sandalwood and herbs.

## Premium Quality - Mild sweet fragrance



### Miyako

512111 JPY 1,045 (950)  
H 6 cm

## Extra Fine Quality - Refreshing fragrance



### Kaoru

511211 JPY 1,045 (950)  
H 6 cm  
Kyoto Nishijin silk Pouch



### Gokuhin

511111 JPY 825 (750)  
H 6 cm

## Fine Quality - Refined, clean fragrance

### Colors



### Johin

510111 JPY 715 (650)  
H 5 cm



### Fukube

510140 JPY 550 (500)  
H 5.5 cm

## Utsusemi - Sweet and fresh fragrance



### Utsusemi

620440 JPY 440 (400)  
W 5.5 x H 8.5 cm

## Nio - Clean, slightly bitter fragrance



### Nio

624901 JPY 440 (400)  
W 5.5 x H 8.5 cm





## Flower Wheel

514151 JPY 1,045 (950)

W 7.5 cm

Colors: Red, Purple, Black, Pink, Light Blue and Beige



## Tagasode -Kakeru-

Tagasode Kakeru, the fragrant hanging sachet, emits a pleasant fragrance that is appropriate for use in closets to give clothing a refreshing scent. It is also effective to enliven a restroom or any personal space.

JPY 1,045 (950)  
W 7.2 × H 16.8 cm



Beige  
519511

Black  
519512



## Sachet

The beautifully designed Japanese traditional pattern adds an aesthetic highlight.

\*The pattern and color are selected randomly.

## How to use

Will hang appropriately on any closet bar or hanging apparatus that is less than 35mm in outside diameter. It is also effective to enliven a restroom or any personal space.



# INCENSE FOR MIND AND ATMOSPHERE

It is widely believed that incense was brought to Japan over 1400 years ago, along with the conveyance of Buddhism.

Historically, Japanese Incense has often been cherished and used for religious occasions, in the social routine of samurai warriors, and more.

During the Edo period, incense became popular among all classes, as it was established as a tradition for all Japanese culture.

Centuries later, the Japanese style of living has changed but the appreciation and pride for incense in Japanese culture remains the same. We are pleased to convey the concept of “life with fragrance” to our customers.



## KUNJYUKAN



### Play, Learn and Experience Incense!

"KUNJYUKAN." It opens with space to experience Shoyeido's incense, gallery and hall ... a place to meet and mingle with fragrance, where visitors can experience Japanese incense culture.

#### Highlight

##### Ground floor: Koh-labo "Exploring Incense"

*Koh-labo*, "Exploring Incense," is a section where visitors can experience various fragrances. Hung from the ceiling are white boxes, along with white poles in front of mural of a tropical rainforest. While this space may at first appear mysterious, it will introduce you to new fragrances. Let's take the first step in exploring the world of incense!

KUNJYUKAN website (English Language)  
[www.kunjyukan.jp/english/](http://www.kunjyukan.jp/english/)



## Kyoto Main Store & KUNJYUKAN ACCESS

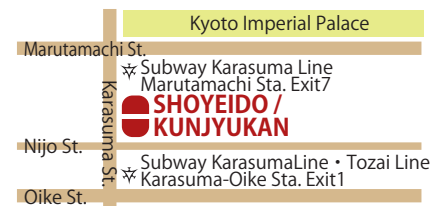

3-minute walk from Subway Karasuma Line, Marutamachi Sta. Exit 7

5-minute walk from Subway Karasuma Line, Tozai Line Karasuma Oike Sta. Exit 1

Limited parking is available

**[Store]** Tax-free  
 Open year round (except New Year's Day)  
 9am - 6pm

**[KUNJYUKAN]**  
 Koh-labo, Gallery  
 Open 10am - 5pm (Irregular holidays)

**Address:** Karasuma Nijo Nakagyo-ku, Kyoto 604-0857 Japan  
**Tel:** +81-75-212-5590

## SHOYEIDO STORE



SHOYEIDO stores are located in Kyoto, Osaka, Tokyo, Yokohama and Sapporo. Please see the information on the website.  
<https://www.shoyeido.co.jp/english/stores/>



## Gift Of Nature

— Traditional Japanese Incense from the Finest Ingredients —



Agarwood



Sandalwood



Cinnamon



Clove



Star Anise



Turmeric



Patchouli



Frankincense



Borneol



香老鋪 松榮堂

**SHOYEIDO INCENSE CO.**

Karasuma Nijo, Nakagyo-ku, Kyoto 604-0857 Japan

TEL : +81-75-212-5590 FAX : +81-75-212-5595

[www.shoyeido.co.jp](http://www.shoyeido.co.jp)

**Shoyeido USA, Inc.**

1700 38th St., Boulder, CO 80301 U.S.A.

TEL : +1-800-786-5476

[www.shoyeido.com](http://www.shoyeido.com)