

SpaceLogic KNX 4" Touch Unit

All-in-one control

se.com



Life Is On

Schneider
Electric

Table of contents

Introducing the
new 4" Touch Unit

1

Design and user
interface

2

Easy installation

3

A multitude of
features

4

All in one control,
everywhere

5

Competitive advantage:
Sustainability

6

SpaceLogic KNX 4" Touch Unit

Are you in need of a single device to control your customers' KNX smart homes or buildings? Something that's straightforward to plan, install, and configure? Then you need the new **SpaceLogic KNX 4" Touch Unit**, an amazing device that will make your customers happy with its combination of a thermostat and a multifunctional push-button along with the intuitive operations of a smartphone or tablet.

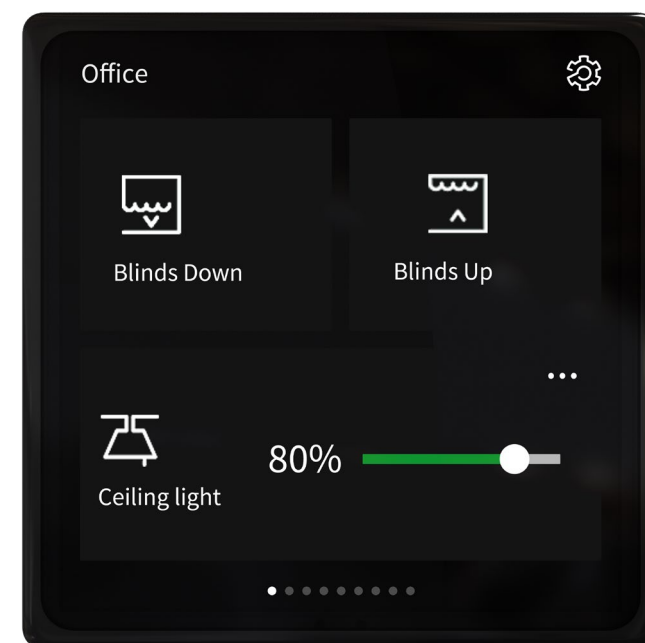

Introducing the new 4" Touch Unit

Design and user interface

Easy installation

A multitude of features

All in one control, everywhere

Competitive advantage: Sustainability



Design and User Interface



The innovative, frameless design of this 4" Touch Unit will convince your customers. It will fit any interior and goes along with any kind of push-button designs. Its slender structure creates a modern and elegant appearance in homes, offices, and hotels. On the high-resolution display, several functions and tailored scenes can be put in place easily and intuitively.

- Frameless design
- Low profile
- 4 inch LCD Touch screen (10 cm)
- High resolution display 480 x 480 px
- Intuitive operation
- Up to 6 functions on 9 screens
- Plain symbols
- Free text
- Personalized screensaver and background image
- Tailored icons / symbols

Limitless capabilities

The 4" Touch Unit gives you maximum freedom. You can manage one or more rooms from one spot, thanks to its nine screens and up to six functions each.



1 function



2 functions

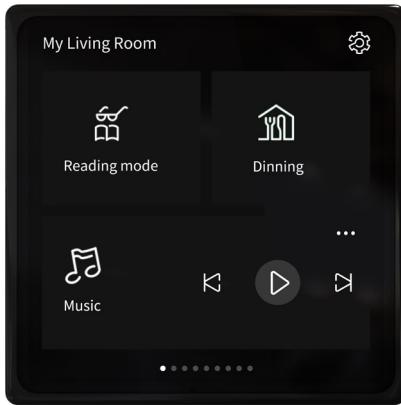

3 functions

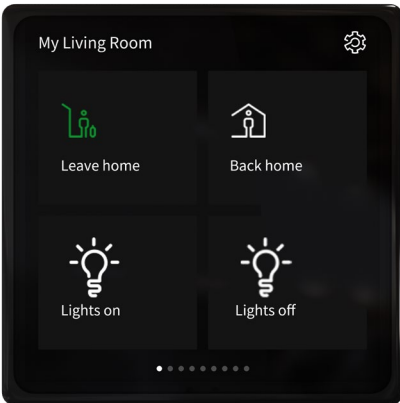

4 functions



5 functions

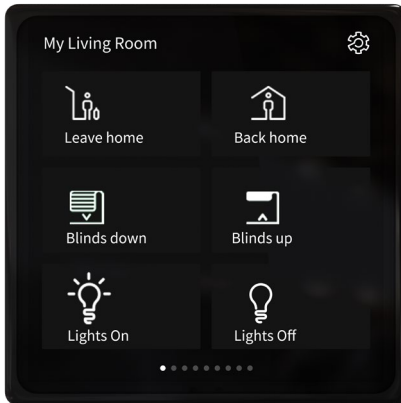

6 functions



Easy installation

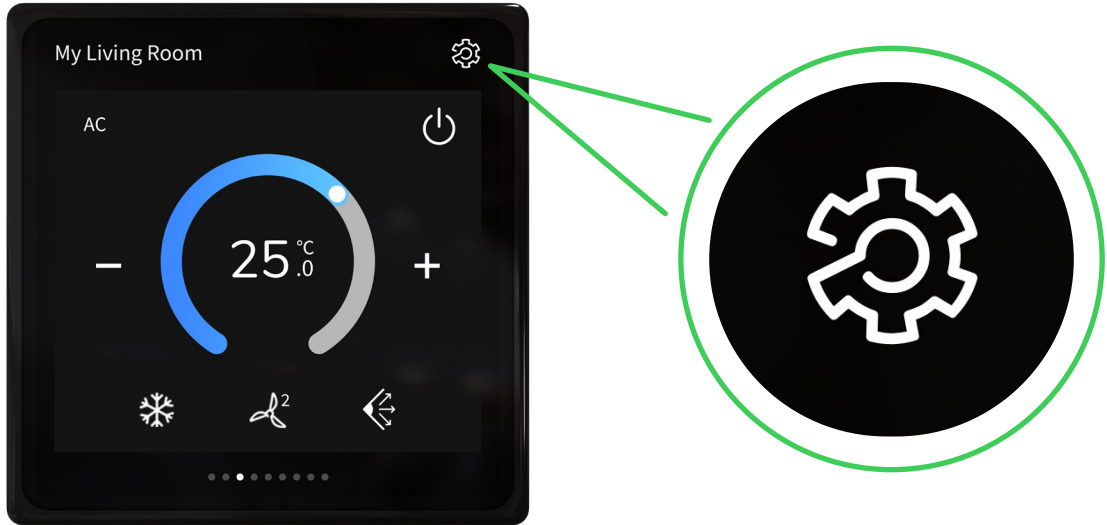
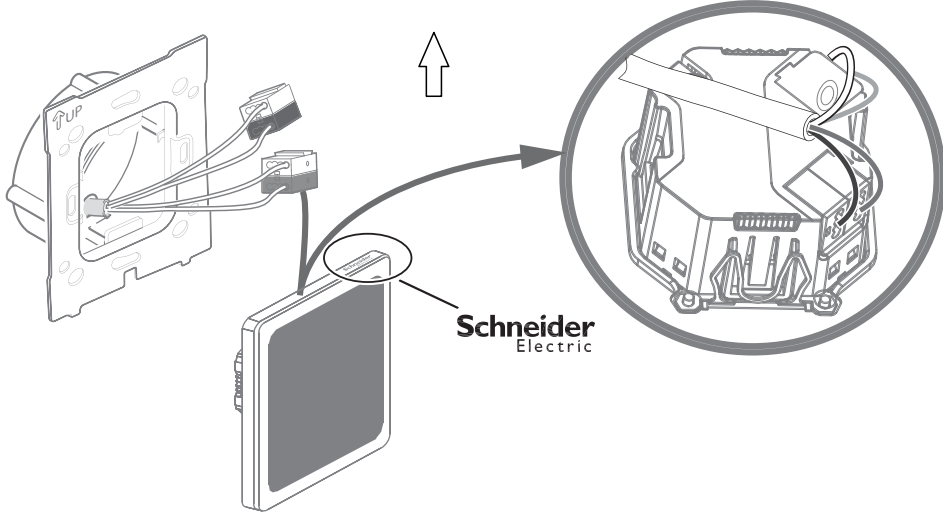
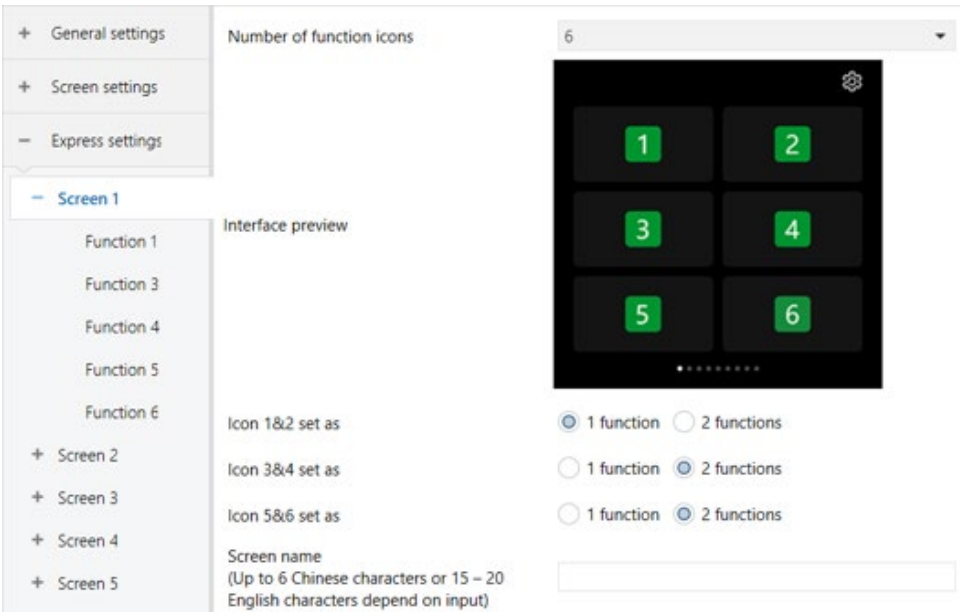

ETS

The user-friendly and structured ETS enables you to accurately program the devices the first time, eliminating errors and increasing the speed of the installation. The product has express settings in ETS, allowing most functions to be quickly and effortlessly configured.

Easy installation, new build or retrofit

The 4" Touch Unit is installed on a CEE60 flush-mounted box. KNX bus and auxiliary power can be supplied in one cable. The device is compatible with both new or retrofitting projects. Any existing KNX installation can be quickly upgraded with the addition of the new KNX 4" Touch Unit: replace a KNX push-button with unit and control more functions from a central location.

Front programming mode

The already installed device can be switched to programming mode from the settings symbol on the display – without having to remove it. The display's background, brightness, date and time can be adjusted from the front.

A multitude of features

The numerous and practical features leave nothing to be desired by the customer

- The **integrated temperature sensor** allows for the current ambient temperature to be shown
- The **proximity sensor** activates the display without needing to be touched
- The **orientation light** can be switched on and used as such in night mode
- The **cleaning mode** prevents unintentional activation by setting the display to inactive for a pre-set period of time
- A **stand by / night mode** lowers energy consumption and prolongs the lifetime of the display
- A **locking function** safeguards the device from potential damage and displays a clear symbol when it has been activated.
- An optional **pin-code based device access** offers added protection, such as in public spaces
- The **micro USB** interface allows custom icons, backgrounds and screensavers to be uploaded
- Three background themes can be selected

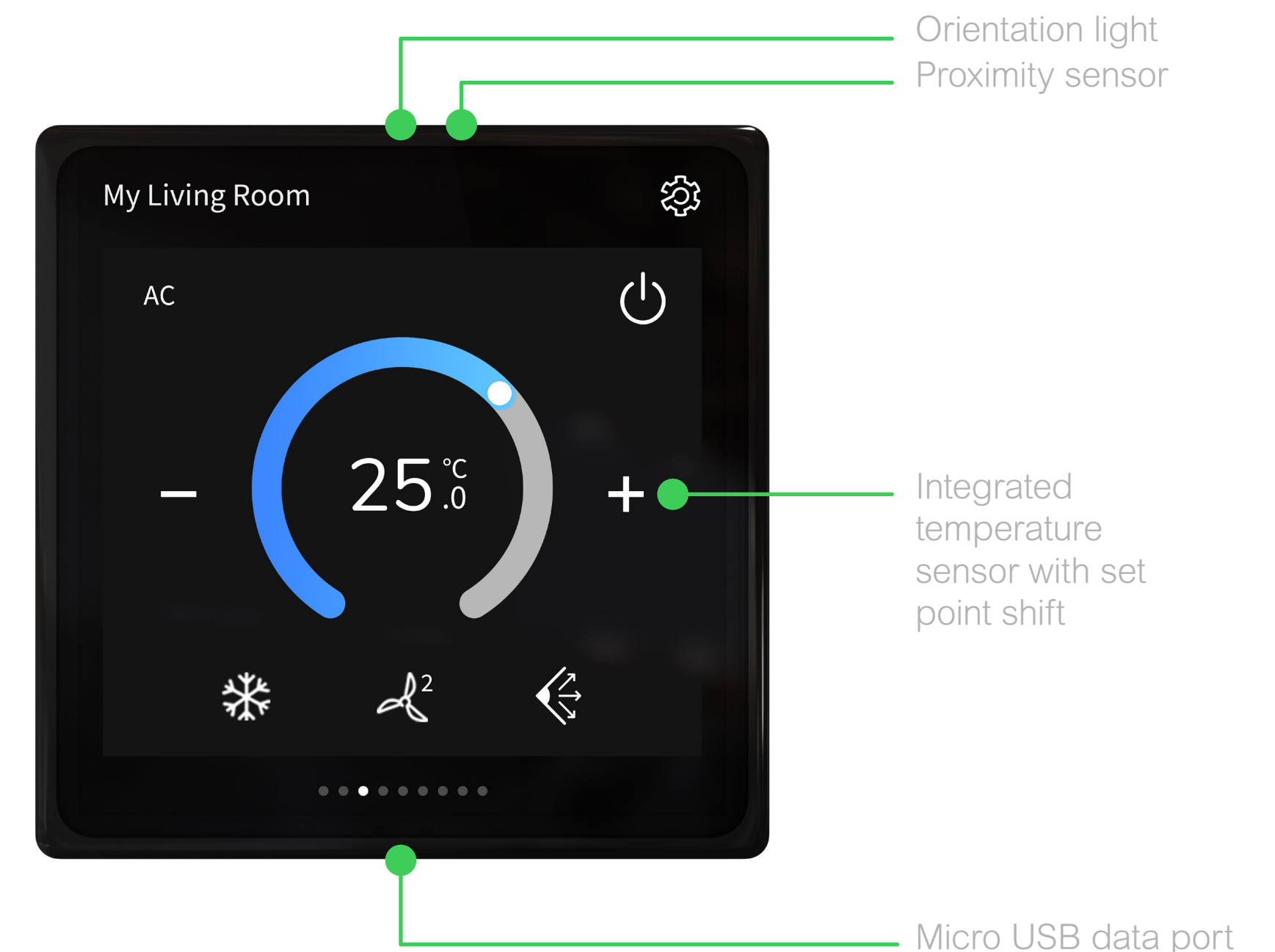

All in one control

The new 4" touch unit is the ideal choice for the comprehensive control of all building functions in one go, and its energy monitoring can assist in finding ways to reduce energy usage.

- Switch
- Dimmer, RGB and RGBW control,
- Temperature control
- Temperature set point shift
- Air Condition
- Fan coil
- Air quality
- Blinds, curtains and shutters
- Scenes
- Audio
- Monitor Energy consumption
- Time and date as screensaver



A device that looks great everywhere



Home

This new 4" touch unit is the perfect choice for smart home residents that want an effortless, intuitive control of all building functions from a single point.



Office

In the office, the device impresses with its numerous functions, the intuitive operation thanks to the clear icons and the individual labeling.



Hotel

The unified control of building functions is extremely practical and time-saving for hotels. The customizable screensavers and backgrounds can also help add unique branding to the hotel.

Sustainability is your competitive advantage

Schneider Electric's purpose is to empower all to make the most of our energy and resources, bridging progress, and sustainability for all. We call this Life Is On.

Sustainability and the consistent keeping of valuable resources are increasingly determining our actions and our everyday life. Our goal at Schneider Electric is also to enable the optimal use of energy and resources for everyone, paving the way for progress and the sustainability that goes with it.

With Schneider Electric, you can actively reduce carbon footprint, optimize energy consumption and draw the environmentally conscious to your properties.



Comply with **environmental regulations**

Be seen as compliant with and aligned to the regulatory roadmap being laid out by policymakers to prepare for an energy-efficient future.



Meet **consumer needs** and **investor requests**

Build your reputation as a developer of homes of the future and futureproof buildings, that are smart and sustainable and cater to the new trends and demands of the residential and building markets.



Increase returns through **added value**

The unified control of building functions is extremely practical and time-saving for hotels. The customizable screensavers and backgrounds can also help add unique branding to the hotel.



Life Is On

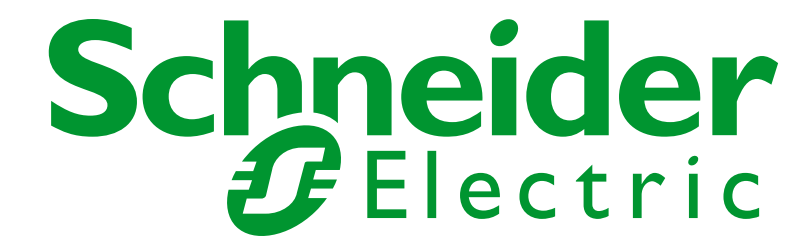

To learn more information about the
Schneider Electric visit

se.com



Schneider Electric

35 rue Joseph Monier
92500 Rueil-Malmaison, France
Tel : +33 (0)1 41 29 70 00

