



Simple all pneumatic operation,
no electrics.



Nylon pistons, light, robust and easy
to clean and change.



Bench mounted as standard,
optional floor stand.

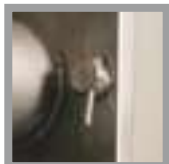

Camlock tube location, making even bent
tube removal easy.



Works with standard 460 mm Scotnet
Tubes. Minimise investment by keeping
your existing loader and tubes.



Braked Castors on optional floor stand
ensuring secure footing while working
and easy movement when required.



Simple operation, simply close lid
to start operation



TECHNICAL INFORMATION

Speed

The machine will cycle over 800 times per hour.
Production speeds will depend on the product
and the input and output flow to the machine.

Weight

Approximately 100 kg

Services

Compressed Air

80 psi or 5.5 BAR

50 ft³ or 1500 litres per minute

Packing Crate Dimensions

Length 1800 mm x Width 760 mm x Height 1460 mm

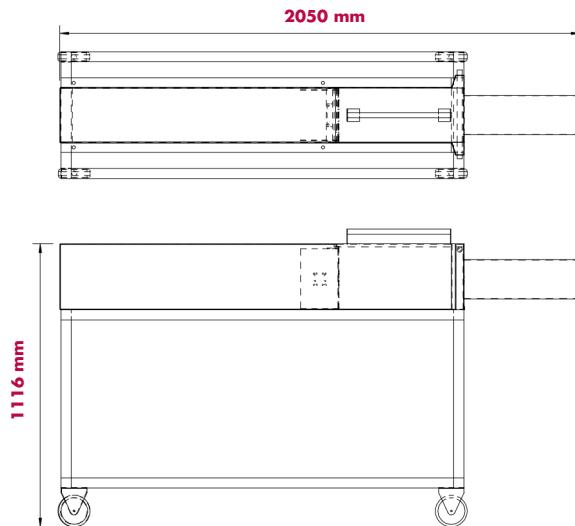

**MACHINE DIMENSIONS
(WITHOUT STAND)**
320mm x 316mm x 1590 mm

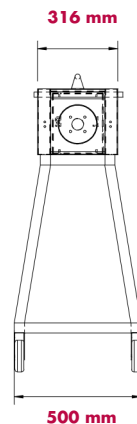

Please note: dimensions are subject to change without notice.



Compliant with the latest safety standards

All contact parts manufactured from 316 Stainless Steel – safe for food contact.

T +44 (0) 1355 244244 E info@scotnetsolutions.com | www.scotnetsolutions.com



Simple all pneumatic operation,
no electrics.



Designed to take standard collagen rolls.

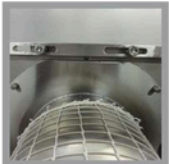

Secure tube location



Camlock tube location, making even bent
tube removal easy.

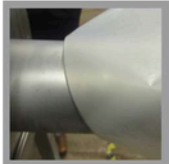

Smooth collagen former easily
changed without tools.



Collegen former with cut out sections
for less friction and easy film feeding.



TECHNICAL INFORMATION

Speed

The machine will cycle over 600 times per hour.
Production speeds will depend on the product and the input and output flows to and from the machine.

Weight

Approximately 130 kilos

Services

Compressed Air

80 psi or 5.5 bar
50ft³ or 1500 litres per minute

Packing Crate Dimensions

Length 2500mm x Width 760mm x Height 1500mm

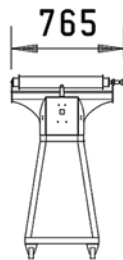
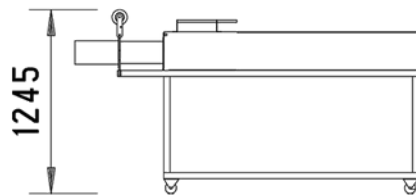
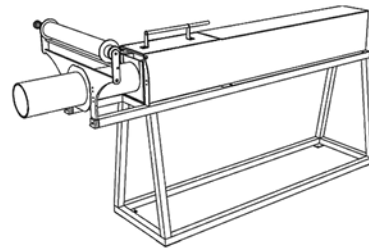
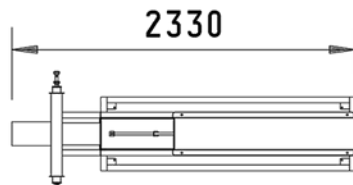
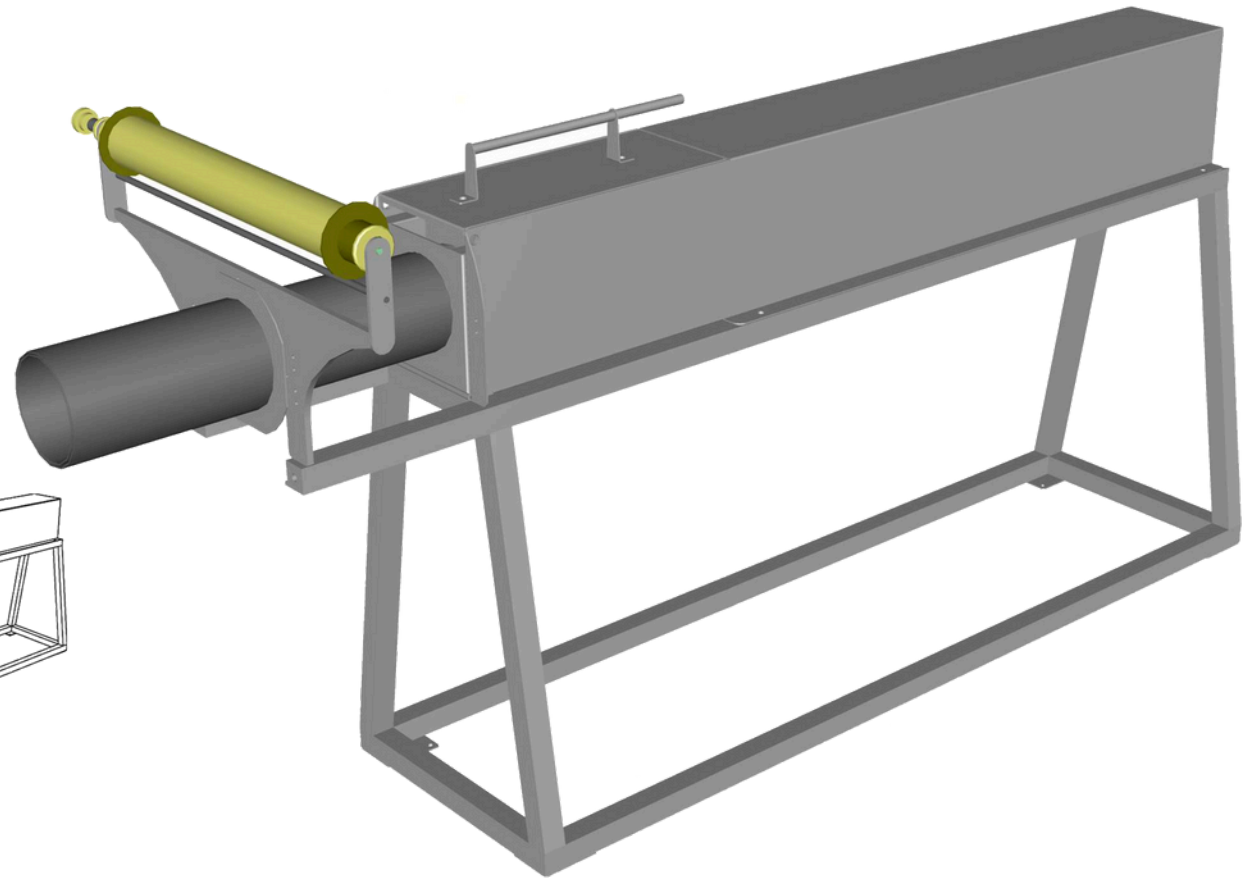

Please note dimensions are subject to change without notice.



Compliant with the latest safety standards

All contact parts manufactured from 316 Stainless Steel—safe for food contact.

T +44 (0) 1355 244244 E info@scotnetsolutions.com | www.scotnetsolutions.com





Information Screen controlling machine functions and reporting output and efficiency figures.



Chamber sides open for easy cleaning and fast tool-less size change.



Gutters and Drains to catch any ingressing liquids.



Emergency Stop buttons mounted on both sides.



Breaked Castors, ensuring secure footing while working and easy movement when required.



Water resistant electrical cabinet.



Simple manifold mounted pneumatic cabinet for easy maintenance.



Cam Tube Location System allowing for easy location of slightly bent tubes.

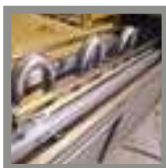

Swan Neck cable system to eliminate water ingress.

OPTIONS

AWI Automatic Water Injection

Injects a fine spray of water into each chamber each cycle to allow easy movement of dry products such as pork.

SSL Selectable Stroke Length

Allows shortening of piston strokes, to optimise shape.

APH Automatic Piston Hold

Pausing the piston in its outward position, to allow further shaping of the product.

Available in all sizes from 75 – 200 mm

EH version available for tube sizes up to 250 mm



TECHNICAL INFORMATION

Speed

The machine will cycle at over 1200 units per hour.
Production speeds will depend on the product and the input and output flow to the machine.

Weight

Approximately 400 kg

Services

Compressed Air

Pressure: 80 psi or 5.5 BAR

Flow: 46 ft³ or 1320 litres per minute

Electrical

230 V, Single phase, 5 amp supply

Packing Crate Dimensions

Length 2590 mm x Width 1160 mm x Height 1550 mm

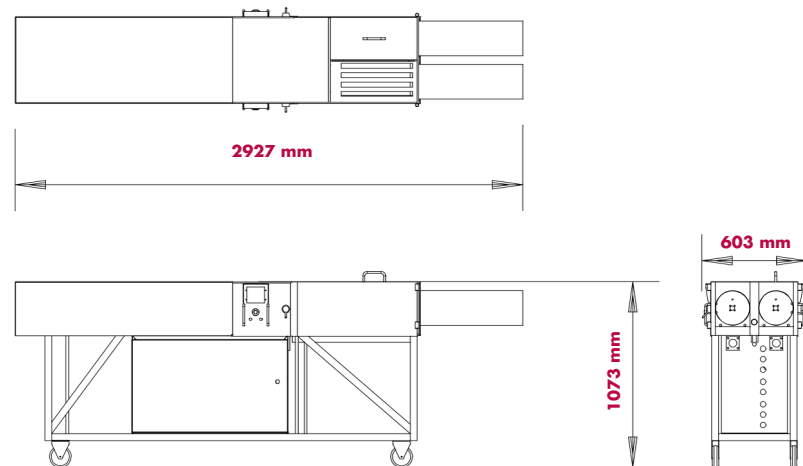

Please note: dimensions are subject to change without notice.

