



Thanks for your interest  
See more at [www.ngi-global.com](http://www.ngi-global.com)

Export VAT No.: DK 34184283  
VAT No.: DK 20861770

**NGI Denmark (Main office)**  
NGI A/S  
Virkelyst 5  
DK-9400 Nørresundby  
Denmark

Phone: +45 98 17 45 00  
E-mail: [ngi@ngi.dk](mailto:ngi@ngi.dk)

**NGI USA**  
805 Satellite Blvd  
Suwanee, GA 30024  
USA

Phone: + 1 (646) 201 9410  
Fax: + 1 (646) 837 0924

**NGI Italy**  
Via Guglielmo Jervis 4  
10015 IVREA TO  
Italy

Phone: +39 0775 68 70 10  
Fax: +39 0775 61 01 35

All NGI hygienic components are  
**design and patent protected**

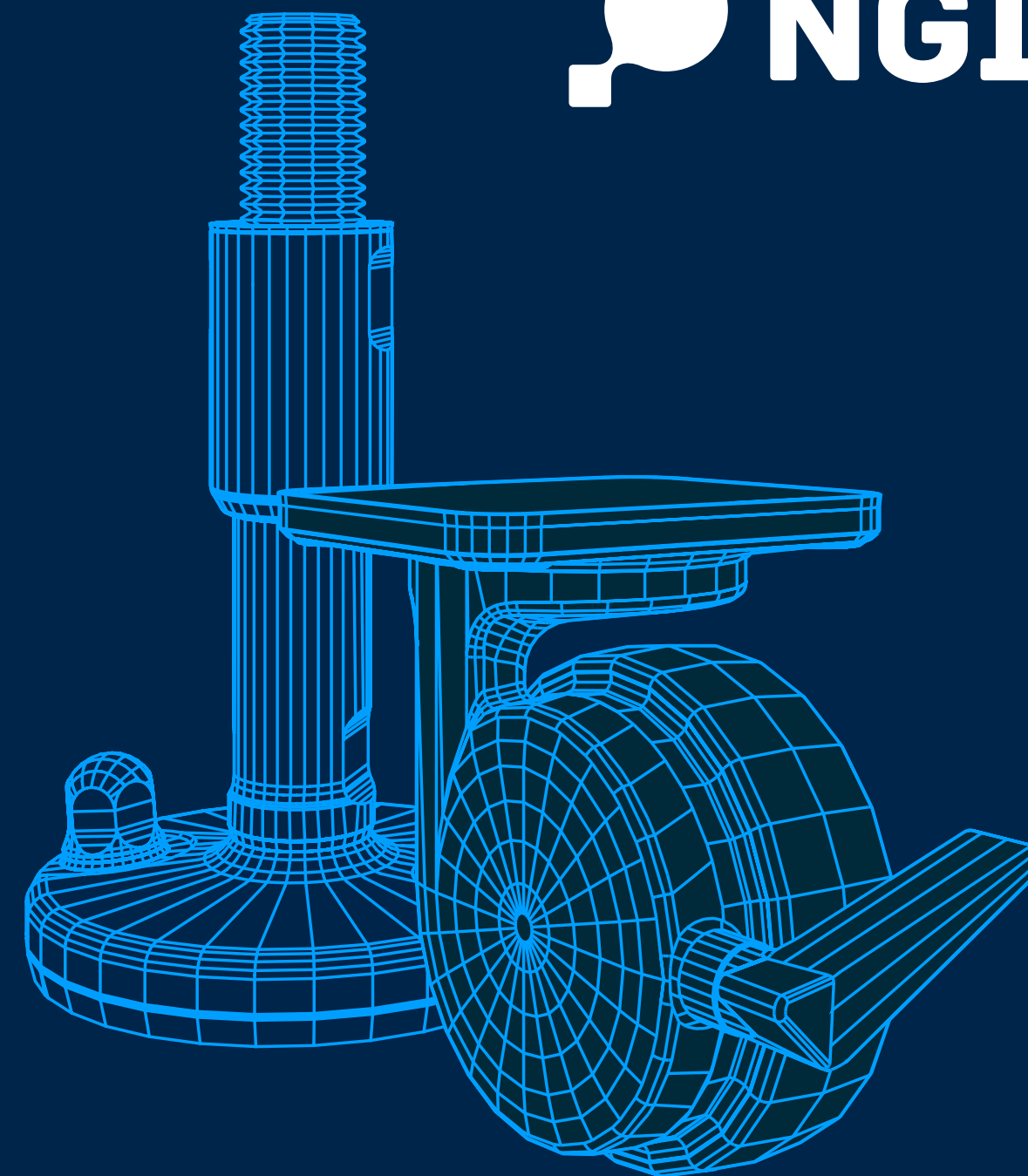

# Hygienic Components

# Certified hygienic Levelling feet



THE only levelling feet in the world hygienically  
certified by 3-A, USDA & EHEDG standards  
for use in sanitary production environments

Self-draining surfaces, sealed movable parts and  
no exposed thread secures absolute minimum cleaning and  
maximum sanitary safety

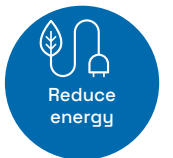

Certified  
hygienic



Minimized  
cleaning time



Minimized  
water usage

# Certified hygienic Levelling feet

All process industries are subject to increasing regulatory requirements, which increases the focus on resource consumption, product safety and official hygienic certifications. The 3-A, USDA and EHEDG certified levelling feet reduce the water consumption and cleaning resources in addition to minimizing the risk of contamination in the production. Choosing NGI's certified levelling feet will hygienically enhance your machinery and your customer's Return-On-Investment (ROI). All certified hygienic levelling feet with fastening to floor are delivered with certified hygienic nuts.

## Product Group Features

- EHEDG certification "TYPE EL – 1st CLASS" and 3-A certification "88-00"
- USDA certification "Dairy" and "NSF/ANIS/3-A 14159-1-2014"
- Self-draining surfaces and safety against exposed thread secures absolute minimum cleaning
- Low-friction washer between spindle and footplate ensures easy adjustment
- All movable parts are 100% hygienically sealed even if the load on the foot is removed
- Vulcanized FDA-approved, anti-vibration, anti-slip rubber blocks out bacteria underneath the footplate
- Stainless steel AISI 304/A2, 1.4301. Optional AISI 316/A4, 1.4401
- More than 1.000 different variations available (weight load, height-adjustment, flexible mounting parts)
- All sealings are blue and therefore detectable by scanning systems
- Design and patent protected

## ZHJS

### Special Features

- Height variation 107 mm – 199 mm
- Weight load up to 110.000 N due to solid footplate & vulcanized rubber
- 3-A logo & EHEDG logo on footplate for certified recognition
- Thread covered with hygienic sleeve functioning as counter nut
- Optional hygienic top cover
- Safety against exposed thread
- Optimized design for cleaning
- Surface below 0,8 µm RA
- 2 X fixing to the floor
- Extra hygienic sealings
- Delivered with hygienic nuts



40

## XH

### Special Features

- Height variation 104 mm – 206 mm
- Weight load up to 65.000 N
- 3-A logo on footplate for certified recognition
- Thread covered with hygienic sleeve functioning as counter nut
- Optional top cover
- Optional fixing to the floor including hygienic nuts

46

## ZHJC

### Special Features

- Height variation 107 mm – 199 mm
- Weight load up to 110.000 N due to solid footplate & vulcanized rubber
- 3-A logo & EHEDG logo on footplate for certified recognition
- Thread covered with hygienic sleeve functioning as counter nut
- Optional hygienic top cover
- Optimized design for cleaning
- Surface below 0,8 µm RA
- 2 X fixing to the floor
- Extra hygienic sealings
- Delivered with hygienic nuts



42

## XHG + XHJ

### Special Features

- Height variation 101 mm – 197 mm
- Weight load up to 110.000 N due to solid footplate & vulcanized rubber
- 3-A logo on footplate for certified recognition
- Thread covered with hygienic sleeve functioning as counter nut
- Optional top cover
- Optional fixing to the floor including hygienic nuts

50

## ZHFVJ

### Special features

- Height variation 96 mm – 327 mm
- Weight load up to 95.500 N due to solid footplate & vulcanized rubber
- 3-A and EHEDG logo on footplate for certified recognition
- 3-A, EHEDG & USDA certified
- Sealed low-friction thread (lubricated for life)
- Flexible mounting with optional flanges or thread adaptor
- Optimized design for cleaning
- Surface below 0,8 µm RA
- 2 X fixing to the floor
- Extra hygienic sealings
- Delivered with hygienic nuts



44

## XHT

### Special Features

- Height variation 109 mm – 208 mm
- Weight load up to 75.000 N
- The footplate and spindle are two separate parts
- Diametrically centered elevation on the footplate
- 3-A logo on footplate for certified recognition
- Thread covered with hygienic sleeve functioning as counter nut
- Optional top cover

54

# Certified hygienic Levelling feet

All process industries are subject to increasing regulatory requirements, which increases the focus on resource consumption, product safety and official hygienic certifications.

The 3-A, USDA and EHEDG certified levelling feet reduce the water consumption and cleaning resources in addition to minimizing the risk of contamination in the production.

Choosing NGI's certified levelling feet will hygienically enhance your machinery and your customer's Return-On-Investment (ROI).

All certified hygienic levelling feet with fastening to floor are delivered with certified hygienic nuts.



## XHFV

### Special Features

- Height variation 99 mm – 335 mm
- Weight load up to 65.000 N
- 3-A logo on footplate for certified recognition
- Sealed low-friction thread (lubricated for life)
- Flexible mounting with optional flanges or thread adaptor
- No risk of over-adjusting the sleeve and thereby exposing thread
- Optional fixing to the floor including hygienic nuts

56



## XHW

### Special Features

- Height variation 115 mm – 218 mm
- Weight load up to 5 ton
- Spindle sizes M16, M20, M24, M30 & M36
- Footplate sizes Ø 80, Ø105, Ø125 & Ø150 mm
- Admits up to 5° slope on floors and equipment
- Vulcanized FDA-approved, anti-vibration, anti-slip rubber
- Thread covered with hygienic sleeve functioning as counter nut

66



## XHFVG + XHFVJ

### Special Features

- Height variation 96 mm – 326 mm
- Weight load up to 110.000 N due to solid footplate & vulcanized rubber
- 3-A logo on footplate for certified recognition
- USDA certified
- Sealed low-friction thread (lubricated for life)
- Flexible mounting with optional flanges or thread adaptor
- Optional fixing to the floor including hygienic nuts

60



## XHGW + XHJW

### Special Features

- Height variation 115 mm – 217 mm
- Weight load up to 5 ton
- Spindle sizes M16, M20, M24, M30 & M36
- Footplate sizes Ø105, Ø125 & Ø150 mm
- Admits up to 10° slope on floors and equipment
- Thread covered with hygienic sleeve functioning as counter nut

68



## XHFVT

### Special Features

- Height variation 104 mm – 335 mm
- Weight load up to 75.000 N
- The footplate and spindle are two separate parts
- Diametrically centered elevation on the footplate
- 3-A logo on footplate for certified recognition
- 3-A & USDA certified
- Sealed low-friction thread (lubricated for life)
- Flexible mounting with optional flanges or thread adaptor

64



## XHTW

### Special Features

- Height variation 115 mm – 218 mm
- Weight load up to 5 ton
- Spindle sizes M16, M20, M24, M30 & M36
- Footplate sizes Ø105, Ø125 & Ø150 mm
- Admits up to 5° slope on floors and equipment
- Vulcanized FDA-approved, anti-vibration, anti-slip rubber
- Thread covered with hygienic sleeve functioning as counter nut
- Separated spindle from weighing footplate makes maintenance easier
- Spindle indirectly connected to the load cell through the footplate

72



# Certified hygienic Levelling feet

All process industries are subject to increasing regulatory requirements, which increases the focus on resource consumption, product safety and official hygienic certifications. The 3-A, USDA and EHEDG certified levelling feet reduce the water consumption and cleaning resources in addition to minimizing the risk of contamination in the production. Choosing NGI's certified levelling feet will hygienically enhance your machinery and your customer's Return-On-Investment (ROI). All certified hygienic levelling feet with fastening to floor are delivered with certified hygienic nuts.

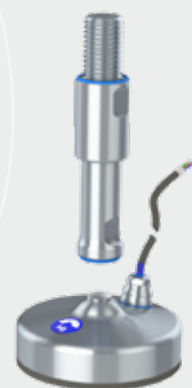

## XHGTW

### Special Features

- Height variation 115 mm – 217 mm
- Weight load up to 5 ton
- Spindle sizes M16, M20, M24, M30, M36
- Footplate sizes Ø105, Ø125 & Ø150 mm
- Admits up to 10° slope on floors and equipment
- Separated spindle from weighing footplate makes maintenance easier
- Spindle indirectly connected to the load cell through the footplate.

74



## XHJSE (S)

### Special Features

- Height adjustment 155 mm - 285 mm
- Certified according to USDA hygienic standard
- Designed according to the 3-A and EHEDG hygienic standards
- Available in two standard lengths per diameter size
- Comes with a hygienic sleeve
- Circular arrangement of anchors for best seismic performance
- Spindle sizes M30, M36, M42, M48 & M56 mm

76



## XHJSE (L)

### Special Features

- Height adjustment 221 mm - 355 mm
- Certified according to USDA hygienic standard
- Designed according to the 3-A and EHEDG hygienic standards
- Available in two standard lengths per diameter size
- Comes with a hygienic sleeve
- Circular arrangement of anchors for best seismic performance
- Spindle sizes M56, M64, M72, M80 & M90 mm

78

# Instructions

It is important to follow these instructions in order to ensure the certified hygienic design and functionality. This documentation is enclosed with the levelling feet and should always be handed over to the enduser.



## CLEANING & MAINTENANCE

This cleaning and maintenance manual describes how to clean and maintain the levelling foot once installed.

80

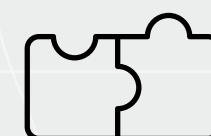

## INSTALLATION MANUAL

This installation manual describes how to install the levelling foot onto the machine or equipment for which it is intended to support.

81



## DECLARATION OF CONFORMITY

This declaration of conformity lists all the directives and standards that NGI adheres to. This ensures that products from NGI are always in compliance with currently valid requirements.

84

# Certified hygienic Accessories

NGI is able to deliver all necessary accessories, which ensures a quick and easy installation of the levelling foot. In addition to supplying standardized accessories we are also able to supply customized accessories.

It is important to follow these instructions in order to ensure the certified hygienic design and functionality.



## CERTIFIED HYGIENIC DOME-HEADED NUT

- Certified in accordance with EHEDG hygienic standard TYPE EL - CLASS I AUX
- Minimizes cleaning time and water consumption
- Surfaces with a maximal roughness of 0,8 µm RA
- Available in sizes M6-M24
- Are delivered with all certified hygienic machine feet with floor fixing



306



## CERTIFIED HYGIENIC TOP COVER

- Top cover with blue sealing detectable by scanning systems
- Ensures hygienic covering of the exposed top thread
- Minimum cleaning effort due to the self-draining design
- Available in standardized and customized dimensions

312



## CERTIFIED HYGIENIC LOW-HEADED NUT

- Certified in accordance with EHEDG hygienic standard TYPE EL - CLASS I AUX
- Minimizes cleaning time and water consumption
- Surfaces with a maximal roughness of 0,8 µm RA
- Available in sizes M5-M24



308



## CERTIFIED HYGIENIC FLANGES & ADAPTOR

- Add-on for the XHFV & ZHFVJ system
- Adaptor converts the size and type of the thread and extends the sleeve. It has blue sealings detectable by scanning systems.
- Flanges are squared or round and installed by bolting or welding. They are available in a large variety of sizes.

314



## CERTIFIED HYGIENIC BOLT

- Certified in accordance with EHEDG hygienic standard TYPE EL - CLASS I AUX
- Minimizes cleaning time and water consumption
- Surfaces with a maximal roughness of 0,8 µm RA
- Available in sizes M5-M24



310

# Certified hygienic Levelling feet - ZHJS

The design and patent protected solid ZHJS levelling foot is the optimal choice for heavy machinery and equipment that has to comply with the strictest hygienic requirements.

The thread is covered with a hygienic sleeve which cannot be overadjusted and secures safety against exposed thread. The sleeve also functions as a counter nut. The ZHJS is designed to be fastened to the floor by the two fixing holes in the footplate. Hygienic nuts according to EHEDG specifications are included.

All movable parts are 100% hygienically sealed even if the load on the foot is removed. All sealings are blue and therefore detectable by scanning systems.

Minimum cleaning effort is obtained by the design of the self-draining 0,8 µm RA surfaces. Additionally, the foot is hygienically sealed to the floor by vulcanized FDA-approved, anti-vibration, anti-slip rubber, which blocks out bacteria underneath the footplate.

#### Available upon request:

- Official 3-A, USDA and EHEDG hygiene certificates
- Installation instructions
- Cleaning & maintenance instructions

#### Included in every shipment:

- Certified hygienic nuts

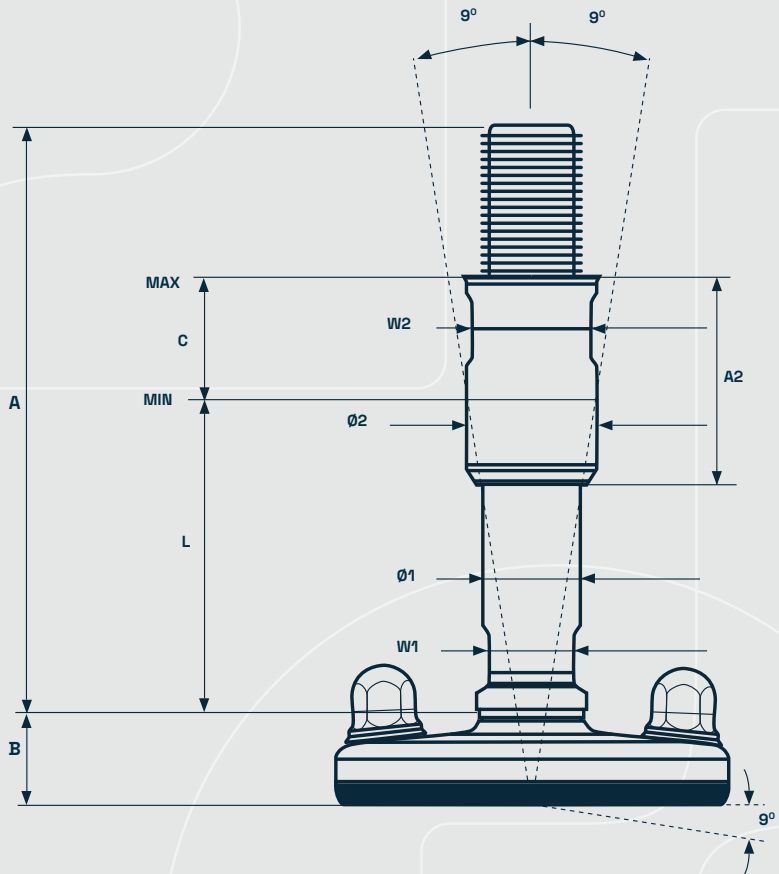
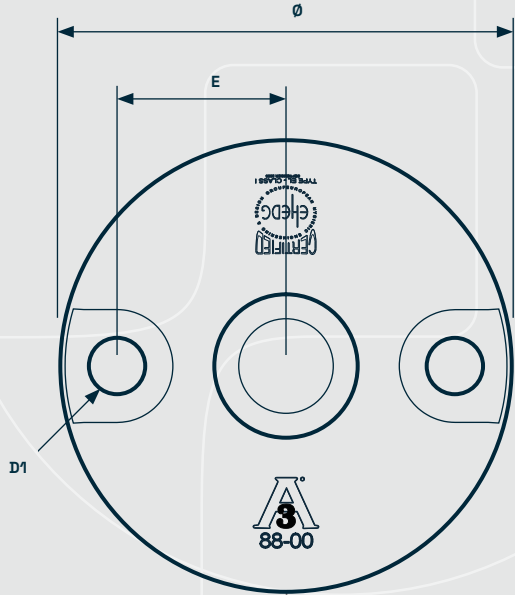

# Certified hygienic Levelling feet - ZHJS



#### FOOT PLATE



#### SPINDLE



#### SLEEVE



#### PRODUCT CODE

EXAMPLE

#### FOOT - SPINDLE - SLEEVE

ZHJ105 - XHJGSC16155 - RHOXS1655

DIAMETER Ø [mm]	HEIGHT B [mm]	HOLE POSITION E [mm]	HOLE DIAMETER D1 [mm]	NOM LOAD COMPRESSION [N]	ITEM CODE
79	25	29	8,4	35.000	ZHJ080
104	25	39	13	55.000	ZHJ105
124	25	48	13	110.000	ZHJ125
149	25	61	13	110.000	ZHJ150

THREAD	HEIGHT A [mm]	MIN HEIGHT L [mm]	W1 [mm]	DIAMETER Ø1 [mm]	NOM LOAD COMPRESSION [N]	ITEM CODE
M16	155	99	15	17	30.800	XHJGSC16155
M16	215	108	15	17	24.900	XHJGSC16215
M20	155	99	19	21	48.200	XHJGSC20155
M20	215	108	19	21	48.200	XHJGSC20215
M24	155	99	22	26,4	69.200	XHJGSC24155
M24	215	108	22	26,4	69.200	XHJGSC24215
M30	155	82	27	32	110.200	XHJGSC30155
M30	215	111	27	32	110.200	XHJGSC30215
M36	155	82	28	32	160.200	XHJGSC36155
M36	215	111	28	32	160.200	XHJGSC36215

THREAD	W2 [mm]	DIAMETER Ø2 [mm]	HEIGHT A2 [mm]	ADJUSTMENT C [mm]	ITEM CODE
M16	22	24,8	55	36	RHOXS1655
M16	22	24,8	85	66	RHOXS1685
M20	27	29,8	55	36	RHOXS2055
M20	27	29,8	85	66	RHOXS2085
M24	32	34,8	55	36	RHOXS2455
M24	32	34,8	85	66	RHOXS2485
M30	38	41,8	55	33	RHOXS3055
M30	38	41,8	85	63	RHOXS3085
M36	46	49,8	55	33	RHOXS3655
M36	46	49,8	85	63	RHOXS3685

Total height = A + B  
Minimum usable height = B + L  
Maximum usable height = B + L + C  
Maximum nominal load = Lowest value for footplate or spindle  
Tolerance of total height = +/-1,5 mm

# Certified hygienic Levelling feet - ZHJC

The design and patent protected solid ZHJC levelling foot is the optimal choice for heavy machinery and equipment that has to comply with the strictest hygienic requirements.

The ZHJC is designed to be fastened to the floor by the two fixing holes in the footplate. Hygienic nuts according to EHEDG specifications are included.

All movable parts are 100% hygienically sealed even if the load on the foot is removed. All sealings are blue and therefore detectable by scanning systems.

Minimum cleaning effort is obtained by the design of the self-draining 0,8 µm RA surfaces. Additionally, the foot is hygienically sealed to the floor by vulcanized FDA-approved, anti-vibration, anti-slip rubber, which blocks out bacteria underneath the footplate.

**Available upon request:**

- Official 3-A and EHEDG hygiene certificates
- Installation instructions
- Cleaning & maintenance instructions

**Included in every shipment:**

- Certified hygienic nuts

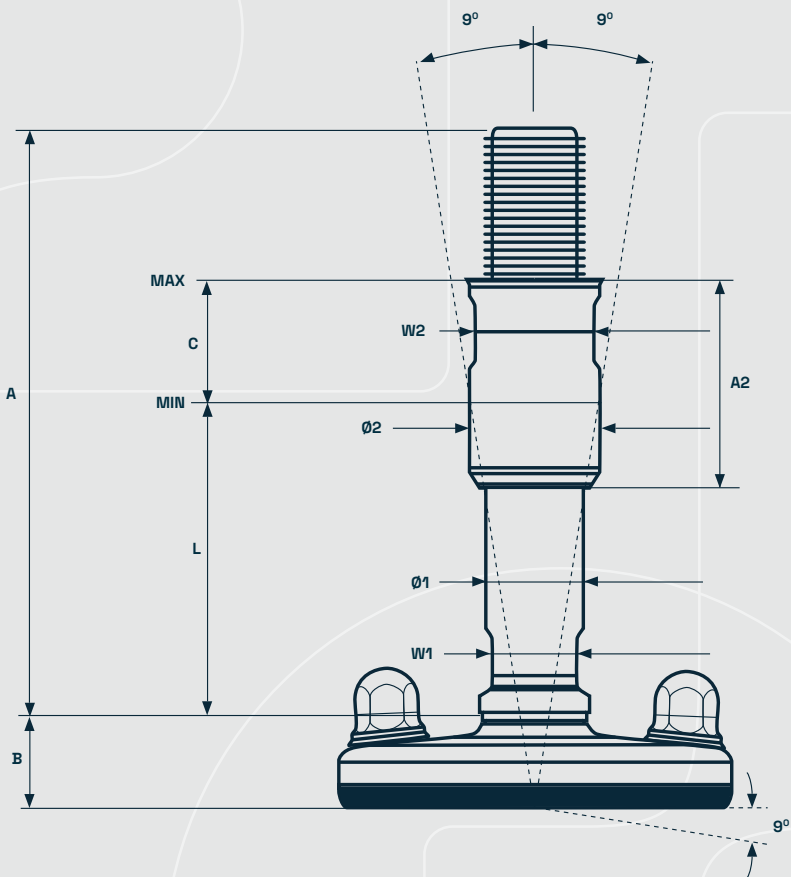
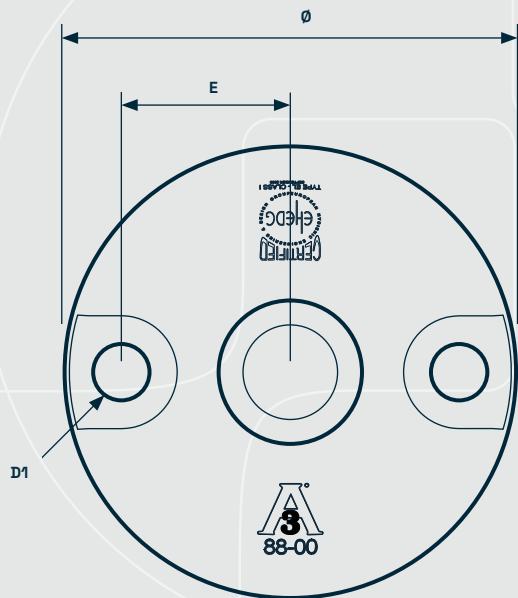

# Certified hygienic Levelling feet - ZHJC



**FOOT PLATE**



**SPINDLE**



**SLEEVE**



**PRODUCT CODE**

EXAMPLE

**FOOT - SPINDLE - SLEEVE**

ZHJ105-XHJGSC16155-RHOXC1655

DIAMETER Ø [mm]	HEIGHT B [mm]	HOLE POSITION E [mm]	HOLE DIAMETER D1 [mm]	NOM LOAD COMPRESSION [N]	ITEM CODE
79	25	29	8,4	35.000	ZHJ080
104	25	39	13	55.000	ZHJ105
124	25	48	13	110.000	ZHJ125
149	25	61	13	110.000	ZHJ150

THREAD	HEIGHT A [mm]	MIN HEIGHT L [mm]	W1 [mm]	DIAMETER Ø1 [mm]	NOM LOAD COMPRESSION [N]	ITEM CODE
M16	155	99	15	17	30.800	XHJGSC16155
M16	215	108	15	17	24.900	XHJGSC16215
M20	155	99	19	21	48.200	XHJGSC20155
M20	215	108	19	21	48.200	XHJGSC20215
M24	155	99	22	26,4	69.200	XHJGSC24155
M24	215	108	22	26,4	69.200	XHJGSC24215
M30	155	82	27	32	110.200	XHJGSC30155
M30	215	111	27	32	110.200	XHJGSC30215

THREAD	W2 [mm]	DIAMETER Ø2 [mm]	HEIGHT A2 [mm]	ADJUSTMENT C [mm]	ITEM CODE
M16	22	24,8	55	36	RHOXC1655
M16	22	24,8	85	66	RHOXC1685
M20	27	29,8	55	36	RHOXC2055
M20	27	29,8	85	66	RHOXC2085
M24	32	34,8	55	36	RHOXC2455
M24	32	34,8	85	66	RHOXC2485
M30	38	41,8	55	33	RHOXC3055
M30	38	41,8	85	63	RHOXC3085

Total height = A + B  
Minimum usable height = B + L  
Maximum usable height = B + L + C  
Maximum nominal load = Lowest value for footplate or spindle  
Tolerance of total height = +/-1,5 mm





# Certified hygienic Levelling feet - ZHFVJ

The design and patent protected ZHFVJ is the optimal choice for machinery and equipment that has to comply with the strictest hygiene requirements.

The ZHFVJ offers supreme height adjustment 100 mm as standard and has a sealed low-friction thread (lubricated for life).

Flexible mounting with optional flanges or thread adaptor, no risk of overadjusting the sleeve and thereby exposing the thread.

All movable parts are 100% hygienically sealed even if the load on the foot is removed. All sealings are blue and therefore detectable by scanning systems.

Minimum cleaning effort is obtained by the design of the self-draining 0,8 µm RA surfaces. Additionally, the foot is hygienically sealed to the floor by vulcanized FDA-approved, anti-vibration, anti-slip rubber, which blocks out bacteria underneath the footplate.

ZHFVJ is designed to be fastened to the floor by the two fixing holes in the footplate. Hygienic nuts according to EHEDG specifications are included.

**Available upon request:**

- Official 3-A, USDA and EHEDG hygiene certificates
- Installation instructions
- Cleaning & maintenance instructions

**Included in every shipment:**

- Certified hygienic nuts



- Certified hygienic
- Minimized cleaning time
- Minimized water usage

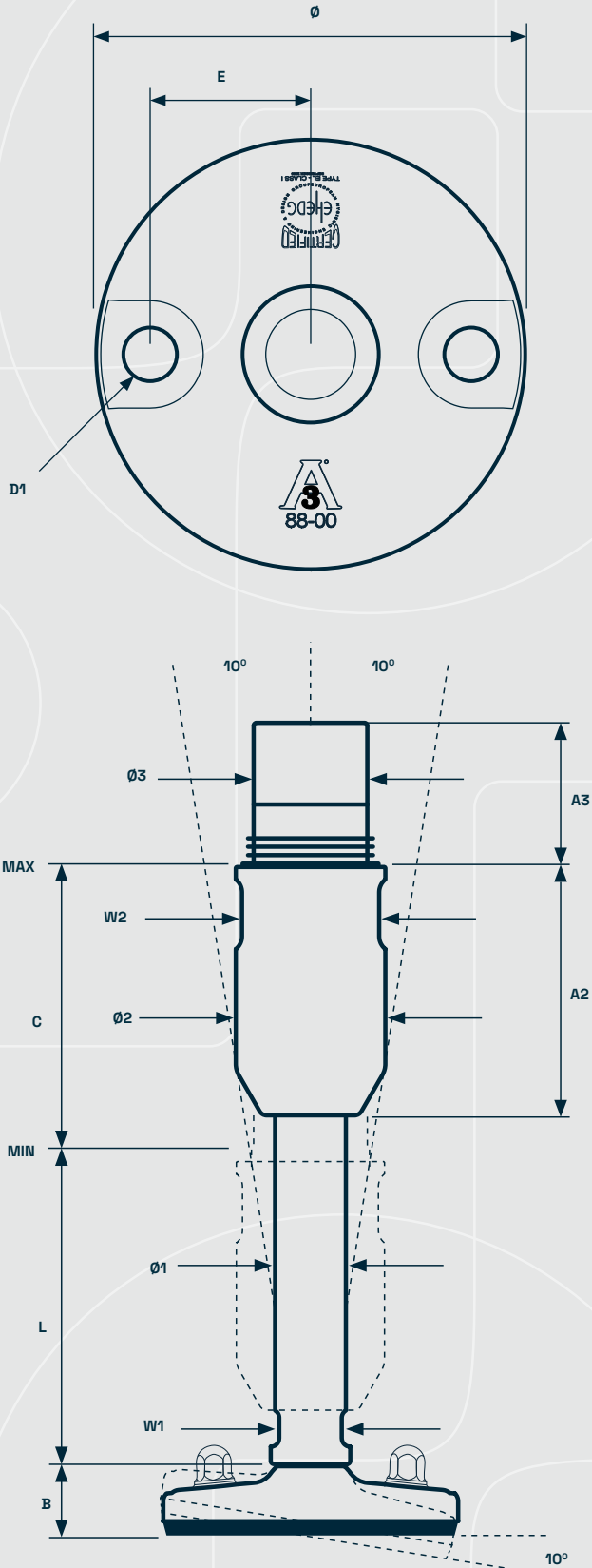

# Certified hygienic Levelling feet - ZHFVJ



**FOOT PLATE**



PRODUCT CODE	FOOT - SPINDLE - SLEEVE
EXAMPLE	ZHFVJ150-XHFJG33144-V1

DIAMETER Ø [mm]	HEIGHT B [mm]	HOLE POSITION E [mm]	HOLE DIAMETER D1 [mm]	NOM LOAD COMPRESSION [N]	ITEM CODE
79	25	29	8,4	35.000	ZHJ080
104	25	39	13	55.000	ZHJ105
124	25	48	13	95.500	ZHJ125
149	25	61	13	95.500	ZHJ150

**SPINDLE**



THREAD	MIN HEIGHT L [mm]	DIAMETER Ø1 [mm]	W1 [mm]	ITEM CODE
M33x3,5	71	25	22	XHFJG
M33x3,5	111	25	22	XHFJG
M33x3,5	152	25	22	XHFJG

**SLEEVE**



THREAD	ADJUSTMENT C [mm]	HEIGHT A2 [mm]	HEIGHT A3 [mm]	DIAMETER Ø2 [mm]	DIAMETER Ø3 [mm]	W2 [mm]	ITEM CODE
M44x2	100	51	90	54,8	40	50	V1
M44x2	100	91	50	54,8	40	50	V2
M44x2	100	131	10	54,8	40	50	V3
M44x2	V3 + adaptor						



Total height  
Minimum usable height  
Maximum usable height  
Maximum nominal load  
Tolerance of total height

= B + L + C + A2  
= B + L  
= B + L + C  
= Lowest value for footplate or spindle  
= +/-1,5 mm

# Certified hygienic Levelling feet - XH

The design and patent protected XH levelling foot is the optimal choice for machinery and equipment that has to comply with the strictest hygienic requirements.

All movable parts are 100% hygienically sealed even if the load on the foot is removed. All sealings are blue and therefore detectable by scanning systems.

Minimum cleaning effort is obtained by the design of the self-draining surfaces. Additionally, the foot is hygienically sealed to the floor by vulcanized FDA-approved, anti-vibration, anti-slip rubber, which blocks out bacteria underneath the footplate.

**Available upon request:**

- Official 3-A hygiene certificate
- Installation instructions
- Cleaning & maintenance instructions

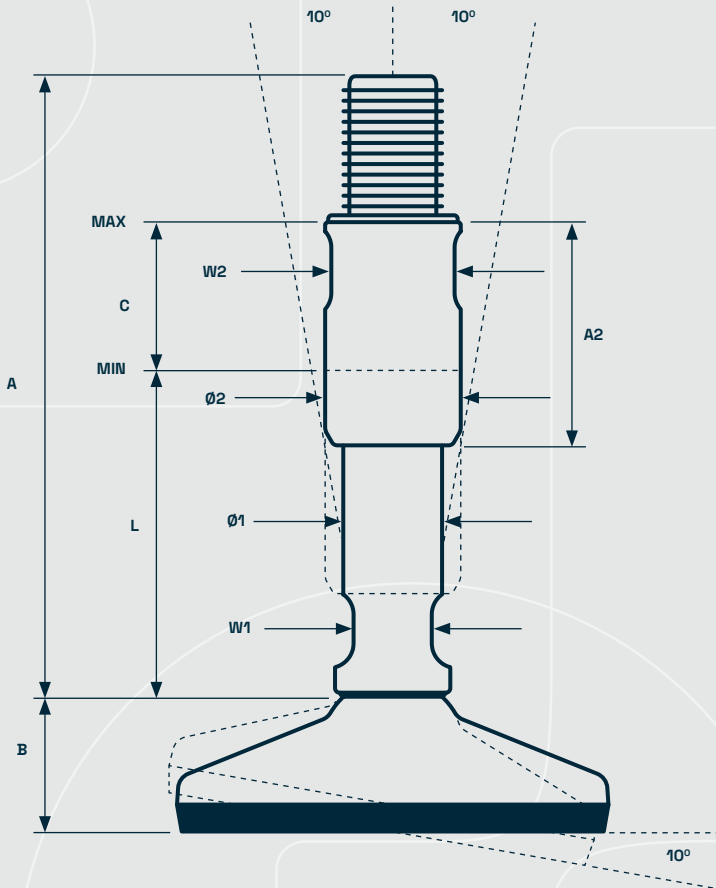

# Certified hygienic Levelling feet - XH



**FOOT PLATE**

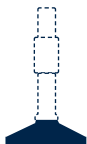

**SPINDLE**



**SLEEVE**



PRODUCT CODE	FOOT - SPINDLE - SLEEVE
EXAMPLE	XH065-XH15150-RHOX1650

DIAMETER Ø [mm]	HEIGHT B [mm]	NOM LOAD COMPRESSION [N]	ITEM CODE
65	28	9.000	XH065
80	33	15.000	XH080
105	33	22.000	XH105
125	34	32.000	XH125
150	34	65.000	XH150

THREAD	HEIGHT A [mm]	MIN HEIGHT L [mm]	W1 [mm]	DIAMETER Ø1 [mm]	NOM LOAD COMPRESSION [N]	ITEM CODE
M12	150	76	13	16	8.000	XH12150
M16	150	76	13	16	30.800	XH16150
M16	210	106	13	16	24.900	XH16210
M20	150	76	15	20	48.200	XH20150
M20	210	106	15	20	48.200	XH20210
M24	150	76	19	24	69.200	XH24150
M24	210	106	19	24	69.200	XH24210
M30	150	76	24	30	110.200	XH30150
M30	210	106	24	30	110.200	XH30210
M36	150	76	30	36	160.200	XH36150
M36	210	106	30	36	160.200	XH36210

THREAD	W2 [mm]	DIAMETER Ø2 [mm]	HEIGHT A2 [mm]	ADJUSTMENT C [mm]	ITEM CODE
M12	22	24,8	50	36	RHOX1250
M16	22	24,8	50	36	RHOX1650
M16	22	24,8	80	66	RHOX1680
M20	27	29,7	50	36	RHOX2050
M20	27	29,7	80	66	RHOX2080
M24	30	34,5	50	36	RHOX2450
M24	30	34,5	80	66	RHOX2480
M30	36	39,5	50	33	RHOX3050
M30	36	39,5	80	63	RHOX3080
M36	46	49,5	50	33	RHOX3650
M36	46	49,5	80	63	RHOX3680

Total height = A + B  
Minimum usable height = B + L  
Maximum usable height = B + L + C  
Maximum nominal load = Lowest value for footplate or spindle  
Tolerance of total height = +/-1,5 mm

# Certified hygienic Levelling feet - XH Fixing

The design and patent protected XH Fixing levelling foot is the optimal choice for machinery and equipment that has to comply with the strictest hygienic requirements.

The XH Fixing is designed to be fastened to the floor by the fixing plate. Certified hygienic levelling feet are always delivered with hygienic nuts.

All movable parts are 100% hygienically sealed even if the load on the foot is removed. All sealings are blue and therefore detectable by scanning systems.

Minimum cleaning effort is obtained by the design of the self-draining surfaces. Additionally, the foot is hygienically sealed to the floor by vulcanized FDA-approved, anti-vibration, anti-slip rubber, which blocks out bacteria underneath the footplate.

#### Available upon request:

- Official 3-A hygiene certificate
- Installation instructions
- Cleaning & maintenance instructions

#### Included in every shipment:

- Certified hygienic nuts

-  Certified hygienic
-  Minimized cleaning time
-  Minimized water usage

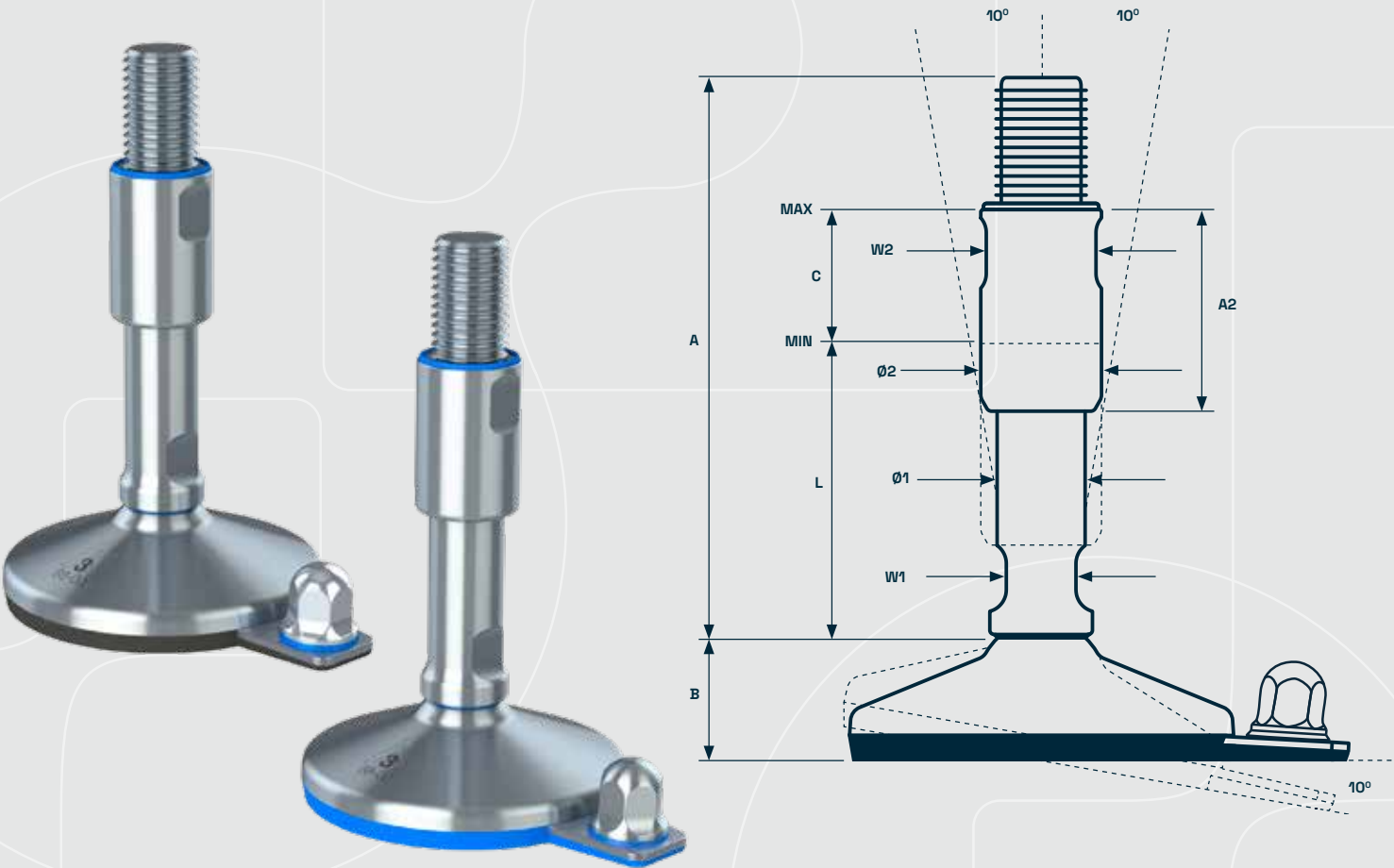
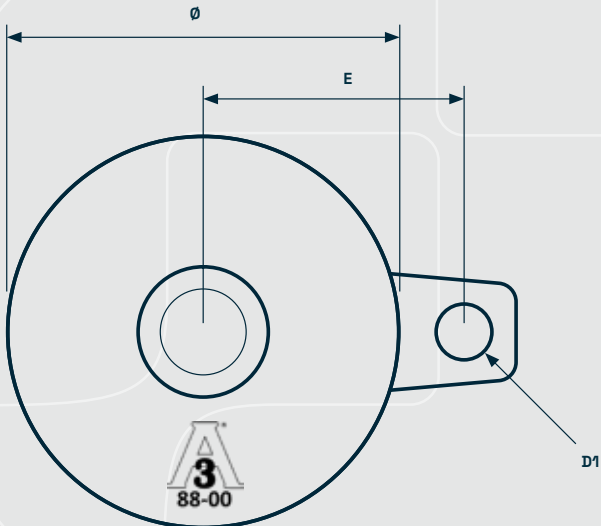

# Certified hygienic Levelling feet - XH Fixing



#### FOOT PLATE



PRODUCT CODE	FOOT - SPINDLE - SLEEVE
EXAMPLE	XH-FIX066-XH16150-RHOX1650

DIAMETER Ø [mm]	HEIGHT B [mm]	HOLE POSITION E [mm]	HOLE DIAMETER D1 [mm]	NOM LOAD COMPRESSION [N]	ITEM CODE
65	28	46,8	15	9.000	XH-FIX066
80	33	53,2	15	15.000	XH-FIX081
105	33	70,0	15	22.000	XH-FIX106
125	34	80	15	32.000	XH-FIX126

#### SPINDLE



THREAD	HEIGHT A [mm]	MIN HEIGHT L [mm]	W1 [mm]	DIAMETER Ø1 [mm]	NOM LOAD COMPRESSION [N]	ITEM CODE
M12	150	76	13	16	8.000	XH12150
M16	150	76	13	16	30.800	XH16150
M16	210	106	13	16	24.900	XH16210
M20	150	76	15	20	48.200	XH20150
M20	210	106	15	20	48.200	XH20210
M24	150	76	19	24	69.200	XH24150
M24	210	106	19	24	69.200	XH24210
M30	150	76	24	30	110.200	XH30150
M30	210	106	24	30	110.200	XH30210
M36	150	76	30	36	160.200	XH36150
M36	210	106	30	36	160.200	XH36210

#### SLEEVE



THREAD	W2 [mm]	DIAMETER Ø2 [mm]	HEIGHT A2 [mm]	ADJUSTMENT C [mm]	ITEM CODE
M12	22	24,8	50	36	RHOX1250
M16	22	24,8	50	36	RHOX1650
M16	22	24,8	80	66	RHOX1680
M20	27	29,7	50	36	RHOX2050
M20	27	29,7	80	66	RHOX2080
M24	30	34,5	50	36	RHOX2450
M24	30	34,5	80	66	RHOX2480
M30	36	39,5	50	33	RHOX3050
M30	36	39,5	80	63	RHOX3080
M36	46	49,5	50	33	RHOX3650
M36	46	49,5	80	63	RHOX3680

Total height = A + B  
Minimum usable height = B + L  
Maximum usable height = B + L + C  
Maximum nominal load = Lowest value for footplate or spindle  
Tolerance of total height = +/-1,5 mm



# Certified hygienic Levelling feet - XHG

The design and patent protected solid XHG levelling foot is the optimal choice for heavy machinery and equipment that has to comply with the strictest hygienic requirements.

All movable parts are 100% hygienically sealed even if the load on the foot is removed. All sealings are blue and therefore detectable by scanning systems.

Minimum cleaning effort is obtained by the design of the self-draining surfaces. Additionally, the foot is hygienically sealed to the floor by vulcanized FDA-approved, anti-vibration, anti-slip rubber, which blocks out bacteria underneath the footplate.

**Available upon request:**

- Official 3-A hygiene certificate
- Installation instructions
- Cleaning & maintenance instructions

- 

Certified hygienic
- 

Minimized cleaning time
- 

Minimized water usage

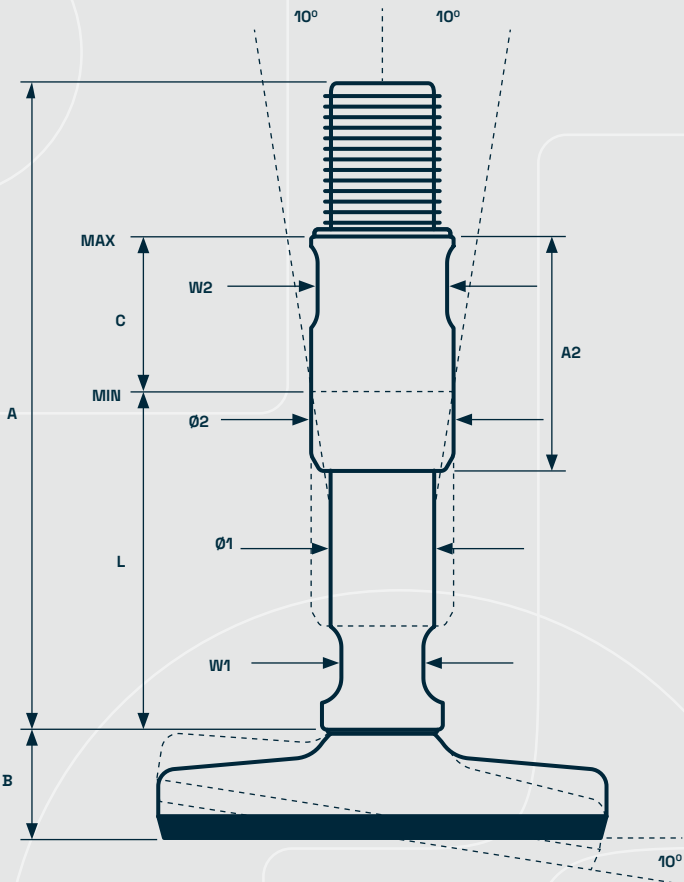
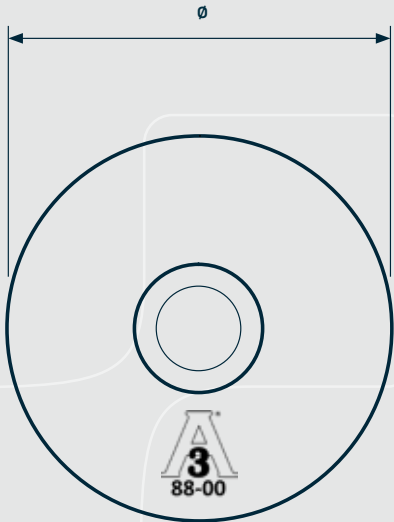

# Certified hygienic Levelling feet - XHG



PRODUCT CODE

EXAMPLE

FOOT - SPINDLE - SLEEVE

XHG105 - XHJG16150 - RHGX1650

FOOT PLATE



DIAMETER Ø [mm]	HEIGHT B [mm]	NOM LOAD COMPRESSION [N]	ITEM CODE
79	25	35.000	XHG080
104	25	55.000	XHG105
124	25	110.000	XHG125
149	25	110.000	XHG150

SPINDLE



THREAD	HEIGHT A [mm]	MIN HEIGHT L [mm]	W1 [mm]	DIAMETER Ø1 [mm]	NOM LOAD [N]	ITEM CODE
M16	150	76	13	16	30.800	XHJG16150
M16	210	106	13	16	24.900	XHJG16210
M20	150	76	15	20	48.200	XHJG20150
M20	210	106	15	20	48.200	XHJG20210
M24	150	76	19	24	69.200	XHJG24150
M24	210	106	19	24	69.200	XHJG24210
M30	150	76	24	30	110.200	XHJG30150
M30	210	106	24	30	110.200	XHJG30210
M36	150	76	30	36	160.200	XHJG36150
M36	210	106	30	36	160.200	XHJG36210

SLEEVE



THREAD	W2 [mm]	DIAMETER Ø2 [mm]	HEIGHT A2 [mm]	ADJUSTMENT C [mm]	ITEM CODE
M16	22	24,8	50	36	RHGX1650
M16	22	24,8	80	66	RHGX1680
M20	27	29,7	50	36	RHGX2050
M20	27	29,7	80	66	RHGX2080
M24	30	34,5	50	36	RHGX2450
M24	30	34,5	80	66	RHGX2480
M30	36	39,5	50	33	RHGX3050
M30	36	39,5	80	63	RHGX3080
M36	46	49,5	50	33	RHGX3650
M36	46	49,5	80	63	RHGX3680



Total height = A + B  
Minimum usable height = B + L  
Maximum usable height = B + L + C  
Maximum nominal load = Lowest value for footplate or spindle  
Tolerance of total height = +/-1,5 mm



# Certified hygienic Levelling feet - XHJ

The design and patent protected solid XHJ levelling foot is the optimal choice for heavy machinery and equipment that has to comply with the strictest hygienic requirements.

The XHJ is designed to be fastened to the floor by the two fixing holes in the footplate. Certified hygienic levelling feet are always delivered with hygienic nuts.

All movable parts are 100% hygienically sealed even if the load on the foot is removed. All sealings are blue and therefore detectable by scanning systems.

Minimum cleaning effort is obtained by the design of the self-draining surfaces. Additionally, the foot is hygienically sealed to the floor by vulcanized FDA-approved, anti-vibration, anti-slip rubber, which blocks out bacteria underneath the footplate.

**Available upon request:**

- Official 3-A hygiene certificate
- Installation instructions
- Cleaning & maintenance instructions

**Included in every shipment:**

- Certified hygienic nuts

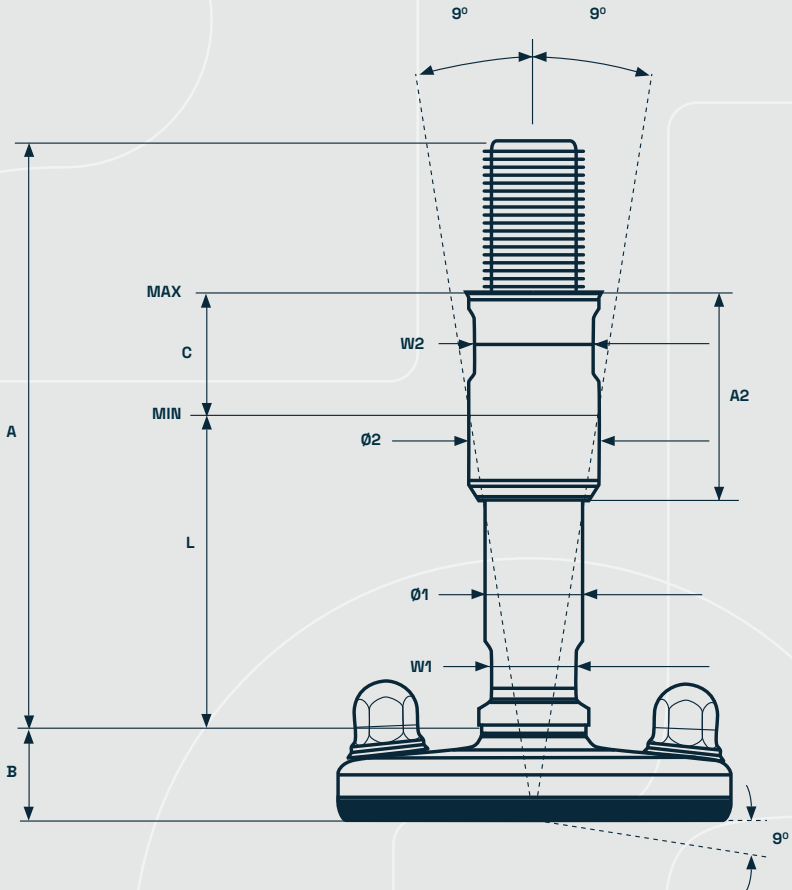
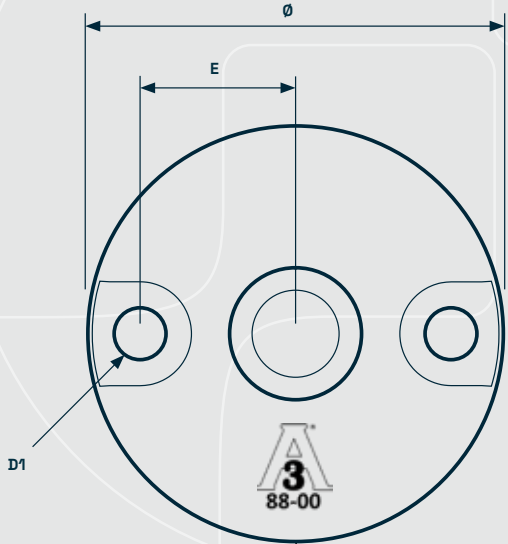

# Certified hygienic Levelling feet - XHJ



**FOOT PLATE**



PRODUCT CODE	FOOT - SPINDLE - SLEEVE
EXAMPLE	XHJ105 - XHJG16150 - RHOX1650

DIAMETER Ø [mm]	HEIGHT B [mm]	HOLE POSITION E [mm]	HOLE DIAMETER D1 [mm]	NOM LOAD COMPRESSION [N]	ITEM CODE
79	25	29	8,4	35.000	XHJ080
104	25	38	13	55.000	XHJ105
124	25	47	13	110.000	XHJ125
149	25	62	13	110.000	XHJ150

**SPINDLE**



THREAD	HEIGHT A [mm]	MIN HEIGHT L [mm]	W1 [mm]	DIAMETER Ø1 [mm]	NOM LOAD [N]	ITEM CODE
M16	150	76	13	16	30.800	XHJG16150
M16	210	106	13	16	24.900	XHJG16210
M20	150	76	15	20	48.200	XHJG20150
M20	210	106	15	20	48.200	XHJG20210
M24	150	76	19	24	69.200	XHJG24150
M24	210	106	19	24	69.200	XHJG24210
M30	150	76	24	30	110.200	XHJG30150
M30	210	106	24	30	110.200	XHJG30210
M36	150	76	30	36	160.200	XHJG36150
M36	210	106	30	36	160.200	XHJG36210

**SLEEVE**



THREAD	W2 [mm]	DIAMETER Ø2 [mm]	HEIGHT A2 [mm]	ADJUSTMENT C [mm]	ITEM CODE
M16	22	24,8	50	36	RHOX1650
M16	22	24,8	80	66	RHOX1680
M20	27	29,7	50	36	RHOX2050
M20	27	29,7	80	66	RHOX2080
M24	30	34,5	50	36	RHOX2450
M24	30	34,5	80	66	RHOX2480
M30	36	39,5	50	33	RHOX3050
M30	36	39,5	80	63	RHOX3080
M36	46	49,5	50	33	RHOX3650
M36	46	49,5	80	63	RHOX3680

Total height = A + B  
Minimum usable height = B + L  
Maximum usable height = B + L + C  
Maximum nominal load = Lowest value for footplate or spindle  
Tolerance of total height = +/-1,5 mm



# Certified hygienic Levelling feet - XHT

The design and patent protected XHT levelling foot is the optimal choice for machinery and equipment that has to comply with the strictest hygienic requirements.

The XHT consists of a separated footplate and spindle connected by the diametrically centered elevation on the footplate.

All movable parts are 100% hygienically sealed. All sealings are blue and therefore detectable by scanning systems.

Minimum cleaning effort is obtained by the design of the self-draining surfaces. Additionally, the foot is hygienically sealed to the floor by vulcanized FDA-approved, anti-vibration, anti-slip rubber, which blocks out bacteria underneath the footplate.

### Available upon request:

- Official 3-A hygiene certificate
- Installation instructions
- Cleaning & maintenance instructions

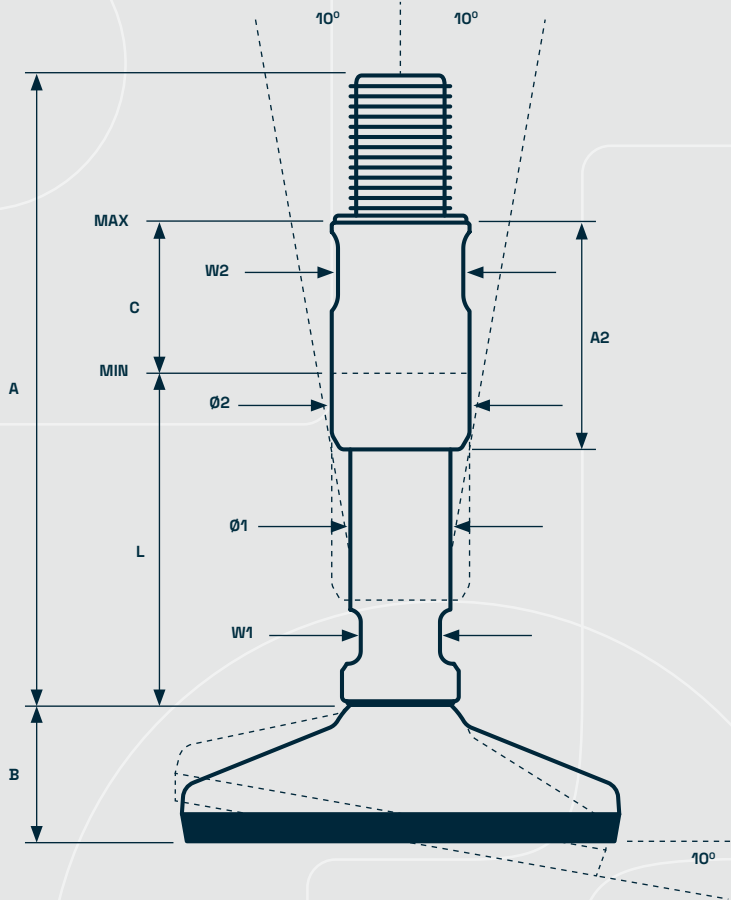
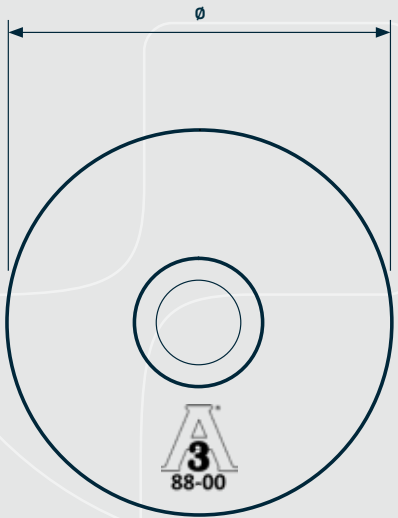

# Certified hygienic Levelling feet - XHT



### PRODUCT CODE

EXAMPLE

### FOOT - SPINDLE - SLEEVE

XHT080 - XHT16150 - RHOX1650

### FOOT PLATE



DIAMETER Ø [mm]	HEIGHT B [mm]	NOM LOAD COMPRESSION [N]	ITEM CODE
80	33	15.000	XHT080
105	33	22.000	XHT105
125	34	32.000	XHT125
150	36	65.000	XHT150

### SPINDLE



THREAD	HEIGHT A [mm]	MIN HEIGHT L [mm]	W1 [mm]	DIAMETER Ø2 [mm]	NOM LOAD [N]	ITEM CODE
M16	150	76	13	16	30.800	XHTS16150
M16	210	106	13	16	24.900	XHTS16210
M20	150	76	15	20	48.200	XHTS20150
M20	210	106	15	20	48.200	XHTS20210
M24	150	76	19	24	69.200	XHTS24150
M24	210	106	19	24	69.200	XHTS24210
M30	150	76	24	30	110.200	XHTS30150
M30	210	106	24	30	110.200	XHTS30210
M36	150	76	30	36	160.200	XHTS36150
M36	210	106	30	36	160.200	XHTS36210

### SLEEVE



THREAD	W2 [mm]	DIAMETER Ø1 [mm]	HEIGHT A2 [mm]	ADJUSTMENT C [mm]	ITEM CODE
M16	22	24,8	50	36	RHOX1650
M16	22	24,8	80	66	RHOX1680
M20	27	29,7	50	36	RHOX2050
M20	27	29,7	80	66	RHOX2080
M24	30	34,5	50	36	RHOX2450
M24	30	34,5	80	66	RHOX2480
M30	36	39,5	50	33	RHOX3050
M30	36	39,5	80	63	RHOX3080
M36	46	49,5	50	33	RHOX3650
M36	46	49,5	80	63	RHOX3680



Total height = A + B  
Minimum usable height = B + L  
Maximum usable height = B + L + C  
Maximum nominal load = Lowest value for footplate or spindle  
Tolerance of total height = +/-1,5 mm

# Certified hygienic Levelling feet - XHFV

The design and patent protected XHFV levelling foot is the optimal choice for machinery and equipment that has to comply with the strictest hygienic requirements.

The XHFV offers supreme height adjustment 100 mm as standard and has a sealed low-friction thread (lubricated for life).

Flexible mounting with optional flanges or thread adaptor.

All movable parts are 100% hygienically sealed even if the load on the foot is removed. All sealings are blue and therefore detectable by scanning systems.

Minimum cleaning effort is obtained by the design of the self-draining surfaces. Additionally, the foot is hygienically sealed to the floor by vulcanized FDA-approved, anti-vibration, anti-slip rubber, which blocks out bacteria underneath the footplate.

**Available upon request:**

- Official 3-A & USDA hygiene certificates
- Installation instructions
- Cleaning & maintenance instructions

-  Certified hygienic
-  Minimized cleaning time
-  Minimized water usage

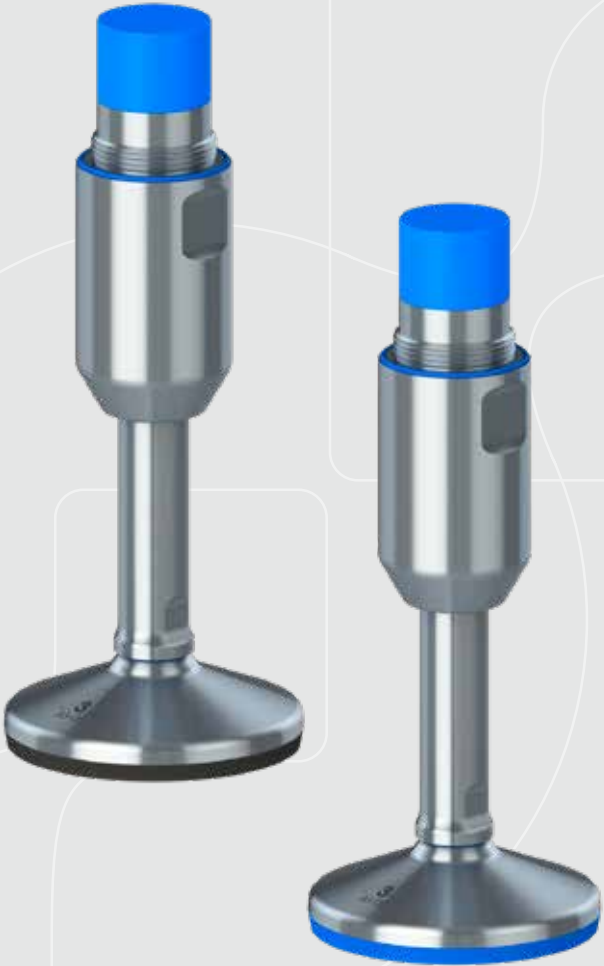
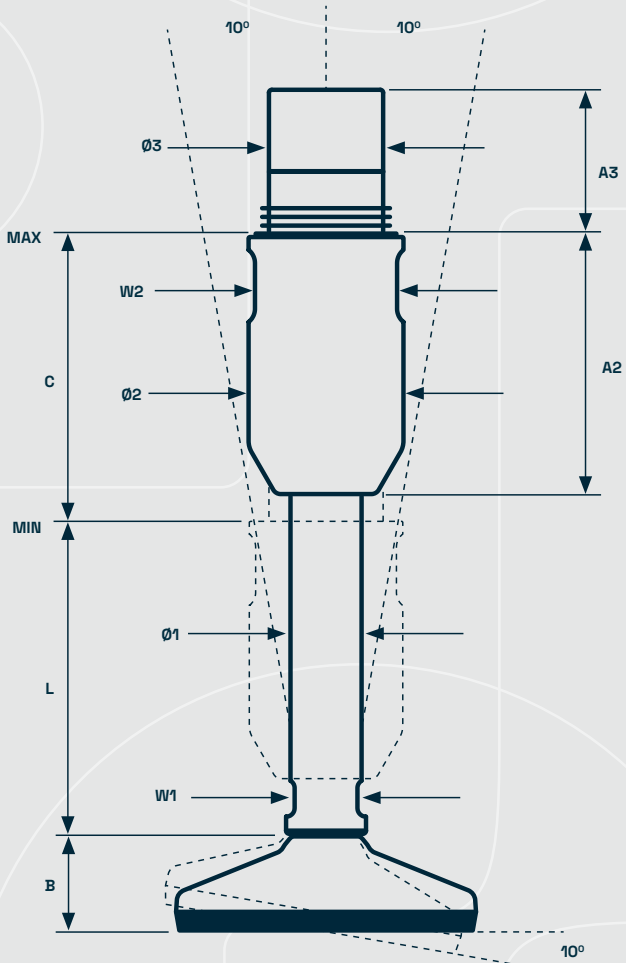
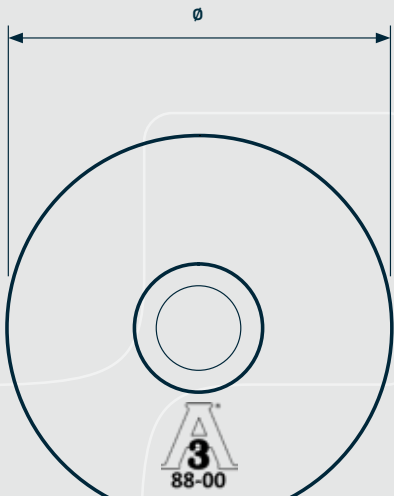

# Certified hygienic Levelling feet - XHFV



**FOOT PLATE**



PRODUCT CODE			FOOT - SPINDLE - SLEEVE
EXAMPLE			XHFV065-XHF33144-V1
DIAMETER Ø [mm]	HEIGHT B [mm]	NOM LOAD COMPRESSION [N]	ITEM CODE
65	28	9.000	XH065
80	33	15.000	XH080
105	33	22.000	XH105
125	34	32.000	XH125
150	34	65.000	XH150

**SPINDLE**



THREAD	MIN HEIGHT L [mm]	DIAMETER Ø1 [mm]	W1 [mm]	ITEM CODE
M33x3,5	71	25	22	XHF
M33x3,5	111	25	22	XHF
M33x3,5	151	25	22	XHF

**SLEEVE**



THREAD	ADJUSTMENT C [mm]	HEIGHT A2 [mm]	HEIGHT A3 [mm]	DIAMETER Ø2 [mm]	DIAMETER Ø3 [mm]	W2 [mm]	ITEM CODE
M44x2	100	51	90	54,8	40	50	V1
M44x2	100	91	50	54,8	40	50	V2
M44x2	100	131	10	54,8	40	50	V3
M44x2	V3 + adaptor						



Total height = B + L + C + A2  
Minimum usable height = B + L  
Maximum usable height = B + L + C  
Tolerance of total height = +/-1,5 mm  
Extra long V4 = V3 + adaptor

# Certified hygienic Levelling feet - XHFV Fixing

The design and patent protected XHFV Fixing levelling foot is the optimal choice for machinery and equipment that has to comply with the strictest hygienic requirements.

The XHFV Fixing is designed to be fastened to the floor by the fixing plate. Certified hygienic levelling feet are always delivered with hygienic nuts.

The XHFV Fixing offers supreme height adjustment 100 mm as standard and has a sealed low-friction thread (lubricated for life).

Flexible mounting with optional flanges or thread adaptor.

All movable parts are 100% hygienically sealed even if the load on the foot is removed. All sealings are blue and therefore detectable by scanning systems.

Minimum cleaning effort is obtained by the design of the self-draining surfaces. Additionally, the foot is hygienically sealed to the floor by vulcanized FDA-approved, anti-vibration, anti-slip rubber, which blocks out bacteria underneath the footplate.

**Available upon request:**

- Official 3-A & USDA hygiene certificates
- Installation instructions
- Cleaning & maintenance instructions

**Included in every shipment:**

- Certified hygienic nuts

-  Certified hygienic
-  Minimized cleaning time
-  Minimized water usage

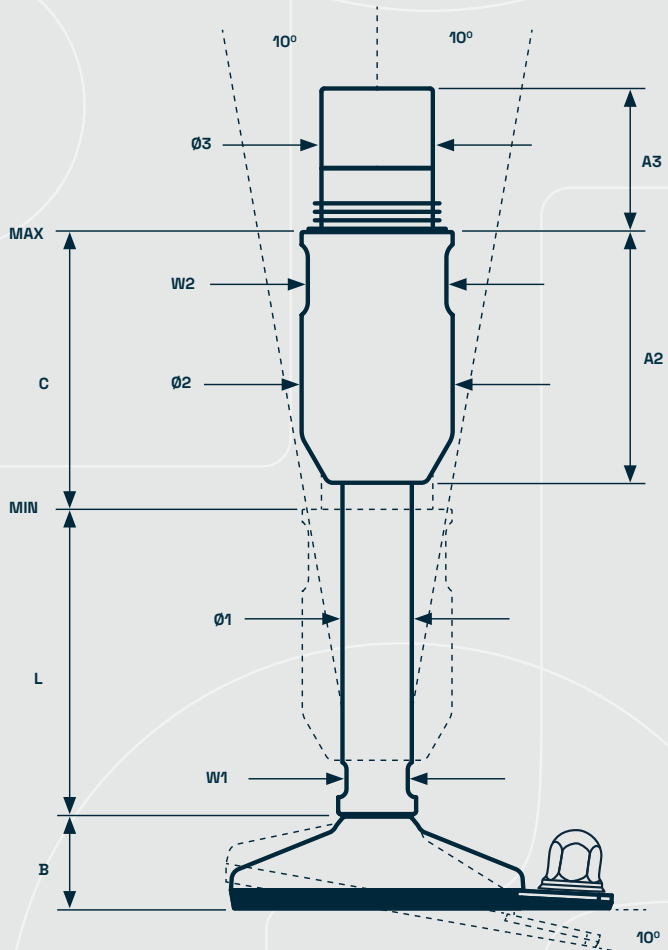
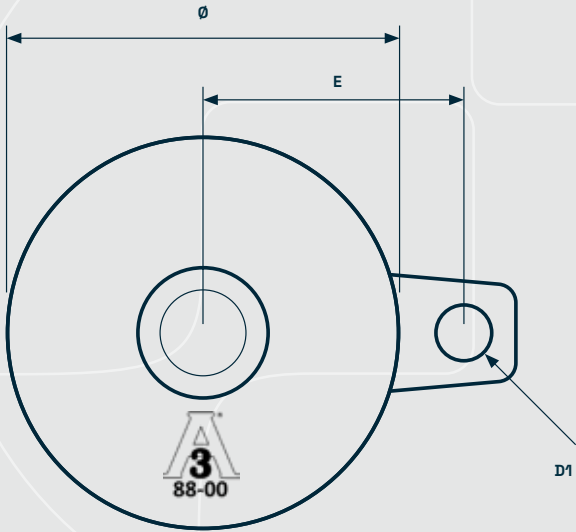

# Certified hygienic Levelling feet - XHFV Fixing



**FOOT PLATE**

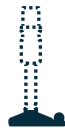

**SPINDLE**



**SLEEVE**



PRODUCT CODE  
EXAMPLE

FOOT - SPINDLE - SLEEVE  
XHFV-FIX066-XHF33144-V1

DIAMETER Ø [mm]	HEIGHT B [mm]	HOLE POSITION E [mm]	HOLE DIAMETER D1 [mm]	NOM LOAD COMPRES- SION [N]	ITEM CODE
65	28	46,8	15	9.000	XH-FIX066
80	33	53,2	15	15.000	XH-FIX081
105	33	70,0	15	22.000	XH-FIX106
125	34	80,0	15	32.000	XH-FIX126

THREAD	MIN HEIGHT L [mm]	DIAMETER Ø1 [mm]	W1 [mm]	ITEM CODE
M33x3,5	71	25	22	XHF
M33x3,5	111	25	22	XHF
M33x3,5	151	25	22	XHF

THREAD	ADJUSTMENT C [mm]	HEIGHT A1 [mm]	HEIGHT A2 [mm]	DIAMETER Ø2 [mm]	DIAMETER Ø3 [mm]	W2 [mm]	ITEM CODE
M44x2	100	51	90	54,8	40	41	V1
M44x2	100	91	50	54,8	40	41	V2
M44x2	100	131	10	54,8	40	41	V3
M44X2	V3 + adaptor						

Total height  
Minimum usable height  
Maximum usable height  
Tolerance of total height  
Extra long V4

= B + L + C + A2  
= B + L  
= B + L + C  
= +/-1,5 mm  
= V3 + adaptor



# Certified hygienic Levelling feet - XHFVG

The design and patent protected solid XHFVG levelling foot is the optimal choice for heavy machinery and equipment that has to comply with the strictest hygienic requirements.

The XHFVG offers supreme height adjustment 100 mm as standard and has a sealed low-friction thread (lubricated for life).

Flexible mounting with optional flanges or thread adaptor, no risk of over-adjusting the sleeve and thereby exposing the thread.

All movable parts are 100% hygienically sealed even if the load on the foot is removed. All sealings are blue and therefore detectable by scanning systems.

Minimum cleaning effort is obtained by the design of the self-draining surfaces. Additionally, the foot is hygienically sealed to the floor by vulcanized FDA-approved, anti-vibration, anti-slip rubber, which blocks out bacteria underneath the footplate.

**Available upon request:**

- Official 3-A & USDA hygiene certificates
- Installation instructions
- Cleaning & maintenance instructions

-  Certified hygienic
-  Minimized cleaning time
-  Minimized water usage

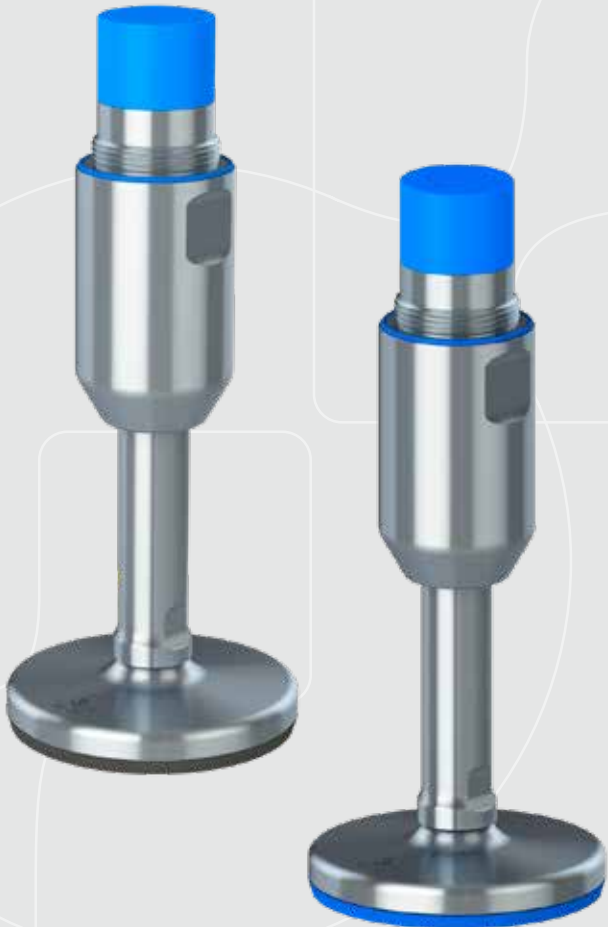
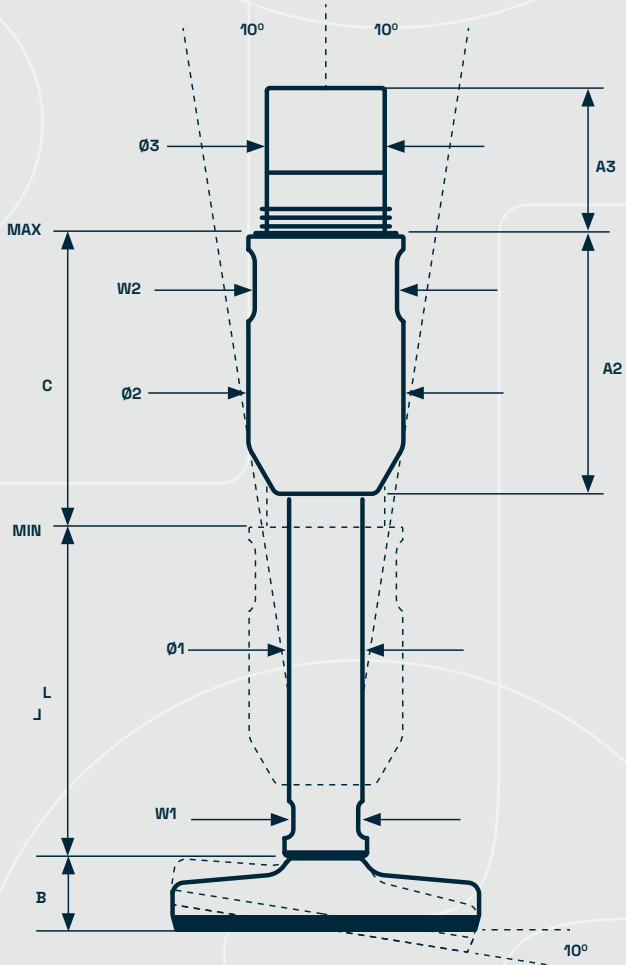
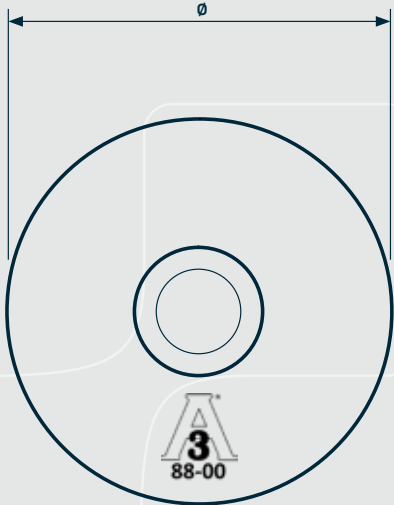

# Certified hygienic Levelling feet - XHFVG



PRODUCT CODE	FOOT - SPINDLE - SLEEVE
EXAMPLE	XHFVG105 - XHFJG33144 - V1

**FOOT PLATE**



DIAMETER Ø [mm]	HEIGHT B [mm]	NOM LOAD COMPRESSION [N]	ITEM CODE
79	25	35.000	XHFVG080
104	25	55.000	XHFVG105
124	25	110.000	XHFVG125
149	25	110.000	XHFVG150

**SPINDLE**



THREAD	MIN HEIGHT L [mm]	DIAMETER Ø1 [mm]	W1 [mm]	ITEM CODE
M33x3,5	71	25	22	XHFJG
M33x3,5	111	25	22	XHFJG
M33x3,5	151	25	22	XHFJG

**SLEEVE**



THREAD	ADJUSTMENT C [mm]	HEIGHT A2 [mm]	HEIGHT A3 [mm]	DIAMETER Ø2 [mm]	DIAMETER Ø3 [mm]	W2 [mm]	ITEM CODE
M44x2	100	51	90	54,8	40	50	V1
M44x2	100	91	50	54,8	40	50	V2
M44x2	100	131	10	54,8	40	50	V3
M44x2	V3 + adaptor						



Total height = B + L + C + A3  
Minimum usable height = B + L  
Maximum usable height = B + L + C  
Tolerance of total height = +/-1,5 mm

# Certified hygienic Levelling feet - XHFVJ

The design and patent protected solid XHFVJ levelling foot is the optimal choice for heavy machinery and equipment that has to comply with the strictest hygienic requirements.

The XHFVJ offers supreme height adjustability up to 100 mm as standard and has a sealed low-friction thread (lubricated for life).

The XHFVJ is designed to be fastened to the floor by the two fixing holes in the footplate. Certified hygienic levelling feet are always delivered with hygienic nuts.

Flexible mounting with optional flanges or thread adaptor.

All movable parts are 100% hygienically sealed even if the load on the foot is removed. All sealings are blue and therefore detectable by scanning systems.

Minimum cleaning effort is obtained by the design of the self-draining surfaces. Additionally, the foot is hygienically sealed to the floor by vulcanized FDA-approved, anti-vibration, anti-slip rubber, which blocks out bacteria underneath the footplate.

#### Available upon request:

- Official 3-A & USDA hygiene certificates
- Installation instructions
- Cleaning & maintenance instructions

#### Included in every shipment:

- Certified hygienic nuts



- Certified hygienic
- Minimized cleaning time
- Minimized water usage

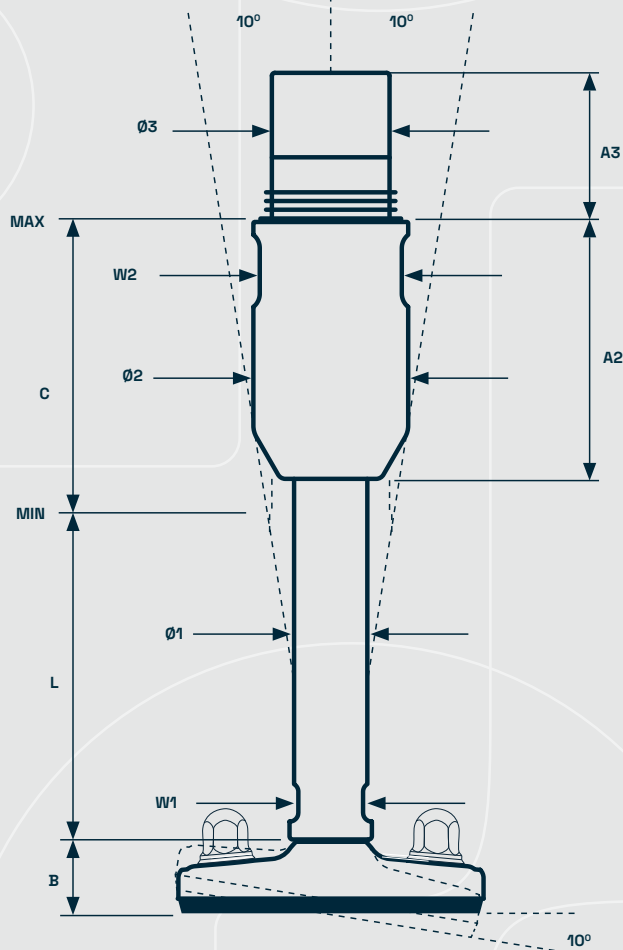
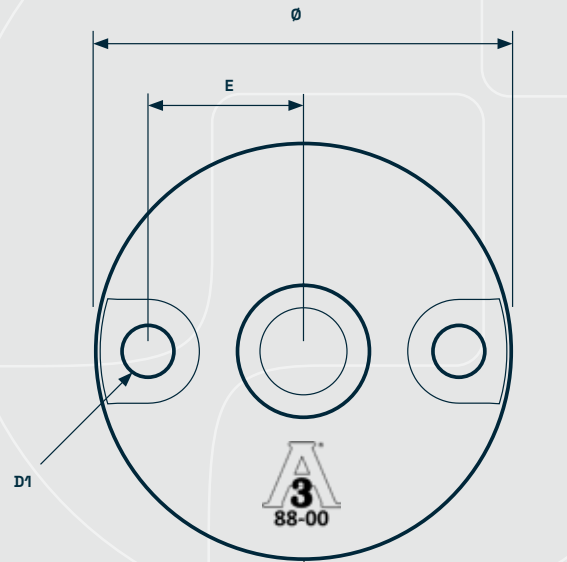

# Certified hygienic Levelling feet - XHFVJ



#### FOOT PLATE



#### SPINDLE



#### SLEEVE



#### PRODUCT CODE

EXAMPLE

#### FOOT - SPINDLE - SLEEVE

XHFVJ105 - XHFJG33144 - V1

DIAMETER Ø [mm]	HEIGHT B [mm]	HOLE POSITION E [mm]	HOLE DIAMETER D1 [mm]	NOM LOAD COMPRESSION [N]	ITEM CODE
79	25	29	8	35.000	XHJ080
104	25	38	13	55.000	XHJ105
124	25	47	13	110.000	XHJ125
149	25	62	13	110.000	XHJ150

THREAD	MIN HEIGHT L [mm]	DIAMETER Ø1 [mm]	W1 [mm]	ITEM CODE
M33x3,5	71	25	22	XHFJG
M33x3,5	111	25	22	XHFJG
M33x3,5	151	25	22	XHFJG

THREAD	ADJUSTMENT C [mm]	HEIGHT A2 [mm]	HEIGHT A3 [mm]	DIAMETER Ø2 [mm]	DIAMETER Ø3 [mm]	W2 [mm]	ITEM CODE
M44x2	100	51	90	54,8	40	50	V1
M44x2	100	91	50	54,8	40	50	V2
M44x2	100	131	10	54,8	40	50	V3
M44x2	V3 + adaptor						

Total height = B + L + C + A2  
Minimum usable height = B + L  
Maximum usable height = B + L + C  
Maximum nominal load = Lowest value for footplate or spindle  
Tolerance of total height = +/-1,5 mm



# Certified hygienic Levelling feet - XHFVT

The design and patent protected XHFVT levelling foot is the optimal choice for machinery and equipment that has to comply with the strictest hygienic requirements.

The XHFVT consists of a separated footplate and spindle connected by the diametrically centered elevation on the footplate.

The XHFVT offers supreme height adjustment 100 mm as standard and has a sealed low-friction thread (lubricated for life).

Flexible mounting with optional flanges or thread adaptor.

All movable parts are 100% hygienically sealed. All sealings are blue and therefore detectable by scanning systems.

Minimum cleaning effort is obtained by the design of the self-draining surfaces. Additionally, the foot is hygienically sealed to the floor by vulcanized FDA-approved, anti-vibration, anti-slip rubber, which blocks out bacteria underneath the footplate.

**Available upon request:**

- Official 3-A & USDA hygiene certificates
- Installation instructions
- Cleaning & maintenance instructions

-  Certified hygienic
-  Minimized cleaning time
-  Minimized water usage

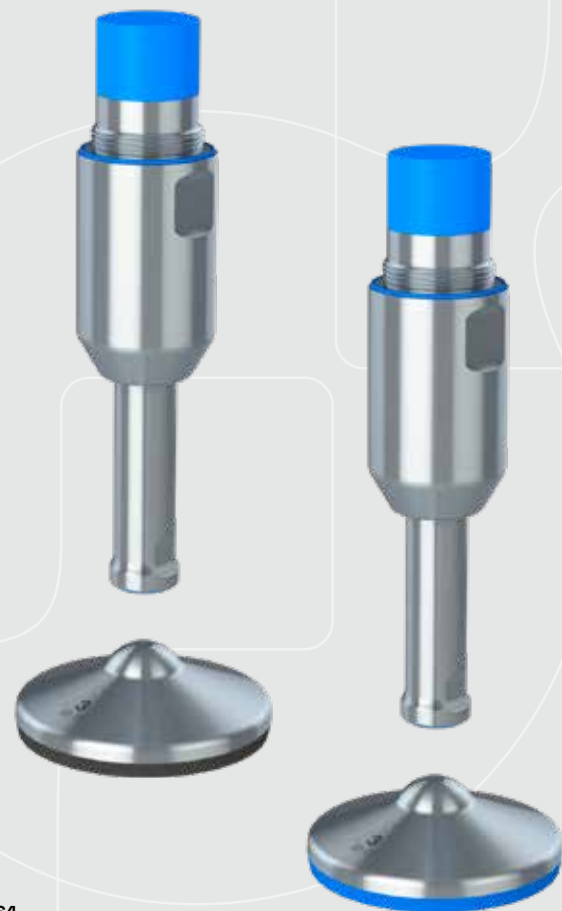
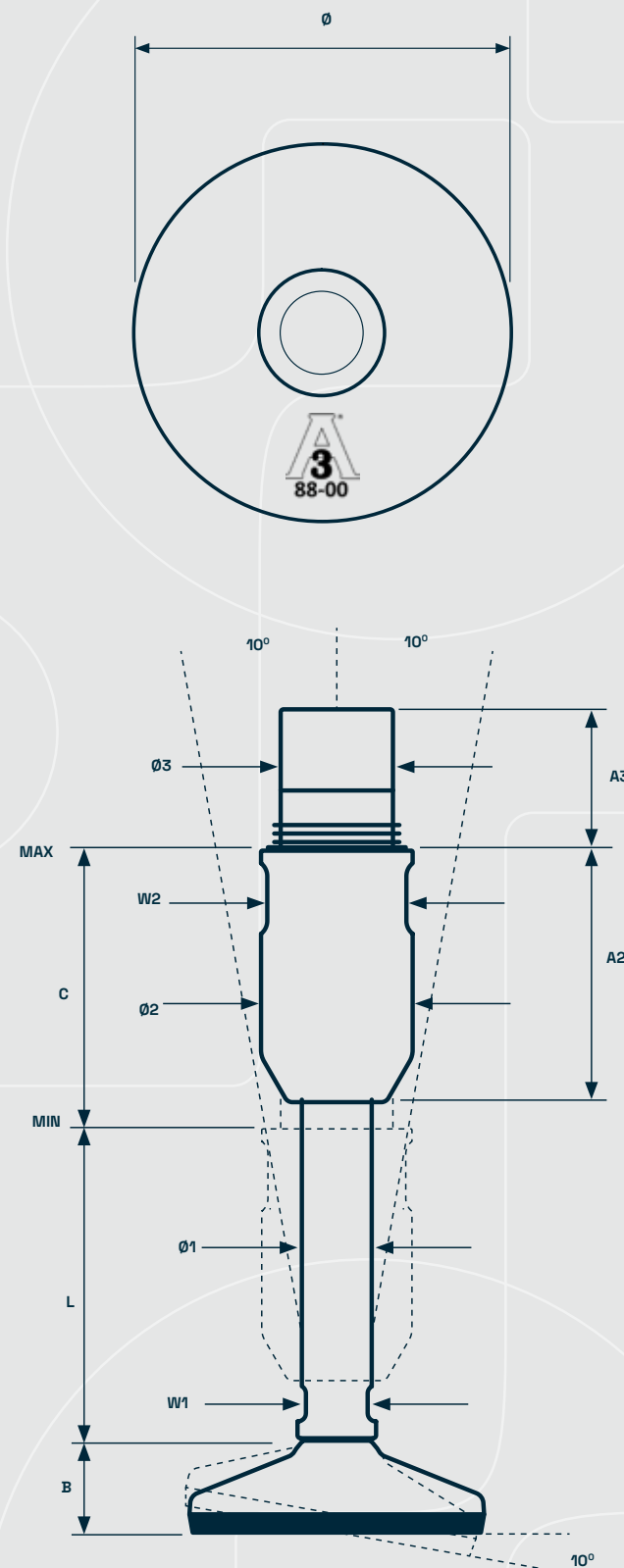

# Certified hygienic Levelling feet - XHFVT



PRODUCT CODE	FOOT - SPINDLE - SLEEVE
EXAMPLE	XHFVT080 - XHFT33144 - V1

## FOOT PLATE



DIAMETER Ø [mm]	HEIGHT B [mm]	NOM LOAD COMPRESSION [N]	ITEM CODE
80	33	15.000	XHJ080
105	33	22.000	XHJ105
125	34	32.000	XHJ125
150	34	70.000	XHJ150

## SPINDLE



THREAD	MIN HEIGHT L [mm]	DIAMETER Ø1 [mm]	W1 [mm]	ITEM CODE
M33x3,5	71	25	22	XHFT
M33x3,5	111	25	22	XHFT
M33x3,5	151	25	22	XHFT

## SLEEVE



THREAD	ADJUSTMENT C [mm]	HEIGHT A2 [mm]	HEIGHT A3 [mm]	DIAMETER Ø2 [mm]	DIAMETER Ø3 [mm]	W2 [mm]	ITEM CODE
M44x2	100	51	90	54,8	40	41	V1
M44x2	100	91	50	54,8	40	41	V2
M44x2	100	131	10	54,8	40	41	V3
M44X2	V3 + adaptor						



Total height = B + L + C + A2  
Minimum usable height = B + L  
Maximum usable height = B + L + C  
Tolerance of total height = +/-1,5 mm

# Certified hygienic Weighing levelling feet - XHW

-  Certified hygienic
-  Minimized cleaning time
-  Minimized water usage

The design and patent protected XHW weighing levelling foot is the optimal choice for supporting and weighing machinery, equipment, tanks and vessels in environments with strict hygienic requirements. The load cell is secured, guided and protected inside the foot.

- Secured: Load cell is secured against hazardous mechanical external impacts
- Guided: Can obtain strong forces in all directions without affecting the load cell
- Protected: Against external influences like corrosion, temperatures and bacteria

The XHW levelling foot is hygienically sealed to the floor by vulcanized FDA-approved, anti-vibration, anti-slip rubber, which blocks out bacteria underneath the footplate and protects the load cell.

- Maintenance free and height-adjustable compact design
- Simple and fast installation - no mounting kit needed
- The different load cells cover a span of 30kg to 5000 kg
- Designed according to the 3-A and EHEDG hygienic standards
- Stainless steel AISI 304/A2, 1.4301. Optional AISI 316/A4, 1.4401

#### Available upon request:

- Datasheet
- Installation instructions
- Cleaning & maintenance instructions

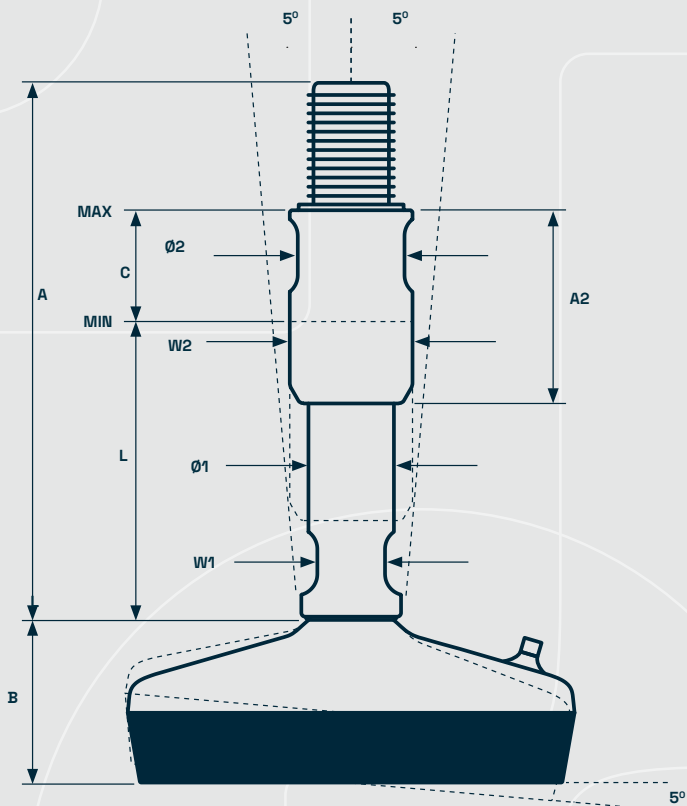
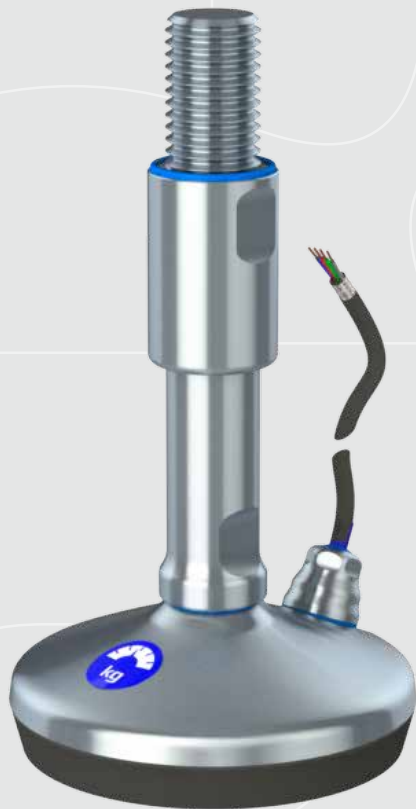

# Certified hygienic Weighing levelling feet - XHW



PRODUCT CODE	FOOT	SPINDLE	SLEEVE	LOAD CELL
EXAMPLE	XHW105 - XHM1224150 - RH0X2450 - PR6211/32D1			

TYPE	DIAMETER Ø [mm]	HEIGHT B [mm]	LOAD CELL NOM LOAD [KG]	ITEM CODE
80	80	39	30/50/100/200/300	XHW080
105	105	40	30/50/100/200/300	XHW105
125	125	45	500/1000/2000/3000/5000	XHW125
150	150	46	500/1000/2000/3000/5000	XHW150

THREAD [metric]	HEIGHT A [mm]	HEIGHT L [mm]	W1 [mm]	DIAMETER Ø1 [mm]	NOM LOAD [N]	ITEM CODE
M20	150	76	17	20	48.200	XHM1220150
M20	210	106	17	20	48.200	XHM1220210
M24	150	76	19	24	69.200	XHM1224150
M24	210	106	19	24	69.200	XHM1224210
M30	150	76	24	30	110.200	XHM1230150
M30	210	106	24	30	110.200	XHM1230210
M36	150	76	30	32	160.200	XHM1236150
M36	210	106	30	32	160.200	XHM1236210

THREAD [metric]	W2 [mm]	DIAMETER Ø2 [mm]	HEIGHT A2 [mm]	ADJUSTMENT C [mm]	ITEM CODE
M20	27	29,7	50	36	RH0X2050
M20	27	29,7	80	66	RH0X2080
M24	30	34,5	50	36	RH0X2450
M24	30	34,5	80	66	RH0X2480
M30	36	39,5	50	33	RH0X3050
M30	36	39,5	80	63	RH0X3080
M36	46	49,5	50	33	RH0X3650
M36	46	49,5	80	63	RH0X3680

LOAD CELL MIN. THREAD [OUTPUT]	30 KG	50 KG	100 KG	200 KG	300 KG	500 KG M24	1.000 KG M24	2.000 KG M30	3.000 KG M30	5.000 KG M30
2mV/V	PR6211/31D1	PR6211/51D1	PR6211/12D1	PR6211/13D1	PR6211/32D1	PR6251/52L	PR6251/13L	PR6251/23L	PR6251/33L	PR6251/53L
4-20mA	-	-	-	-	-	PR6251/52LA	PR6251/13LA	PR6251/23LA	PR6251/33LA	PR6251/53LA



Total height = A + B  
Minimum usable height = B + L  
Maximum usable height = B + L + C  
Maximum nominal load = Lowest value for load cell or spindle  
Tolerance of total height = +/-1,5 mm



# Certified hygienic Weighing levelling feet - XHGW

-  Certified hygienic
-  Minimized cleaning time
-  Minimized water usage

The design and patent protected XHGW weighing levelling foot is the optimal choice for supporting and weighing machinery, equipment, tanks and vessels in environments with strict hygienic requirements. The load cell is secured, guided and protected inside the foot.

- Secured: Load cell is secured against hazardous mechanical external impacts
- Guided: Can obtain strong forces in all directions without affecting the load cell
- Protected: Against external influences like corrosion, temperatures and bacteria
- Maintenance free and height-adjustable compact design
- Simple and fast installation - no mounting kit needed
- The different load cells cover a span of 30 kg to 5.000 kg
- Designed according to the 3-A and EHEDG hygienic standards
- Stainless steel AISI 304/A2, 1.4301. Optional AISI 316/A4, 1.4401

- Available upon request:
- Datasheet
  - Installation instructions
  - Cleaning & maintenance instructions

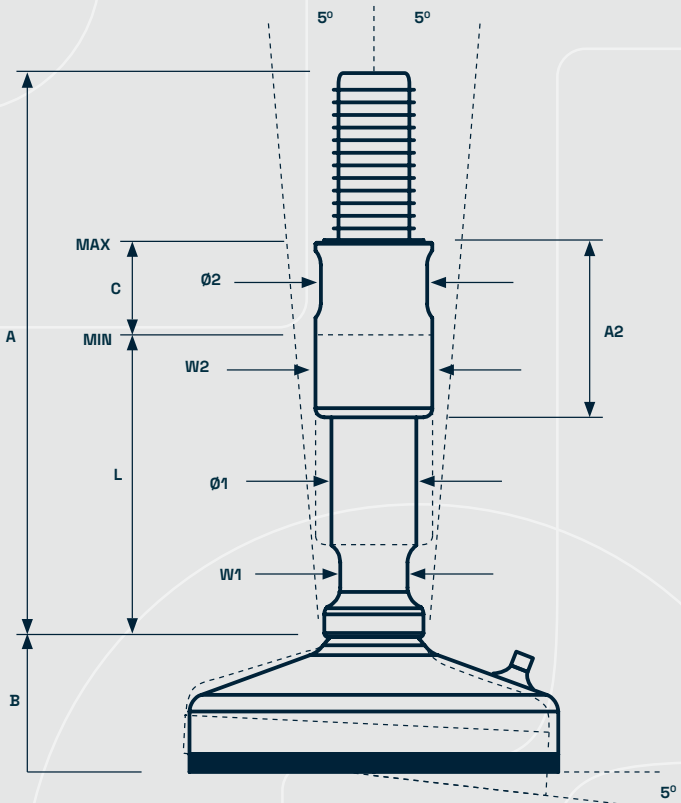

# Certified hygienic Weighing levelling feet - XHGW

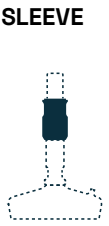

PRODUCT CODE	FOOT	-	SPINDLE	-	SLEEVE	-	LOAD CELL
EXAMPLE	XHGW105	-	XHJGM1220150	-	RHOX2050	-	PR6211/32D1

TYPE	DIAMETER Ø [mm]	HEIGHT B [mm]	LOAD CELL NOM LOAD [KG]	ITEM CODE
105	104	39	30/50/100/200/300	XHGW105
150	149	45	500/1000/2000/3000/5000	XHGW150

THREAD [metric]	HEIGHT A [mm]	HEIGHT L [mm]	W1 [mm]	DIAMETER Ø1 [mm]	NOM LOAD [N]	ITEM CODE
M20	150	76	17	20	48.200	XHM1220150
M20	210	106	17	20	48.200	XHM1220210
M24	150	76	19	24	69.200	XHM1224150
M24	210	106	19	24	69.200	XHM1224210
M30	150	76	24	30	110.200	XHM1230150
M30	210	106	24	30	110.200	XHM1230210
M36	150	76	30	32	160.200	XHM1236150
M36	210	106	30	32	160.200	XHM1236210

THREAD [metric]	W2 [mm]	DIAMETER Ø2 [mm]	HEIGHT A2 [mm]	ADJUSTMENT C [mm]	ITEM CODE
M20	27	29,7	50	36	RHOX2050
M20	27	29,7	80	66	RHOX2080
M24	30	34,5	50	36	RHOX2450
M24	30	34,5	80	66	RHOX2480
M30	36	39,5	50	33	RHOX3050
M30	36	39,5	80	63	RHOX3080
M36	46	49,5	50	33	RHOX3650
M36	46	49,5	80	63	RHOX3680

LOAD CELL MIN. THREAD [OUTPUT] 2mV/V 4-20mA	30 KG	50 KG	100 KG M16	200 KG	300 KG	500 KG M24	1.000 KG M24	2.000 KG M30	3.000 KG M30	5.000 KG M30
	PR6211/31D1	PR6211/51D1	PR6211/12D1	PR6211/13D1	PR6211/32D1	PR6251/52L	PR6251/13L	PR6251/23L	PR6251/33L	PR6251/53L
	-	-	-	-	-	PR6251/52LA	PR6251/13LA	PR6251/23LA	PR6251/33LA	PR6251/53LA



Total height = A + B  
Minimum usable height = B + L  
Maximum usable height = B + L + C  
Maximum nominal load = Lowest value for load cell or spindle  
Tolerance of total height = +/- 1,5 mm

# Certified hygienic Weighing levelling feet - XHJW

-  Certified hygienic
-  Minimized cleaning time
-  Minimized water usage

The design and patent protected XHJW weighing levelling foot is the optimal choice for supporting and weighing machinery, equipment, tanks and vessels in environments with strict hygienic requirements. The load cell is secured, guided and protected inside the foot.

- Secured: Load cell is secured against hazardous mechanical external impacts
- Guided: Can obtain strong forces in all directions without affecting the load cell
- Protected: Against external influences like corrosion, temperatures and bacteria

The XHJW is designed to be fastened to the floor by the two fixing holes in the footplate.

- Maintenance free and height-adjustable compact design
- Simple and fast installation - no mounting kit needed
- The different load cells cover a span of 30 kg to 5.000 kg
- Designed according to the 3-A and EHEDG hygienic standards
- Stainless steel AISI 304/A2, 1.4301. Optional AISI 316/A4, 1.4401

#### Available upon request:

- Datasheet
- Installation instructions
- Cleaning & maintenance instructions

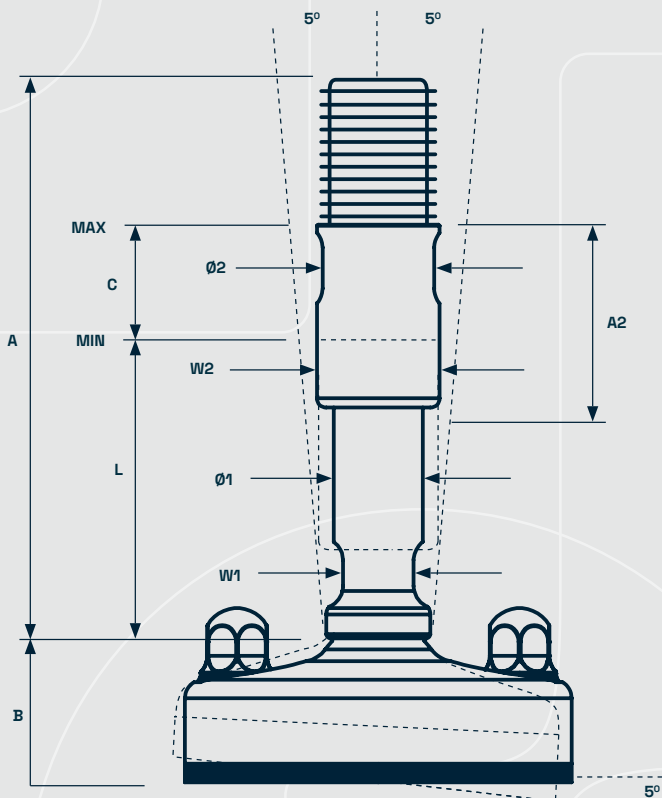
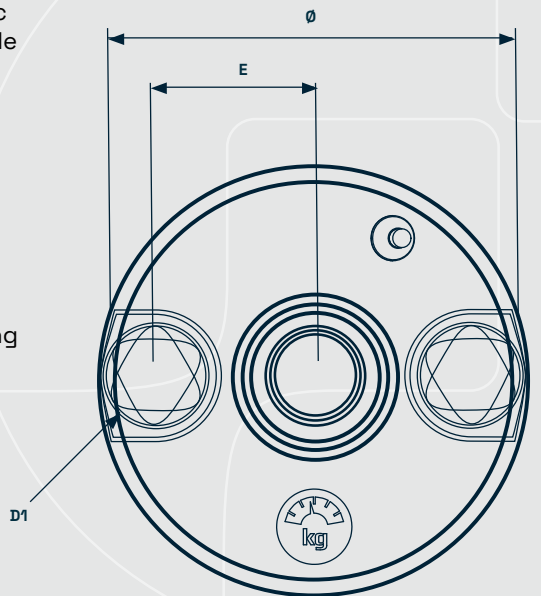

# Certified hygienic Weighing levelling feet - XHJW



FOOT PLATE

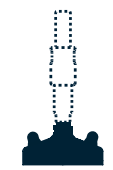

SPINDLE

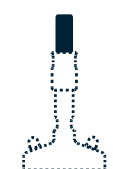

SLEEVE



PRODUCT CODE	FOOT	SPINDLE	SLEEVE	LOAD CELL
EXAMPLE	XHJW105 - XHJGM1220150 - RH0X2050 - PR6211/32D1			

TYPE	DIAMETER Ø [mm]	HEIGHT B [mm]	HOLE POSITION E [mm]	HOLE DIAMETER D1 [mm]	LOAD CELL NOM LOAD [KG]	ITEM CODE
105	104	39	37,75	13	30/50/100/200/300	XHJW105
150	149	45	58	13	500/1000/2000/3000/5000	XHJW150

THREAD [metric]	HEIGHT A [mm]	HEIGHT L [mm]	W1 [mm]	DIAMETER Ø1 [mm]	NOM LOAD [N]	ITEM CODE
M20	150	76	17	20	48.200	XHM1220150
M20	210	106	17	20	48.200	XHM1220210
M24	150	76	19	24	69.200	XHM1224150
M24	210	106	19	24	69.200	XHM1224210
M30	150	76	24	30	110.200	XHM1230150
M30	210	106	24	30	110.200	XHM1230210
M36	150	76	30	32	160.200	XHM1236150
M36	210	106	30	32	160.200	XHM1236210

THREAD [metric]	W2 [mm]	DIAMETER Ø2 [mm]	HEIGHT A2 [mm]	ADJUSTMENT C [mm]	ITEM CODE
M20	27	29,7	50	36	RH0X2050
M20	27	29,7	80	66	RH0X2080
M24	30	34,5	50	36	RH0X2450
M24	30	34,5	80	66	RH0X2480
M30	36	39,5	50	33	RH0X3050
M30	36	39,5	80	63	RH0X3080
M36	46	49,5	50	33	RH0X3650
M36	46	49,5	80	63	RH0X3680

LOAD CELL  
MIN. THREAD  
[OUTPUT]  
2mV/V  
4-20mA

30 KG	50 KG	100 KG M16	200 KG	300 KG	500 KG M24	1.000 KG M24	2.000 KG M30	3.000 KG M30	5.000 KG M30
PR6211/31D1	PR6211/51D1	PR6211/12D1	PR6211/13D1	PR6211/32D1	PR6251/52L	PR6251/13L	PR6251/23L	PR6251/33L	PR6251/53L
-	-	-	-	-	PR6251/52LA	PR6251/13LA	PR6251/23LA	PR6251/33LA	PR6251/53LA



Total height = A + B  
Minimum usable height = B + L  
Maximum usable height = B + L + C  
Maximum nominal load = Lowest value for load cell or spindle  
Tolerance of total height = +/- 1,5 mm

# Certified hygienic Weighing levelling feet - XHTW

-  Certified hygienic
-  Minimized cleaning time
-  Minimized water usage

The design and patent protected XHTW weighing levelling foot is the optimal choice for supporting and weighing machinery, equipment, tanks and vessels in environments with strict hygienic requirements. The load cell is secured, guided and protected inside the foot.

- Secured: Load cell is secured against hazardous mechanical external impacts
- Guided: Can obtain strong forces in all directions without affecting the load cell
- Protected: Against external influences like corrosion, temperatures and bacteria

The XHTW consists of a separated footplate and spindle connected by the diametrically centered elevation on the weighing footplate. Additionally, the levelling foot is hygienically sealed to the floor by vulcanized FDA-approved, anti-vibration, anti-slip rubber, which blocks out bacteria underneath the footplate and protects the load cell.

- Maintenance free and height-adjustable compact design
- Simple and fast installation - no mounting kit needed
- The different load cells cover a span of 30 kg to 5000 kg
- Designed according to the 3-A and EHEDG hygienic standards
- Stainless steel AISI 304/A2, 1.4301. Optional AISI 316/A4, 1.4401

#### Available upon request:

- Datasheet
- Installation instructions
- Cleaning & maintenance instructions

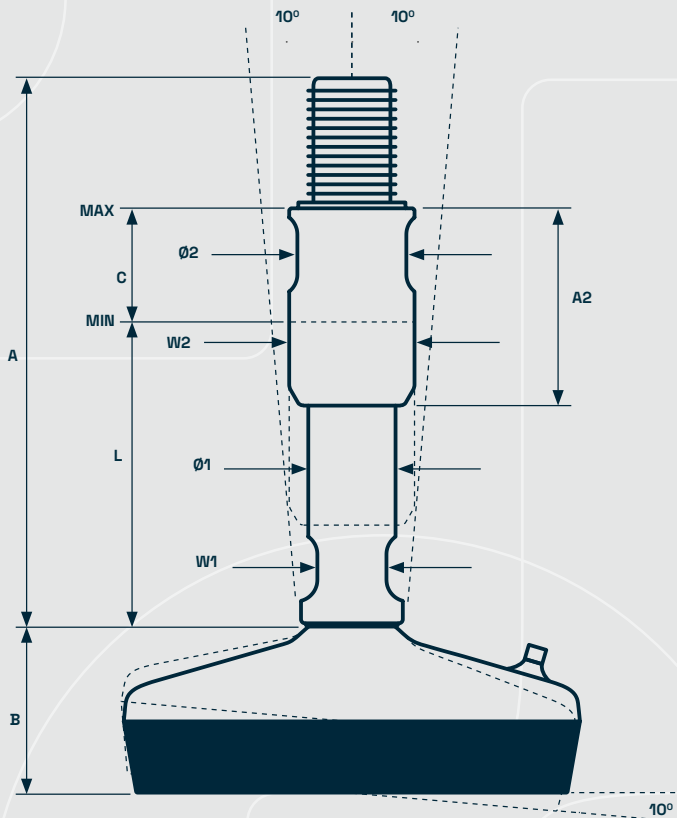

# Certified hygienic Weighing levelling feet - XHTW



FOOT PLATE



SPINDLE



SLEEVE



PRODUCT CODE	FOOT	SPINDLE	SLEEVE	LOAD CELL
EXAMPLE	XHTW105	XHT24150	RHOX2450	PR6211/32D1

TYPE	DIAMETER Ø [mm]	HEIGHT B [mm]	LOAD CELL NOM LOAD [KG]	ITEM CODE
80	80	39	30/50/100/200/300	XHW080
105	105	40	30/50/100/200/300	XHW105
125	125	45	500/1000/2000/3000/5000	XHW250
150	150	46	500/1000/2000/3000/5000	XHW250

THREAD [metric]	HEIGHT A [mm]	HEIGHT L [mm]	W1 [mm]	DIAMETER Ø1 [mm]	NOM LOAD [N]	ITEM CODE
M16	150	76	13	16	30.800	XHT16150
M16	210	106	13	16	24.900	XHT16210
M20	150	76	17	20	48.200	XHT20150
M20	210	106	17	20	48.200	XHT20210
M24	150	76	19	24	69.200	XHT24150
M24	210	106	19	24	69.200	XHT24210
M30	150	76	24	30	110.200	XHT30150
M30	210	106	24	30	110.200	XHT30210
M36	150	76	30	32	160.200	XHT36150
M36	210	106	30	32	160.200	XHT36210

THREAD [metric]	W2 [mm]	DIAMETER Ø2 [mm]	HEIGHT A2 [mm]	ADJUSTMENT C [mm]	ITEM CODE
M16	22	24,8	50	36	RHOX1650
M16	22	24,8	80	66	RHOX1680
M20	27	29,7	50	36	RHOX2050
M20	27	29,7	80	66	RHOX2080
M24	30	34,5	50	36	RHOX2450
M24	30	34,5	80	66	RHOX2480
M30	36	39,5	50	33	RHOX3050
M30	36	39,5	80	63	RHOX3080
M36	46	49,5	50	33	RHOX3650
M36	46	49,5	80	63	RHOX3680

LOAD CELL MIN. THREAD [OUTPUT]	30 KG	50 KG	100 KG M16	200 KG	300 KG	500 KG M24	1.000 KG M24	2.000 KG M30	3.000 KG M30	5.000 KG M30
2mV/V	PR6211/31D1	PR6211/51D1	PR6211/12D1	PR6211/13D1	PR6211/32D1	PR6251/52L	PR6251/13L	PR6251/23L	PR6251/33L	PR6251/53L
4-20mA	-	-	-	-	-	PR6251/52LA	PR6251/13LA	PR6251/23LA	PR6251/33LA	PR6251/53LA



Total height = A + B  
Minimum usable height = B + L  
Maximum usable height = B + L + C  
Maximum nominal load = Lowest value for load cell or spindle  
Tolerance of total height = +/-1,5 mm

# Certified hygienic Weighing levelling feet - XHGTW

-  Certified hygienic
-  Minimized cleaning time
-  Minimized water usage

The design and patent protected XHGTW weighing levelling foot is the optimal choice for supporting and weighing machinery, equipment, tanks and vessels in environments with strict hygienic requirements. The load cell is secured, guided and protected inside the foot.

- Secured: Load cell is secured against hazardous mechanical external impacts
- Guided: Can obtain strong forces in all directions without affecting the load cell
- Protected: Against external influences like corrosion, temperatures and bacteria

The XHGTW consists of a separated footplate and spindle connected by the diametrically centered elevation on the weighing footplate.

- Maintenance free and height-adjustable compact design
- Simple and fast installation - no mounting kit needed
- The different load cells cover a span of 30 kg to 5.000 kg
- Designed according to the 3-A and EHEDG hygienic standards
- Stainless steel AISI 304/A2, 1.4301. Optional AISI 316/A4, 1.4401

#### Available upon request:

- Datasheet
- Installation instructions
- Cleaning & maintenance instructions

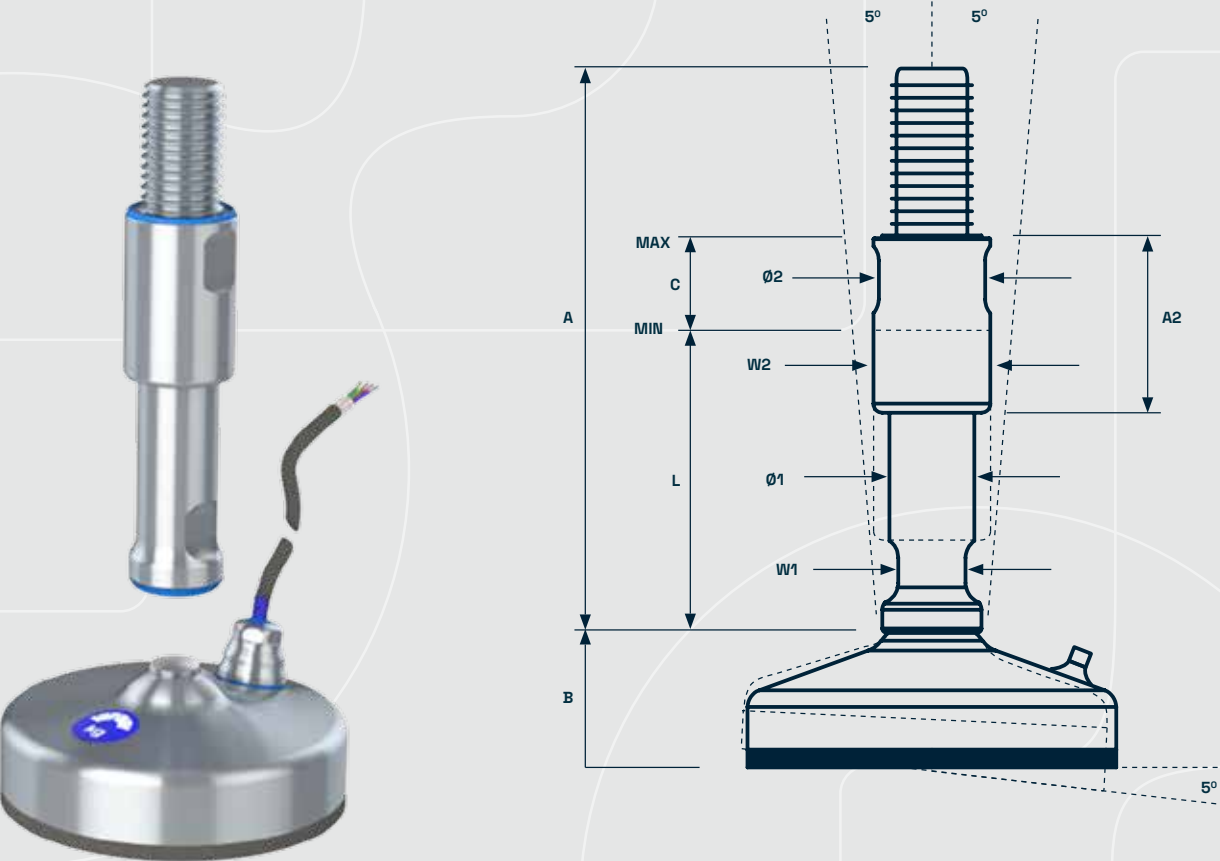

# Certified hygienic Weighing levelling feet - XHGTW



FOOT PLATE



SPINDLE



SLEEVE

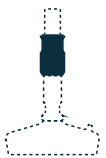

PRODUCT CODE	FOOT	-	SPINDLE	-	SLEEVE	-	LOAD CELL
EXAMPLE	XHGTW105	-	XHT20150	-	RHOX2050	-	PR6211/32D1

TYPE	DIAMETER Ø [mm]	HEIGHT B [mm]	LOAD CELL NOM LOAD [KG]	ITEM CODE
105	104	39	30/50/100/200/300	XHGTW105
150	149	45	500/1000/2000/3000/5000	XHGTW150

THREAD [metric]	HEIGHT A [mm]	HEIGHT L [mm]	W1 [mm]	DIAMETER Ø1 [mm]	NOM LOAD [N]	ITEM CODE
M16	150	76	13	16	30.800	XHT16150
M16	210	106	13	16	24.900	XHT16210
M20	150	76	17	20	48.200	XHT20150
M20	210	106	17	20	48.200	XHT20210
M24	150	76	19	24	69.200	XHT24150
M24	210	106	19	24	69.200	XHT24210
M30	150	76	24	30	110.200	XHT30150
M30	210	106	24	30	110.200	XHT30210
M36	150	76	30	32	160.200	XHT36150
M36	210	106	30	32	160.200	XHT36210

THREAD [metric]	W2 [mm]	DIAMETER Ø2 [mm]	HEIGHT A2 [mm]	ADJUSTMENT C [mm]	ITEM CODE
M16	22	24,8	50	36	RHOX1650
M16	22	24,8	80	66	RHOX1680
M20	27	29,7	50	36	RHOX2050
M20	27	29,7	80	66	RHOX2080
M24	30	34,5	50	36	RHOX2450
M24	30	34,5	80	66	RHOX2480
M30	36	39,5	50	33	RHOX3050
M30	36	39,5	80	63	RHOX3080
M36	46	49,5	50	33	RHOX3650
M36	46	49,5	80	63	RHOX3680

LOAD CELL  
MIN. THREAD  
[OUTPUT]  
2mV/V  
4-20mA

30 KG	50 KG	100 KG M16	200 KG	300 KG	500 KG M24	1.000 KG M24	2.000 KG M30	3.000 KG M30	5.000 KG M30
PR6211/31D1	PR6211/51D1	PR6211/12D1	PR6211/13D1	PR6211/32D1	PR6251/52L	PR6251/13L	PR6251/23L	PR6251/33L	PR6251/53L
-	-	-	-	-	PR6251/52LA	PR6251/13LA	PR6251/23LA	PR6251/33LA	PR6251/53LA

Total height = A + B  
Minimum usable height = B + L  
Maximum usable height = B + L + C  
Maximum nominal load = Lowest value for load cell or spindle  
Tolerance of total height = +/-1,5 mm





# Certified hygienic Seismic levelling feet - XHJSE (S)

-  Certified hygienic
-  Minimized cleaning time
-  Minimized water usage

The design and patent protected seismic XHJSE (S) levelling foot is the optimal choice for machinery, equipment, tanks and vessels located in areas subject to earthquakes and also has to comply with the strictest hygienic requirements.

- Total seismic stability and bolted fastening to concrete floors
- Movable set-up - no concrete moulding required
- Seismic anchors chosen and approved by our experienced partner Hilti
- Patented locking mechanism secures seismic stability
- Calculated according to international seismic standard NZS 4219
- Design verified through Finite element simulation
- Designed according to the 3-A and EHEDG hygienic standards
- Certified according to USDA hygienic standard
- Stainless steel AISI 304/A2, 1.4301. Optional AISI 316/A4, 1.4401

Available upon request:

- Official USDA hygienic certificate
- Datasheet calculations
- Installation instructions
- Cleaning & maintenance instructions

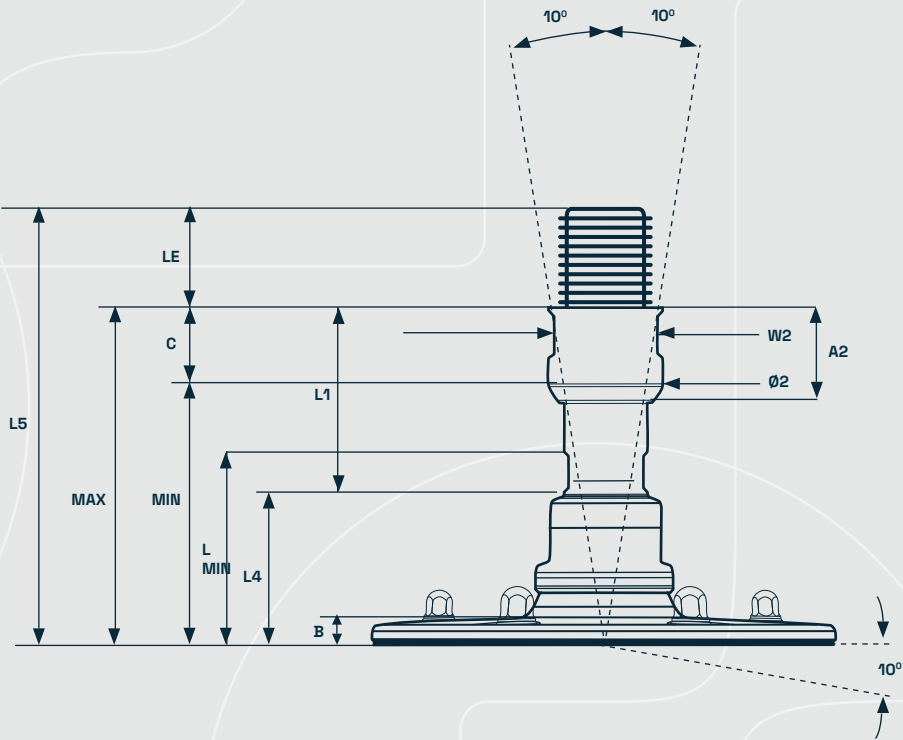
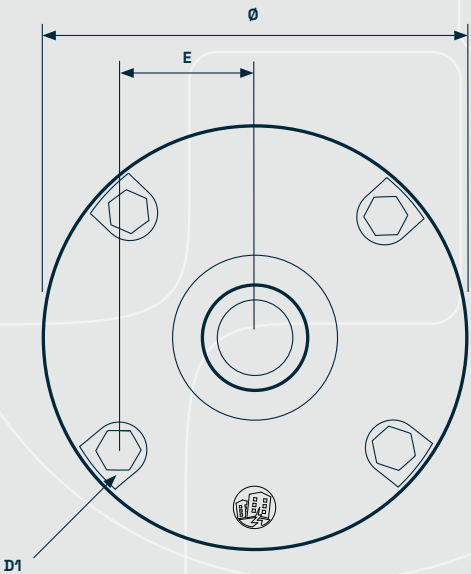

# Certified hygienic Seismic levelling feet - XHJSE (S)



FOOT PLATE

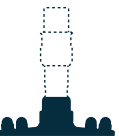

SPINDLE



SLEEVE



PRODUCT CODE	FOOT - SPINDLE - SLEEVE
EXAMPLE	XHJSE150(S)-XHJSE36150-RHOXS3655

TYPE	DIAMETER Ø [mm]	HEIGHT B [mm]	HOLES [PCS]	BOLT TYPE [SIZE]	POSITION E [mm]	NOM PULL TENSION [N]	ITEM CODE
150	149	19	3	M10x160	60	28000	XHJSE150(S)
200	199	16,5	4	M12x155	80	38000	XHJSE200(S)
250	249	15	4	M16x205	101	61.000	XHJSE250(S)
300	299	12	6	M20x250	121	80000	XHJSE300(S)

THREAD	HEIGHT L1 [mm]	HEIGHT L4 [mm]	HEIGHT L5 [mm]	L MIN [mm]	NOM LOAD COMPRESSION [N]	MAX HORIZONTAL LOAD SHEAR [N]	ITEM CODE
M30	116	77	228	105	60.000	2.100	XHJSE(S)30150
M30	178	77	288	107	60.000	1.300	XHJSE(S)30210
M36	114	77	221	103	96.000	3.500	XHJSE(S)36150
M36	179	77	288	105	96.000	2.200	XHJSE(S)36210
M42	118	82	233	109	140.000	4.900	XHJSE(S)42150
M42	179	82	298	110	140.000	3.200	XHJSE(S)42210
M48	143	82	283	120	140.000	6.900	XHJSE(S)48200
M48	203	82	343	120	140.000	4.800	XHJSE(S)48260
M56	138	82	278	115	140.000	13.100	XHJSE(S)56200
M56	203	82	343	120	140.000	8.900	XHJSE(S)56260

THREAD	W2 [mm]	DIAMETER Ø2 [mm]	HEIGHT A2 [mm]	ADJUSTMENT C [mm]	LEVELLING MAX [mm]	LEVELLING MIN [mm]	ITEM CODE
M30	38	41,8	55	33	193	160	RHOXS3055
M30	38	41,8	85	63	255	192	RHOXS3085
M36	46	49,8	55	36	191	158	RHOXS3655
M36	46	49,8	85	66	256	190	RHOXS3685
M42	50	54,5	55	36	200	164	RHOXS4255
M42	50	54,5	85	66	261	195	RHOXS4285
M48	55	59,5	70	35	225	190	RHOXS4870
M48	55	59,5	100	65	285	220	RHOXS48100
M56	65	69,5	70	35	220	185	RHOXS5670
M56	65	69,5	100	65	285	220	RHOXS56100

Maximum nominal load  
Tolerance of total height

= Depends on horizontal forces, request load diagram  
= +/-1,5 mm

# Certified hygienic Seismic levelling feet - XHJSE (L)

The design and patent protected seismic XHJSE (L) levelling foot is the optimal choice for machinery, equipment, tanks and vessels located in areas subject to earthquakes and also has to comply with the strictest hygienic requirements.

- Total seismic stability and bolted fastening to concrete floors
- Movable set-up - no concrete moulding required
- Seismic anchors chosen and approved by our experienced partner Hilti
- Patented locking mechanism secures seismic stability
- Calculated according to international seismic standard NZS 4219
- Design verified through Finite element simulation
- Designed according to the 3-A and EHEDG hygienic standards
- Certified according to USDA hygienic standard
- Stainless steel AISI 304/A2, 1.4301. Optional AISI 316/A4, 1.4401

Available upon request:

- Official USDA hygienic certificate
- Datasheet calculations
- Installation instructions
- Cleaning & maintenance instructions



Certified hygienic



Minimized cleaning time



Minimized water usage

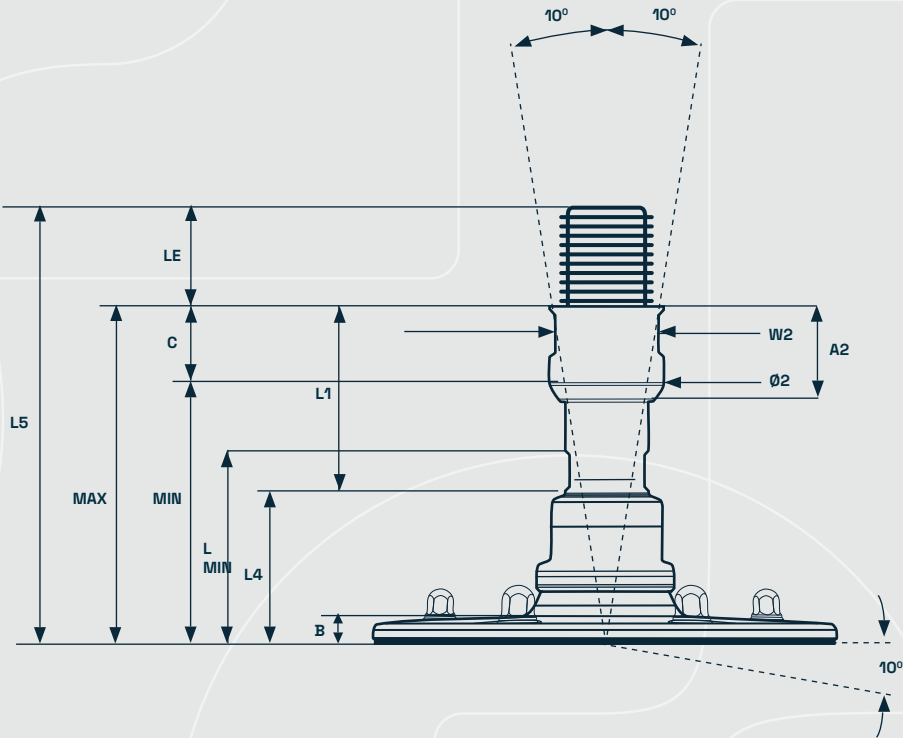
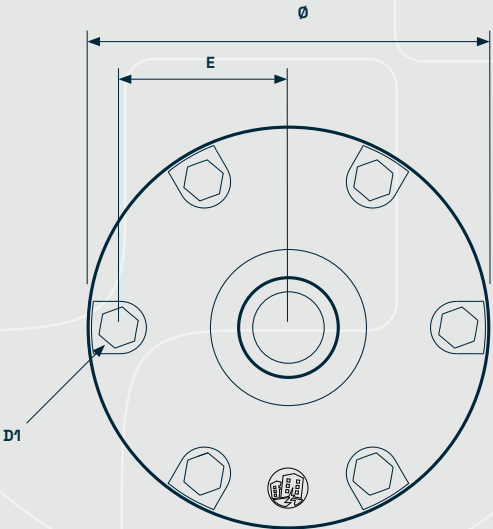

# Certified hygienic Seismic levelling feet - XHJSE (L)



FOOT PLATE

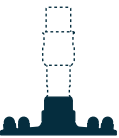

SPINDLE



SLEEVE



PRODUCT CODE	FOOT - SPINDLE - SLEEVE
EXAMPLE	XHJSE300(L) - XHJSE80310 - RHOXS80115

TYPE	DIAMETER Ø [mm]	HEIGHT B [mm]	HOLES [PSC]	BOLT TYPE [SIZE]	POSITION E [mm]	NOM. PULL TENSION [N]	ITEM CODE
250	249	22	3	M16x240	101	63000	XHJSE250(L)
300	299	19	4	M20x250	121	82000	XHJSE300(L)
350	349	18	6	M20x250	142	90.000	XHJSE350(L)
400	399	17	6	M24x330	166	126000	XHJSE400(L)

THREAD	HEIGHT L1 [mm]	HEIGHT L4 [mm]	HEIGHT L5 [mm]	L MIN [mm]	NOM LOAD COMPRESSION [N]	MAX HORIZONTAL LOAD SHEAR [N]	ITEM CODE
M56	138	118	314	151	188.000	11.800	XHJSE(L)56200
M56	203	118	379	156	188.000	8.000	XHJSE(L)56260
M64	143	118	319	156	236.000	17.800	XHJSE(L)64200
M64	203	118	379	156	236.000	12.500	XHJSE(L)64260
M72	166	129	380	170	327.000	22.200	XHJSE(L)72250
M72	226	129	438	170	327.000	16.300	XHJSE(L)72310
M80	166	129	380	170	432.000	30.800	XHJSE(L)80250
M80	226	129	438	170	432.000	22.600	XHJSE(L)80310
M90	166	129	380	170	432.000	50.500	XHJSE(L)90250
M90	226	129	438	170	432.000	37.100	XHJSE(L)90310

THREAD	W2 [mm]	DIAMETER Ø2 [mm]	HEIGHT A2 [mm]	ADJUSTMENT C [mm]	LEVELLING MAX [mm]	LEVELLING MIN [mm]	ITEM CODE
M56	65	69,5	70	35	256	221	RHOXS5670
M56	65	69,5	100	65	321	256	RHOXS56100
M64	75	79,5	70	35	261	226	RHOXS6470
M64	75	79,5	100	65	321	256	RHOXS64100
M72	80	88	85	40	295	255	RHOXS7285
M72	80	88	115	70	355	285	RHOXS72115
M80	90	99,5	85	40	295	255	RHOXS8085
M80	90	99,5	115	70	355	285	RHOXS80115
M90	95	104	85	40	295	255	RHOXS59085
M90	96	104	115	70	355	285	RHOXS90115

Maximum nominal load  
Tolerance of total height

= Depends on horizontal forces, request load diagram  
= +/-1,5 mm



# Specific market consultants

Invitation to innovation  
Investing in knowledge-sharing

## Locally based Area Sales Managers

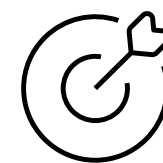

### Gain a competitive advantage with hygienic components

NGI has grown to become the global market leader for hygienic components due to our continuously high involvement in our customer's businesses and needs.

Our deep insight into the various sectors within the machine manufacturing and food processing industries makes us a value-adding partner with focus on consulting and knowledge sharing.

Today, NGI is represented in more than 50 countries and is rapidly expanding. As an NGI customer you will always be able to talk to a country-specific consultant with local language skills.

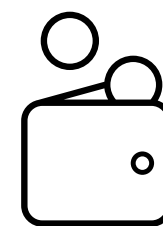

### Do you want us to calculate your savings?

Contact us if you want a free sample or if you want us to help calculate your savings?



# Product Innovation

Innovating for tomorrow  
Investing in research & development

## NGI Innovation - the Sustainable Way

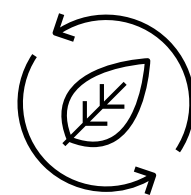

### Stainless steel - Recyclable materials

80% of our products can be recycled. We are working on initiatives to make this percentage even higher.

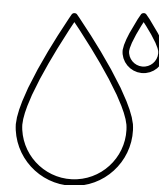

### Hygienic seals - Resource saving

Permit easy cleaning and reduce water consumption.

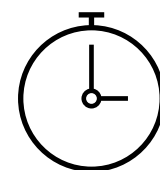

### High Quality - Longer lifetime

Our products are very high quality which means they have a longer lifetime than corresponding components.

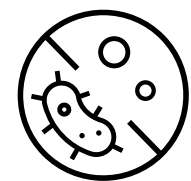

### Hygienic design - Protecting consumers

We make sure that the components do not constitute a hygiene risk through innovative and uncompromising design.



## CASE STORY

# ARLA Retrofit to avoid cracks and openings in the floor



DAIRY, MILK  
& CHEESE



## THE CHALLENGE

Arla's dairy in Rødskær (Rødskær), Denmark, is the largest mozzarella production site in Europe. The dairy had a problem with some of the pumps in their production area, because the vibrations of the pumps were so severe that they caused holes in the floor underneath them. This was a problem in relation to maintenance as well as hygiene.

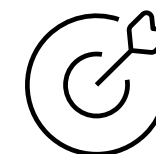

## THE SOLUTION

A local maintenance engineer asked NGI for assistance, and NGI retrofitted the feet under the pumps with NGI certified hygienic levelling feet.

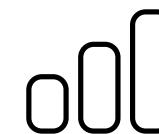

## THE EFFECT

The new feet levelled out the vibrations of the pumps and there was no longer a problem with holes in the floor. This made maintenance easier, optimized the uptime of the machinery and increased the overall hygiene of the production area. The retrofitting has, in other words, saved Arla money because they no longer have to stop production and fix holes, and it has, also improved the general hygiene.

"As part of Arla Maintenance it is crucial that the machines are up and running all the time. If we need to have extra down-time it will be a problem.

I saw the hygienic feet as an excellent option to minimise the floor damage, the pumps were causing on our floor. That the feet are hygienic and easy to clean for facility services is in perfect synergy with Arla's new updated hygienic standard.

The feet are very hygienic and easy to clean - and the hygienic seal to the floor will secure that the vibrations from the pump are absorbed and doesn't make holes anymore."

**Per Kaster Nielsen**  
Maintenance, Arla

## CASE STORY

# BARRY CALLEBAUT

## The highest standards - also in hygiene

**BARRY CALLEBAUT**



BAKERY &  
SWEETS



## THE CHALLENGE

As a major part of the world's chocolate food chain, Barry Callebaut wants to secure the highest standards within hygiene. After they started using hygienic feet from NGI in their factories in Belgium and United Kingdom they saw the value of implementing these feet at the specifications stage when they ordered new machines from their machine builders. Therefore, Barry Callebaut wanted to implement NGI components in their technical specifications.

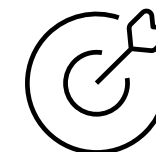

## THE SOLUTION

NGI helped Barry Callebaut develop and implement their standard for production equipment. NGI has been in close contact with Barry Callebaut during the process and NGI have furthermore helped the machine builders of Barry Callebaut with the implementation. Throughout the solution NGI and Barry Callebaut has focused on all parts of the machine supply chain, ensuring that both Barry Callebaut and the advisers and suppliers all benefit from the new standards.

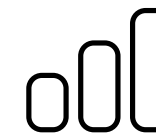

## THE EFFECT

The new standard is implemented at Barry Callebaut and the suppliers have started using the standards. One of these suppliers is DESMI and they have confirmed that both the standards and the NGI hygienic feet are easy to work with.

“NGI is a very interesting partner for us since their innovation within hygienic design allows us as a brand owner to specify hygienic EHEDG certified levelling systems, thereby assuring that NGI will assist the OEM in implementing the most hygienic possible systems to our final gain.

We will continuously keep track of the current and new NGI hygienic products, and we are sure we have found a partner that can assist us and our machine builders with very little effort from our side to our final gain.”

**Hugo Durado & Sebastien Ducatteeuw**  
Mechanical engineer & Project manager,  
Barry Callebaut



## CASE STORY

# ECOLAB Identifying the problem & delivering the solution

**ECOLAB®**



DAIRY, MILK  
& CHEESE



## THE CHALLENGE

One of Ecolab's customers suffered a serious listeria outbreak at a European factory. They brought in Ecolab in order to find the problem and point to a possible solution.

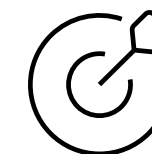

## THE SOLUTION

A specialist from Ecolab visited the plant, and he found several points for improvement. Some of these were related to machine design. Numerous machines were for example not built with hygienically optimized components.

Due to Ecolab's participation in BOPP – NGI's Brand Owner Partnership Programme – the specialist was able to not only identify the problem but to point to a solution as well. And the machines were retrofitted with hygienic and easy-to-clean certified leveling feet from NGI.

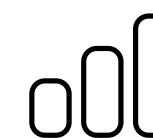

## THE EFFECT

Ecolab's customer was offered a fast and effective solution to their problem, and afterward the customer has asked machine builders to contact NGI to make sure that machines are supplied with NGI's certified components in the future.

NGI is thus brought in as a preferred supplier of certified feet as well as an external expert on hygienic design.

"Being part of BOPP will allow us to offer our customers hygienic design advise about how to solve specific issues in their production regarding hygienic design and of course correctly combined with Ecolab cleaning procedures."

**Michael Stavad**

European Application Specialist Food,  
Ecolab

Maximum **12-HOURS RESPONSE TIME** to customer enquiries  
**QUICK ORDER CONFIRMATION** (within 24 hours)  
 Incoming orders packed and **SHIPPED THE SAME DAY**

World-wide delivery **1-6 DAYS**  
 Optional **EXPRESS DELIVERY** (next day)  
**TRACK & TRACE** on all shipments

# WHY NGI?

1-4 DAYS  
DELIVERY IN  
SCANDINAVIA

4-6 DAYS  
DELIVERY IN REST  
OF WORLD

**NO MINIMUM ORDER QUANTITIES**  
 No levelling **PROJECT IS IMPOSSIBLE** for NGI

NGI offers **ALL TYPES OF HIGH-QUALITY LEVELLING FEET** at competitive prices  
 NGI is the **ONLY MANUFACTURER IN THE WORLD** of certified hygienic levelling feet  
 Country-specific key account consultants with **LOCAL LANGUAGE SKILLS**







**“Hygienic and sustainable solutions  
for the food industry**

**We continuously develop and innovate our  
products and concepts to satisfy the  
requirements of our customers”**

