

湖北金龙新材料股份有限公司

HUBEI JINLONG NEW MATERIALS CO.,LTD



HUBEI JINLONG NEW MATERIALS CO.,LTD

Address: Jinlong Industry Park, No.2,Yingbin
Avenue,Zengdu District,Suizhou,Hubei,China
Web: www.jltarpaulin.com



Inflatable tent product catalogue

COMPANY PROFILE

Hubei jinlong Group is located in Suizhou, Hubei, which is a famous historical and cultural city in China. The magnificent historical culture promotes the development of Jinlong Group. Founded in 1988, the group has been dedicated to making a piece of fabric professionally for more than 30 years. It is the earliest manufacturer of tarpaulin material in China, the designated manufacturer of China Railway Corporation and the strategic reserve enterprise of emergency industrial materials in China. It has become the leader in the industry of industrial fabric.

Hubei Jinlong Group covers an area of 400,000 square meters. The company has more than 1000 employees and an annual output value of over \$1 billion. With advanced production equipment and technology, it is the only enterprise of large-scale new high-end indoor and outdoor advertising consumables and industrial fabric materials in China that integrates textile calendaring, wide coating and coating production.

The company's domestic market share reaches more than 60%. Our high quality products are exported to Europe and America, Middle East, Southeast Asia, Africa, South America and other countries and regions. Due to the professional and reassuring one-stop procurement service, we have established long-term business cooperation with Amazon, DHL, the United Nations, many governments and other customers to achieve a win-win situation.

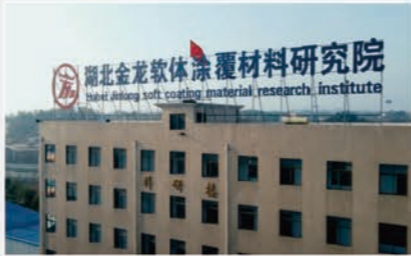

Brand story

In September 2023, the company grandly launched the "Tanyinglang" brand, focusing on the R&D, production and sales of simple inflatable tent series, tent hotel series, and space capsule series products, focusing on the outdoor camping category and one-click simple construction design. The concept covers multiple scenarios such as parent-child, family gatherings, company team building, advertising exhibitions, leisure and entertainment, camping bases, B&B and cultural tourism, etc., and is committed to providing a complete set of service solutions for outdoor enthusiasts around the world. We are currently actively exploring the new retail field and are sincerely recruiting global dealers to join hands in creating new retail. New mileage.



Tent production workshop



Tent production workshop



TANYINGLANG·ENJOY
S6.3 Outdoor inflatable tent

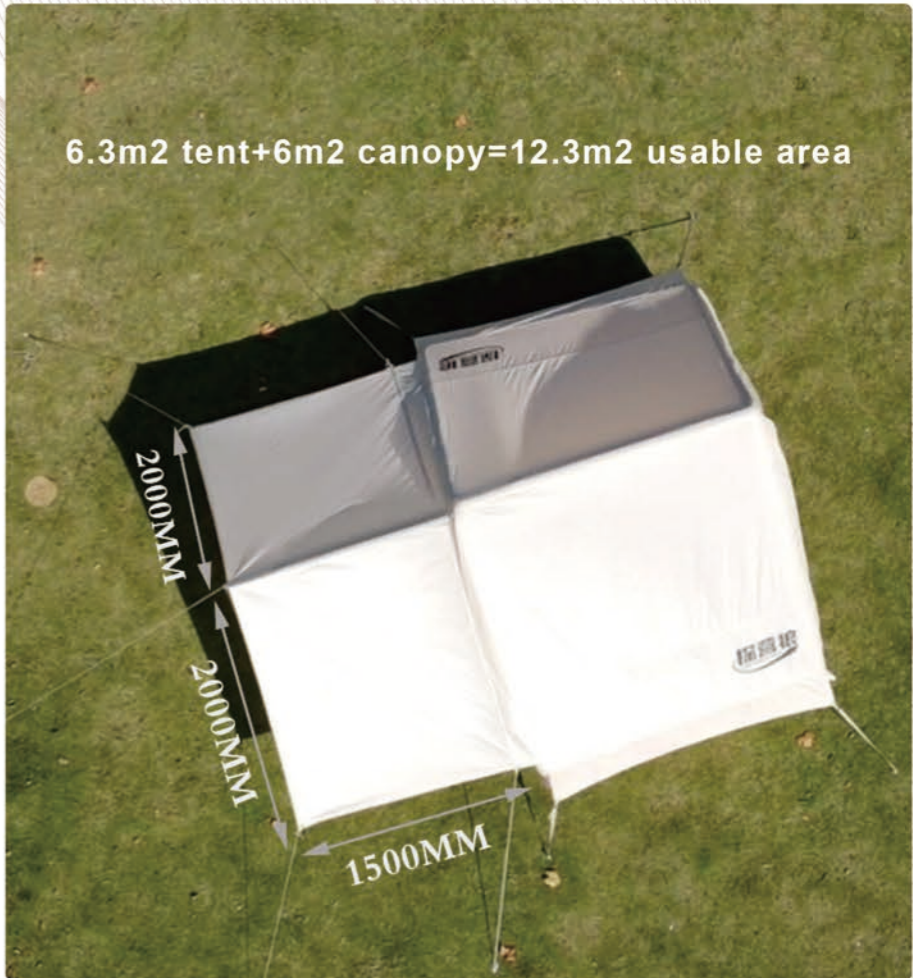

Brand	Name
	6.3m Outdoor inflatable tent
Expanded size	Storage size
300×210×200 cm Canopy size:150×400cm	75×37×50 cm
Weight	Color
about 13.8 kg (including accessories)	Khaki
Material	
Outer layer: 210D thickened PU coated Oxford fabric; Air column: PVC air column Floor fabric: PVC knife coated fabric; Mesh: Polyester mesh	
Accessories list	
Luminous wind rope x6 Steel tent peg x14 High-pressure pump x1 Storage bag x1 Repair Kit x1 Tent peg hammer x1	





TANYINGLANG·ENJOY S4.8 Portable inflatable tent



Brand	Name
	4.8m outdoor inflatable tent
Expanded size	Storage size
220×220×200 cm Canopy size:175×120cm	75×42×40 cm
Weight	Color
about 14.5 kg (including accessories)	Khaki
Material	
Outer layer: 210D thickened PU coated Oxford fabric Air column: PVC air column Floor fabric: PVC knife coated fabric Mesh: Polyester mesh	
Accessories list	
Luminous wind rope x6 Steel tent peg x14 High-pressure pump x1 Storage bag x1 Repair Kit x1 Tent peg hammer x1	



TANYINGLANG·ENJOY S4 Triangular inflatable tent



Brand	Name
	4m ³ Triangular inflatable tent
Expanded size	Storage size
220×220×180 cm	67×42×35 cm
Canopy size:140×160cm	
Weight	Color
about 10.4 kg (including accessories)	Khaki
Material	
Outer layer: 210D thickened PU coated Oxford fabric Air column: PVC air column Floor fabric: PVC knife coated fabric Mesh: Polyester mesh	
Accessories list	
Luminous wind rope x6 Steel tent peg x10 High-pressure pump x1 Storage bag x1 Repair Kit x1 Tent peg hammer x1 Tarp pole x2	



TANYINGLANG·ENJOY S5 Conical inflatable tent



Brand	Name
	5m Conical inflatable tent

Expanded size	Storage size
240×210×200 cm	67×42×35 cm

Weight	Color
about 9 kg (including accessories)	Khaki

Material
Outer layer: 210D thickened PU coated Oxford fabric Air column: PVC air column Floor fabric: PVC knife coated fabric Mesh: Polyester mesh

Accessories list
Luminous wind rope x6 Steel tent peg x8 High-pressure pump x1 Storage bag x1 Repair Kit x1 Tent peg hammer x1



TANYINGLANG·ENJOY S3.9 Conical inflatable tent



注意：以下数据均为人工测量，如有误差以实物为准。



Brand	Name
	3.9m ³ Couples inflatable tent
Expanded size	Storage size
220×180×130 cm	67×42×35 cm
Weight	Color
about 9.4 kg (including accessories)	Khaki
Material	
Outer layer: 210D thickened PU coated Oxford fabric; Air column: PVC air column Floor fabric: PVC knife coated fabric; Mesh: Polyester mesh	
Accessories list	
Luminous wind rope x6 Steel tent peg x10 High-pressure pump x1 Storage bag x1 Repair Kit x1 Tent peg hammer x1	





TANYINGLANG·TRAVEL

D6.3 Outdoor inflatable tent



Brand	Name
	6.3m ³ Winter outdoor inflatable tent
Expanded size	Storage size
300×210×200 cm	75×37×50 cm
Weight	Color
about 13.8 kg (including accessories)	Khaki
Material	
Outer layer: Waterproof technical canvas Air column: PVC air column Floor fabric: PVC knife coated fabric Mesh: Polyester mesh	
Accessories list	
Luminous wind rope x6 Steel tent peg x14 High-pressure pump x1 Storage bag x1 Repair Kit x1 Tent peg hammer x1	

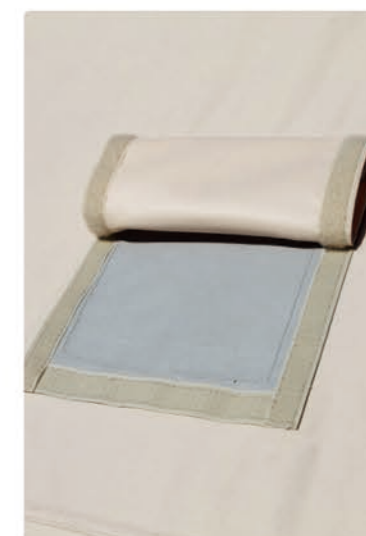



TANYINGLANG·TRAVEL
D Luxury dome inflatable tent



Brand	Name
GINLOE	Dome tent
Expanded size	Storage size
465×465×80 cm	120×120×80 cm
Weight	Color
about 70kg (including accessories)	Army green
Material	
Outer layer: 210D thickened PU coated Oxford fabric Air column: PVC air column Floor fabric: PVC knife coated fabric Mesh: Polyester mesh	
Accessories list	
Luminous wind rope x8 Steel tent peg x16 High-pressure pump x1 Storage bag x1 Repair Kit x1 Tent peg hammer x1	





TANYINGLANG · TRAVEL

D 12 Starry camouflage inflatable tent



Brand	Name
GINLOE	12m² Starry camouflage inflatable tent
Expanded size	Storage size
400×300×215 cm	80×45×50 cm
Weight	Color
about 36.5 kg (including accessories)	Starry camouflage
Material	
Outer layer: Oxford fabric Air column: PVC air column Floor fabric: PVC knife coated fabric Mesh: Polyester mesh	
Accessories list	
Luminous wind rope x6 Steel tent peg x12 High-pressure pump x1 Storage bag x1 Repair Kit x1 Tent peg hammer x1	



TANYINGLANG·LETU S8 Outdoor inflatable tent



Brand	Name
	8m outdoor inflatable tent
Expanded size	Storage size
220*220*180 cm Canopy size:325*200cm	80*48*50 cm
Weight	Color
about23.8kg (including accessories)	Khaki
Material	
Outer layer: 210D thickened PU coated Oxford fabric Air column: PVC air column Floor fabric: PVC knife coated fabric Mesh: Polyester mesh	
Accessories list	
Luminous wind rope x8 Steel tent peg x16 High-pressure pump x1 Storage bag x1 Repair Kit x1 Tent peg hammer x1 Tarpole x2	



TANYINGLANG·LETU S12 Outdoor inflatable tent

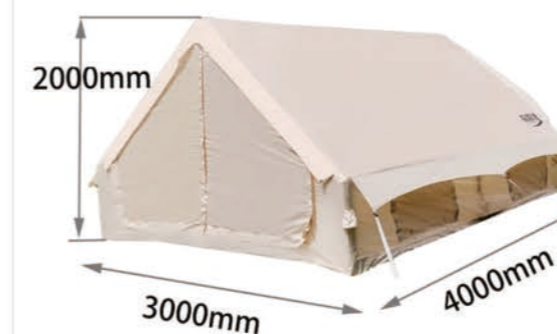

Brand	Name
	12m outdoor inflatable tent
Expanded size	Storage size
400×300×200 cm	90×45×50 cm
Weight	Color
about22.8kg (including accessories)	Khaki
Material	
Outer layer: 210D thickened PU coated Oxford fabric Air column: PVC air column Floor fabric: PVC knife coated fabric Mesh: Polyester mesh	
Accessories list	
Luminous wind rope x6 Steel tent peg x16 High-pressure pump x1 Storage bag x1 Repair Kit x1 Tent peg hammer x1	





TANYINGLANG·TRAVEL

D12 Oxford inflatable tent



Brand	Name
GINLOE	Hexagonal winter luxury inflatable tent
Expanded size	Storage size
400×400×245 cm	120×60×50 cm
Weight	Color
about 32.8kg (including accessories)	Khaki
Material	
Outer layer: Waterproof technical canvas (winter style) Outer layer: 210D thickened PU coated Oxford fabric (All seasons) Air column: PVC air column	
Accessories list	
Luminous wind rope x6 Steel tent peg x12 High-pressure pump x1 Storage bag x1 Repair Kit x1 Tent peg hammer x1	



TANYINGLANG · VIP D10 RV Companion Inflatable Tent

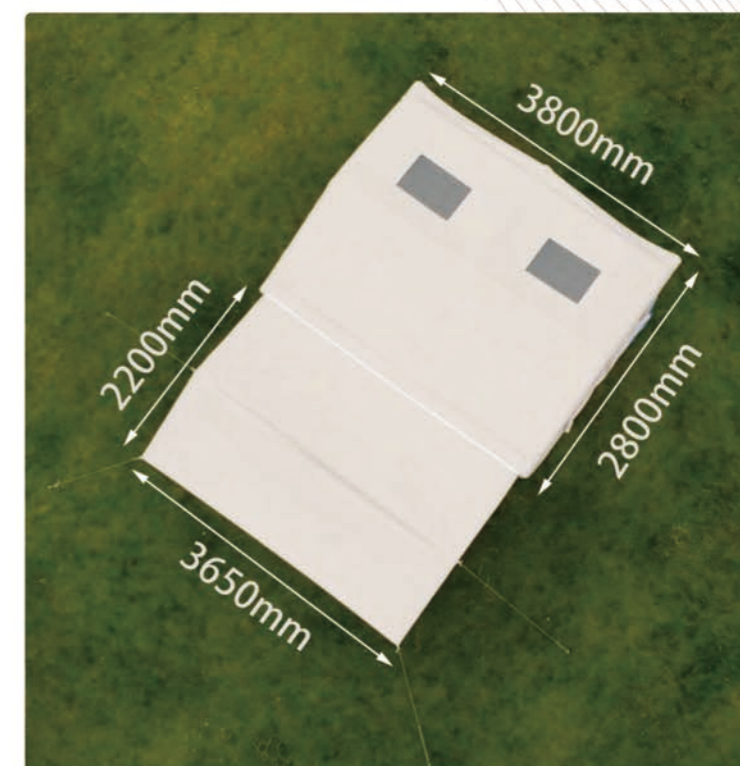

Brand	Name
	10m RV Companion Inflatable Tent
Expanded size	Storage size
380×280×240 cm Canopy size:365×220cm	90×50×50 cm
Weight	Color
about 49 kg (including accessories)	Khaki
Material	
Outer layer: Oxford fabric; Air column: PVC air column Floor fabric: PVC knife coated fabric Mesh: Polyester mesh	
Accessories list	
Luminous wind rope x8 Steel tent peg x16 High-pressure pump x1 Storage bag x1 Repair Kit x1 Tent peg hammer x1 Tarp pole x4	



TANYINGLANG · VIP D6 Winter luxury inflatable tent

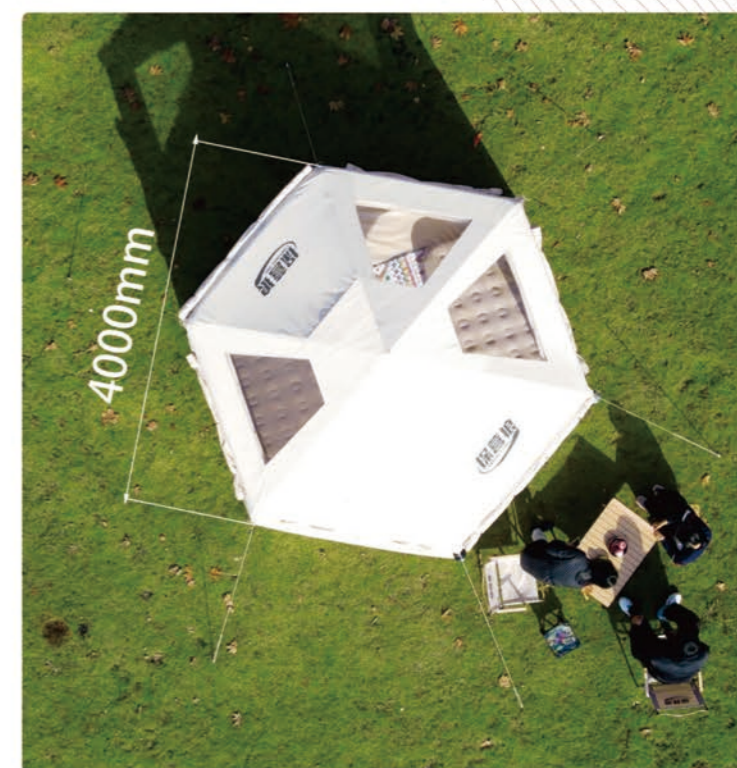

Brand	Name
	Hexagonal winter luxury tent
Expanded size	Storage size
400×400×245 cm	120×60×50 cm
Weight	Color
about 32.8 kg (including accessories)	Khaki
Material	
Outer layer: 210D thickened PU coated Oxford fabric(A11 seasons) Waterproof technical canvas (winter style) Air column: PVC air column Floor fabric: PVC knife coated fabric Mesh: Polyester mesh	
Accessories list	
Luminous wind rope x6 Steel tent peg x12 High-pressure pump x1 Storage bag x1 Repair Kit x1 Tent peg hammer x1	



TANYINGLANG · VIP D12 Technical canvas inflatable tent



Brand	Name
GINLOE	12m ² Canvas tent
Expanded size	Storage size
400×400×215 cm	80×45×50 cm
Weight	Color
about 36.5kg (including accessories)	Army green
Material	
Outer layer: Waterproof technical canvas Air column: PVC air column Floor fabric: PVC knife coated fabric Mesh: Polyester mesh	
Accessories list	
Luminous wind rope x6 Steel tent peg x12 High-pressure pump x1 Storage bag x1 Repair Kit x1 Tent peg hammer x1	





Fishing platform



Product information

Name

Fishing platform

Size

Size
250x170x35cm

Platform size:
150x100cm
120x100cm
150x80cm

Color

Yellow (Customizable)

Material

PVC tarpaulin

Fishing platform



Product information

Name

Fishing platform

Size

Size
400x170x30cm

Color

Yellow (Customizable)

Material

PVC tarpaulin

Surfboard



Product information

Name

Surfboard

Size

Customizable

Color

Customizable

Material

Materials available: 15cm 20cm Drop stitch fabric

Accessories

Paddle / Backpack / Pump

Fishing boat



Product information

Name

Fishing boat

Size

175x100x26cm 200x115x28cm 230x125x30cm
260x130x32cm 300x140x35cm

Color

Blue (Customizable)

Material

Materials available: 0.7-0.9mm PVC tarpaulin

Accessories

Paddle / Aluminum paddle / Backpack / Pump



Inflatable toy horse



Product information

Name

Inflatable toy horse

Size

120x65x40cm

Color

Blue / Pink

Material

PVC tarpaulin

Inflatable airplane model



Product information

Name

Inflatable airplane model

Size

500x350x90cm

Color

Customizable

Material

PVC tarpaulin

Two-person kayak

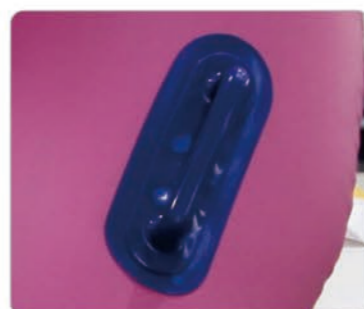

Product information

Name

Two-person kayak

Size

185x95x32cm

Color

Rose red (customizable)

Material

PVC tarpaulin
can be customized according to customer needs

Four-person kayak



Product information

Name

Four-person kayak

Size

200x200x40cm

Color

Yellow (customizable)

Material

PVC tarpaulin

>> Inflatable Sofa



Product information

Name

Inflatable Sofa

Size

Can be customized according to customer needs

Color

White (customizable)

Material

PVC tarpaulin
can be customized according to customer needs

Assault boat <<



Product information

Name

Assault boat

Size

230x132x35cm	270x152x40cm	300x152x40cm
330x152x45cm	370x172x45cm	430x182x45cm
470x192x48cm	500x200x50cm	550x200x55cm

Color

Red (customizable)

Material

PVC tarpaulin
can be customized according to customer needs

PVC water tank



Product information

Name

PVC water tank

Size

Can be customized according to customer needs

Material

PVC tarpaulin

Water tank containers of different tonnage
can be customized according to customer needs

Floating ball

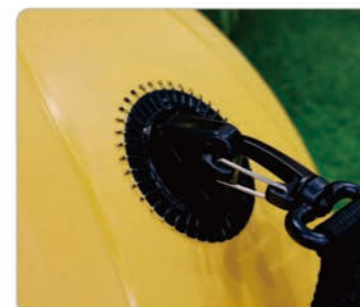

Product information

Name

Floating ball

Size

230x132x35cm

Color

Red(customizable)

Material

PVC tarpaulin

Waterproof bag

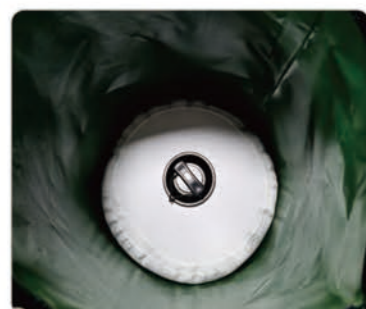
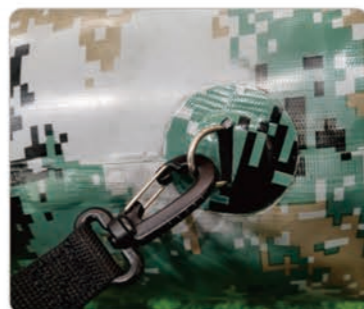
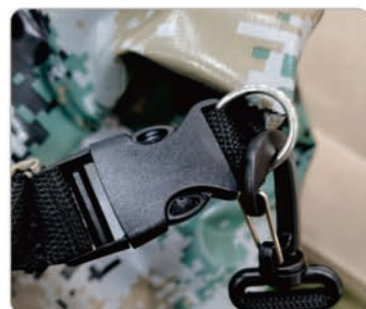

Product information

Brand: 探营狼
Name: Waterproof bag

Size: 70×25 cm

Color: Camouflage

Material: PVC tarpaulin

Can be customized according to customer needs

Outdoor folding bucket



Product information

Brand: 探营狼
Name: Outdoor folding bucket

Diameter: 25cm
Height: 20cm

Weight: 0.25kg
Weight: 10L

Material: PVC tarpaulin

Can be customized according to customer needs



Wild luxury series quadrilateral structure



The actual object shall prevail, the renderings are for reference only.

The pointed curved structure design and aluminum alloy PVC assembly structure can be matched with more than 7 different colors of double-sided coated PVC synthetic fiber fabric to break the traditional tent shape and bring a luxurious, comfortable and tranquil outdoor travel experience to scenic spots and campsites. You can sit on the terrace, drink tea, chat and watch the scenery, and immerse yourself in the beautiful scenery in front of you.

Configuration list:

Platform structure	Steel-wood hybrid structure
Tarpaulin series	PVC knife coated synthetic fiber fabric weight 650-850g/m ²
Tarpaulin color	white / sand yellow / beige / black / silver gray / color can be customized
Wall system	double-layer hollow glass wall, aluminum alloy curtain wall, (can be equipped with internal blinds, sliding windows, sliding doors, screen windows)
Optional accessories	furniture / home appliances / lighting bathroom / SPC lock floor / linings / insulation cotton, curtains, single open glass door / double open glass door
Usage	Scenic tent camps, B&B tent camps, special wild luxury camps, garden landscapes, hot spring vacations, water park lounges, leisure tourism, specialty restaurants, etc.



Layout diagram

Projected area: 23.8m² Terrace area: 31m²

Length x width (m)	Side height (m)	Top height (m)	Indoor area (m ²)	Projected area of tensile membrane (m ²)	Platform reference area (m ²)
5x5m	2.5	5.6	23.8	62	31
6x6m	2.5	5.8	37.2	81	46.3
8x8m	2.5	6.25	64	121	75

*Dimensions can be customized





Wild luxury series hexagonal structure



The wild luxury hexagon focuses on open space, which is transparent and bright, and integrates with nature to leave more space for people to relax and enjoy. For example, the observation deck, floor-to-ceiling windows, and transparent skylights are as comfortable as a star-rated hotel, returning to nature.

Configuration list:

Platform structure	Steel-wood hybrid structure
Tarpaulin series	PVC knife coated synthetic fiber fabric weight 650-850g/m ²
Tarpaulin color	white / sand yellow / beige / black / silver gray / color can be customized
Wall system	double-layer hollow glass wall, aluminum alloy curtain wall, (can be equipped with internal blinds, sliding windows, sliding doors, screen windows)
Optional accessories	furniture / home appliances / lighting bathroom / SPC lock floor / linings / insulation cotton, curtains, single open glass door / double open glass door
Usage	Scenic tent camps, B&B tent camps, special wild luxury camps, garden landscapes, hot spring vacations, water park lounges, leisure tourism, specialty restaurants, etc.



Layout diagram

Projected area: 24.3m² Terrace area: 41m²

Diameter (m)	Side height (m)	Top height (m)	Indoor area (m ²)	Projected area of tensile membrane (m ²)	Platform reference area (m ²)
6m	2.5	5.7	24.3	52	41
8m	2.5	6.3	40	78	68
10m	2.5	7.7	62.3	110	102

*Dimensions can be customized



Sectional View



Perspective View



Wild luxury series multi-top structure



The design concept of "close to nature" and "integration into nature" is an assembled modular standardized design, which can be assembled and spliced into multiple pieces. It has a lazy sofa, independent bathroom, private bathtub, open-air viewing platform, and unique small decorations, which meets the living preferences of young people. From accommodation, entertainment to catering, it has complete supporting facilities, making it a good residence especially suitable for family activities, friend gatherings, and couples' vacations.

Configuration list:

Platform structure	Steel-wood hybrid structure
Tarpaulin series	PVC knife coated synthetic fiber fabric weight 650-850g/m ²
Tarpaulin color	white / sand yellow / beige / black / silver gray / color can be customized
Wall system	double-layer hollow glass wall, aluminum alloy curtain wall, (can be equipped with internal blinds, sliding windows, sliding doors, screen windows)
Optional accessories	furniture / home appliances / lighting bathroom / SPC lock floor / linings / insulation cotton, curtains, single open glass door / double open glass door
Usage	Scenic tent camps, B&B tent camps, special wild luxury camps, garden landscapes, hot spring vacations, water park lounges, leisure tourism, specialty restaurants, etc.



Layout diagram

Projected area: 140m² Terrace area: 231m²

Diameter (m)	Length (m)	Side height (m)	Top height (m)	Indoor area (m ²)	Platform reference area(m ²)
6	15	2.5	5.7	78	135
8	21	2.5	6.3	140	231
10	26	2.5	7.7	200	338

*Dimensions can be customized



Sectional View



Perspective View



Wild luxury series multi-top structure



Encounter the stars and the Milky Way in the dark night
Lying in bed and watching the stars
What makes your heart beat is not the five-star hotel but the 50,000 stars that you can see as soon as you look up. This is probably the best interpretation of the starry series tents.

Configuration list:

Platform structure	Steel-wood hybrid structure
Bracket system	Q235 high-strength steel pipe (surface hot-dip galvanized treatment)
Tarpaulin series	PVC knife coated synthetic fiber fabric weight 650-850g/m²
Tarpaulin color	white / sand yellow / beige / black / silver gray / color can be customized
Transparent windows	round or triangular transparent PVC windows are available upon request
Optional accessories	furniture / home appliances / lighting bathroom / SPC lock floor / linings / insulation cotton, curtains, single open glass door / double open glass door
Usage	Scenic tent camps, B&B tent camps, special wild luxury camps, garden landscapes, hot spring vacations, water park lounges, leisure tourism, specialty restaurants, etc.



Layout diagram

Projected area: 28.3m² Terrace area: 49m²

Diameter (m)	Side height (m)	Projected area (m²)	Spatial volume (m³)	Tarpaulin area (m²)
6	3.52	28.3	70	69
7	4.1	38.5	110	93
8	4.68	50	168	123

*Dimensions can be customized



Sectional View



透视图
Perspective View



Starry series elliptical dome tent



Compared with the dome shape, the elliptical dome tent is a more personalized shape. The long strip shape looks like a goose egg when viewed from a height. The overall longitudinal space becomes longer, which is more comfortable and can make full use of the space and place furniture reasonably.

Configuration list:

Platform structure	Steel-wood hybrid structure
Bracket system	Q235 high-strength steel pipe (surface hot-dip galvanized treatment)
Tarpaulin series	PVC knife coated synthetic fiber fabric weight 650-850g/m ²
Tarpaulin color	white / sand yellow / beige / black / silver gray / color can be customized
Transparent windows	round or triangular transparent PVC windows are available upon request
Optional accessories	furniture / home appliances / lighting bathroom / SPC lock floor / linings / insulation cotton, curtains, single open glass door / double open glass door
Usage	Scenic tent camps, B&B tent camps, special wild luxury camps, garden landscapes, hot spring vacations, water park lounges, leisure tourism, specialty restaurants, etc.



Layout diagram

Projected area: 32.2m² Terrace area: 63m²

Length (m)	width (m)	Top height (m)	Indoor area (m ²)	Platform reference area(m ²)
7	4.8	3.3	22.6	48
8	6	4	32.2	63

*Dimensions can be customized

Sectional View



Perspective View





Starry Series Beetle Tent



The Beetle has colorful and bright colors and a childlike shape. Considering that a family with children is traveling, a parent-child room is also required. Comprehensive planning has been carried out from the exterior color matching to the internal layout. It is an outdoor camping tent that can be used for family parent-child rooms.

Configuration list:

Platform structure	Steel-wood hybrid structure
Bracket system	Q235 high-strength steel pipe (surface hot-dip galvanized treatment)
Tarpaulin series	PVC knife coated synthetic fiber fabric weight 650-850g/m²
Tarpaulin color	white / sand yellow / beige / black / silver gray / color can be customized
Optional accessories	furniture, home appliances, bedding, lighting, bathroom SPC lock floors, luxury curtains, thermal insulation cotton (color and thickness are optional), integrated bathroom system (shower, toilet, wash basin), screen windows, solar ventilation windows, push-out windows, rolling shutter windows, PVC rolling shutter doors, aluminum alloy doors.
Usage	Scenic tent camps, B&B tent camps, special wild luxury camps, garden landscapes, hot spring vacations, water park lounges, leisure tourism, specialty restaurants, etc.



Layout diagram

Projected area: 23.7m² Terrace area: 72m²

Length (m)	width (m)	Top height (m)	Indoor area (m²)	Platform reference area(m²)
7.2	6	4	23.7	72

*Dimensions can be customized

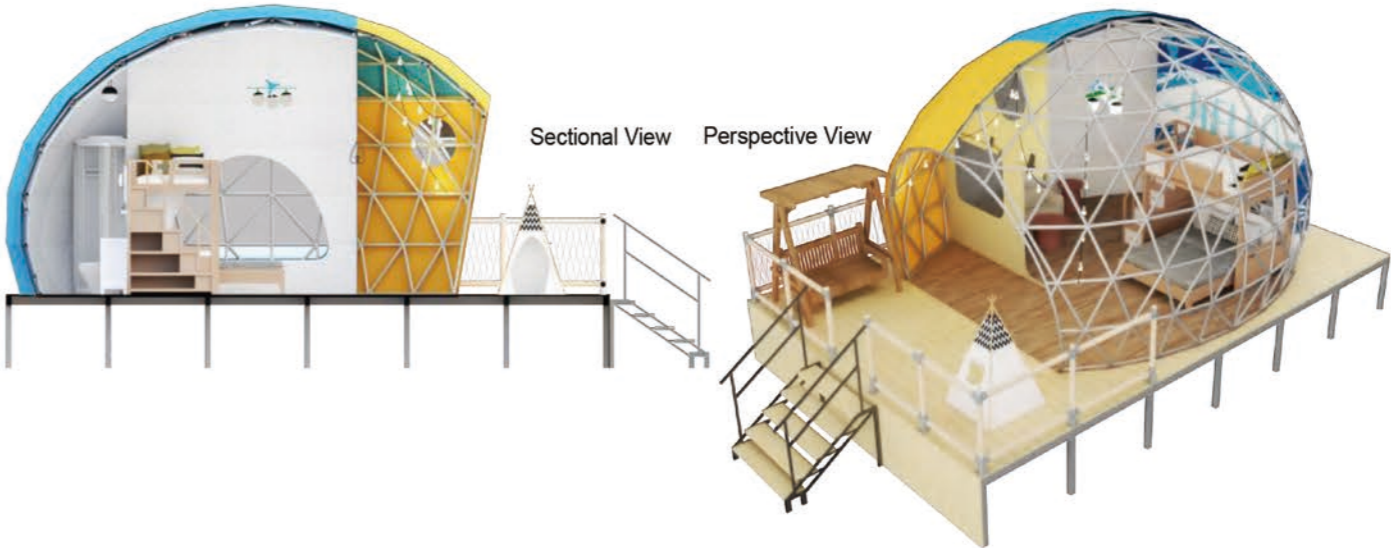



Mushroom House Series



Configuration list:

Platform structure	Steel-wood hybrid structure
Bracket system	Q235 high-strength steel pipe (surface hot-dip galvanized treatment)
Tarpaulin series	PVC knife coated synthetic fiber fabric weight 650-850g/m ²
Tarpaulin color	white / sand yellow / beige / black / silver gray / color can be customized
Transparent windows	Hexagonal transparent PVC windows can be applied upon request
Optional accessories	furniture / home appliances / lighting bathroom / SPC lock floor / linings / insulation cotton, curtains, single open glass door / double open glass door
Usage	Scenic tent camps, B&B tent camps, special wild luxury camps, garden landscapes, hot spring vacations, water park lounges, leisure tourism, specialty restaurants, etc.



First floor indoor area: 15m² Second floor indoor area: 28m²

First floor diameter(m)	Second floor diameter(m)	Second floor height(m)	Top height (m)	First floor area (m ²)	Second floor area(m ²)
4.4	6	2.8	6.3	15	28
5.3	7	3.0	7.1	22	38
6.3	8	3.0	7.7	31	50

*Dimensions can be customized



Sectional View



Perspective View



Mushroom House is a new self-developed patented product, with first- and second-generation products for customers to choose from. Create a stacked LOFT unit, with a kitchen on the first floor and bedrooms on the second floor to maximize space utilization, meet the needs of integrated life and leisure, and improve the quality of living.



Shell series



The shell tent combines the elegant form of architecture and bionics and is the best choice among various outdoor camps. It has an open platform to meet the viewing needs from different angles. The pointed shell corners can provide adequate shelter from rain and sun. The spacious platform attracts many children and can be turned into a parent-child amusement park. There are three room types available: mini, standard, and luxury.

Configuration list:

Platform structure	Steel-wood hybrid structure
Bracket system	Q235 high-strength steel pipe (surface hot-dip galvanized treatment)
Tarpaulin series	PVC knife coated synthetic fiber fabric weight 650-850g/m ²
Tarpaulin color	white / sand yellow / beige / black / silver gray / color can be customized
Optional accessories	furniture / home appliances / lighting bathroom / SPC lock floor / linings / insulation cotton, curtains, single open glass door / double open glass door
Usage	Scenic tent camps, B&B tent camps, special wild luxury camps, garden landscapes, hot spring vacations, water park lounges, leisure tourism, specialty restaurants, etc.



Layout diagram

Standard type indoor area: 31m², one bedroom, one living room and one terrace

Span (m)	Length (m)	Top height (m)	Indoor area (m ²)	Platform reference area (m ²)
4	11.7	2.85	31	46
5	12.3	3.5	42	61
6	13.1	4.3	53	78

*Dimensions can be customized



Sectional View



Perspective View

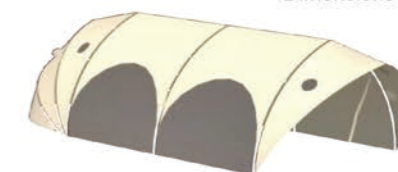

Exploded View



Capsule hotel series



The fashion capsule is an upgraded version of the capsule cabin. It continues the modular structure model of quick disassembly and assembly, and has a variety of colors, materials, and styling designs. The entire wall can be designed with transparency, whether it is glass or PC board, it can have great lighting and transparency.

The fashion capsule has a rich color scheme, with simple white, calm black and passionate colors. The wall can be designed with some personalized visual design to match the brand image.

The high-looking advertising effect is like a walking advertising machine, which can achieve better publicity effect for the brand.

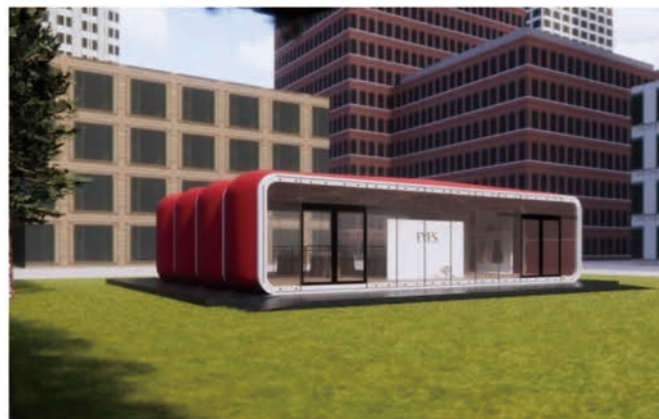

Configuration list:

Platform structure	Steel-wood hybrid structure
Bracket system	Q235 high-strength steel pipe (surface hot-dip galvanized treatment)
Tarpaulin series	PVC knife coated synthetic fiber fabric weight 650-850g/m ²
Tarpaulin color	white / sand yellow / beige / black / silver gray / color can be customized
Wall system	transparent PC board, hollow glass wall
Optional accessories	smart furniture system, lighting system, integrated bathroom SPC lock floor, curtains, doors, fingerprint locks, etc.
Usage	Tent camps in scenic spots, B&B tent camps, coffee houses in scenic spots, 4S image showrooms, stores, etc.



Indoor area: 16.5m² Platform area: 5.4m²

Width (m)	Pitch (m)	Height (m)	Indoor area (m ²)	Spatial volume (m ³)
2.2	2.5	2.3	5.75	13.22
4	2.5	2.5	10	25
6	2.5	3	15	45
8	2.5	3	19	60
10	2.5	3	24	75
12	2.5	3	29	90

*Dimensions can be customized



Sectional View



Perspective View

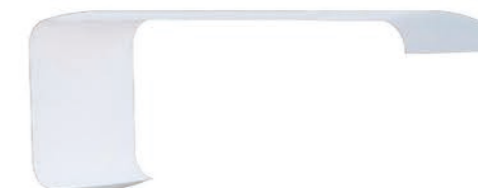

Exploded View



Mongolian yurt series



The world-famous architectural form of the yurt is a major innovation of the Asian nomads. Today we are trying to combine this traditional building method with modern architecture. Although the yurt looks small in appearance, it has a large usable area with indoor air circulation and excellent lighting conditions. It is easy to build and relocate. It is suitable for animal husbandry production and nomadic life. Of course, you can also realize your feelings of the prairie anytime and anywhere.

Configuration list:

Platform structure	Steel-wood hybrid structure
Customizable sizes	5m / 6m / 8m / 10m / 12m
Tarpaulin series	PVC knife coated synthetic fiber fabric weight 650-850g/m²
Transparent windows	Hexagonal transparent PVC windows can be applied upon request
Transparent windows	round or triangular transparent PVC windows are available upon request
Optional accessories	ceiling interior, glass doors, rolling shutter doors, floor systems, hard walls, load-bearing chassis, screens, sliding doors, transparent windows, bathrooms, furniture, ground anchors, drainage channels, etc.
Usage	Mongolian grassland camps, B&B tent camps, special scenic spots camps, etc.



Layout diagram

Projected area: 5.4m²

Width (m)	Top height (m)	Projected area (m²)
5	4.2	16.5
6	4.5	23.5
8	4.9	45.5
10	5.4	73.5
12	5.9	106

*Dimensions can be customized



Sectional View



Perspective View

Characteristics of PVC Oxford fabric



Hubei Jinlong Company participated in military research projects, benchmarked against the US military tarpaulin requirements, and studied the current status of military tarpaulins in my country. During the military's research on tarpaulins, some performance shortcomings were discovered that urgently need improvement. Some results of related research can also be used to improve product performance in the civilian field. Jinlong Company quoted military technology, introduced cutting-edge technology to upgrade the functions of civilian products, and developed a targeted PVC Oxford fabric suitable for outdoor tents and canopies.

Comparing the excellent performance characteristics of PVC Oxford fabrics with traditional tent fabrics, they mainly include:

1. Strength difference: Traditional fabric types and fabric strength requirements have not kept up with the progress of the industrial chain. Traditional vinylon fabrics (canvas) and polyester civilian yarn fabrics (Oxford fabric) have the same square gram weight. There are common strength indicators such as tensile strength and tear strength, which are not as good as high-strength industrial polyester filament fabrics. PVC Oxford fabric is made of high-strength industrial polyester filament reinforced fabric, and composite materials matching different strength requirements can be designed according to the applicable area.

2. Outdoor weather resistance: Oxford fabric has insufficient light resistance, and the fiber molecular chains caused by ultraviolet rays are broken. Even if it has been treated with ultraviolet resistance, it is still unsatisfactory. The printing and dyeing process of Oxford fabric is a highly polluting industry strictly controlled by the state, and it is not environmentally friendly enough. , the color has insufficient light fastness, and will fade significantly after a short period of outdoor sunlight. The old appearance will appear in a short period of time, affecting the aesthetics. The color fastness of PVC Oxford fabric adopts additive process, which is different from printing and dyeing process. The color fastness is much better than traditional printing and dyeing fabrics, the entire production process is pollution-free, and it is

4. Wicking: With the traditional waterproof treatment of single-sided coating of fabric, the wicking phenomenon cannot be avoided, absorbing water and moisture, making it difficult to dry. The coating material on one side will become damaged, leakage, and light transmission after repeated use. The PVC Oxford fabric is treated with double-sided polymer materials to avoid wicking. It dries quickly after getting wet, has a longer service life, and is easier to store and store.

5. Creases and shading: The single-sided coating of traditional fabric (for example: silver coating, black coating) has a certain shading effect. After repeated use, creases or breaks, coating aging, coating peeling off, and loss of aesthetics. Practicality is greatly reduced. The unique process of PVC Oxford fabric has light-shielding properties, folding resistance, smoothness and excellent resilience.

6. Flame retardancy: The good flame retardancy of traditional fabrics is difficult to achieve satisfactorily and the safety is insufficient. The flame retardant properties of PVC Oxford fabric can extinguish fire immediately, greatly improving safety.

7. Anti-ultraviolet: Outdoor products must protect human skin from sunburn caused by ultraviolet rays. PVC Oxford fabric is designed with special anti-ultraviolet penetration capabilities, which is better than ordinary fabrics.

8. Special properties: The needle-shaped whisker nanomaterial added to PVC Oxford fabric is a special three-dimensional reinforcing material, and military technology is used in civilian products. Special modified rubber material ensures resilience, comfort, cold resistance and folding resistance.

9. Appearance: The specially designed surface texture breaks through the texture characteristics of traditional fabrics and can be designed with colorful surface textures, which is more fashionable and beautiful.

PVC Oxford fabric has now achieved excellent performance and application advantages, with ten physical indicators integrated into one. It is produced using military confidential formulas, advanced technology, and multiple sets of equipment to accurately match.

1. Super strong base force
2. Super weather resistance
3. Mildew resistance
4. High shading
5. High flame retardant
6. High cold resistance
7. Super anti-violet
8. Super waterproof
9. High strength and high elasticity technology
10. Special texture style, high resolution and recognition

Ultra-light weight of 310g/square meter, more convenient to carry, the world's widest fabric of 5 meters breaks the industry bottleneck, extending the production space to unlimited

In the next 3 to 5 years, there will be development space and applications. More technological elements will be embedded in fabrics. Heat insulation and noise reduction technologies will be implanted in fabrics to meet users' sleep and leisure requirements. The fabric structure will break through the aramid manufacturing process. Fully realize the safety performance of outdoor tents, greatly improving the fabric's anti-cut, anti-puncture and anti-theft properties to satisfy customers' safety psychology.

Development space in the next 5 to 10 years, further research on cutting-edge science and technology, extract high-performance lighting and luminous lighting raw materials from special rare ores and add them to coated fabrics. Plant extracts are implanted to realize the outdoor tent's own mosquito repellent and insect repellent functions. At the same time, we jointly develop remote control installation, storage, ventilation, air conditioning, and sonic positioning search and rescue functions with electronic technology companies, truly realizing that technology changes life and technology benefits the outdoors.