

ARTICULATED STRUT LIFTER

HU43025

- Supports the strut on the vehicle: 500Kg
- To be mounted on 30mm Hydraulic transmission
- POM (polyoxymethylene) clamping jaws to avoid damage to the strut.
3 Sizes of Jaws (Light vehicle , Light commercial vehicle , rear shock absorbers)
- Depth and tilt adjustment

Ideal for the following operations :

- Removal and installation of struts
- Removal and installation of drive shaft
- Removal and installation of arms and Hub ball joint separation
- 100% safe Work
- Operator has both hands free to work safely.

No risk of damage to parts as :

- Sensors
- Wiring harness
- Plastic protection, Body

Works on electric vehicles Tesla, Zoe, Leaf, Hyundai, Kia etc..

Ideal for modern vehicles with double triangulation



ARTICULATED STRUT LIFTER

HU43025

Security :

- Once the tool is placed, the operator has both hands free to work safely.
- The tool supports up to 500Kg of pressure

Productivity :

- The tool is placed in less than a minute
- Dismantling of a strut in 7 to 8 minutes
- No risk of damage to mechanical parts or bodywork

Creativity :

- Patented tool
- Axial adjustment in 5 positions
- 120° articulation to respect the geometry of the suspension



Very Compact ,can be used on the right or on the left side !

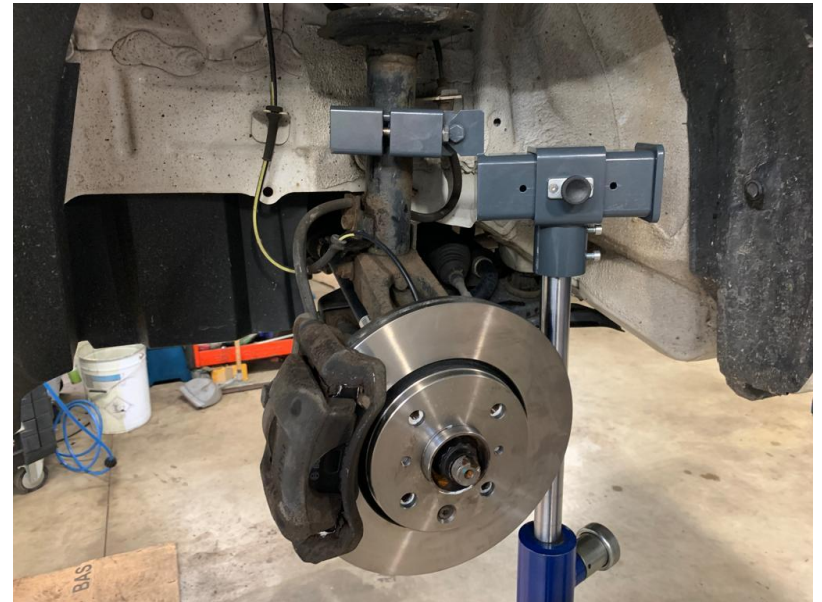

Ideal for complicated suspension with double triangulation!

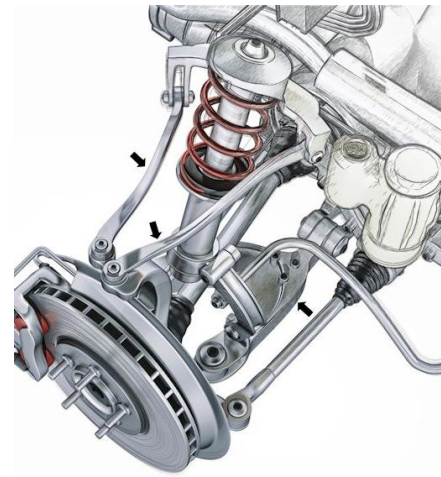
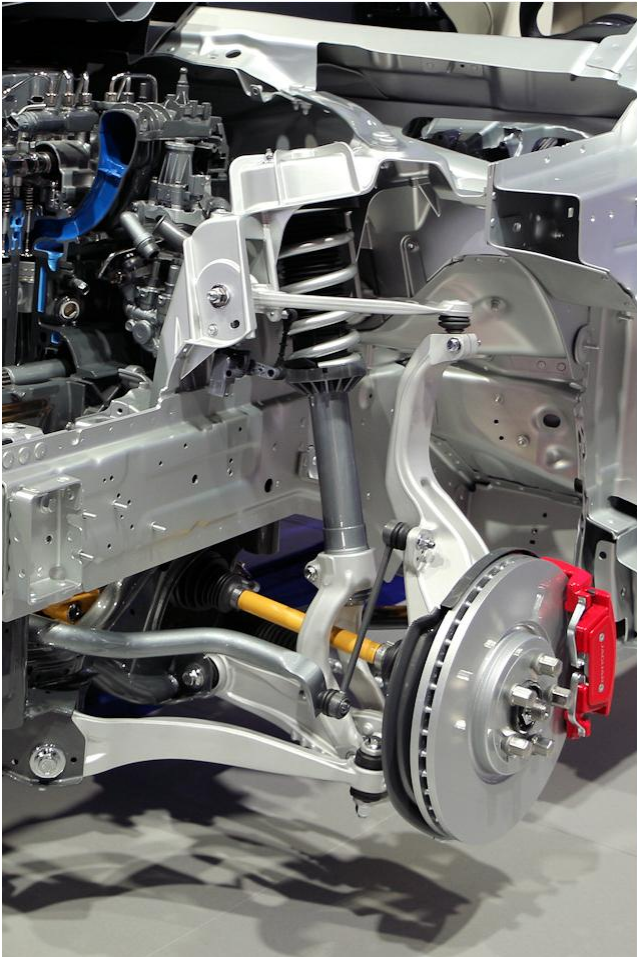

Example of vehicles with a double wishbone suspension

- BMW X6
- Mercedes
- Jaguar
- Lancia
- Alfa Roméo
- Ferrari 812 GTS
- McLaren 720S
- Lexus LC
- Tesla Model 3
- Tesla Model S
- Tesla Model X
- Lexus NX
- Acura RLX
- Acura RDX
- BMW 5 Series
- Toyota Highlander
- Toyota Sequoia
- Ford Expedition
- Toyota 4Runner
- Lamborghini Huracan
- Bugatti Veyron
- Porsche Cayenne

ARTICULATED STRUT LIFTER

HU43025



**Ball joint and Arms
Disassembly and
Reassembly**



**Hubdisassembly
and reassembly**



**Drive Shaft disassembly
and reassembly**

Ideal for the following operations:

- Removal and installation of constant velocity joints**
- Assembly and disassembly of the struts**
- Separation of hub and lower arms**
- Separation of the ball joints**





Existing products:

- No security
- 100 Kg vs 500 Kg
- Often impossible to place

Accessories :

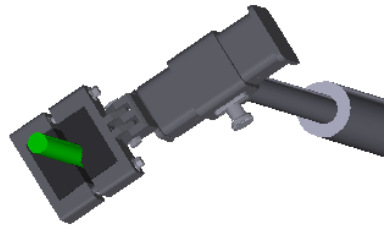

**Rear Shock absorber
Clamping jaws 22-
44mm**

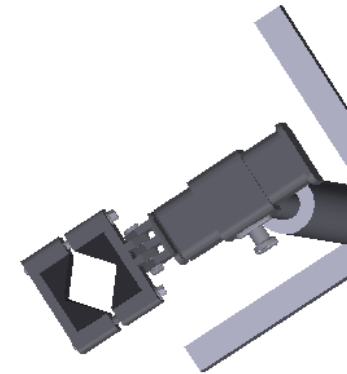

**Light commercial vehicle
front Shock absorber
clamping jaws 67mm-
Max**