

Instructions for Multi-loading Grease Gun

Follow These Steps Carefully Before Using This Gun.

How to load a grease gun cartridge.

Step 1

Unscrew the head from the barrel.

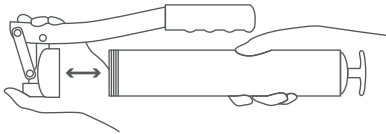

Step 2

Pull back the rod handle and lock into position.

(A) Push-Lock Style:

Pull the rod handle through the housing and pull into the slotted end cap.

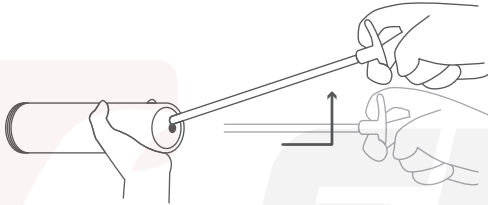

(B) Stopper Style:

Pull back the rod handle to automatically lock the rod by stopper in the position.

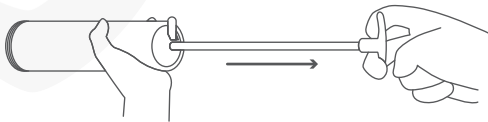

Step 3

Remove the plastic cap from the end of grease cartridge, and insert the open end first into the barrel.



(A)
Cartridge
Loading



(B)
Dispenser
Loading



(C)
Bulk
Loading

Step 4

Screw head back onto the barrel.

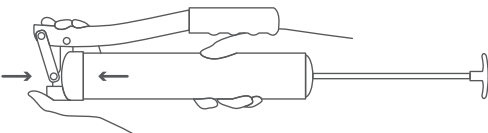

Step 5

Unlock the rod handle from the end cap.

(If the rod handle is hard to release back from the end cap, slightly loosen the gun head 1~3 turns)

(A) Push-Lock Style:

Release the rod handle from the slotted end cap, and push down the rod handle into the barrel.

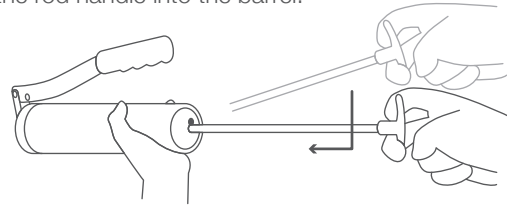

(B) Stopper Style:

Press the stopper to release rod handle from end cap, and at the same time push down the rod handle into the barrel.

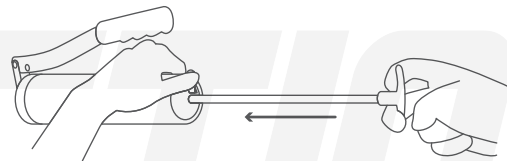

Step 6

Unscrew gun head 1~3 turns and pump the lever handle around 6-8 times until grease comes out. This releases air pockets from barrel and makes it easy to pump the grease.

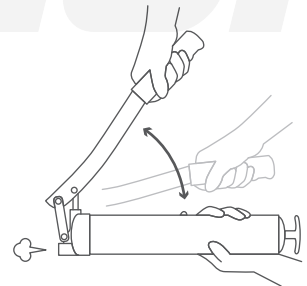

Step 7

Screw the gun head tightly and ready for priming.

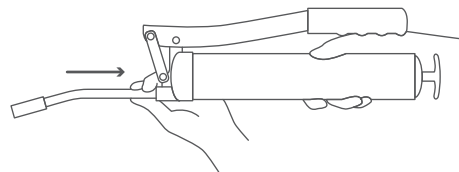

Trouble shooting

Problem: Gun not pumping grease.

Possible causes: Air pocket between in the tube and gun head, or between in the gun head and spout.

Solution: (1) Take off spout from gun head.

(2) Unscrew container tube 1-2 turns from gun head.

(3) Pump the lever handle around 6-8 times until grease comes out.

(4) Screw the gun head tightly.