

# NST

# NST

Dalian Newstar Automobile Equipment Co., Ltd.

No. 8, Chengfeng Road, Shisanli Industrial New Area, Dalian China

Tel.: +86-411-39253920

Fax: +86-411-39253926

E-mail: [info@nsttool.com](mailto:info@nsttool.com)

Website: [www.nsttool.com](http://www.nsttool.com)

大连纳思达汽车设备有限公司  
Dalian Newstar Automobile Equipment Co., Ltd.

Auto intelligent special tools brand  
designated by millions of dealers.





NST, established in 2005, is the largest enterprise in China specializing in the R&D and the production of intelligent tools for automobiles. Serving as an executive director unit of the China Automotive Maintenance Equipment Industry Association, NST provides comprehensive solutions, including after-sale maintenance documents, tools, equipment, training consultation, and services to automobile manufacturers. Over nearly two decades of development, NST has established strategic partnerships with more than one hundred automobile manufacturers, new energy vehicle enterprises, and more than ten thousand dealers.

## R&D Honors

NST possesses leading independent research and development capabilities in China, having obtained over one hundred patents for research and development technologies.



Undertake more than 80% of the self-owned brand special tools system construction;  
Undertake more than 90% joint venture brands' special tools localization projects;  
More than 60 senior engineers work together;  
Over 20 years, around 70 automakers, nearly 100 models of special tools design and production experience;

Special tool machining, testing production line imported from Italy;  
National Auto Maintenance Special Tool Standard Drafting enterprise;  
More than 100 National patents;  
National "high-tech enterprise".





Main Customers

# Product Catalogue

01	Electric Vehicle Maintenance Tools	05
02	Intelligent Painting Robot	17
03	Auto Body Repair System	21
04	VW/AUDI Special Tools	25
05	SAIC Special Tools	32
06	Great Wall Special Tools	39
07	Chery Special Tools	43
08	NIO Special Tools	47
09	JAC Special Tools	48
10	Geely Special Tools	51
11	Universal Equipment	55
12	NST Factory	60

91C0184



Battery Pack Repair Table

Application: EV Battery Pack Repair  
Dimension: 2200\*1500\*1000 mm  
Load: 1000 kg

18E0019



Battery Storage Rack

Application: EV Battery Pack storage  
Dimensions: L2400 W1600 H700;  
All connections are insulated;  
The storage rack is equipped with a safety lock to prevent the battery from slipping and causing danger;  
Anti-static spraying treatment to prevent the frame from the danger of high-voltage electrostatic breakdown of the battery.

14E0017



Battery Lift

Application: EV Battery Pack remove and install  
Lifting Capacity: 1000 KG  
Maximum Height: 1645mm  
Minimum Height: 645mm  
Platform Size: 1600x800mm  
Caster Wheel Diameter: 150mm  
Lift: Manual hydraulic

18E0010



Battery Lift (Adjustable)

Application: EV Battery Pack remove and install  
Rated lifting weight: 1000 KG  
Maximum lifting height: 1800 mm  
Platform adjustable range: Move in the front, back, left & right directions 100mm  
Upper board body size: 1780×820 mm  
Bottom support size: 1915×850×580 mm

14E0017R2



Battery Lift (Pneumatic)

Application: EV Battery Pack remove and install  
Lifting Capacity: 1200 KG  
Platform Size: 1600x800 mm  
Insulated Support Beams: 800\*100\*100 mm  
Maximum Height: 1600 mm  
Minimum Height: 600mm  
Lifting Method: Pneumatic, hydraulic  
Intake Pressure: 0.6-0.8 Mpa

18E0011



Battery Lift (Automatic Electric)

Application: EV Battery Pack remove and install  
Lifting capacity:1000kg  
Battery capacity: 105Ah  
Lifting Motor Power: 1KW  
Platform length: 1300±5mm  
Platform width: 700±5mm  
Max height: 1800±5mm  
Min height: 800±5mm  
The left and right tilt angle can be adjusted: 3°±1°  
Dimensions: Length 1600±5mm X Width 700±5mm X Height 800±10mm



91C0076



Goggles

Application: EV Repair  
 1. Executive standard: GB14866-20063;  
 2. The lens is made of PC material to protect maintenance personnel from splashes, high heat, ultraviolet rays, etc.;  
 3. The frame is made of flexible PVC material, which closely fits the face.

97C0056



Retractable Belt Barrier

Application: Placed on both sides of the EV maintenance station.  
 Portable disassembly, this product is composed of a telescopic head, cloth belt, rod body, and base, which can be freely disassembled and assembled for convenient transportation and portability.

97C0055R1

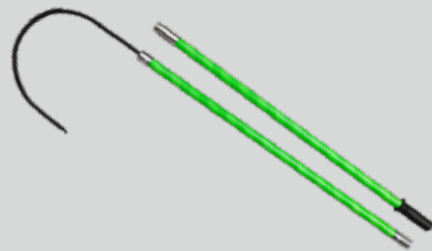

Insulated Rescue Hook

Application: EV Repair high-voltage insulated rescue  
 Voltage level: 110kV  
 Product specification: 1 meter \* 2 sections  
 Product material: Insulated fiberglass (FRP)  
 Product bearing capacity:  $\geq 80\text{KG}$

14E0045



Battery Module Extraction Tool

Application: EV battery module remove  
 Insert the tool into the positioning hole of the battery pack module, rotate the upper handle to squeeze the tool against the inner wall of the module and increase the friction to extract and install the battery pack module.  
 Application: AS23P EU  
 e-HS、AS23P MCE EU  
 e-HS MCE、ZS11E  
 EZS, Saic passenger car EP21

97C0057



High Voltage Warning Sign

Application: EV Repair high-voltage warning  
 1. High-strength ABS plastic;  
 2. "Danger! Do Not Approach" high voltage sign.

97C0062

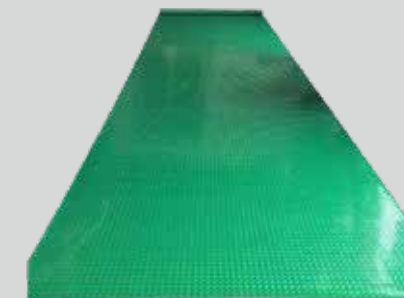

Insulated Mat

Application: EV Repair work station  
 Applicable standard: HG2949-1999;  
 Insulation class:  $\geq 1000\text{V}$ ;  
 The waterproof level of the tool is similar to that of the plastics or the rubber material;  
 Willow pattern in green, two pieces (7m\*2m/pc) for each work station;  
 Thickness 4mm



91C0175

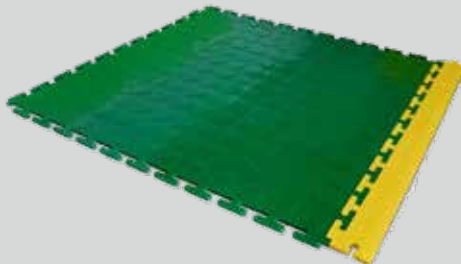

Insulated Mat

Application: EV Repair work station  
Size: 50\*50 cm/ pc  
Border width: 35mm  
Thickness : 6mm  
Color: Red or Green  
Can be customized in size according to the worksta-  
tion size.

NST-J094



Insulated Gloves

Application: EV Repair  
Flexible operation and good insulation.  
Palm shaped design, more suitable for hand shape and  
more convenient operation.  
Withstand voltage: 12000V  
Material: Natural rubber  
Product weight: 0.4Kg  
Executive standard: GB/T17622-2008

97C0049



Insulated Tools Kit 66 pcs

Application: EV Repair  
Include 1 Trolley and 66 pcs Insulated Tools. The  
insulated tools are respectively placed in the three  
drawers of the Trolley;  
Have got VDE approval;  
Insulation withstand voltage 1000V, Comply with  
IEC/EN 60900-2004 standard;  
Has passed the Adhesion Test, Flame Test, Torsion  
Test, Pressure Test, High & Low Temperature Test  
Oven, Extreme Low Temperature Impact Test and  
Dielectric Test.

97C0291



Insulated Socket Set 24pcs

Application: EV Repair  
Have got VDE approval;  
Insulation withstand voltage 1000V, Comply with  
IEC/EN 60900-2004 standard;  
Has passed the Adhesion Test, Flame Test, Torsion  
Test, Pressure Test, High & Low Temperature Test  
Oven, Extreme Low Temperature Impact Test and  
Dielectric Test.







18E0030 Battery Explosion-proof Box

There are a certain amount of battery packs to be installed in the car manufacturing workshop and repair shops. These battery packs are sometimes dangerous due to poor management, even explosion will occur in severe cases, such as impact or high temperature will cause battery leakage and smoke. When such situation occurs, people can only be evacuated nearby or transfer the battery to a safe area, but still have hidden safety risk. This battery explosion-proof box is easy to use, saves time and effort, prevent battery accidents, put the battery pack into the explosion-proof box quickly, ensure the safety of the operators. This high voltage battery explosion-proof box is a professional and essential equipment designed for EV repair.

Main Features:

- 1.It is made of 5mm thick steel plate with a top cover. Are welded against liquid leakage according to national standards, and a sealing test report should be provided with the product.
- 2.The specifications can be customized according to the size of high-voltage batteries.
- 3.The inner plate of the explosion-proof box is made of fireproof material with a thickness not exceeding 30mm and can withstand acid and alkali.
- 4.Two air springs are installed on both sides of the box cover, providing two opening angles for easy operation.
- 5.There is an inlet pipe on the box cover for connecting a filling valve for water injection, there's an outlet pipe at the bottom of the box.
- 6.The box cover includes an exhaust port sealed with a brass safety valve to prevent over pressure and automatically release air.
- 7.Liquid level indicators are installed on the side of the box, with a red float indicating the liquid level inside the box.

46E0018R1 Battery Pack Air Tightness Detector

Automatic air tightness detector is a professional test equipment developed for new energy vehicles. It is used for the air tightness test of cooling water channel and cavity of the battery pack and motor.

Poor battery airtightness can lead to severe degradation in battery performance, electrolyte leakage, battery swelling, and even explosions. The new type of airtightness tester uses compressed air as the detection medium, offering greater stability and efficiency compared to traditional water bubble testing.



Rated voltage	AC110V ~ 220V
Rated power	100W
Pressure test sensor	0kPa-500kpa, accuracy 1Pa
Pressure accuracy	± 0.1%FS
Pressure repeat accuracy	0.02%FS
Measurement medium	air, when positive pressure testing, air source requires 0.6-0.8MPa
Over-pressure protection	support
Environmental temperature	Storage 0C ° -50C ° , Use 0C ° -50C ° , No frost and dew
Equipment language	Chinese/English, Other languages can be customized
Display screen	10.1 -inch multi -point color capacitor touch screen
Protection level	IP41
Certification	CE
Test log	The screen can be readable, can be output through a U disk or WiFi
Software upgrade	U disk or wifi upgrade
Storage parameters	100 group test parameters
Air intake	International standard universal fast insert interface
Output form	International standard universal interface (low voltage air tight test port) European standard fast interface (high voltage air tight test port)





NST02050 Battery Module Charge & Discharge Device

In the process of replacing the battery module, the module is charged and discharged to adjust the voltage or SOC of the module in the same standard range. Then avoid the inconsistency caused by the replacement of modules, which leads to unreasonable attenuation of the new energy vehicles RPC. When the device is used in a regular maintenance of the module, the spare parts module can be charged and discharged to activate the battery activity, restore the battery capacity, and adjust the SOC when the battery module is stored, To avoid damage to the battery module due to high or low SOC, resulting in irreversible battery capacity attenuation.

Input voltage	AC200 ~ 240V, 50Hz ~ 60Hz
Support the number of balanced batteries	1 ~ 121 string, 1 ~ 24 string is available
Maximum current charging and discharge	10A, 20A, 30A multi -series
The maximum value of battery voltage sampling	0 ~ 5V
Battery voltage test accuracy	± (0.1%FS+0.1%RD)
Working environment humidity	20% ~ 80%
Working environment temperature	-20 ℃ ~ 40 ℃
Language	Chinese and English, other languages can be customized

14E0113 Battery Cells Equalization Device

The cells equalization device is designed for charging and discharging the cell in the module and collecting the data of the single battery cells to ensure the safety. Suitable for the management and maintenance of power modules composed of lithium iron phosphate batteries, lithium cobalt batteries, lithium manganese Li ion batteries or ternary lithium batteries. Use the method charging or discharging to charge and discharge each battery cell in the module, so that the battery cells in the module can reach the same state of charge, improve the dynamic consistency and output performance of the module, and thus increase the service life of the battery pack.



Power supply voltage	AC 220V AC 50Hz
Support string number	2-36 (upgrade is available)
Single string voltage collection range	0-5V
Voltage collection accuracy	± 2mv
Equalizing current	1-5A MAX
Working environment humidity	20% ~ 80%
Working environment temperature	-20 ℃ ~ 40 ℃
Control method	High-definition touch screen
Protection function	Opposite connection protection, over voltage protection, over current protection, over temperature protection, abnormal power loss protection
Cooling method	Air cooling
Use environmental conditions	Non-corrosive, explosive and insulation damaged air and conductivity dust, etc.
Language	Chinese and English, other languages can be customized





14E0109 Single Cell Charge Device

Since electric vehicles use lithium batteries as their power source, during the charging and discharging process of lithium batteries, the capacity difference between different single cells will gradually increase with the use time, resulting in a decline in the performance of the entire battery pack. The single cell replenish equipment can monitor the power and capacity of each single cell, and then charge the single cell with a low power in the battery pack to achieve a balanced charging state of the battery pack. This can extend the service life of the battery and improve the performance and reliability of the battery pack. At the same time, the cell replenish equipment can also detect the temperature and status of the battery cells to ensure the safety of the battery, and is suitable for charging and discharging maintenance of battery cells.

Application range	Lithium cells within 1-5V, 2-999Ah
Charging range	1-5V adjustable, 1-50A adjustable, constant current, constant voltage
Discharge range	1-5V adjustable, 1-50A adjustable, constant current/constant voltage (no spike pulse)
Process steps	Charge/discharge/cycle 1-5 times
Protection method	Battery over voltage/battery reverse connection/battery disconnection/high temperature alarm and protection inside the machine
Accuracy	Voltage ±0.1%; Current ±0.2%
Heat dissipation	Temperature-controlled fan turns on at 40℃ and protects at 83℃
Note	It is prohibited to test batteries exceeding 5V
Equipment power supply	AC200-240V 50/60HZ (110V can be customized)
Working environment	0-40℃ ventilation, do not allow heat to accumulate around the machine
Dimensions	Width 210 mm, height 190 mm, depth 250 mm,
Net weight	4Kg

91E0003R1 Coolant Exchange Equipment

This equipment can replace the coolant conveniently, quickly and safely. Connect the relevant pipelines of this equipment to the corresponding positions of the coolant pipeline as required, which can realize the functions of recycling old coolant, adding new coolant, internal circulation washing, equal exchange functions. It has the characteristics of low working noise, smooth operation, simple and convenient operation interface.



Working temperature	5°C~40°C
Relative humidity	30%~80%
Atmospheric pressure	700hPa~1060hPa
Rated voltage	AC 220V ±10%
Power frequency	50Hz±1Hz
Input power	≤200w
New and old liquid tank	20Lx2
Control mode	20Lx2
Movement method	Push-pull
Display	7-inch capacitive screen
Weight	25KG
Language	Chinese, other languages can be customized



Efficient painting, human-robot collaboration, using the power of technology to drive innovation and upgrade in automotive aftermarket services. Assisting customers in achieving the goal of automated maintenance, providing customers with a more efficient and superior aftermarket service experience. This product can also be applied to various service industries such as automotive, high-speed train, aircraft, as well as various factory paintings, and technician training schools, and other fields.

Function

NST intelligent paint robot can spray the vehicle and spare parts like door, Fender, Bumper, Trunk Lid, Bonnet and other components. Blending Paint is available too.



Technology

Leading Technology

Nine-axis linkage, powerful motion algorithm, flexible and multi-directional, adaptable to various complex spraying trajectories, leading-edge technology; Visual recognition, intelligent AI, touch-based computer operation, 3D imaging, automatically generates painting trajectories, fully intelligent spraying.

Environmental friendly

Keep painters away from toxic and harmful spray

When the robot is performing painting, the paint technician can operate and observe from outside the spray booth, Keep painters away from toxic and harmful spray, which greatly improves the working environment. It is conducive to the health of the painters, and can greatly reduce the fatigue of the painters, which is a safe and environmental friendly painting method.

Intelligent

Database

Independently developed software system, paint trajectory data cloud storage, software can be upgraded remotely; it also possesses automatic learning and analysis capabilities; data traceability is supported.



Quality

Comparable to new car

Accurate trajectory, with high precision positioning of  $\pm 0.1\text{mm}$ , smooth spraying process, stable speed, uniform spraying, thickness error of  $\pm 0.02\text{mm}$ , high-quality without color deviation. Especially for special paint, the spraying effect is far superior to manual painting, comparable to the quality of a new cars.

Safety

Explosion-proof and anti-collision

Obtained the national explosion-proof certification, working normally in the explosive environments, significantly reducing operational risks. Collision-free movement and high safety.

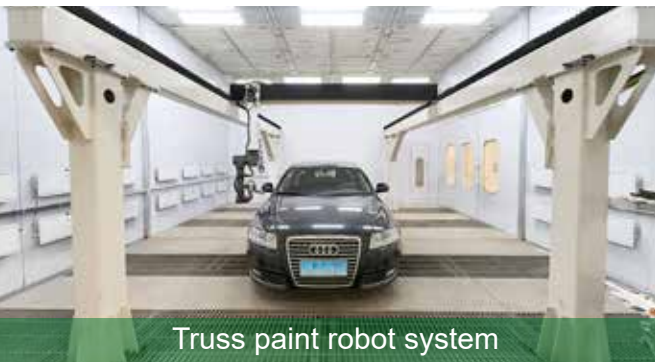



Standard spray booth configuration plan

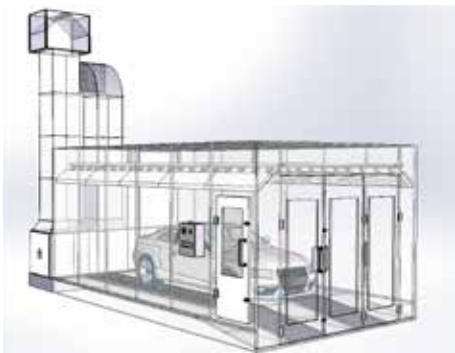

Customized spray booth configuration plan

One painting one heating

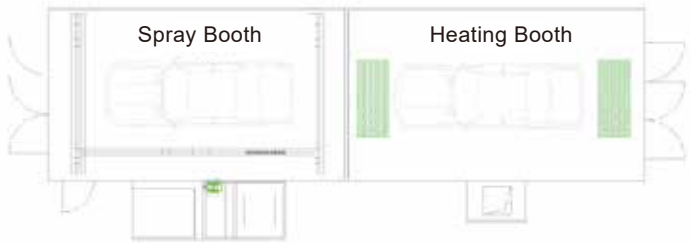
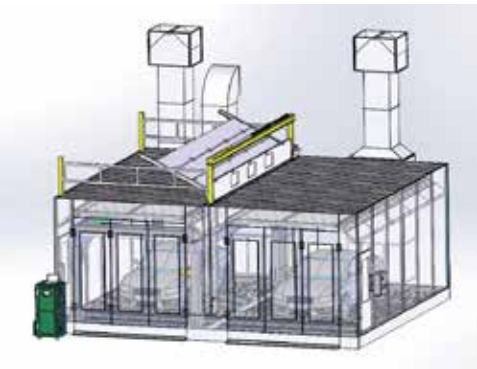

One painting two heating

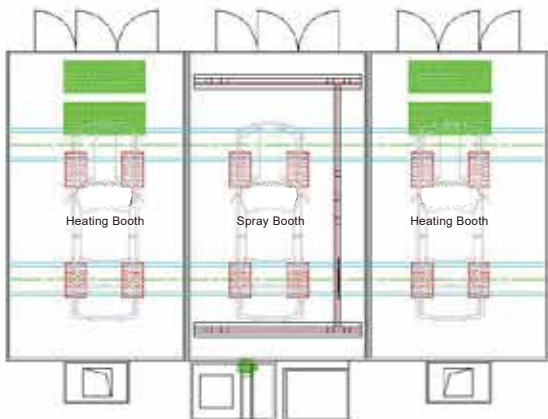
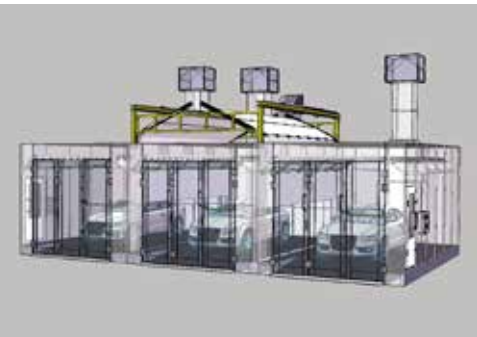

Patent certification

NST Intelligent Paint Robot is a smart paint robot system developed by NST and the Chinese Academy of Sciences, is an intelligent painting robot system featuring cutting-edge collaborative robot technology. It represents a pioneering application domestically and leads in technological achievements in the automotive aftermarket in the word. The system has been granted national invention patents, as well as patents for appearance, software, utility models, and the invention patents in the United States and the European Union.





## NST-8459 Collision Dent Repair Pullers

The Panel Repair System allows to repair damaged body panels rather than replacing them. The system comes with a variety of lightweight alloy pullers. Each puller is designed to cover most panel repairs.



Strong Puller



Item number: NST-8459R3-02-00  
 Product Name: Strong Puller  
 Application: Front framework, doorsill, creeper, front door, boot cover, mud guards, stringer and other parts for less damaged, much pressed, etc.  
 Advantage: Designed for hard steel plate repairing, which suitable for all extents of damage. It can reduce the exchange of steel plate, more efficient.



Easy Puller



Item number: NST-8459R3-03-00  
 Product Name: Easy Puller  
 Application: Repairing functions for less damaged body plates, such as dent and scratch, etc.  
 Advantage: The components are professional designed to work together, which decreases painting make up situations. Automatic welding operated easily.



Line Puller



Item number: NST-8459 04-00  
 Product Name: Line Puller  
 Applicable: Roof, front panel, car door, rear board, rear leaf board, engine hood, thumb, side door panel, rear tail board and other parts.  
 Advantages: Simple operation, all repair work is under your perfect control, as long as the handle is pushed in, the dent can be flattened at the same time, reducing the grinding time, and and painting workload.





Lever Puller

Item number: NST-8459 05-00  
 Product Name: Lever Puller  
 Application: Using the lever to maintain those powerful fulcrum areas, like doorsill, bumper, car roof's hard edges, etc.  
 Advantages: Easy to operate, the drawing work and leveling work can be finished at the same time. Operators can control the power freely, also avoiding harm the metal plate.



Pneumatic Bit Cutter

Item number: NST-8459/12  
 Product Name: Pneumatic Bit Cutter  
 Application: Welding bits.  
 Advantages: It helps to increase the service life of welding bits.



Sliding Puller



Item number: 18B0029/18B0030  
 Product Name: Sliding Puller  
 Application: It is used for all dents that can be pulled out easily by hands.  
 Advantages: Simple easy to use. Automatically welding when touch the steel, which reduce grinding time and painting work.



Mix set bits(Straight Bit/Strong Bit/Screw Bit)



Item number: NST-8459-57-01/02/03  
 Product Name: Mix set bits(Straight Bit/Strong Bit/Screw Bit)  
 Application: Welding metal plate. Suits for Automatic Spot Welding Machine, Strong Puller, Line Puller, Lever Puller and Manual Puller.  
 Advantages: High welding strength and tensile strength, very simple to use, suits for most kinds of maintenance.



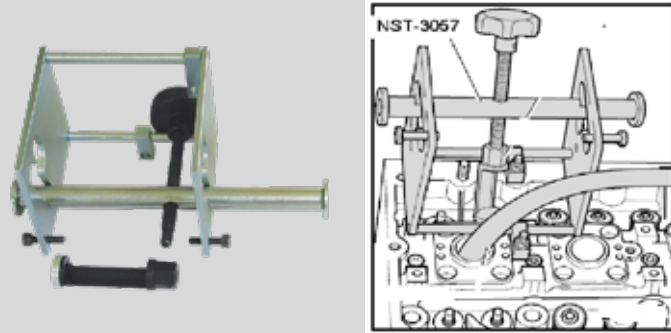

NST-3057 Valve Spring Compressor

Equals to OE Number VW 3362  
Is used to remove the valve spring of Volkswagen, Audi group cars.  
Application: Lupo 1999 ,Fox 2005 ,Polo 1995 ,Polo 2002 ,Caddy 1996 /Polo Classic 1996 ,New Beetle 1999 ,Golf 1998 /Bora 1999 ,Golf 2004 /Jetta 2006,Golf Plus 2005 ,Tiguan 2008,Eos 2006 ,Passat 1997,Passat 2006 ,Sharan 1996 ,Touran 2003 ,Audi A2 2001,Audi A3 2004



NST-3160



Wedge Pry Tool

Equals to OE Number 3409  
Used to remove various trim parts on the vehicle without damaging the part.  
Application: VAG Group VW/Audi/Skoda/SEAT



NST-3148



Valve Seal Puller

Equals to OE Number VW 3364  
Used to remove valve stem seals.  
Application: Lupo 1999 ,Fox 2005 ,Polo 1995 ,Polo 2002 ,Caddy 1996 /Polo Classic 1996 ,New Beetle 1999 ,Golf 1998 /Bora 1999 ,Golf 2004 /Jetta 2006,Golf Plus 2005 ,Eos 2006 ,Passat 1997 ,Passat 2006,Passat CC 2009,Sharan 1996 ,Touran 2003 ,Touareg 2003,Phaeton 2003



NST-3276

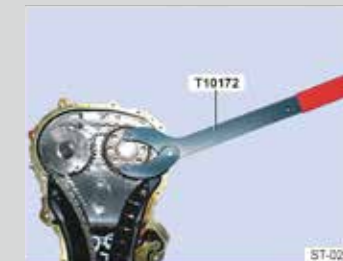

Camshaft Holding Tool

Equals to OE Number T10172  
Use for mounting and dismounting of the camshaft, timing belt replacement, testing and adjustment of camshaft timing, locking the crankshaft.  
Application: VW, Audi  
3-cyl TDI pump pipe nozzle 1.4l 2 valves engine  
3-cyl EFI Engine  
4-cyl EFI Engine, chain drive  
4-cyl EFI Engine (Direct Injection)  
4-cyl Diesel Engine (2.0 l common rail engine)  
4-cyl Diesel Engine with pump pipe nozzle system  
6-cyl Petrol Direct Injection Engine 3.2l (4 valves)

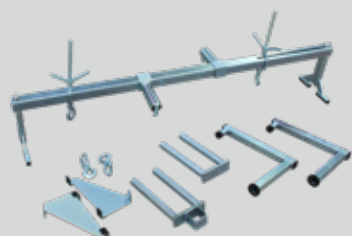

NST-3173R1



Engine Support Bracket

Equals to OE Number 10-222A  
Used for supporting engine.  
Application: Lupo 1999 ,Fox 2005 ,Polo 1995 ,Polo 2002,Caddy 1996 /Polo Classic 1996 ,New Beetle 1999 ,Golf 1992 /Vento 1992,Golf 1998 /Bora 1999,Golf 2004 /Jetta 2006,Golf Plus 2005 ,Tiguan 2008,Eos 2006 ,Passat 1994 ,Passat 1997 ,Passat 2006 ,Passat CC 2009



NST-3355

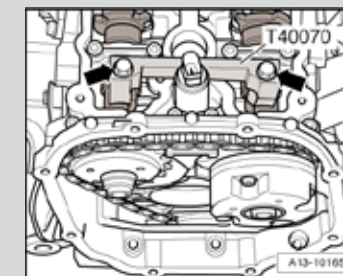

Engine Camshaft Clamp Tool

Equals to OE Number T40070  
Use to lock camshafts when adjusting the left and right camshafts Set of 2.  
For locking camshafts when checking valve timing.  
Application:  
Audi  
A4 (2005-2008), A4 Avant (2005-2008), A4 Cabriolet (2007-2009), A6 (2005-2009), A6 Avant (2006), A8 (2007-2009), A8 L (2007-2009), Q7 (2007-2009), R8 (2008-2009), RS4 (2007-2008), S5 (2008-2009), S6 (2007-2009) and S8 (2007-2009).  
Volkswagen  
Jetta (2005-2012), Jetta SportsWagen (2008-2009), New Beetle (2006-2010), New Beetle Convertible (2006-2010), Rabbit (2006-2009) and Touareg (2007-2009).



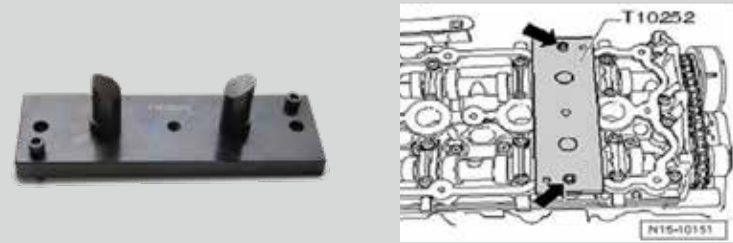

NST-3294 Engine Camshaft Locking Tool

Equals to OE Number T10252  
Used for removing and installing camshafts on 2006-2008 BPY 4-cyl. injection engine (2.0 l), direct injection.  
Application: Golf 2004, Touran 2004, Audi A3 2004, 4-cyl. Injection engine (2, 0 l), direct injection.

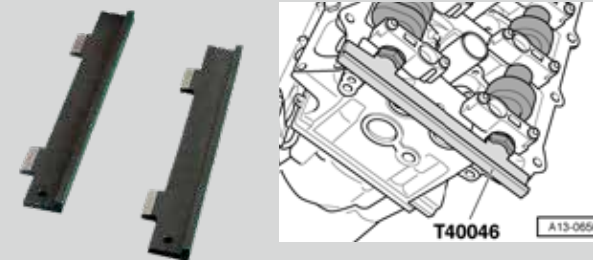

NST-3342 Camshaft Locking Fixtures

Equals to OE Number T40046  
Two camshaft alignment fixture that secure and maintain TDC timing alignment when the cam belt is serviced or removed for other front-engine or cylinder head service tasks.  
Application: 4.2L 40-valve (5 valve per cylinder) V8 engine (engine codes: BAS, BBD, BHF, BNK, BFM, BGK)

Audi B6 S4  
Audi B7 S4  
Audi A6, A6L  
Audi A8, A8L  
Volkswagen Phaeton  
Others ... see engine type above



NST-3426 Valve Cotters Removal and Installation Device

Equals to OE Number VAS5161  
The removal and installation device for valve cotters was designed specifically for the cylinder heads of all VW and Audi engines.  
Advantages:  
- Removal and installation is conducted quickly and simply in a fitted or removed state  
- Repair time is reduced by approx. 3 min compared to previous valve repair  
- Additional aids such as magnets or tongs are no longer required  
- The valve cotters are held firmly in the assembly cartridge  
- By means of a valve insertion device, new valve cotters can also be fitted very quickly  
Application: VW, Audi



NST-3793 Camshaft Timing Tool

Equals to OE Number T10171A  
Engine camshaft timing tool is used to lock the camshaft when checking and adjusting the valve timing.  
Application: Polo 2002, 4-cyl. injection engine (direct injection)



NST-3053 Timing Camshaft Alignment Tool

Equals to OE Number T10068A  
Special designed to hold and align the camshaft.

Engine model: 6-cyl. injection engine (4-valve), 8-cyl. injection engine (W8), 12-cyl. injection engine (W12).

Applicable: Golf 1998-newer, Bora 1999-newer, Passat 1997-newer, Sharan 1996-newer, Touareg 2003-newer, Phaeton 2003-newer, Transporter 1991-newer, Audi A8 1994-newer, Audi TT 1999-newer



NST-3314 Crankshaft Pulley Holding Tool

Equals to OE Number T10355  
Used to hold the pulley still whilst loosening or tightening the pulley fixing bolt. Specially designed for TFSI/TSI 1.8 & 2.0lt petrol engines found in the VAG ranges. Covers engines from 2006 onwards  
Application:  
Audi A3 2,0 P CCZA 2008 2013 TFSI  
Audi A3 Cabrio 1,8 P BZB 2008 2009 TFSI  
Audi A3 Cabrio 1,8 P CDAA 2009 2013 TFSI  
Audi A3 Cabrio 2,0 P CAWB 2008 2009 TFSI  
Audi A3 Cabrio 2,0 P CCZA 2009 2013 TFSI  
Audi A4 1,8 P CABA 2007 2008 TFSI  
Audi A4 1,8 P CABB 2007 2008 TFSI  
Audi A4 1,8 P CDHA 2008 2013 TFSI  
Audi A4 1,8 P CDHB 2008 2012 TFSI  
Audi A4 2,0 P CDNB 2008 2013 TFSI  
Audi A4 2,0 P CDNC 2008 2013 TFSI



NST-3142



Fuel Pump Wrench

Equals to OE Number 3307  
To remove and install the fuel pump. Using the wrench, turn inner section of surge housing approx 15 degree to the left up to the stop and withdraw fuel pump assembly complete with the inner housing section.  
Application:  
Audi:  
A4 (1995-2004 AWD) - B5 & B6 Platform  
A6 (1999-2004) - C5 Platform  
Volkswagen:  
Passat (1998-2005) - B5 & B5.5 Platform

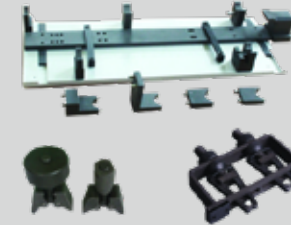

13P0058  
13P0054  
13P0057



Camshaft Timing Tool

Equals to OE Number T40094 T40095 T40096  
To mount the camshafts in the correct position to avoid damage to the camshaft bearing bracket and cylinder head.  
Application:  
Tiguan 2008 >, Jetta 2006 >, Touareg 2003 >, Phaeton 2003 >  
Audi A4 2001 >, Audi A6 2005 >, Audi A8 2003 >  
4-cyl. Diesel engine (2.0 l-engine, Common Rail)  
6-cyl. TDI Common Rail 2.7l and 3.0l 4 valve engine  
8-cyl. TDI Common Rail 4.0l 4 valve engine



NST-3235



Fuel Injector Puller

Equals to OE Number T10055  
Used when removing fuel injectors from cylinder head and other tasks.  
Application: VW/AUDI  
3-cyl Diesel Engine  
3-cyl Diesel Engine (1.4 l engine, TDI)  
4-cyl Diesel Engine (2.0 l common rail engine)  
4-cyl Diesel Engine with unit injector AT 09G  
6-cyl EFI Engine



NST-3320



Transmission Oil Seal Puller

Equals to OE Number T20143  
The tools are used to remove oil seal of crankshaft and camshaft for VW Audi.  
Application: VW, Audi  
5-cyl EFI Engine  
6-cyl EFI Engine  
5-speed manual transmission  
6-speed manual transmission  
6-speed DSG 02E



NST-3571



Thrust Plate

Equals to OE Number VW401  
Assembly aid for gearbox and suspension work.  
Application: Jetta



NST-3259



FSI-TDI Injector Extractor

Equals to OE Number T10133  
For removing and installing high pressure injector.  
Application: Audi, VW CC 2009, Golf, Magotan 2006, 4-cyl EFI Engine (Direct Injection)





NST-3017

Camshaft Alignment Tool Kit

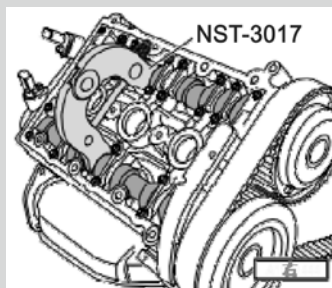

Equals to OE Number T40030  
Holding and alignment fixture.  
Used to align and hold camshaft when  
adjusting the left and right camshaft.  
Application: VW Polo diesel, Audi 100 since  
1991, Audi A6 with engine Z15L TDI.

14G0198



Clutch Adjustment Shim Gauge

Equals to OE Number TPT00273  
Measure the distance between the separation bearing  
gasket and the input shaft clutch spring (the spring sup-  
port provides a pre-tightening, so that the upper and lower  
discs are closed to the spring and pads), measure the  
height twice with a vernier caliper through 4 measuring  
holes, then select the suitable clutch adjusting gasket  
through the calculation formula.  
Application: AS23P EU  
e-HS、AS23P MCE EU  
e-HS MCE



NST-3003

Crankshaft Locking Pin

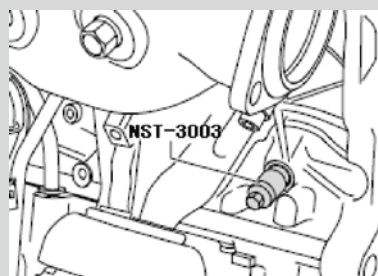

Equals to OE Number 3242  
Used to hold the crankshaft in place during timing  
belt replacement, crankshaft bolt loosening and  
removal, or other service when engine TDC should  
be maintained. Threads into the side of the engine  
block while protruding into the crankshaft in order to  
hold the crankshaft stationary.  
Application: Fits 2.7T V6, 2.8L V6, and 4.2L V8  
engines in the following models: 1996-2001.  
Audi A4, 1995-2001 Audi A6, 2001-2005 Audi  
Allroad, 2000-2002 Audi S4, 2000-2006 Audi A8,  
2001-2003 Audi S8, 2003-2004 Audi S6 and RS6,  
1998-2005 Passat, 2004-2007 VW Touareg,  
2004-2006 VW Phaeton.

14G0196



Locking Bolt Tightening Tool

Equals to OE Number TPT00275  
Set the tool into the rear bearings of the input shaft,  
middle shaft, and output shaft to prevent deviation  
between the entire shafting when tightening the locking  
bolts.  
Application: AS23P EU  
e-HS、AS23P MCE EU  
e-HS MCE

Welcome to contact us for more VW/AUDI Special Tools

14E0045



Battery Module Extraction Tools Kit

Equals to OE Number TEL00070  
Insert the tool into the positioning hole of the battery pack  
module, rotate the upper handle to squeeze the tool  
against the inner wall of the module and increase the  
friction to extract and install the battery pack module.  
Application: AS23P EU  
e-HS、AS23P MCE EU  
e-HS MCE、ZS11E  
EVS

14P0040R1



Camshaft Locking Tool

Equals to OE Number TEN00134  
Adjust the camshaft to the timing position, and use the tools to stuck the six parties of the two camshafts. Both ends of the tool are put on the top surface of the shell to lock the camshaft.  
Application: AS23P EU e-HS、AS23P MCE EU e-HS MCE、AS23 EU、AS23 MCE EU HS MCE、ZS11 MCE SE

14P0138



Fuel Injector Remover/Installer

Equals to OE Number TPT00238  
Installation: Support the adjustable end of the tool at the fuel inlet of the injector, the other end is stuck at the end of the fuel injector, and adjust tool to install the fuel injector.  
Disassembling: Support the adjustable end of the tool at the fuel inlet of the injector, the other end is stuck at the end of the fuel injector, and the adjust tool to remove the fuel injector.  
Application: AS23P EU e-HS、AS23P MCE EU e-HS MCE、AS23 EU、AS23 MCE EU HS MCE

14P0060



Crankshaft Remove Tool

Equals to OE Number TEN00135  
When disassembling the crankshaft bolt, insert the tool into the crankshaft shock absorber, and use a torque to reverse force to disassemble the crankshaft bolt.  
Application: AS23P EU e-HS、AS23P MCE EU e-HS MCE、AS23 EU、AS23 MCE EU HS MCE、ZS11 MCE SE

NST-2028



Rear Wiper Arm Remover

Equals to OE Number TBO00015  
Remove the lock nut on the windshield wiper arm, stuck the tool on the wiper arm, turn the handle to push the wiper bar out.  
Application: AS23P EU e-HS、AS23P MCE EU e-HS MCE、AS23 EU、AS23 MCE EU HS MCE、ZS11E EZS、ZS11E MCE EZS MCE、EP21 Marvel R、EP22 MG5 EV EP22 MY23、ZS11 MCE SE、EH32 MG4 EV X1、EH32 MG4 EV X7 MY23、EH32 MG4 EV X3 4WD

14G0205



Shaft Support Bearing Remove Tool

Equals to OE Number TEN00151  
The connection bolts on both sides of the tool are symmetrically connected in the threaded hole of the axis. The tool passes through the connecting plate, puts it on the bolt, Intermediate spreader passes through the bearing. By observing the gap between the upper bearing and the housing, Adjust the top bolt to open the tool front end opening to the outer ring wall of the bearing, and rotate the lower nut to pull the bearing out.  
Application: AS23P EU e-HS、AS23P MCE EU e-HS MCE

14B0025



Grease Removal Tool

Equals to OE Number TBO00061  
Use this tool to remove grease from the notch of the sunroof, and wipe the scraped grease with oil absorbent paper.  
Application: ZS11E MCE EZS MCE、ZS11 MCE SE



NST-4312



Brake Disc Runout Test Kit

Equals to OE Number TCH00022  
Check whether the flatness of the brake disc surface meets the requirements with the dial indicator.  
Application: AS23P EU  
e-HS、AS23P MCE EU  
e-HS MCE、AS23 EU、AS23 MCE EU  
HS MCE、ZS11E  
EZS、ZS11E MCE  
EZS MCE、EP21  
Marvel R、EP22  
MG5 EV EP22 MY23、ZS11 MCE SE、EH32  
MG4 EV X1、EH32  
MG4 EV X7 MY23、EH32 MG4 EV X3 4WD

NST-4068



Puller

Equals to OE Number T32001  
Assemble the tool according to the figure, stick the two crescent puller in the gap of the parts to be removed, adjust the height, and rotate the middle rod to pull out the parts.  
Application: AS23 EU、AS23 MCE EU HS MCE、ZS11 MCE SE

14G0056



Dual Clutch Remover/Installer

Equals to OE Number TPT00199  
Disassemble: Select the applicable outer bolt to fix the stuck claws on the clutch housing, connect the intermediate bolt with the clutch, and rotate the intermediate bolt to pull the clutch out,the clutch disassembly is completed.  
Installation: Place the clutch in the housing, select the applicable bolt to fix the stuck claws on the housing, select the applicable middle sleeve and press it on the clutch, rotate the center bolt to press the clutch, adjust the middle bolt of each claws, press the clutch, adjust the clutch, and complete the clutch installation.  
Application: AS23P EU  
e-HS、AS23P MCE EU  
e-HS MCE、AS23 EU、AS23 MCE EU  
HS MCE

14P0213



Valve Spring Compressor

Equals to OE Number T10005  
Place the separated cylinder head on a platform. Use one end of the tool to press against the upper valve spring seat and the other end against the valve seat. Rotate the tool to compress the valve spring, remove the valve retainer, and complete the disassembly of the valve.  
Application: ZS11 MCE SE

NST-4315



Rear Brake Caliper Piston Reset Tool

Equals to OE Number TCH00015  
Put the tool through the brake shoes of the rear brake caliper, the front end is on the piston,put the plate on the tool and on the inside of the brake shoes, and rotate screw to reset the piston.  
Application: EP22 MG5 EV  
EP22 MY23、ZS11 MCE SE

NST-4228



Camshaft Timing Tool

Equals to OE Number TEN00004  
Adjust the camshaft to the top dead center position, align the tool with the camshaft, insert the pin through the two holes in the middle of the tool into the camshaft, and then secure the tool to the housing with a bolt.  
Application: ZS11 MCE SE

NST-4234



Crankshaft Belt Wheel Retainer

Equals to OE Number TEN00008  
Insert the tool into the hole on the pulley, use a ratchet socket to cover the bolt in the middle of the pulley, and achieve the disassembly and assembly of the sprocket through reverse force.  
Application: ZS11 MCE SE

NST-4534



Transmission Select Shift Shaft Sleeve Supporter

Equals to OE Number TPT00136  
Place the tool on the press machine, position the selector shaft and sleeve in the tool's limiting position, align with the mounting hole, place the pin in the hole, fix the matching pressure head on the cylinder, and press the pin into place.  
Application: AS23 EU、AS23 MCE EU HS MCE

14E0090



Lift Auxiliary Kit

Equals to OE Number TEL00097  
Remove the lifting pad from the car lift and install the appropriate size of auxiliary kit on the car lift. Align it with the vehicle's chassis, then start the car lift to raise the vehicle.  
Application: EH32 MG4 EV  
X1、EH32 MG4 EV  
X7 MY23、EH32  
MG4 EV X3 4WD

14G0032



Transmission Gearset Assembly Fixture

Equals to OE Number TPT00165  
Install each gear shaft and selector shaft in the tool according to their positions, and then, with the tool, install them in their corresponding positions on the housing.  
Application: AS23 EU、AS23 MCE EU HS MCE

NST-4525



Transmission Locking Bolt Tightening Tool

Equals to OE Number TPT00126  
Place the tool on the rear bearing of the input shaft, intermediate shaft, and output shaft respectively to prevent the entire shaft system from shifting when tightening the screws.  
Application: AS23 EU、AS23 MCE EU HS MCE

Welcome to contact us for more SAIC Special Tools





36P0048



Silicon Oil Fan Installation  
Wheel Locking Tool

Equals to OE Number ZEF068992  
It is used to lock silicon oil fan installation wheel.  
Application: Great Wall

36P0060

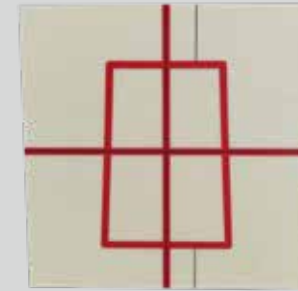

Parking Camera Calibration Board

Equals to OE Number ZEF069077  
It is used to calibrate parking cameras. Park the car in the test location, mark the axial center of the vehicle, place the calibration board in the specified location according to the use requirements, and then use a professional detector to calibrate.  
Application: Great Wall

36G0024



Input Shaft Rear Cap Installation Tool

Equals to OE Number ZEF068655  
It is used to install input shaft rear plug cover.  
Application: Great Wall 7DCT450

36P0030



Urea Pump Disassembly Tool

Equals to OE Number ZEF068733  
It is used to remove and install urea pump chuck.  
Application: Great Wall Haval H9/ Wingle 7/ high-end pickup

36E0021

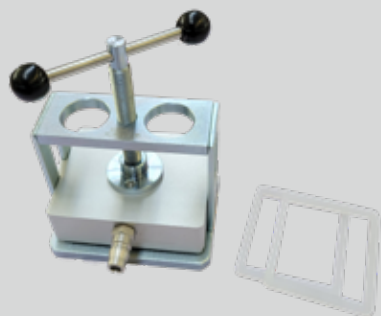

Battery Pack Airtightness Testing Tool

Equals to OE Number ZEF068736  
It is used together with other plugs to test Airtightness.  
Application: Great Wall

36P0033



Crankshaft Half Ring Plate Press Tool

Equals to OE Number ZEF068732  
It is used to press the half ring plate on the crankshaft.  
Application: Great Wall Haval, WEY

36P0031



Spring Compression Tool

Equals to OE Number ZEZF068731  
It is used to compress torsion spring.  
Application: Great Wall Haval, WEY

36P0062



Crankshaft Rear Oil Seal  
Installation Tool - 4B15H

Equals to OE Number ZEZF069094  
It is used to install crankshaft rear oil seal.  
Application: Great Wall

36P0018



Fuel Pump Belt Pulley Fixing Tool

Equals to OE Number ZEZF068657  
It is used to fix fuel pump pulley and remove pulley bolts.  
Application: Great Wall GW4D20T

36P0061



Crankshaft Front Oil Seal Installation Tool - 4B15H

Equals to OE Number ZEZF069093  
It is used to install crankshaft front oil seal.  
Application: Great Wall

Welcome to contact us for more Great Wall Special Tools

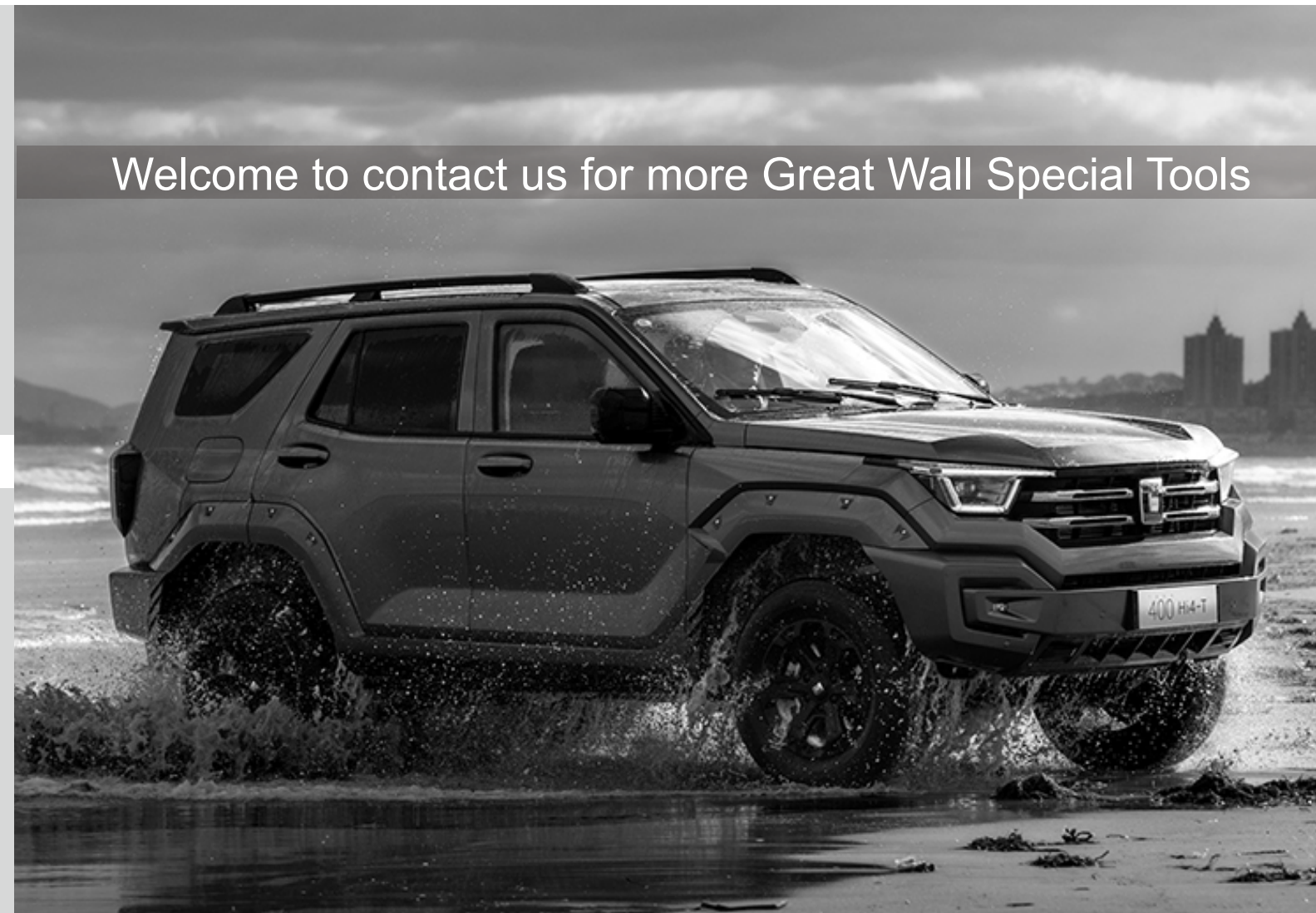





**21P0050**

Equals to OE Number ZJP-GJ1000032  
It is used to fix the engine flywheel, remove and install the screw of the crankshaft pulley.  
Application: Chery

Flywheel Locking Tool



**NST-8101**

Equals to OE Number ZJP-GJ1000044  
It is used to remove engine gearbox oil pan.  
Application: Chery

Oil Pan Remove Tool



**21P0051**

Equals to OE Number ZJP-GJ1000033  
It is used to fix the camshaft when installing the timing belt.  
Application: Chery E4T15B/SQR484 /E4G15B/E4G16

Camshaft Timing Tool



**21P0062**

Equals to OE Number ZJP-GJ1000045  
It is used to fix crankshaft when installing the timing belt.  
Application: Chery E4T15B/E4G15B/E4G16

VVT Crankshaft Timing Bolt



**21P0058**

Equals to OE Number ZJP-GJ1000041  
It is used to fix the crankshaft pulley and remove the crankshaft screws.  
Application: Chery SQR484

Crankshaft Pulley Tensioning Tool



**21P0064**

Equals to OE Number ZJP-GJ1000048  
It is used to remove the steering wheel.  
Application: Chery

Steering Wheel Disassembly Tool



**91C0100**

Equals to OE Number ZJP-GJ1000051  
It is used to remove bearing or oil seal.  
Application: Chery

Differential Bearing Puller



**51C0068**

Equals to OE Number ZJP-GJ1000040  
It is used for valve spring disassembly and installation.  
Application: Chery

Valve Spring Removal Tool



**NST-A003**

Equals to OE Number ZJP-GJ1000052  
It is used to remove output shaft bearing outer ring.  
Application: Chery

Output Shaft Bearing Puller



**21P0053**

Equals to OE Number ZJP-GJ1000036  
It is used to remove valve oil seal.  
Application: Chery

Valve Stem Seal Plier



**NST-A004**

Equals to OE Number ZJP-GJ1000053  
It is used to fix input shaft, remove the nut.  
Application: Chery 525MH/515

Input Shaft Locking Tool

Welcome to contact us for more Chery Special Tools







Subframe Disassembly and  
Positioning Bottom Plate

**45R0001**

Equals to OE Number CHS-0014

Used to support and position the subframe when disassembling and assembling the subframe of specific models ES6.ES8.

Application: NIO ES6.ES8

Welcome to contact us for more NIO Special Tools



Input Shaft Oil Seal  
Installation Tool

**45G0002**

Equals to OE Number EDS-0010

It is used to install the input shaft oil seal from motor to GB.

Application: NIO ES6.ES8



Crankshaft Rear Oil Seal  
Installation Tool

**27P0032**

Equals to OE Number JAC-T6F017

It is used to install the crankshaft rear oil seal, put the oil seal on the crankshaft, gently tap with a tool, and install it.

Application: JAC

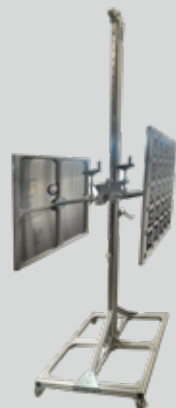

ADS-0001 Drive Assist System  
Camera Calibration Tool

**45B0035R2**

Equals to OE Number ADS-0001E

It is used to calibrate Drive Assist System Camera.

Application: NIO ES8/ES6/EC6



Crankshaft Pulley Wrench

**27P0035**

Equals to OE Number JAC-T6F021

It is used to fix crankshaft pulley, remove crankshaft bolts.

Application: JAC



**27G0092**

Equals to OE Number JAC-T5B111

It is used to install clutch seal cover.  
Application: JAC

Clutch Seal Cap Pressing Tool



**27P0005**

Equals to OE Number JAC-T5F043

It is used to fix the flywheel.  
Application: JAC

Flywheel Locking Tool



**27P0044**

Equals to OE Number JAC-T5F101

It is used to lock camshaft.  
Application: JAC

Camshaft Locking Tool

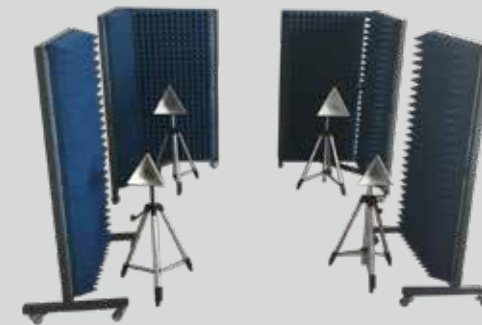

**27B0002**

Equals to OE Number JAC-T0057  
This equipment is used for calibrating the JAC Motors BSD Blind Spot Monitoring System. The purpose of calibration is to determine the relative installation error between the radar and the car body, and to compensate for this installation error through software.  
Application: JAC

BSD Calibration Tool



**27P0045**

Equals to OE Number JAC-T5F102

It is used to lock the lower belt when repair engine.  
Application: JAC

Timing Belt Tool

Welcome to contact us for more JAC Special Tools





15P0105

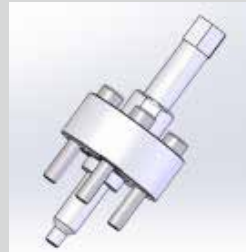

Equals to OE Number 4114870387  
It is used to remove the timing pulley. Wring the screw on the axis, connect the tool with the belt wheel, and move the middle screw to remove the belt wheel.  
Application: Geely

Timing Belt Pulley Disassembly Tool

41P0099

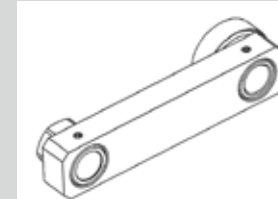

Equals to OE Number 4114720191  
It is used to fasten VVT bolt. Install this tool on phaser and remove bolt.  
Application: Geely LYNK&CO 02

VVT Bolt Tightening Tool

41P0100

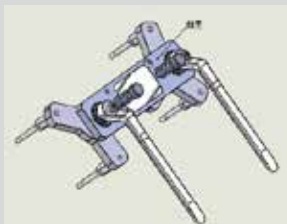

Equals to OE Number 4114720189  
It is used for timing adjustment. Install this tool on the phaser and adjust the timing. VVT Timing Positioning Tool.  
Application: Geely LYNK&CO 02

Timing Adjustment Tool

41P0021

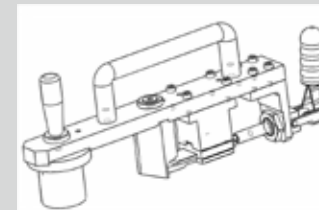

Equals to OE Number 4114720195  
It is used for oil pump installation. Use this tool to adjust the installation position when installing the oil pump.  
Application: Geely LYNK&CO 02

Oil Pump Installation Tool

41P0035

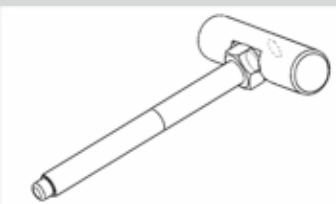

Equals to OE Number 4114720190  
It is used to fix crankshaft timing point of the belt pulley. Insert the tool through the pulley into the housing to complete the timely fixing of the pulley.  
Application: Geely LYNK&CO 02

Crankshaft Fixing Tool

41P0003

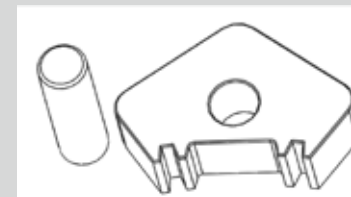

Equals to OE Number 4114720207  
It is used to fix flywheel.  
Application: Geely LYNK&CO 02

Flywheel Fixing Tool

41P0037

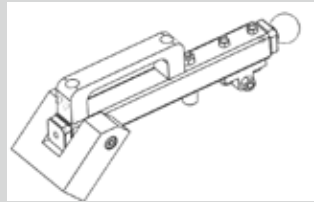

Equals to OE Number 4114720212  
It is used to adjust water pump belt .  
Application: Geely LYNK&CO 02

Water Pump Belt Adjustment Tool

15P0103

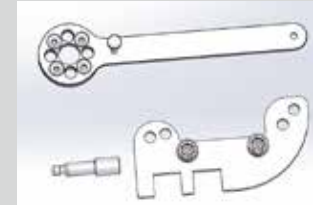

Equals to OE Number 4114870385  
It is used for crankshaft positioning.  
Application: Geely

Crankshaft Positioning Tool

15P0045

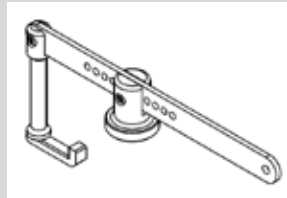

Equals to OE Number 4114870317  
When installing the high -pressure oil pump, because the oil pump has a spring, the oil pump is not easy to fit into the installation surface. It is necessary to use the tool to tighten the flange and install the bolt.  
Application: Geely

High Pressure Fuel Pump Clamping Tool

15P0092

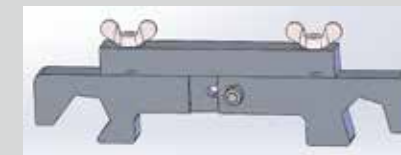

Equals to OE Number 4114870596  
It is used to fix camshaft.  
Application: Geely

Camshaft Fixing Tool

15P0114

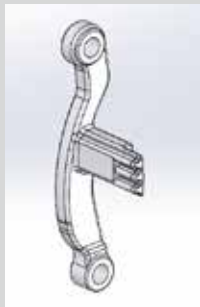

Equals to OE Number 4114870396  
It is used to fix the flywheel. Clamp the tooth on the flywheel, fix the tool to the housing with bolts.  
Application: Geely

Flywheel Fixing Tool (1.5T)

Welcome to contact us for more Geely Special Tools







## 18R0046 Brake Oil Change Machine

NST Electric Auto Brake Fluid Exchange Machine is compact, convenient and easy to operate. It has an intelligent electric design. It can easily discharge air bubbles and impurities in the pipeline with one button. It can complete the oil replacement by one person.

The brake fluid is sucked from the new fluid storage tank by the pump and pumped into the automobile brake fluid container with the specified pressure reserve. The old brake fluid is drained from the wheel brake cylinders until the new brake fluid flows out.



Benz, BMW, AUDI, Volkswagen, SKODA, Volvo, Land Rover, Jaguar, Porsche, Buick, Chevrolet, Ford, Citroen, Peugeot, Chery, Changan, Mazda, Haima, BYD, Roewe, Renault, Geely, Zhonghua, Great Wall, MG, BESTURN, LEXUS, GAC, QOROS, etc.

JAC, Hyundai, Subaru, Renault, KIA series, ROEWE 550, Mitsubishi, Infiniti, BAIC new energy.

BUICK BPV



FORD FOX, EDGE, part of AUDI, part of Peugeot

HONDA, BYD series

TOYOTA, KING LONG series



Soueast DX5, DX7



BUICK, FORD Fiesta, FAW Mazda, Cadillac, FAW Besturn series

DODGE, Chrysler, JEEP series

Ford series



JAC series, Teana, Qashqai, X-trail (Nissan 2.0 and above)



Nissan series

Wuling Bao Chun series (Hongguang S3, Bao Chun 560, 510, 730, 530)

Changan Suzuki



Mitsubishi, Soueast, Lingyue



### 30C0002-03-00 Moveable Scissor Car Lift

Car Lift is a professional and essential equipment for car repair, Some car repair shops are not big enough, Not suitable for installing two-column car lift and four column car lift, NST Moveable Scissor Car Lift can solve this problem very well, (Two Column Car Lift , Four Column Car Lift)

Simple operation and easy to learn

1. Turn on the switch (Rotate to the right), confirm the power of the lithium battery of the car lift is higher than 30%. Use the Towing Handle to drag the car lift to under the vehicle chassis.
2. Expand the four supporting arm of the car lift, install the suitable rubber pad according to the different models, the lifting arms support the four main points of the vehicle chassis.
3. Loose the butterfly bolts near the four wheels and pull out the auxiliary wheels.
4. Remove the locking pin from the car lift (The Towing Handle should be removed when remove the locking pin) and put it into the locking pin hole, connect the Control Unit.
5. Press the Lift Button on the Control Unit, raise the vehicle (Rated lifting weight 2200kg) to the maximum height,the car lift stop automatically. Press the Down Button to lock the lift.
6. According to the safety identification location of the car lift, the vehicle can be repaired after the safety support is placed.
7. After the maintenance, take away the safety support, press the lift button on the control unit, when the mechanical lock can be opened,press the unlock button and down button at the same time to release the car lift to the ground.
8. Install the locking pin, put the auxiliary wheel back, remove the control unit, drag out the car lift, and turn off the switch (Rotate to the left).



### 18R9138R11

### Multifunctional Maintenance Trolley



1. This product is a special equipment for rapid maintenance of automobile brake system. It can independently complete the maintenance and disassembly work of the vehicle brake system.
2. Air source pressure 0.6-0.8MPa, working pressure 0.6 MPa, movement speed 3 ~ 5 meters/minute (adjustable).
3. The maximum load 120Kg.
4. Adopt unique air circuit design, manual control, and equipped with exhaust valve, can make the tire frame fall to the bottom point without air.
5. Lifting mechanism adopts imported linear bearings, with high precision and high strength. Both sides are equipped with spiral tube and tool barrel, users can use pneumatic tools according to their request.
6. The air cylinder adopts exhaust type one-way throttle valve speed control to maintain back pressure, stable operation, good anti-interference performance, easy speed regulation, and the lifting speed does not interfere with each other.
7. The main body adopts stainless steel frame; the bottom of the tool box is covered with non-slip rubber pad, which is beautiful and simple, and the structure is simple and convenient for accessing tools and spare parts.
8. Adopt four-wheel walking mechanism, two rear wheels with brake device. Flexible, light-weight, accurate and firm.





The EV Road-Side Service vehicle is equipped with a mobile 2.5-ton hydraulic scissor car lift, battery disassembly lift, spare chassis-mounted battery pack, rescue electric vehicle charging system, disassembly tools, essential rescue tools, and a series of other configurations. In the event of accidents such as sudden power failure, breakdown, prolonged disuse leading to low battery charge unable to start, or battery pack damage due to external forces, this rescue vehicle can be promptly utilized for on-site emergency rescue and temporary recharging functions. All lifting equipment is waterproofed, with quick and convenient connections. The vehicle-mounted lifting device starts with one button, making operation simple.



NST has comprehensive processing capabilities, strong technical and equipment strength, with over 180 various types of machining equipment, including nearly 80 CNC machining devices. We possess systematic processing capabilities for long shafts, deep holes, planes, and spatial surfaces. Currently, we have 93 production personnel, and the operational area of the factory exceeds 40,000 square meters, ensuring the fulfillment of order production requirements.



NST has a quality inspection team of 5 members, equipped with a basic set of measuring and testing equipment. Coupled with integrated control and management of the supply chain and collaborators, NST ensures effective control over the product formation process. The company is currently revising the quality control standards for non-standard products. While meeting customer needs, the goal is to gradually elevate each individual product to the highest industry standards.