

THE WILD LIGHTING EXPERT



Brighter LED Lighting Co., Ltd.

+86 757 85221719
www.brtled-light.com
No. 10, Keji East Road, Songxia Industrial Zone, Songgang, Nanhai
Foshan, Guangdong

Product Guide 2024



ABOUT BRTLED

Company Profile

BRTLED was established in 2013 and has more than 150 employees, covers 8,000 square meters.

BRTLED is an innovative national high-tech enterprise integrating research, design, production and sales of automotive and industrial LED lighting solutions widely applied for off-road, Forestry, Mining, Agriculture, Heavy Duty Machinery, UTV, ATV, Marine etc.

Besides the ISO/IATF16949 quality control system, BRTLED had obtained 200+ certificates and worldwide patents, e.g. DOT, AMECA, E-Mark (ECE R148/R149 R65), CE, IP68, IP69K, ROHS, Vibration Tests, CISPR25-Class5, domestic and international Patents for Design and technology etc.

BRTLED is committed to meeting the demands of clients globally and to striving for the establishment of first class enterprise of "high efficiency, energy-saving, environmental protection and harmony".





LED ANTI-ICING LIGHT

Working in the cold and freezing winter is no longer a problem! BRTLED applies the PATENT heating technology on those innovative LED Head Lamps and Work Lamps, fast and stable snow melting and anti-icing performance ensures the clean and safe driving and working condition for the vehicles and drivers.

Compared with traditional heating technology, we provide an invisible automatic design with more favorable light and beam output, appearance, the better waterproof and dustproof standard for customers. DOT/ECE certified means they are legal on road.

LED Anti-icing Head Light



Part No.: BLHL0415S2

Raw Lumen: High beam 3600LM/ Low beam 1800LM
 Beam Pattern: High beam / Low beam / Indicator / Position light
 Power: High beam 48W/ Low beam 24W / Indicator 12W / Position light 3W
 Approval: DOT/CE/RoHS/ECE R112(Ref. No.:17.5)/R7/R6/R10
 Distance (High beam/Low beam): 1 Lux @280M / 163M
 Dimensions: 215*150*85mm

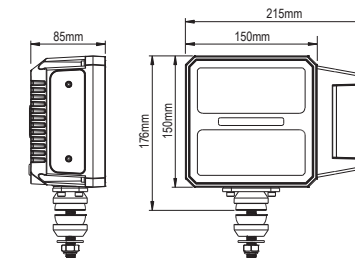

LED Anti-icing Head Light



Part No.: BLHL0408S

Raw Lumen: High beam 3600LM/ Low beam 1800LM
 Beam Pattern: High beam / Low beam / Indicator / Position light
 Power: High beam 38W/ Low beam 20W / Indicator 18W / Position light 1.5W
 Approval: DOT/CE/RoHS/ECE R112(Ref. No.:12.5)/R7/R6/R10
 Distance (High beam/Low beam): 1 Lux @260M / 131M
 Dimensions: 340*107*85mm

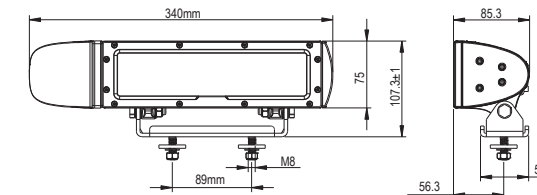

7"/9" Round LED Driving Light

Raw Lumen: 7200LM- 13000LM
Dual position light: White & Amber
Beam Pattern: Combo beam/Spot beam
Approval: R148/R149/ R10/RoHS/CE



Part No.	Size	Power	Raw Lumen	Beam pattern	1 Lux @ M	ECE R149 Ref.No.
BLD1205R-B	7" Φ180*65mm	72W	7200 LM	Combo	430/380M	30
BLD1210R-B	9" Φ218*70mm	120W	13000LM	Combo 25°	659/407M	37.5
				Spot 8°	805/493M	50

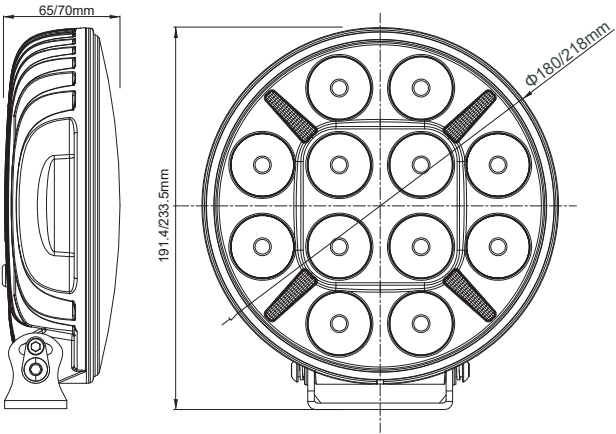

LED DRIVING LIGHT

BRTLED driving lights produce an ECE R112 conformed driving beam for the vehicles, with the innovative Side-reflecting optic lens and TIR optic lens, our lights provide a more penetrating light down to the road which decreases the glare to the coming vehicles and much brighter and clearer than the same watt lights in the market.

Hardened PC cover in the front, provides the IP68 waterproof & dustproof standard, extra anti-corrosion, and anti-scratch function.

Park light is ingeniously added on the light, making the lights not only legal, safer but also cooler!

7"/9" Round LED Driving Light

Raw Lumen: 6000LM- 12000LM
Dual position light: White & Amber
Beam Pattern: Driving beam(30°)
Approval: R148/R149/ R10/RoHS/CE



Part No.	Size	Power	Raw Lumen	1 Lux @ M	ECE R149 Ref.No.
BLD0808R	7" (Φ180*190*67.5mm)	60W	6000 LM	406M	37.5
BLD0815R	9" (Φ218*232*84mm)	120W	12000LM	469M	45

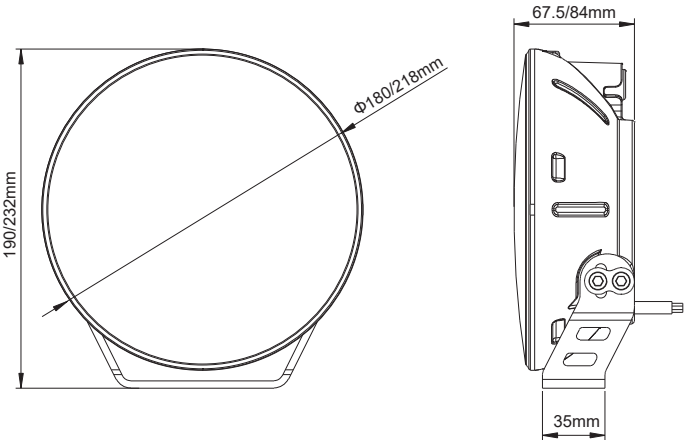

9" Round LED Driving Light

Raw Lumen: 14500 LM
Dual position light: White & Amber
Beam Pattern: Driving Beam(25°)

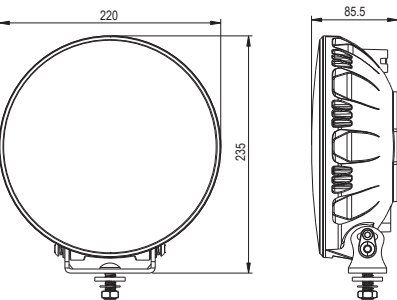

Distance (Off-road/ECE): 1 Lux @732M / 463M
Dimensions: 220*235*85.5mm
Approval: R112(Ref. No.:50)/R7/R10/RoHS/CE

Part No.: BLD1215R

9" Round LED Driving Light

Raw Lumen: 16500 LM
Dual position light: White & Amber
Beam Pattern: Driving Beam(12°)

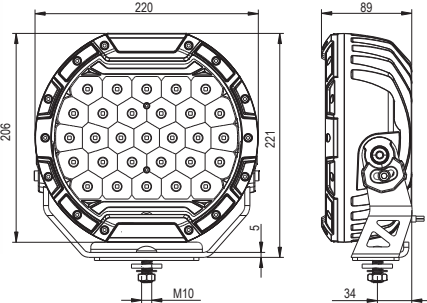

Distance: 1 Lux @1000M
Dimensions: 220*221*89mm
Approval: R112/R7/R10/RoHS/CE/REF. 50

Part No.: BLD2906R

10" Jumbo LED Driving Light



Part No.: BLD1212S-WL

Raw Lumen: 11000 LM
Dual position light: White & Amber
Beam Pattern: Driving Beam

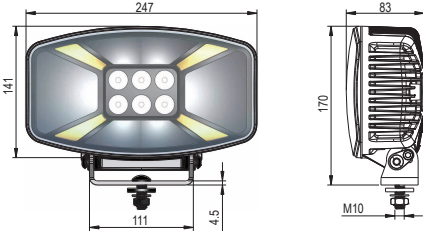

Distance (Off-road): 1 Lux @600M
Dimensions: 247*141*83mm
Approval: R112/R7/R10/R65/RoHS/CE

4.3" Diamond LED Driving Light



Part No.: BLD0710S

Raw Lumen: 6500 LM
Distance: 1 Lux @ 509M
Beam Pattern: Driving Beam(30°)

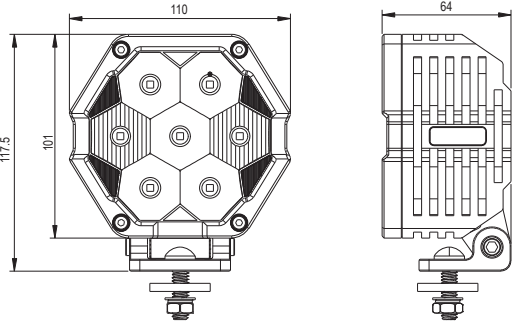

Dimensions: 110*64*117.5mm
Approval: R10/RoHS/CE

7" LED Head Light



Part No.: BLHL7R-2

Raw Lumen: High beam 3900LM/ Low beam 1800LM
Distance (High beam/Low beam): 1 Lux @256M / 187M
Approval: DOT/SAE/CE/ RoHS/ECE R112(Ref. No.:20)/R7
Dimensions: 176*69.5*115.2mm
Power: High beam 54W/ Low beam 24W
Beam Pattern: High beam / Low beam

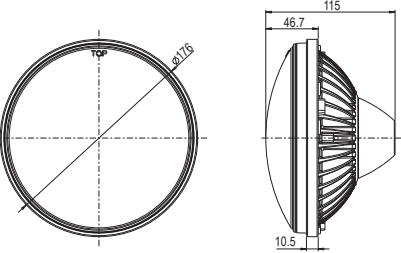

5 x 7 " LED Head Light



Part No.: BLHL7S

Raw Lumen: High beam 3900LM/ Low beam 1800LM
Distance (High beam/Low beam): 1 Lux @256M / 187M
Approval: DOT/SAE/CE/RoHS/ECE R112/R7(Ref. No.:12.5)
Beam Pattern: High beam / Low beam
Power: High beam 38W/ Low beam 24W
Dimensions: 198.5*142*116.2mm

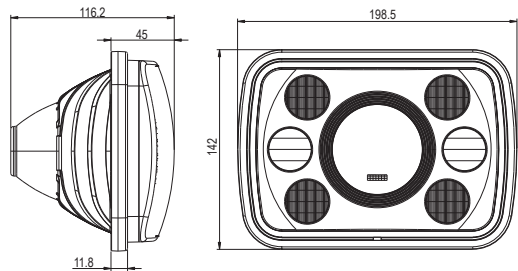



LED WORK LIGHT

Work lamps are widely applied to every working place of the mining, agriculture, forklift, heavy duty machinery, construction, forest, marine industries etc.

BRTLED work lamps are developed to illuminate the working area as large as possible with uniform light. From 40 degrees to 140 degrees working angle, you can always find the best solution.

CISPR25 CLASS 3/4/5 circuit board design, the highest anti radio interference level, you can install the lights as many as you want and no need to worry about the interference.

All Black High Power LED Work Light

Raw Lumen: 6400LM-12800 LM
Beam Pattern: Diffused Beam(80°)
Approval: R10/RoHS/CE/CISPR 25



Part No.	Size	Power	Raw Lumen	1 Lux @ M	CISPR25
BLW0418S	4.5" (115*95*60mm)	72W	6400 LM	79M	Class 5
BLW0618S	5.2" (133*110*60mm)	108W	9600 LM	101M	Class 5
BLW0818S	5.9" (150*128*60mm)	144W	12800 LM	135M	Class 3

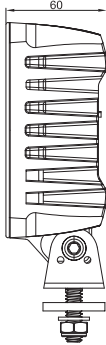
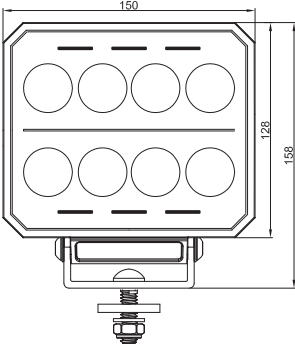
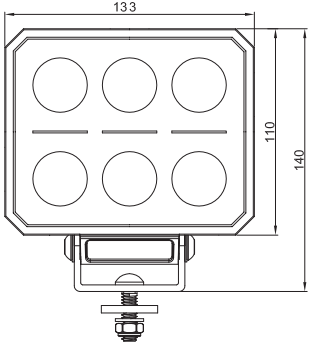
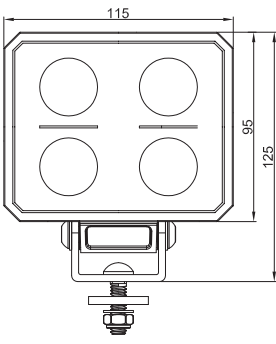

5.4" LED Curved Work Light



Part No.: BLW0610S

Raw Lumen: 5600 LM
Distance: 1 Lux@88M
Beam Pattern: Diffused Beam(120°)

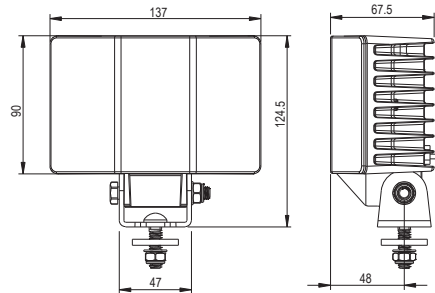

Dimensions: 137*90*67.5mm
Approval: R10/RoHS/CE/CISPR 25-CLASS5

5.4" LED Curved Work Light



Part No.: BLW0312S

Raw Lumen: 3200LM
Distance: 1 Lux@54 M
Beam Pattern: Diffused Beam(120°60°)

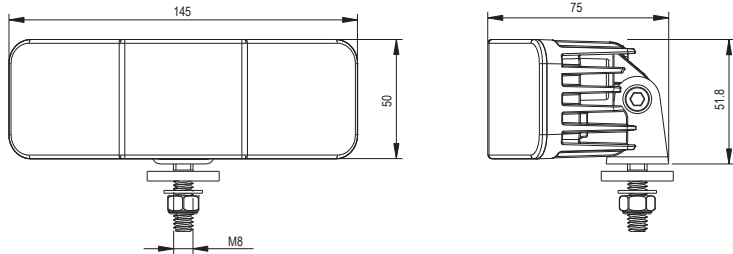

Dimensions: 145*50*75mm
Approval: R10/RoHS/CE/CISPR 25 CLASS3

5.7" LED Curved Work Light



Part No.: BLW0910S

Raw Lumen: 9500 LM
Distance(Diffused/Combo): 1 Lux@93M /229M
Beam Pattern: Diffused and Combo Beam(120°)

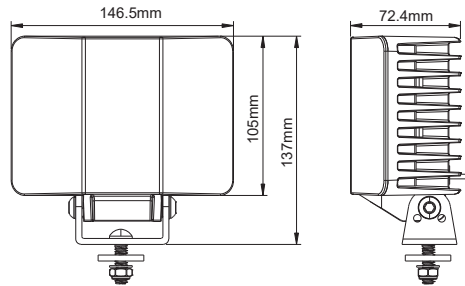

Dimensions: 146.5*105*72.4mm
Approval: R10/RoHS/CE/CISPR 25-CLASS3

5.1" LED Curved Work Light



Part No.: BLW0610S2

Raw Lumen: 6000LM
Distance: 1 Lux@76 M
Beam Pattern: Diffused Beam(130°50°)

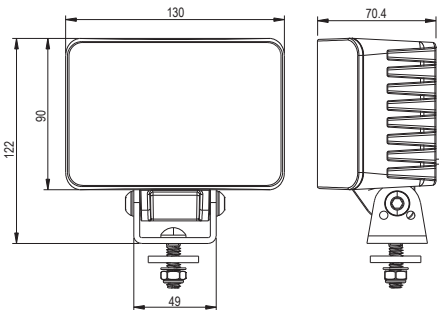

Dimensions: 130*90*70.4mm
Approval: IP69K/CE/R10/CISPR 25 CLASS5/RoHS

3" Round LED Work Light



Part No.: BLW0410R

Raw Lumen: 3800 LM
Distance: 1 Lux@74M
Beam Pattern: Flood Beam(60°)

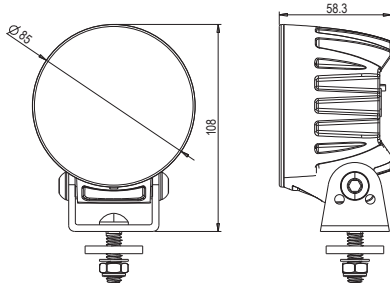

Dimensions: 85*108*58.3mm
Approval: R10/RoHS/CE/CISPR 25-CLASS3

3" Square LED Work Light



Part No.: BLW0405S

Raw Lumen: 3800 LM
Distance(Flood/Spot): 1 Lux@67M /273M
Beam Pattern: Flood Beam(60°),Spot Beam (10°)

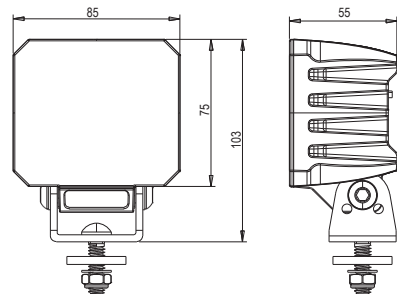

Dimensions: 85*103*55mm
Approval: R10/RoHS/CE/CISPR 25-CLASS3

5.9" Non-glare LED Work Light



Part No.: BLW1005S

Raw Lumen: 5600LM
Distance: 1 Lux@144 M
Beam Pattern: Diffused Beam(100°X40°)

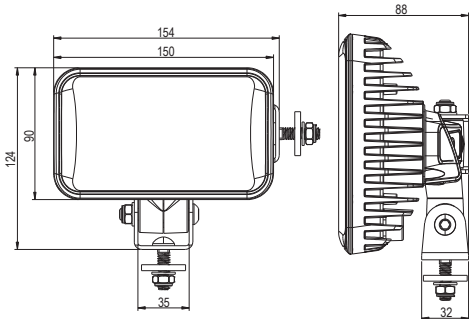

Dimensions: 150*90*88mm
Approval: R10/RoHS/CE

5.9" Tractor LED Work Light



Part No.: BLW3201S

Raw Lumen: 4500LM
Distance: 1 Lux@83 M
Beam Pattern: Flood Beam(60°)

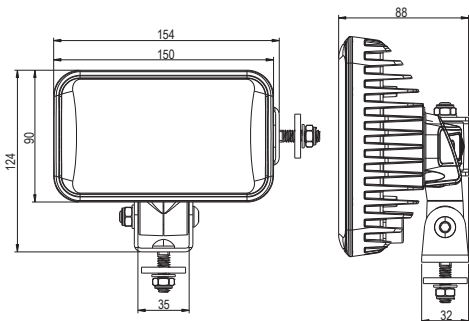

Dimensions: 150*90*88mm
Approval: R10/RoHS/CE/CISPR 25-CLASS5

Oval tractor work Light



Part No.: BLW0606R-H

Raw Lumen: 5800LM
Distance(Flood/Spot): 1 Lux@117M/442M
Beam Pattern: Flood Beam(60°) & Spot beam(10°)

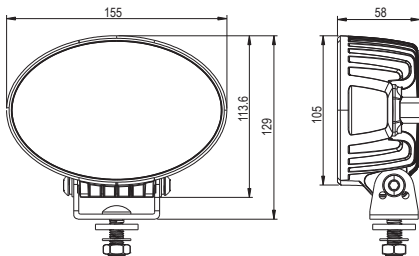

Approval: ECE R10/CE/CISPR25 CLASS3/RoHS
Dimensions:155*105*58mm

LED Work light with Warning Function



Part No.: BLW0220S

Raw Lumen: 3600 LM
Distance(Flood/Spot): 1 Lux@70M/247M
Beam Pattern: Flood beam(55°) & Spot beam(25°)

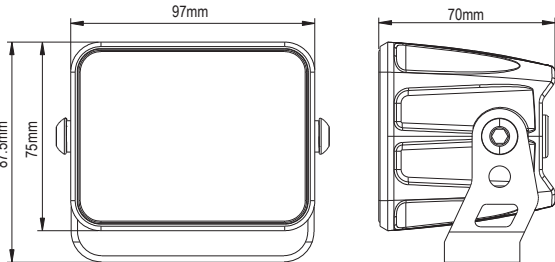

Dimensions: 97*75*70mm
Approval: ECE R65/RoHS/R10/SAE-J581/J595/CE

Oval tractor work Light with warning function



Part No.: BLW0606R-WL

Raw Lumen: 2500LM
Distance(Flood/Spot): 1 Lux@85M/369M
Beam Pattern: Flood Beam(60°) & Spot beam(8°)

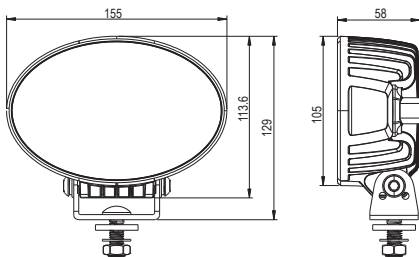

Approval: ECE R65/R10/CE/CISPR25 CLASS3/RoHS
Dimensions: 155*105*58mm

Multi-Kelvin Work Light



Part No.: BLW0420S2

Raw Lumen: 3900LM
Distance: 1 Lux@68M
Beam Pattern: Flood Beam(60°)

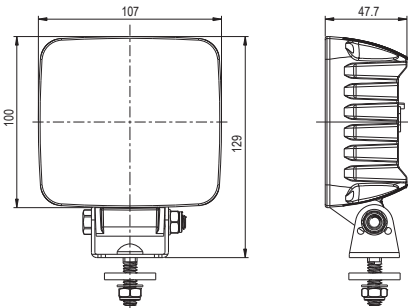

Color Temperature: 3000K/4500K/6000K
Approval: R10/RoHS/CE/CISPR 25 CLASS3
Dimensions: 107*129*47.7mm

Ultra slim single row light bar series



Function: Dual position light(White & Amber) Beam Pattern: Driving Beam(30-45°)
Raw Lumen: 4900LM-19400 LM Approval: R10/RoHS/CE/ECE R148/ECE R149



Part No.	Size	Power	Raw Lumen	1 Lux @ M	ECE R149 Ref. No.
BL0906S10-P	10" (291*33*59mm)	54W	4900 LM	420/289 M	20
BL1806S10-P	20" (534*33*59mm)	108W	9600 LM	594/463 M	50
BL2706S10-P	30" (777*33*59mm)	162W	14600 LM	701/468 M	50
BL3606S10-P	40" (1020*33*59mm)	216W	19400 LM	762/468 M	50

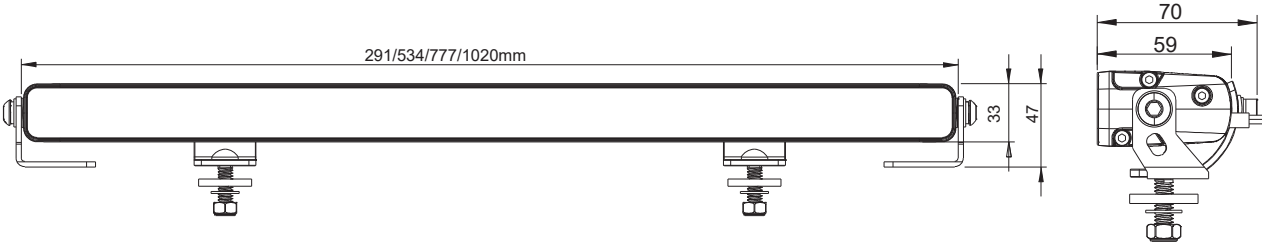

LED LIGHT BAR

People adore the LED light bar due to its various fancy designs. As an auxiliary light for the driving beam, BRTLED not only focuses on innovative outlook design but also puts significant effort into high-quality finishing and performance.

High-intensity brand LEDs are used in these series, and the light transmittance is more than 95%. With the toughest high-quality materials, our light bars are approved for use in the roughest environments, including 4x4 off-road, construction, heavy-duty machinery, etc., as driving and working auxiliary lights.

Slim Light Bar Series

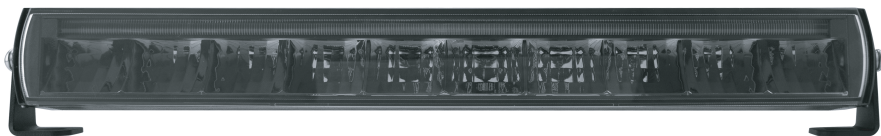

Function: Dual position light(White &Amber)
Raw Lumen: 8500LM- 14000LM

Beam Pattern: Driving beam (35°)
Approval: R148/R149/ R10/RoHS/CE



Part No.	Size	Power	Raw Lumen	1 Lux @ M	ECE R149 Ref.No.
BL0615S4	13" (324*58*81mm)	90W	8500 LM	435M	30
BL1015S4	20" (516*58*81mm)	150W	14000LM	588/470M	50

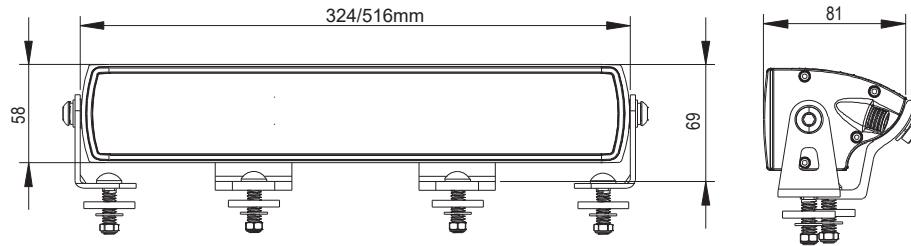

Slim Light Bar Series



Part No.: BL1015S3

Raw Lumen: 14000LM
Beam Pattern: Driving beam (35°)
Dual Position Light: White &Amber

Distance(Offroad/ECE): 1 Lux@588M /470M
Dimensions: 514*54*61.5mm
Approval: R148/R149/ R10/RoHS/CE(Ref. No. 50)

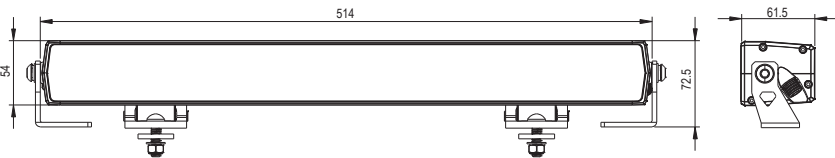

Slim LED Light Bar with Warning Light

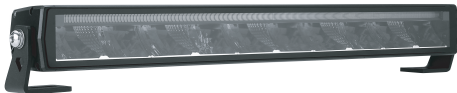

Part No.: BLWL1012S

Function: Dual position light & warning light
Raw Lumen: 11000 LM
Distance: 1 Lux @ 465 M
Beam Pattern: Driving beam (20°)
Dimensions: 514*54*61.5mm
Approval: R65/R10/RoHS/CE/R148/R149(Ref. No. 50)

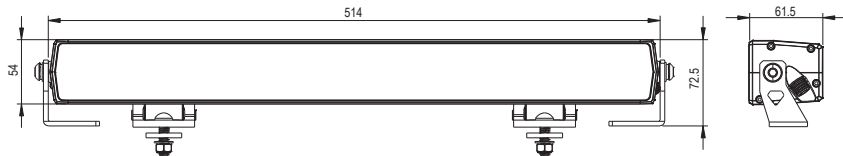

Slim Curved LED Light bar Series



Function: Dual position light(White &Amber)
Raw Lumen: 15500LM- 23400LM

Beam Pattern: Driving beam (30-40°)
Approval: R148/R149/ R10/RoHS/CE



Part No.	Size	Power	Raw Lumen	1 Lux @ M	ECE R149 Ref.No.
BL1215CS4	20" (519*47*60.5mm)	180W	15500 LM	535/468M	50
BL1815CS4	30" (764*47*60.5mm)	270W	23400LM	605/468M	50

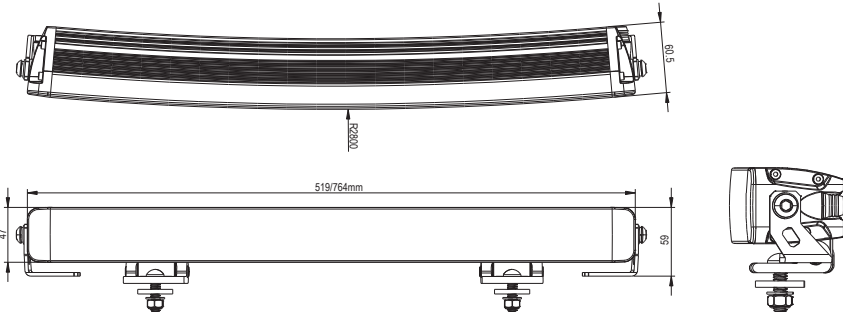

Ultra slim curved single row light bar series



Function: Dual position light(White & Amber)
Approval: R10/RoHS/CE/ECE R148/ECE R149

Raw Lumen: 9200LM-19400 LM
Beam Pattern: Driving Beam(30-45°)



Part No.	Size	Power	Raw Lumen	1 Lux @ M	ECE R149 Ref.No.
BL1806CS15-P	20" (534*33*59mm)	108W	9200 LM	545/463 M	50
BL2706CS15-P	30" (777*33*59mm)	162W	14600 LM	571/468 M	50
BL3606CS15-P	40"(1020*33*59mm)	216W	19400 LM	601/468 M	50

