

DONGNAN ELECTRONICS CO.,LTD.

ADD:NO.218 weishi Rd.,yueqing Economic Development Zone
Zhejiang Province,china p.c.325600

TEL:+86(577)61527114 FAX:+86(577)62539762
E-mail:dongnan@switch-china.com
Http://www.switch-china.com



DONGNAN provide you professional micro switch solutions.



DONGNAN Micro Switch Product
Selection Catalog
Scan to view

MICRO SWITCH

To provide a safe and reliable on-off service, let electric appliances more perfect

MICRO SWITCH SERIES

KW3A

KW3A

BASIC SWITCH

Widely used in home appliances
Electronic equipment and other
fields



27.8*15.9*10.3

MAX 25(10)A250VAC T200

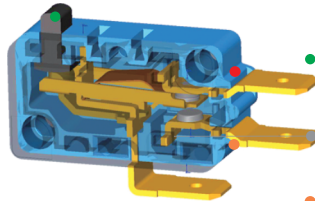

• Cover

Cover protruding
Increase the climbing distance
between the terminal and the
Cover Improve pressure

• Plunger

High temperature resistance material
Avoid high temperature softening
caused by current work
Switching work is always stable

• Terminal

Multi-track bending process
Accelerate the heat dissipation
during work
Increased electrical life of

Switches

Increasing current capacity
Drive mechanism



MICRO SWITCH SERIES

KW3A

KW3A PARTS



Self-locking

KW3A-G type
Special switch component
of the drying rack

27.8*15.9*10.3

MAX 25(10)A250VAC T200

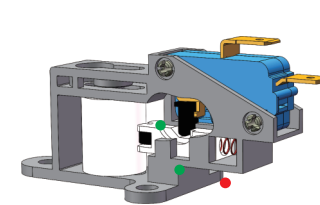

• Slim sliding rail movement
is more reliable

• The rotation and wheel
contact slide is smoother smoother

Patent



Anti-roll

Facial changes in the direction and
position of the switch
Automatic switching of the
power supply through the power supply
Suitable for electric heaters and so on

Mute

The product performance is reliable,
and the movement is not abnormal
The shape is small,
Suitable for each tadpole
to install at will



MICRO SWITCH SERIES

KW3A

KW3A DC SWITCH

KW3A large gap switch
Developed for automation
equipment and electric tools



27.8*15.9*10.3

MAX 25(10)A250VAC T200

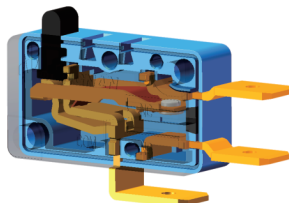

Developed for automation equipment and power tools

DC large gap

Electric parameters:
48VDC/15A; 36VDC/20A
Electronic life: 5E4
Mechanical life: 50E4
Temperature: 25T85



MICRO SWITCH SERIES

KW4A

KW4A

Apply to small current
Frequent transformation
working environment



19.8*10.8*6.4

MAX 10(4)A250VAC 25T125

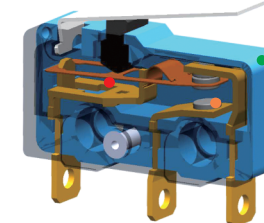

• Drive mechanism

Reed
Parallel compulsory disconnection mode
Suitable for the vibration environment of
large current and motor load

• Use the working

Environment that meets UL
125°C high-temperature-resistant
material injection molding molding shell

• Contact

Nickel silver contact
Long life, high reliability



MICRO SWITCH SERIES

KW4A(S)

KW4A(S)

Small gap\high sensitivity
\tiny stroke



19.8*10.8*6.4

MAX 10(3)A250VAC 25T125

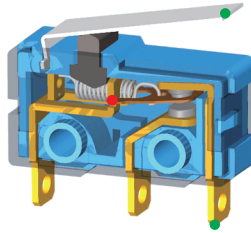

- **Drive mechanism**

Reprint - driven,
long mechanical life
Suitable for small current
Frequent conversion working
environment

- **Lever and terminal**

A variety of terminals and lever
are available



MICRO SWITCH SERIES

KW10

KW10

MINI SWITCH

Small clearance high sensitivity
Large current and high
load 0.1A-3A



12.8*6.5*5.8

MAX 3(1)250VAC 40T85

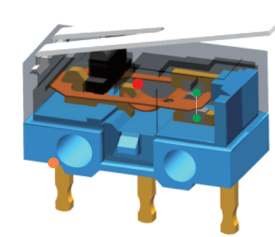

- **Internal structure**

Using the deduction bronze,
the itinerary is stable
Long mechanical life

- **Material**

All terminal contacts
include nickel silver (Agni10)
High -speed stamping
integrated molding

- **Base and terminal**

The base and terminal
integrated molding



MICRO SWITCH SERIES

KW4B

KW4B

Widely used in household appliances,
Electronic equipment,
Automation equipment and similar equipment.
Multiple wiring terminal type



19.8*10.8*6.4

MAX 10(4)A250VAC 0~10A 0~36VDC 25T125

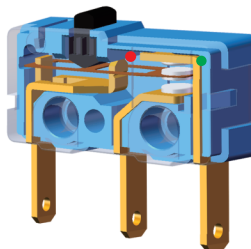

- **Internal structure**

Use reed driver,
long mechanical life
Use in small current
Stable

- **Contact**

Nickel contact
Long life, high reliability



MICRO SWITCH SERIES

MS1

MS1

The scope of action is wide
Fast terminal, Solder terminal terminal
and PCB terminal



27.8*15.9*10.3

MAX 16A(4) 250VAC 40T125

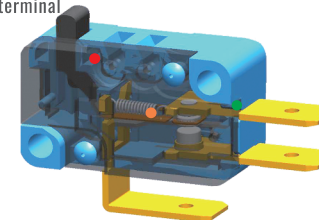

- **Plunger**

Unique plunger design,
Increase the distance between the
parts with the parts
Increase the climbing distance and
reduce the chance of leakage

- **NC terminal**

Sinking design
Powering distance between the long
terminal and the installation hole
Simple support point design,
stable itinerary

- **Lever**

Unique lever structure
Submission power >
Action for more than 50%or
more Contact is more closely



MICRO SWITCH SERIES

MS2

MS2

Customized for water level control



19.8*10.5*6.4

MAX 5(2)A 250VAC 25T100

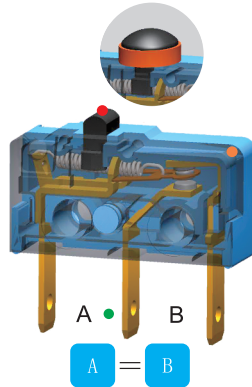

• Plunger

In dry and dusty environment
Can increase the dustproofability at the plungers

• Dust-proof

The design of the dust gap between the cover and the base Prevent dust from entering the gap

• Isometric design

Can avoid contact points when vibrating Constantly in the on-off state.
Special big difference stroke customization
Design for medical treatment beds, vacuum cleaners and other designs



MICRO SWITCH SERIES

MS5

MS5

Mainly used for car central lock and window control



20.2*8*11.6

MAX 10A 12VDC 40T85



Simple and compact structure

Anti-vibration
Shock resistance

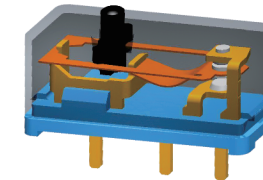

MICRO SWITCH SERIES

MS3

MS3

Customized for water level control



21.2*10*6.7

MAX 6(3)A 250VAC 25T85

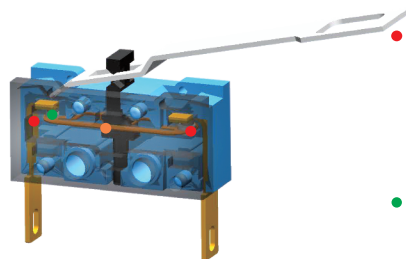

• The security on-off

Structure any contact is broken, You can end the work
Extra force is reset
Reduce misunderstanding, Work more stable and accurate

• Direct connection

Reliable all -silver contact
Other conductive intervals
Reduce the arc
A relative life increase

• Simple structure

Stable symmetrical single reed dual contact structure
Small action force, fast action response
Slowly no dead point design
Design for water level control



MICRO SWITCH SERIES

MS6

MS6

Mainly used in automobile steering wheel combined switch



19.2*15.5*7.9

MAX 10A24VDC 40T85

• Automatic reset

Contact stabilization
Prevent misoperation
Strong anti-seismic ability
Easy to disassemble

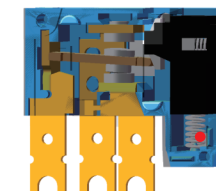

MICRO SWITCH SERIES

MS7

MS7

Mainly used in air conditioning, DVD and so on



8*6.5*3.5
MAX DC 6V 0.1mA-15mA

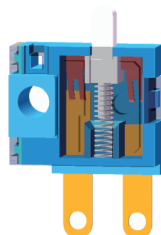

Product structure is simple, Super small volume

Contact stability, easy to disassemble,
seismic ability is strong
Light movement
Long life



MICRO SWITCH SERIES

MS10

MS10

A lighter action option
Spring and spring composite structure



27.8*15.9*10.3
MAX 16(4)A 250VAC 25T105
cULus CB CE D

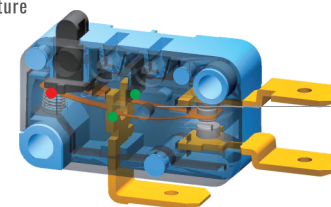

Reset spring

Spring directly acts on the button
Fast reset speed

Double support points

Small moving force is more stable
Under a small motivation
The ratio of action and recovery power ≥50%

The action force can be as low as 15 grams
Simple support point design, stable itinerary



MICRO SWITCH SERIES

MS9

MS9

Widely used in household appliances
Power tools/toys
Fax machine/alarm



19.90*9.65*6.45
MAX 10(4)A250VAC 40T125
cULus CB CE CE

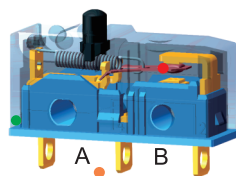

Movable piece/electric contact

Fast action/high sensitivity

Upper and lower cover construction

Seamless dust prevention

Isometric design

Contact points can be avoided when vibrating
Frequently in the on/off state



MICRO SWITCH SERIES

MS11

MS11

Subminiature switch

For the auxiliary contacts of intelligent circuit breakers, they are mainly used to monitor the operation status of the circuit breaker, the indication of the contact trip and the alarm signal of the ground fault of the circuit breaker.



31.5*26.8*12.6
MAX 0.3A~10A 600VAC 250VDC 5T40
cULus CB CE CE

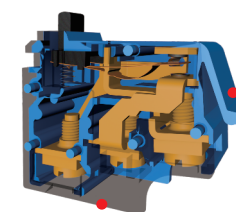

Quick rail removal and installation

Two kinds of structure



Screw construction



Circlip quick connection structure



MICRO SWITCH SERIES

MS12

MS12

SUBMINIATURE SWITCH

It can be mounted vertically and horizontally on the printed circuit board



8.2*7.6*2.7
MAX 5~500mA 30VDC 25T85
cFUS (CCC) CE

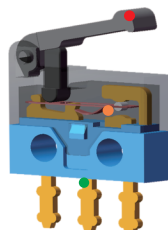

- **Lever**
Optional with or without lever type
- **Base/terminal**
The base and terminal are integrated
Smaller volume
- **Shrapnel structure**
High sensitivity with small gap



WATERPROOF MICRO SWITCH SERIES

WS1

WS1 IP67

Equipped with rich boom and wire
Suitable for all kinds of wet and dusty environment.



19.8*9.6*6.4
MAX 5(2)A 250VAC 40T85
cFUS (CCC) CE

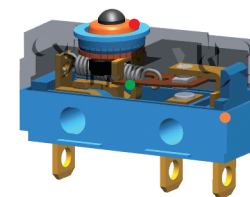

- **Waterproof hermeticloop**
Made of imported silicone rubber
Welding with ultrasonic technology
Flame retardant 94V-0 class
- **Driving mechanism**
The moving contact is made of nickel silver
The electrical contacts are made in phosphorous copper at one stroke
Contact strength can reach more than 40N
Symmetry error 0.025
- **Cover and Case**
After sealing with 200 resistant adhesive
Ultrasonic welding
0.02-0.04MPa air pressure
The reliability of waterproofing is tested comprehensively



MICRO SWITCH SERIES

MS13

MS13

Widely used in office equipment, home appliances, child seats, intelligent game consoles and automotive electronics and other equipment.



29.2*10.4*7.0
MAX 5(3)A 125/250VAC 25T125
cFUS (CCC) CE

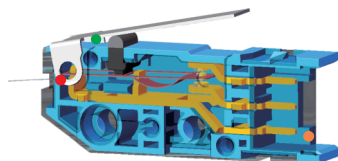

- **Contact form**
Multiple contact forms
Normally open, normally closed and convert type
- **Lever**
Mounting position of lever
It can be divided into two ways
- **Standard connector**
Crimp connector terminal, save wiring, save time, more environmental protection.



WATERPROOF MICRO SWITCH SERIES

WS1L

WS1L IP67

Long stroke and anti-vibration
Suitable for cars



20*10.4*6.4
MAX 5(2)A 250VAC 40T85
cFUS (CCC) CE

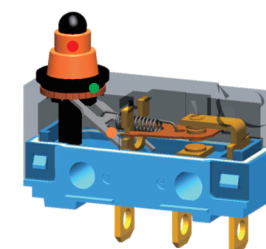

- **Special waterproof hermeticloop**
Specially enhanced waterproof hermeticloop
On the basis of ensuring waterproof reliability, Increased range of motion
- **Overstroke region**
Suitable for vibration environment
Contact contact will not break
Stability and reliability have been greatly improved
- **Special lever structure**
Increased overtravel range



WATERPROOF MICRO SWITCH SERIES

WS2 AND COMPONENTS

WS2 IP67

Appearance and mounting size is the same to KW3A



33*15.9*10
MAX 10A(3)A 250VAC 40T85
UL US CCC CE RoHS

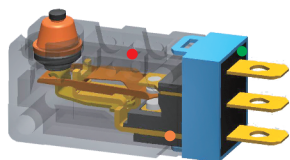

- **Cover**
The cover is made of integral Injection molding reduce the gap Improved waterproof effect
- **Silicone rubber seal**
6MM depth of dispensing groove Effective waterproofing
- **Drawer type components**
The internal components adopt the integrated structure of drawer type Simple and reliable Switch stability is effectively improved



WS2 PARTS

Used in domestic and foreign garbage disposal, Dishwasher, Jacuzzi, etc
As a working power supply and control equipment.....

Electrical parameters: 250VAC/10A
Cover dimensions: 124*76*56
Installation size: 111.5*484-4.2



AS1



ANQ1

Air push button switch

Used in humid environment
Control the power supply through the air button switch
Prevent electric shock accidents

Shield design
It can effectively prevent water splashing and drenching.



LBZ-1

WATERPROOF MICRO SWITCH SERIES

WS3

WS3 IP67

Waterproof subminiature switch



12.8*6*6.5
MAX 2GPA 250VAC 40T85
UL US CCC CE RoHS

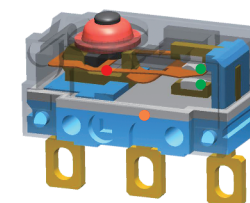

- **Simple structure**
Special beryllium bronze reed Stroke stability
- **Silver contacts**
Ultra-long life Max 2A Small contact clearance
- **Secondary silicone injection molding process**
Extruded waterproof design



WATERPROOF MICRO SWITCH SERIES

WS4

WS4 IP67

Shell anti - dull design, lever can pass the stroke



19.8*10.1*6.4
MAX 5GPA 250VAC 25T105
UL US CCC CE RoHS

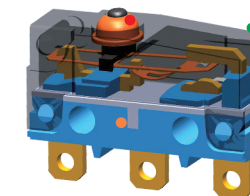

- **Sealing hermeticloop**
Made of high quality silicone rubber Flame retardant 94V-0 class
- **Cover ramp design**
When the lever is inappropriate Buffer and prevent deformation Installation options are wider
- **The base and terminal are integrated**
Improve the overall stability of small volume switch Increase waterproof performance

Adopt secondary injection molding process to improve automatic production speed
Terminal design parallel to the direction of the housing
Suitable for automatic welding



WATERPROOF MICRO SWITCH SERIES

WS5

WS5 IP67

Apply to the environment of frequent vibration



14.7*6.8*5.4
MAX 3A 12VDC 40T130
cULus CB CE D

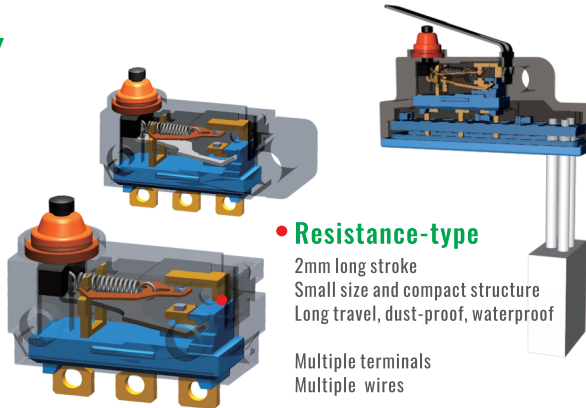

Resistance-type

2mm long stroke
Small size and compact structure
Long travel, dust-proof, waterproof

Multiple terminals
Multiple wires



WATERPROOF MICRO SWITCH SERIES

WS7

WS7 IP67

Suitable for building door and window control device
Industrial control equipment



33*23.2*9.8
MAX 10(4)A 250VAC 25T125
cULus CB CE D



KW4A microswitch is used inside the product
Stable performance and long life

The external structure of the product is simple
Reliable sealing performance
Dustproof and waterproof



WATERPROOF MICRO SWITCH SERIES

WS6

WS6 IP67 EXPLOSION CERTIFICATION

Suitable for car door lock and electric suction door



13.3*5.4*9.6
MAX 100 mA 30VDC 40T85
cULus CB CE D

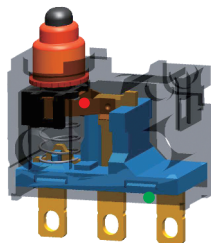

Appearance size

Volume, convenient installation
Ultra long formation (over 3mm)

Driving mechanism

Sliding contact mute design
Ensure stroke consistency

Achieve stable tightness

It is filled with rubber waterproof hermeticloop and epoxy resin
Achieve stable tightness



WATERPROOF MICRO SWITCH SERIES

WS8

WS8 IP67

Mainly used for auto parts



8.3*5.3*5
MAX 0.1A 12VDC
cULus CB CE D

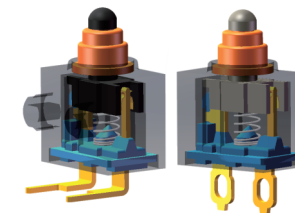

Super small size

8.3*5.3*5
The microcurrent is 0.1A

Waterproof and dustproof
Equipped with a variety of terminal structures
Suitable for installation in various environments



WATERPROOF MICRO SWITCH SERIES

WS9

WS9

IP67

Mainly used in car
car side door/trunk

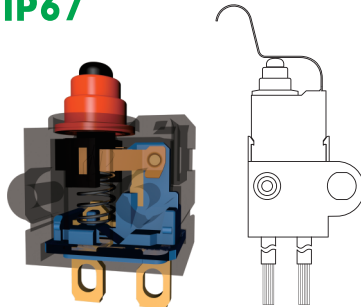

Can be equipped
with lever and wire

Contact force does not
depend on operating stroke
Small load
High sealing
Mute



8.3*5.3*5
MAX 1mA/50mA 5VDC/16VDC 40T85

WATERPROOF MICRO SWITCH SERIES

WS11

WS11

IP67

Used in automobiles and
household appliances

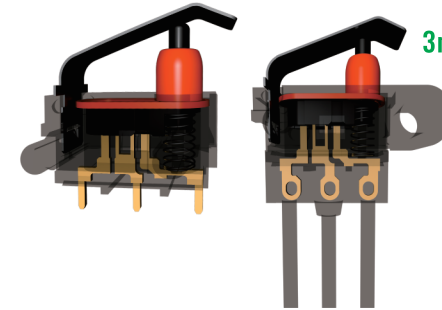

3mm long stroke



13.3*10.6*5.8
MAX: 0.1A 12VDC / 50μA 3VDC 40T85

WATERPROOF MICRO SWITCH SERIES

WS10

WS10

IP67

Used in automobiles and
household appliances

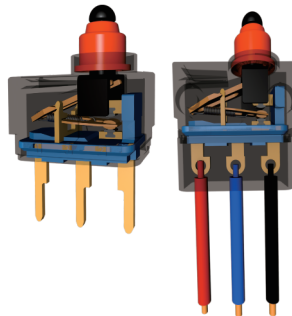

Square contact structure with
integral riveting and soldering

Normally open and normally
closed terminals
Inverted structure

Z: 转换式 SPDT	T: 常开式 SPST-NO	D: 常闭式 SPST-NC



13.1*8.5*15
MAX: 0.1A/125VAC; 3A 12VDC
0.1A/250VAC 0.1A 48VDC 40T85

OTHER SWITCH SERIES

PS6

PS6

Applied to household appliances,
Power tools, lamps, toys.

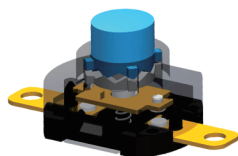

16A Small volume
High current

Mountable

Excellent self-locking function
Bring more safe and reliable
operation performance

18*13*9.6
MAX 16GPA 250VAC 25T125
cRUus



OTHER SWITCH SERIES

PS9

PS9

Widely used in household
appliances, refrigerators and lighting.

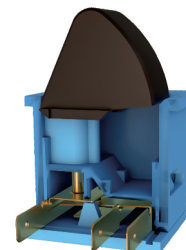

Long service life

High reliability
Contact contact is
stable and reliable

26.2*39.4*19.45
cRUus



OTHER SWITCH SERIES

PS8

PS8

IP67

Ignition switch for kitchen stoves

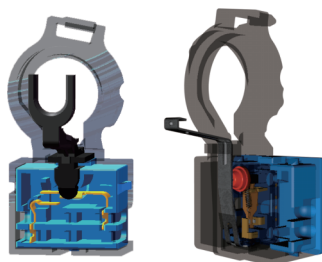

Buckle mounting
multilink
microcurrent

MAX 0.1A 250VAC T130
cRUus



OTHER SWITCH SERIES

RS1

RS1

Widely used in household appliances,
electronic equipment, automation
equipment and similar equipment

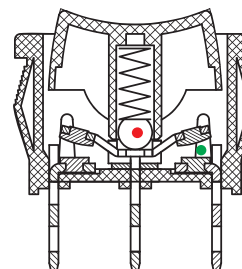

Steel ball construction

Good hand feel
Cross the dead end quickly
Service life has been
greatly improved

Contact

The electrical contacts are made of
nickel silver alloy
Adopt full contact contact structure
Greatly increased overcurrent capacity
The switch life is guaranteed

32*12*14
MAX 16(4)A 250VAC 25T125
cRUus



OTHER SWITCH SERIES

RS2

RS2

Widely used in household appliances, electronic equipment, automation equipment and similar equipment



32.8*20.6*16.5
MAX 16GPA 250VAC 25T125
cULus CE D

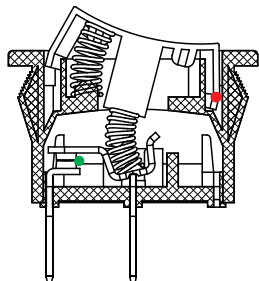

- Enclosure adds drainage design
Prevent short circuit caused by splashing water
- All-silver contact design



OTHER SWITCH SERIES

RS4

RS4

Widely used in household appliances, electronic equipment, automation equipment and similar equipment



19.8*10.8*6.4
MAX 10(3)A250VAC 25T125
cULus CE D

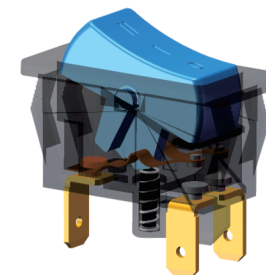

Multi-gear adjustment
Simple structure
Easy installation
Long life



OTHER SWITCH SERIES

RS3

RS3

Widely used in household appliances, electronic equipment, automation equipment and similar equipment



32*31*25
MAX 16(4)A 250VAC 25T125
cULus CE D

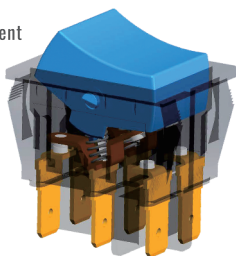

All-silver contact design
DPDT

On the basis of Rs1
Add a set of circuit
Multi-circuit combination design
Achieve complete disconnect,
more secure



OTHER SWITCH SERIES

PRS1

PRS1

Applied to dishwasher, washing machine and other household appliances and water level control equipment

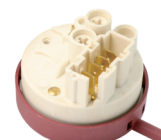

55*40
MAX 16GPA 250VAC T85
cULus CE

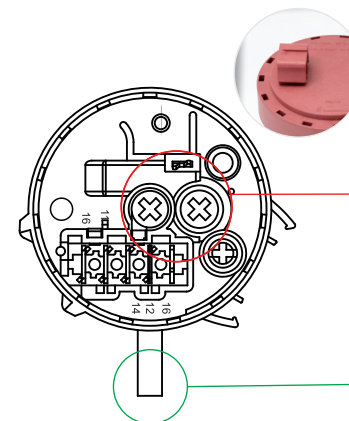

Quick installation
Simple connection mode

Adjustability
The action force can be adjusted according to the need

Driving mode
Input air pressure,
switch forward action
Release pressure switch reset



OTHER SWITCH SERIES

SP02

SP02

Mainly used for oven doors



- **High temperature resistance**
Up to 200°C
- **Contact — Contact patent design**
- **Premium case**
Button: LCP material
Cover: PPS material
- **Install**
Special metal card
Can make installation more convenient and stable



24*48.2
MAX 2A 250VAC T200
UL CE

OTHER SWITCH SERIES

SS6

SS6

The product is mainly used for automatic adjustment switches of car seats and doors and windows

Small size

Small size and reliable product performance.

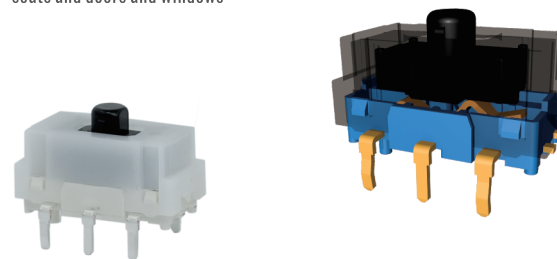

23.5*11.6*12
MAX 12VDC 10(4)A 40T85



OTHER SWITCH SERIES

SS5

SS5

Widely used in computer motherboard overclocking, wireless communication, radio and television and other equipment

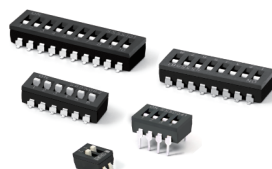

Compact structure
Small size
Contact stabilization

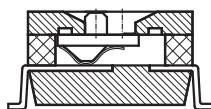

OTHER SWITCH SERIES

BD1

BD1

Door control button triggering device applied to electric ovens and similar equipment.

Extra long drive rod
Length can be customized

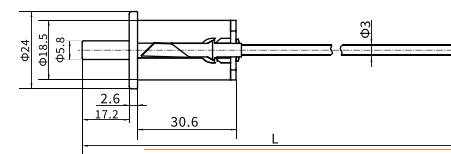
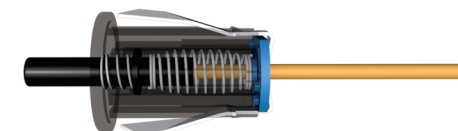

OTHER SWITCH SERIES

BS1

BS1

IP67

Mainly used for car hood, door and window control switch.

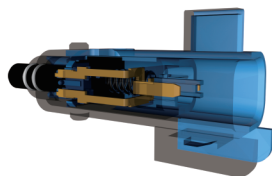

Small size

Small size, reliable performance

Easy connection replacement

Using crimping standard contact terminals, easy connection and replacement, more environmentally friendly.

48.5*25.2*8
MAX 30VDC, 0.1A 40T85



OTHER SWITCH SERIES

DNL101

DNL101

Dnl101 is used in automobile charging gun end, charging pile and automobile.

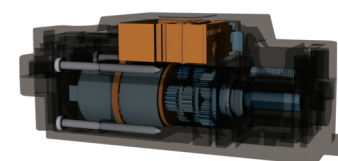

Structural reliability
Meet national standards



55.4*17.6*20.8
MAX 12V 450mA 30T85



OTHER SWITCH SERIES

MTW1

MTW1

Widely used in liquid and detergent distributors, washing machines, dishwashers, refrigerators, electric ovens, etc.



Simple and reliable structure

Simple and reliable structure, easy to install. High thrust, no noise, energy-saving

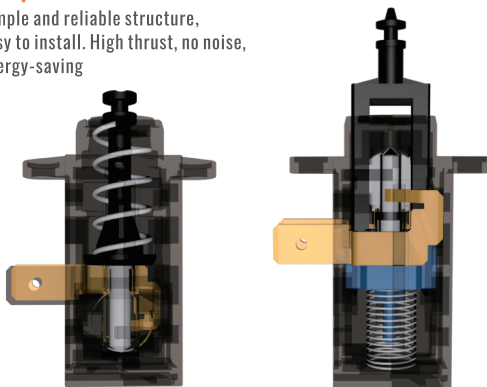

Multiple models

Two forms of action: push and pull
Multiple motion stroke

Motion stroke(mm)			
MTW1-AL635	MTW1-AS635-01	MTW1-AS800	MTW1-AS1200
4.98~6.35	4.98~6.35	6~8.2	9~12.3

110~240VAC, 50/60Hz, Steady state current 0.12Amax, Pulse current 0.75Amax



MICRO SWITCH

Applied to the field of auto parts



IATF 16949



汽车点火Car ignition device

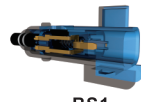

引擎盖Bonnet

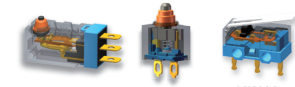

安全带与座椅控制 Application of seat belt

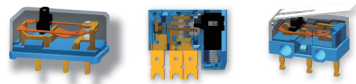

中控锁 Seat belt center control lock



汽车门锁 Car door lock

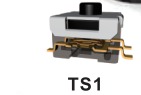

操纵杆 Control lever



汽车座椅 Car seats

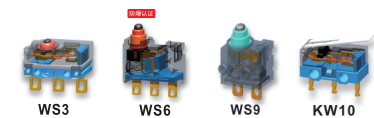

后尾门 Rear door

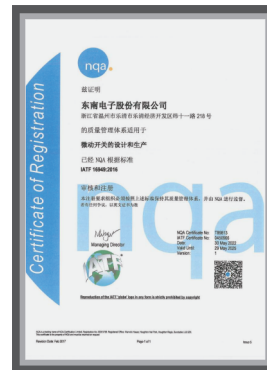

Reference for automotive microswitches



東南電子股份有限公司
DONGNAN ELECTRONICS CO., LTD.
www.switch-china.com