



股票代码:002593

打造世界一流品质汽车车轮

厦门日上集团股份有限公司
XIAMEN SUNRISE GROUP CO., LTD.

ADD : 中国福建省厦门市集美区杏北路30号
No.30 Xingbei Road, jimei District, Xiamen City,
Fujian Province, China
Tel : +(86)592-6666888
Fax : +(86)592-6076726

 www.sunrisewheel.com



精益求精 追求卓越
持续改善 客户满意

我们创造钢铁文明

WE CREATE STEEL CIVILIZATION

www.sunrisewheel.com

厦门日上集团股份有限公司 XIAMEN SUNRISE GROUP CO. LTD

- 2023年4月
April 2023 投资成立日上车轮越南有限责任公司
Sunrise Wheel Vietnam Company Limited. founded
- 2021年12月
December 2021 日上集团试验中心通过CNAS认证
Sunrise Group Test Center Has Obtained CNAS Certification in 2021.
- 2021年5月
May 2021 投资成立河北日上车轮有限公司
Hebei Sunrise Wheel Co.,Ltd. Founded
- 2021年5月
May 2021 投资成立重庆新长城钢构工程有限公司
Chongqing NCC Steel Engineering Co.,Ltd.founded
- 2021年5月
May 2021 投资成立新长城（厦门）建设工程有限公司
NCC (Xiamen) Construct Engineering Co.,Ltd. founded
- 2018年4月
April 2018 通过ISO 14001环境管理体系及ISO45001职业健康安全管理体系认证
ISO 14001 & ISO45001 Certification Approved
- 2017年11月
November 2017 投资成立漳州新长城钢格板有限公司
Zhang Zhou Ncc Gratings CO.,LTD. founded
- 2017年8月
August 2017 通过IATF 16949:2016 国际汽车工业质量管理体系认证
IATF(International Automotive Task Force)
- 2017年3月
March 2017 投资成立福建日上锻造有限公司
Fujian Sunrise Forging Technology Co.,Ltd founded.
- 2016年5月
May 2016 投资成立壹东金属幕墙有限公司
I DOMAIM Metal CURTAIN WALL Co.,Ltd founded.
- 2015年12月
December 2015 投资成立厦门日上运通国际物流有限公司
Xiamen Sunrise Express IOT Co.,Ltd founded.
- 2015年6月
June 2015 公司名称更改为“厦门日上集团股份有限公司”
Officially renamed as Xiamen Sunrise Group Co.,Ltd
- 2012年3月
March 2012 投资成立新长城（漳州）重工有限公司
NCC(Zhang Zhou)Heavy Industry Co.,Ltd founded
- 2011年6月
June 2011 在深圳证券交易所上市，股票代码：002593
Listed company in Shenzhen Stock Exchange,NO: 002593
- 2010年5月
May 2010 “22.5系列轻量化无内胎钢圈”被认定为国内领先水平
“22.5 series lightweight tubeless wheel” recognized as top-level wheel in China
- 2010年4月
April 2010 投资成立“四川日上金属工业有限公司”
Sichuan Sunrise Metal Industry Co. Ltd. founded
- 2009年8月
August 2009 被认定为高新技术企业
SRW identified as High-tech Enterprise
- 2008年5月
May 2008 厦门多富进出口有限公司
Xiamen TOPU Import & Export Co.,Ltd.
- 2008年1月
January 2008 投资成立“新长城（越南）有限公司”
NCC Vietnam Co. Ltd. founded
- 2006年12月
December 2006 投资成立“厦门日上金属有限公司”
Xiamen Sunrise Metal Co. Ltd. founded
- 2006年10月
October 2006 成为中国标准化协会团体会员单位
Became a member of China Association for Standardization
- 2005年12月
December 2005 投资成立“厦门日上钢圈有限公司”
Xiamen Sunrise Wheel Co. Ltd. founded
- 1997年2月
February 1997 投资成立“厦门新长城钢构浪板有限公司”
Xiamen New Changcheng Steel Engineering Co. Ltd. founded
- 1995年8月
August 1995 成立“厦门日上实业有限公司”
Xiamen Rishang Industry Co. Ltd. founded

通过IATF 16949国际汽车工业质量管理体系、ISO 14001环境管理体系及ISO 45001职业健康安全管理体系认证，并取得美国DOT注册，通过美国SAE、德国TÜV、巴西INMETRO、俄罗斯EAC、印尼SNI等产品质量测试认证。

SRW has obtained accredited by IATF 16949, ISO 14001 and ISO 45001. Sunrise wheels attained U.S. DOT registration and successfully passed the tests certificate by U.S. SAE, TÜV Germany, INMETRO Brazil, EAC Russia and SNI Indonesia.

HISTORY

集团简介 Group Profile

厦门日上集团股份有限公司(简称“日上集团”,股票代码:002593)创立于1995年并于2011年成功在深圳证券交易所A股上市,集团下辖两大业务板块,专业从事“汽车车轮”及“钢结构”的研发、制造与销售。日上集团旗下拥有19家分公司,5大生产基地(厦门、漳州、四川、河北、海外越南),集团辖下工厂总占地面积67万平方米,员工4000多人,技术人员300余人。

日上集团一直专注于金属制品的研发、制作与销售,集团自成立二十多年来,始终秉承“创新、诚信、责任、合作”的核心价值观,坚持“诚实守信”的原则为广大客户提供优质的服务。日上集团充分利用自身技术积累和产业基础优势,打造出具有特色的建筑钢结构和汽车车轮自主品牌,并成为国内最大规模的汽车车轮制造集团及钢制品综合生产集团之一,产能达到1400万套车轮及钢结构年用钢量35万吨的生产规模,年销售额达到38亿元人民币。

日上集团凭借先做强再做大的理念,扎实经营,将以广阔而又专业快速的服务精神,优质的产品竭力与客户共求发展,共同创造产业全新生态圈。日上集团将以“打造世界一流品质的卡客车车轮和钢结构产品”为目标,以“创造钢铁文明”为出发点。打造更高品质,更具价值的车轮和钢构制品,为社会经济发展做出自身应有的贡献。

Group Profile

Xiamen Sunrise Group Co., Ltd. (referred to as "Sunrise Group", stock code: 002593) was founded in 1995 and listed on the Shenzhen Stock Exchange in 2011. The group has two major business segments, specializing in the R&D, manufacturing and sales of "automotive wheel" and "steel structure". Sunrise Group has 19 branches and 5 major production bases (Xiamen, Zhangzhou, Sichuan, Hebei, and overseas Vietnam). The group covers a total area of 670,000 square meters of the factories, with more than 4,000 employees and more than 300 technicians.

Sunrise Group has been focusing on the R&D, production and sales of metal products. Since its establishment of more than 20 years, the group has always adhered to the core values of "innovation, integrity, responsibility and cooperation" and adhered to the principle of "honesty and trust" to provide customers with excellent service. Sunrise Group has made full use of its own technology accumulation and industrial foundation advantages to create distinctive architectural steel structures and independent brand of automobile wheels, and has become one of the largest automobile wheel manufacturing groups and steel product production groups in China. The production capacity has 14 million sets of wheels and the annual steel consumption of steel structures is 350,000 tons, and the annual sales volume reaches 3.8 billion yuan.

With broad, professional and fast service spirit and high-quality products, Sunrise Group relying on the concept of becoming stronger first and then growing bigger, operates solidly, and will strive to seek mutual development with customers and jointly create a new industrial ecosystem. Sunrise Group takes "creating world-class quality truck and bus wheels and steel structure products" as its goal, and "creating a steel civilization" as its start, creates higher quality, more valuable wheels and steel structure products, and makes contributions to social economic development.



先进的 **生产工艺**

Advanced Production process



我们相信科技对当今钢圈产业带来的巨大改革，相信先进的设备，一流的高级人才，合理的管理体制对一个企业带来的超前生机。因此，日上注重产品的尖端技术，为此，引进了当今钢圈一流的生产流水线设备，从而体现了日上采用自动化生产线的超前决策。在国内同业办厂投资规划上，日上也走在了前列，也为“汽车钢圈”的生产体现了现代高端技术所带来的巨大变化。

SRW always believes that science and technology has brought about great changes in steel wheel industry, and that advanced equipments, senior talents, and reasonable management system will generate unprecedented vitality for an enterprise. Therefore, SRW attaches great importance to advanced technology in terms of the introduction of top-class production equipment in steel wheel industry, which is a manifestation of its superior decision-making policy in adopting automated production line. SRW stands at the forefront of strategic planning and investment in the industry.



原材料开卷线
Flattening And Stretching Line



轮辋生产线
Rim Production Line



连续冲压设备
Continuous Punching Machine



WF数控旋压
WF CNC Spinning Machine



轮辐生产线
Disc Production Line



压配焊接生产线
Assembling And Welding Line

Innovation

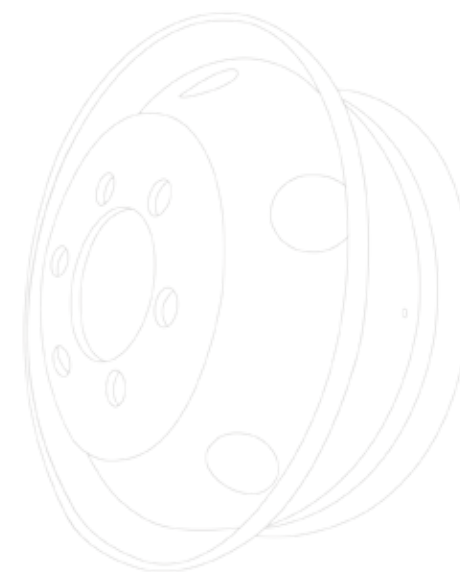

世界一流的德国WF 三旋轮数控旋压机

World-advanced German WF
Three-stage CNC spinning machine

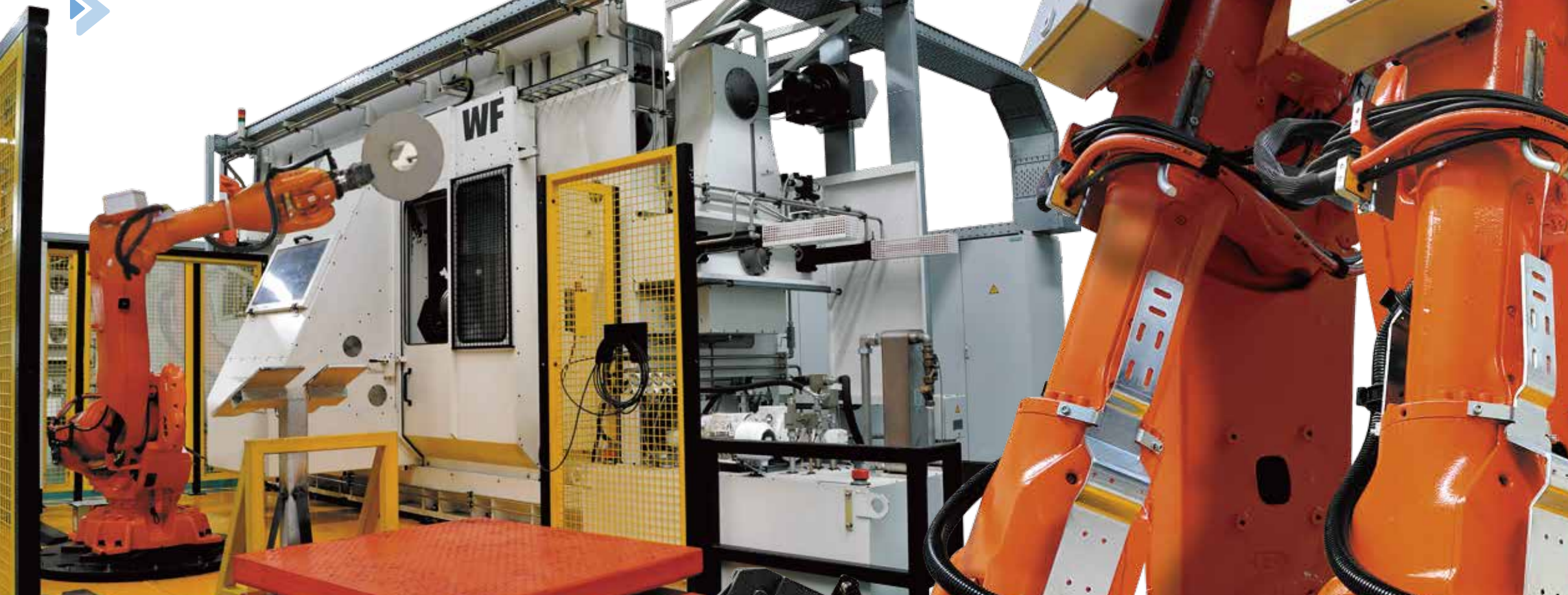

公司引进了德国瓦格纳手动静电粉末喷涂设备, 美国Valspar 粉体漆及具有国际先进水平的全自动数控旋压机, 使钢圈重量更轻、强度更高、粉末更均匀、表面光滑平整。焊接方面, 公司引进美国Lincoln埋弧焊机, 保证焊缝的强度、气密性及疲劳寿命。

SRW has introduced German Wagner static powder painting machine, American Valspar powder material and world-advanced automatic CNC spinning machine. In this way, SRW can produce tubeless steel wheel with lighter weight, better strength, uniform top-powder and smooth surface. Regarding welding, SRW has adopted American Lincoln submerge welding machine to guarantee welding quality, especially the strength and endurance life of welding seam, and air tightness.

旋压机工件上料机械臂
Mechanical feeding arm
of WF spinning machine

世界 一流
美国PPG及Valspar 涂料

World-advanced American PPG and Valspar painting materials



世界一流的美国PPG及 Valspar 涂料，能保证钢圈表面长时间不褪色、不掉漆，从根本上解决了钢圈漆面的质量问题。

The world-advanced painting materials ensure no fading and peeling at surface coating for a long time, which provides a basic solution to the problem of surface coating quality.



进口液体面漆线，充分保证了钢圈面漆厚度及均匀度，使产品更加美观。

The surface-coating line with imported painting material fully renders every wheel with uniform thickness and smooth surface.

世界 一流
日本KAKUSAI在线全检测设备

World-advanced Japan KAKUSAI on-line inspection machine



世界 一流日本KAKUSAI在线全检测设备。

World-advanced Japanese KAKUSAI on-line checking machine ensures better product quality



动平衡测试仪Balance checking machine 严格检测钢圈动平衡，确保行驶安全；优良的钢圈动平衡可以减少轮胎与地面的异常磨损，延长轮胎的使用寿命。

The machine performs strict inspection of wheel balance to secure driving safety. Excellent wheel balance will reduce unnatural tire wear, which prolong its service life.

世界 一流
美国Lincoln埋弧焊机

World-advanced American Lincoln submerge welding machine



世界 一流美国 Lincoln 埋弧焊机，焊缝扎实，确保钢圈良好的气密性。

The machine contributes to solid welding seam and excellent air tightness.

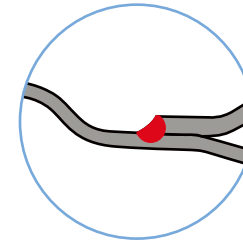

采用最新焊接工艺，增加强度及耐用性，提高行驶过程中的安全。

Updated welding technology is applied to increase wheel's strength and durability, and improve driving safety.

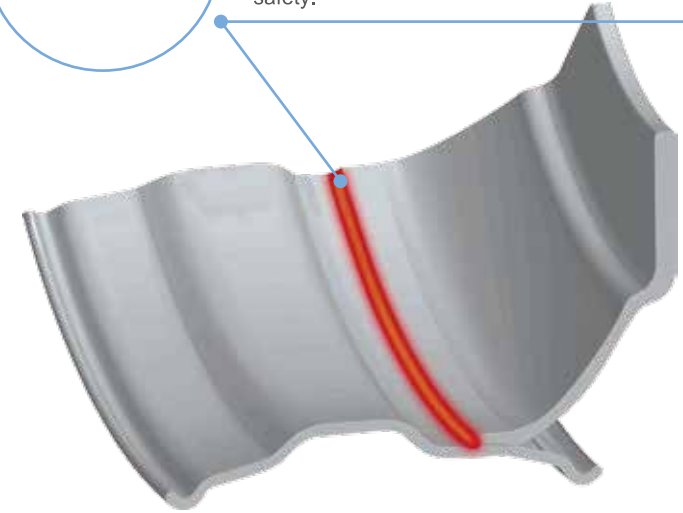

更宽、更高的轮缘设计，全面保护轮胎胎唇。

Wider and higher rim design protects tyre bead.

改变散热气流方向，提高散热性能。

Different heat flow direction improves cooling performance.

采用最新型高性能高强度钢材，从根本上加强使用过程中的耐用度以及安全性，最大限度的让用户得到利益的同时，拥有安心。

The newest and high-quality steel material can basically strengthen the durability and security of wheels in use, meanwhile maximize user's benefits and dispel user's worries.

采用世界 一流美国 PPG 及 Valspar 涂 料，长时间保证钢圈表面不褪色，不掉漆，涂漆面均匀加厚，有效减少沙石路面 对钢圈漆面损伤，确保使用。

World-advanced American PPG and Valspar painting materials ensure no fading and peeling at surface coating, and contribute to even painting thickness and smooth painting surface, which effectively prevent wheel's surface coating from damage on rugged road.

轮辋加厚，提高载重能力。

Thicker rim enhances loading capacity.

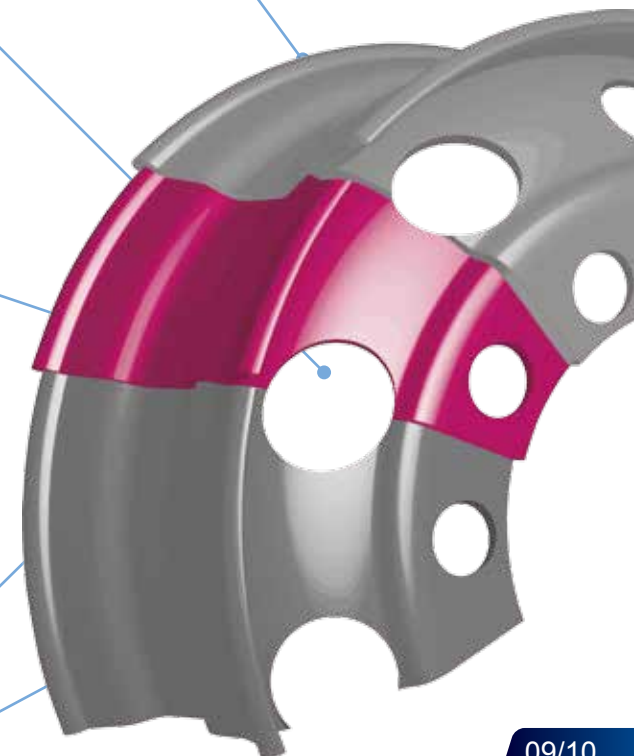

品质控制 Quality Control

产品从设计、测试、生产到品质管控，应用一流的软件和设备，实施严格的管理，确保出厂的每一个钢圈质量合格。

SRW applies advanced softwares and equipments in design, test, production and quality control to all its products, and implements strict management to guarantee every delivered wheel quality.

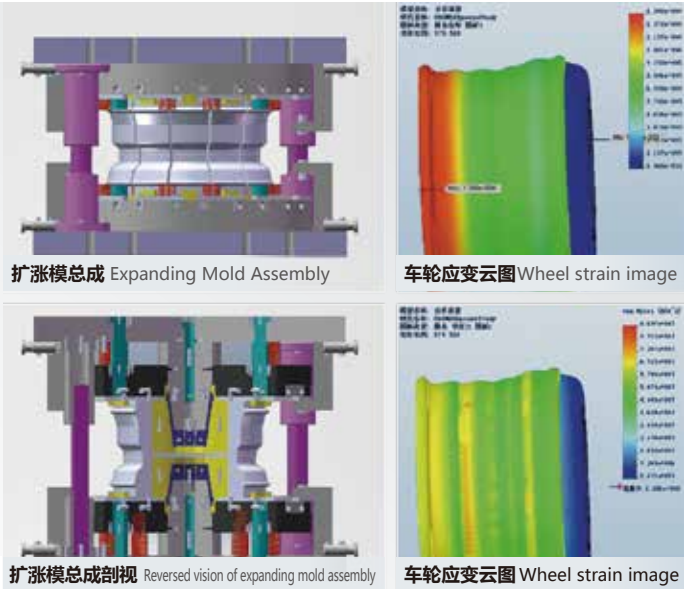

无内胎钢圈优点 Advantages of tubeless steel wheel

载重 • 节省燃料
Heavy duty • Energy efficient

由于无内胎轮胎滚动阻力更小，且带轮辋整套重量比有内胎轮胎轻 12% 左右。据资料统计，如果全钢有内胎轮胎换成全钢无内胎轮胎，每根轴可省燃油 1% 左右。也就是说，你的挂车是 1.2.3 轴的话，就可省 6% 的油费。

Tubeless wheel has less rolling resistance and is 12% lighter than tube wheel. According to statistics, if the tube wheel is replaced by tubeless wheel, each axle can save fuel by 1%, which means that your trailer can save fuel by 6% if it is a 123-type axle.

高速 • 降低胎压
High speed • Lower tyre temperature

由于全钢无内胎轮胎取消了内胎和垫带，而且所使用的钢圈也要比有内胎轮胎轻薄了许多，所以在长途高速行驶中，散热性能更好。并且无内胎轮胎轮辋的外直径比有内胎大，所以刹车片的散热也更好。行驶胎压的降低对轮胎的耐磨性提高，预防肩空，大有好处，而且有效提高了高速性能，比有内胎轮胎有更长的行驶里程。

As tubeless wheel is without inner tube and flap, and it is lighter than tube wheel, the tubeless wheel has better cooling performance in long-distance and high-speed driving. The tubeless wheel rim has bigger external diameter than that of tube wheel rim, which contributes to better cooling property for brake pad. Lowering tyre temperature can reduce wear resistance, prevent tyre-shoulder separation and effectively enhance high-speed performance but with longer driving distance than tube wheel.

安全 • 提高安全性
Safety---better wheel security

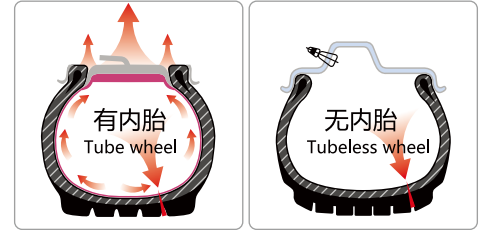

被刺穿后，空气瞬间从内胎和外胎的间隙 向子口处、气门嘴孔泄露，汽车即刻发生 倾斜，极有翻车的可能!

After being punched, the air will flow from the clearance between inner tube and tyre, and then leak out through tyre toes and air valve. In this case, a car or truck will lean immediately, leading to a danger of turning over.

被刺穿后，胎内空气只能从唯一出口缓慢泄露，汽车不会发生倾斜，让司机有一个处置的时间。

After being punched, the air can only leak out through an only outlet slowly. In this case, a car or truck will not lean and a driver will have time to handle it.

根据路况选用钢圈 Right wheel in right road condition

*G*代表标准载重 *G* refers to standard loading capacity

使用路况 Road conditions	良好路面 Good conditions			非良好路面 Poor conditions	
	高速公路 Express highway	国道 National highway	市区路面 Urban road	混合路面 Mixed road	恶劣路面 Rugged road
一般 general ≤G	★★★★★	★★★★★	★★★★★	★★★★★	★★★★★
较重 heavier ≤1.5G	★★★★★	★★★★★	★★★★★	★★★★★	★★★★★
重载 over-weight ≥1.5G	★★★★★	★★★★★	★★★★★	★★★★★	★★★★★

根据车型轮位选用钢圈 Right wheel with right vehicle and position

车型 vehicle type	客车 Bus	挂车 Trailer	单车 Truck
轮位 wheel position			
前轮 front wheel	★★★★★	★★★★★	★★★★★
驱动轮 driving wheel	★★★★★	★★★★★/★★★★★	★★★★★/★★★★★
从动轮 driven wheel	★★★★★	★★★★★	★★★★★
轻量型 Lightweight	★★★★★	普通型 General	★★★★★
加强型 Reinforced	★★★★★	载重型 Heavyweight	★★★★★
加强载重型 Reinforced heavyweight	★★★★★		★★★★★

物流保证 Transport Assurance



日上集团地处美丽的厦门，交通便利，距离机场、码头及火车站均只需 15-20 分钟的路程。厦门港是中国沿海十大港口之一，交通发达，拥有完善的陆海空交通体系，为外向型经济的发展提供了强有力的保障。

Sunrise Group, located in beautiful Xiamen City, enjoys convenient means of transportation. It takes only 15-20 minutes' drive to international airport, sea port and train station in or around Xiamen. Xiamen port, one of the top 10 sea ports in China, facilitates the development of export-oriented economy in Xiamen with its great support of comprehensive transportation system.

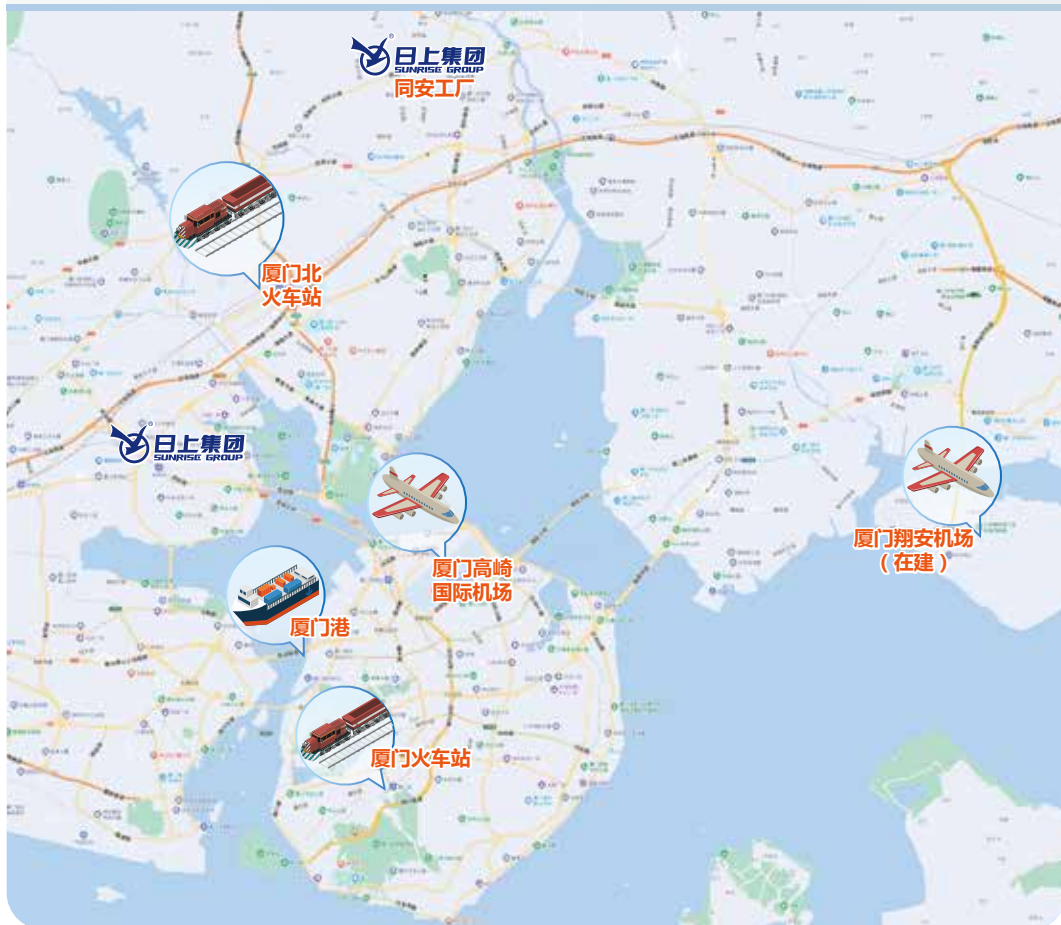

主要适配车种 Major Adaptive Vehicle Types



 Mercedes-Benz	 SCANIA	 MITSUBISHI	 Volkswagen	 SUZUKI
 中国一汽	 DAEWOO	 TATA	 HYUNDAI	 江淮汽车
 中国重汽	 东风	 FOTON 福田汽车	 ISUZU 庆铃汽车	 跃进汽车
 VOLVO	 MAN	 NISSAN	 UD	 Hino
 陕汽重卡	 上依维柯红岩 SAIC-IVECO HONGYAN	 青年汽车 YOUNG MAN	 KING LONG 金龙客车	 CAMC
 Mack TRUCKS	 Ashok Leyland	 ITPA	 SAIPA	 Reinke
 CIMC	 IVECO	 National Trailer Corporation VANGUARD	 БОРДАН КОРПОРАЦИЈА	
 FACCHINI	 Transcraft®	 NOMA	 STECO	
 Empresas RANCON®	 WESTERN TRAILERS	 CHAPARRAL	 TEREX	

日上联结世界 Sunrise Links the World



日上集团公司秉承“创新、品质、诚信、责任”的经营理念，已形成了国内外OE市场和售后市场的良好格局，成功进入了中国一汽，中国重汽，金龙，东风，宇通，大运，吉利商用车、中集，美国Vanguard，巴西FACCHINI，德国Fligel，白俄罗斯MAZ、奥地利Schwarz Müller、巴西Randon等国内外大型卡拖客车制造商的供应系统。日上集团旗下拥有19家分公司，专业从事汽车钢圈，铝圈的研发、制造与销售，员工4000人，技术人员300人，现总占地面积67万平方米，出口占比70%，年产能达1100万套，产品远销全球150多个国家及地区。



Sunrise group Adhering to the management philosophy of "Innovation, Quality, Integrity, Responsibility", Sunrise Group has formed a good pattern of OE market and after-sales market at home and abroad, and successfully entered into the world top truck, trailer and bus manufacturers' supplying systems such as CIMC, China FAW, SINOTRUK, KINGLONG, DONGFENG, YUTONG, DAYUN, GEELY Commercial Vehicle, CIMC, American Vanguard, Brazil FACCHINI, Germany Fligel, Belarus MAZ, Austria Schwarz Müller, and Brazil Randon. Sunrise group operates 19 branches, specializes in R&D, manufacturing and distribution of Steel Wheel and Aluminum Wheel. shoulders the responsibility of over 4000 employees and 300 technicians. The whole group covers a total area of 670,000 square meters with an annual capacity of 11 million wheels, with an export ratio of 70%. Currently, self-owned brand of SRW wheels roll in more than 150 countries and regions abroad.



- 华东地区 East China
- 华南地区 South China
- 华中地区 Central China
- 华北地区 North China
- 西北地区 Northwest China
- 西南地区 Southwest China
- 东北地区 Northeast China

日上集团中国分布图

SRW distribution network in China



Integrity

日上车轮 Sunrise Wheel



为进一步提升生产效率、提升产品品质，以全力提升集团公司的竞争力，日上集团对生产线进行了一系列的自动化、省力化等提升改造，其中包括新增德国WF轮辐旋压设备、轮辋线脉冲对焊改造、涂装线自动喷涂改造等；同时为提升集团公司的产品研发能力，集团于2021年正式取得CNAS国家合格试验室认证标准。

为加强对市场的快速响应能力，提升在原材料、产品等物流配送方面的优势，集团国内新增河北生产基地及进一步扩大海外越南工厂的规模。

To fully enhance the competitiveness of the group, Sunrise makes further efforts to improve production efficiency and product quality. Sunrise Group has carried out a series of transformation and updating of production line on automation and laborsaving, including the addition of German WF CNC Spinning Machine, the transformation of Pulse Butt Welding Rim Line and the Automatic Spraying Painting Line, etc.; At the same time, to improve the capability of R&D, the group has obtained CNAS National Qualified Laboratory Certification in 2021.

New production base of Hebei under building and further expansion of the scale of Vietnam factory will strengthen the ability of rapid response to the market and enhance the advantages in logistics distribution of raw materials and products.

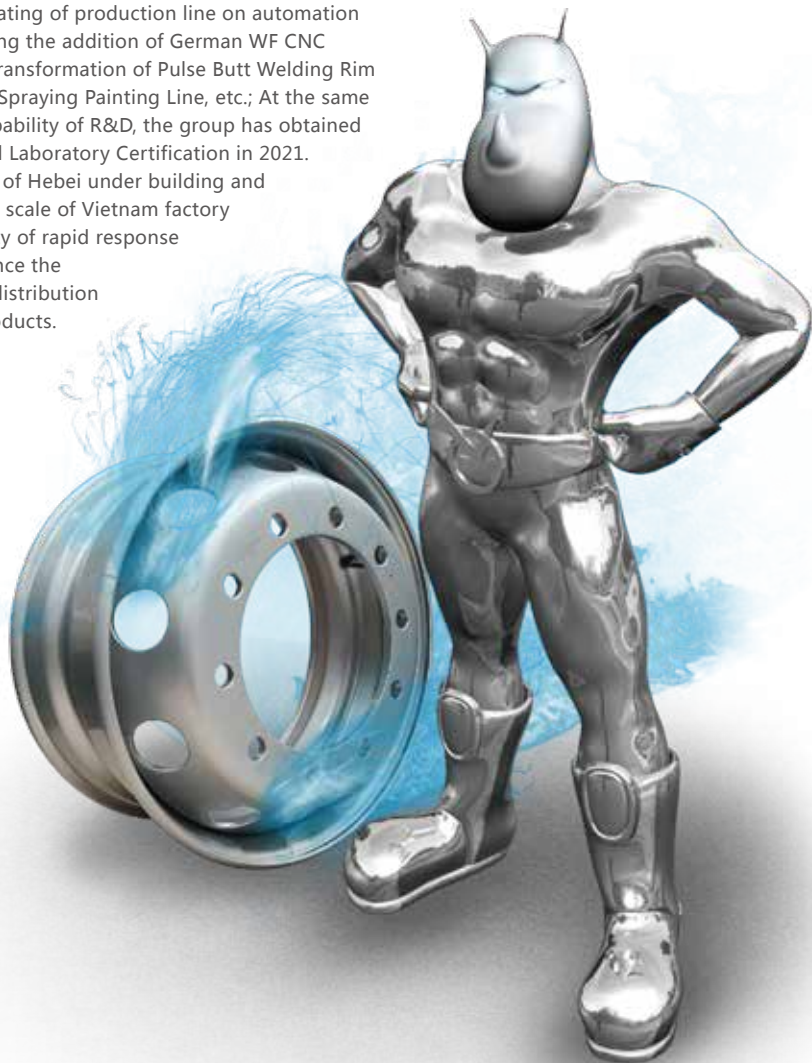

钢圈 Steel Wheel

特征
Feature

专为良好路面高速行驶设计，卡客车全轮位安全使用。

It is specially designed for the safe use of all wheel bits to truck and bus in high-speed running on good road condition.

优点
Advantages

- 更节省燃油
- 有效降低胎温
- 提高安全性
- Much more energy efficient
- Effectively lowering tyre temperature
- Improve driving security



型钢钢圈 Tube Wheel



无辐钢圈 Demountable Wheel



无内胎钢圈 Tubeless Wheel



轻量化 Lightweight

研发优势:日上集团致力于商用车钢制车轮产品研发二十多年，已积累了较强的产品研发实力，能针对市场的特殊需求进行产品的个性化定制，特别是在产品结构设计方面，能有效运用有限元分析软件，对不同材质和不同性能要求的产品实施可靠的结构设计，尤其是在高抗拉强度材料使用方面，日上集团以市场的轻量化需求为导向，已成功开发了全行业最轻量的22.5x8.25系列产品，重量为28.6kg，比同类产品减重约18%。

R&D advantages: Sunrise Group is committed to commercial vehicle steel and aluminium wheel product development nearly 20 years, has accumulated a strong product development strength, the specific needs of the market for personalized products, Finite element analysis software, the different materials and different performance requirements of the product to implement a reliable structural design, especially in the use of high tensile strength materials, Sunrise Group by lightweight market demand oriented, has successfully developed the industry's most lightweight 22.5x8.25 series products, the weight of 28.6kg, about 18% weight loss than similar products.



轻量化产品优势 Advantages for light weight as below



节省燃油
Fuel Saving



安全性好
Better security



重量轻
Lighter on weight



造型美观
Attractive appearance



承载能力高
Higher max load capacity



提高驾驶舒适性
Improve driving comfort



轮胎磨损降低26%
Tire wear rate decreased by 26%



刹车维修费用降低
Lower the cost for brake maintenance



锻造铝圈 Forged Aluminum Wheel

制造优势: 日上集团采用行业内领先的工艺规划, 进行产品的闭模锻压成型, 保证了产品几何精度的同时, 又能使产品的质量分布均匀, 材料金相组织得到有效保证; 旋压成型设备采用德国立式三旋轮结构的旋压机, 可以保证产品圆柱度精度控制在0.5mm以内, 同时还减少了加工的残余应力; 热处理设备采用日本设计的连续式步进炉, 炉温控制可靠性高, 控温精度能达到 $\pm 1^{\circ}\text{C}$, 产品的热变形量在0.5mm的可控范围内, 加热和淬火的过程控制稳定可靠, 能得到可靠的合金固溶体组织, 从而确保了产品的抗拉强度和表面硬度均能满足产品的设计要求以及市场需求; 机加工方面 采用台湾制造的精密数控车床, 在保障产品加工精度的同时还有效提升了生产效率, 可有效减少加工误差, 加工精度可达0.01mm。在铝合金车轮的全线生产过程中, 全程实现自动化, 工件物流自动化以及换模自动化等, 保证了产品品质的一致可靠。

Manufacturing advantage: Sunrise Group uses the industry's leading technology planning, the product of the closed-die forging molding to ensure that the product geometric accuracy and also make the product quality distribution evenly, the material metallurgy organization is effectively guaranteed; spinning equipment used in Germany The three-wheel-type spinning machine which can ensure that the product cylindrical precision is controlled within 0.5mm, and also reduces the residual stress of the processing. The heat treatment equipment adopts the Japanese-designed continuous stepping furnace, the furnace temperature control is high reliability, Temperature control accuracy can reach $\pm 1^{\circ}\text{C}$, the product of the thermal deformation of 0.5mm in the controllable range, heating and quenching process control is stable and reliable to get a reliable alloy solid solution structure, thus ensuring the product of tensile strength and Surface hardness alike to meet the product design requirements and market demand; Machining, Taiwan-made precision CNC lathe, in ensuring the accuracy of product processing at the same time also effectively improve the production efficiency which can effectively reduce the processing error and processing accuracy of up to 0.01mm. Aluminum alloy wheels in the entire production process, the entire process are automation, workpiece logistics automation and mold change automation, to ensure consistent product quality and reliability.



轿车锻造铝圈 Forged Aluminum Passenger car wheel



适用于各种表面处理和客户意向的定制。

Suitable for all kinds of surface treatment and combination of customer's intention.



卡客车锻造铝圈 Forged Aluminum Commercial wheel

Forged Aluminum Wheel Product Advantages

重量更轻, 运营成本更低 Lighter in Weight and Lower in Cost

锻造铝圈重量只相当于钢圈的五分之四, 以22.5X8.25为例, 锻造铝圈重量约为24KG, 钢圈至少为30KG; 据世界铝业协会提供的数据, 一般情况下汽车每减少10%的重量, 其油耗便可降低6%-8%。

Aluminum Wheel is 20% lighter than steel wheel, take 22.5X8.25 as an example, the weight for Aluminum wheel is just about 24kg and 30kg for the steel wheel. According to the statistics by International Aluminum Institute, every 10% reduction in weight will decrease 6%-8% fuel generally.

强度更高, 更加安全 Higher Strength and Safer in Driving

锻造铝圈的承载能力是钢圈的5倍, 并且减轻了轮胎磨损, 降低刹车鼓以及轮胎的老化, 提高轮胎使用寿命, 降低爆胎的可能性; 当受到外部冲击时, 铝圈受到的损坏程度远小于钢圈。

Forged Aluminum wheel owns 5 times higher loading capacity than steel wheel. Also, it reduce the tire wear and the brake drum abrasion which prolong the tire life and lower the possibility of flat tire. When it comes to external force impact, Forged Aluminum Wheel suffers far less damage than steel wheel.

散热性能更好, 轮胎磨损降低 26%。 Good Heat Dissipation, Tire Wear Decrease by 26%

锻造铝圈有散热快的特性, 所以能更好地保护刹车系统以及其他零部件, 从而大大降低刹车系统的保养费及轮胎的磨损率。

Forged Aluminum Wheels are good at heat dissipation which allow better protection for brake system and other parts of the vehicle, which correspondingly reduce the maintenance cost and the tire wear.

