



Car Lift



Zhejiang Altertool Technology Incorporated

ADD: No.303# Zhuangqian Road, Economic & Technological Development District, Jiaxing City, Zhejiang, China 314050
Mp:+86-18957369690
Tell:+86-573-82078308
E-mail:sales@altertool.com
Website:www.altertool.com



Zhejiang Altertool Technology Incorporated





MODERN PRODUCTION BASE

现代化的生产基地

浙江傲途科技股份有限公司举升机生产基础位于紧邻上海的太仓市国家级港口开发区，工厂占地二十亩，标准厂房面积八千二百平米，厂房设计年产能2万台汽车举升机，公司拥有各类先进的大型制造设备和高级专业技术人才，主营生产各类中高站汽车举升机，强大的技术研发团队确保机型种类与世界发达国家保持同步。

我们拥有专业的生产管理、技术研发、市场销售团队。在中国国内提供服务的同时，也服务于欧洲、澳洲、北美洲、中东、南非等海外汽保企业和经销商，科学的管理体系，保证了高品质的产品，完善的售后为客户提供无忧的售后服务。

Zhejiang Altertool Technology Incorporated car lift production base is located in Taicang national port Development Zone near Shanghai, our factory covers an area of 20 acres, the standard plant area of 8,200 square meters, the plant design annual capacity of 20,000 car lifts, We have all kinds of advanced large-scale manufacturing equipment and senior professional and technical personnel, the main production of all kinds of high station car lifts, Strong technical research and development team to ensure that the types of models and developed countries in the world to keep pace.

We have a professional production management, technology research and development, marketing and sales team. In China to provide services at the same time, but also to serve Europe, Australia, North America, the Middle East, South Africa and other overseas auto insurance enterprises and dealers, scientific management system, to ensure high-quality products, perfect after-sales service to provide customers with worry-free after-sales service.



STANDARDIZED PRODUCTION MANAGEMENT AND QUALITY CONTROL

生产管理与质量控制

浙江傲途科技股份有限公司的生产管理和质量管理团队秉承“专心制造精品”的生产理念，并将这个理念贯彻给每一个员工。从原材料采购，所用的钢材一律采购正规国有大型钢厂生产的优质钢材，各类配件实行严格的管控流程，不定期对配件进行各类机械性能和理化性能测试，零部件生产过程中的每一道工序都经过相关部门专业品检，确保制成优质合格的成品，打造“零缺陷”、“长寿命”优质产品是我们的不断追求目标。

The production management and quality management team of Zhejiang Aotu Technology Co., Ltd. adheres to the production concept of "focusing on manufacturing high-quality products" and implements this concept to every employee. From the procurement of raw materials, the steel used is all the high-quality steel produced by regular state-owned large-scale steel mills. All kinds of accessories are strictly controlled, and various mechanical properties and physical and chemical properties of accessories are tested from time to time. Every process in the production of parts is inspected by relevant departments to ensure that high-quality and qualified finished products are made. To create "zero defect", "long life" quality products is our constant pursuit of the goal.

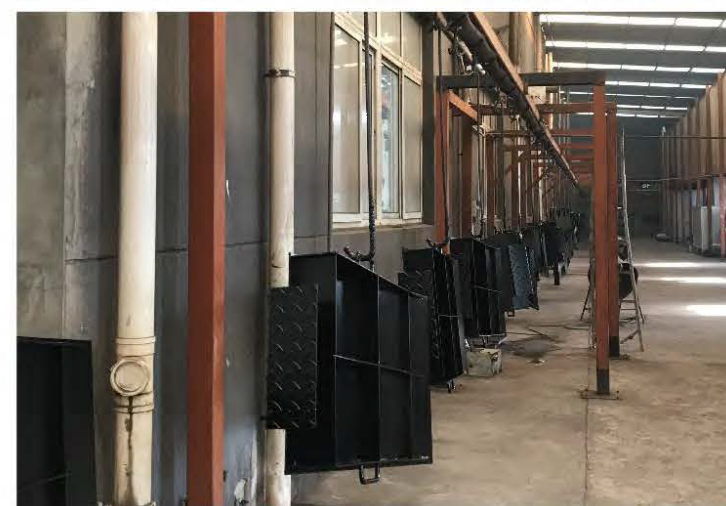

CHINESE SERVICE TERRITORY

国内服务

ALTERTOOL作为一个拥有26历史的品牌,从成立初期,ALTERTOOL举升机就成为了大众维修站的指定产品。ALTERTOOL系列举升机又相继成为了一汽丰田、北京现代、日产尼桑等4S站的配套产品。直至今日,“ALTERTOOL”品牌在全中国各地拥有100多家专业经销商,以稳定的产品质量和一流的服务理念赢得了国内外同行的一致好评。

"ZHEJIANG ALTERTOOL" as a famous brand with 26 years history in China, it has been the indicated products for Volkswagen station when it was just established. And it has been the auxiliary products of Toyota, Hyundai, Nissan, BYD etc in succession. Till today, "ZHEJIANG ALTERTOOL" brand has more 100 distributors in Chinese market, and gain the good reputation with the steady and good quality and first-class service philosophy.



www.altertool.com



INTERNATIONAL SERVICE TERRITORY

国际服务

在为国内汽保业提供服务的同时，公司旗下的“PSYCHE”品牌从2002年成立起，专业服务于海外市场。为了更好的迎合海外市场的需求，公司不断开发研制了更多适合国际市场需求的的产品，如停车系列举升机、单柱举升机、轮胎服务举升机，现已成功远销欧洲、亚洲、澳洲、俄罗斯、非洲、中东、南美等海外市场，获得了海外经销商的一致认可。

When offering the service for domestic market, and the brand was established in 2002, is especially serving the oversea market. In order to cater for the global marketing requirements, we developed more different lifts, like parking lift, single post lift, tire service lift. Now is well selling and accepted in the market of Europe, Russia, Asia, Australia, Africa, Middle East and South America.

www.altertool.com



TJS19-21640

4T 双柱双缸液压举升机
Electro-Hydraulic 2 Post Lift Floor Plate Type, Manual two sides lock release



4000 kg

Manual

380 V

220 V

- 手动双边解锁。
- 托臂自锁结构，上升时自动锁紧，下降到地面时自动解锁。
- 二节螺旋举升托垫可以轻松调节高度，更容易定位汽车支撑点，适合于更多的低底盘车辆。
- 油缸端头装有节流阀，即便油管突然爆裂，也能确保安全。
- 橡胶车门防撞垫作为标准配置，能有效地保护车门的损伤。
- 托臂防压脚作为CE标准配置。

- Manual lock release from two sides.
- Automatic arm restraints, lifting arm automatically engages when lift is raised and disengaged when lift lowered to the ground.
- 2-stage Screw-up pads suitable for low chassis vehicle as well as.
- Parachute valve that equipped in hydraulic joint ensures safety in case of oil hose broken.
- Door opening protection rubber as standard.
- Foot guard as CE standard.

细节说明 Details



- ① 24V低压控制系统
24v low voltage control system
- ② 加强型滑台/车门防撞橡胶垫
Strengthen carriage /Door opening protection rubber
- ③ 内置式油管保护罩
Built-in pipeline protection cover
- ④ 车门保护橡胶
Door Opening Protection Rubber
- ⑤ 二节螺旋举升托垫
2-stage Screw-up pads
- ⑥ 节流阀
Parachute valve

外形尺寸 Dimension

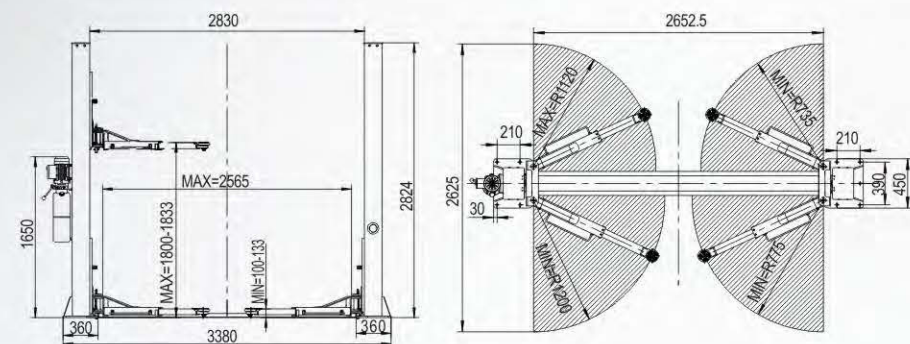

技术参数 Technical Data

举升重量	Lifting capacity	4000kg
安装宽度	Mount width	3380mm
立柱高度	Height of post	2824mm
举升高度	Lifting height	1880mm
立柱间距	Width between post	2830mm
最低高度	Min. height	100mm
上升时间	Lifting time	<50s
下降时间	Lowering time	<40s
电机功率	Motor power	2.2kw
电压	Power supply	220v/380v

4000 kg

Electric

380 V

220 V

TJS19-21840EFC

4T 双柱双缸液压举升机/电动解锁
Electro-Hydraulic 2 Post Lift Floor Plate Type, Automatic Lock Release



- 电动解锁，只需按上升和下降按钮来实现操作。
- 托臂自锁结构，上升时自动锁紧，下降到地面时自动解锁。
- 三节螺旋举升托垫可以轻松调节高度，更容易定位汽车支撑点，适合于更多的低底盘车辆。
- 油缸端头装有节流阀，即便油管突然爆裂，也能确保安全。
- 橡胶车门防撞垫作为标准配置，能有效的保护车门的损伤。
- 链条防护帘作为CE标准配置。
- 托臂防压脚作为CE标准配置。

- Automatic lock release, just press Up and Down button to operate the lift.
- Automatic arm restraints, lifting arm automatically engages when lift is raised, and disengaged when lift lowered to the ground.
- 3-stage Screw-up pads suitable for low chassis vehicle and makes easy and quick service.
- Parachute valve that equipped in hydraulic joint ensures safety in case of oil hose broken.
- Door opening protection rubber as standard.
- Chain protection curtain as CE standard.
- Foot guard as CE standard.

细节说明 Details



- ① 24V低压控制系统(电动解锁)
24v low voltage control system (Automatic lock release)
- ② 加强型滑台/车门防撞橡胶垫
Strengthen carriage /Door opening protection rubber
- ③ 三节螺旋举升托垫
3-stage screw-up lifting pad
- ④ 车门保护垫,链防护装置
Door protection pad & chain guard
- ⑤ 高度限位开关
Height limited switch
- ⑥ 节流阀
Parachute valve

外形尺寸 Dimension

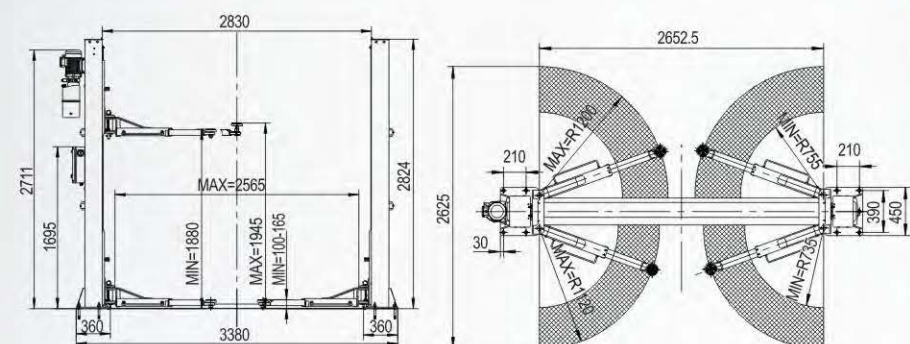

技术参数 Technical Data

举升重量	Lifting capacity	4000kg
举升高度	Lifting height	1880mm
立柱高度	Height of post	2824mm
立柱间距	Width between post	2830mm
安装宽度	Mount width	3380mm
最低高度	Min. height	100mm
上升时间	Lifting time	<50s
下降时间	Lowering time	<40s
电机功率	Motor power	2.2kw
电压	Power supply	220v/380v

TJS19-22840SFC

4T 双柱双缸液压举升机/单边解锁
Electro-Hydraulic 2 Post Lift Floor Plate Type, Manual Single Side Lock Release



4000 kg



- 单边解锁，使操作更为简便。
- 托臂自锁结构，上升时自动锁紧，下降到地面时自动解锁。
- 三节螺旋举升托垫可以轻松调节高度，更容易定位汽车支撑点，适合于更多的低底盘车辆。
- 油缸端头装有节流阀，即便油管突然爆裂，也能确保安全。
- 橡胶车门防撞垫作为标准配置，能有效的保护车门的损伤。
- 托臂防压脚作为CE标准配置。

- Manual lock release from single side.
- Automatic arm restraints, lifting arm automatically engages when lift is raised, and disengaged when lift lowered to the ground.
- 3-stage Screw-up pads suitable for low chassis vehicle and makes easy and quick service.
- Parachute valve that equipped in hydraulic joint ensures safety in case of oil hose broken.
- Door opening protection rubber as standard.
- Foot guard as CE standard.

细节说明 Details



- ① 24V低压控制系统
24V low voltage control system
- ② 加强型滑台/车门防撞橡胶垫
Strengthen carriage /Door opening protection rubber
- ③ 更合理的保险锁结构
More reasonable safety lock structure
- ④ 三节螺旋举升托垫
3-stage Screw-up pads
- ⑤ 节流阀
Parachute valve
- ⑥ 车门保护垫，链条防护装置
Door protection pad & chain guard

外形尺寸 Dimension

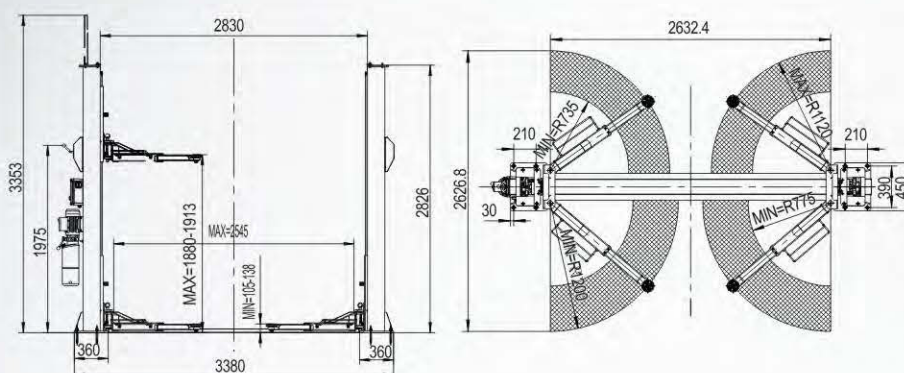

技术参数 Technical Data		
举升重量	Lifting capacity	4000kg
举升高度	Lifting height	1880mm
最低高度	Min. height	105mm
上升时间	Lifting time	<50s
电机功率	Motor power	2.2kw
安装宽度	Mount width	3380mm
立柱高度	Height of post	2824mm
立柱间距	Width between post	2830mm
下降时间	Lowering time	<40s
电压	Power supply	220v/380v

5500 kg



TJS19-21855EFC

5.5T 双柱双缸举升机/电动解锁
Electro-Hydraulic 2 Post Lift Floor Plate Type, Automatic Lock Release



- 电动解锁，只需按上升和下降按钮来实现操作。
- 托臂自锁结构，上升时自动锁紧，下降到地面时自动解锁。
- 三节螺旋举升托垫可以轻松调节高度，更容易定位汽车支撑点，适合于更多的低底盘车辆。
- 油缸端头装有节流阀，即便油管突然爆裂，也能确保安全。
- 橡胶车门防撞垫作为标准配置，能有效的保护车门的损伤。
- 链条防护帘作为CE标准配置。
- 托臂防压脚作为CE标准配置。

- Automatic lock release, just press Up and Down button to operate the lift.
- Automatic arm restraints, lifting arm automatically engages when lift is raised, and disengaged when lift lowered to the ground.
- 3-stage Screw-up pads suitable for low chassis vehicle and makes easy and quick service.
- Parachute valve that equipped in hydraulic joint ensures safety in case of oil hose broken.
- Door opening protection rubber as standard.
- Chain protection curtain as CE standard.
- Foot guard as CE standard.

细节说明 Details

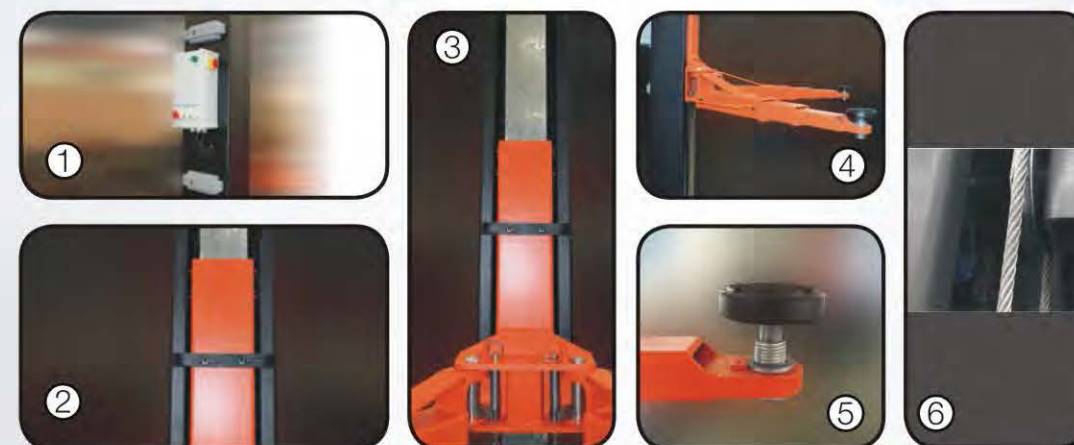

- ① 24V低压控制系统(电动解锁)
24V low voltage control system (Automatic lock release)
- ② 车门保护垫链条防护装置
Door protection pad & chain guard
- ③ 加强型滑台内置锁
Strengthen carriage Inner arm lock
- ④ 三节托臂带防压脚
3-stage telescopic arm foot protection
- ⑤ 三节螺旋举升托垫
3-stage screw-up lifting pad
- ⑥ 高度限位开关
Height limited switch

外形尺寸 Dimension

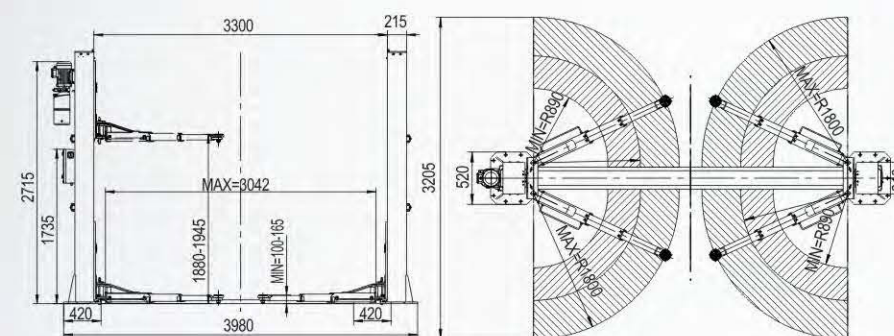

技术参数 Technical Data		
举升重量	Lifting capacity	5500kg
举升高度	Lifting height	1880mm
最低高度	Min. height	100mm
上升时间	Lifting time	55s
下降时间	Lowering time	50s
电机功率	Motor power	3kw
电压	Power supply	220v/380v 1/3phase

TJS19-31640M

4T 双柱龙门式液压举升机/手动双边解锁
Electro-Hydraulic 2 Post Lift Clear Floor Type, Manual Two Sides Lock Release



4000 kg

Manual

380 V

220 V

- 手动双边解锁。
- 托臂自锁结构，上升时自动锁紧，下降到地面时自动解锁。
- 二节螺旋举升托垫可以轻松调节高度，更容易定位汽车支撑点，适合于更多的低底盘车辆。
- 油缸端头装有节流阀，即便油管突然爆裂，也能确保安全。
- 橡胶车门防撞垫作为标准配置，能有效地保护车门的损伤。
- 高度限位开关有效地防止车顶损坏。
- 托臂防压脚作为CE标准配置。
- Manual two sides lock release.
- Automatic arm restraints, lifting arm automatically engages when lift is raised, and disengaged when lift lowered to the ground.
- 2-stage screw-up pads suitable for low chassis vehicle and makes easy and quick service.
- Parachute valve equipped in hydraulic joint ensures safety in case of oil hose broken.
- Door opening protection rubber as standard.
- Top limit switch on overhead bar prevent damaging vehicle roof.
- Foot guard as CE standard.

细节说明 Details



- ① 手动双边解锁，下置式解锁钢丝
Manual two sides lock release Underlying release cable
- ② 车门保护橡胶
Door Opening Protection Rubber
- ③ 内置式油管保护罩
Built-in pipeline protection cover
- ④ 24V高度限位开关
24V top limit switch
- ⑤ 二节螺旋举升托垫
2-stage Screw-up pads
- ⑥ 节流阀
Parachute valve

外形尺寸 Dimension

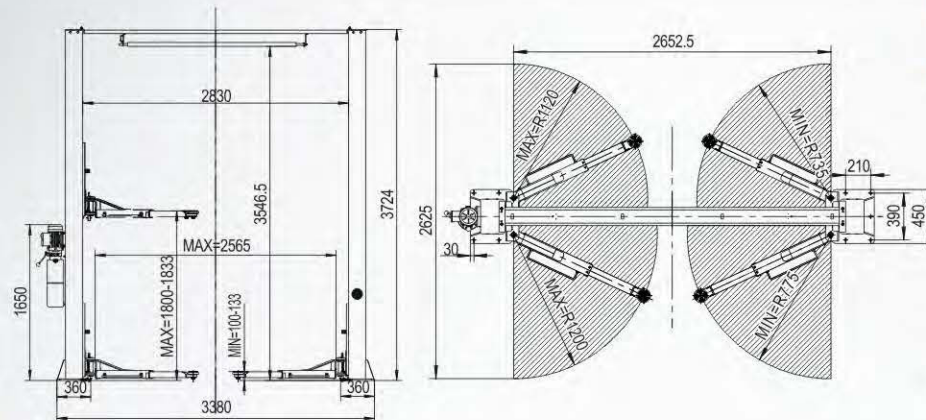

技术参数 Technical Data		
举升重量	Lifting capacity	4000kg
举升高度	Lifting height	1800mm
最低高度	Min. height	100mm
上升时间	Lifting time	<50s
电机功率	Motor power	2.2kw
安装宽度	Mount width	3380mm
立柱高度	Height of post	3724mm
立柱间距	Width between post	2830mm
下降时间	Lowering time	<40s
电压	Power supply	220v/240v/380v/415v

4000 kg

380 V

220 V

TJS19-31640MS

4T 双柱龙门式液压举升机/单边解锁
Electro-Hydraulic 2 Post Lift Clear Floor Plate Type, Manual Single Side Lock Release



- 单边解锁，使操作更为简便。
- 托臂自锁结构，上升时自动锁紧，下降到地面时自动解锁。
- 三节螺旋举升托垫可以轻松调节高度，更容易定位汽车支撑点，适合于更多的低底盘车辆。
- 油缸端头装有节流阀，即便油管突然爆裂，也能确保安全。
- 橡胶车门防撞垫作为标准配置，能有效地保护车门的损伤。
- 高度限位开关有效地防止车顶损坏。
- 油缸链条保护罩有效地保护油缸，确保设备外观整洁。
- 链条防护帘作为CE标准配置。
- 托臂防压脚作为CE标准配置。
- Manual lock release from single side, more convenient for operation.
- Automatic arm restraints, lifting arm automatically engages when lift is raised, and disengaged when lift lowered to the ground.
- 3-stage Screw-up pads suitable for low chassis vehicle and makes easy and quick service.
- Parachute valve that equipped in hydraulic joint ensures safety in case of oil hose broken.
- Door opening protection rubber as standard.
- Top limits switch on overhead bar prevent damaging vehicle roof.
- Chain guard protects the cylinder and makes lift in good appearance.
- Chain protection curtain as CE standard.
- Foot guard as CE standard.

细节说明 Details



- ① 手动单边解锁
Manual lock release from single side
- ② 高度限位开关
Top Limit Switch
- ③ 更合理的保险锁结构
More reasonable safety lock structure
- ④ 三节螺旋举升托垫
3-stage Screw-up pads
- ⑤ 橡胶车门防撞垫/高精度5度托臂锁齿
Door opening protection rubber/High-precision 5 degrees arm lock
- ⑥ 节流阀
Parachute valve

外形尺寸 Dimension

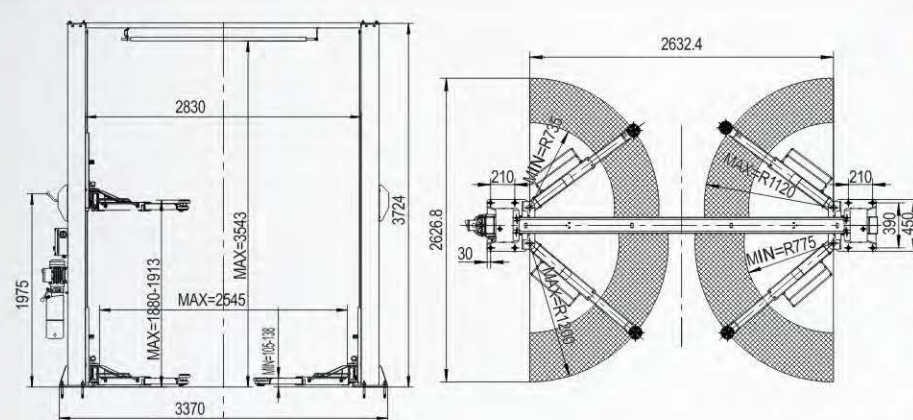

技术参数 Technical Data		
举升重量	Lifting capacity	4000kg
举升高度	Lifting height	1880mm
立柱高度	Height of post	3724mm
立柱间距	Width between post	2830mm
安装宽度	Mount width	3380mm
最低高度	Min. height	105mm
上升时间	Lifting time	<50s
下降时间	Lowering time	<40s
电机功率	Motor power	2.2kw
电压	Power supply	220v/240v/380v/415v

TJS19-31840EFC

4T 双柱龙门式液压举升机/电动解锁
Electro-Hydraulic 2 Post Lift Clear Floor Type, Automatic Lock Release



4000 kg

Electric

380 V

220 V

- 电动解锁，只需按上升/下降按钮来实现操作。
- 托臂自锁结构，上升时自动锁紧，下降到地面时自动解锁。
- 三节螺旋举升托垫可以轻松调节高度，更容易定位汽车支撑点，适合于更多的低底盘车辆。
- 油缸端头装有节流阀，即便油管突然爆裂，也能确保安全。
- 橡胶车门防撞垫作为标准配置，能有效地保护车门的损伤。
- 高度限位开关有效地防止车顶损坏。
- 油缸链条保护罩有效地保护油缸，确保设备外观整洁。
- 托臂防压脚作为CE标准配置。

- Automatic lock release, only press UP/DOWN button for operation.
- Automatic arm restraints, lifting arm automatically engages when lift is raised, and disengaged when lift lowered to the ground.
- 3-stage screw-up pads suitable for low chassis vehicle and makes easy and quick service.
- Parachute valve equipped in hydraulic joint ensures safety in case of oil hose broken.
- Door opening protection rubber as standard.
- Top limit switch on overhead bar prevent damaging vehicle roof.
- Chain guard protects the cylinder and makes lift in good appearance.
- Foot guard as CE standard.

细节说明 Details

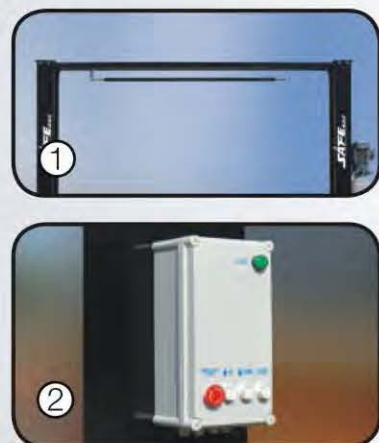

- ① 高度限位开关
Top limit switch
- ② 24V低压控制系统(电动解锁)
24V low voltage control system
(Automatic lock release)
- ③ 加强型滑台/车门防撞橡胶垫
Strengthen carriage/Door opening protection rubber
- ④ 三节螺旋举升托垫
3-stage Screw-up pads
- ⑤ 节流阀
Parachute valve
- ⑥ 车门保护垫链防护装置
Door protection pad & chain guard

外形尺寸 Dimension

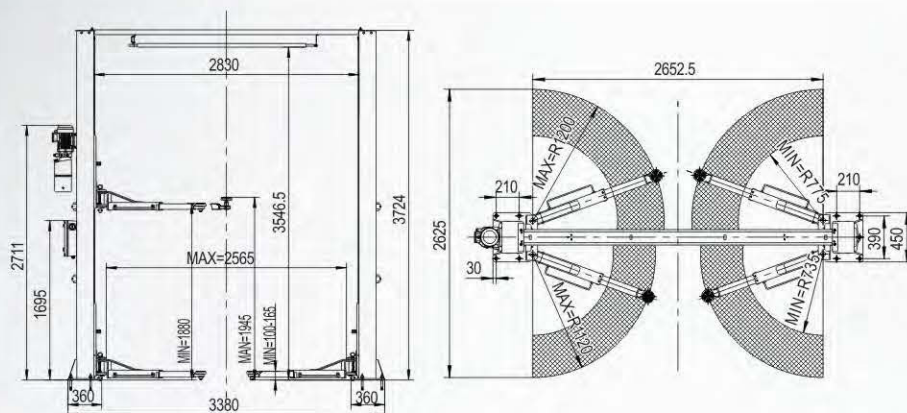

技术参数 Technical Data		
举升重量	Lifting capacity	4000kg
举升高度	Lifting height	1880mm
最低高度	Min. height	100mm
上升时间	Lifting time	<50s
电机功率	Motor power	2.2kw
安装宽度	Mount width	3380mm
立柱高度	Height of post	3724mm
立柱间距	Width between post	2830mm
下降时间	Lowering time	<40s
电压	Power supply	220v/240v/380v/415v

4500 kg

380 V

220 V

TJS19-31645MS

4.5T 双柱龙门式液压举升机/单边解锁
Electro-Hydraulic 2 Post Lift Clear Floor Plate Type,
Manual Single Side Lock Release



- 单边解锁，使操作更为简便。
- 托臂自锁结构，上升时自动锁紧，下降到地面时自动解锁。
- 三节螺旋举升托垫可以轻松调节高度，更容易定位汽车支撑点，适合于更多的低底盘车辆。
- 标配2+3节托臂。
- 油缸端头装有节流阀，即便油管突然爆裂，也能确保安全。
- 橡胶车门防撞垫作为标准配置，能有效地保护车门的损伤。
- 高度限位开关有效地防止车顶损坏。
- 油缸链条保护罩有效地保护油缸，确保设备外观整洁。
- 链条防护帘作为CE标准配置。
- 托臂防压脚作为CE标准配置。

- Manual lock release from single side, more convenient for operation.
- Automatic arm restraints, lifting arm automatically engages when lift is raised, and disengaged when lift lowered to the ground.
- 3-stage Screw-up pads suitable for low chassis vehicle and makes easy and quick service.
- 2+3 stage arm as standard.
- Parachute valve that equipped in hydraulic joint ensures safety in case of oil hose broken.
- Door opening protection rubber as standard.
- Top limits switch on overhead bar prevent damaging vehicle roof.
- Chain guard protects the cylinder and makes lift in good appearance.
- Chain protection curtain as CE standard.
- Foot guard as CE standard.

细节说明 Details

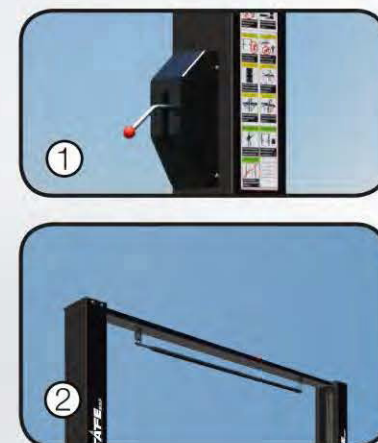

- ① 手动单边解锁
Manual lock release from single side
- ② 高度限位开关
Top Limit Switch
- ③ 更合理的保险锁结构
More reasonable safety lock structure
- ④ 三节螺旋举升托垫
3-stage Screw-up pads
- ⑤ 橡胶车门防撞垫/高精度5度托臂锁齿
Door opening protection rubber/high-precision 5 degrees arm lock
- ⑥ 节流阀
Parachute valve

外形尺寸 Dimension

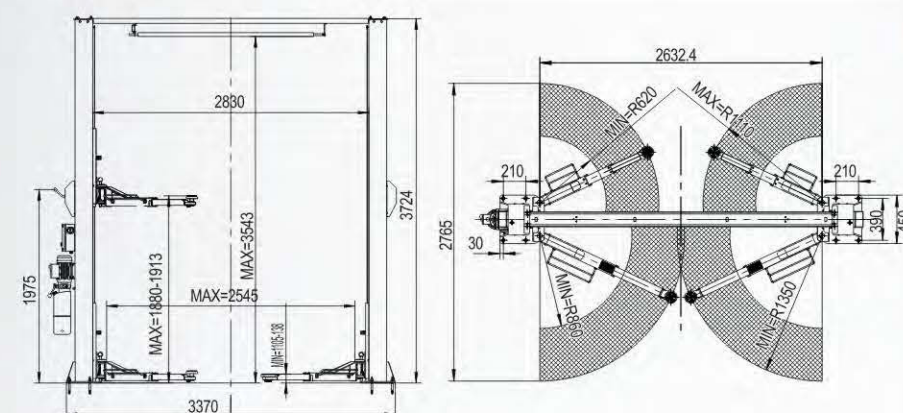

技术参数 Technical Data		
举升重量	Lifting capacity	4500kg
举升高度	Lifting height	1880mm
立柱高度	Height of post	3724mm
立柱间距	Width between post	2830mm
安装宽度	Mount width	3380mm
最低高度	Min. height	105mm
上升时间	Lifting time	<50s
下降时间	Lowering time	<40s
电机功率	Motor power	3kw
电压	Power supply	220v/240v/380v/415v

TJS19-31860EF

6T 双柱双缸举升机/电动解锁
Electro-Hydraulic 2 Post Lift Clear Floor Type, Automatic Lock Release



6000 kg



- 电动解锁，只需按上升和下降按钮来实现操作。
 - 托臂自锁结构，上升时自动锁紧，下降到地面时自动解锁。
 - 三节螺旋举升托垫可以轻松调节高度，更容易定位汽车支撑点，适合于更多的低底盘车辆。
 - 油缸端头装有节流阀，即便油管突然爆裂，也能确保安全。
 - 橡胶车门防撞垫作为标准配置，能有效的保护车门的损伤。
 - 链条防护帘作为CE标准配置。
 - 托臂防压脚作为CE标准配置。
- Automatic lock release, just press Up and Down button to operate the lift.
 - Automatic arm restraints, lifting arm automatically engages when lift is raised, and disengaged when lift lowered to the ground.
 - 3-stage Screw-up pads suitable for low chassis vehicle and makes easy and quick service.
 - Parachute valve that equipped in hydraulic joint ensures safety in case of oil hose broken.
 - Door opening protection rubber as standard.
 - Chain protection curtain as CE standard.
 - Foot guard as CE standard.

3000 kg



- 手动双边解锁。
 - 可移动式设计，操作更为简便。
 - 立柱间无底座，宽度可轻松调节。
 - 动力单元放置在移动推车上。
 - 最低高度85MM，适合更多低底盘车型。
 - 举升高度1505MM，总高2124MM。
- Manual two sides lock release.
 - Easy operation with movable column.
 - No base plate between columns, width to be easily adjustable.
 - Mobile trolley for power unit.
 - Lowest lifting height at 85mm for more low chassis vehicles.
 - Lifting height 1505mm, overall height 2040mm.

移动式双柱举升机
Two Post Mobile Lift



细节说明 Details



- ① 24V低压控制系统(电动解锁)
24v low voltage control system
- ② 车门保护垫链防护装置
Door protection pad & chain guard
- ③ 加强型滑台内置锁
Strengthen carriage Inner arm lock
- ④ 三节托臂带防压脚
3-stage telescopic arm Foot protection
- ⑤ 三节螺旋举升托垫
3-stage screw-up lifting pad
- ⑥ 高度限位开关
Height limited switch

外形尺寸 Dimension

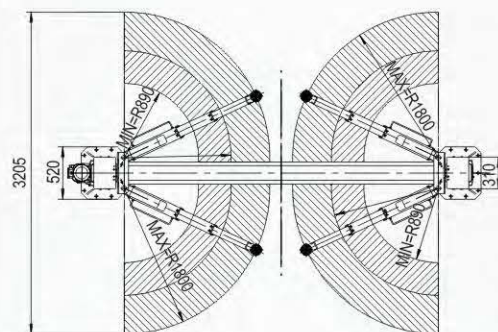
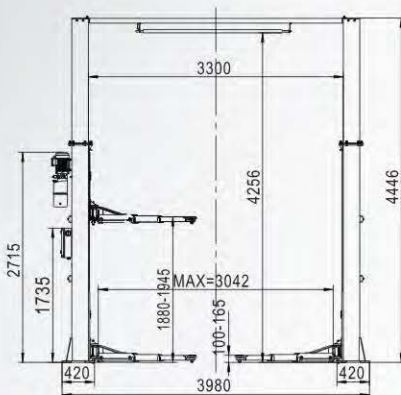

技术参数 Technical Data		
举升重量	Lifting capacity	6000kg
举升高度	Lifting height	1880mm
最低高度	Min. height	100mm
上升时间	Lifting time	<55s
电机功率	Motor power	3kw
安装宽度	Mount width	3980mm
立柱高度	Height of post	4446mm
立柱间距	Width between post	3300mm
下降时间	Lowering time	<50s
电压	Power supply	220V/380V 1/3phase

细节说明 Details



- ① 加强型滑台/车门保护橡胶
Strengthen carriage/door opening protection rubber
- ② 平衡阀
Balance valve
- ③ 动力单元移动推车
Mobile trolley for power unit
- ④ 移动轮组
Mobile wheel kit

外形尺寸 Dimension

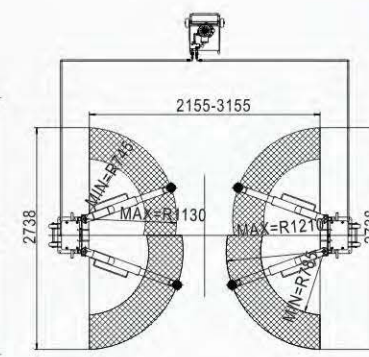
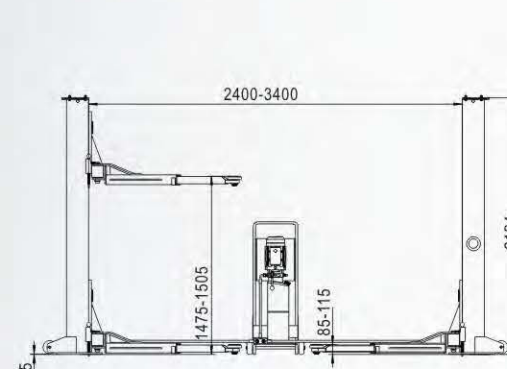

技术参数 Technical Data		
举升重量	Lifting capacity	3000kg
举升高度	Lifting height	1505mm
最低高度	Min. height	85mm
上升时间	Lifting time	35s
电机功率	Motor power	2.2kw
电压	Power supply	220V/380V

TJS19-51830LC

中位小剪举升机
Mid-rise scissors lift



3000 kg

Electric

380 V

220 V

- 地表安装，最低高度110mm。
- 机械锁装置上升时自动锁紧，下降时通过电动解锁，安全可靠。
- 所有的活动关节都装有自润轴承，定期保养会延长使用寿命。
- 可支撑引桥可以适用于更多长轴距车辆。
- 可选的移动组可以轻松移动举升机。
- 中间的连接杆确保稳定性和同步性能。
- 下降蜂鸣器作为CE标准的选配装置。

- Surface mounting at minimum height of 110mm.
- Mechanical safety lock engaged automatically, with electrical release when lowering.
- All pivot joints made with self-lubrication bushing ensure long service life.
- Optional mobile kit for easy moving.
- Extendable platform suitable for more long chassis vehicles.
- The middle steel bar connects two platform ensure stability and synchronization.
- Lowering beeper as optional for CE standard.

细节说明 Details

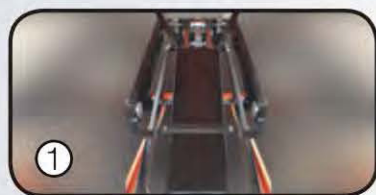

- ① 油缸保护罩
Cylinder protection cover
- ② 发泡橡胶垫
Rubber pad
- ③ 机械安全锁
Mechanical Safety lock
- ④ 加强延伸平台
Strengthen extended ramp
- ⑤ 移动组(可选)
Mobile kit(optional)
- ⑥ 蜂鸣器(可选)
Lowering beeper(optional)

外形尺寸 Dimension

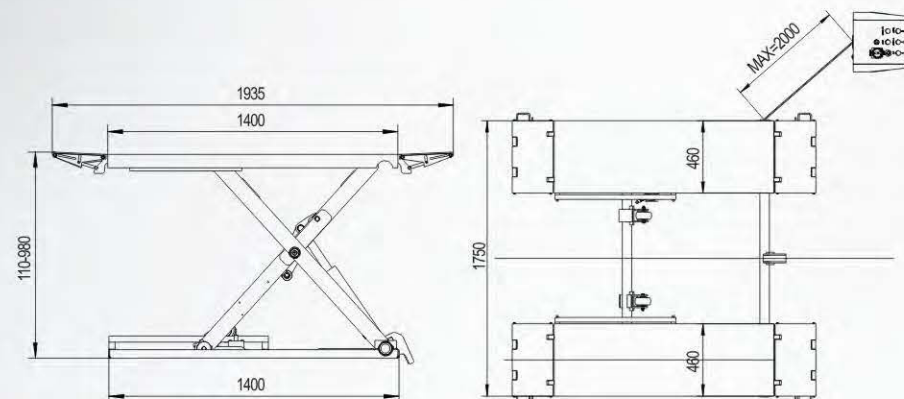

技术参数 Technical Data		
举升重量	Lifting capacity	3000kg
举升高度	Lifting height	1000mm
最低高度	Min. height	110mm
上升时间	Lifting time	20s
下降时间	Lowering time	20s
电机功率	Motor power	2.2kw
电压	Power supply	220v/380v 1/3phase

2800 kg

Manual

380 V

220 V

TJS19-52828C

移动式小剪举升机
Portable Scissor Lift



- SF-K2800是一款最理想的适合于轮胎快速服务的举升设备。
- 最低高度110mm。
- 机械锁装置上升时自动锁紧，下降时通过手动解锁，安全可靠。
- 螺旋举升托垫可以轻松调节高度，更容易定位汽车支撑点。
- 移动组与动力单元的完美结合可以轻松移动举升机。

- SF-K2800 is a ideal lifting equipment for tire changing and quick service.
- Minimum height of 110mm.
- Mechanical safety lock engaged automatically, with manual release when lowering.
- Screw-up pads makes easy and quick service.
- The mobile kits is perfectly combined with power , unit that makes the lift easily moved.

细节说明 Details

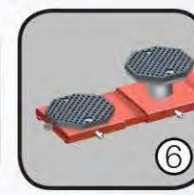

- ① 可移动举升托臂
Portable lifting arm
- ② 机械保险装置
Mechanical safety lock
- ③ 移动组
Mobile kit
- ④ 油管装置
Hose connection
- ⑤ 滑动轮
Sliding wheel
- ⑥ 标准节套式托盘
Standard section pad
- ⑦ 24V控制盒(可选)
24V Control box (optional)

外形尺寸 Dimension

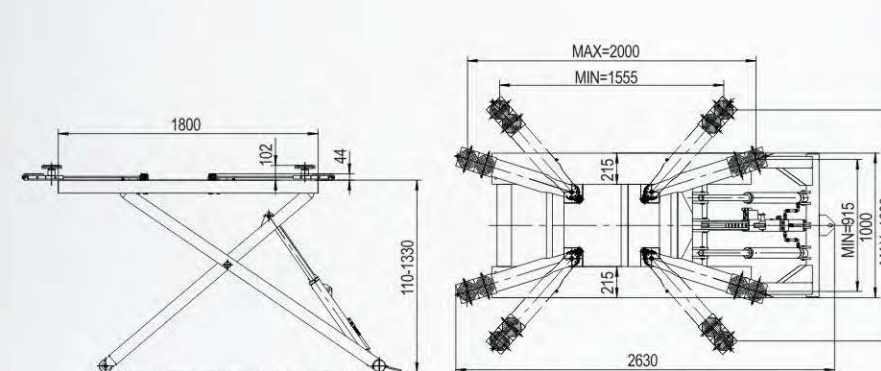

技术参数 Technical Data		
举升重量	Lifting capacity	2800kg
举升高度	Lifting height	1330mm
最低高度	Min. height	110mm
上升时间	Lifting time	30s
长度	Length	2550mm
宽度	Width	1000mm
电压	Power supply	220v/240v/380v/415v

TJS19-62835C

藏地式小剪升降机
In-ground Scissor Lift



3500 kg
380 V
220 V

- 藏地式安装，节省空间。
- 机械锁装置上升时自动锁紧，下降时通过气动解锁，安全可靠。
- 可延长的举升平台可以适用于更多长轴距车辆。
- 所有的活动关节都装有自润轴承，定期保养会延长使用寿命。
- 双抽拉举升平台为可选配置。

- In-ground mounting, saving space.
- Mechanical safety lock engaged automatically, with pneumatic release when lowering.
- Extendable platform suitable for more long chassis vehicles.
- All pivot joints made with self-lubrication bushing ensure long service life.
- Double extendable platform as option.

细节说明 Details



- ① 机械锁装置
Mechanical safety lock
- ② 可延长的举升平台
Extendable platform
- ③ 气动解锁
Pneumatic release
- ④ 活动关节都装有自润轴承
Joints with self-lubrication bushing
- ⑤ 进口球阀
Imported valve
- ⑥ 光电开关(可选)
Photocell switch(Optional)

外形尺寸 Dimension

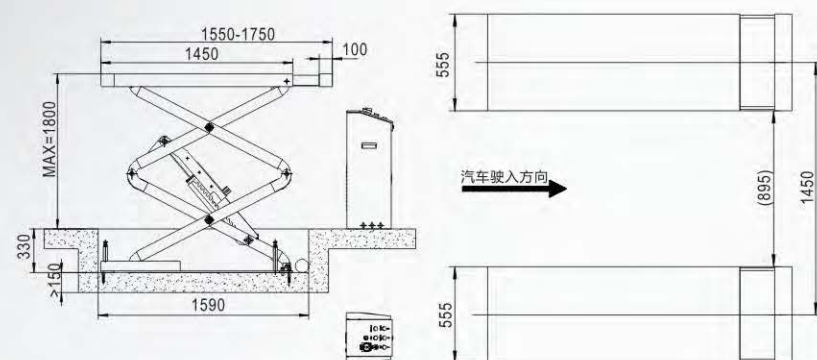

技术参数 Technical Data		
举升重量	Lifting capacity	3500kg
举升高度	Lifting height	1800mm
台面长度	Table length	1550-1750mm
台面宽度	Table width	555mm
上升时间	Lifting time	<50s
电机功率	Motor power	2.2kw
电压	Power supply	220v/380v

3000 kg
380 V
220 V

TJS19-61830C

超薄小剪升降机
Low Profile Scissor Lift, Surface Mounting



- 地表安装，最低高度110mm。
- 机械装置上升时自动锁紧，下降时通过气动解锁，安全可靠。
- 可支撑引桥可以适用于更多长轴距车辆。
- 所有的活动关节都装有自润轴承，定期保养会延长使用寿命。
- 下降蜂鸣器作为CE选配装置。
- 自动调平液压系统为选配。

- Surface mounting, Minimum height of 110mm.
- Mechanical safety lock engaged automatically, with pneumatic release when lowering.
- Extendable platform suitable for more long chassis vehicles.
- All pivot joints made with self-lubrication bushing ensure long service life.
- Lowering beeper as optional for CE standard.
- Automatically synchronization system as optional.

细节说明 Details



- ① 最低高度110mm
Min height at 110mm
- ② 机械锁装置
Mechanical safety lock
- ③ 可延长的举升平台
Extendable platform
- ④ 油缸保护罩
Cylinder guard
- ⑤ 活动关节都装有自润轴承
Joints with self-lubrication bushing
- ⑥ 进口球阀
Imported valve

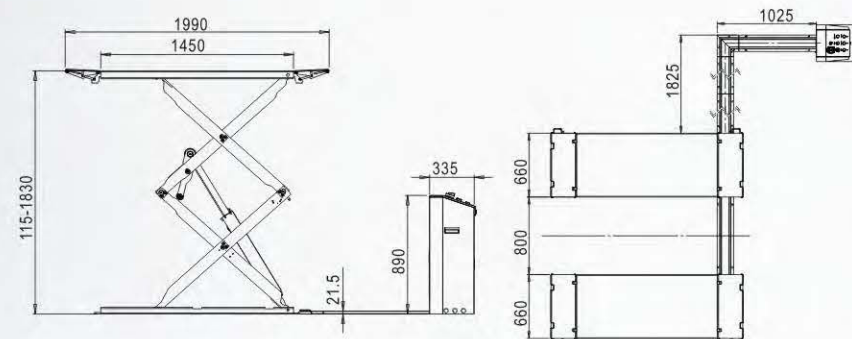

技术参数 Technical Data		
举升重量	Lifting capacity	3000kg
举升高度	Lifting height	1830mm
最低高度	Min. height	110mm
台面长度	Table length	1450-1990mm
台面宽度	Table width	660mm
上升时间	Lifting time	<50s
电机功率	Motor power	2.2kw
电压	Power supply	220v/380v

TJS19-52840C

4T 子母式大剪升降机
Two Level Alignment Scissor Lift, In-Ground Mounting



4000 kg
380 V
220 V

- 藏地式安装或选配上车引桥直接安装在地面。
- 可调的转角盘位置和侧滑板为四轮定位专用配置。
- 机械锁装置上升时自动锁紧，下降时通过气动解锁，安全可靠。
- 所有的活动关节都装有自润轴承，定期保养会延长使用寿命。
- 下降蜂鸣器作为CE标准配置。
- In-ground mounting, or surface mounting with the optional entering ramp.
- Adjustable turn plate position and sliding plate specially for 4 wheel Alignment purpose.
- Mechanical safety lock engaged automatically, with pneumatic release when lowering.
- All pivot joints made with self-lubrication bushing ensure long service life.
- Lowering beeper as optional for CE standard.

细节说明 Details



- ① 二次举升小车
Rolling Jack
- ② 机械安全锁
Mechanical safety lock
- ③ 上车板
Entering Ramp
- ④ 更长的平台用于定位
Long platform for alignment
- ⑤ 气阀解锁
Pneumatic release
- ⑥ 转角盘(可选)
Turn plate(optional)

外形尺寸 Dimension

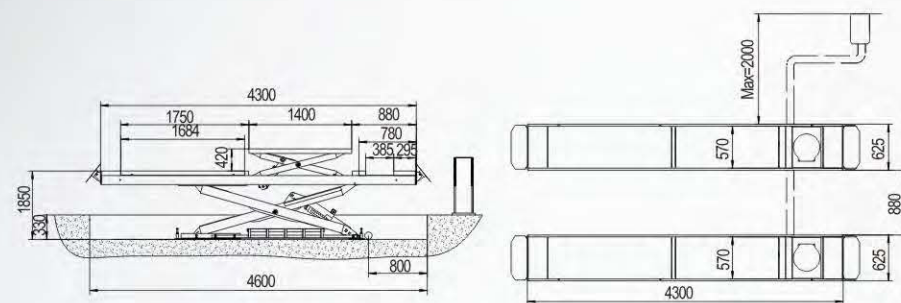

技术参数 Technical Data		
举升重量	Lifting capacity	4000kg
举升高度	Lifting height	1850+420mm
最低高度	Min. height	330mm
跑道长度	Platform length	4300mm
上升时间	Lifting time	50s
下降时间	Lowering time	45s
电机功率	Motor power	2.2kw
电压	Power supply	220V/380v, 1/3phase

2500 kg
Manual
380 V
220 V

TJS19-12828C

2.5T 移动单柱液压升降机/手动解锁
Mobile Single Post Lift, Manual Lock Release



- 移动式设计能有效地节省空间，举升机可以轻松移动到任意位置进行维修。
- 单柱结构给予车门更多空间。
- 手动解锁。
- 24V控制系统符合CE标准。
- 采用85MM高度的底座，将最低举升高度控制在100MM。
- 三节螺旋举升托垫可以轻松调节高度，更容易定位汽车支撑点，适合于更多的低底盘和SUV车辆。
- 24V高度限位开关能有效保护油缸，延长使用寿命。
- 油缸链条保护罩有效地保护油缸，确保设备外观整洁。
- 车门防撞垫。
- CE认证。
- Mobile design is ideal choice for tight space, easily moving as a pallet.
- One post structure gives more free access to vehicle door.
- Manual lock release system.
- 24V control system compliance with CE standard.
- 85mm low base frame with min. height <110mm.
- 3-stage Screw-up pads makes easy and quick service for low chassis vehicles as well as SUVs.
- 24V top limited switch protects the cylinder in long service lift.
- Chain guard protects the cylinder and makes lift in good appearance.
- Door protection pads.
- CE-Certificate.

细节说明 Details

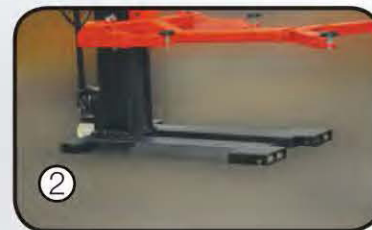

- ① 可调节旋转支臂
Telescopic & Swivel arms
- ② 80mm厚度底板
80mm strong base frame
- ③ 24V控制盒
24V Control box
- ④ 移动组
Mobile wheel kit
- ⑤ 三节螺旋举升托垫
3-stage Screw-up Pads
- ⑥ 车门保护垫链防护装置
Door protection pad & chain guard

外形尺寸 Dimension

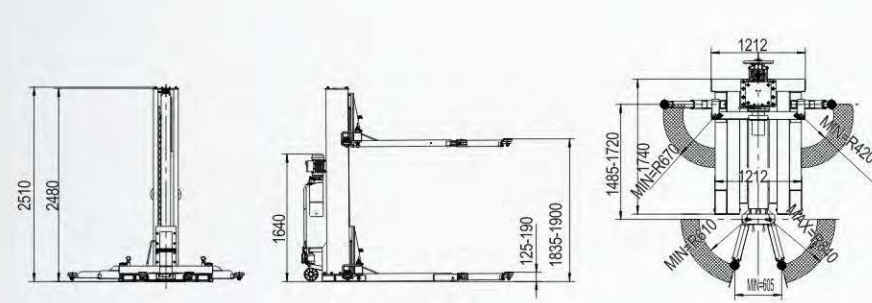

技术参数 Technical Data		
举升重量	Lifting capacity	2500kg
举升高度	Lifting height	1850mm
最低高度	Min. height	125mm
上升时间	Lifting time	35s
下降时间	Lowering time	30s
电机功率	Motor power	2.2kw
电压	Power supply	220v/380v

TJS19-12225ELC

2.5T 移动单柱液压升降机/电动解锁
Mobile Single Post Lift, Automatic Lock Release



2500 kg

- 移动式设计能有效地节省空间，举升机可以轻松移动到任意位置进行维修。
- 单柱结构给予车门更多空间。
- 采用85MM高度的底座，将最低举升高度控制在100MM。
- 三节螺旋举升托垫可以轻松调节高度，更容易定位汽车支撑点，适合于更多的低底盘车。
- 24V高度限位开关能有效保护油缸，延长使用寿命。
- 油缸保护罩为标准配置。
- 电控箱。
- 车门防撞垫。
- 节流阀。
- CE认证。

- Mobile design is ideal choice for tight space, easily moving as a pallet .
- One post structure gives more free access to vehicle door.
- 85mm low base frame with min. height <110mm.
- 3-stage Screw-up pads makes easy and quick service for low chassis vehicles as well as SUVs.
- 24V top limited switch protects the cylinder in long service lift.
- Column chain guard.
- Control Box.
- Door protection pads.
- Parachute valve .
- CE-Certificate.

细节说明 Details



- ① 可调节旋转支臂
Telescopic & Swivel arms
- ② 80mm厚度底板
80mm strong base frame
- ③ 24V低压控制系统
24v low voltage control system
- ④ 移动组
Mobile wheel kit
- ⑤ 三节螺旋举升托垫
3-stage Screw-up Pads
- ⑥ 车门保护垫链防护装置
Door protection pad & chain guard

外形尺寸 Dimension

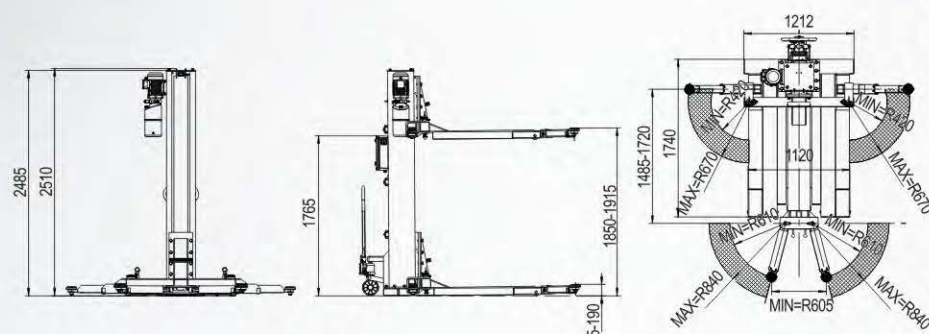

技术参数 Technical Data

举升重量	Lifting capacity	2500kg
举升高度	Lifting height	1850mm
最低高度	Min. height	125mm
上升时间	Lifting time	35s
下降时间	Lowering time	30s
电机功率	Motor power	2.2kw
电压	Power supply	220v/380v

4000/5000 kg

TJS19-41840APC/41850APC

4T/5T四轮定位专用四柱举升机
Electro-Hydraulic 4 Post Lift For Wheel Alignment



- 手动单边解锁。
- 两个平台间的宽度可以调节以适应于不同轴距的车辆。
- 每个立柱内都安装机械保险装置。
- 可调的转角盘位置和侧滑板为四轮定位专用配置。
- 前后挡板在车辆维修时能有效地起到保护作用。
- 二次举升小车作为标准配置。
- 进口的三通阀极好的完成了举升机和小车间的转换操作。

- Single point manual lock release.
- Width between two platforms is adjustable to be fit for different vehicle.
- Mechanical safety lock installed in each column.
- Adjustable turnplate position and sliding plate specially for 4 wheel Alignment purpose.
- Front and rear stop plate well protect the vehicle during repairing.
- Center rolling jack including as standard.
- Imported three-way valve perfectly shift the operation between lift and rolling jack.

细节说明 Details

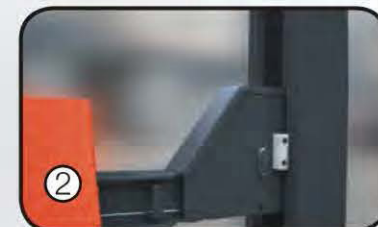

- ① 可调节二次举升小车
Length adjustable rolling jack
- ② 安全锁装置
Safety Lock Device
- ③ 上车板
Entering ramp
- ④ 侧滑板用于定位
Sliding plate for alignment
- ⑤ 24V低压控制系统(可选)
24V low voltage control system(optional)
- ⑥ 转角盘(可选)
Turn plate(optional)

外形尺寸 Dimension

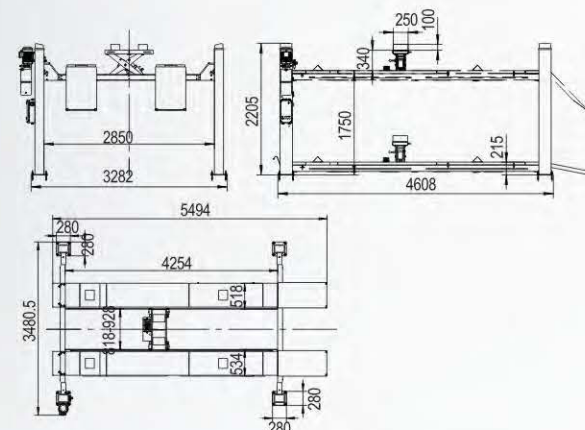

技术参数 Technical Data

型号	Model	4SF-4000B	4SF-5000B
最低高度	Min. height	215mm	215mm
举升高度	Lifting capacity	1750mm	1750mm
车道长度	Runway length	4250mm	5000mm
车道内宽度	Runway width	918~1118mm	918~1118mm
单车道宽度	Unilateral runway width	480mm	480mm
最大通车宽度	Max. through width	2850mm	2850mm
上升时间	Lifting time	70s	70s
电机功率	Motor power	2.2kw	2.2kw
电压	Power supply	220/240/380V/415V	220/240/380V/415V