

ROOF RAILS

ROOF RAILS

ROOF RAILS

ROOF RAILS

ELEGANCE

ROOF RAILS

As the name indicates these roof rails provide practicality without spoiling your vehicle's elegant look. It is available in two colors, garnishing its reliable and robust aluminum bars through flawless anodizing.

Elegance roof rails are precisely made to fit on your vehicle's roof fixing points, sparing you the burden of drilling holes on your roof. Feet made of "heavy-duty" plastic and rubber endings ensure a maximum fixation and zero leaks on rainy days.

Polyanide 6
GF30

EPDM

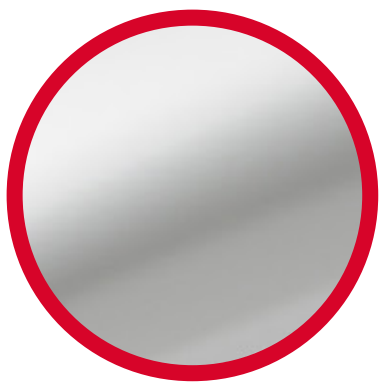

Anodized
Aluminum



TUV Approved



Carrying Capacity



Two Color Options

OMTEC AUTO ACCESSORIES

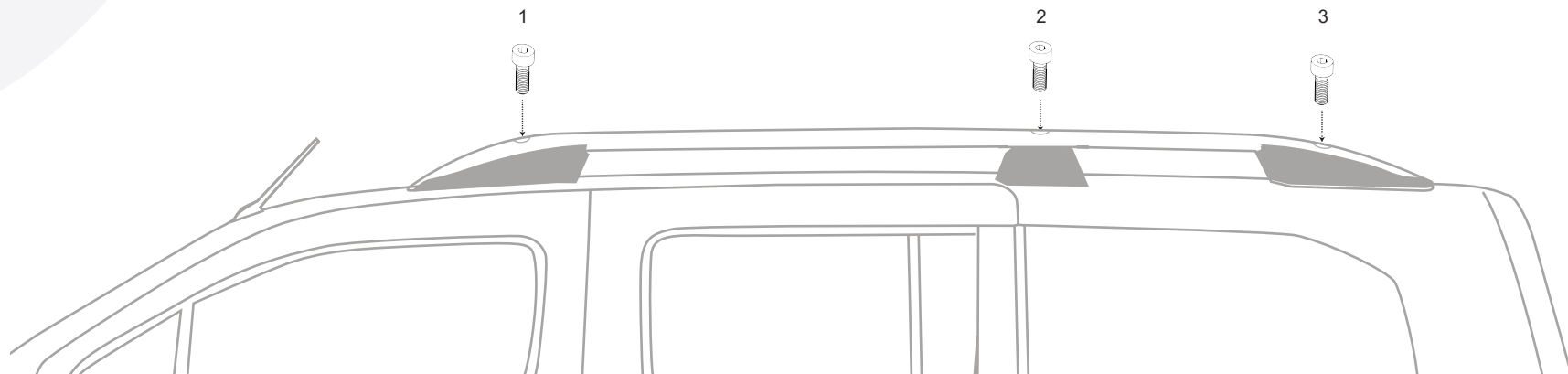
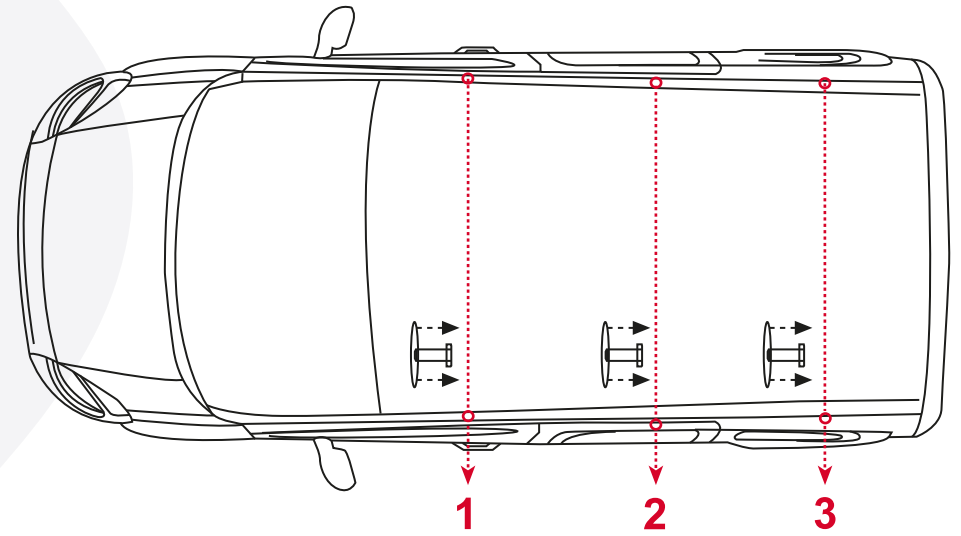

The roof rails are fitted using three fixing points on each side. Bolts and other fitting pieces are provided in the product box in addition to detailed mounting instructions.

SPORT

ROOF RAILS

Our Sport roof rails come in a different rear design, gently marrying the aerodynamics of your car. It is available in two colors, garnishing its reliable and robust aluminum bars through flawless anodizing.

Sport roof rails are precisely made to fit on your vehicle's roof fixing points, sparing you the burden of drilling holes on your roof. Feet made of "heavy-duty" plastic and rubber endings ensure a maximum fixation and zero leaks on rainy days.

Polyamide 6
GF30

EPDM

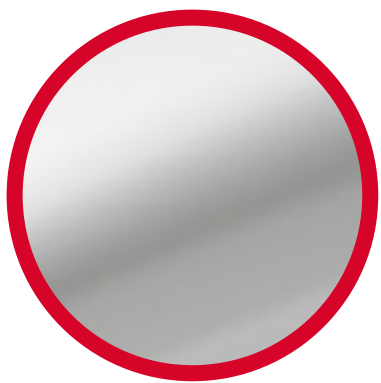

Anodized
Aluminum



TUV Approved



Carrying Capacity



Two Color Options

OMTEC AUTO ACCESSORIES

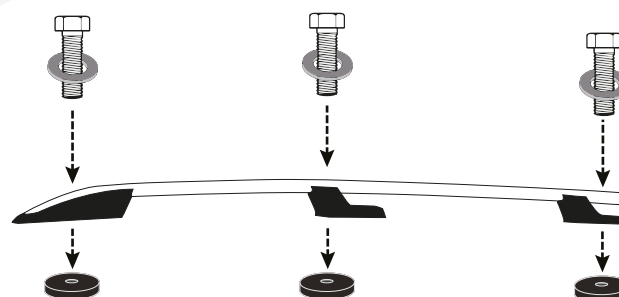
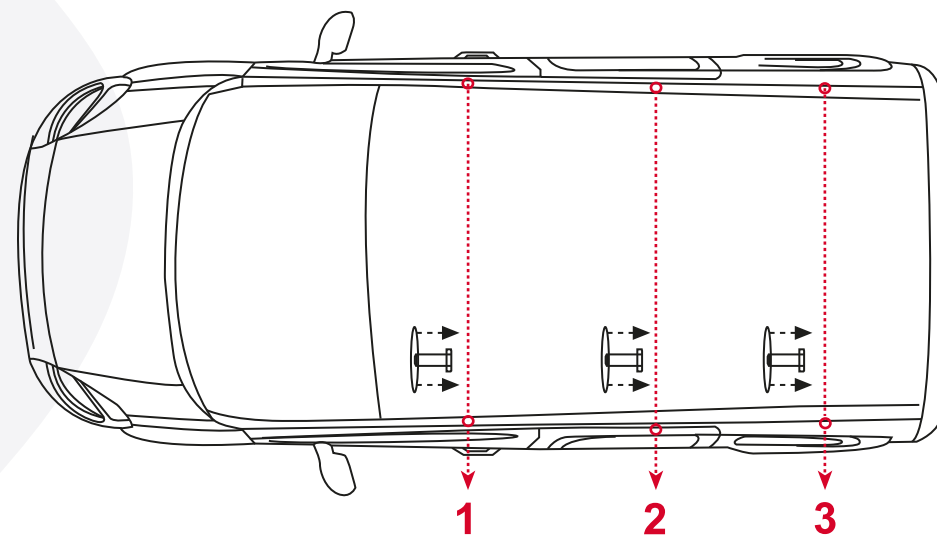
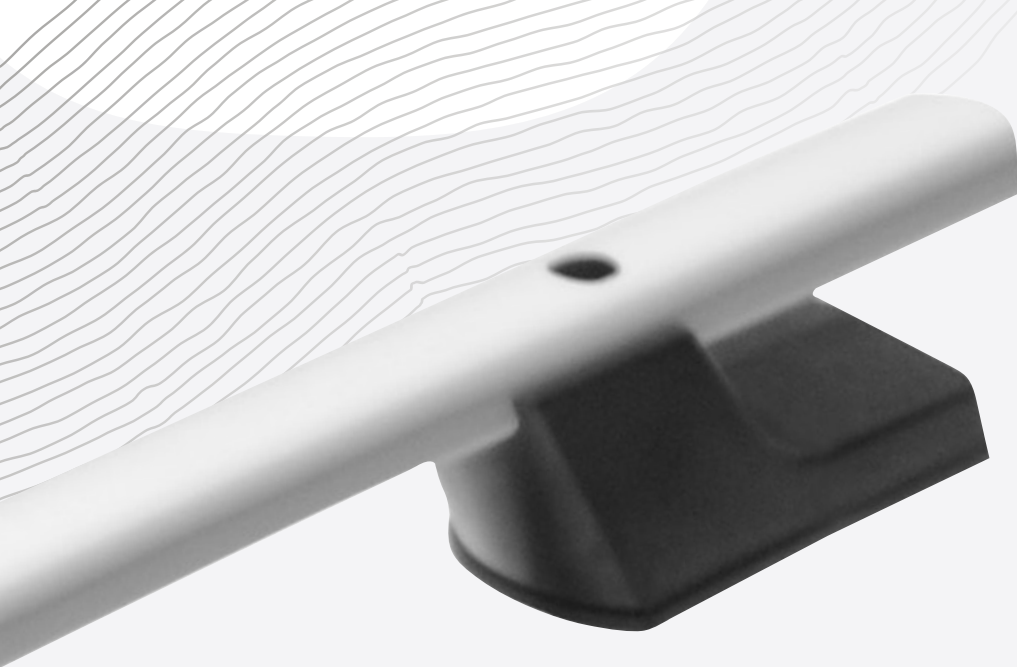

The roof rails are installed using three fixing points on each side. Bolts and other fitting pieces are provided in the product box in addition to detailed mounting instructions.

SOLID ROOF RAILS

Solid roof rails come with a unique design. The immaculate aluminium bar perfectly meets the heavy-duty plastic feet on both ends to create a mixture of style and practicability on your car. They are available in the Silver and Black coating.

Solid roof rails are precisely made to fit on your vehicle's roof fixing points, sparing you the burden of drilling holes on your roof. Feet made of "heavy-duty" plastic and rubber endings ensure a maximum fixation and zero leaks on rainy days.

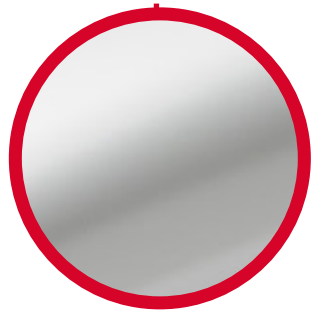

Anodized
Aluminum

Polyamide 6
GF30

EPDM



Carrying Capacity



Two Color Options

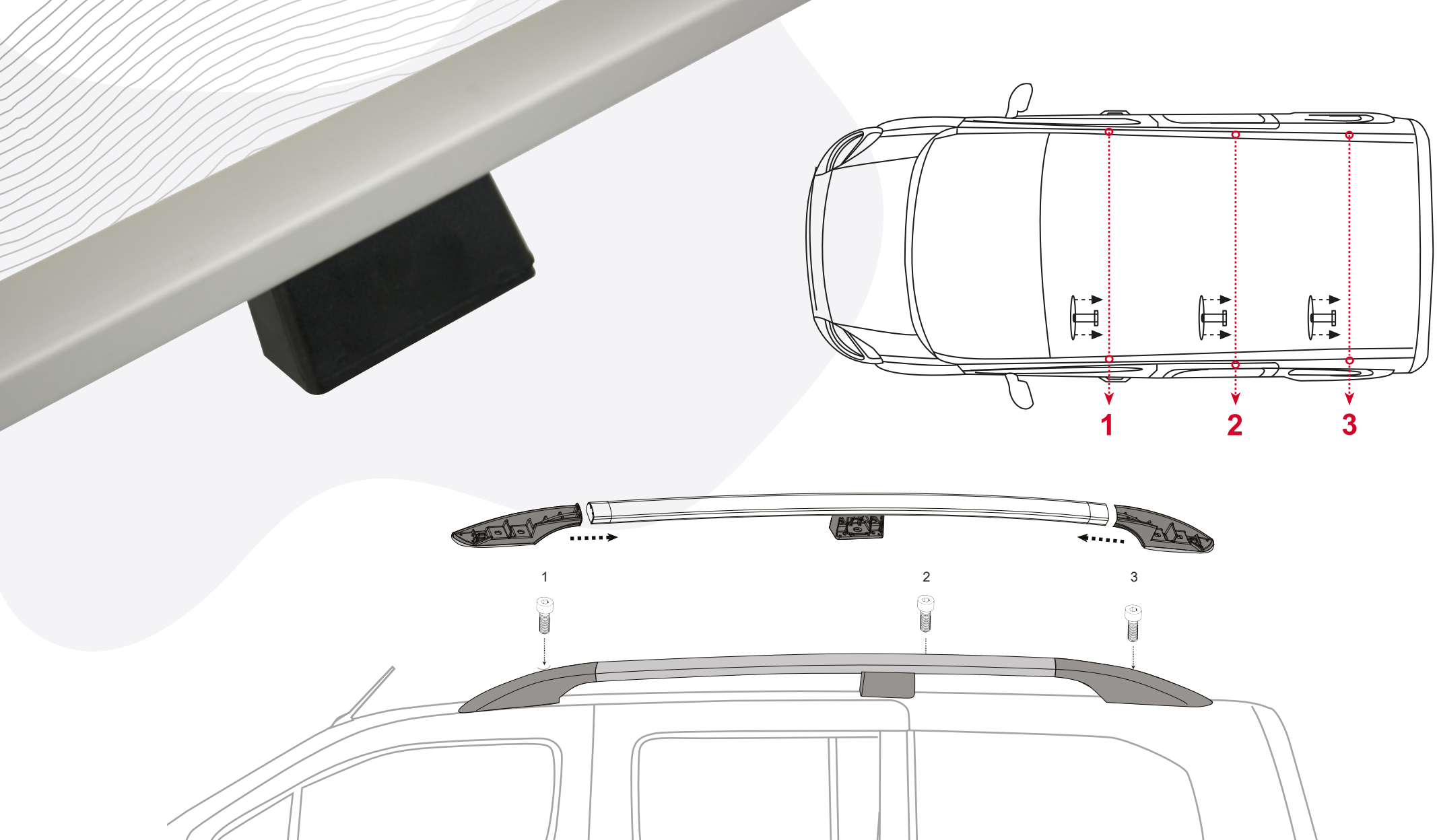

The roof rails are installed using three fixing points on each side. Bolts and other fitting pieces are provided in the product box in addition to detailed mounting instructions. A Stick-on version is available for the vehicles without fixing points.

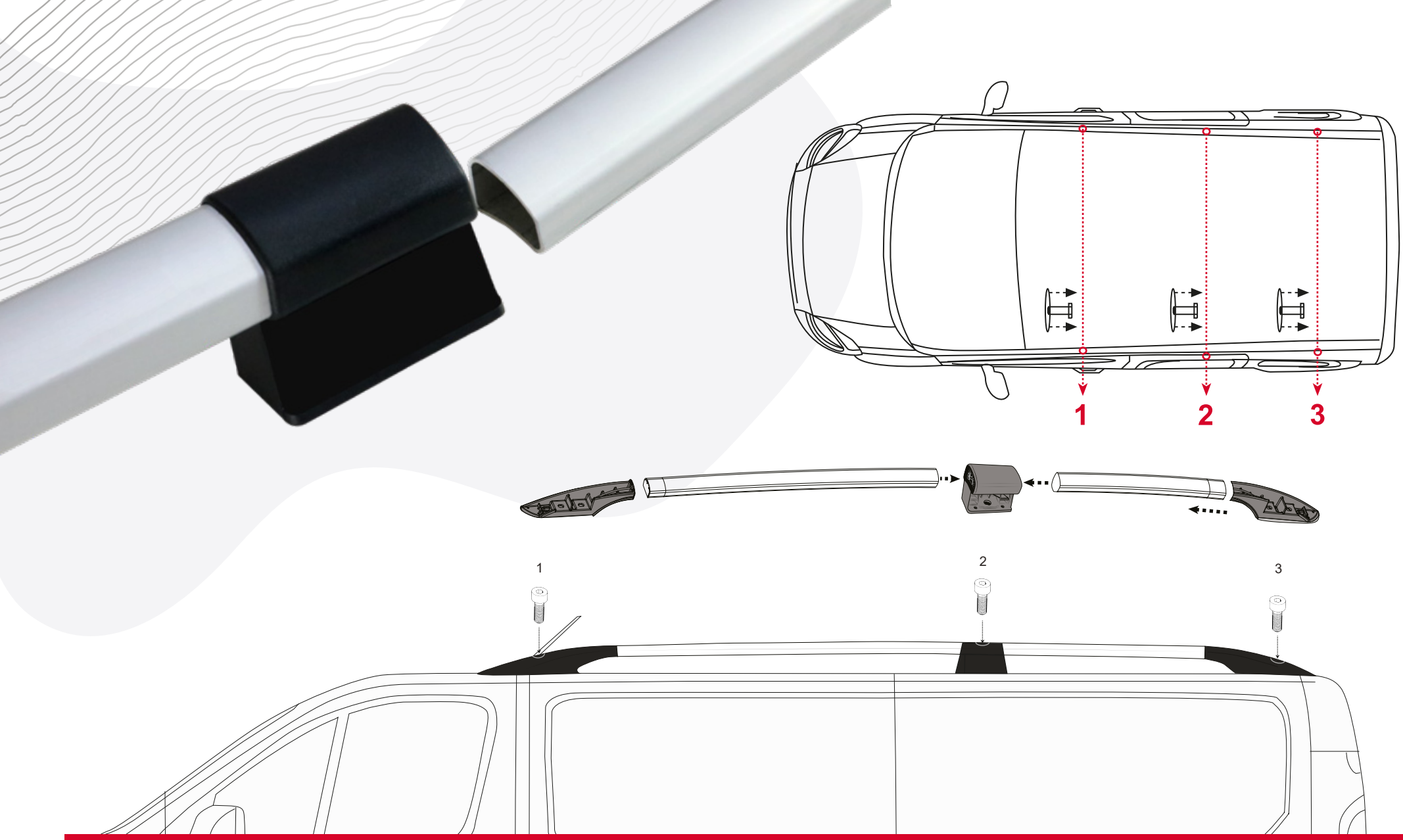



To make the product box smaller, we created a dividable version of the Solid roof rail. The packaging is nearly half the length of the rails, saving up mainly on individual shipping costs.

CARRYTEC

By OMTEC AUTO ACCESSORIES



 [omtecautoaccessories](https://www.instagram.com/omtecautoaccessories)

 [omtecautoaccessories](https://www.facebook.com/omtecautoaccessories)

 [OmttecAutomotive](https://twitter.com/OmttecAutomotive)

 [OMTEC Auto Accessories Co.](https://www.youtube.com/OMTEC-Auto-Accessories-Co)

 www.omtec.com.tr