

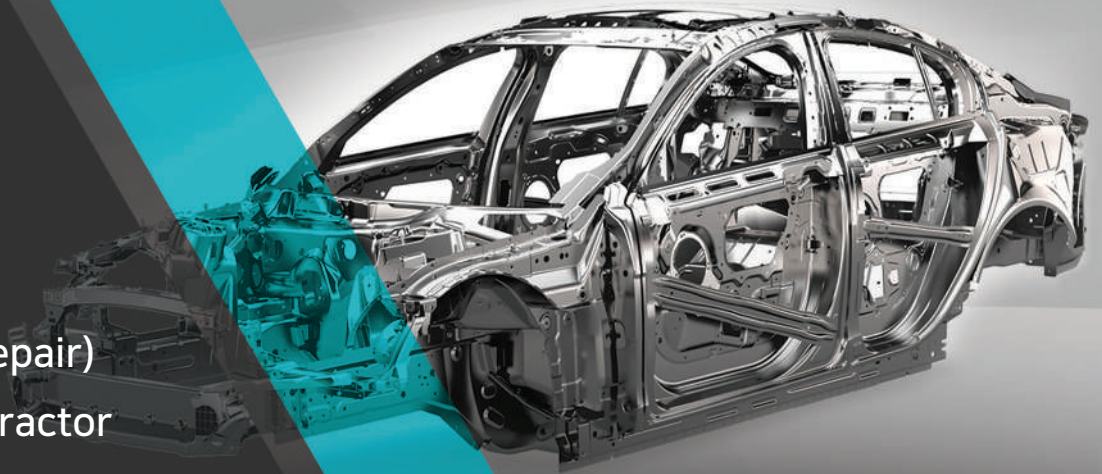

AutonomousTM

- About Company
- EV Balancing (Repair)
- Torch-Fume Extractor
- Gun-Washer



www.autonomousskr.com

AutonomousTM

AUTONOMOUS was established on 1972.

Our founder has a goal to localize the automotive repair machines and tools in the South Korea.

We manufacture spray booth, inspection machines, floor system, clamp and everything related to the car repair. And now we are producing a future with electric vehicle.

Spray booth



Inspection machines

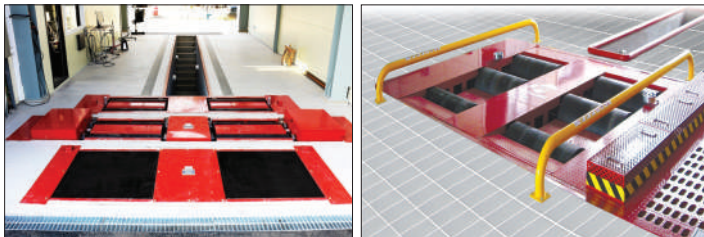

Body repair



Imported products



Snap-on

3M

RUPES[®]

Like 90 GO FAST[®]

FESTOOL

CAR-O-LINER[®]

Bishamon[®]

SCANGRIP[®]
INNOVATION FROM DENMARK

PRO SPOT
QUALITY WELDING SYSTEMS

EV Battery Balancer (Repair)



Fast and constant with precision

- High current (115A) reduces balancing time
- Simultaneously balancing the module and cell voltage with precise control
- Up to 32cell simultaneous balancing : option (default 8 cells)
(Available for simultaneous balancing of two modules and various models)
- Battery module voltage deviation : 3 decimal places control (0.000V)
- Voltage deviation for each cell : 3 decimal places control (0.000V)
- Voltage drop voltage deviation : 3 decimal places control (0.000V)
- Voltage measurement function for ev battery diagnosis (multi tester)
- EV battery polarity connection mistake protection function

Category	Detail
Model	BRS-3000
Country of Origin	SOUTH KOREA
Size	450(L) x 825(W) x 690(H) (32.5inch / 26.3inch)
Max Charge / Discharge current	115A
Max Charge / Discharge Voltage	250V-12A / 150V-20A / 60V-50A / 25V-110A
Maximum charge / discharge power	3KW
Voltage Measure (Accuracy)	0.001Vdc (3~4mV)
Maximum cell deviation between modules	0.009Vdc
Communication interface	LAN, Wi-Fi, Ethernet, USB, VNC Server Control, Remote Control, Screen Share System
Display & Software	Industrial 12" Touch Panel & PC (Window10)
Charge / Discharge balancing mode	CC, CV, BSM (Common)
Input Voltage	220V, 23A / 110V, 47A (Free Voltage)



Registered at



HYUNDAI



GENESIS

Torch-Fume Extractor



- Triple filter system
- Demister filter / Carbon filter x2
- Special fume extractor installed at torch
- Easy to change filter
(Can be replace by automotive carbon filter)
- Easy installation and easy to use
- Can be applied all kinds of mig welder after the modification
- Welder can be operate without extractor on

Category	Detail
Model	AC2000H
Country of Origin	SOUTH KOREA
Size	440(L) x 265(W) x 435(H)
Color	DARK GRAY
Power	380V or 220V / 60Hz or 50Hz / 1.5Kw
Air Supply	Max 10 m/s
Filter Size / Spec.	CARBON MAT Filter : 220 x 210 x 40T / DEMISTER Filter : 220 x 205 x 40T



Registered at



HYUNDAI



GENESIS

Gun-Washer



- Can be only waterborne / solvent washer
- Narrow so easy to install (one unit 55cm/1.8ft)
- Made by stainless (Anti rust)
- Compatible with most of spray gun in the market
- Applied safety valve
- Applied rinse function
- Applied washer timer (30min)
- Minimize use of water
- Easy and quick cleaning

Category	Detail
Model	GW100 & GW300
Country of Origin	SOUTH KOREA
Size	550(D) x 550(W) x 1,600(H)
Color	DARK GRAY
Type	GW100 (Solvent) GW300 (Waterborne)
Require Air	6-10 BAR
Material	Stainless

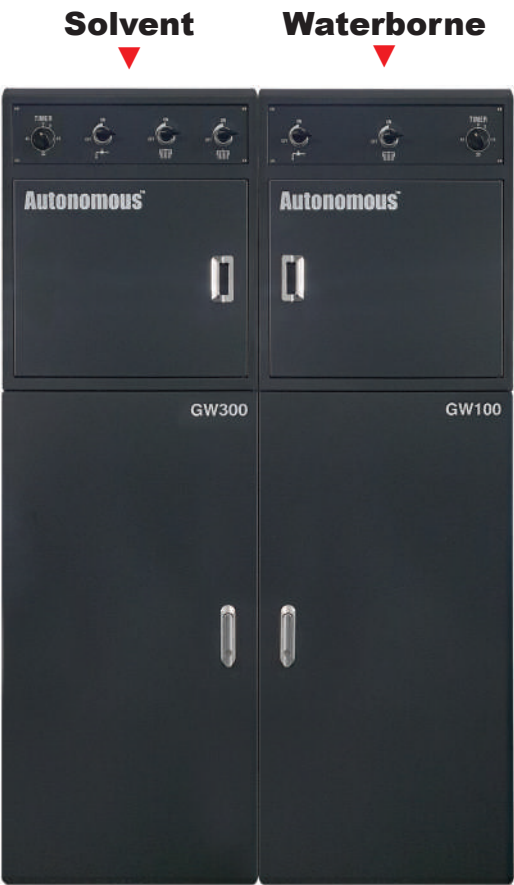

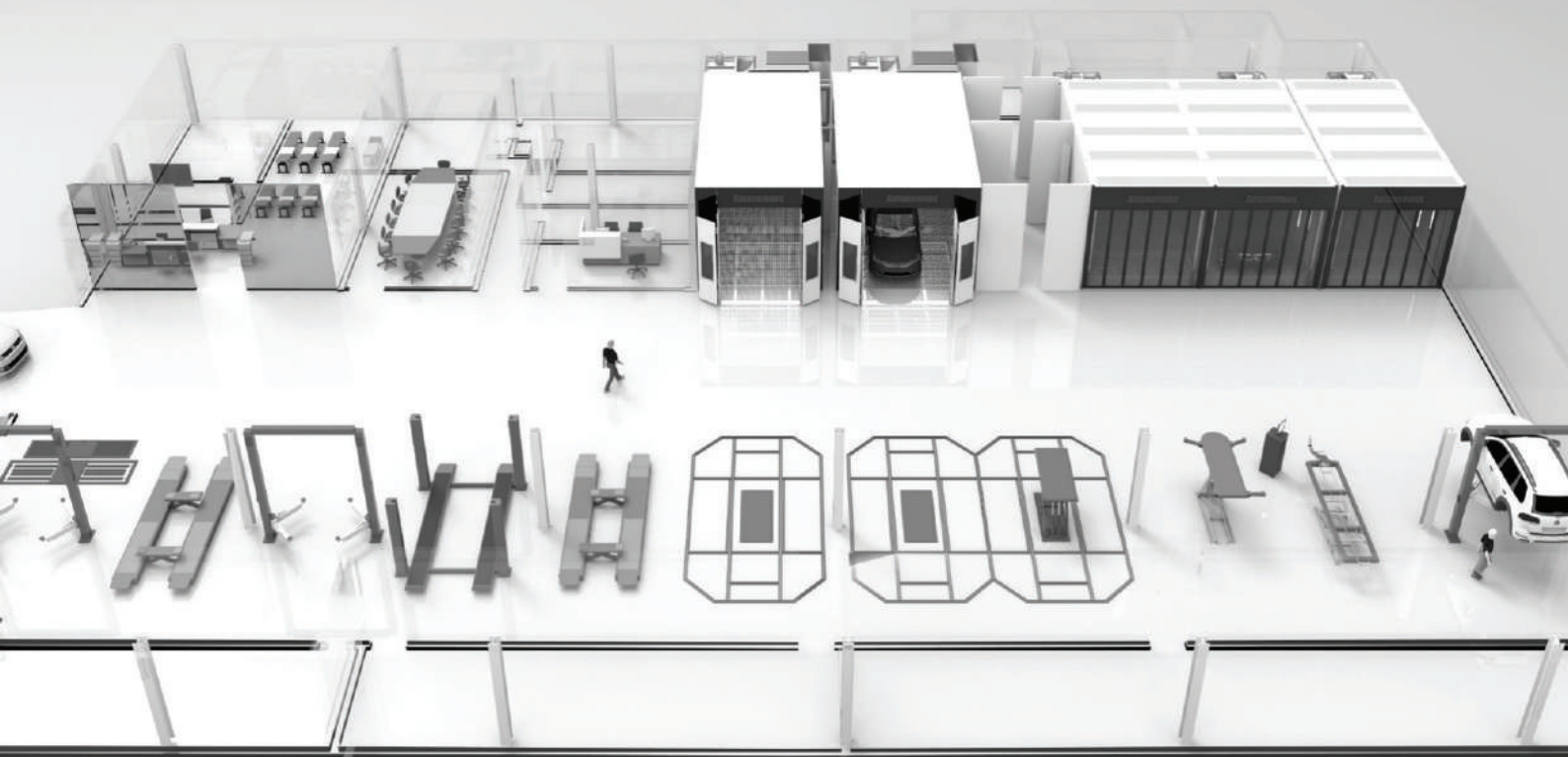

AutonomousTM

www.autonomoussr.com

HEADQUARTER : 690, Cheonho-daero, Gwangjin-gu, Seoul, Republic of Korea

FACTORY : 70, Gyeongchung-daero 1284beon-gil, Chowol-eup, Gwangju-si, Gyeonggi-do, Republic of Korea

TEL : +82-2-2299-3406

FAX : +82-2-2291-4136

E-mail : autopole@autonomoussr.com