

# WINNARD

## PRODUCT FOCUS

### WHEEL END HUBS & HUB KITS



FITTED WITH  
**FAG**  
BEARINGS

# WINNARD

MARCH 2024

## HUBS & HUBKITS

DIMENSION SPECIFICATION KEY

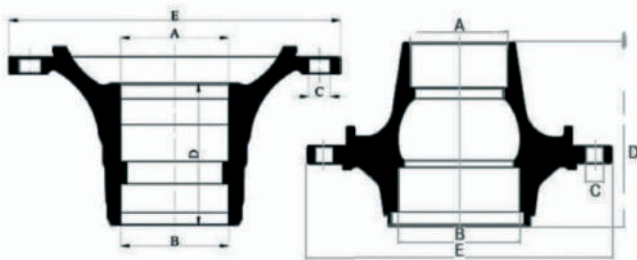

FRONT HUB

REAR & LIFT HUB



**FAG**  
BEARINGS  
&  
ABS RING\*

### BARE HUB (NO BEARING)

### HUB WITH BEARING

### COMPLETE WHEEL END HUB KIT

#### HUB0001NB

SUPPLIED WITHOUT BEARING

Specification

(A) OUTER BEARING DIA:	150
(B) INNER BEARING DIA:	150
(C) STUD HOLE DIA:	25
(D) HEIGHT:	295
(E) OUTER FLANGE DIA:	373
WEIGHT	40.0 kg

USES FAG BEARING  
566283.01.H195 WINNARD FAG0001

OEM: 1657637, 1812161



**Identification tip: ABS ring, ABS0010, sits flat on the base of the hub.**

#### HUB0001

SUPPLIED WITH FAG BEARING FITTED



#### HUBKIT0001

SUPPLIED WITH FAG BEARING & ABS RING, BRAKE DISC & WHEEL STUDS FITTED

Vehicle Applications

DAF CF, LF & XF	2000-
FODEN ALPHA	2001-
VAN HOOL T9	2003-

REAR AXLE



HUB OEM: 1657637, 1812161

NOTES: FITTED WITH OUR NEW DA1063 BRAKE DISC & FAG WHEEL BEARING AND FAG ABS RING. DA1058S SOLID BRAKE DISC CAN BE FITTED AS AN OPTION.

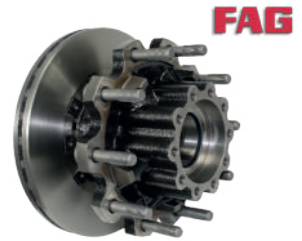

#### HUB0002NB

SUPPLIED WITHOUT BEARING

Specification

(A) OUTER BEARING DIA:	148
(B) INNER BEARING DIA:	148
(C) STUD HOLE DIA:	25
(D) HEIGHT:	287
(E) OUTER FLANGE DIA:	381
WEIGHT	39.00 kg

USES FAG BEARING  
566283.01.H195 WINNARD FAG0001

OEM: 1389061, 1391617, 1818003, 1956105, 2015333, 2019853



**Identification tip: ABS ring, ABS0012, is angled back**

#### HUB0002

SUPPLIED WITH FAG BEARING FITTED



#### HUBKIT0002

SUPPLIED WITH FAG BEARING & ABS RING, BRAKE DISC & WHEEL STUDS FITTED

Vehicle Applications

DAF CF, LF & XF	2000-
FODEN ALPHA	2001-
VAN HOOL T9	2003-

REAR AXLE



HUB OEM: 1389061, 1391617, 1818003, 1956105, 2015333, 2019853

NOTES: FITTED WITH OUR NEW DA1063 BRAKE DISC & FAG WHEEL BEARING AND FAG ABS RING. DA1058S SOLID BRAKE DISC CAN BE FITTED AS AN OPTION.

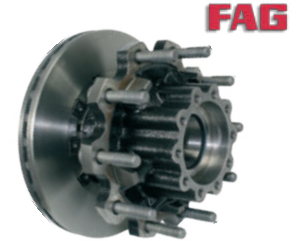

**BARE HUB (NO BEARING)****HUB WITH BEARING****HUB0003NB**

SUPPLIED WITHOUT BEARING

## Specification

(A) OUTER BEARING DIA:	119.7
(B) INNER BEARING DIA:	124.7
(C) STUD HOLE DIA:	25
(D) HEIGHT:	210
(E) OUTER FLANGE DIA:	386
WEIGHT	29 kg

USES FAG BEARING  
566834.H195 WINNARD FAG0002

**OEM:** 1388905, 1391615 Check hub design, 1697346 Check hub design



**See technical bulletin about part identification  
HUB0003 & HUB0004 are often interchanged.**

**HUB0003**

SUPPLIED WITH FAG BEARING FITTED

**HUB0004NB**

SUPPLIED WITHOUT BEARING

## Specification

(A) OUTER BEARING DIA:	125
(B) INNER BEARING DIA:	125
(C) STUD HOLE DIA:	25
(D) HEIGHT:	210
(E) OUTER FLANGE DIA:	383
WEIGHT	35 kg

USES FAG BEARING  
566074.H195 WINNARD FAG0003

**OEM:** 1691621, 1699327, 1818004



**See technical bulletin about part identification  
HUB0003 & HUB0004 are often interchanged.**

**HUB0004**

SUPPLIED WITH FAG BEARING FITTED

**HUB0005NB**

SUPPLIED WITHOUT BEARING

## Specification

(A) OUTER BEARING DIA:	125
(B) INNER BEARING DIA:	125
(C) STUD HOLE DIA:	27.2
(D) HEIGHT:	224
(E) OUTER FLANGE DIA:	383
WEIGHT	29.80 kg

USES FAG BEARING  
566426.H195 WINNARD FAG0007

**OEM:** 3092719, 3988831, 85101818, 85105693, 85111794, 85114471



**See HUB0008 / HUBKIT0008 for Metric stud version**

**HUB0005**

SUPPLIED WITH FAG BEARING FITTED



IMPERIAL STUD  
APPLICATION

**HUB0007NB**

SUPPLIED WITHOUT BEARING

## Specification

(A) OUTER BEARING DIA:	148
(B) INNER BEARING DIA:	148
(C) STUD HOLE DIA:	25
(D) HEIGHT:	270
(E) OUTER FLANGE DIA:	383
WEIGHT	33.4 kg

USES FAG BEARING  
566425.H195 WINNARD FAG0006

**OEM:** 20535263, 7420535263, 7485107753, 85107753



**Metric stud version of HUB0012 / HUBKIT0012**

**HUB0007**

SUPPLIED WITH FAG BEARING FITTED

**COMPLETE WHEEL END HUB KIT****HUBKIT0003**

SUPPLIED WITH FAG BEARING &amp; ABS RING, BRAKE DISC &amp; WHEEL STUDS FITTED

## Vehicle Applications

DAF CF, LF & XF	2000-
FODEN ALPHA	2001-
VAN HOOL T9	2003-

FRONT AXLE



**HUB SERVICE KITS ARE  
AVAILABLE: HUB CAP, LOCKING PLATES. PART# HSK0003**

**HUB OEM:** 1388905, 1391615 Check hub design, 1697346 Check hub design

NOTES: FITTED WITH OUR NEWDA1063 BRAKE DISC & FAG WHEEL BEARING AND FAG ABS RING. DA1058S SOLID BRAKE DISC CAN BE FITTED AS AN OPTION.

**DAF****FAG****HUBKIT0004**

SUPPLIED WITH FAG BEARING &amp; ABS RING, BRAKE DISC &amp; WHEEL STUDS FITTED

## Vehicle Applications

DAF CF, LF & XF	2000-
FODEN ALPHA	2001-
VAN HOOL T9	2003-

FRONT AXLE



**HUB SERVICE KITS ARE  
AVAILABLE: HUB CAP, LOCKING PLATES. PART# HSK0004**

**HUB OEM:** 1691621, 1699327, 1818004

NOTES: FITTED WITH OUR NEWDA1063 BRAKE DISC & FAG WHEEL BEARING AND FAG ABS RING. DA1058S SOLID BRAKE DISC CAN BE FITTED AS AN OPTION.

**DAF****FAG****HUBKIT0005**

SUPPLIED WITH FAG BEARING, BRAKE DISC, ABS RING &amp; WHEEL STUDS FITTED

## Vehicle Applications

VOLVO FL / FH / FM

FRONT &amp; REAR AXLE



**OEM:** 3092719, 3988831, 85101818, 85105693, 85111794, 85114471

NOTES: CAN BE FITTED WITH THE SOLID (VO1083) or VENTED (VO1071) BRAKE DISC. THE 410 mm DIAMETER DISCS VO1078 (SOLID) & VO1079 (VENTED) CAN ALSO BE FITTED

**WHEEL STUD OPTIONS:**  
WS0004 (OEM 1573081 86mm) or WS0005 (OEM 3112593 77mm)

**FAG****REN / VOLVO****HUBKIT0007**

SUPPLIED WITH FAG BEARING, BRAKE DISC, ABS RING &amp; WHEEL STUDS FITTED

## Vehicle Applications

RENAULT

VOLVO B9R / B13R  
VOLVO FH / FM

REAR AXLE



**HALF SHAFT SERVICE KIT  
AVAILABLE: PART# HSK0007**

**HUB OEM:** 20535263, 7420535263, 7485107753, 85107753

NOTES: CAN BE FITTED WITH THE SOLID (VO1083) or VENTED (VO1071) BRAKE DISC. STUDS FOR SINGLE STEEL WHEEL: WS0012 (95mm), TWIN WHEEL WS0014 (104mm) SEE WEB SITE FOR ALTERNATIVE WHEEL STUD OPTIONS

**FAG****REN / VOLVO**



**BARE HUB (NO BEARING)****HUB WITH BEARING****HUB0008NB**

SUPPLIED WITHOUT BEARING

## Specification

(A) OUTER BEARING DIA:	125
(B) INNER BEARING DIA:	125/68*
(C) STUD HOLE DIA:	25
(D) HEIGHT:	224
(E) OUTER FLANGE DIA:	383
WEIGHT	30.4 kg

USES FAG BEARING  
566426.H195 WINNARD FAG0007

**OEM:** 1026798, 20535202, 21116569, 3989341, 3988930, 85107750, 85111448, 85111791, 85114470



Metric stud version of HUB0005 / HUBKIT0005

**HUB0008**

SUPPLIED WITH FAG BEARING FITTED

**HUB0009NB**

SUPPLIED WITHOUT BEARING

## Specification

(A) OUTER BEARING DIA:	148
(B) INNER BEARING DIA:	148
(C) STUD HOLE DIA:	25
(D) HEIGHT:	226
(E) OUTER FLANGE DIA:	383
WEIGHT	33.0 kg

USES FAG BEARING  
566425.H195 WINNARD FAG0006

**OEM:** 1026662, 20517168, 85107752, 85109244

**HUB0009**

SUPPLIED WITH FAG BEARING FITTED

**HUB0012NB**

SUPPLIED WITHOUT BEARING

## Specification

(A) OUTER BEARING DIA:	148
(B) INNER BEARING DIA:	148
(C) STUD HOLE DIA:	27.2
(D) HEIGHT:	270
(E) OUTER FLANGE DIA:	383
WEIGHT	33.20 kg

USES FAG BEARING  
566425.H195 WINNARD FAG0006

**OEM:** 20476383, 3988833, 3988834, 85105696



See HUB0007 / HUBKIT0007 for Metric stud version

**HUB0012**

SUPPLIED WITH FAG BEARING FITTED

**HUB0013NB**

SUPPLIED WITHOUT BEARING

## Specification

(A) OUTER BEARING DIA:	110
(B) INNER BEARING DIA:	110
(C) STUD HOLE DIA:	25
(D) HEIGHT:	224
(E) OUTER FLANGE DIA:	383.5
WEIGHT	27.8 kg

USES FAG BEARING  
566427.H195 WINNARD FAG0008

**OEM:** 85107748, 85107749, 85111789



Metric stud version version of HUB0024 / HUBKIT0024

**HUB0013**

SUPPLIED WITH FAG BEARING FITTED

**COMPLETE WHEEL END HUB KIT****HUBKIT0008**

SUPPLIED WITH FAG BEARING, BRAKE DISC, ABS RING &amp; WHEEL STUDS FITTED

## Vehicle Applications

VOLVO B7R / B9L / B9TL / B12B, B12M  
VOLVO FH

FRONT AXLE



\*68MM INNER STUB  
AXLE DIAMETER  
See HUBKIT0047 FOR 58MM

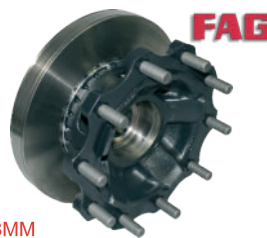

**HUB OEM:** 1026798, 1026659, 20535202, 21116569, 3989341, 3988930, 85107750, 85111448, 85111791, 85114470, 7420535202, 7485114470, 7421024206 See web site for wheel stud options.

NOTES: CAN BE FITTED WITH THE SOLID (VO1083) or VENTED (VO1071) BRAKE DISC THE 410 mm DIAMETER DISCS VO1078 (SOLID) & VO1079 (VENTED) CAN ALSO BE FITTED. STUDS FOR SINGLE STEEL WHEEL: WS0009 (78mm) SEE WEB SITE FOR ALTERNATIVE WHEEL STUD OPTIONS

**HUBKIT0009**

SUPPLIED WITH FAG BEARING, BRAKE DISC, ABS RING &amp; WHEEL STUDS FITTED

## Vehicle Applications

VOLVO B12M  
VOLVO FH / FM

REAR &amp; LIFT AXLE



**HUB OEM:** 31026662, 20517168, 85107752, 85109244

NOTES: CAN BE FITTED WITH 430mm SOLID (VO1083) or VENTED (VO1071) - 410mm SOLID(VO1078) or VENTED (VO1079) BRAKE DISC.. STUDS FOR SINGLE STEEL WHEEL: WS0012 (95mm), TWIN WHEEL WS0014 (104mm) SEE WEB SITE FOR ALTERNATIVE WHEEL STUD OPTIONS

**HUBKIT0012**

SUPPLIED WITH FAG BEARING, BRAKE DISC, ABS RING &amp; WHEEL STUDS FITTED

## Vehicle Applications

VOLVO B7R / B9L / B9TL / B12B, B12M  
VOLVO FH / FM

REAR AXLE



**HUB OEM:** 20476383, 3988833, 3988834, 85105696

NOTES: CAN BE FITTED WITH THE SOLID (VO1083) or VENTED (VO1071) BRAKE DISC. STUDS FOR SINGLE STEEL WHEEL: WS0012 (95mm), TWIN WHEEL WS0014 (104mm) SEE WEB SITE FOR ALTERNATIVE WHEEL STUD OPTIONS

**HUBKIT0013**

SUPPLIED WITH FAG BEARING, BRAKE DISC, ABS RING &amp; WHEEL STUDS FITTED

## Vehicle Applications

VOLVO FE / FH / FM

FRONT AXLE



**HUB OEM:** 21022433, 7421022433, 85107748, 85107749, 85111789

NOTES: CAN BE FITTED WITH THE SOLID (VO1083) or VENTED (VO1071) BRAKE DISC. STUDS FOR SINGLE STEEL WHEEL: WS0009 (78mm) SEE WEB SITE FOR ALTERNATIVE WHEEL STUD OPTIONS

**BARE HUB (NO BEARING)****HUB WITH BEARING****COMPLETE WHEEL END HUB KIT****HUB0014NB**

SUPPLIED WITHOUT BEARING

## Specification

(A) OUTER BEARING DIA:	110
(B) INNER BEARING DIA:	110
(C) STUD HOLE DIA:	25
(D) HEIGHT:	224
(E) OUTER FLANGE DIA:	384
WEIGHT	25.4 kg

USES FAG BEARING  
566427.H195 WINNARD FAG0008

**OEM:** 21024206, 8505694, 85100557, 85107751, 85111790, 85111793**HUB0014**

SUPPLIED WITH FAG BEARING FITTED

**FAG****HUBKIT0014**

SUPPLIED WITH FAG BEARING, BRAKE DISC, ABS RING &amp; WHEEL STUDS FITTED

## Vehicle Applications

VOLVO FE / FH / FM

FRONT AXLE

**HUB OEM:** 21024206, 8505694, 85100557, 85107751, 85111790, 85111793

NOTES: CAN BE FITTED WITH THE SOLID (VO1072) or VENTED (VO1077) BRAKE DISC.  
STUDS FOR SINGLE STEEL WHEEL: WS0009 (78mm)  
SEE WEB SITE FOR ALTERNATIVE WHEEL STUD OPTIONS

**REN / VOLVO****FAG****HUB0015NB**

SUPPLIED WITHOUT BEARING

## Specification

(A) OUTER BEARING DIA:	138
(B) INNER BEARING DIA:	138
(C) STUD HOLE DIA:	22
(D) HEIGHT:	184
(E) OUTER FLANGE DIA:	386
WEIGHT	25.6 kg

USES FAG BEARING  
569868.H195 WINNARD FAG0016

**OEM:** 3.307.3030.00, 3.307.3030.01, 3307303000, 3307303001**HUB0015**

SUPPLIED WITH FAG BEARING FITTED

**FAG****HUBKIT0015**

SUPPLIED WITH FAG BEARING, BRAKE DISC, ABS RING &amp; WHEEL STUDS FITTED

## Vehicle Applications

SAF SK RB9019

SAF SK RB9022

TRAILER AXLE

**HUB OEM:** 3.307.3030.00, 3.307.3030.01, 3307303000, 3307303001

NOTES: CAN BE FITTED WITH THE EITHER SAU1030 OR SAU1031 BRAKE DISC.

**SAF****FAG****HUB KIT NOT CURRENTLY AVAILABLE****HUB0016NB**

SUPPLIED WITHOUT BEARING

## Specification

(A) OUTER BEARING DIA:	138
(B) INNER BEARING DIA:	138
(C) STUD HOLE DIA:	25
(D) HEIGHT:	154
(E) OUTER FLANGE DIA:	383
WEIGHT	28.4 kg

USES FAG BEARING  
566193.H195 WINNARD FAG0015

**OEM:** 1428396, 1613331, 1812160**HUB0016**

SUPPLIED WITH FAG BEARING FITTED

**FAG****HUBKIT0016**

SUPPLIED WITH FAG BEARING, BRAKE DISC, ABS RING &amp; WHEEL STUDS FITTED

## Vehicle Applications

DAF CF, LF &amp; XF 2010-

FRONT AXLE

**9 Tonne axle****HUB OEM:** 1428396, 1613331, 1812160

NOTES: FITTED WITH OUR NEW DA1059 BRAKE DISC &amp; FAG WHEEL BEARING AND FAG ABS RING.

**DAF****FAG****HUB0018NB**

SUPPLIED WITHOUT BEARING

## Specification

(A) OUTER BEARING DIA:	110
(B) INNER BEARING DIA:	110
(C) STUD HOLE DIA:	27.3
(D) HEIGHT:	224
(E) OUTER FLANGE DIA:	384
WEIGHT	25.4 kg

USES FAG BEARING  
566427.H195 WINNARD FAG0008

**OEM:** 85105694, 85111793**HUB0018**

SUPPLIED WITH FAG BEARING FITTED

**FAG**

IMPERIAL STUD  
APPLICATION

**HUBKIT0018**

SUPPLIED WITH FAG BEARING, BRAKE DISC, ABS RING &amp; WHEEL STUDS FITTED

## Vehicle Applications

VOLVO (Various applications)

FRONT AXLE

**HUB OEM:** 85105694, 85111793

NOTES: CAN BE FITTED WITH THE SOLID (VO1072) or VENTED (VO1077) BRAKE DISC.  
WHEEL STUD OPTIONS:  
WS0004 (OEM 1573081 86mm ) or WS0005 (OEM3112593 115mm)

**REN / VOLVO****FAG**

**BARE HUB (NO BEARING)****HUB0019NB**

SUPPLIED WITHOUT BEARING

## Specification

(A) OUTER BEARING DIA:	148
(B) INNER BEARING DIA:	148
(C) STUD HOLE DIA:	27
(D) HEIGHT:	226
(E) OUTER FLANGE DIA:	383
WEIGHT	31.8 kg

USES FAG BEARING  
566425.H195 WINNARD FAG0006

OEM: 85105695

**HUB WITH BEARING****HUB0019**

SUPPLIED WITH FAG BEARING FITTED

**HUB0021NB**

SUPPLIED WITHOUT BEARING

## Specification

(A) OUTER BEARING DIA:	130
(B) INNER BEARING DIA:	130
(C) STUD HOLE DIA:	27
(D) HEIGHT:	224
(E) OUTER FLANGE DIA:	383
WEIGHT	30.2 kg

USES FAG BEARING  
631903.H195 WINNARD FAG0025

OEM: 21102556, 21550437

**HUB0021**

SUPPLIED WITH FAG BEARING FITTED

**HUB0024NB**

SUPPLIED WITHOUT BEARING

## Specification

(A) OUTER BEARING DIA:	110
(B) INNER BEARING DIA:	110
(C) STUD HOLE DIA:	27.2
(D) HEIGHT:	224
(E) OUTER FLANGE DIA:	383.5
WEIGHT	27.6 kg

USES FAG BEARING  
566427.H195 WINNARD FAG0008

OEM: 7410241087, 7421021381

**HUB0024**

SUPPLIED WITH FAG BEARING FITTED



See HUB0013 / HUBKIT0013 for Metric stud version

**HUB0025NB**

SUPPLIED WITHOUT BEARING

## Specification

(A) OUTER BEARING DIA:	
(B) INNER BEARING DIA:	
(C) STUD HOLE DIA:	
(D) HEIGHT:	
(E) OUTER FLANGE DIA:	
WEIGHT	

USES FAG BEARING  
AWAITING BEARING CONFIRMATION

OEM: 510587029

**HUB0025**

SUPPLIED WITH FAG BEARING FITTED

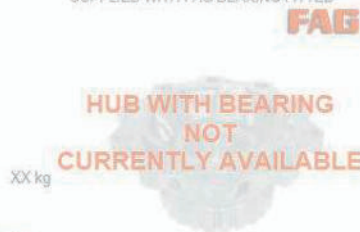
**COMPLETE WHEEL END HUB KIT****HUBKIT0019**

SUPPLIED WITH FAG BEARING, BRAKE DISC, ABS RING &amp; WHEEL STUDS FITTED

## Vehicle Applications

VOLVO (Various applications)

## LIFT AXLE



HUB OEM: 85105695

NOTES: CAN BE FITTED WITH 430mm SOLID (VO1083) or VENTED (VO1071) - 410mm SOLID (VO1078) or VENTED (VO1079) BRAKE DISC.

## WHEEL STUD OPTIONS:

WS0004 (OEM 1573081 86mm) or WS0005 (OEM3112593 115mm)

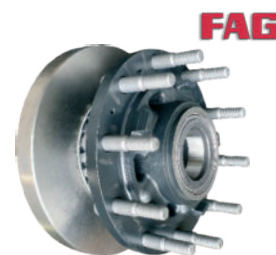
**REN / VOLVO****HUBKIT0021**

SUPPLIED WITH FAG BEARING, BRAKE DISC, ABS RING &amp; WHEEL STUDS FITTED

## Vehicle Applications

VOLVO (Various applications)

## FRONT AXLE



HUB OEM: 21102556, 21550437

NOTES: CAN BE FITTED WITH THE SOLID (VO1083) or VENTED (VO1071) BRAKE DISC.

## WHEEL STUD OPTIONS:

WS0004 (OEM 1573081 86mm) or WS0005 (OEM3112593 115mm)

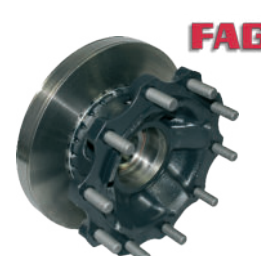
**REN / VOLVO****HUBKIT0024**

SUPPLIED WITH FAG BEARING, BRAKE DISC, ABS RING &amp; WHEEL STUDS FITTED

## Vehicle Applications

VOLVO (Various applications)

## FRONT AXLE



HUB OEM: 7410241087, 7421021381

NOTES: CAN BE FITTED WITH THE SOLID (VO1083) or VENTED (VO1071) BRAKE DISC.

## WHEEL STUD OPTIONS:

WS0004 (OEM 1573081 86mm) or WS0005 (OEM3112593 115mm)

**REN / VOLVO****HUBKIT0025**

SUPPLIED WITH FAG BEARING, BRAKE DISC, ABS RING &amp; WHEEL STUDS FITTED

## Vehicle Applications

RENAULT (Various applications)

## FRONT AXLE



HUB OEM: 510587029

NOTES: CAN BE FITTED WITH THE SOLID (VO1083) or VENTED (VO1071) BRAKE DISC.  
SEE WEB SITE FOR WHEEL STUD OPTIONS

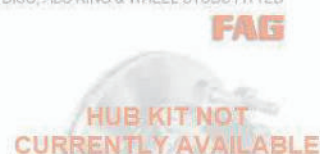
**REN / VOLVO**



**BARE HUB (NO BEARING)****HUB0026NB**

SUPPLIED WITHOUT BEARING

## Specification

(A) OUTER BEARING DIA:	148
(B) INNER BEARING DIA:	148
(C) STUD HOLE DIA:	25
(D) HEIGHT:	287
(E) OUTER FLANGE DIA:	383.4
WEIGHT	35.8 kg

USES FAG BEARING  
566425.H195 WINNARD FAG0006

OEM: 7420819859

**HUB WITH BEARING****HUB0026**

SUPPLIED WITH FAG BEARING FITTED

**FAG****HUB0029NB**

SUPPLIED WITHOUT BEARING

## Specification

(A) OUTER BEARING DIA:	148
(B) INNER BEARING DIA:	148
(C) STUD HOLE DIA:	25
(D) HEIGHT:	192
(E) OUTER FLANGE DIA:	384
WEIGHT	23.4 kg

USES FAG BEARING  
566425.H195 WINNARD FAG0006

OEM 20518053, 20535244, 20535245, 21336855, 21336856,  
21336857, 3988774

**Metric stud version of HUB0040 / HUBKIT0040****HUB0029**

SUPPLIED WITH FAG BEARING FITTED

**FAG****HUB0030NB**

SUPPLIED WITHOUT BEARING

## Specification

(A) OUTER BEARING DIA:	127.3
(B) INNER BEARING DIA:	127
(C) STUD HOLE DIA:	22.3
(D) HEIGHT:	194
(E) OUTER FLANGE DIA:	380
WEIGHT	24.4 kg

USES FAG BEARING  
1439070, 1476945, 1724482, 1868087,  
WINNARD FAG0012

OEM: 1480933, 1724406, 1868663

**HUB0030**

SUPPLIED WITH FAG BEARING FITTED

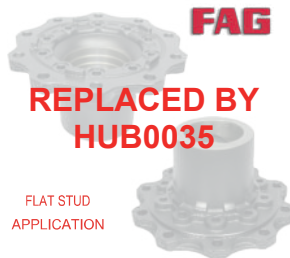
**FAG****REPLACED BY  
HUB0035**FLAT STUD  
APPLICATION**HUB0031NB**

SUPPLIED WITHOUT BEARING

## Specification

(A) OUTER BEARING DIA:	147
(B) INNER BEARING DIA:	147
(C) STUD HOLE DIA:	22.3
(D) HEIGHT:	210.5
(E) OUTER FLANGE DIA:	380
WEIGHT	24.4 kg

USES FAG BEARING  
SCANIA 1524625, 723015110, KHM218248.218210,  
KHM218248.HM218210 WINNARD FAG0017

OEM: 1382884

**HUB0031**

SUPPLIED WITH FAG BEARING FITTED

**FAG****COMPLETE WHEEL END HUB KIT****HUBKIT0026**

SUPPLIED WITH FAG BEARING, BRAKE DISC, ABS RING &amp; WHEEL STUDS FITTED

## Vehicle Applications

RENAULT (Differential Hub)

REAR AXLE



HUB OEM: 7420819859, 7420819860

**REN / VOLVO****FAG**

NOTES: CAN BE FITTED WITH THE SOLID (VO1083) or VENTED (VO1071) BRAKE DISC.  
STUDS FOR SINGLE STEEL WHEEL: WS0012 (95mm), TWIN WHEEL WS0014 (104mm)  
SEE WEB SITE FOR ALTERNATIVE WHEEL STUD OPTIONS

**HUBKIT0029**

SUPPLIED WITH FAG BEARING &amp; ABS RING, BRAKE DISC &amp; WHEEL STUDS FITTED

## Vehicle Applications

VOLVO FH

REAR AXLE

DRUM  
OPTIONS  
**VO1041**  
**VO1042**

NOTES: BRAKE DRUM NOT INCLUDED BUT CAN BE SUPPLIED SEPARATELY

## WHEEL STUD OPTIONS:

WS0014 ( 20515519 104mm), WS0016 (20553560 123mm)

**VOLVO****FAG****HUBKIT0030**

SUPPLIED WITH FAG BEARING, BRAKE DISC, ABS RING &amp; WHEEL STUDS FITTED

## Vehicle Applications

SCANIA

FRONT AXLE



HUB OEM: 480933, 1724406, 18686637

**SCANIA****FAG****REPLACED BY  
HUBKIT0035**

NOTES: CAN BE FITTED WITH THE SOLID (SC1023S) or VENTED (SC1023) BRAKE DISC.  
**WHEEL STUD OPTIONS:**  
WS0023 (OEM 1868665 72mm ROUND STEEL WHEEL ) or WS0024 (OEM 1868667 81mm  
ROUND ALLOY WHEEL)

**HUBKIT0031**

SUPPLIED WITH FAG BEARING, BRAKE DISC, ABS RING &amp; WHEEL STUDS FITTED

## Vehicle Applications

SCANIA

REAR AXLE

**PRELOAD SLEEVE  
IS AVAILABLE  
HSK0032-1**

HUB OEM: 1382884

**SCANIA****FAG**

**BARE HUB (NO BEARING)****HUB WITH BEARING****HUB0032NB**

SUPPLIED WITHOUT BEARING

## Specification

(A) OUTER BEARING DIA:	147
(B) INNER BEARING DIA:	147
(C) STUD HOLE DIA:	24.0
(D) HEIGHT:	213.5
(E) OUTER FLANGE DIA:	380
WEIGHT	24.4kg

USES FAG BEARING

SCANIA 1524625, 723015110, KHM218248, 218210, KHM218248.HM218210 WINNARD FAG0017

OEM: 1800283, 2290542,

**HUB0032**

SUPPLIED WITH FAG BEARING FITTED

**HUB0033NB**

SUPPLIED WITHOUT BEARING

## Specification

(A) OUTER BEARING DIA:	148
(B) INNER BEARING DIA:	148
(C) STUD HOLE DIA:	25.3
(D) HEIGHT:	157
(E) OUTER FLANGE DIA:	385.5
WEIGHT	26.4kg

USES FAG BEARING

566425.H195 WINNARD FAG0006

OEM: 20535207, 20819804, 20819806, 20820402, 21328177, 21328181

**HUB0033**

SUPPLIED WITH FAG BEARING FITTED

**HUB0035NB**

SUPPLIED WITHOUT BEARING

## Specification

(A) OUTER BEARING DIA:	127.3
(B) INNER BEARING DIA:	127
(C) STUD HOLE DIA:	22.3
(D) HEIGHT:	197
(E) OUTER FLANGE DIA:	380
WEIGHT	24.4 kg

USES FAG BEARING

1439070, 1476945, 1724482, 1868087, WINNARD FAG0012

OEM: 1864430

**HUB0035**

SUPPLIED WITH FAG BEARING FITTED

**HUB0036NB**

SUPPLIED WITHOUT BEARING

## Specification

(A) OUTER BEARING DIA:	127.3
(B) INNER BEARING DIA:	127
(C) STUD HOLE DIA:	24
(D) HEIGHT:	137
(E) OUTER FLANGE DIA:	375
WEIGHT	24.4 kg

USES FAG BEARING

1439070, 1476945, 1724482, 1868087, WINNARD FAG0012

OEM: 2290532

**HUB0036**

SUPPLIED WITH FAG BEARING FITTED

**COMPLETE WHEEL END HUB KIT****HUBKIT0032**

SUPPLIED WITH FAG BEARING, BRAKE DISC, ABS RING &amp; WHEEL STUDS FITTED

## Vehicle Applications

SCANIA

REAR AXLE PRELOAD SLEEVE IS AVAILABLE HSK0032-1



HUB OEM: 1800283, 2290542

**SCANIA****FAG****HUBKIT0033**

SUPPLIED WITH FAG BEARING, ABS RING &amp; WHEEL STUDS FITTED

## Vehicle Applications

VOLVO (DRUM BRAKE - LIFT AXLE)

**REN / VOLVO****FAG**

HUB OEM: 20535207, 20819804, 20819806, 20820402, 21328177, 21328181

NOTES: BRAKE DRUM NOT INCLUDED BUT CAN BE SUPPLIED SEPARATELY

## WHEEL STUD OPTIONS:

WS0014 (OEM 20515519, 20524942 104mm) or WS0015 (OEM 21147687 113mm - ALLOY WHEEL)

**HUBKIT0035**

SUPPLIED WITH FAG BEARING, BRAKE DISC, ABS RING &amp; WHEEL STUDS FITTED

## Vehicle Applications

SCANIA

FRONT AXLE



NOTES: CAN BE FITTED WITH THE EITHER SC1023 VENTED OR SC1023S SOLID BRAKE DISC.

**HUBKIT0036**

SUPPLIED WITH FAG BEARING, ABS RING &amp; WHEEL STUDS FITTED

## Vehicle Applications

SCANIA

FRONT AXLE

DRUM  
OPTIONS**SC1021**  
**SC1022****SCANIA****FAG**

NOTES: BRAKE DRUM NOT INCLUDED BUT CAN BE SUPPLIED SEPARATELY

## WHEEL STUD OPTIONS:

WS0023 (OEM 1868665, 2285275 72mm) or WS0024 (OEM 1868667, 2285278 81mm)



**BARE HUB (NO BEARING)****HUB0037NB**

SUPPLIED WITHOUT BEARING

## Specification

(A) OUTER BEARING DIA:	112.6
(B) INNER BEARING DIA:	62
(C) STUD HOLE DIA: 8x21 (16x12.5 Disc)	
(D) HEIGHT:	169
(E) OUTER FLANGE DIA:	
WEIGHT	15 kg

USES FAG BEARING

1400078, 32206A, WINNARD FAG0020-2 &amp; 40 26677690210, K39581.39520 WINNARD FAG0021-1

**OEM:** 1408100**HUB WITH BEARING****HUB0037**

SUPPLIED WITH FAG BEARING FITTED

**HUB0038NB**

SUPPLIED WITHOUT BEARING

## Specification

(A) OUTER BEARING DIA:	140.0
(B) INNER BEARING DIA:	140.0
(C) STUD HOLE DIA:	22
(D) HEIGHT:	169.5
(E) OUTER FLANGE DIA:	
WEIGHT	25.2 kg

USES FAG BEARING

201034, 805003A.H195, F-805003.01.TR2U1, F-805003.01.TR2U1-H195, GIGANT 9272681 9272778, MERCEDES 0003300725 0003500535 003500935 019815105 0149819305 0149819905 0169812805 0179815005 149819305 169812805 9433341125, SCHMITZ 16477, WINNARD FAG0019

**OEM:** 10003500535, 0003502335, A0003502335, A942010271, JAE0120802471**HUB0038**

SUPPLIED WITH FAG BEARING FITTED

**HUB0039NB**

SUPPLIED WITHOUT BEARING

## Specification

(A) OUTER BEARING DIA:	62.0
(B) INNER BEARING DIA:	95.0
(C) STUD HOLE DIA:	19
(D) HEIGHT:	144.5
(E) OUTER FLANGE DIA:	
WEIGHT	7.8 kg

USES FAG BEARING 201080, OEM 1400081, WINNARD FAG0020-1 &amp; 32206A OEM 1400078, WINNARD FAG0020-2

**OEM:** 1407382, NJK3913RM**HUB0039**

SUPPLIED WITH FAG BEARING FITTED

**HUB0040NB**

SUPPLIED WITHOUT BEARING

## Specification

(A) OUTER BEARING DIA:	148
(B) INNER BEARING DIA:	148
(C) STUD HOLE DIA:	27.2
(D) HEIGHT:	192
(E) OUTER FLANGE DIA:	384
WEIGHT	23.4 kg

USES FAG BEARING

566425.H195 WINNARD FAG0006

**OEM:** 20476519, 20518054, 3943982, 3988774**HUB0040**

SUPPLIED WITH FAG BEARING FITTED

**Imperial stud version of HUB0029 / HUBKIT0029****COMPLETE WHEEL END HUB KIT****HUBKIT0037****DAF**

SUPPLIED WITH FAG BEARING, BRAKE DISC, HUB BOLTS &amp; WHEEL STUDS FITTED

## Vehicle Applications

DAF LF45 Series 12 Ton - PAN17

FRONT AXLE



NOTES: CAN BE FITTED WITH THE EITHER DA1048 or DA1054 BRAKE DISC

**HUBKIT0038****MERC / TRAILER**

SUPPLIED WITH FAG BEARING, BRAKE DISC, ABS RING &amp; WHEEL STUDS FITTED HUB CAP, HUB SEAL, CIRCLIP &amp; HUB BOLTS

## Vehicle Applications

MERCEDES / DISCOS / GIGANT / SCHMITZ

FRONT AXLE / TRAILER



NOTES: CAN BE FITTED WITH THE EITHER MNE101065 VENTED OR MNE1065 SOLID or MNE1108 BRAKE DISC.

**HUBKIT0039****DAF**

SUPPLIED WITH FAG BEARING, BRAKE DISC, ABS RING &amp; WHEEL STUDS FITTED

## Vehicle Applications

DAF LF 45 Exc 12 ton - PAN 17

FRONT AXLE

**HUBKIT0040****VOLVO**

SUPPLIED WITH FAG BEARING, ABS RING &amp; WHEEL STUDS FITTED

## Vehicle Applications

VOLVO FH

REAR AXLE

DRUM  
OPTIONS  
**VO1041**  
**VO1042**

NOTES: BRAKE DRUM NOT INCLUDED BUT CAN BE SUPPLIED SEPARATELY

## WHEEL STUD OPTIONS:

WS0006 (OEM 11573082 102mm) or WS0007 (OEM 1589009, 8152104 110mm)

**BARE HUB (NO BEARING)****HUB0041NB**

SUPPLIED WITHOUT BEARING

## Specification

(A) OUTER BEARING DIA:	125
(B) INNER BEARING DIA:	125
(C) STUD HOLE DIA:	27.2
(D) HEIGHT:	164.5
(E) OUTER FLANGE DIA:	384
WEIGHT	21.8 kg

USES FAG BEARING  
566426.H195 WINNARD FAG0007

OEM: 2024155, 20518092, 3988674

**HUB WITH BEARING****HUB0041**

SUPPLIED WITH FAG BEARING FITTED

**HUB0042NB**

SUPPLIED WITHOUT BEARING

## Specification

(A) OUTER BEARING DIA:	148
(B) INNER BEARING DIA:	148
(C) STUD HOLE DIA:	25
(D) HEIGHT:	197.5
(E) OUTER FLANGE DIA:	383.5
WEIGHT	30.6 kg

USES FAG BEARING  
566425.H195 WINNARD FAG0006

OEM: 20499881, 20820420

**HUB0042**

SUPPLIED WITH FAG BEARING FITTED

**HUB0046NB**

SUPPLIED WITHOUT BEARING

## Specification

(A) OUTER BEARING DIA:	147
(B) INNER BEARING DIA:	147
(C) STUD HOLE DIA:	22.3
(D) HEIGHT:	213.5
(E) OUTER FLANGE DIA:	380
WEIGHT	29.80 kg

USES FAG BEARING  
SCANIA 1524625, 723015110, KHM218248.218210,  
KHM218248.HM218210 WINNARD FAG0017

OEM: 1724790

**HUB0046**

SUPPLIED WITH FAG BEARING FITTED

**HUB0047NB**

SUPPLIED WITHOUT BEARING

## Specification

(A) OUTER BEARING DIA:	115
(B) INNER BEARING DIA:	115/58*
(C) STUD HOLE DIA:	25
(D) HEIGHT:	224
(E) OUTER FLANGE DIA:	383
WEIGHT	33.2 kg

USES FAG BEARING  
F-588258.TR21, F-611766.TR21 WINNARD  
FAG0024

OEM: 221940776, 21946101, 21953590, 21983587, 21983590, 7421940776,

**HUB0047**

SUPPLIED WITH FAG BEARING FITTED

**COMPLETE WHEEL END HUB KIT****HUBKIT0041**

SUPPLIED WITH FAG BEARING, ABS RING &amp; WHEEL STUDS FITTED

## Vehicle Applications

VOLVO FH

FRONT AXLE



NOTES: BRAKE DRUM NOT INCLUDED BUT CAN BE SUPPLIED SEPARATELY

**VOLVO****HUBKIT0042**

SUPPLIED WITH FAG BEARING, ABS RING &amp; WHEEL STUDS FITTED

## Vehicle Applications

VOLVO



DRUM  
OPTIONS  
VO1041  
VO1042

NOTES: BRAKE DRUM NOT INCLUDED BUT CAN BE SUPPLIED SEPARATELY

## WHEEL STUD OPTIONS:

WS0014 (OEM 20515519, 20524942 104mm) or WS0016 (OEM 20553560 122mm)

**HUBKIT0046**

SUPPLIED WITH FAG BEARING, BRAKE DISC, ABS RING &amp; WHEEL STUDS FITTED

## Vehicle Applications

SCANIA

REAR AXLE



PRELOAD SLEEVE  
IS AVAILABLE  
HSK0032-1

HUB OEM: 1724790

**SCANIA****HUBKIT0047**

SUPPLIED WITH FAG BEARING &amp; ABS RING, BRAKE DISC &amp; WHEEL STUDS FITTED

## Vehicle Applications

VOLVO FE / FH / FM

FRONT AXLE



\*58MM INNER STUB  
AXLE DIAMETER  
See HUBKIT0008 FOR 68MM

NOTES: CAN BE FITTED WITH THE SOLID (VO1083) or VENTED (VO1071) BRAKE DISC  
THE 410 mm DIAMETER DISCS VO1078 (SOLID) & VO1079 (VENTED) CAN ALSO BE FITTED,  
STUDS FOR SINGLE STEEL WHEEL: WS0009 (78mm)  
SEE WEB SITE FOR ALTERNATIVE WHEEL STUD OPTIONS

**REN VOLVO**

**BARE HUB (NO BEARING)****HUB WITH BEARING****HUB0049NB**

SUPPLIED WITHOUT BEARING

## Specification

(A) OUTER BEARING DIA:	125
(B) INNER BEARING DIA:	138/68*
(C) STUD HOLE DIA:	25
(D) HEIGHT:	25
(E) OUTER FLANGE DIA:	384
WEIGHT	35.8 kg

USES FAG BEARING  
Z-561079.12

OEM: 22018115, 22036498, 22491569

**HUB0049**

SUPPLIED WITH FAG BEARING FITTED

**FAG****HUB0051NB**

SUPPLIED WITHOUT BEARING

## Specification

(A) OUTER BEARING DIA:	148
(B) INNER BEARING DIA:	148
(C) STUD HOLE DIA:	24
(D) HEIGHT:	149.5
(E) OUTER FLANGE DIA:	375
WEIGHT	34.15 kg

USES FAG BEARING  
566425.H195 WINNARD FAG0006

OEM: A975 330 0825, A975 330 4025, A975 334 0101, A975 334 0301

**HUB0051**

SUPPLIED WITH FAG BEARING FITTED

**FAG****HUB0054NB**

SUPPLIED WITHOUT BEARING

## Specification

(A) OUTER BEARING DIA:	130
(B) INNER BEARING DIA:	130
(C) STUD HOLE DIA:	19
(D) HEIGHT:	141
(E) OUTER FLANGE DIA:	375
WEIGHT	9.20 Kg

USES FAG BEARING  
803194.26.H195, FAG0005

OEM: 1703809

**HUB0054**

SUPPLIED WITH FAG BEARING FITTED

**FAG****HUB0055NB**

SUPPLIED WITHOUT BEARING

## Specification

(A) OUTER BEARING DIA:	110
(B) INNER BEARING DIA:	110
(C) STUD HOLE DIA:	19
(D) HEIGHT:	133.0
(E) OUTER FLANGE DIA:	248
WEIGHT	10.8 Kg

USES FAG BEARING  
201079

OEM: 1407582

**HUB0055**

SUPPLIED WITH FAG BEARING FITTED

**FAG****COMPLETE WHEEL END HUB KIT****HUBKIT0049**

SUPPLIED WITH FAG BEARING &amp; ABS RING, BRAKE DISC &amp; WHEEL STUDS FITTED

## Vehicle Applications

VOLVO FE / FH / FM

FRONT AXLE



\*68MM INNER STUB  
AXLE DIAMETER  
See HUBKIT0047 FOR 58MM

NOTES: CAN BE FITTED WITH THE SOLID (VO1083) or VENTED (VO1071) BRAKE DISC  
THE 410 mm DIAMETER DISCS VO1078 (SOLID) & VO1079 (VENTED) CAN ALSO BE FITTED.  
STUDS FOR SINGLE STEEL WHEEL: WS0009 (78m)  
SEE WEB SITE FOR ALTERNATIVE WHEEL STUD OPTIONS

**REN VOLVO****FAG****HUBKIT0051**

SUPPLIED WITH FAG BEARING &amp; ABS RING, BRAKE DISC &amp; WHEEL STUDS FITTED

## Vehicle Applications

SCANIA

REAR AXLE

**SCANIA****FAG****HUBKIT0054**

SUPPLIED WITH FAG BEARING &amp; ABS RING, BRAKE DISC &amp; WHEEL STUDS FITTED

## Vehicle Applications

DAF LF45  
OPTARE SOLO  
WRIGHTBUS STEETLITE

REAR AXLE

**DAF****FAG****HUBKIT0055**

SUPPLIED WITH FAG BEARING &amp; ABS RING, BRAKE DISC &amp; WHEEL STUDS FITTED

## Vehicle Applications

DAF LF45

REAR AXLE

**DAF****FAG**



## BARE HUB (NO BEARING)

### HUB0056NB

SUPPLIED WITHOUT BEARING

#### Specification

(A) OUTER BEARING DIA:	160
(B) INNER BEARING DIA:	160
(C) STUD HOLE DIA:	21
(D) HEIGHT:	173
(E) OUTER FLANGE DIA:	316
WEIGHT	19.6 kg

USES FAG BEARING  
805012.06.H195

**OEM:** 1400289, 1702952

## HUB WITH BEARING

### HUB0056

SUPPLIED WITH FAG BEARING FITTED

**FAG**



### HUB0057NB

SUPPLIED WITHOUT BEARING

#### Specification

(A) OUTER BEARING DIA:	130
(B) INNER BEARING DIA:	130
(C) STUD HOLE DIA:	21
(D) HEIGHT:	143
(E) OUTER FLANGE DIA:	316
WEIGHT	14.6 Kg

USES FAG BEARING  
803194.26.H195

**OEM:** 1707742

### HUB0057

SUPPLIED WITH FAG BEARING FITTED

**FAG**



## COMPLETE WHEEL END HUB KIT

### HUBKIT0056

SUPPLIED WITH FAG BEARING, ABS RING & WHEEL STUDS FITTED

**DAF**

**FAG**

#### Vehicle Applications

DAF LF55

REAR AXLE



### HUBKIT0057

SUPPLIED WITH FAG BEARING, ABS RING & WHEEL STUDS FITTED

**DAF**

**FAG**

#### Vehicle Applications

DAF LF45 12 Ton

REAR AXLE



# WINNARD

## INSTALLATION BULLETIN FOR SCANIA REAR WHEEL HUBS FITTED WITH FAG KHM218248.218210 (FAG0017) TAPPER ROLLER BEARINGS

1. To ensure the correct operation of the bearings it is vital that inner bearing (7) & outer bearing (9) are packed with the vehicle manufacturers recommended grease.
2. The pre-load sleeve (8) **MUST** be fitted. This sleeve prevents torque being transferred to the bearing rollers. Pre-load sleeve part number: 1507770, Winnard HSK0032-1.
3. This bulletin is highlighting the importance of installing the pre-load sleeve and correctly greasing the bearings. When carrying out a hub / wheel bearing replacement it is essential to adhere to the manufacturers installation guidelines and examine the vehicles overall condition.

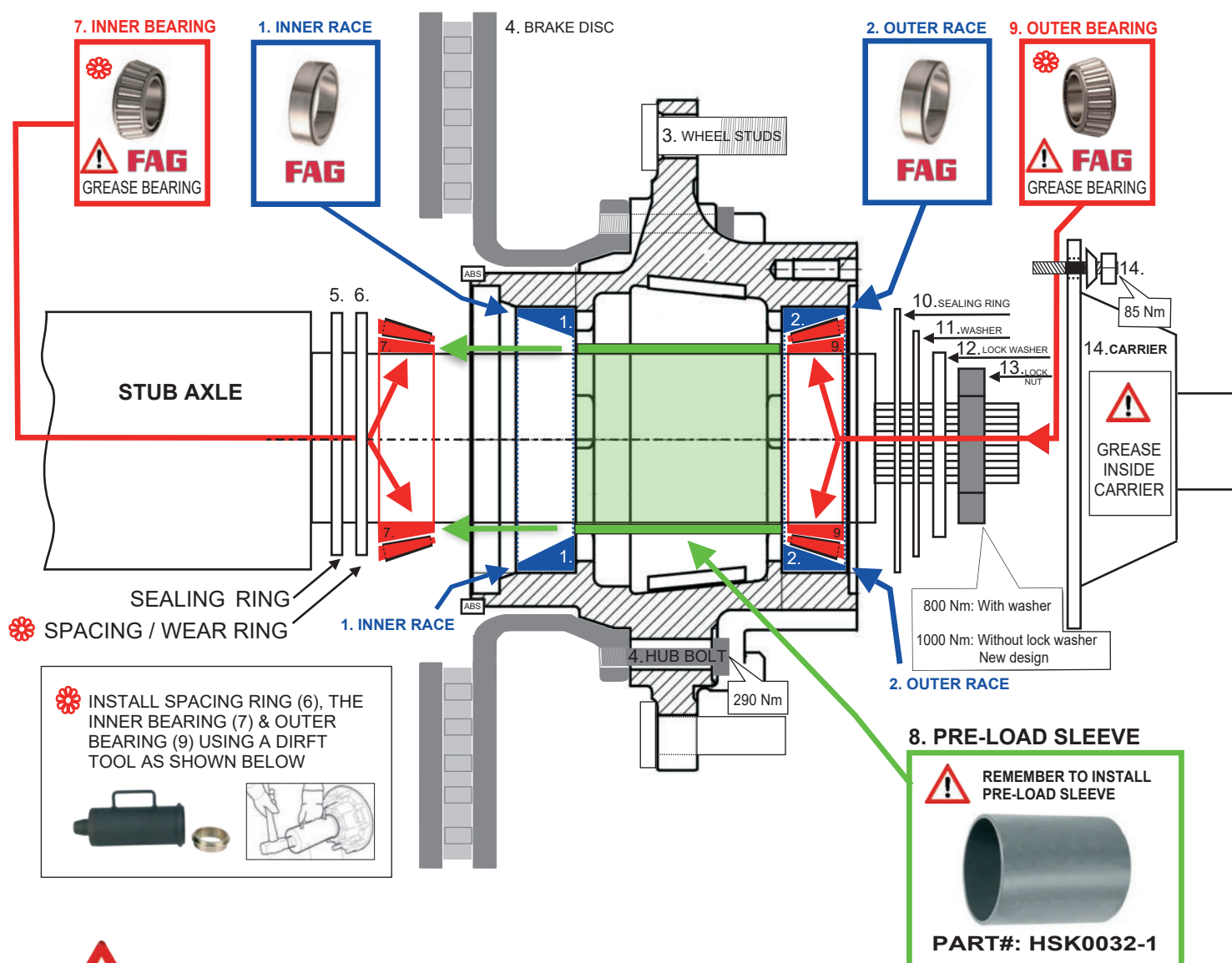

**FAILURE TO FOLLOW THE INSTALLATION PROCEDURE CAN CAUSE PREMATURE BEARING FAILURE**

Thos. Winnard & Sons Ltd 2023 [www.winnard.co.uk](http://www.winnard.co.uk)

Original Equipment Manufacturers part numbers are used for reference purposes only and do not imply that their parts will be supplied.

# WINNARD

## TECHNICAL BULLETIN

### DAF 7.5T FRONT / TRAILING WHEEL HUB

This technical bulletin is designed to help customers understand the difference between the older and newer 7.5T front / trailing wheel hubs and to provide installation guidance.

#### OLD HUB DESIGN



**WINNARD HUB0003NB**  
**OEM 1388905, 1391615**  
**USES FAG BEARING 566834.H195**

#### NEW HUB DESIGN



**WINNARD HUB0004NB**  
**OEM 1818004, 1699327, 2019789**  
**USES FAG BEARING 566074.H195**



**PLEASE NOTE:** While the OE and Winnard designs of these hubs have a different wheel flange configurations there are hubs available in the market that both have a similar petaled arrangement like HUB0003NB. Therefore, it is advisable to check the outer bearing diameter to identify the correct part.

HUB0003NB has a 120mm outer bearing diameter and HUB0004NB 125mm.  
 To double check this you can measure the outer hub location diameter of the hub cap.

HUB CAP 1691965 = 125mm and fits with HUB0004NB  
 HUB CAP 1339107 = 120mm and fits with HUB0003NB

HUB CAP LOCATION DIAMETER  
 120 or 125mm



It is possible to install the newer hub, HUB0004NB, in place of the older hub, HUB0003NB, but you need to order the HUB0004NB service kit order to do so, our part number HSK0004. A service kit for HUB0003NB is also available if required, HSK0003

DESCRIPTION	ITEM	KIT PARTS FOR OLD HUB HUB0003NB	KIT PARTS FOR NEW HUB HUB0004NB
HUB CAP	1	1339107	1691965
O-ring	2	393841	1692506
Axle Nut	3	1396606	1697215
Locking Plate	4	1385327	1692215
<b>WINNARD SERVICE KIT PART #</b>	<b>1-4</b>	<b>HSK0003</b> <small>(It contains all the above parts but they may be purchased separately. Example 1692215-1)</small>	<b>HSK0004</b> <small>(It contains all the above parts but they may be purchased separately. Example 1692215-1)</small>



When installing the new hub, HUB0004NB, on an old axle mount the locking plate so that the axle nut (3) fits in the recess.

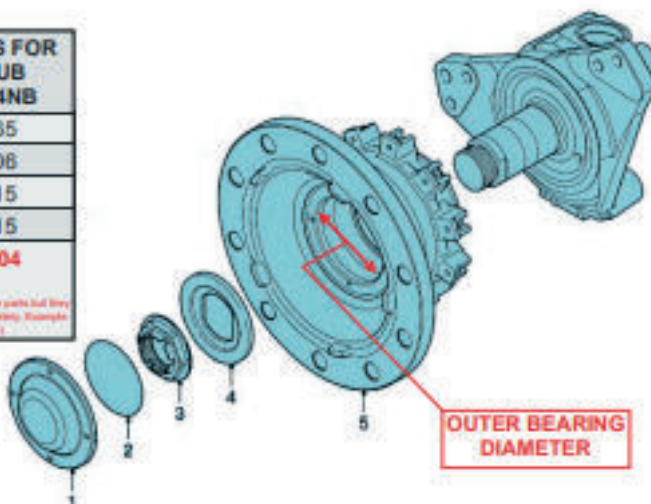



# WINNARD

Visit the Winnard web site for the latest Company & Product news: [www.winnard.co.uk](http://www.winnard.co.uk)

WINNARD

NEWS VEHICLES PRODUCTS CATALOGUE DOWNLOADS CONTACT ABOUT US

Quick Search

Dimension Search

Quick Buy

Admin Panel

Terms & Conditions

Your Basket (0)

My Account

## Latest Products



**HUBKIT0055** (Mar 20, 2024)  
NEW TO RANGE - DAF LF 45 REAR HUBKIT - 1407582



**HUBKIT0056** (Mar 20, 2024)  
NEW TO RANGE - DAF LF 55 REAR HUBKIT - 1400289, 1702952



**HUBKIT0057** (Mar 20, 2024)  
NEW TO RANGE - DAF LF45 REAR HUB KIT 1707742



**WBSK0051** (Jan 12, 2024)  
410 x 225 - VL/89/2 - ECE R90 approved Lined Wheel End kit Kit



**HUB0054** (Oct 25, 2023)  
NEW TO RANGE - DAF LF 45 REAR HUB WITH FAG BEARING FITTED - AVAILABLE AS A HUBKIT



**ABS0092** (Oct 25, 2023)  
NEW TO RANGE - ABS RING FOR MT1032 - QMX925100



**HUB0054NB** (Oct 20, 2023)  
NEW TO RANGE - DAF LF 45 REAR HUB



**JC1005** (Sep 26, 2023)  
NEW TO RANGE - JCB FASTRAC

## Product Groups

Select Group...

Go

## Download Catalogues

[Winnard Hub and Hub Kit Range October 2023.pdf](#)

[Winnard Lined Brake Shoe Kits October 2023.pdf](#)

[Bus, Truck, Trailer, Light Commercial, Industrial](#)

## Recent Vehicles

[Volvo FL 6 Series FL6.08, 6.09, 6.10, 6.11 - With Disc Brakes](#) 1987 → 2000

[Mercedes Benz Unimog](#) 1992 → Current

[Kessler Axle Brake Discs - All applications from 2010 with Wabco MAXXUS 22 caliper](#) 2010 → Current

[ADR Axles 300 x 160](#) 2000 → Current

[Gigant 305 x 150](#) 2000 → Current

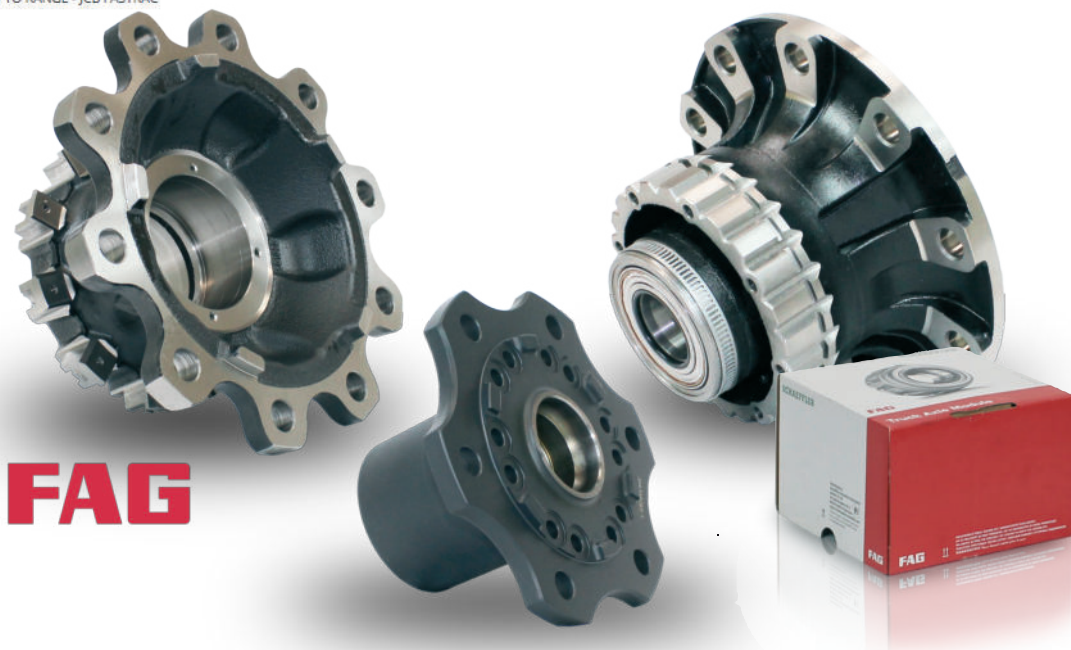

O.E. manufacturers parts numbers and names are used for reference purposes only and does not imply that their parts will be supplied.

# WINNARD

## ECE R90 APPROVED BRAKING COMPONENTS

**BRAKE DISCS**

**BRAKE PADS**

**BRAKE DRUMS**

**BRAKE LININGS**

**WEAR LEADS**

**HUBS & HUBKITS**

**BRAKE SHOES & LINED KITS**

**ABS RINGS & FITTING KITS**

**Thos. Winnard & Sons Ltd**

Mangham Road

Barbot Hall Ind Est

Rotherham

UK S62 6EF

Tel: +44 1709 712000

Email: [sales@winnard.co.uk](mailto:sales@winnard.co.uk)

**UK**



**FRANCE**

**Winnard France SAS**

12 Rue des Tourneballets

28110 Lucé FRANCE

Tel: +33 234400401

Email: [commande@winnard.fr](mailto:commande@winnard.fr)



**ECE R90 APPROVED**

**DESIGNED & TESTED IN THE UK**