



PLATIN
B A T T E R Y

Premium for your vehicle



TETRA CORE PLATE TECHNOLOGY

Active Material recipe developed with 50 years of production experience.



Tetra Core Plate

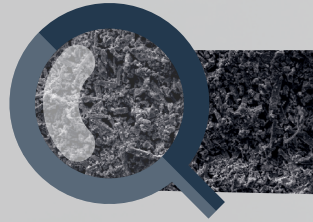

Massive cranking power abilities.
Superior life cycle.
Excellent structural stability.
Perfect chemical composition

Flawless corrosion result even under the temperatures that is more than double as high (60°C) against the competitors' standards (25°C)

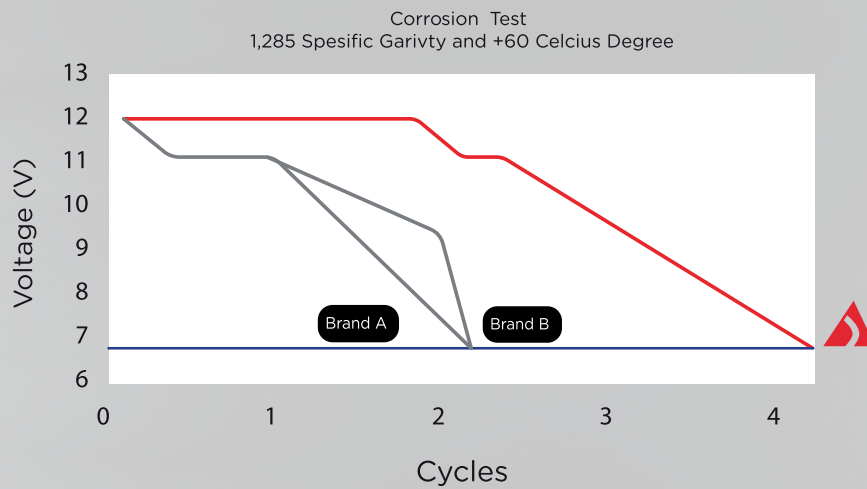

LIFE CYCLE

Excellent Charge Acceptance under all environmental conditions (0°C-25°C-40°C)
Reinforced Cold Cranking Power Capabilities

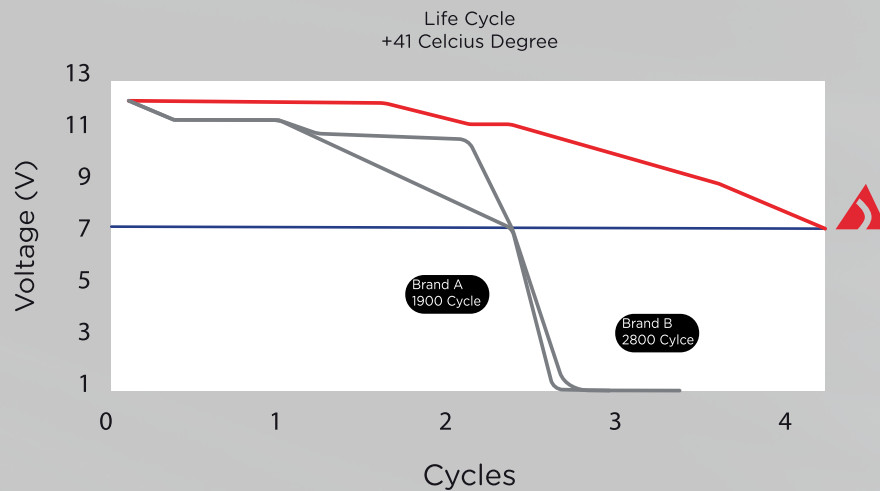

Cranking power enhanced by %20
For high performance.



Strong structure



Advanced and quick charge
capability



Terminal



Patented closed lid system



Special grid design with
strong positive plates

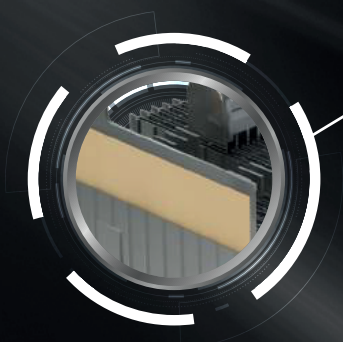

20% extra performance
with special paste formula

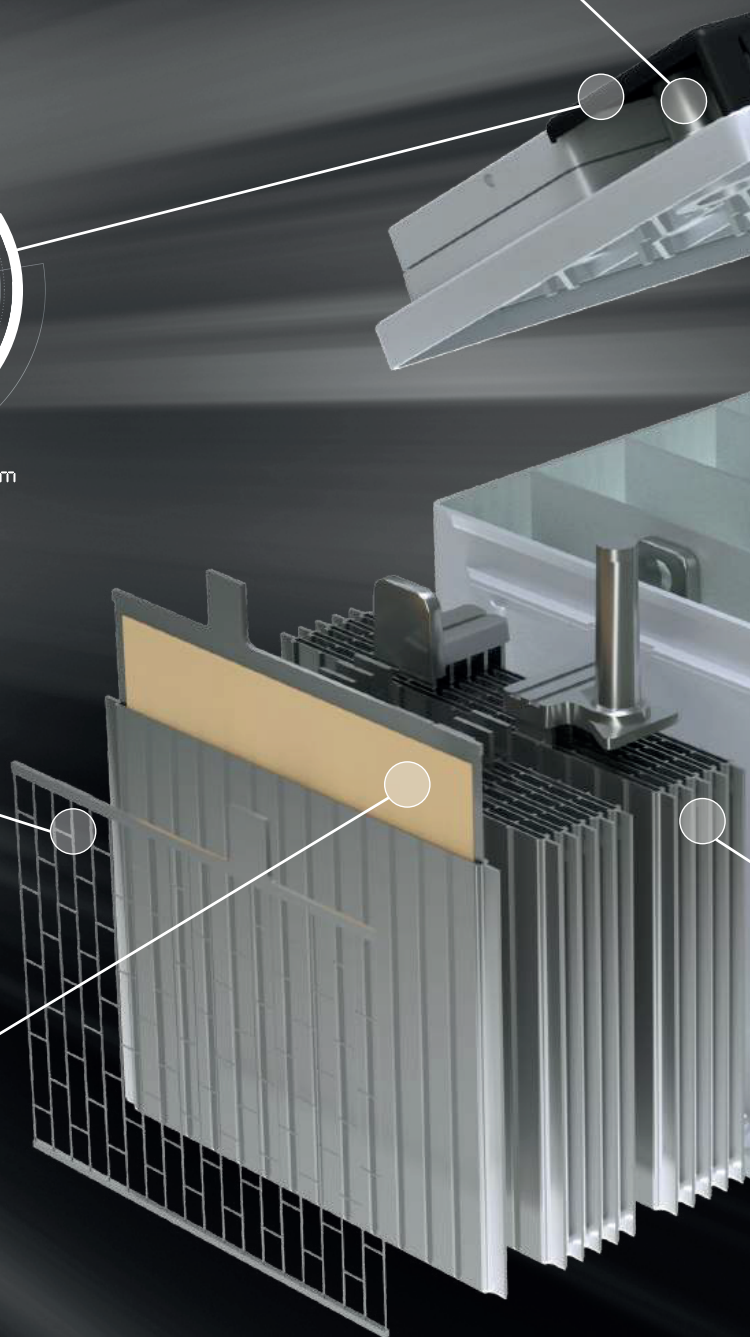



Highest level of product warranty in compliance with all standards including TSE, EN, BCI, JIS, DIN, IEC, SAE, etc.



All temperatures from desert heat to freezing cold.



Production in compliance with the OEM Standards



Indicator



Polypropylene case

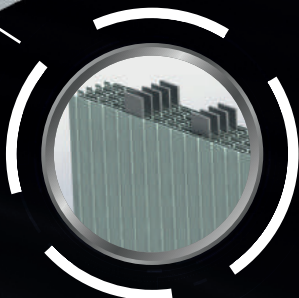

Premium quality separator

EUROPEAN SERIES



LAYOUT

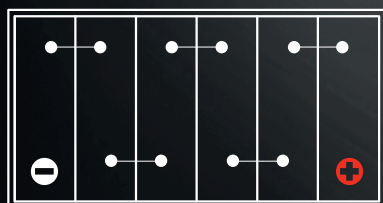

0

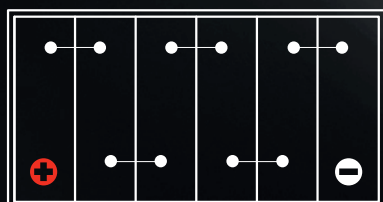

1

TERMINAL



STD

BASE HOLD DOWN (BHD)



B13



B14

*B14 BHD option is available by client requests.

**Reverse polarity is available for all types.

MODEL REF.		CAPACITY		CCA		DIMENSIONS					
BCI	DIN	AH	RC	SAE	A(EN)	LENGTH (MM)	WIDTH (MM)	HEIGHT (MM)	LAY OUT	TERMINAL	HOLD DOWN
-	LO	40	61	370	350	175	175	190	O/1	STD	B13
99	LB1	36	52	340	330	207	175	175	O/1	STD	B13
		40	59	380	360	207	175	175	O/1	STD	B13
		45	70	440	420	207	175	175	O/1	STD	B13
		50	75	500	460	207	175	175	O/1	STD	B13
140R	L1	36	52	340	330	207	175	190	O/1	STD	B13
		40	59	380	360	207	175	190	O/1	STD	B13
		45	70	440	420	207	175	190	O/1	STD	B13
		50	75	500	460	207	175	190	O/1	STD	B13
42,90, 96	LB2	55	86	550	500	207	175	190	O/1	STD	B13
		36	52	340	330	242	175	175	O/1	STD	B13
		40	59	380	360	242	175	175	O/1	STD	B13
		45	70	440	420	242	175	175	O/1	STD	B13
47	L2	50	75	500	460	242	175	175	O/1	STD	B13
		55	86	550	500	242	175	175	O/1	STD	B13
		60	96	600	560	242	175	175	O/1	STD	B13
		64	109	640	620	242	175	190	O/1	STD	B13
40,91	LB3	64	109	640	620	242	175	190	O/1	STD	B13
		70	114	660	640	278	175	175	O/1	STD	B13
		75	124	700	680	278	175	175	O/1	STD	B13
		80	130	750	710	278	175	175	O/1	STD	B13
48	L3	55	86	560	500	278	175	175	O/1	STD	B13
		60	96	600	560	278	175	190	O/1	STD	B13
		64	109	640	620	278	175	190	O/1	STD	B13
		70	114	660	640	278	175	190	O/1	STD	B13
92	LB4	75	124	700	680	278	175	190	O/1	STD	B13
		80	130	750	710	278	175	190	O/1	STD	B13
		70	114	660	640	315	175	175	O/1	STD	B13
		75	124	700	680	315	175	175	O/1	STD	B13
94	L4	80	130	750	710	315	175	175	O/1	STD	B13
		84	145	800	760	315	175	175	O/1	STD	B13
		90	151	860	810	315	175	175	O/1	STD	B13
		70	114	660	640	315	175	190	O/1	STD	B13
93	LB5	75	124	700	680	315	175	190	O/1	STD	B13
		80	130	750	710	315	175	190	O/1	STD	B13
		84	145	800	760	315	175	175	O/1	STD	B13
		90	151	860	810	315	175	175	O/1	STD	B13
49	L5	94	165	900	860	353	175	175	O/1	STD	B13
		100	173	950	900	353	175	175	O/1	STD	B13
		105	189	1000	950	353	175	175	O/1	STD	B13
		80	130	750	710	353	175	190	O/1	STD	B13
93	LB5	84	145	800	760	353	175	175	O/1	STD	B13
		90	151	860	810	353	175	175	O/1	STD	B13
		94	165	900	860	353	175	175	O/1	STD	B13
		100	173	950	900	353	175	190	O/1	STD	B13
49	L5	105	186	1000	950	353	175	190	O/1	STD	B13
		80	130	750	710	353	175	190	O/1	STD	B13
		84	145	800	760	353	175	190	O/1	STD	B13
		90	151	860	810	353	175	190	O/1	STD	B13

ASIAN SERIES



LAYOUT

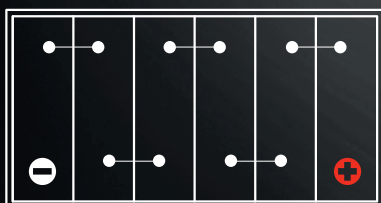

0

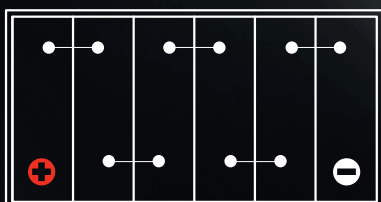

1

TERMINAL



STD



SM

BASE HOLD DOWN (BHD)



B00



B01



B03



B09



B10

*Reverse polarity is available for all types.

MODEL REF.			CAPACITY		CCA		DIMENSIONS					
BCI	JIS	DIN	AH	RC	SAE	A(EN)	LENGTH (MM)	WIDTH (MM)	HEIGHT (MM)	LAY OUT	TERMINAL	HOLD DOWN
-	B20	NS40	36	54	280	250	196	128	225	O/1	STD/SM	B00/B01
			40	57	320	300	196	128	225	O/1	STD/SM	B00/B01
			45	70	370	330	196	128	225	O/1	STD/SM	B00/B01
			50	73	400	380	196	128	225	O/1	STD/SM	B00/B01
51	B24, NX100	NS60	45	70	370	330	237	128	225	O/1	STD/SM	B00/B01
			50	73	400	380	237	128	225	O/1	STD/SM	B00/B01
			55	89	450	420	237	128	225	O/1	STD/SM	B00/B01
			60	93	500	460	237	128	225	O/1	STD/SM	B00/B01
25/35	D23	D23	48	70	420	390	230	172	225	O/1	STD	B00/B01/B03/B09
			50	75	480	440	230	172	225	O/1	STD	B00/B01/B03/B09
			55	90	550	510	230	172	225	O/1	STD	B00/B01/B03/B09
			60	94	580	550	230	172	225	O/1	STD	B00/B01/B03/B09
			64	108	640	600	230	172	225	O/1	STD	B00/B01/B03/B09
			70	116	680	630	230	172	225	O/1	STD	B00/B01/B03/B09
24	D26	N50	48	70	420	390	260	173	225	O/1	STD	B00/B01/B03/B09/B10
			50	75	480	440	260	173	225	O/1	STD	B00/B01/B03/B09/B10
			55	90	550	510	260	173	225	O/1	STD	B00/B01/B03/B09/B10
			60	94	580	550	260	173	225	O/1	STD	B00/B01/B03/B09/B10
			64	108	640	600	260	173	225	O/1	STD	B00/B01/B03/B09/B10
			70	116	680	630	260	173	225	O/1	STD	B00/B01/B03/B09/B10
			72	126	700	660	260	173	225	O/1	STD	B00/B01/B03/B09/B10
			80	132	760	710	260	173	225	O/1	STD	B00/B01/B03/B09/B10
27	D31	N70	70	116	660	630	306	173	225	O/1	STD	B00/B01/B03
			72	126	700	670	306	173	225	O/1	STD	B00/B01/B03
			80	132	750	710	306	173	225	O/1	STD	B00/B01/B03
			82	146	780	730	306	173	225	O/1	STD	B00/B01/B03
			85	151	820	760	306	173	225	O/1	STD	B00/B01/B03
			90	164	840	800	306	173	225	O/1	STD	B00/B01/B03
			95	172	870	840	306	173	225	O/1	STD	B00/B01/B03
			100	189	920	880	306	173	225	O/1	STD	B00/B01/B03

AMERICAN SERIES



LAYOUT

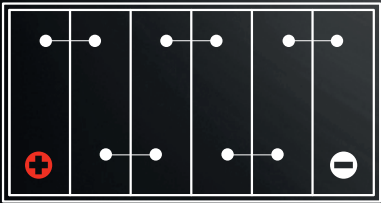

1

TERMINAL



STD

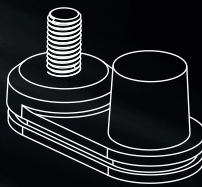

DUAL

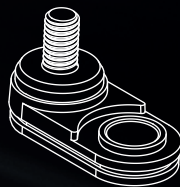

SCREW

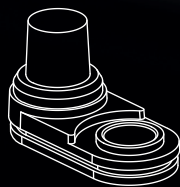

STANDARD

BASE HOLD DOWN (BHD)



B00



B01



B03

MODEL REF.	CAPACITY		CCA		DIMENSIONS					
BCI	AH	RC	SAE	A(EN)	LENGTH (MM)	WIDTH (MM)	HEIGHT (MM)	LAY OUT	TERMINAL	HOLD DOWN
31/31S/31A/30H	75	126	700	660	330	172	238	1	STD/SCREW	B00/B03
	80	132	740	700	330	172	238	1	STD/SCREW	B00/B03
	82	148	780	740	330	172	238	1	STD/SCREW	B00/B03
	85	154	820	760	330	172	238	1	STD/SCREW	B00/B03
	90	166	850	800	330	172	238	1	STD/SCREW	B00/B03
	95	178	900	860	330	172	238	1	STD/SCREW	B00/B03
	100	190	940	910	330	172	238	1	STD/SCREW	B00/B03
	105	194	980	950	330	172	238	1	STD/SCREW	B00/B03
65	70	116	660	640	288	198	191	1	STD	B00/B01
	75	124	720	680	288	198	191	1	STD	B00/B01
	80	131	750	710	288	198	191	1	STD	B00/B01

*B03 BHD option is available by client requests.

HEAVY DUTY



LAYOUT

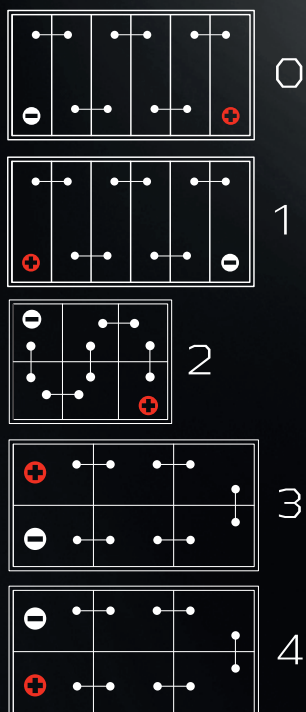

TERMINAL



BASE HOLD DOWN (BHD)



Heavy Duty Series - SMF (Sealed Maintenance Free)											
MODEL REF.		CAPACITY		CCA		DIMENSIONS					
BCI	DIN	AH	RC	SAE	A(EN)	LENGTH (MM)	WIDTH (MM)	HEIGHT (MM)	LAY OUT	TERMINAL	HOLD DOWN
-	A(D4)	120	223	870	800	513	189	223	3/4	STD	B00/B03
-	A(D4)	135	256	980	860	513	189	223	3/4	STD	B00/B03
4D	B(D5)	150	290	1040	900	513	223	223	3/4	STD	B00/B03
4D	B(D5)	165	324	1090	980	513	223	223	3/4	STD	B00/B03
4D	B(D5)	180	360	1200	1050	513	223	223	3/4	STD	B00/B03
8D	C(D6)	200	407	1250	1130	518	276	242	3/4	STD	B00
8D	C(D6)	210	432	1250	1150	518	276	242	3/4	STD	B00
8D	C(D6)	225	468	1310	1230	518	276	242	3/4	STD	B00

*Reverse polarity is available for all types.

Heavy Duty Series - MF (With Plugs)												
-	-	H3	90	158	650	600	324	175	227	0	STD	B03
-	-	H4	105	190	760	700	346	175	230	0	STD	B03
-	-	D2	105	190	760	700	349	175	235	0	STD	B00/B01
-	-	D2	110	201	820	750	349	175	235	0	STD	B00/B01
-	-	D2	115	212	870	800	349	175	235	0	STD	B00/B01
A* HD	-	A(D4)	120	223	870	800	513	189	223	3/4	STD	B00/B03
	-	A(D4)	135	256	980	900	513	189	223	3/4	STD	B00/B03
	-	A(D4)	145	278	1040	950	513	189	223	3/4	STD	B00/B03
	-	A(D4)	150	290	1040	950	513	189	223	3/4	STD	B00/B03
B* HD	-	B(D5)	150	290	1040	950	513	223	223	3/4	STD	B00/B03
	-	B(D5)	165	324	1090	1000	513	223	223	3/4	STD	B00/B03
C* HD	8D	B(D5)	180	360	1200	1100	513	223	223	3/4	STD	B00/B03
	8D	C(D6)	200	407	1250	1150	518	276	242	3/4	STD	B00
	8D	C(D6)	210	432	1250	1150	518	276	242	3/4	STD	B00
	8D	C(D6)	225	468	1310	1200	518	276	242	3/4	STD	B00
		C(D6)	240	505	1310	1200	518	276	242	3/4	STD	B00

*Reverse polarity is available for all types.

Tank Series - MF (With Plugs)												
Nato	6TL	D7	100	179	680	640	286	270	230	2	STD	B00
Nato	6TL	D7	125	234	850	800	286	270	230	2	STD	B00

MARINE SERIES



LAYOUT

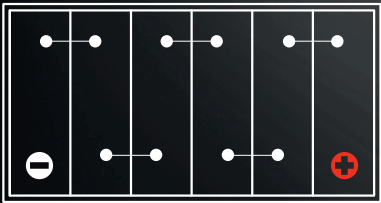

0

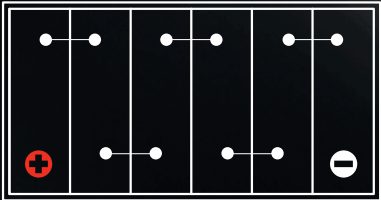

1

TERMINAL

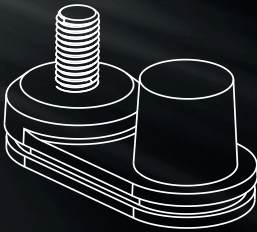

DUAL

BASE HOLD DOWN (BHD)



B00

MODEL REF.			CAPACITY		CCA		DIMENSIONS						
BCI	JIS	DIN	AH	RC	SAE	A(EN)	LENGTH (MM)	WIDTH (MM)	HEIGHT (MM)	LAY OUT	TERMINAL	HOLD DOWN	LID
31	GR31	31D	85	151	820	760	330	172	238	1	Dual	B00	SMF/MF
			95	171	900	860	330	172	238	1	Dual	B00	SMF/MF
			105	192	980	950	330	172	238	1	Dual	B00	SMF/MF
24	D26	N50	70	116	680	630	260	173	225	0/1	Dual	B00	SMF
			72	126	700	660	260	173	225	0/1	Dual	B00	SMF
			80	132	760	710	260	173	225	0/1	Dual	B00	SMF
27	D31	N70	82	146	780	730	306	173	225	0/1	Dual	B00	SMF
			85	151	820	760	306	173	225	0/1	Dual	B00	SMF
			90	164	840	800	306	173	225	0/1	Dual	B00	SMF
			95	172	870	840	306	173	225	0/1	Dual	B00	SMF

EFB START&STOP SERIES & SIGNATURE LINE



LAYOUT

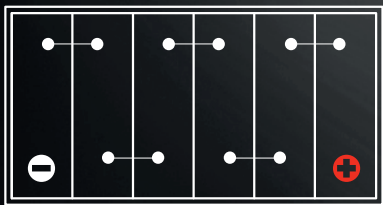

0

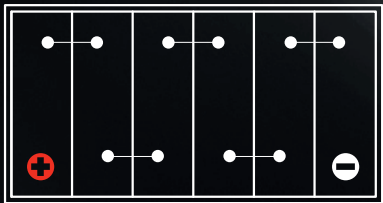

1

TERMINAL



STD

BASE HOLD DOWN (BHD)



B00

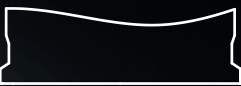

B01



B13

Start & Stop EFB	Group No	AH	RC	SAE	A(EN)	LENGTH (MM)	WIDTH (MM)	HEIGHT (MM)	LAY OUT	TERMINAL	HOLD DOWN
L2	47	63	106	580	530	242	175	190	0/1	STD	B13
L2B	42	63	106	580	530	242	175	175	0/1	STD	B13
L3	48	72	137	740	700	278	175	190	0/1	STD	B13
L3B	91	72	137	740	700	278	175	175	0/1	STD	B13
D23	25/35	70	122	620	580	230	172	225	0/1	STD	B00
N50	24	70	122	620	580	260	170	225	0/1	STD	B00
N70	27	100	178	820	770	306	176	225	0/1	STD	B00

SIGATURE LINE	Group No	AH	RC	SAE	A(EN)	LENGTH (MM)	WIDTH (MM)	HEIGHT (MM)	LAY OUT	TERMINAL	HOLD DOWN
L2	47	62	102	660	620	242	175	190	0/1	STD	B13
L3	48	80	134	760	720	278	175	190	0/1	STD	B13
NS60	51	52	81	470	440	236	128	225	0/1	STD	B00
N50	24	80	138	670	630	260	170	225	0/1	STD	B01
N70	27	90	160	850	830	306	176	225	0/1	STD	B01





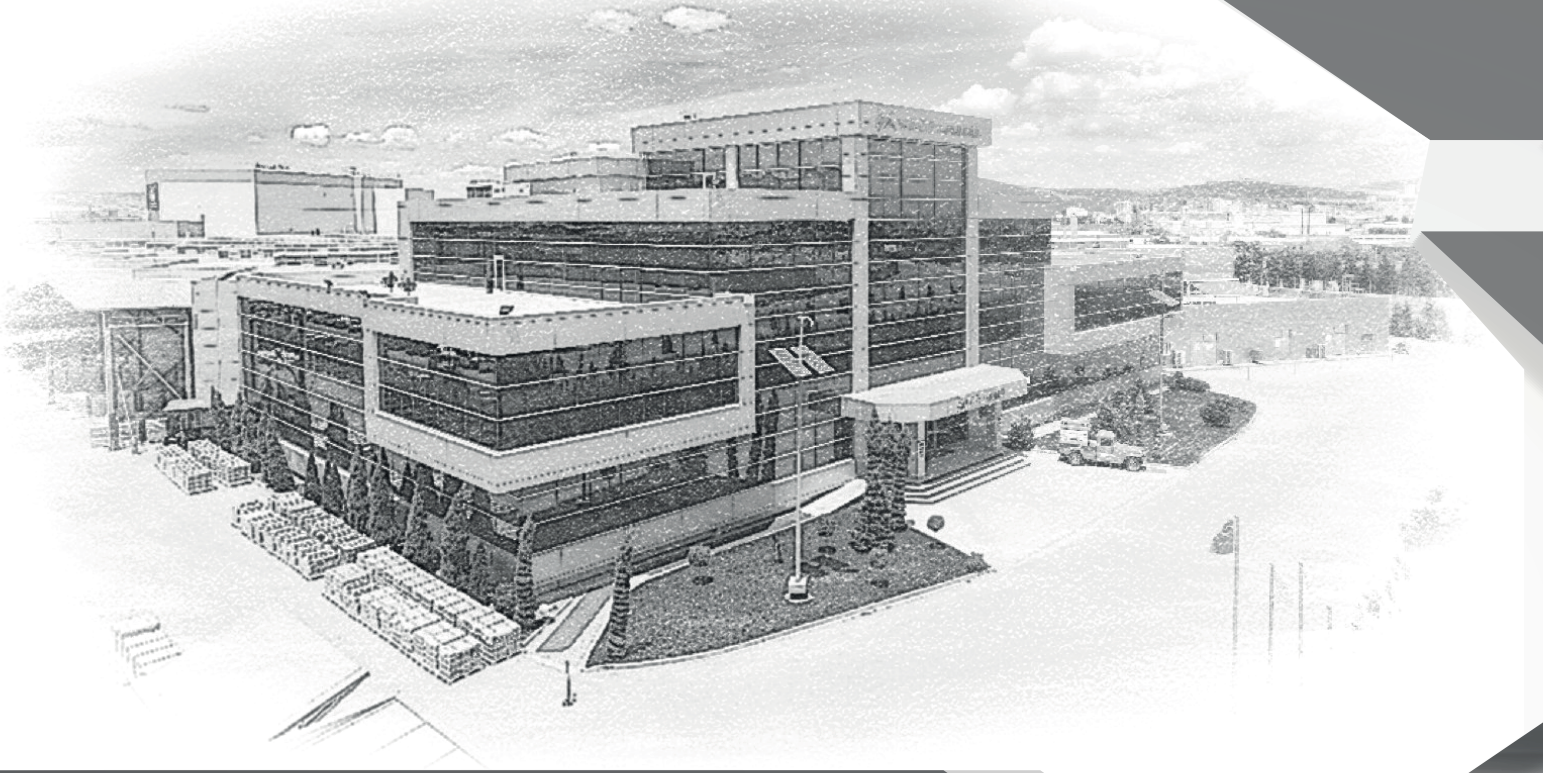

Yiğit Akü Malzemeleri A.Ş.

Organize Sanayi Bölgesi Oğuz Caddesi No: 2 Sincan/ANKARA

+90 312 267 02 80

+90 312 267 08 61

info@yigitaku.com | export@yigitaku.com