

GRUNER SERVOMOTORS

# SUPERFAST RUNNING ACTUATOR WITH HIGH TORQUE, CONTINUOUS CONTROL AND ADDITIONAL FAILSAFE 364C & 364Q

NEW DEVELOPMENT!





# REVOLUTIONIZING TECHNICAL BUILDINGS: UNMATCHED RUNNING TIME WITH MAXIMUM TORQUE, SETTING A NEW STANDARD IN PERFORMANCE. 20 s / 90° WITH 40 Nm

## 364C CONTINUOUS CONTROLLED SERVOMOTOR WITH ADDITIONAL MODBUS COMMUNICATION

- Test button with integrated LED to indicate power supply and for functional check
- Service connection for parameterisation (no power supply to the actuator is needed)
- Additional formfit inserts in different sizes
- 2 auxiliary switches 10-85°
- Modeswitch (direction of rotation, adaption drive or input signal)

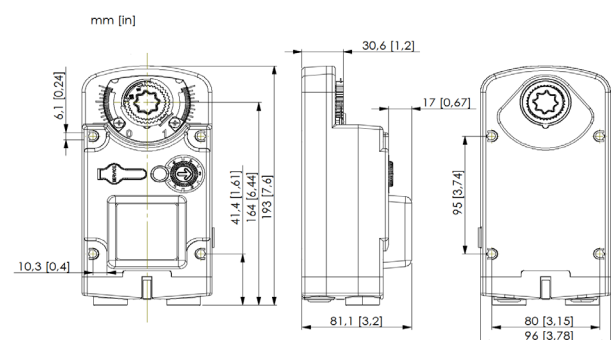
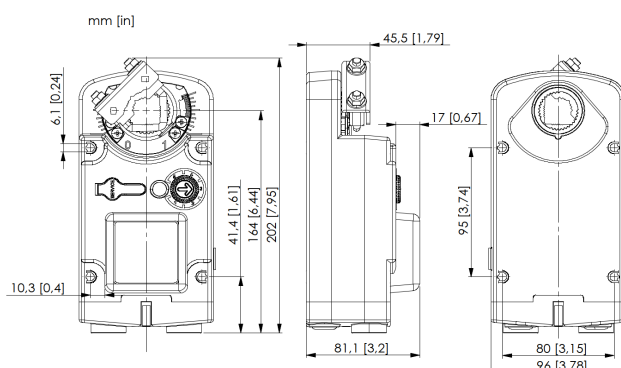

**REVOLUTIONIZING TECHNICAL BUILDING:  
UNMATCHED RUNNING TIME WITH MAXIMUM TORQUE,  
SETTING A NEW STANDARD IN PERFORMANCE.  
20 s / 90° WITH 40 Nm**

## 364Q CONTINUOUS CONTROLLED SERVOMOTOR WITH FAILSAFE POSITION AND ADDITIONAL MODBUS COMMUNICATION

INTERRUPTING THE POWER SUPPLY CAUSES THE SERVOMOTOR TO ROTATE BACK TO ITS PRESET FAILSAFE POSITION, BY MEANS OF STORED ELECTRICAL ENERGY FROM THE BUILD IN SUPERCAPS.

- Failsafe position via supercap
- Test button with integrated LED to indicate power supply and for functional check
- Service connection for parameterisation (no power supply to the actuator is needed)
- Additional formfit inserts in different sizes
- Modeswitch (direction of rotation, adaption drive or failsafe position)

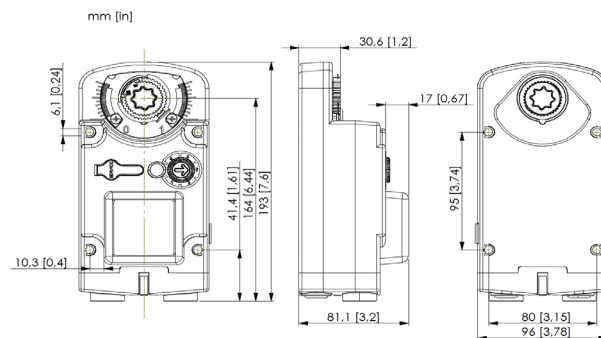
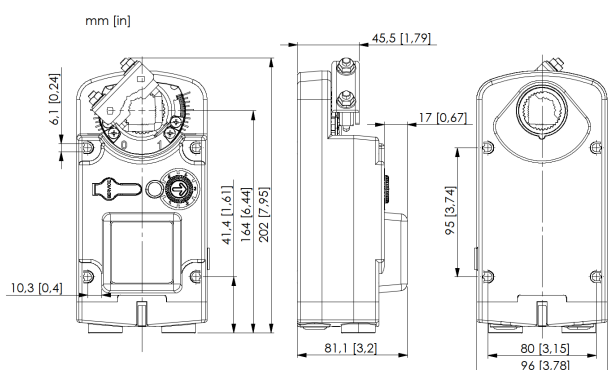



GRUNER AG, headquartered in Wehingen with around 1,300 employees, based in Germany, Tunisia, Serbia and India, is a major manufacturer of actuators, relays and solenoids. Our system solutions for building management, the automotive industry and medical technology are in demand around the world, featuring compelling innovation and quality.

**GRUNER AG**

Bürglestraße 15-17 | 78564 Wehingen | Germany  
T +49 7426 948-0 | F +49 7426 948-200  
[info@gruner.de](mailto:info@gruner.de) | [www.gruner.de](http://www.gruner.de)

03 | 2024